

BRAVIA Wireless Link

Startup Guide

The Startup Guide explains how to connect, setup and use your Wireless Link.

DMX-WL1

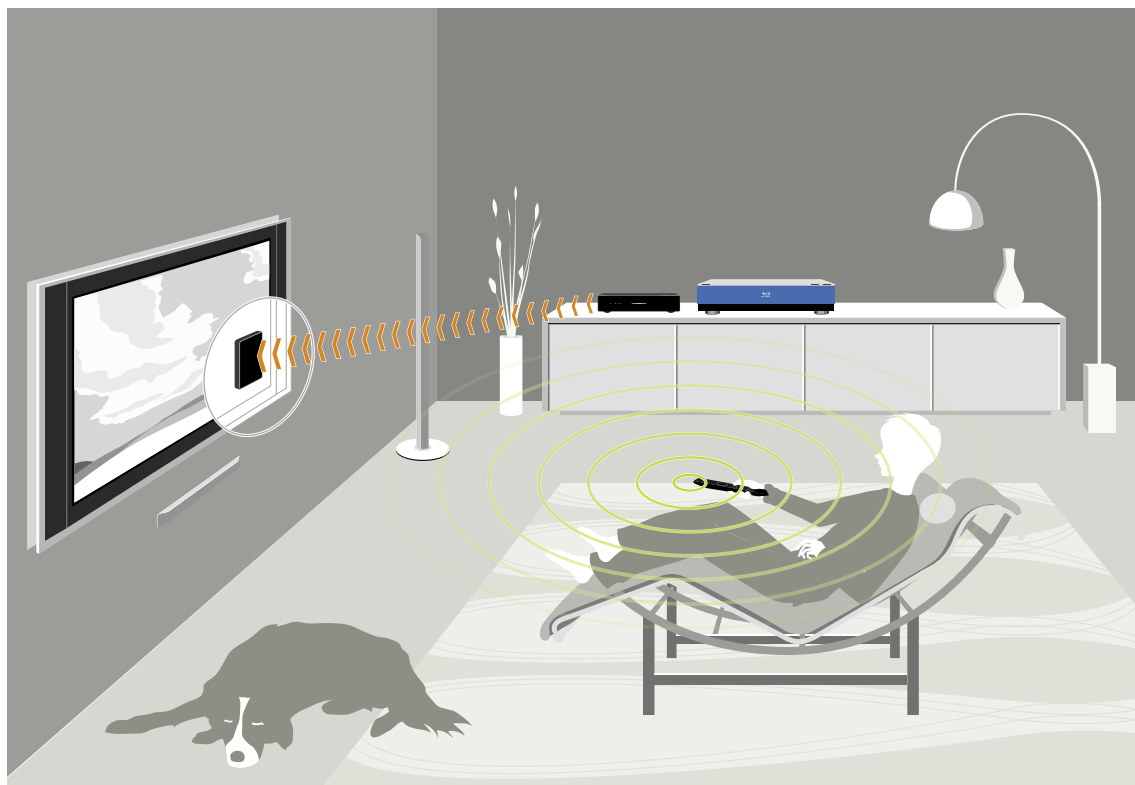

Welcome to the World of Wireless Link

Entertainment made simple

Transmitter and Receiver provide a wireless link between your sources and your compatible BRAVIA HDTV

Real time transmission

For a true gaming experience

Expandability

Support up to 5 source devices (4 HDMI and 1 component)

Simple Operation

Control your BRAVIA HDTV and all connected sources using the supplied remote

Clean and Cable-free

Easy to mount receiver remains concealed behind your compatible BRAVIA HDTV

This product is compatible with Control for HDMI enabled BRAVIA TVs released from 2007. Please check with your retailer or visit <http://www.sonymstyle.com/dmxwl1> to view model compatibility.

1 Connecting the Receiver unit

Attaching the Receiver Unit to the Rear of the TV

Power off your TV before beginning setup.

- 1 Attach the supplied TV Mounting bracket to the bottom left side of the TV rear panel.

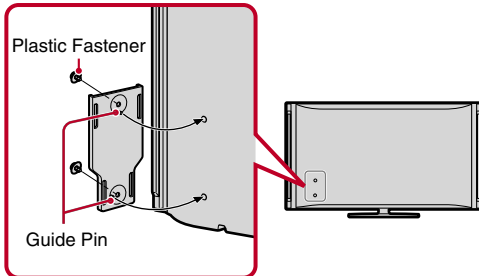

- Do not push on the head of the Plastic Fastener until you have inserted the fastener into the hole of the TV.

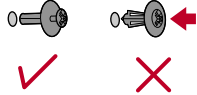

- 2 Align the slider on the bottom of the receiver unit with the groove of the TV Mounting bracket.

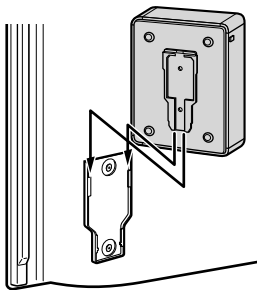

- 3 Slide the receiver unit onto the bracket.

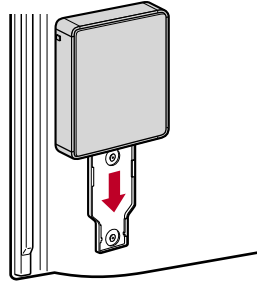

- 4 Connect the receiver unit and TV with the supplied HDMI cable.

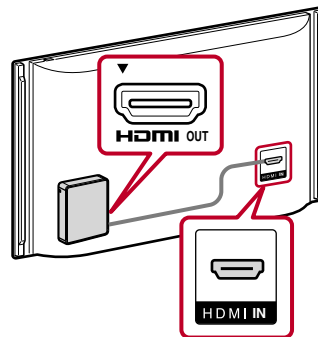

- 5 Connect the AC power adapter with AC power cord between the receiver unit and the wall outlet.

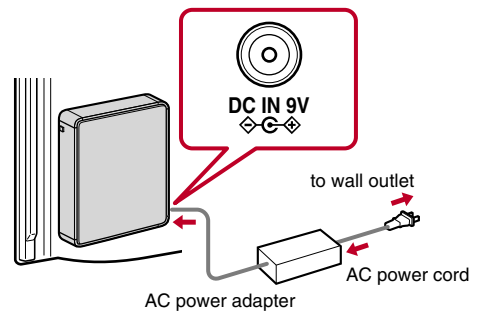

- See the Reference Guide for information for alternate attachment methods.

2 Choosing your setup type

A

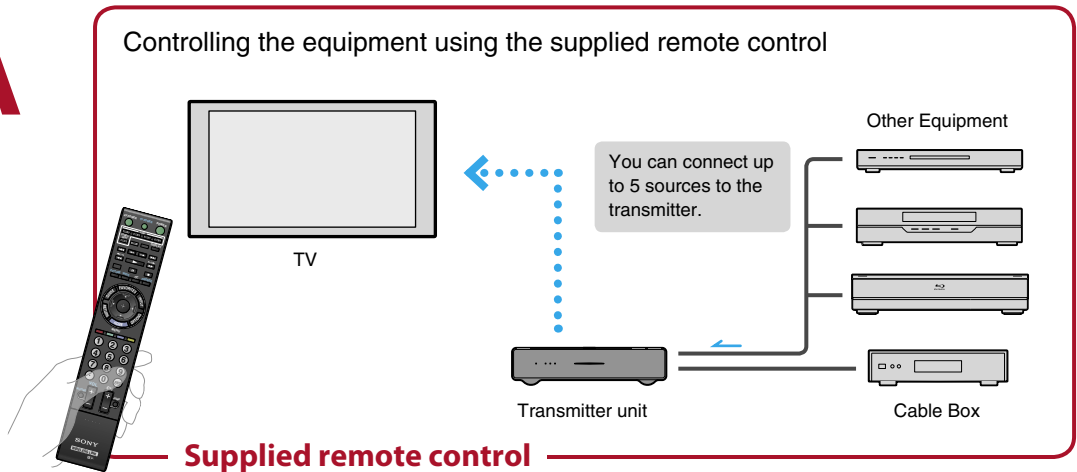

B

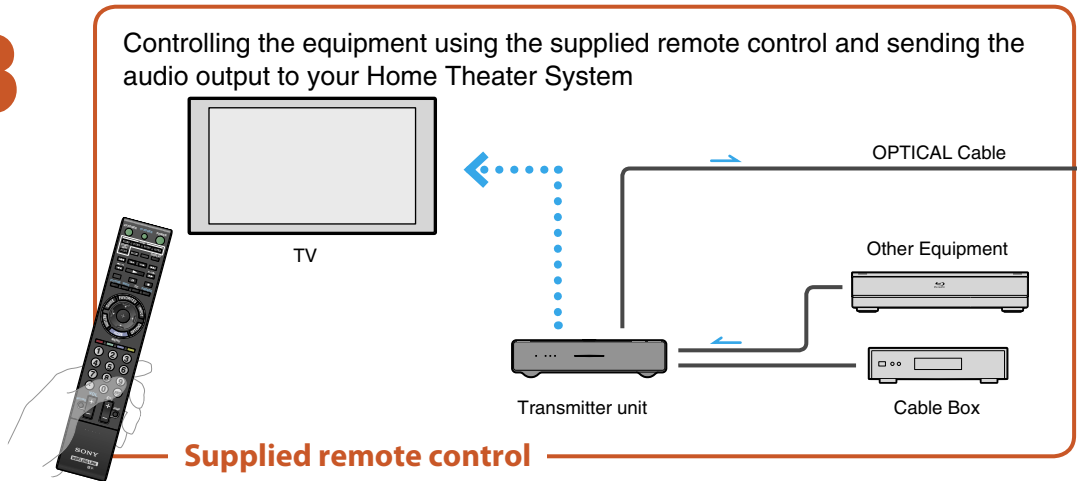

C

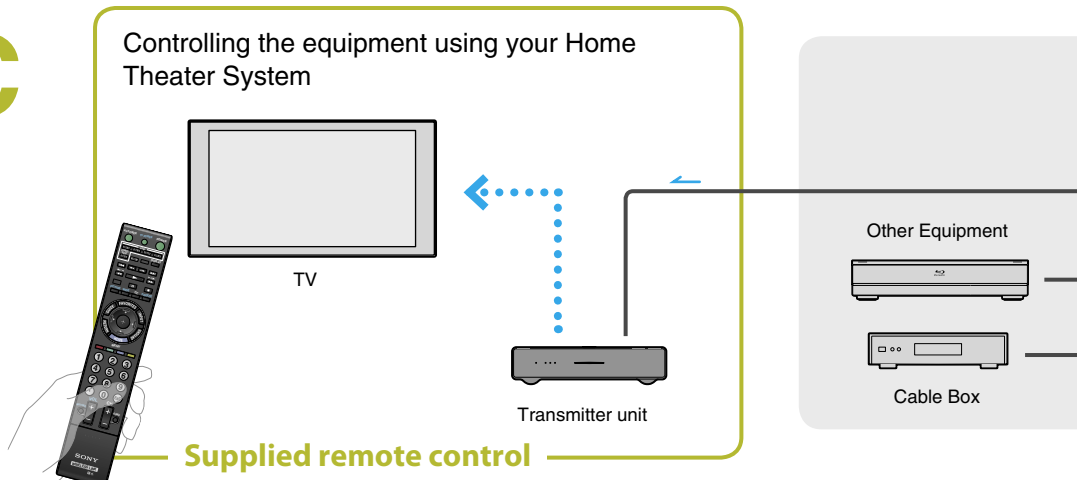

You can operate equipment connected to the transmitter unit with the supplied remote control.

Some equipment may not be supported.



You can operate equipment connected to the transmitter unit with the supplied remote control.

Use your Home Theater System remote control to control the Volume.



Use your Home Theater System remote control to select the sources attached to your Home Theater System.



- You cannot operate any equipment connected to the transmitter unit with the supplied remote control.

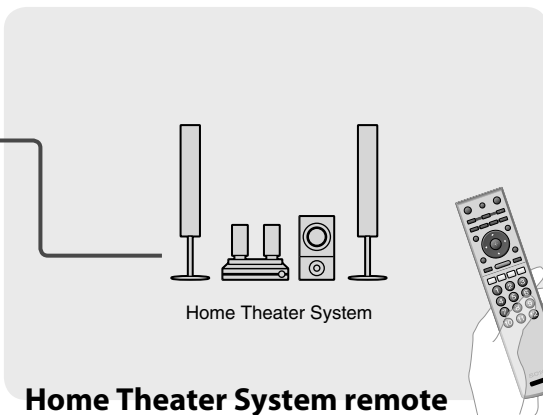

Home Theater System

Home Theater System remote control

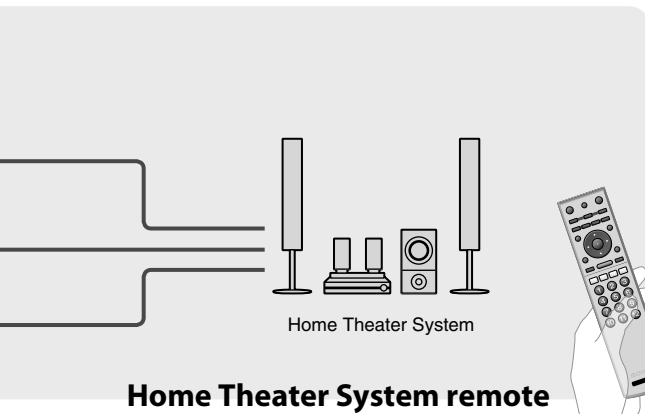

Home Theater System

Home Theater System remote control

3 Connecting the Transmitter unit

A

Transmitter unit

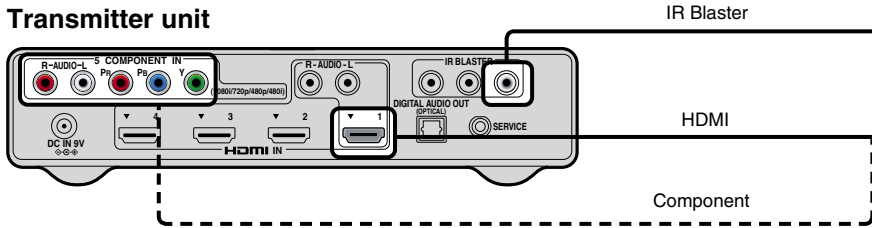

B

Transmitter unit

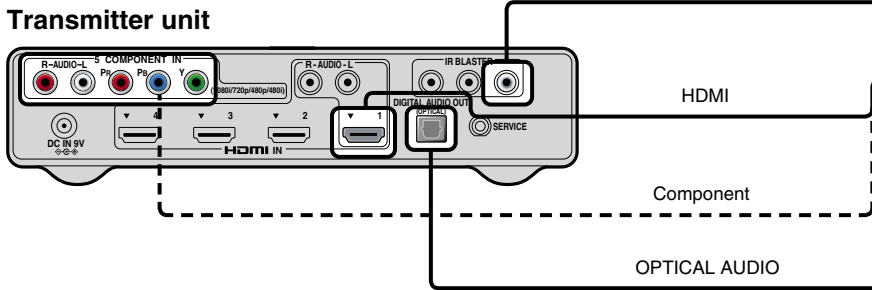

C

Transmitter unit

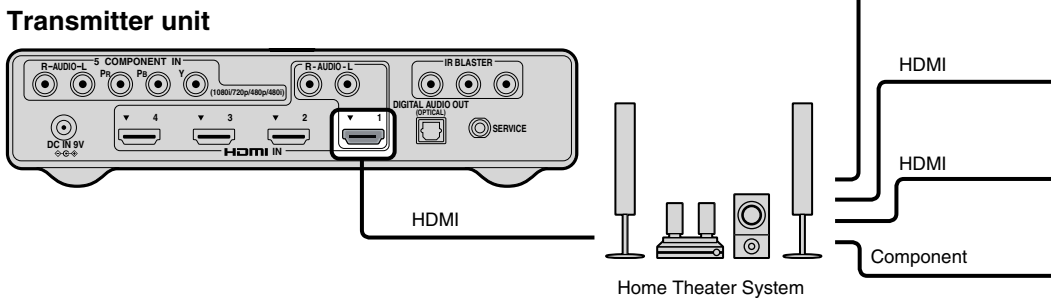

Place the IR Blaster near the IR receiver of the equipment.

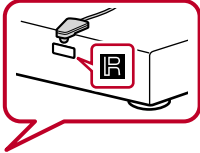

VCR/DVD/Blu-ray Disc/
Satellite receiver/
Cable box

Place the IR Blaster near the IR receiver of the equipment.

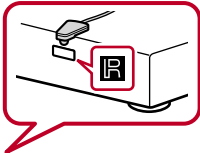

VCR/DVD/Blu-ray Disc/
Satellite receiver/
Cable box

Home Theater System

DVD

Blu-ray Disc

Cable box

VCR

Connecting to the AC power outlet

When you finish connecting the equipment to the transmitter unit, connect the AC power adapter to the wall outlet.

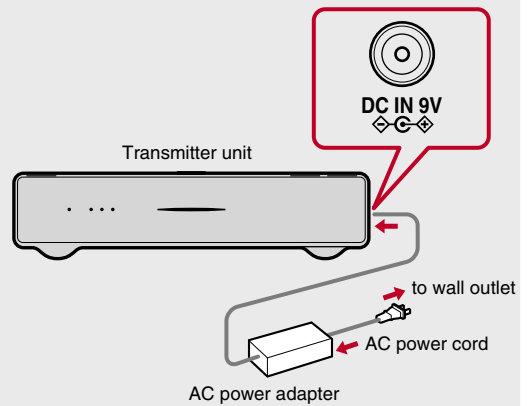

- Set the output resolution of the equipment to 480i, 480p, 720p or 1080i. If you currently use equipment connected directly to your TV with 1080p resolution, make sure to change the equipment's resolution to 1080i or less before connecting it to the transmitter unit. You should connect the equipment directly to the TV to change the resolution.

4 Turning the TV and the Transmitter unit on

- 1 Turn the power of the TV on. Set **Control for HDMI** in the **Settings** menu of the TV **On**. Then select the HDMI input that the receiver unit is connected to.

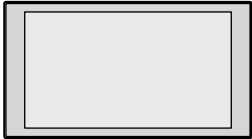

TV



- If POWER LED of the receiver unit does not light up, confirm **Control for HDMI** setting of the TV is **On**.
- The power of the receiver unit turns on or off in conjunction with TV, if **Control for HDMI** setting of the TV is **On** and the unit is connected to the TV by HDMI cable.
- When **Control for HDMI** is enabled on your TV, the power of the receiver unit will follow the power state of the TV. When the TV is turned on or off, the receiver unit will also turn on or off. To manually control the power of the receiver unit using the receiver's **POWER** button, you must turn off the TV's **Control for HDMI**.
- If **Control for HDMI** of the TV is **Off**, you must turn the power of the receiver unit on or off by pressing the **POWER** button on the unit.
- The supplied remote control cannot be used to turn on or off the receiver unit separately from the TV.

- 2 Confirm the POWER LED automatically lights up in green on the receiver unit.

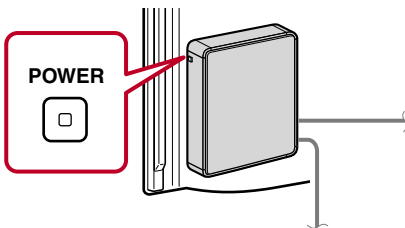

- 3 Press **POWER** on the transmitter unit.

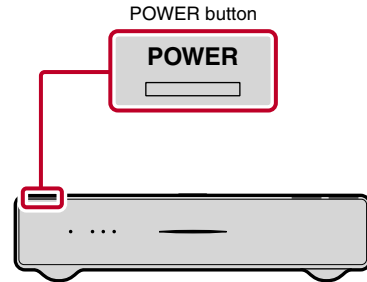

When the power of the transmitter unit is turned on, the POWER LED will light up in green, along with the white lamp on the front.

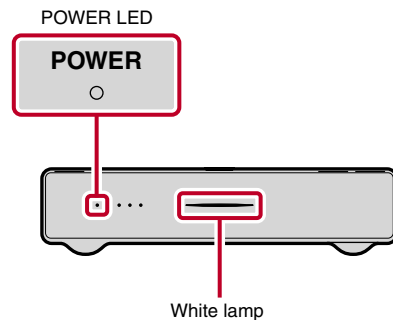

- 4** Verify the Wireless LINK LEVEL.
The LINK LEVEL LEDs located on the front of the transmitter unit allows you to verify the Wireless LINK LEVEL between the transmitter and the receiver units.

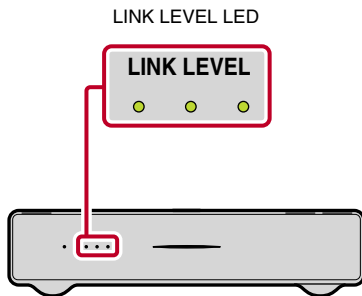

When the units are establishing a link, the LINK LEVEL LED blinks.

After the wireless connection is established, the LED stops blinking.

To ensure good picture quality, make sure that all three LEDs light up in green, indicating a good link.

Recommended placement of the receiver and transmitter units is within 65 feet (20 m) of each other. If you experience problems with the LINK LEVEL, removing obstructions from the path between the units may improve the LINK LEVEL.

If the Wireless LINK LEVEL is less than three or the picture is noisy or the sound quality is diminished, press **CONNECT** to switch to another wireless channel.

If you experience problems finding a suitable LINK LEVEL, see the Troubleshooting section in the Reference Guide for more information.

Optimal environment for placement of the units

Follow the suggestions below to create an optimal environment for your Wireless Link. Proper placement of the receiver and transmitter units will ensure a strong Wireless LINK LEVEL for superior performance.

- Use one system per room, placing the transmitter and receiver units for each system in the same room.
- If you use a 5 GHz WLAN or cordless phone, place those in a different room.
- Do not place either unit on a metallic rack.
- Place the transmitter unit as high up as possible.
- Maximum operating distance is approximately 65 feet (20 m), depending on the environment.
- Be sure to keep at least 1 foot (30 cm) minimum distance between the transmitter and receiver units.

5 Running Initial Setup

Initial Setup instructions will appear on the screen when the receiver and transmitter units are turned on for the first time.

- 1 Press **INPUT SELECT** on the transmitter unit to highlight your language choice. Then, press **CONNECT** on the transmitter unit to continue the setup.

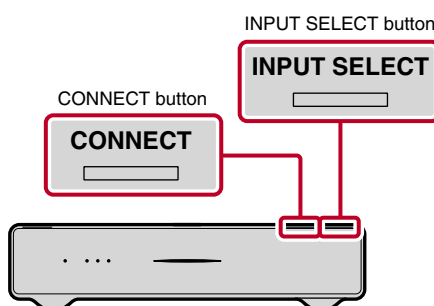
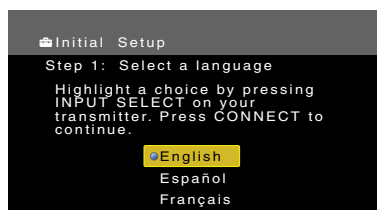

- The supplied remote control cannot be used at this stage.

- 2 Insert batteries into the remote control.

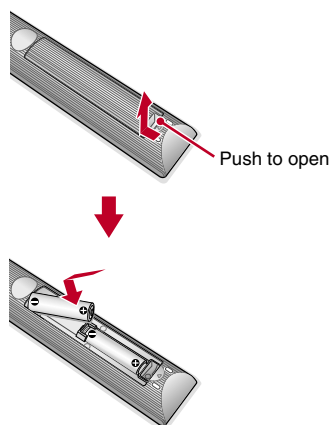

- 3** On your remote control, press and hold the **IN 1** button. While holding **IN 1**, press the **RETURN** button. Hold both for at least 2 seconds.

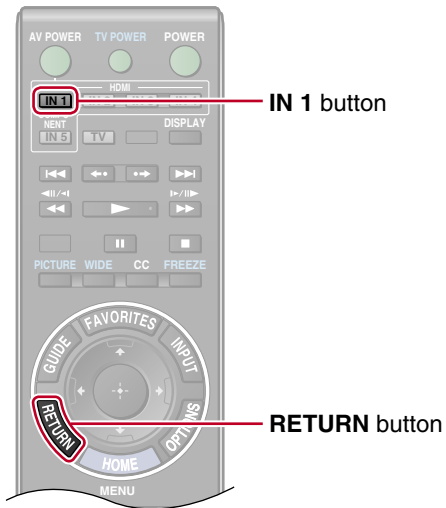
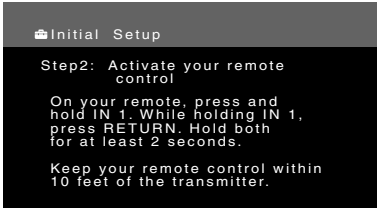

- 4** Initial Setup is complete.

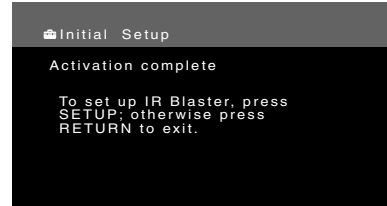

To use the supplied remote control to operate equipment connected to the transmitter unit, proceed to the next page.



- To display **Initial Setup** again, press **CONNECT** and **INPUT SELECT** on the transmitter unit simultaneously.

6 Configuring the remote control

Configure the **IR Blaster** to control your connected equipment using the supplied remote control.

You can control connected equipment with your remote by using the IR Blaster (supplied).

If you chose setup type C, you cannot use the IR Blaster to control connected equipment. Exit the **Setup** menu by pressing **SETUP** on the remote control to skip these steps.

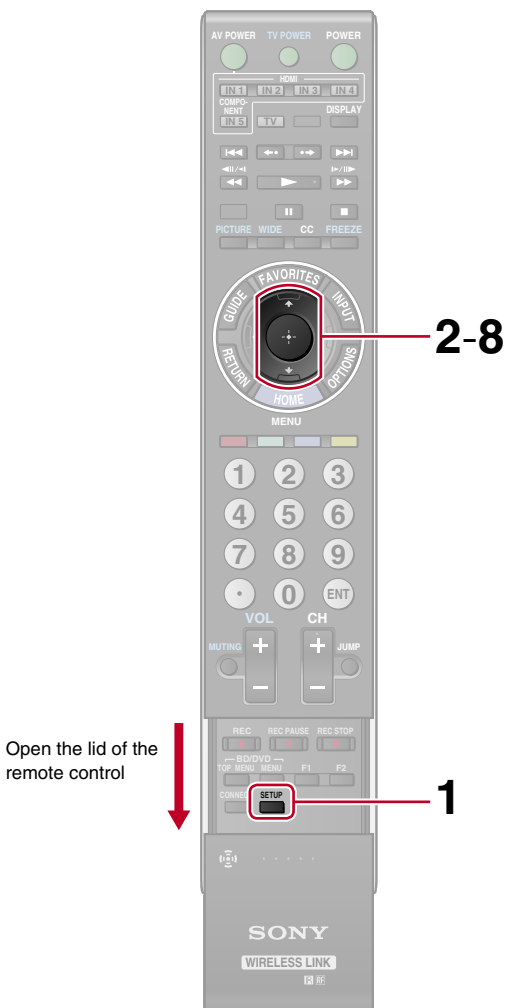

- 1 Press **SETUP** on the remote control to display the **Setup** menu.

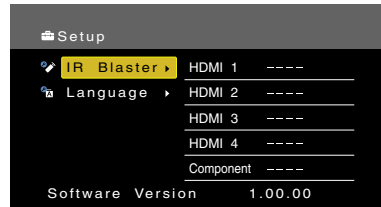

- 2 Press \uparrow/\downarrow to highlight **IR Blaster**, and press \odot . The following screen appears.

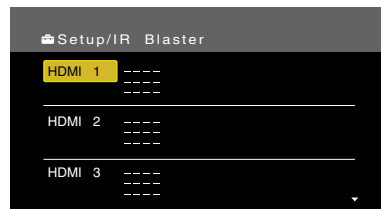

- 3 Press \uparrow/\downarrow to highlight an input to configure, and press \odot .

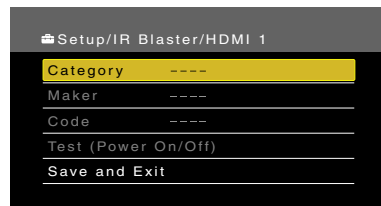

- 4 Press $\uparrow\downarrow$ to highlight **Category** (equipment type), and press \oplus .
Select an equipment type from the list, and press \oplus .

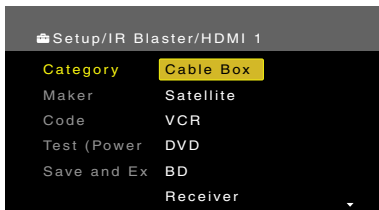

- 5 Press $\uparrow\downarrow$ to highlight **Maker**, and press \oplus .
Select a manufacturer from the list, and press \oplus .

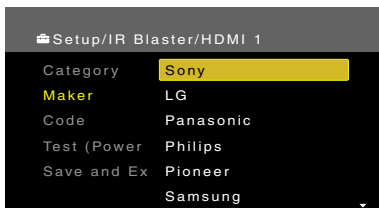

- 6 Press $\uparrow\downarrow$ to highlight **Code**, and press \oplus .
Select a code from the list, and press \oplus .

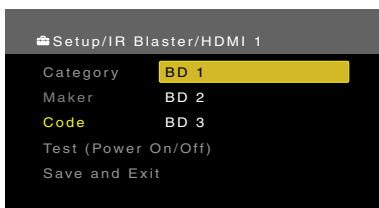

See page 15 on Reference Guide if your code is not on the list.



- When more than one code is available for your manufacturer, start checking from the top of the list for the code that operates your equipment.

- 7 Press $\uparrow\downarrow$ to highlight **Test (Power On/Off)** and press \oplus .
Test to see if the selected equipment power turns on and off.
You may need to test more than one code to find the right code for your equipment.



- If the equipment's supplied remote control has both POWER ON and POWER OFF buttons, using **Test (Power On/Off)** might not work to test the IR code. Select **Save and Exit** then check if any other remote buttons will operate your equipment.

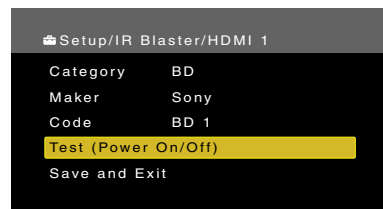

- 8 When you have found the right code, press $\uparrow\downarrow$ to highlight **Save and Exit**, and press \oplus .
Save the setting and exit from the **Setup** menu.

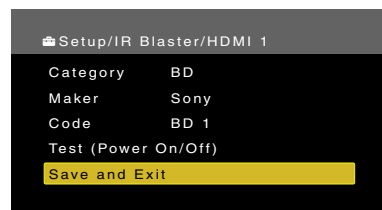

- Do not connect two of the same equipment from the same manufacturer (Eg. two Sony Blu-ray disc players), you will not be able to control each equipment individually.
- To erase the code, select **Category**, then press $\uparrow\downarrow$ to highlight "----" and press \oplus in step 4.

7 Using the supplied remote control

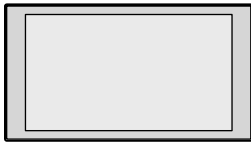

Operating your TV



The following buttons are for operating your TV. Press the **TV** button before using them.

Button	Description
TV POWER	Press to turn the TV on and off.
TV	You must first press the TV function button to operate the TV.
INPUT	Press to select the input of the TV.
PICTURE	Press to change the picture mode.
WIDE	Press to change the wide mode.
FREEZE	Press once to display a frozen image with the current program in a window. Press again to return to the current program.
0-9, ENT	Press 0-9 to select a channel; the channel changes after two seconds, press ENT to change channels immediately.
CH +/-	Press to scan through channels.
HOME/MENU	Press to display the TV Home menu.
VOL +/-	Press to adjust the volume.
MUTING	Press to mute the sound. Press again or press VOL+ to restore the sound.

Press the **SETUP** button to display the **Setup** menu if you need to change **Language** or **IR Blaster** settings.

If the **Wireless LINK LEVEL** is less than three or the picture is noisy, press **CONNECT** to switch to another wireless channel.



- You can use the **SETUP** or **CONNECT** buttons when any input is selected.

Operating equipment connected to the transmitter unit



- You must connect the IR Blaster and complete setup for all connected equipment before you can operate them.

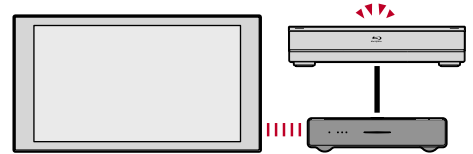

- Press **POWER** to turn the transmitter unit on.
- Press **IN 1-4 HDMI** or **IN 5 COMPONENT** to select the desired input source.
- Press **AV POWER** to turn on the equipment connected to the selected input source.

The connected equipment can be operated without aiming the remote control directly at the equipment.

Button	Description
⏮ / ⏭	Goes to the beginning of the previous/next title/chapter/scene/track.
⏪ / ⏩	Replays the scene/briefly fast forwards the scene.
⏮ / ⏭	Fast reverses/fast forwards the disc when pressed during playback.
▶	Plays a disc at normal speed.
⏸	Pauses the playback.
■	Stops the playback.
HOME/MENU	Displays menus of selected external equipment.
↑↓←→ ⊕	Moves the on-screen cursor of selected external equipment. Press ⊕ to select/confirm an item.





For Your Convenience

Please contact Sony Customer Support directly if you:

- Have questions on the use of your module after reading the Startup Guide or Reference Guide
- Experience difficulty operating your module

For United States

<http://www.sony.com/tvsupport>

or to speak with a support representative: 1-866-918-2485

For Canada

<http://www.sony.ca/support>

or to speak with a support representative: 1-877-899-SONY (7669)

Sony will work to resolve your questions more quickly than your retailer or place of purchase.

Please Do Not Return the Product to the Store

On-line Registration

United States

<http://productregistration.sony.com>

Canada

<http://www.SonyStyle.ca/registration>

Free Manuals Download Website

<http://myh66.com>

<http://usermanuals.us>

<http://www.somanuals.com>

<http://www.4manuals.cc>

<http://www.manual-lib.com>

<http://www.404manual.com>

<http://www.luxmanual.com>

<http://aubethermostatmanual.com>

Golf course search by state

<http://golfingnear.com>

Email search by domain

<http://emailbydomain.com>

Auto manuals search

<http://auto.somanuals.com>

TV manuals search

<http://tv.somanuals.com>