

Sound-Sensor Nursery Monitor

Operating Instructions

NTM-910DUAL

© 2007 Sony Corporation Printed in China

http://www.sony.net/

For customers who purchased this product in the USA

Please register this product on line at <http://www.sony.com/productregistration>. Proper registration will enable us to send you periodic mailings about new products, services, and other important announcements. Registering your product will also allow us to contact you in the unlikely event that the product needs adjustment or modification. Thank you.

SONY

Portable Audio

LIMITED WARRANTY (U.S. Only)

Sony Electronics Inc. ("Sony") warrants this product against defects in material or workmanship for the time periods and as set forth below. Pursuant to this Limited Warranty, Sony will, at its option, (i) repair the product using new or refurbished parts or (ii) replace the product with a new or refurbished product. For purposes of this Limited Warranty, "refurbished" means a product or part that has been returned to its original specifications. **In the event of a defect, these are your exclusive remedies.**

Term: For a period of one (1) year from the original date of purchase of the product, Sony will, at its option, repair or replace with new or refurbished product or parts, any product or parts determined to be defective.

This Limited Warranty covers only the hardware components packaged with the Product. It does not cover technical assistance for hardware or software usage and it does not cover any software products whether or not contained in the Product; any such software is provided "AS IS" unless expressly provided for in any enclosed software Limited Warranty. Please refer to the End User License Agreements included with the Product for your rights and obligations with respect to the software.

Instructions: To obtain warranty service, you must deliver the product, freight prepaid, in either its original packaging or packaging affording an equal degree of protection to the Sony authorized service facility specified. **It is your responsibility to backup any data, software or other materials you may have stored or preserved on your unit. It is likely that such data, software, or other materials will be lost or reformatted during service and Sony will not be responsible for any such damage or loss.** A dated purchase receipt is required. For specific instructions on how to obtain warranty service for your product,

The Address of the Laredo Fulfillment Center is:

Laredo Fulfillment Center
10227 Crossroads Loop, Suite B
Laredo, TX 78045

Visit Sony's Web Site:
www.sony.com/service

Or call the Sony Customer Information Service Center
1-800-222-SONY (7669)

For an accessory or part not available from your authorized dealer, call:

1-800-488-SONY (7669)

Repair / Replacement Warranty: This Limited Warranty shall apply to any repair, replacement part or replacement product for the remainder of the original Limited Warranty period or for ninety (90) days, whichever is longer. Any parts or product replaced under this Limited Warranty will become the property of Sony.

This Limited Warranty only covers product issues caused by defects in material or workmanship during ordinary consumer use; it does not cover product issues caused by any other reason, including but not limited to product issues due to commercial use, acts of God, misuse, limitations of technology, or modification of or to any part of the Sony product. This Limited Warranty does not cover Sony products sold AS IS or WITH ALL FAULTS or consumables (such as fuses or batteries). This Limited Warranty is invalid if the factory-applied serial number has been altered or removed from the product. This Limited Warranty is valid only in the United States.

LIMITATION ON DAMAGES: SONY SHALL NOT BE LIABLE FOR ANY INCIDENTAL OR CONSEQUENTIAL DAMAGES FOR BREACH OF ANY EXPRESS OR IMPLIED WARRANTY ON THIS PRODUCT.

DURATION OF IMPLIED WARRANTIES: EXCEPT TO THE EXTENT PROHIBITED BY APPLICABLE LAW, ANY IMPLIED WARRANTY OF MERCHANTABILITY OR FITNESS FOR A PARTICULAR PURPOSE ON THIS PRODUCT IS LIMITED IN DURATION TO THE DURATION OF THIS WARRANTY.

Some states do not allow the exclusion or limitation of incidental or consequential damages, or allow limitations on how long an implied warranty lasts, so the above limitations or exclusions may not apply to you. This Limited Warranty gives you specific legal rights and you may have other rights which vary from state to state.

WARNING

To reduce the risk of fire or electric shock, do not expose this apparatus to rain or moisture.

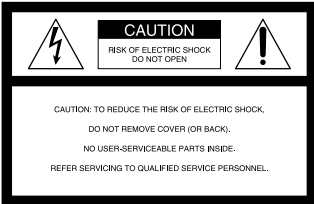

This symbol is intended to alert the user to the presence of uninsulated "dangerous voltage" within the product's enclosure that may be of sufficient magnitude to constitute a risk of electric shock to persons.



This symbol is intended to alert the user to the presence of important operating and maintenance (servicing) instructions in the literature accompanying the appliance.

* The graphical symbols are on the AC power adaptor enclosure on the transmitter.

You are cautioned that any changes or modifications not expressly approved in this manual could void your authority to operate this equipment.

INFORMATION

This equipment has been tested and found to comply with the limits for a Class B digital device, pursuant to Part 15 of the FCC Rules. These limits are designed to provide reasonable protection against harmful interference in a residential installation. This equipment generates, uses and can radiate radio frequency energy and, if not installed and used in accordance with the instructions, may cause harmful interference to radio communications. However, there is no guarantee that interference will not occur in a particular installation. If this equipment does cause harmful interference to radio or television reception, which can be determined by turning the equipment off and on, the user is encouraged to try to correct the interference by one or more of the following measures:

- Reorient or relocate the receiving antenna.
- Increase the separation between the equipment and receiver.
- Connect the equipment into an outlet on a circuit different from that to which the receiver is connected.
- Consult the dealer or an experienced radio/TV technician for help.

If you have any questions about this product, you may call:
Sony Customer Information Services Center 1-800-222-7669 or <http://www.sony.com/>

Declaration of Conformity
Trade Name: SONY
Model: NTM-910 (Receiver unit)
Responsible Party: Sony Electronics Inc.
Address: 16530 Via Esprillo, San Diego, CA 92127 USA
Telephone Number: 858-942-2230

This device complies with Part 15 of the FCC Rules. Operation is subject to the following two conditions: (1) This device may not cause harmful interference, and (2) this device must accept any interference received, including interference that may cause undesired operation.

RECYCLING NICKEL METAL HYDRIDE BATTERIES

Nickel Metal Hydride batteries are recyclable. You can help preserve our environment by returning your used rechargeable batteries to the collection and recycling location nearest you.

For more information regarding recycling of rechargeable batteries, call toll free 1-800-822-8837, or visit <http://www.rbc.org/>

Caution: Do not handle damaged or leaking Nickel Metal Hydride batteries.



Features

- Up to 27 channels for maximized reception.
- Voice Activation eliminates most background noise for a more peaceful sleep.
- 5 indicators for monitoring sound levels.
- RANGE ALM., POWER/BATT and CHARGE indicators allow you to know the operating condition of the receiver.
- Water-resistance allows operating the receiver in slight moisture areas such as kitchen or bathroom.
- Operating on rechargeable battery pack.

Precautions

Safety Precautions

- Operate the transmitter only on 120 V AC, 60 Hz; and the receiver on 9 V DC. To operate the receiver on house current, use only the supplied AC power adaptor; do not use any other type. For battery operation, use one rechargeable battery pack BP-TR10.
- Should any solid object or liquid fall into the unit, disconnect the AC power adaptor and remove the battery, and have the unit checked by a qualified personnel before operating it any further.
- If you are not going to use the system for a long time:
 - Disconnect both transmitter and receiver from the wall outlet by pulling out the plugs of both AC power cord and AC power adaptor respectively.
 - Remove the battery out of the receiver to avoid damage from battery leakage.

If you have any questions or problems concerning your system, please consult your nearest Sony dealer.

Precautions on Usage

This product cannot replace responsible adult supervision of a child. It is designed to assist adults in child supervision. Do not use it for medical monitoring of a sick baby or child.

- The transmitter detects normal sound levels within a range of 2 to 3 meters (6 to 10 feet) from a child. If the child moves outside of this range, it may not be able to detect sounds from him or her.
- It is essential that you check the operating range and condition of the Sound-Sensor Nursery Monitor on initial installation, and on a regular basis after that.
- Stay close to the receiver in order to hear normal sounds from it. Check the volume regularly to ensure that it is set high enough. Recharge the rechargeable battery pack in the receiver or operate it on house current as soon as the **POWER/BATT** indicator starts flashing and the receiver sounds a beep.
- Be sure to place the transmitter out of the child's reach. Do not place the transmitter inside a crib or playpen.
- The receiver can be affected by other devices in or near your home that may interfere with the signals sent by the transmitter. Such interference can be caused by TV sets, cordless phones, vacuum cleaners, car ignitions, and other electrical devices. You should test the receiver when you expect such devices to be in operation while you are using the Sound-Sensor Nursery Monitor.
- The signal from the transmitter can be received by another receiver, as it uses a public air wave.

Cautions on Water-resistance (for the receiver only)

- This unit is designed so that it can be used with slight exposure to water, rain, snow and other forms of moisture, but there are several points on which caution should be observed.
- Do not allow it to come into contact with large amounts of water.
 - Do not immerse it in water.
 - If water should get on it or if it should fall into water, take it out immediately and wipe it off with a dry cloth. To prevent the battery from corroding, wipe out the interior of the battery compartment as follows:
 - Open or close the battery compartment with dry hands in a place without exposure to any water.
 - Wipe off the battery and the inside of the battery compartment. Give special attention to the contacts so that no water remains on them.

Troubleshooting

Should any problem persist after you have made the following checks, consult your nearest Sony dealer.

No sound (even with both units turned on)

- AC power cord or AC power adaptor is disconnected from the wall outlet.
- Battery is used up.
- Receiver is too far from the transmitter.
- **CH** selectors of both transmitter and receiver are not on the same settings.

Too much noise

- Weak battery.
- Receiver is too far from the transmitter.
- Interference from another electrical appliance. Turn off the appliance, or move it further from the receiver.

Weak reception

- Receiver is too far from the transmitter.

MONITOR indicator is not lit.

- Weak battery.
- Receiver is too far from the transmitter.

Buzzing, interference

- Another transmitter interfering. Set the **CH** selectors of both the transmitter and receiver to another setting.

Shrill noise

- Receiver is too close to the transmitter.
- Volume is too high.

Alarm continues to sound although the distance between the transmitter and the receiver becomes within operating range.

- Transmitter is not set to **ON**.
- **CH** selectors of both the transmitter and receiver are not on the same settings.

Specifications

Frequency range: 902.200 - 904.900 MHz

Number of channels: 27 channels

Modulation system: FM

Transmitter

Circuitry: Crystal-controlled PLL circuit

Power requirement: 120 V AC, 60 Hz

Power consumption: 2 W

Dimensions:

101.8 × 99.5 × 63 mm (w/h/d) (4¹/₈ × 4 × 2¹/₂ inches) not incl. projecting parts and antenna

101.8 × 140.5 × 63 mm (w/h/d) (4¹/₈ × 5⁵/₈ × 2¹/₂ inches) incl. projecting parts and antenna

Mass: Approx. 229.5 g (8.1 oz)

Receiver

Circuitry: Single superheterodyne

Power requirement:

AC power adaptor (DC IN 9 V jack):

120 V AC, 60 Hz

2.4 V DC, Rechargeable battery pack

BP-TR10

Audio power output:

80 mW (using the supplied AC power adaptor)

28 mW (using 2.4 V DC)

Speaker: 57 mm dia., 8 Ω

Dimensions:

94 × 109 × 59 mm (w/h/d) (3³/₄ × 4³/₈ × 2³/₈ inches) not incl. projecting parts and antenna

94 × 157 × 59 mm (w/h/d) (3³/₄ × 6¹/₄ × 2³/₈ inches) incl. projecting parts and antenna

Mass:

Approx. 184.3 g (6.5 oz)

Approx. 228.8 g (8.1 oz) incl. a rechargeable battery pack

Supplied accessories:

AC power adaptor (2)

Rechargeable battery pack BP-TR10 (2)

Design and specifications are subject to change without notice.

IMPORTANT SAFEGUARDS

For your protection, please read these safety instructions completely before operating the appliance, and keep this manual for future reference. Carefully observe all warnings, precautions and instructions on the appliance and in the operating instructions, and adhere to them.

INSTALLATION

Water and Moisture

Do not use powerline operated appliances near water - for example, near a bathtub, washbowl, kitchen sink, or laundry tub, in a wet basement, or near a swimming pool, etc.

Heat

Do not place the appliance near or over a radiator or heat register, or where it is exposed to direct sunlight.

Ventilation

The slots and openings in the cabinet are provided for necessary ventilation. To ensure reliable operation of the appliance, and to protect it from overheating, these slots and openings must never be blocked or covered.

-Never cover the slots and openings with a cloth or other materials.

-Never block the slots and openings by placing the appliance on a bed, sofa, rug or other similar surface.

-Never place the appliance in a confined space, such as a bookcase, or built-in cabinet, unless proper ventilation is provided.

Accessories

Do not place the appliance on an unstable cart, stand, tripod, bracket, or table. The appliance may fall, causing serious injury to a child or an adult, and serious damage to the appliance. Use only a cart, stand, tripod, bracket, or table recommended by Sony.

-An appliance and cart combination should be moved with care. Quick stops, excessive force, and uneven surfaces may cause the appliance and cart combination to overturn.

Wall or Ceiling Mounting

If your appliance can be mounted to a wall or ceiling, mount it only as recommended by Sony.

USE

Power Source

This appliance should be operated only from the type of power source indicated on the marking label. If you are not sure of the type of electrical power supplied to your home, consult your dealer or local power company. For those appliances designed to operate from battery power, or other sources, refer to the operating instructions.

Grounding or Polarization

This appliance is equipped with a polarized AC power cord plug (a plug having one blade wider than the other), or with a three-wire grounding type plug (a plug having a third pin for grounding). Follow the instructions below:

-For the appliance with a polarized AC power cord plug:

This plug will fit into the power outlet only one way. This is a safety feature. If you are unable to insert the plug fully into the outlet, try reversing the plug. If the plug should still fail to fit, contact your electrician to have a suitable outlet installed. Do not defeat the safety purpose of the polarized plug by forcing it in.

-For the appliance with a three-wire grounding type AC plug:

This plug will only fit into a grounding-type power outlet. This is a safety feature. If you are unable to insert the plug into the outlet, contact your electrician to have a suitable outlet installed. Do not defeat the safety purpose of the grounding plug.

Overloading

Do not overload wall outlets, extension cords or convenience receptacles beyond their capacity, since this can result in fire or electric shock.

When not in use

Unplug the power cord of the appliance from the outlet when left unused for a long period of time.

To disconnect the cord, pull it out by grasping the plug. Never pull the plug out by the cord.

Power-Cord Protection

Route the power cord so that it is not likely to be walked on or pinched by items placed upon or against them, paying particular attention to the plugs, receptacles, and the point where the cord exits from the appliance.

Lightning

For added protection for this appliance during a lightning storm, or when it is left unattended and unused for long periods of time, unplug it from the wall outlet and disconnect the antenna or cable system. This will prevent damage to the appliance due to lightning and powerline surges.

Object and Liquid Entry

Never push objects of any kind into the appliance through openings as they may touch dangerous voltage points or short out parts that could result in a fire or electric shock. Never spill liquid of any kind on the appliance.

Cleaning

Unplug the appliance from the wall outlet before cleaning or polishing it. Do not use liquid cleaners or aerosol cleaners. Use a cloth lightly dampened with water for cleaning the exterior of the appliance. Clean the appliance only as recommended by Sony.

Attachments

Do not use attachments not recommended by Sony, as they may cause hazards.

ANTENNAS

Outdoor Antenna Grounding

If an outdoor antenna or cable system is installed, follow the precautions below.

An outdoor antenna system should not be located in the vicinity of overhead power lines or other electric light or power circuits, or where it can come in contact with such power lines or circuits. **WHEN INSTALLING AN OUTDOOR ANTENNA SYSTEM, EXTREME CARE SHOULD BE TAKEN TO KEEP FROM CONTACTING SUCH POWER LINES OR CIRCUITS AS CONTACT WITH THEM IS ALMOST INVARIABLY FATAL.**

Be sure the antenna system is grounded so as to provide some protection against voltage surges and built-up static charges. Section 810 of the National Electrical Code provides information with respect to proper grounding of the mast and supporting structure, grounding of the lead-in wire to an antenna discharge unit, size of grounding conductors, location of antenna-discharge unit, connection to grounding electrodes, and requirements for the grounding electrode.

Antenna Grounding According to the National Electrical Code

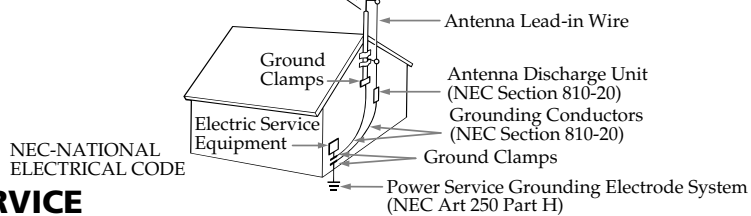

SERVICE

Damage Requiring Service

Unplug the appliance from the wall outlet and refer servicing to qualified service personnel under the following conditions:

- When the power cord or plug is damaged or frayed.
- If liquid has been spilled or objects have fallen into the appliance.
- If the appliance has been exposed to rain or water.
- The appliance does not appear to operate normally or exhibits a marked change in performance.
- This indicates a need for service.
- If the appliance does not operate normally when following the operating instructions, adjust only those controls that are specified in the operating instructions. Improper adjustment of other controls may result in damage and will often require extensive work by a qualified technician to restore the appliance to normal operation.
- If the appliance has been subject to excessive shock by being dropped, or the cabinet has been damaged.

Servicing

Do not attempt to service the appliance yourself as opening or removing covers may expose you to dangerous voltage or other hazards. Refer all servicing to qualified service personnel.

Replacement parts

When replacement parts are required, be sure the service technician has used replacement parts specified by Sony that have the same characteristics as the original parts.

Unauthorized substitutions may result in fire, electric shock, or other hazards.

Safety Check

Upon completion of any service or repairs to the appliance, ask the service technician to perform routine safety checks (as specified by Sony) to determine that the appliance is in safe operating condition.

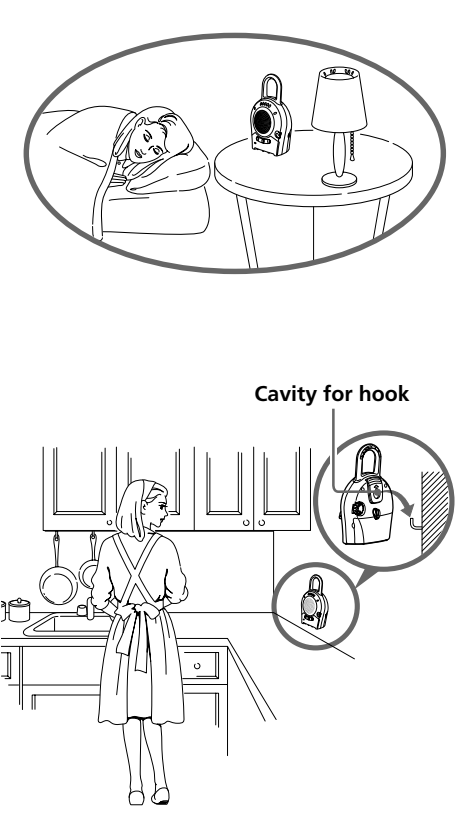
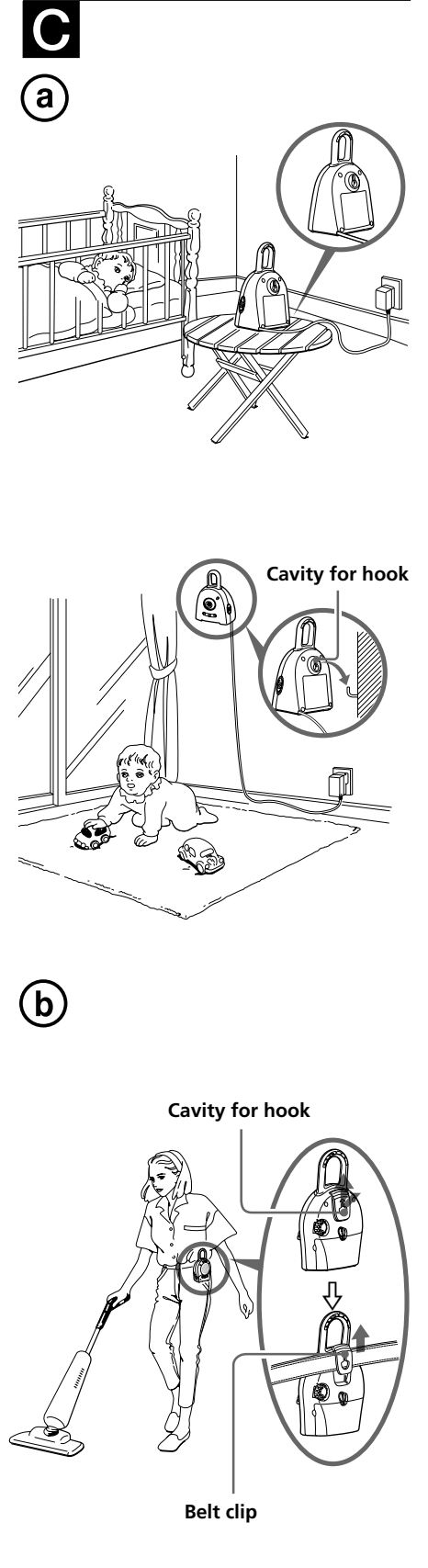
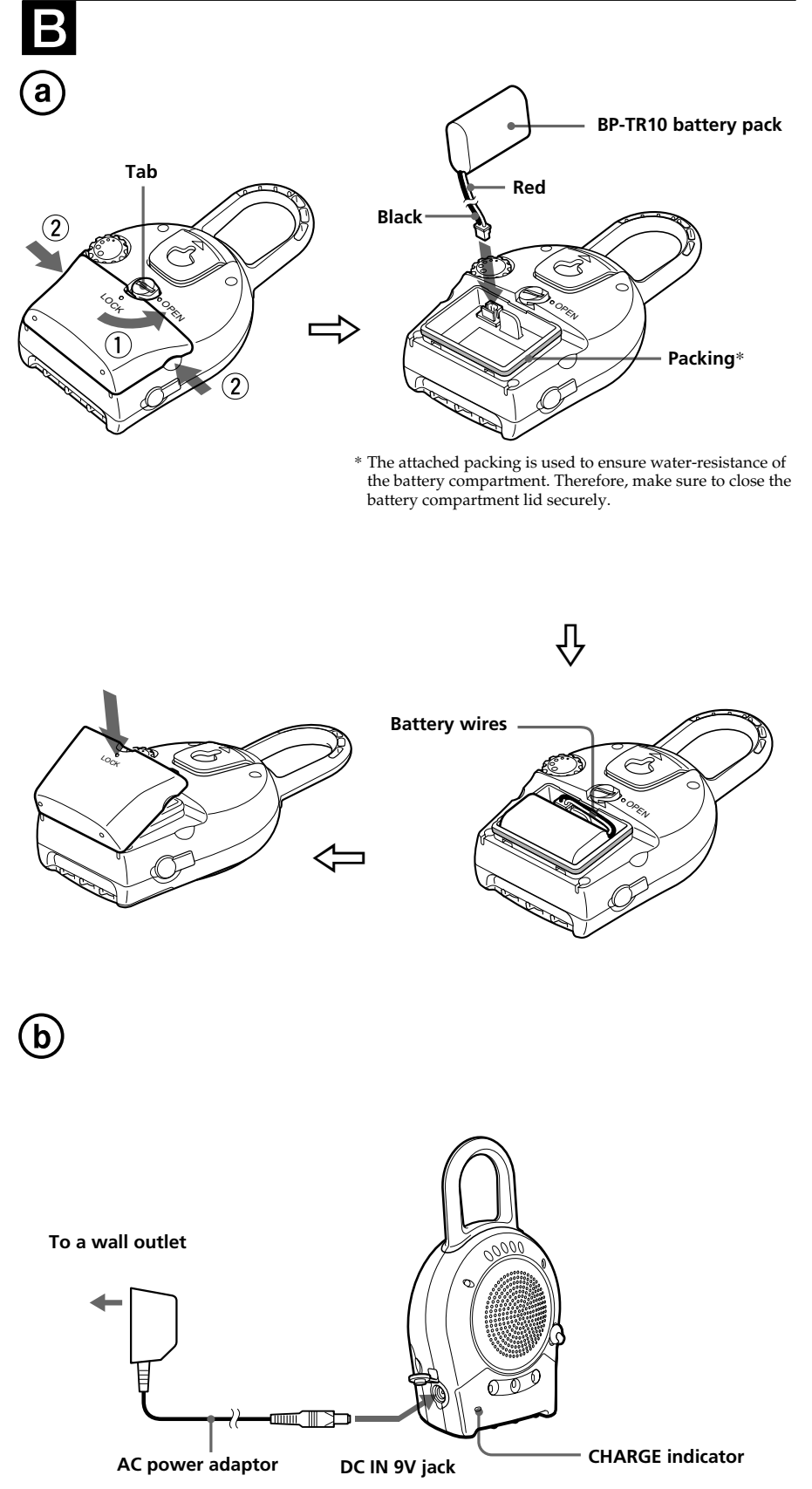
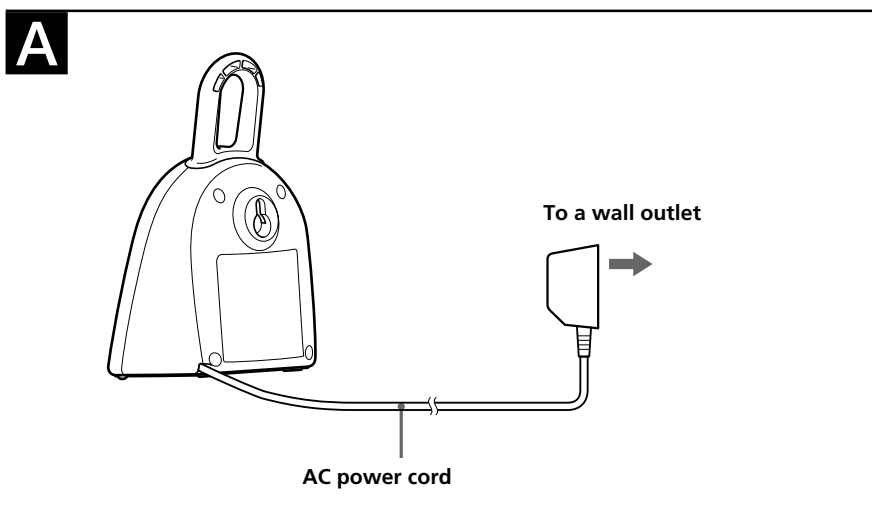
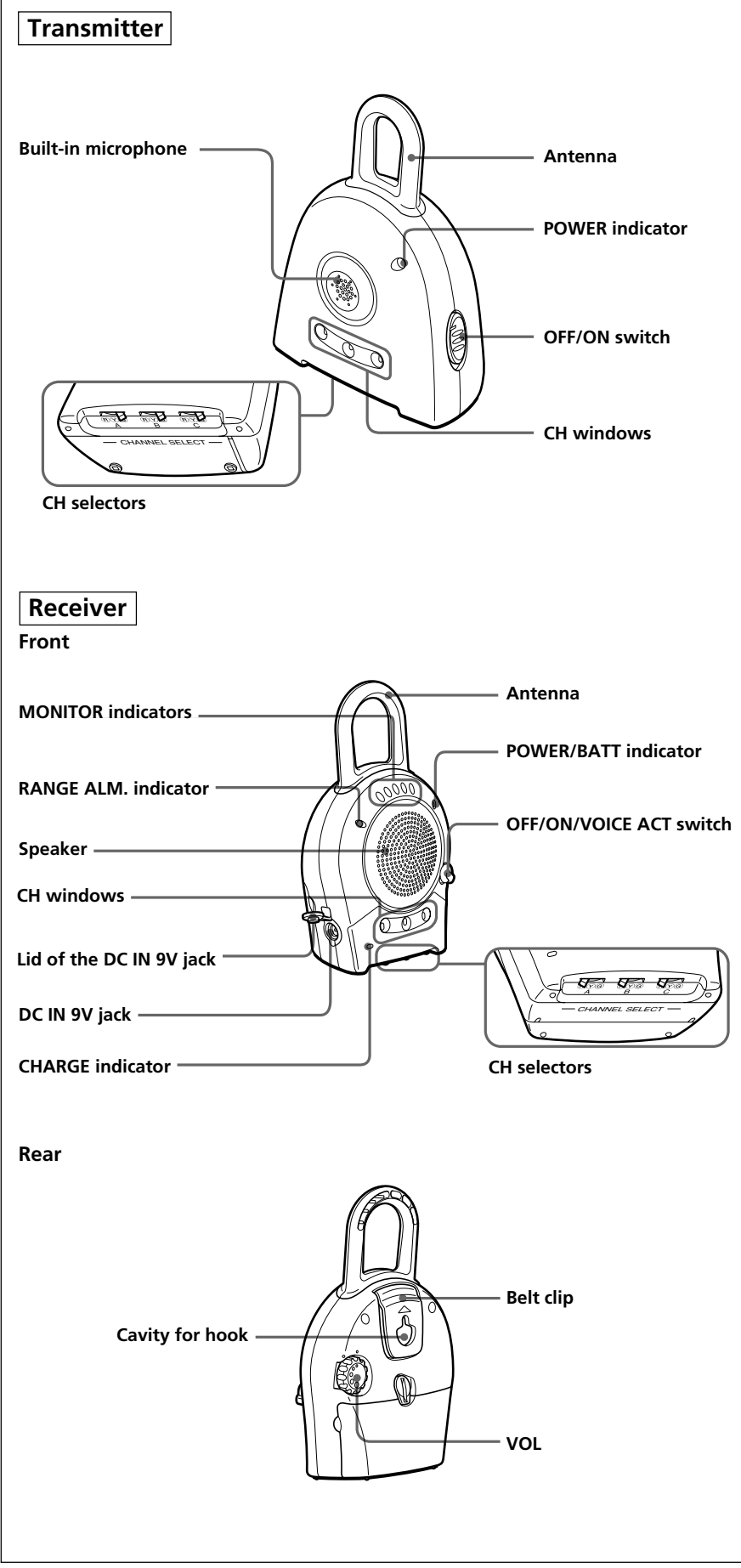

Power Sources

Transmitter (See Fig. A)
Connect the AC power cord to a wall outlet.

Receiver
To operate on battery (See Fig. B-a)

- Turn the tab of the battery compartment lid at the rear of the receiver to the **OPEN** position with a coin. Pull the depressions on both sides to open the lid.
- Connect the battery connector to the battery terminal with correct polarity. Black wire goes on the left side and red wire goes on the right side.
- Insert one rechargeable battery pack BP-TR10 (supplied) into the battery compartment. Make sure the battery wires are positioned properly so that the wires are not pushed out of the compartment when closing the lid.
- Close the lid, then turn the tab to the **LOCK** position with a coin.

Note
When operating the receiver on a rechargeable battery pack, make sure that the lid of the DC IN 9V jack of the receiver is closed securely to ensure water-resistance of the receiver.

Battery life (approx. hours for continuous standby) (JEITA*)
Sony rechargeable battery pack BP-TR10 22

* Measured by JEITA (Japan Electronics and Information Technology Industries Association) standards. The actual battery life may vary depending on the circumstance of the unit.

When to recharge the rechargeable battery pack
If the sound becomes distorted or interrupted, we recommend that you recharge the battery pack. When the battery pack is used up, the **POWER/BATT** indicator starts flashing and the receiver sounds a beep. If the battery pack is extremely used up, the beep may be interrupted or the **POWER/BATT** indicator may flash when you turn on the power. Recharge the battery pack as soon as possible in either case. Recharge the battery pack for more than 22 hours so that the battery pack is fully charged. Turn off the receiver before charging the battery pack. The **CHARGE** indicator remains lit even after charging has been completed.

Charging duration
Approximately 22 hours are required to charge the battery pack to its full capacity.

Notes on the rechargeable battery pack

- The battery pack will gradually discharge over a long period of time, even if not in use.
- If you leave the weak battery pack inside the receiver without charging it, the battery pack will be completely discharged. It may require several times of charging to recover to its full capacity.

Notes on replacing the rechargeable battery pack

- If the battery pack lasts only a few minutes even after 22 hours of charging, the battery life has expired and needs replacement.
- Before replacing the battery pack, make sure that the receiver is turned off.
- Replace the battery pack with a new one. Contact your local Sony authorized dealer or service center, and ask for a Sony BP-TR10 rechargeable battery pack.
- Do not use any other rechargeable battery pack.

To operate on house current (See Fig. B-b)

Open the lid of the DC IN 9V jack of the receiver. Connect the supplied AC power adaptor to the DC IN 9V jack and plug it in to a wall outlet. The **CHARGE** indicator will light up whether or not the receiver is turned on.

Notes on AC power adaptor

- When the AC power adaptor is not used, be sure to turn off the receiver, and unplug it from the DC IN 9V jack and the wall outlet. Then close the lid of the DC IN 9V jack securely.
- Use only the supplied AC power adaptor. Do not use any other AC power adaptor.
- Replace the AC power adaptor with the same type as the one supplied if replacement is necessary.



Setting Up

Turning on the power
Set the **OFF/ON** switch of the transmitter and the **OFF/ON/VOICE ACT** switch of the receiver to **ON** to turn on the power. The **POWER** indicator of the transmitter and the **POWER/BATT** indicator of the receiver will light up. To turn off the power, set the **OFF/ON** switch of the transmitter and the **OFF/ON/VOICE ACT** switch of the receiver to **OFF**.

Setting the frequency channels
Up to 27 channels can be set through the **CH** selectors by changing the combination of three colors (red, yellow and green) on the **CH** windows. Set the **CH** selectors of both the transmitter and receiver so that the settings of color combinations shown in the **CH** windows are the same. Otherwise, the transmitter and receiver will not function. If the settings of the receiver and transmitter are not the same, the **RANGE ALM.** indicator starts flashing and the receiver sounds a beep.

If signal interference occurs
Set the **CH** selectors of both the transmitter and receiver to another setting. Make sure that both the settings shown in the **CH** windows are the same.

Setting up the transmitter (See Fig. C-a)

Place the transmitter within 2 to 3 meters (6 to 10 feet) from a crib or play area. If the child moves outside of this range, the transmitter may not be able to detect his/her sounds. The transmitter must be placed upright during operation.

Tips for better reception

- Place the transmitter at a location as high as practically possible such as on a table or on a wall.
- Make sure that the transmitter is not covered or obstructed for picking up sounds.
- Make sure that nothing touches the antenna during operation.

Notes

- Keep the transmitter out of the reach of the baby. Do not place the transmitter inside a crib or playpen.
- Position the transmitter with the front side where the built-in microphone is located facing the baby.
- Do not use the antenna as a carrying handle.
- Do not use the antenna to hang the transmitter on the wall. Be sure to use the cavity for hook.

Monitoring through the receiver (See Fig. C-b)

The longest distance you can place the receiver from the transmitter varies according to obstructions and other conditions. First, test the operating range with the assistance of another adult, or by placing a radio, etc., near the transmitter. If you move outside the effective operating range of the system, the **RANGE ALM.** indicator lights up and the buzzer sounds. In such a case, move closer toward the transmitter until the indicator and the buzzer turn off.

Tips for better reception

- Keep the receiver upright during operation.
- Make sure that nothing touches the antenna during operation.

The **VOICE ACT** function eliminates most background noise when the receiver does not detect any sound. Set the **OFF/ON/VOICE ACT** switch to **VOICE ACT** to turn on this function.

When the receiver receives sounds from the transmitter, the **MONITOR** indicators light up from left to right in five steps depending on the sound level. Only one indicator may light up if the sound from the transmitter is not loud, or all the indicators may light up if the sound is very loud. You can also hear sounds through the speaker.

To adjust the volume
The volume of the sounds you receive varies depending on the loudness of the baby's voice, distance between the transmitter and the baby, direction of the built-in microphone of the transmitter, obstructions, etc. Set the volume as required using **VOL**. If the volume level is set too high and is accompanied by a shrill noise, reduce the volume. The volume level can be adjusted between the smallest and biggest dots on the **VOL**.

Notes

- Avoid placing the units near heat sources or where they are subject to direct sunlight, excessive dust, moisture, or mechanical shock.
- Be careful not to drop the receiver in water, or drop any liquid over it.
- Do not use the antenna as a carrying handle.
- Do not use the antenna to hang the receiver on the wall. Be sure to use the cavity for hook.

Using Belt Clip (See Fig. C-b)

The receiver has a belt clip located on the rear. It is convenient when you move around, for example, when you clean up the room, etc. Insert your finger into the cavity for hook and slide upwards as illustrated, then hang the belt clip onto your belt. When fixing the receiver onto your belt, be sure to turn off the receiver, and disconnect the AC power adaptor from the DC IN 9V jack and the wall outlet. Then close the lid of the DC IN 9V jack securely.

Notes

- When using the belt clip, the receiver can be operated only on battery.
- When you are not using the belt clip, push it back to its original position.
- Make sure that you do not move outside the effective operating range of the system.

Free Manuals Download Website

<http://myh66.com>

<http://usermanuals.us>

<http://www.somanuals.com>

<http://www.4manuals.cc>

<http://www.manual-lib.com>

<http://www.404manual.com>

<http://www.luxmanual.com>

<http://aubethermostatmanual.com>

Golf course search by state

<http://golfingnear.com>

Email search by domain

<http://emailbydomain.com>

Auto manuals search

<http://auto.somanuals.com>

TV manuals search

<http://tv.somanuals.com>