

AIR HOGS®

TWIN FURY™

INSTRUCTIONS

8+

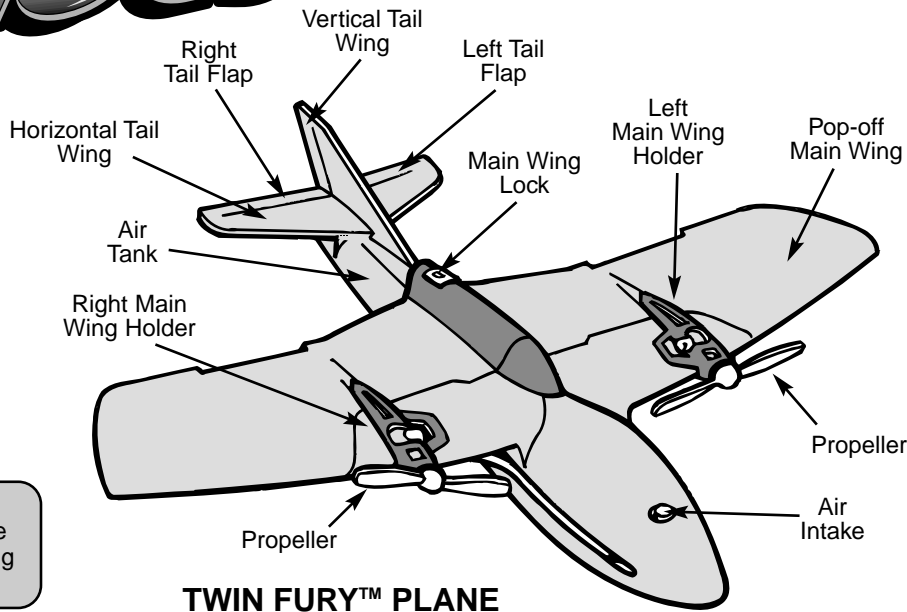

Contents:

- 1 Twin Fury™ Plane
- 1 Pop-off Main Wing
- 1 Air Pump

TWIN FURY™ PLANE

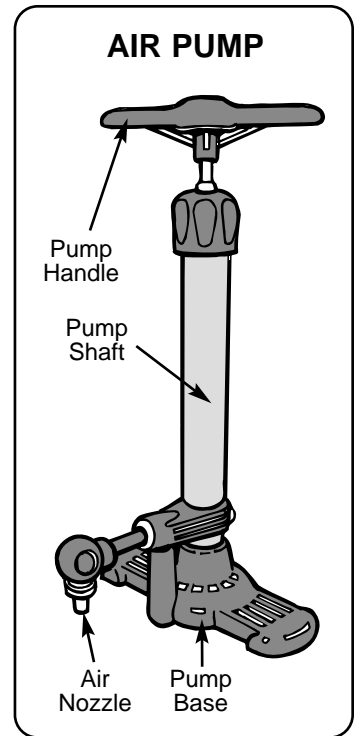

MAIN WING ASSEMBLY

To increase the durability of your Twin Fury™, it has been equipped with a POP-OFF MAIN WING. This pop-off feature will significantly help to avoid breakage on impact with harsh surfaces (i.e. ground, trees, etc).

IMPORTANT: While pop-off wings do help to protect against damage, they are not fool-proof. To help preserve the life of your Twin Fury™, always fly in a wide-open area with lots of grass.

STEP 1

Attach the MAIN WING by sliding it into the RIGHT and LEFT MAIN WING HOLDERS.

NOTE: Be sure that the MAIN WING is carefully placed between the UPPER and LOWER CLASPS of each MAIN WING HOLDER.

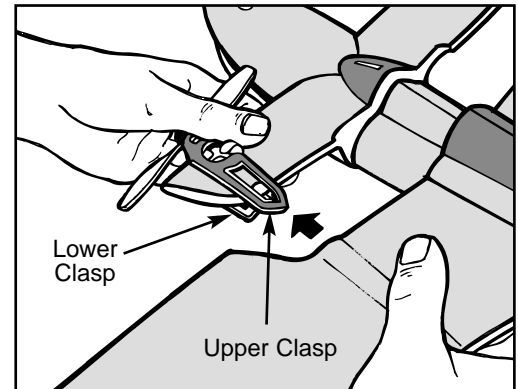
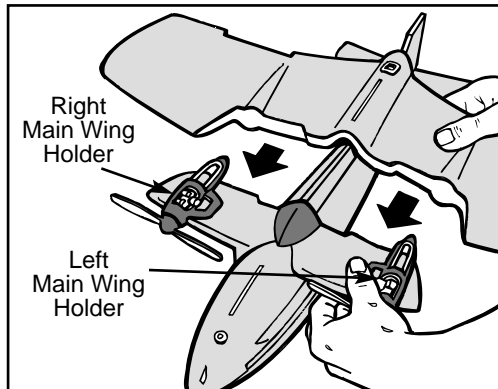

STEP 2

Push MAIN WING LOCK until you hear a "CLICK".

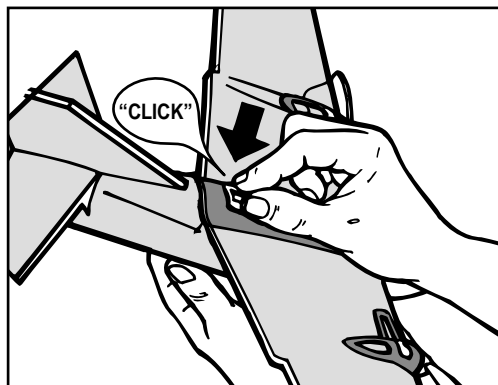

PUMP UP YOUR TWIN FURY™

STEP 1

Gently push the PUMP NOZZLE all the way into the AIR INTAKE on top of the plane.

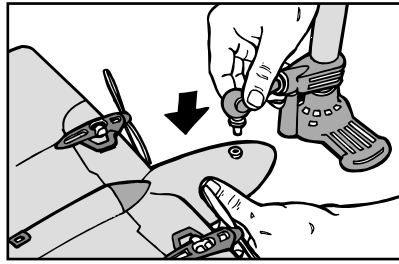

STEP 2

Pump 50 times. A built-in pressure relief valve will release air or whistle if the AIR TANK is full.

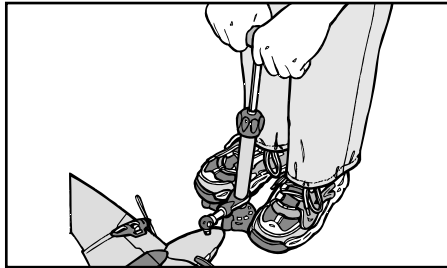

STEP 3

Carefully remove the plane from the PUMP NOZZLE.

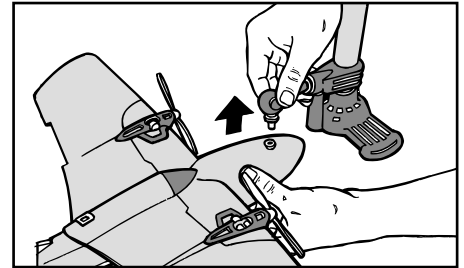

FLIGHT INSTRUCTIONS

STEP 1

Hold the plane in your launching hand and strike the PROPELLERS quickly, one after the other, with your other hand.

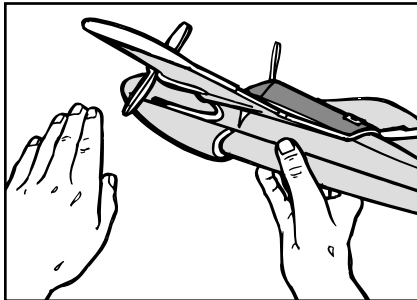

STEP 2

Immediately launch your Twin Fury™ at a 45° angle, against the wind for best take-offs and flight results.

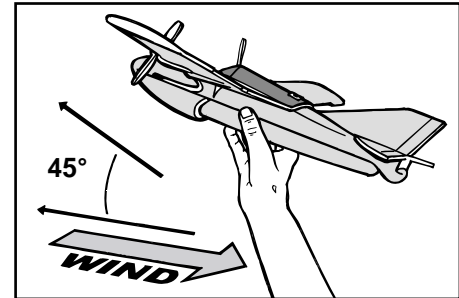

BASIC FLYING TIPS

TURN RIGHT

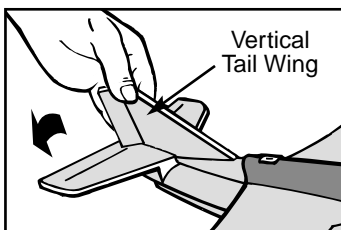
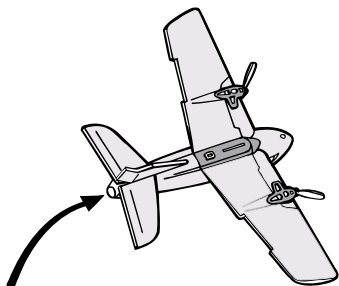

Bend the VERTICAL TAIL WING to the right to make the plane turn right.

TURN LEFT

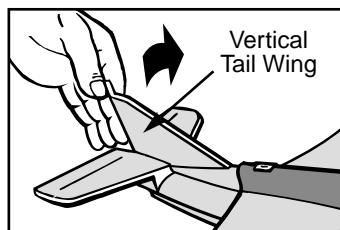
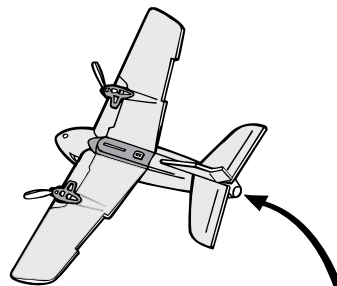

Bend the VERTICAL TAIL WING to the left to make the plane turn left.

CLIMB

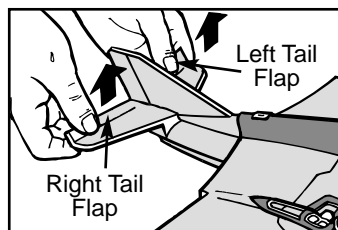
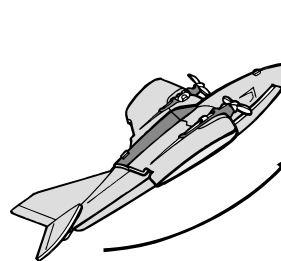

Bend both TAIL FLAPS up to make the plane climb higher.

DIVE

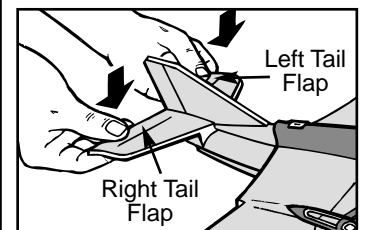
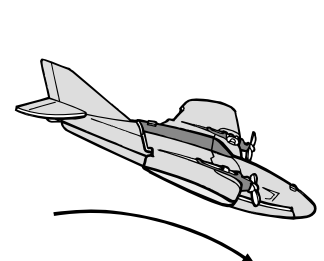

Bend both TAIL FLAPS down if the plane is climbing sharply, and then crashing.

IMPORTANT SAFETY INFORMATION

Keep propellers away from face, eyes, hair, and fingers. Do NOT launch at people or animals. Use caution; make sure people around you know you are playing with Air Hogs®. Point plane away from face when launching. Do NOT fly plane in temperatures below 45°F/7°C. In these low temperatures, the wings will become brittle and may break, and performance will decrease. Do NOT fly near overhead wires, trees, buildings, or other obstructions. Only use your Twin Fury™ in grassy wide-open areas. Use only the pump included in this package. Other pumps may damage the plane or lead to injury. Never pump anything except air into the air tank. After your last flight, spin the propellers to make sure all the air has been used up.

ADULT SUPERVISION IS RECOMMENDED

TROUBLE-SHOOTING GUIDE

PROBLEM	CAUSE	SOLUTION
Engine will not start.	<ol style="list-style-type: none"> 1. No air in AIR TANK. 2. Twin Fury™ AIR INTAKE or PUMP NOZZLE are clogged with dirt. 	<ol style="list-style-type: none"> 1. Pump up Twin Fury™. 2. Clean out AIR INTAKE with a toothpick and re-pump.
Twin Fury™ does not have a level flight path.	<ol style="list-style-type: none"> 1. TAIL WING FLAPS are not adjusted properly. 	<ol style="list-style-type: none"> 1. Re-adjust the TAIL WING FLAPS. Adjusting the FLAPS up will prevent dives, and adjusting the FLAPS down will prevent stalls.
Twin Fury™ AIR INTAKE will not fit into PUMP NOZZLE.	<ol style="list-style-type: none"> 1. Check for dirt in Twin Fury™ AIR INTAKE or PUMP NOZZLE. 	<ol style="list-style-type: none"> 1. Clean up AIR INTAKE and/or PUMP NOZZLE with a toothpick.
Plane seems to constantly turn right/left.	<ol style="list-style-type: none"> 1. VERTICAL TAIL WING needs to be adjusted. 	<ol style="list-style-type: none"> 1. If the plane is always turning right, bend the VERTICAL TAIL FLAP to the left. If the plane is always turning left, bend the VERTICAL TAIL FLAP to the right.
WINGS on your Twin Fury™ get damaged.		<ol style="list-style-type: none"> 1. The WINGS can easily be repaired with clear tape.

WARRANTY (U.S.A.)

Spin Master Ltd. warrants to the original consumer purchaser, that this product is thoroughly tested and inspected before shipment and is guaranteed to be free of factory defects in materials and workmanship for thirty (30) days (unless specified in alternate warranties) from the date of purchase.

In the event of such a defect within the warranty period, Spin Master Ltd., at our sole option, will repair or replace the product or provide you with another product of equal value. Repair or replacement shipment is free of charge. Shipping replacement may take 2 to 6 weeks, depending on customer's location.

In the event of a defect covered under this warranty, please call the toll-free number listed below. Many problems can be solved in this manner. If necessary, you will be instructed to return the defective part or unit, packed securely, postage prepaid and insured by the customer, to the address below. Enclose your name, address, dated sales receipt, and a brief explanation of the defect. There may be an additional handling charge if you send the entire toy.

The warranty is valid if and only if the product has been operated in accordance with the instructions. This warranty does not cover worn or defective batteries, damage resulting from neglect, unauthorized modification, accident, misuse, abuse, any action or omission which constitutes a deviation from the instructions or from the use of accessories or parts not manufactured by Spin Master Ltd. If the product is returned without a dated sales receipt the product is excluded from coverage under this warranty.

Spin Master Ltd.'s liability for defects in material and workmanship under this warranty shall be limited to repair or replacement, at our sole option, and in no event shall we be responsible for accidental, consequential, or contingent damages (except in those states that do not allow this exclusion or limitation) or refunds. This warranty is exclusive, and is made in lieu of any express or implied warranty. This warranty is valid only for products sold in the U.S.A. This warranty gives you specific legal rights and you may have other rights, which vary from state to state. Some states do not allow the exclusion of incidental or consequential damages, so the above exclusions or limitations may not apply to you.

Spin Master Ltd. reserves the right to improve the design of any product without assuming any obligation to modify any product previously manufactured.

If you have a problem, please contact our Customer Care Centre below for help.

SPIN MASTER LTD.
 CUSTOMER CARE CENTRE
 450 Front Street West
 Toronto, Ontario M5V 1B6 CANADA
 TOLL-FREE NUMBER 1-800-622-8339
 (valid only in North America)
 Hours: 8:00 A.M. - 5:00 P.M.
 Eastern Time; Monday – Friday.

Air Hogs® is a registered trademark and Twin Fury™ is a trademark of Spin Master Ltd.
 © 2003 Spin Master Ltd. All rights reserved.
 Manufactured for and distributed by Spin Master Ltd.

MADE IN CHINA Item # 45076
 REV 2 U.S. English

Download from www.Somanuals.com. All Manuals Search And Download.



Free Manuals Download Website

<http://myh66.com>

<http://usermanuals.us>

<http://www.somanuals.com>

<http://www.4manuals.cc>

<http://www.manual-lib.com>

<http://www.404manual.com>

<http://www.luxmanual.com>

<http://aubethermostatmanual.com>

Golf course search by state

<http://golfingnear.com>

Email search by domain

<http://emailbydomain.com>

Auto manuals search

<http://auto.somanuals.com>

TV manuals search

<http://tv.somanuals.com>