



## The ARISTON by Splendide RV/Marine Laundry Pair 2008

Continuing the Splendide tradition of space-saving product design with the aim of creating top-quality, specialized laundry appliances for the RV and Marine industries.

**Splendide**  
*Laundry Centers*



### Easy to use.

Regardless of the type of fabric or degree of soil, Splendide's AW122 washer's handy slide-out key makes choosing the right cycle easy. Load your laundry with ease - Splendide's AS66VX dryer features an extra-wide 14" door opening plus 3 timed drying cycles and a handy 'Auto' cycle that stops automatically when your load is dry.



### As caring as you are.

Splendide washing machines feature electronic control modules which mean they are able to process the quantity and type of wash and decide the right combination of water, temperature and spin speed with a high level of precision to offer you a better performance and great results - whiter whites, brighter colors.



### Built RV/Marine tough.

Splendide washers and dryers not only offer the space, weight and energy savings that are so important in RV's and yachts, but they're built tough to withstand the rigors of the road and the sea. Splendide washers are equipped with heavy-duty springs and shock absorbers, stainless steel drums and reinforced cases for a long travelling life.

### Class-leading dryer.

Splendide 120V dryers not only dry your laundry completely, but they're easier to install and to maintain. Along with Splendide's optional RV/Marine Stack Kit for speedier installations, the AS66VX dryer features an easy-clean lint filter and an industry-first, 4.0 cubic foot dryer drum that maximizes airflow around your clothes - so you're laundry dries faster with less creasing.

### Maximum Performance. Minimum Consumption.

Splendide washers are class A rated, spin up to 1200rpm and carry the ENERGY STAR label. This makes them some of the most efficient washing machines available. So, you'll not only be getting outstanding wash and dry results, but you'll also be conserving precious resources in your RV or yacht - energy and water.



## Washer and Stackable Dryer

Stacked or side-by-side. Splendide-quality washing with added drying capacity.



### AW122 Washer

**Dimensions:** 33"H x 23 5/8"W x 21 1/8"D  
**Electrical:** 120V / 60Hz/13amp  
**Color:** Arctic White  
**Weight:** 159 lbs.

Specifications

**Max. spin:** 1200 rpm  
**Cycles:** 11 wash  
**Max. capacity:** 11 lbs.  
 Automatic water level control  
 158°F Sanitary cycle  
 Load balancing system  
 Self-cleaning pump  
 Slide-out dispenser with cycle key  
 Built-in self diagnostics

Options

Adjustable water temp.  
 Adjustable spin speeds  
 Silk and Wool cycles  
 Pre Wash, Extra rinse, Soaking  
 Easy Iron  
 Bleach option

Performance

ENERGY STAR  
 Washing performance class: A  
 Energy efficiency class: A  
 Wash water use: 7.5 to 16 gal/cycle



### AS66VX Dryer

**Dimensions:** 33"H x 23 5/8"W x 21 3/4"D  
**Electrical:** 120V / 60Hz/13amp  
**Color:** Arctic White  
**Weight:** 78 lbs.

Specifications

**Drying system:** Ventless  
**Stacked Height:** 66 1/4"H  
**Cycles:** 3 (+1 auto) dry  
**Max. capacity:** 11 lbs.  
 4.0 cubic foot drum  
 Easy-clean lint filter  
*Side-mounting stack kit included*

Options

Adjustable dry timer  
 Air Fluff  
 Easy Iron  
 Low Heat  
 Auto Dry

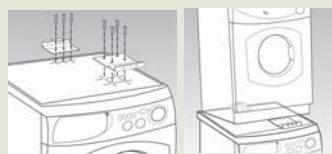
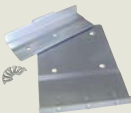

**SK02 Custom RV/Marine Stack Kit**  
*(optional)*

Splendide's new 2008  
 RV / Marine laundry  
 collection leads the industry  
 in capacity, efficiency and  
 performance.

| MODELS  | AW122 WASHER<br>AS66VX DRYER           |
|---|--|
| <b>Additional Features</b>                                    |  |
| Electronic Controls   | •                                      |
| Cycle Status indicators                                       | Knob                                   |
| Washer Door Lock indicator                                    | •                                      |
| Antifoam  | •                                      |
| Soak and Rain wash action                                     | •                                      |
| Detergent Recycling System                                    | •                                      |
| Dryer tumble direction  | Dual                                   |
| <b>Structure</b>  |  |
| Reinforced cases  | •                                      |
| Stainless steel inner drums                                   | •                                      |
| Heavy duty shock absorbers                                    | •                                      |
| Washer door opening/swing                                     | 10.5"/150°                             |
| Dryer door opening/swing                                      | 14"/170°                               |
| Detergent drawer detent                                       | •                                      |
| <b>Safety</b>   |  |
| cULus listed  | •                                      |
| Washer install clearances                                     | 0" sides / 1" front-back               |
| Dryer install clearances                                      | 3/4" sides-front-back / 1/2" top       |
| Dryer install clearances<br><i>(alternative installation)</i> | 0" sides / 5" top /<br>3/4" front-back |
| Overflow flood protection                                     | •                                      |
| Child safety door lock  | •                                      |

Call us at your convenience

Splendide RV/Marine customer service and  
 product support is second to none.  
 You can call us when you need us at

1 800 356 0766

**Splendide Laundry Centers**

A division of Westland Sales, 15650 SE 102nd Ave.  
 Clackamas, Oregon 97015  
 Local Phone: 503 656 2280 Fax: 503 656 8829  
[www.splendide.com](http://www.splendide.com)



"The most trusted name in RV/Marine laundry"

## Free Manuals Download Website

<http://myh66.com>

<http://usermanuals.us>

<http://www.somanuals.com>

<http://www.4manuals.cc>

<http://www.manual-lib.com>

<http://www.404manual.com>

<http://www.luxmanual.com>

<http://aubethermostatmanual.com>

Golf course search by state

<http://golfingnear.com>

Email search by domain

<http://emailbydomain.com>

Auto manuals search

<http://auto.somanuals.com>

TV manuals search

<http://tv.somanuals.com>