

STIGA PARK

121 M

8211-3011-09

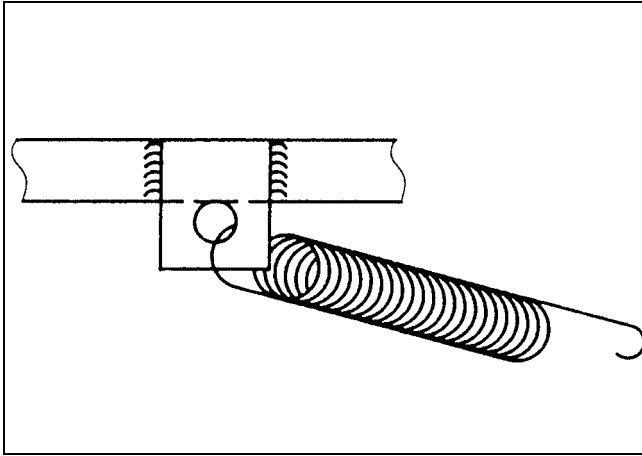



1. Park -1993

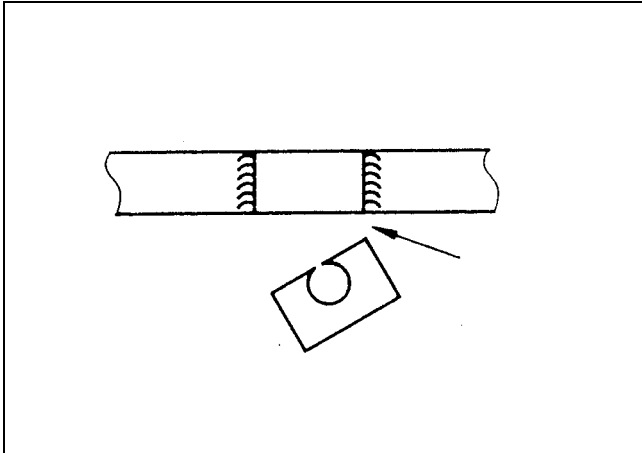

2. Park -1993

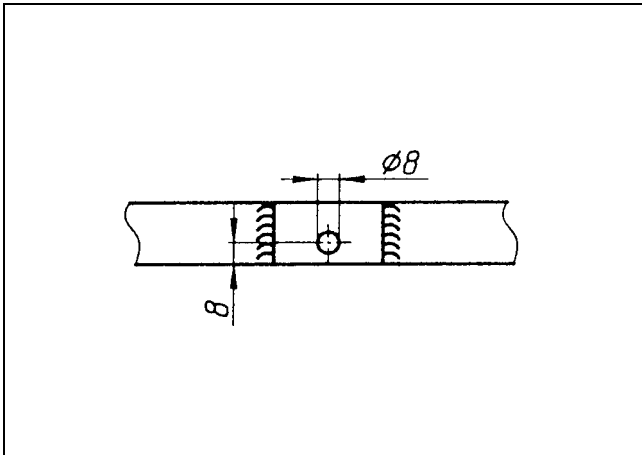

3. Park -1993

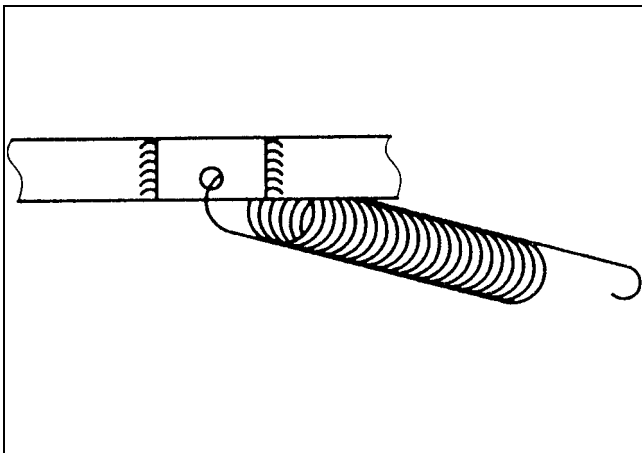

4. Park -1993



5a.

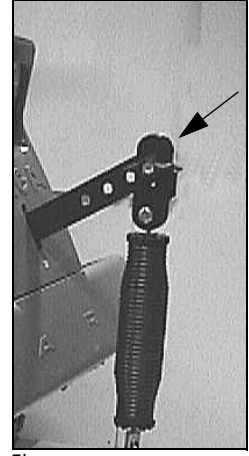

5b.

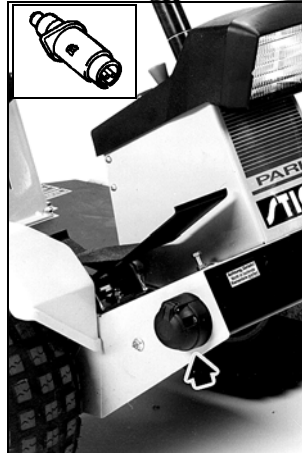

6a. Park -1999

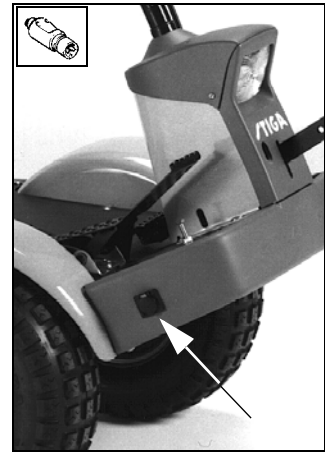

6b. Park 2000-

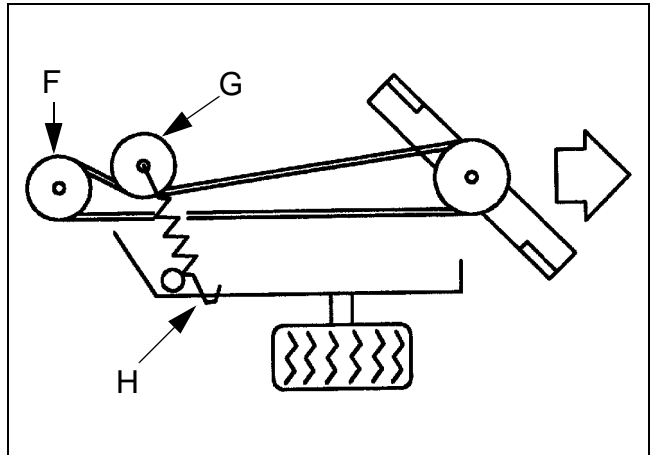

7.



8.



9.

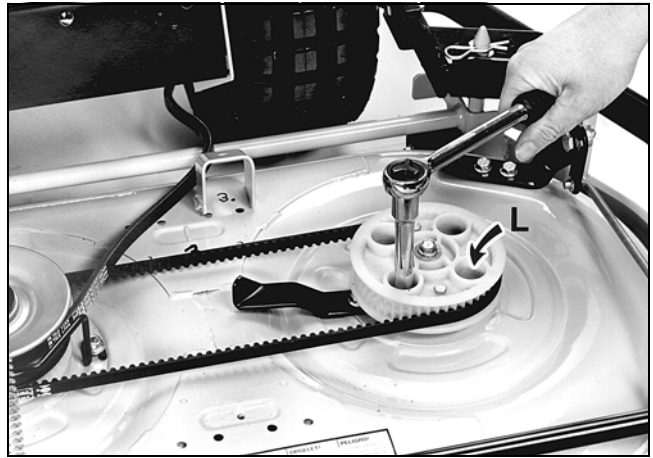

13.



10.

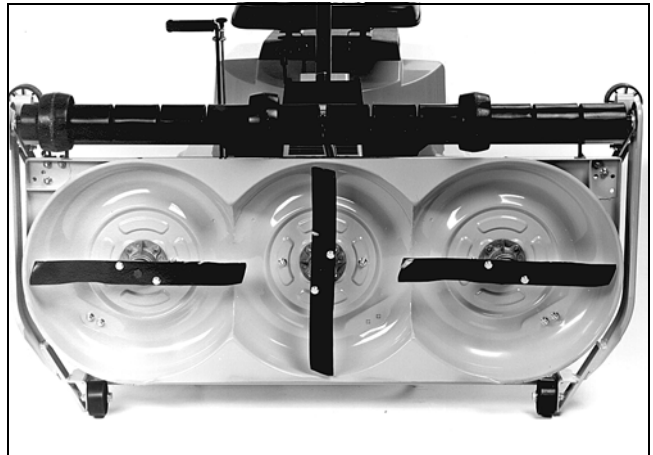

14.

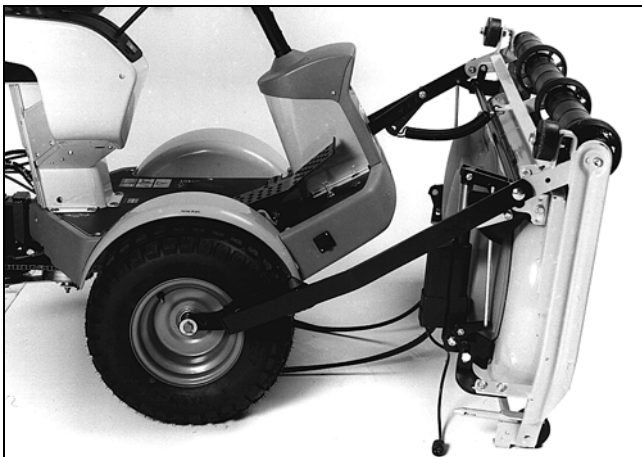

11.

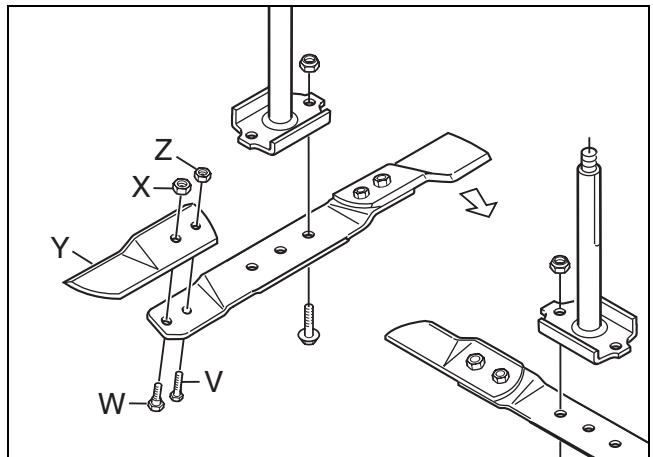

15.

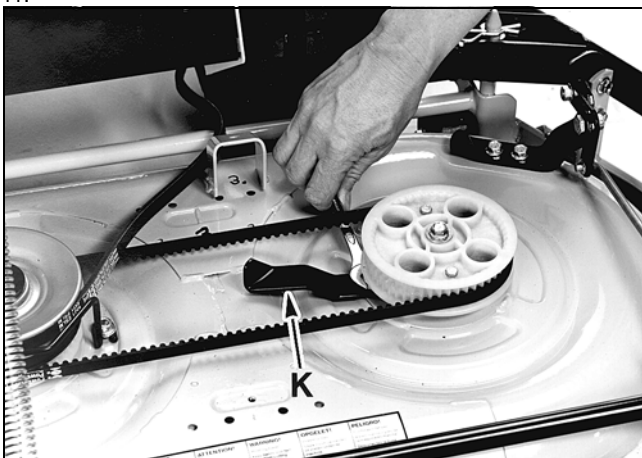

12.

Denna produkt, eller delar därav, omfattas av följande
 mönsterskydd:
 This product, or part of it, is covered by the following
 design registration:

Sverige/Sweden	62 435
Tyskland/Germany	M97 07 997.9 (pending)



SYMBOLS

The following symbols can be found on the machine to remind you of the care and attention that are required during use.

The symbols mean:



Warning!
Read the instruction manual and the safety manual before using the machine.



Warning!
Do not insert your hands or feet under the cover when the machine is in operation.



Warning!
Watch out for discarded objects. Keep onlookers away.



Warning!
Before starting repair work, remove the spark plug cable from the spark plug.



INTRODUCTION

This cutting deck may only be used with Park machines with a motor performance of at least 16 hp.

The cutting deck is available as standard in two versions:

- with mechanical setting of the cutting height (item no. 13-2915).
- with factory-fitted, electrical setting of the cutting height (item no. 13-2921).

PREPARATIONS

Park, year models up to and including 1993:

In order for the deck to be used, the machine has to be modified:

1. Remove the return spring for the articulated joint (fig. 1).
2. Saw off the spring mount flush with the frame side member (fig. 2).
3. Drill a new hole (\varnothing 8 mm), 8 mm from the lower edge of the frame side member (fig. 3).

4. Install the spring in the new hole (fig. 4).

INSTALLATION

CUTTING DECK

1. Screw the cutting deck into the deck mounts D (fig. 5a).
2. Attach the lift spring to the implement lifter (fig. 5b).
3. Install the lifting cylinder in the front lifting arm by inserting the accompanying spacer in the hole on the lifting cylinder and threading on two washers, one on either side. Secure with screw and nut (only applies to item no. 13-2921).
4. Connect the electrical contact to the socket on the side of the machine (only applies to item no. 13-2921), (fig. 6).

V-BELT

1. Set the cutting height setting to an intermediate position.
2. Force the V-belt onto the machine's centre pulley F (fig. 7).
3. Tension the belt with belt idler G. The belt idler should be on the left of the belt viewed from the driver's position.
4. Park -1999:
Hook the belt idler spring H in the floor on the right side (fig. 7).

SETTING

In order for the deck to cut evenly and attractively, it has to be correctly adjusted:

1. Make sure the air pressure in the tyres is correct:
Front: 0.6 bar (9 psi).
Rear: 0.4 bar (6 psi).
2. Place the machine on a level floor. Undo screws I (fig. 8).
3. Adjust the deck so that the front and rear edge of the cover are the same height above the floor.
4. Tighten the screws.

USE

CUTTING HEIGHT

The cutting height can be varied from 30 to 80 mm.

- item no. 13-2915 has seventeen *fixed* positions for cutting height.
- item no. 13-2921 has *continuously variable* adjustment of cutting height.

Note: Stated cutting heights apply when the machine is on a firm surface.

CUTTING TIPS

For optimum 'Multiclip effect', follow these tips:

- cut frequently.
- run the motor at full revs.
- keep the underside of the cutting deck clean.
- use sharp blades.
- do not cut wet grass.
- cut twice (with different cutting heights) if the grass is long.

MAINTENANCE

PREPARATIONS

Unless otherwise stated, all service and maintenance must be carried out on a stationary machine when the motor is not running.



Prevent the machine from rolling by always applying the parking brake.



Prevent unintentional starting of the motor by always stopping the motor, disconnecting the spark plug cable from the spark plug and earthing it. Disconnect the negative cable from the battery.

MAINTENANCE TIPS

To make cleaning and maintenance easier, the cutting deck can be folded up:

1. Set the cutting height setting to an intermediate position (= drive belt minimum tension).
2. Secure the tensioning arm on the hook.
3. Force the belt off the centre pulley F.
4. Undo both pins J (fig. 9).
5. Grip the deck's frame (fig. 10).

6. Fold up the deck until it is upright on the rear support plates (fig. 11).

CLEANING

After each use, the underside of the cutting deck should be rinsed off.

If the grass has dried solid, scrape clean the underside.

If necessary, paint the underside to prevent corrosion.

POSITIVE DRIVE BELTS

If one of the blades has struck a solid object (e.g. a stone), the belt tension may be altered. This can lead to the positive drive belt 'over-meshing' which, in the long term, can damage the blades.

Adjust the belt tension if necessary:

1. Secure the tensioning arm on the hook.
2. Force the belt off the centre pulley F.
3. Dismantle the transmission cover.
4. Undo tensioning arm K (fig. 12).
5. Undo the bearing box's mounting screws L (fig. 13).
6. Tension the positive drive belt by pressing the tensioning arm backwards.
7. Tighten the tensioning arm's mounting screw.
8. Tighten the bearing box's mounting screws.
9. Repeat with the other positive drive belt.



When replacing positive drive belts, ensure that both the outer blades are always at right-angles to the central blade (see fig. 14).

If the positive drive belts are incorrectly mounted, the blades will strike each other because they overlap.

Always check the position of the blades after replacing a belt or adjusting belt tension.

REPLACING BLADES



Use protective gloves when changing blades to avoid cutting yourself.

Ensure that the blades are always sharp. This produces the best cutting results.

Always check the blades after a collision. If the blade system has been damaged, defective parts should be replaced.



Always use original spare parts. Non-original spare parts can entail a risk of injury, even if they fit the machine.

The cutting system comprises three blade bars with two replaceable blades Y (fig. 15). When replacing blades, both should be replaced to avoid imbalance.

Install the new blades. Tighten screws V and W properly. Tightening torque: V - 9.8 Nm, W - 24 Nm.

In the event of a powerful collision, the blades may be bent out. Undo the locking nut X and fold back the blade. Install a new original break bolt V. Tighten the locking nuts X and Z.

SPARE PARTS

STIGA original spare parts and accessories are designed specifically for STIGA machines. Please note that 'non-original' spare parts and accessories have not been checked or approved by STIGA:



The use of such parts and accessories can affect the function and safety of the machine. STIGA accepts no responsibility for damage or injuries caused by such products.

STIGA reserves the right to make alterations to the product without prior notification.



MOWING AHEAD

BOX 1006 · SE-573 28 TRANÅS

www.stiga.com

Free Manuals Download Website

<http://myh66.com>

<http://usermanuals.us>

<http://www.somanuals.com>

<http://www.4manuals.cc>

<http://www.manual-lib.com>

<http://www.404manual.com>

<http://www.luxmanual.com>

<http://aubethermostatmanual.com>

Golf course search by state

<http://golfingnear.com>

Email search by domain

<http://emailbydomain.com>

Auto manuals search

<http://auto.somanuals.com>

TV manuals search

<http://tv.somanuals.com>