

Sunbeam

MultiGrinder

Coffee, Spice and Herb Grinder

INSTRUCTION BOOKLET.



EM0400

Sunbeam's Safety Precautions.

SAFETY PRECAUTIONS FOR YOUR SUNBEAM MULTIGRINDER.

- Always place the unit on a flat, level surface.
- The grinder cannot operate without the lid in position.
- Switch off and unplug at power point before cleaning.
- Do not use the appliance continuously for more than 60 seconds at a time.

SAFETY PRECAUTIONS FOR ALL ELECTRICAL APPLIANCES

Sunbeam are very safety conscious when designing and manufacturing consumer products, but it is essential that the product user also exercise care when using an electrical appliance. Listed below are precautions which are essential for the safe use of an electrical appliance:

- Read carefully and save all the instructions provided with an appliance.
- Always turn the power off at the power outlet before you insert or remove a plug. Remove by grasping the plug - do not pull on the cord.
- Turn the power off and remove the plug when the appliance is not in use and before cleaning.
- Do not use your appliance with an extension cord unless this cord has been checked and tested by a qualified technician or service person.
- Always use your appliance from a power outlet of the voltage (A.C. only) marked on the appliance.
- Close supervision is necessary when your appliance is being used near children or infirm persons.
- Never leave an appliance unattended while in use.
- Young children should be supervised to ensure that they do not play with the appliance.
- Do not use an appliance for any purpose other than its intended use.
- Do not place an appliance on or near a hot gas flame, electric element or on a heated oven. Do not place on top of any other appliance.
- Do not let the power cord of an appliance hang over the edge of a table or bench top or touch any hot surface.
- For safety reasons and to avoid maintenance by unskilled persons, some appliances are 'sealed' using tamperproof screws. Such appliances should always be returned to the nearest Sunbeam Appointed Service Centre for adjustment or repair if required.
- Do not operate any electrical appliance with a damaged cord or after the appliance has been dropped or damaged in any manner. If damage is suspected, return the appliance to the nearest Sunbeam Appointed Service Centre for examination, repair or adjustment.
- For additional protection, Sunbeam recommend the use of a residual current device (RCD) with a tripping current not exceeding 30mA in the electrical circuit supplying power to your appliances.
- Do not immerse the appliance in water or any other liquid unless recommended.

If you have any concerns regarding the performance and use of your appliance, please ring our Toll Free number (Australia only) 1800 025 059. New Zealand - contact the Sunbeam Office in Auckland on 09 912 0747.

Ensure the above safety precautions are understood.

تأكد من تفهم الاحتياطات السلامة المذكورة اعلاه

請務必理解上述的安全預防措施。

Assurez-vous que les précautions ci-dessus relatives à la sécurité sont bien comprises

Versichern Sie sich daß die obenstehenden Sicherheitsmaßnahmen Verstanden werden

Βεβαιώστε πως οι παραπάνω προφυλάξεις ασφαλείας γίνονται κατανοητές

Pastikan bahwa tindakan-tindakan keselamatan seperti di atas dimengerti anda

Accertatevi che le suddette norme di sicurezza siano comprese a dovere

上記の注意事項をよくお読みになり、安全を御確認ください

Уверете се дека погоре споменатите мерки на претпазливост се добро разбрани

Asegúrese de que las precauciones de seguridad precedentes sean bien comprendidas

کاری بکنید کہ احتیاط‌های بالا حتماً درک بشوند

ต้องแน่ใจว่า ข้อควรระวังเรื่องความปลอดภัยข้างต้น เป็นที่เข้าใจกันดี

Yukarda belirtilen güvenlik önlemlerinin anlaşıldığından emin olunuz

Xin kiểm chắc rằng những biện pháp làm an toàn kể trên được hiểu rõ

Features of your Sunbeam MultiGrinder.

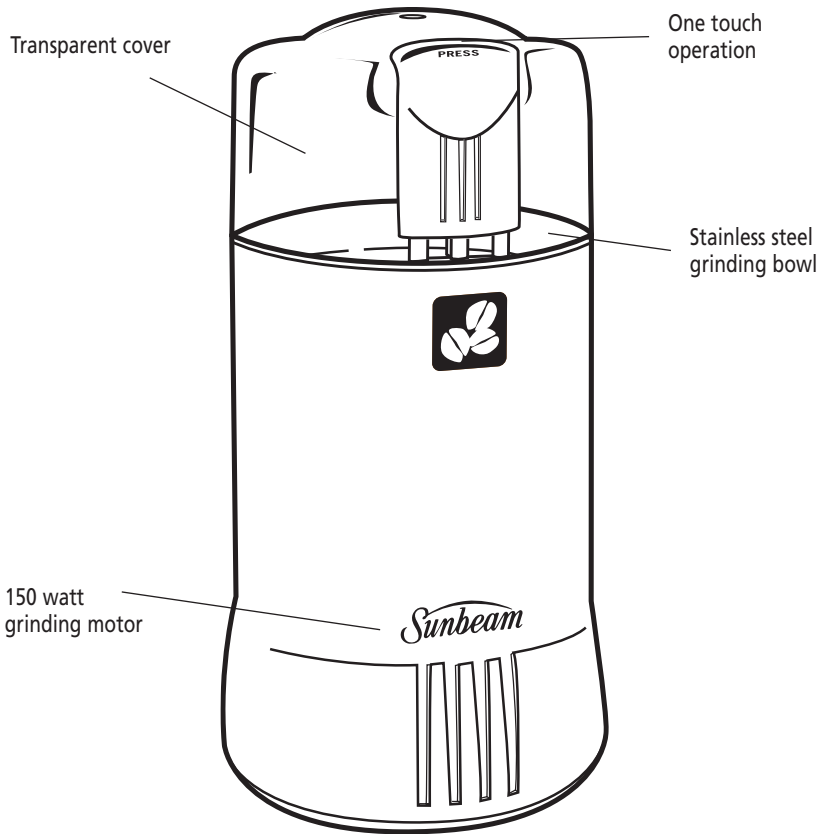

150 watt grinding motor

Handles a variety of grinding tasks.

Stainless steel wing-blade system

Effortlessly grinds coffee beans, spices and herbs to powder in seconds.

Stainless steel grinding bowl

As coffee beans, spices and herbs are oily and aromatic, the stainless steel grinding bowl surface ensures minimal transfer of flavours and odours.

One touch operation

Simple to use, press the operating button on the cover to commence grinding and release to stop.

Transparent cover

Enables the user to observe the coffee beans, spices and herbs as they are being ground to check the fineness of the grind for perfect results every time.

Handy Hints for Grinding Coffee Beans.

- For a good cup of coffee only grind the amount you need for immediate use, as ground coffee quickly loses its flavour and aroma.
- With the Sunbeam MultiGrinder coffee beans can be ground to a very fine grind or a coarse grind. The required coffee grind will be determined by the brewing method used. The different brewing methods include;
- Do not leave coffee beans or grounds in the open air, always store them in an airtight container.
- Excess coffee beans or grounds can be stored in the refrigerator or freezer as by doing so will slow down the rate at which the coffee reacts with the moisture in the air.

Brewing Method	Grind
Turkish Coffee	Very fine grind
Electronic Espresso Machines	Fine grind
Stovetop Espresso or Filter	Medium grind
Plunger or Percolator	Coarse grind

Using your Sunbeam MultiGrinder.

Before using your Sunbeam MultiGrinder, wash the stainless steel grinding bowl, blades, hopper and transparent cover in warm soapy water. Dry thoroughly.

Note: Allow to dry completely before using.

1. Place the MultiGrinder on a dry, level surface.
2. Remove the cover of the MultiGrinder and measure out the desired quantity of coffee beans, spices or herbs into the stainless steel grinding bowl (Figure 1).

Important: Do not exceed 60 grams, approximately fill to the brim of the hopper.

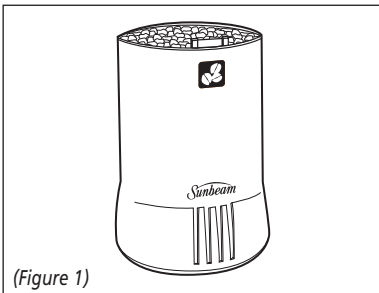

3. Place the cover onto the MultiGrinder (Figure 2).

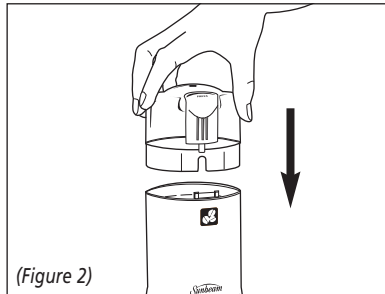

4. Plug the power cord into a 230-240V AC power outlet and turn the power 'ON'.

Using your Sunbeam MultiGrinder (cont).

5. Make sure the cover is securely in place. To commence grinding, simply press down the operating button, located on the cover of the grinder. Continue to press down on the button until you have achieved the desired level of grind and to stop simply release the pressure on the operating button (Figure 3).

Important: Do not remove the cover before the blades have stopped rotating.

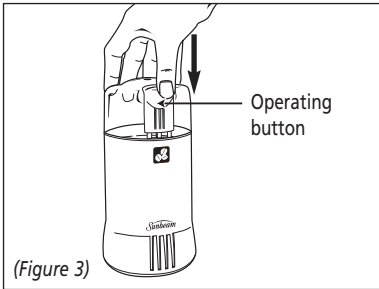

Important: Do not use the MultiGrinder continuously for more than 60 seconds at a time.

TIP: Use only a small amount of coffee beans to experiment with the length of time in which you grind the coffee beans. This will enable you to get exactly the grind you prefer with minimal waste, bringing you one step closer to that perfect cup of coffee.

6. Once the blades have stopped rotating, unplug the cord from the power outlet and remove the cover. Gently tap the base of the MultiGrinder to loosen the freshly ground coffee beans, spices or herbs from the stainless steel grinding bowl and empty into an airtight container or use immediately.

Care and Cleaning.

Do not immerse the motor base of the MultiGrinder in water.

Do not place the MultiGrinder in the dishwasher.

When you have finished grinding, unplug your MultiGrinder from the power outlet.

Remove the cover and wash in warm soapy water. Rinse and dry thoroughly.

Wipe the blades, stainless steel grinding bowl, exterior and motor base with a damp cloth or paper towel to remove any excess ground coffee, spices or herbs.

Use caution when handling the blades, as they are extremely sharp.

Sunbeam is a registered trademark. MultiGrinder is a trademark of the Sunbeam Corporation. Made in China. Due to minor changes in design or otherwise, the product may differ from the one shown in this leaflet. Approved by the appropriate Electrical Regulatory Authorities. Backed by Sunbeam's 12 Month Replacement Guarantee and National Service Network.

© Copyright. SUNBEAM CORPORATION LIMITED 2002. (INCORPORATED IN N.S.W.) A.C.N. 000 006 771

For more information or advice on this or any other Sunbeam appliance, visit www.sunbeam.com.au or contact the Sunbeam Consumer Service Line.

Australia 1800 025 059
New Zealand (09) 912 0747.

Free Manuals Download Website

<http://myh66.com>

<http://usermanuals.us>

<http://www.somanuals.com>

<http://www.4manuals.cc>

<http://www.manual-lib.com>

<http://www.404manual.com>

<http://www.luxmanual.com>

<http://aubethermostatmanual.com>

Golf course search by state

<http://golfingnear.com>

Email search by domain

<http://emailbydomain.com>

Auto manuals search

<http://auto.somanuals.com>

TV manuals search

<http://tv.somanuals.com>