

SR-LXi

TEAC

Hi-Fi Table Radio OWNER'S MANUAL

TEAC CORPORATION	3-7-3, Nakacho, Musashino-shi, Tokyo 180-8550, Japan Phone: (0422) 52-5081
TEAC AMERICA, INC.	7733 Telegraph Road, Montebello, California 90640 Phone: (323) 726-0303
TEAC CANADA LTD.	5939 Wallace Street, Mississauga, Ontario L4Z 1Z8, Canada Phone: (905) 890-8008
TEAC MEXICO, S.A. De C.V	Campeños N°184, Colonia Granjas Esmeralda, Delegacion Iztapalapa, CP 09810, México DF Phone: (525) 581-5500
TEAC UK LIMITED	Unit 19 & 20, The Courtyards, Hatters Lane, Watford, Hertfordshire, WD18 8TE, U.K. Phone: (0845) 130-2511
TEAC EUROPE GmbH	Bahnstrasse 12, 65205 Wiesbaden-Erbenheim, Germany Phone: 0611-71580
TEAC AUSTRALIA PTY., LTD.	30 Tullamarine Park Road, Tullamarine, VIC 3043, Australia Phone: (03) 8336-6500 A.B.N. 11 113 998 048

This appliance has a serial number located on the rear panel. Please record the model number and serial number and retain them for your records.

Model number _____ Serial number _____

1006·MA-1087A

Download from www.Somanuals.com. All Manuals Search And Download.





Includes adapters for:

- iPod nano
- iPod with video
- iPod mini
- iPod with Click Wheel
- iPod with color display

Adapters sold separately:

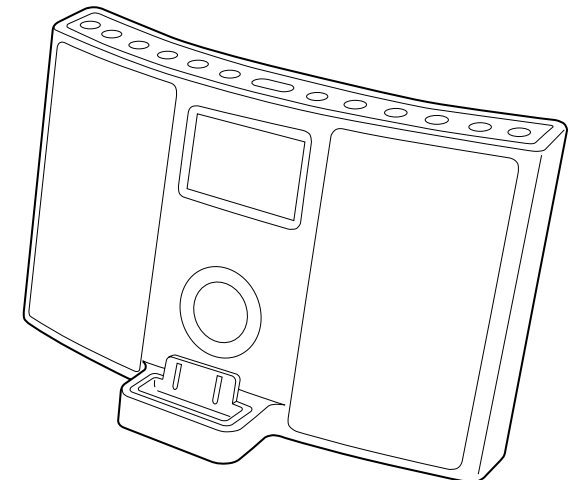
- iPod with dock connector





CAUTION
RISK OF ELECTRIC SHOCK
DO NOT OPEN



CAUTION: TO REDUCE THE RISK OF ELECTRIC SHOCK, DO NOT REMOVE COVER (OR BACK). NO USER-SERVICEABLE PARTS INSIDE. REFER SERVICING TO QUALIFIED SERVICE PERSONNEL.

Cautionary Marking is located on bottom of the unit.



The lightning flash with arrowhead symbol, within an equilateral triangle, is intended to alert the user to the presence of uninsulated "dangerous voltage" within the product's enclosure that may be of sufficient magnitude to constitute a risk of electric shock to persons.



The exclamation point within an equilateral triangle is intended to alert the user to the presence of important operating and maintenance (servicing) instructions in the literature accompanying the appliance.

IMPORTANT SAFETY INSTRUCTIONS

- 1) Read these instructions.
- 2) Keep these instructions.
- 3) Heed all warnings.
- 4) Follow all instructions.
- 5) Do not use this apparatus near water.
- 6) Clean only with dry cloth.
- 7) Do not block any ventilation openings. Install in accordance with the manufacturer's instructions.
- 8) Do not install near any heat sources such as radiators, heat registers, stoves, or other apparatus (including amplifiers) that produce heat.
- 9) Do not defeat the safety purpose of the polarized or grounding-type plug. A polarized plug has two blades with one wider than the other. A grounding type plug has two blades and a third grounding prong. The wide blade or the third prong are provided for your safety. If the provided plug does not fit into your outlet, consult an electrician for replacement of the obsolete outlet.
- 10) Protect the power cord from being walked on or pinched particularly at plugs, convenience receptacles, and the point where they exit from the apparatus.
- 11) Only use attachments/accessories specified by the manufacturer.
- 12) Use only with the cart, stand, tripod, bracket, or table specified by the manufacturer, or sold with the apparatus.  When a cart is used, use caution when moving the cart/apparatus combination to avoid injury from tip-over.
- 13) Unplug this apparatus during lightning storms or when unused for long periods of time.

14) Refer all servicing to qualified service personnel. Servicing is required when the apparatus has been damaged in any way, such as power-supply cord or plug is damaged, liquid has been spilled or objects have fallen into the apparatus, the apparatus has been exposed to rain or moisture, does not operate normally, or has been dropped.

- Do not expose this apparatus to drips or splashes.
- Do not place any objects filled with liquids, such as vases, on the apparatus.
- Do not install this apparatus in a confined space such as a book case or similar unit.
- The apparatus draws nominal non-operating power from the AC outlet with its STANDBY/ON switch in the standby position.
- The apparatus should be located close enough to the AC outlet so that you can easily grasp the power cord plug at any time.
- An apparatus with Class I construction shall be connected to an AC outlet with a protective grounding connection.
- Batteries (battery pack or batteries installed) shall not be exposed to excessive heat such as sunshine, fire or the like.

WARNING: TO PREVENT FIRE OR SHOCK HAZARD, DO NOT EXPOSE THIS APPLIANCE TO RAIN OR MOISTURE.

CAUTION

- DO NOT REMOVE THE EXTERNAL CASES OR CABINETS TO EXPOSE THE ELECTRONICS. NO USER SERVICEABLE PARTS ARE WITHIN!
- IF YOU ARE EXPERIENCING PROBLEMS WITH THIS PRODUCT, CONTACT TEAC FOR A SERVICE REFERRAL. DO NOT USE THE PRODUCT UNTIL IT HAS BEEN REPAIRED.

For European customers Disposal of your old appliance

1. When this crossed-out wheeled bin symbol is attached to a product it means the product is covered by the European Directive 2002/96/EC. 
2. All electrical and electronic products should be disposed of separately from the municipal waste stream via designated collection facilities appointed by the government or the local authorities.
3. The correct disposal of your old appliance will help prevent potential negative consequences for the environment and human health.
4. For more detailed information about disposal of your old appliance, please contact your city office, waste disposal service or the shop where you purchased the product.

Contents

Thank you for choosing TEAC. Read this manual carefully to get the best performance from this unit.

Important Safety Instructions	2
Before Using the Unit	4
Remote Control Unit.	5
Display	5
Unit Functions.	6
Connection.	8
Getting Started	10
Setting the Clock	11
Basic Operation.	12
Listening to iPod.	14
Operating iPod	15
Listening to an External Source.	17
Listening to the Radio	18
Presets Tuning	19
Timer	20
Troubleshooting	22
Specifications	23

Before Using the Unit

Read this before attempting any operations.

- As the unit may become warm during operation, always leave sufficient space around the unit for ventilation.
- The voltage supplied to the unit should match the voltage as printed on the rear panel. If you are in any doubt regarding this matter, consult an electrician.
- Choose the installation location of your unit carefully. Avoid placing it in direct sunlight or close to a source of heat. Also avoid locations subject to vibrations and excessive dust, heat, cold or moisture.
- Do not place the unit on an amplifier/receiver.
- Do not open the cabinet as this might result in damage to the circuitry or electrical shock. If a foreign object should get into the unit, contact your dealer or service company.
- When removing the power plug from the wall outlet, always pull directly on the plug, never yank the cord.
- Do not attempt to clean the unit with chemical solvents as this might damage the finish. Use a clean, dry cloth.
- Keep this manual in a safe place for future reference.

Remote Control Unit

The provided Remote Control Unit allows the unit to be operated from a distance. When operating the remote control unit, point it towards the remote sensor on the front panel of the unit.

- Even if the remote control unit is operated within the effective range, remote control operation may be impossible if there are any obstacles between the unit and the remote control.
- If the remote control unit is operated near other products which generate infrared rays, or if other remote control devices using infrared rays are used near the unit, it may operate incorrectly. Conversely, the other products may also operate incorrectly.

Battery Installation

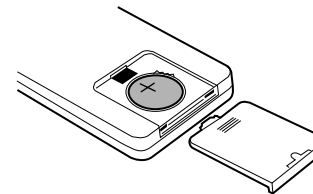

1. Remove the battery compartment cover.
2. Put in the lithium battery (CR2032, 3V).
3. Close the cover.

Battery Replacement

If the distance required between the remote control unit and main unit decreases, the battery is exhausted. In this case, replace the battery with a new one.

Precautions concerning batteries

Do not heat or disassemble batteries and never dispose of old batteries by throwing them in a fire.

Display

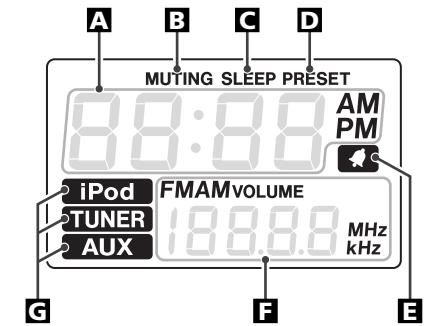

- A** Shows the digital clock, sleep time or preset channels.
- B** Lights during muting.
- C** Lights when the sleep function is active.
- D** Lights in preset tuning mode.
- E** Lights when the timer is on.
- F** Shows frequency, volume, date, etc.
- G** When the unit is on, one of these indicators lights to show the current source.

Unit Functions

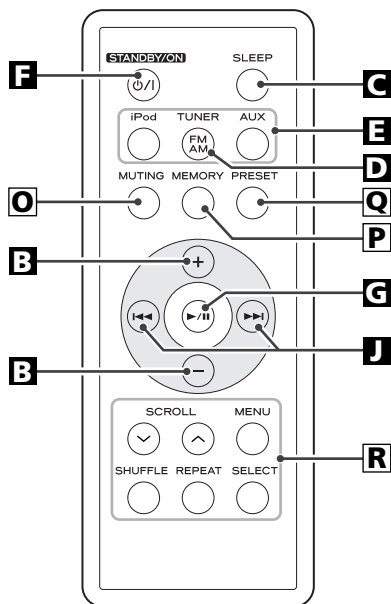
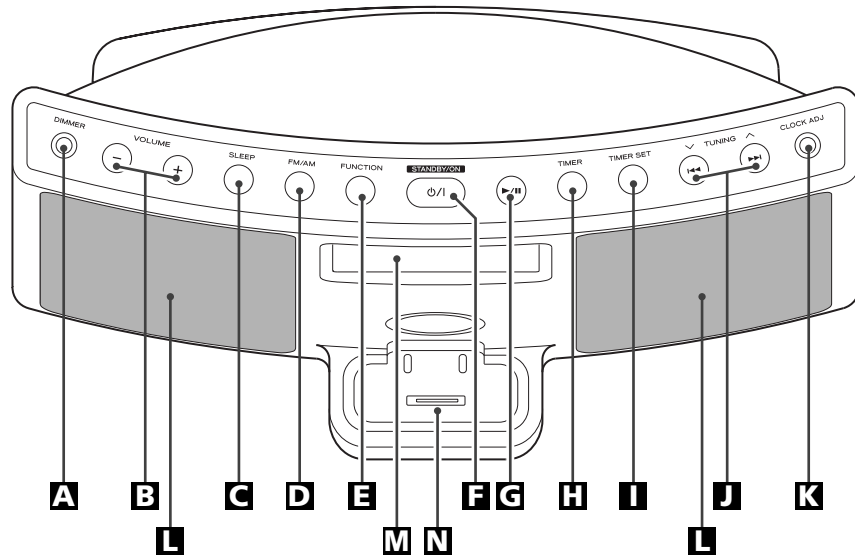

A DIMMER

Use this button to dim the display.

B VOLUME

Press these buttons to adjust the volume level.

C SLEEP

Use this button to set sleep timer.

D FM/AM

In TUNER mode, press this button to select FM or AM.

E FUNCTION

Use these buttons to select the source you want to listen to.

F STANDBY/ON

Use this button to turn the unit on or standby.

The equipment draws a nominal amount of power from the AC outlet even with its STANDBY/ON switch in the STANDBY position.

G Play/Pause (▶/⏸)

Use this button to start or pause playback of iPod.

H TIMER

Use this button to turn on or off the timer function.

I TIMER SET

Use this button to set a timer.

J TUNING(∇/∧)/Skip(◀◀/▶▶)

In TUNER mode, use these buttons to tune in stations.

In iPod mode, use these buttons to skip tracks. Hold down this button to search for a part of a track.

K CLOCK ADJ

Hold down this button for more than 3 seconds to enter clock setting mode.

L Speakers (Stereo)

M Display

N Dock connector

Before use, insert an appropriate Dock adapter in the Dock (see page 10).

Insert an iPod mobile digital device into this dock.

O MUTING

Use this button to mute the sound.

P MEMORY

In TUNER mode, use this button to preset stations.

Q PRESET

In TUNER mode, use this button to select a preset station.

R iPod operation buttons

SCROLL (∇/∧)

Use these buttons to scroll up and down the menu.

MENU

Use this button to go back to the previous menu.

SHUFFLE

Use this button to turn on and off the shuffle playback.

REPEAT

Use this button to set the repeat function.

SELECT

Use this button to confirm selection in menus.

Note:

To simplify explanations, instructions in this manual refer to the names of the buttons and controls on the front panel only. Associated controls on the remote control will also operate similarly.

Connection

CAUTION:

- Switch off the power before making connection.
- Read the instructions of each component you intend to use with this unit.
- Be sure to insert each plug securely. To prevent hum and noise, do not bundle the connection cords.

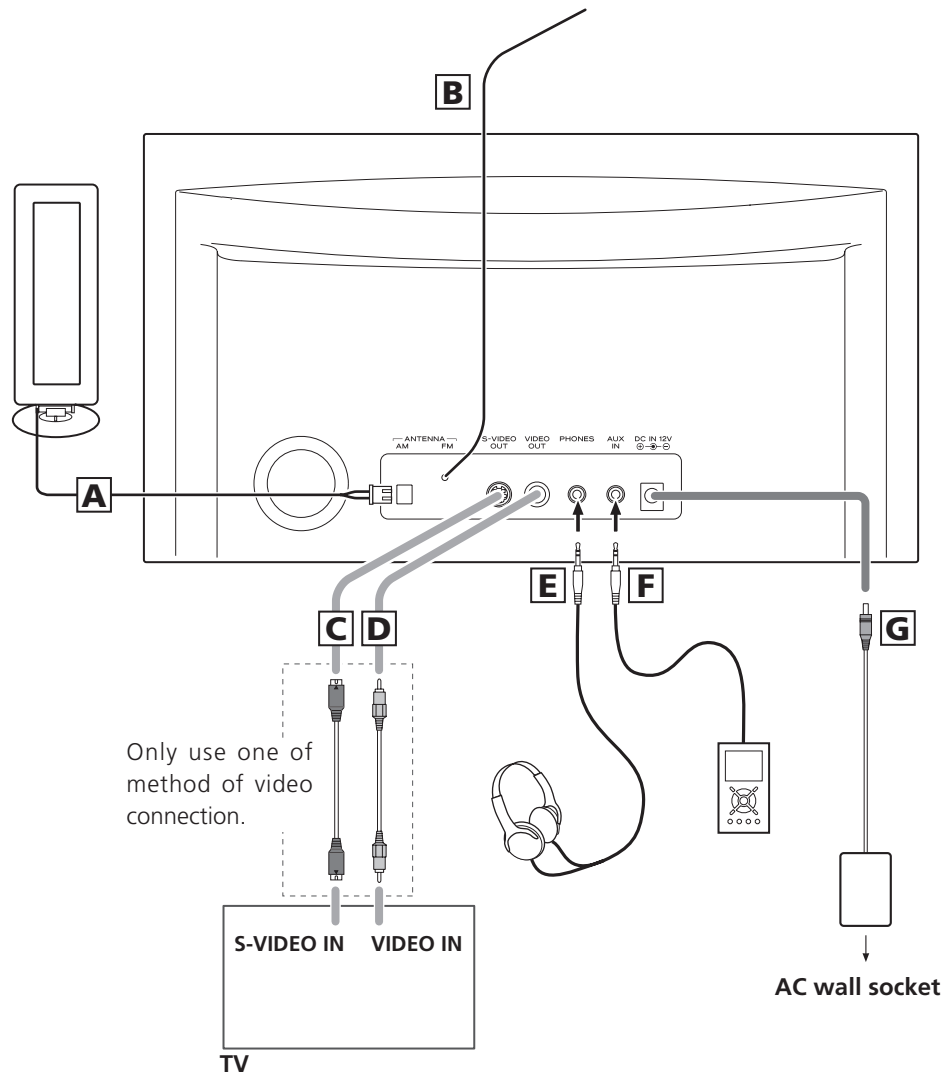

A AM loop antenna

Connect the supplied AM loop antenna to the AM ANTENNA terminal. Place the antenna on a shelf or hang it on a window frame, etc., in the direction which gives the best reception.

If you want, you can hook the AM antenna on a wall as shown below:

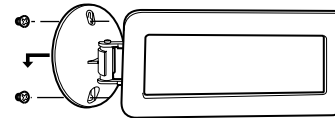

B FM antenna

While in FM mode, tune in an FM station and extend the lead to find the best position for the reception. This antenna may need to be repositioned if you move your unit to a new location.

C S-VIDEO OUT

You can enjoy videos or slideshow reproduced by your iPod through your TV screen. Connect this jack to S-VIDEO IN of your TV set using a commercially available S-Video cable.

D VIDEO OUT

If the S-VIDEO connection method is not available, use a commercially available RCA (pin) video cable to connect to VIDEO IN of your TV set.

E PHONES

For private listening, insert the headphones plug into this jack, and adjust the volume using the VOLUME button.

F AUX IN

You can connect a portable audio player to this jack. See page 17 for details.

G DC IN jack

Connect the provided AC adapter to this jack. Then connect the AC adapter's plug to the AC wall socket.

- Do not use any AC adapters other than the one included with this unit to avoid fire, electric shock, etc. Be sure to connect the adapter to an AC outlet that supplies the correct voltage.

Getting Started

The SR-LXi comes mounted with an adapter "60GB (color) + Photo 40GB/60GB". To play your iPod through the SR-LXi, you have first to check if the factory mounted adapter fits your model of iPod. If it does not, you have to replace it with a correct one, as explained below.

1. Remove the adapter from the Dock of the SR-LXi.

Hold the left and right sides of the adapter and gently pull it up.

2. Choose the Dock adapter that fits your iPod mobile digital device.

"Video 30GB" for iPod with video (30 GB).

"Video 60GB" for iPod with video (60 GB).

"nano" for iPod nano.

"mini" for iPod mini.

"20GB (color) + Photo 30GB" for iPod with color display (20GB, 30GB, U2 Special Edition).

"60GB (color) + Photo 40GB/60GB" for iPod with color display (40GB, 60GB).

"20GB + U2" for iPod with Click Wheel (20 GB, U2 Special Edition).

"40GB" for iPod with Click Wheel (40 GB).

- Use a commercially available adapter to play iPod with dock connector.

3. Insert the adapter into the Dock of the SR-LXi.

Fit the front edge of the adapter into the Dock, and then press the back edge of the adapter onto the Dock until a slight "click" is heard indicating the adapter is inserted correctly.

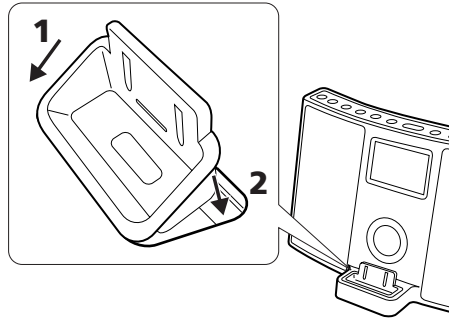

- When you need to remove the adapter, hold the left and right sides of the adapter and gently pull it up.
- When you don't use the Dock, use the supplied cover for the Dock to prevent dust from settling on the Dock.

Compatible iPod Software

In case your iPod will not work with the SR-LXi or with the remote control unit, software update may solve the problem. Visit the Apple website and download the latest iPod Software.

iPod is a trademark of Apple Computer, Inc., registered in the U.S. and other countries.

Setting the Clock

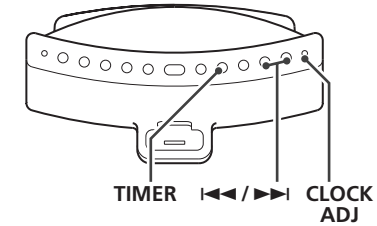

- 1 Press and hold the CLOCK ADJ button for more than 3 seconds and release it when the time display starts blinking.



- If you leave the unit idle for about 1 minute, the clock setting mode will be cancelled.

- 2 Press the skip buttons (I< and >I) to adjust the clock, and then press the CLOCK ADJ button.

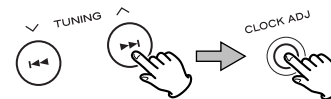

- Hold down the skip button (I< or >I) to adjust the clock continuously.

The clock starts from 00 second.

- 3 Press the skip buttons (I< and >I) to select Year, and then press the CLOCK ADJ button.

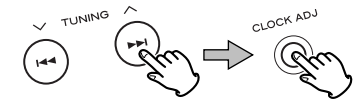

- 4 Press the skip buttons (I< and >I) to select Date, and then press the CLOCK ADJ button.

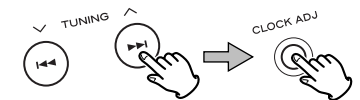

If the power supply is interrupted, the settings kept in memory (clock, preset stations, timer setting) will be erased.

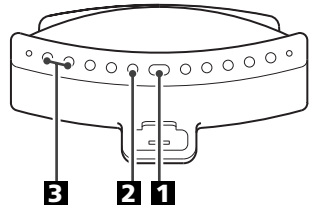

1 Press the STANDBY/ON switch to turn the unit on.



- The unit turns on with the source that was last selected. If the iPod that is in playback mode is inserted into the Dock, the SR-LXi will automatically turn on and start playback of the iPod.
- You can also use the FUNCTION button or Play/Pause button (▶/⏸) to turn the unit on.

2 Press the FUNCTION button to select a source.



- To listen to an external source connected to the AUX IN jack, select AUX.
- If you press the iPod button when no iPod is docked, the iPod indicator on the display blinks.

3 Play the source, and adjust the volume using the VOLUME buttons (-/+).

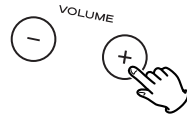

The volume is adjustable from MIN (00) to MAX (40). Hold down the VOLUME - or + buttons to turn down or up the volume continuously.

Dimmer

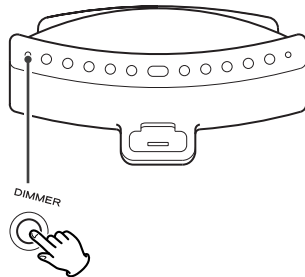

You can dim the front panel's display by pressing the DIMMER button.

- This function will be cancelled when the STANDBY/ON switch is pressed.
- When you set the sleep timer, the display is dimmed automatically.

Muting

To mute the sound temporarily, press the MUTING button. Press the MUTING button again to restore the sound.

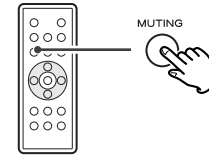

- The MUTING indicator lights on the display to indicate that the muting is engaged.
- If you change the volume or source during the muting, the muting will be canceled.

Headphones

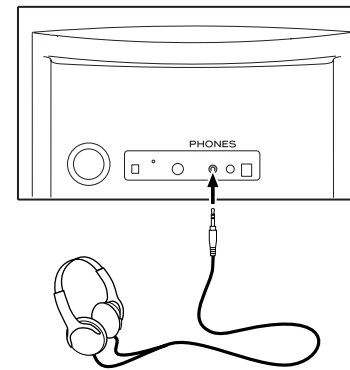

Insert the headphones plug into the PHONES jack, and adjust the volume.

CAUTION

Always lower the volume level prior to plugging in your headphones. TO AVOID DAMAGING YOUR HEARING - Do not place your headphones on your head until after you have plugged them in.

Sleep Timer

You can set a sleep timer so the unit turns itself off after a specified time.

Press the SLEEP button repeatedly until desired time appears on the display.

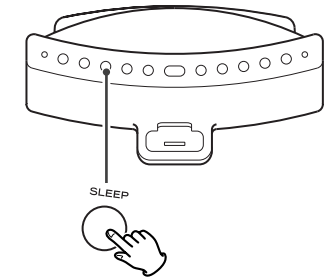

SLEEP 90, 60 or 30:

The power will be switched off 90, 60 or 30 minutes later.

OFF:

The sleep timer is off.

- When you set the sleep timer, the display is dimmed automatically.
- If you want to check the remaining time, press the SLEEP button once. The remaining time will be displayed for a few seconds.

Insert the iPod into the Dock of the SR-LXi.

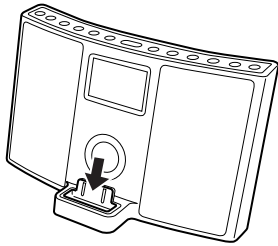

Then push the Play/Pause button (▶/||) on the iPod or the SR-LXi. The SR-LXi will automatically turn on and start playback from the iPod's music list.

- Make sure to use an appropriate Dock adapter (see "Getting Started" on page 10).
- If you remove the iPod during playback, the SR-LXi automatically turns standby.
- The battery of the iPod is recharged to the full whenever the iPod is docked and the SR-LXi is connected to the AC power supply.
- When headphones are plugged into the iPod, sound comes from both the speakers of the SR-LXi and the headphones.

To select iPod mode

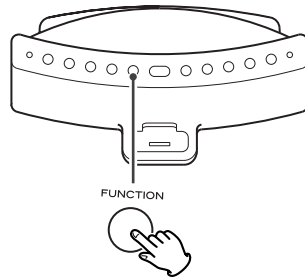

Select "iPod" using the FUNCTION button or the "iPod" button of the remote control unit. If an iPod is already docked, playback will start.

When no iPod is docked the iPod indicator on the display blinks.

- You can also use the Play/Pause button (▶/||) to select "iPod".

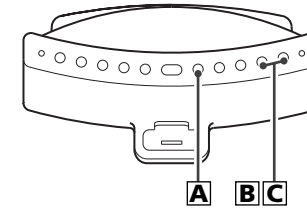

A To suspend playback temporarily (pause mode)



Press the Play/Pause button (▶/||) during playback. Playback stops at the current position. To resume playback, press the Play/Pause button (▶/||) again.

B Search for a part of a track

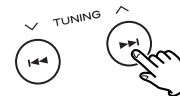

During playback, hold down the Skip button (▶▶) for more than 2 seconds and release it when the part you want to listen to is found.

C To skip to the next or a previous track



During playback, repeatedly press the Skip button (▶▶ or ◀◀) until the desired track is found. The selected track will be played from the beginning.

- When the ◀◀ button is pressed during playback, the track being played will be played from the beginning. To return to the beginning of the previous track, press the ◀◀ button twice.

To go back to the previous menu

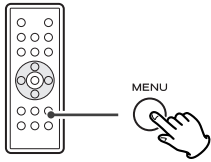

Press the MENU button. It works same as the MENU button of the iPod.

Select the menu item

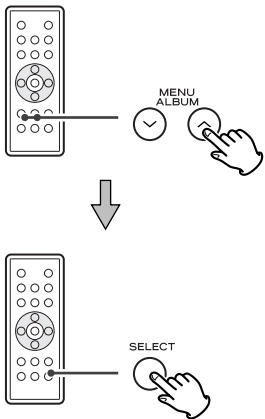

Press the MENU/ALBUM buttons (∨/∧) to scroll to the menu item you want. And then press the SELECT button.

To activate the shuffle mode

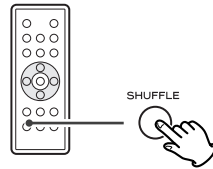

During playback, press the SHUFFLE button to change the shuffle mode. Each time the SHUFFLE button is pressed, the SHUFFLE setting of iPod is changed as follows:

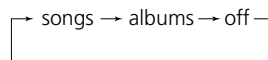

If iPod is set to shuffle songs or albums, the Shuffle icon (∞) appears in the iPod's display.

To activate the repeat mode

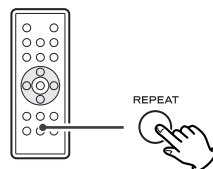

During playback, press the REPEAT button to change the repeat mode. Each time the REPEAT button is pressed, the REPEAT setting of iPod is changed as follows:

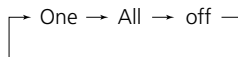

If the iPod is set to repeat one song, the repeat Once icon (↺) appears in the iPod's display.

If the iPod is set to repeat all songs, the repeat icon (↻) appears in the iPod's display.

1 Connect the PHONES jack (audio output jack) of a portable audio player to the AUX IN jack of the SR-LXi using the supplied stereo mini plug cable.

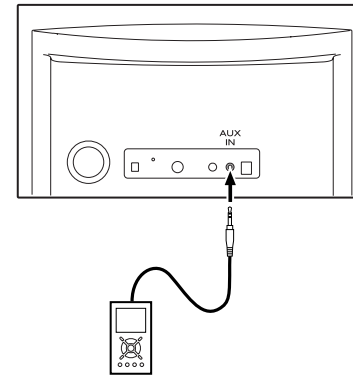

You can use this way of connection to listen to an iPod that has no Dock connector or that has, but an appropriate Dock adapter is not available.

2 Select "AUX" using the FUNCTION button.

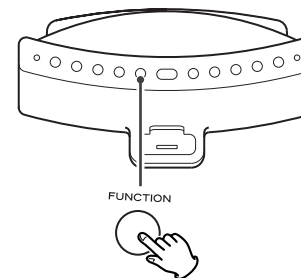

3 Play the source, and adjust the volume of both the SR-LXi and the audio player.

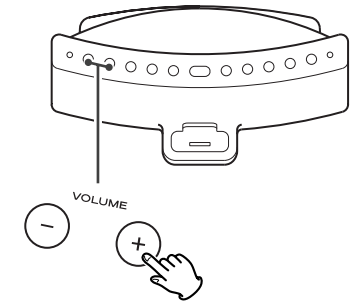

When using the PHONES jack of your mini player, you must adjust the volume of the mini-player or you may hear no sound from your SR-LXi.

- Turning the volume of the mini player up too high may cause the sound from your SR-LXi to be distorted. If this is the case, reduce the volume of the mini player until the distortion stops and then adjust the volume level of the SR-LXi to a comfortable listening level

Listening to the Radio

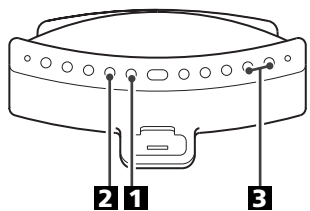

- 1 Select "TUNER" using the FUNCTION button.



- 2 To select FM or AM, press the TUNER (FM/AM) button again.



- 3 Select the station you want to listen to (auto selection).

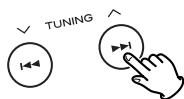

Hold down the Skip button (◀◀ or ▶▶) for more than 2 seconds and release it when the frequency display begins to change.

When a station is tuned in, the tuning process will stop automatically.

- To stop the auto selection, press the Skip button.

Selecting stations which cannot be tuned automatically (manual selection)

When the Skip button (◀◀ or ▶▶) is pressed momentarily the frequency changes by a fixed step.

Press the Skip button repeatedly until the station you want to listen to is found.

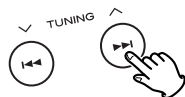

If the reception is poor

For the best reception, rotate the FM or the AM antenna until you get stations clearly.

Preset Tuning

You can program 10 FM & 10 AM channel presets.

If the power supply is interrupted, the settings kept in memory (clock, preset stations, timer setting) will be erased.

- 1 Tune in a station you want to listen to (see page 18).

- 2 Press the MEMORY button.

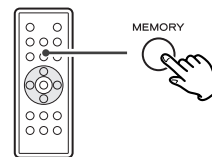

- 3 Within 5 seconds, select a preset channel to store the station using the PRESET button.

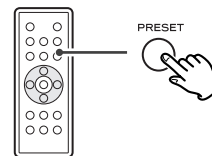

- 4 Within 5 seconds, press the MEMORY button.

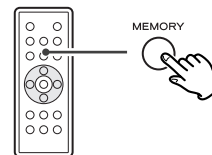

To store more stations, repeat steps 1 to 4.

How to select a preset station

- 1 To select FM or AM, press the TUNER (FM/AM) button.

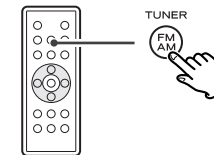

- 2 Press the PRESET button repeatedly until the desired preset station is found.

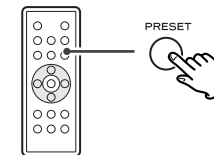

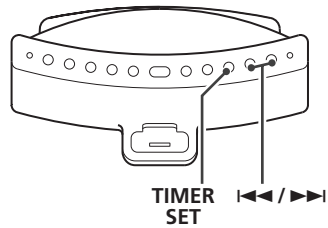

- The unit can be programmed to turn on at a specified time. The unit will turn off after 60 minutes of reaching the specified time.
- Adjust the clock before setting the timer (see page 11).

If the power supply is interrupted, the settings kept in memory (clock, preset stations, timer setting) will be erased.

Setting the timer

- 1 Press the **TIMER SET** button.



The clock and the Timer indicator (🕒) blinks on the display.

- If no button is pressed for about 1 minute, the timer setting mode will be cancelled.

- 2 Set the start time using the Skip buttons (⏮/⏭), and then press the **TIMER SET** button.

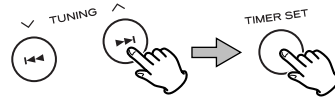

- 3 Select a source (iPod or TUNER) using the Skip buttons (⏮/⏭), and then press the **TIMER SET** button.

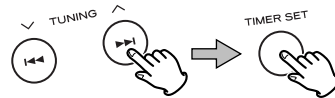

- You cannot select "AUX".

- 4 Set the volume using the Skip buttons (⏮/⏭), and then press the **TIMER SET** button.

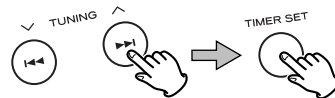

The volume for timer operation is adjustable from 10 to 40. Setting the timer is now completed.

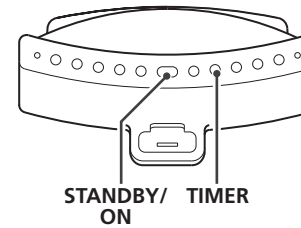

To turn on the timer

- 1 After setting the timer, press the **TIMER** button to turn the timer on.



The Timer indicator (🕒) appears on the display.

- 2 Prepare the source.

When the source is set to "iPod", insert an iPod.
When the source is set to "TUNER", tune in a station.

- 3 Press the **STANDBY/ON** switch to turn the unit off (standby).



Don't forget to turn the unit off (standby), or the timer won't work.

- Playback volume will gradually increase up to your set volume when the unit is turned on by timer.
- If the source is set to "iPod" but no iPod is set, the unit will turn on into TUNER mode.
- When the source is set to "TUNER" and the unit turns on, it will tune in to the station you selected last time.

To turn off the timer

When you don't use the timer, press the **TIMER** button to turn it off.



The Timer indicator (🕒) disappears from the display. Press the **TIMER** button again to turn it on.

If you have problems with your system, look through this chart and see if you can solve the problem yourself before calling your dealer or TEAC service center.

General

No power

- ➔ Check the connection to the AC power supply. Check and make sure the AC source is not a switched outlet and that, if it is, the switch is turned on. Make sure there is power to the AC outlet by plugging another item such as a lamp or fan into the outlet.

No sound from speakers.

- ➔ Select the source by pressing the TUNER, iPod or AUX button.
- ➔ Adjust the volume.
- ➔ Pull out the headphone's plug from the PHONES jack.
- ➔ If the MUTING indicator lights on the display, press the MUTING button.

The sound is noisy.

- ➔ The unit is too close to a TV or similar appliances. Install the unit apart from them, or turn them off.

Remote control doesn't work.

- ➔ Press the STANDBY/ON switch to turn the unit on.
- ➔ If the battery is exhausted, replace it with a new one.
- ➔ Use remote control unit within the range (5 m) and point at the remote sensor on the front panel.
- ➔ Clear obstacles between the remote control unit and the main unit.
- ➔ If a strong light is near the unit, turn it off.

iPod Player

Cannot insert the iPod.

- ➔ Check the dock adapter.
- ➔ Remove dust or obstacles from the Dock connector of the SR-L200i and the iPod, and insert the iPod again.

Will not play.

- ➔ Remove the iPod from the dock, wait a few seconds, and insert it again.
- ➔ Software update may solve the problem. Visit the Apple website and download the latest iPod Software.

Cannot operate the iPod.

- ➔ Set off the HOLD switch of the iPod.

Tuner

Cannot listen to any station, or signal is too weak.

- ➔ Tune in the station properly.
- ➔ Rotate the FM or the AM antenna until you get stations clearly.

If normal operation cannot be recovered, unplug the power cord from the outlet and plug it again.

Maintenance

If the surface of the unit gets dirty, wipe with a soft cloth or use a diluted mild liquid soap. Be sure to remove any excess liquid completely. Do not use thinner, benzene or alcohol as they may damage the surface of the unit. Allow the surface of the unit to dry completely before using.

TUNER Section

Frequency Range FM: 87.5 MHz to 108.0 MHz
 AM: 522 kHz to 1,629 kHz

SPEAKER SYSTEM Section

Type 65 mm x 2
 Impedance 4 ohms

GENERAL

Total Output Power 4 W + 4 W
 Power Requirement AC 230 V, 50 Hz
 Power Consumption 23 W
 Dimension (W x H x D) 320 x 179 x 171 mm
 Weight (Net) 1.8 kg

Standard Accessories

Remote Control Unit (RC-1084 or RC-1085) x 1
 Battery (CR2032) for Remote Control Unit x 1
 AM loop antenna x 1
 Stereo mini plug cable x 1
 AC Adapter x 1

Dock adapter x 8
 (adapter "60GB (color) + Photo 40/60GB" premounted)
 Cover for the Dock x 1

Owner's Manual x 1
 Warranty Card x 1

- Design and specifications are subject to change without notice.
- Weight and dimensions are approximate.
- Illustrations may differ slightly from production models.

Free Manuals Download Website

<http://myh66.com>

<http://usermanuals.us>

<http://www.somanuals.com>

<http://www.4manuals.cc>

<http://www.manual-lib.com>

<http://www.404manual.com>

<http://www.luxmanual.com>

<http://aubethermostatmanual.com>

Golf course search by state

<http://golfingnear.com>

Email search by domain

<http://emailbydomain.com>

Auto manuals search

<http://auto.somanuals.com>

TV manuals search

<http://tv.somanuals.com>