

TEAC

9A09878900
CQX1A860Z

T-H300DAB

DAB
Digital Audio Broadcasting

DAB/AM/FM Stereo Tuner

OWNER'S MANUAL

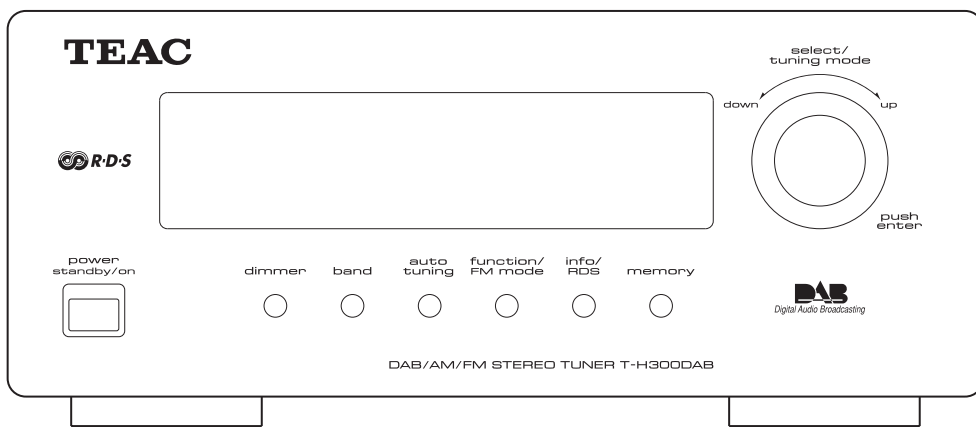

IMPORTANT(for U.K.Customers)

DO NOT cut off the mains plug from this equipment. If the plug fitted is not suitable for the power points in your home or the cable is too short to reach a power point, then obtain an appropriate safety approved extension lead or consult your dealer.

If nonetheless the mains plug is cut off, remove the fuse and dispose of the plug immediately, to avoid a possible shock hazard by inadvertent connection to the mains supply.

If this product is not provided with a mains plug, or one has to be fitted, then follow the instructions given below:

IMPORTANT. DO NOT make any connection to the larger terminal which is marked with the letter E or by the safety earth symbol \perp or coloured GREEN or GREEN-and-YELLOW.

The wires in the mains lead on this product are coloured in accordance with the following code:

BLUE : NEUTRAL
BROWN : LIVE

As these colours may not correspond with the coloured markings identifying the terminals in your plug proceed as follows:

The wire which is coloured BLUE must be connected to the terminal which is marked with the letter N or coloured BLACK.

The wire which is coloured BROWN must be connected to the terminal which is marked with the letter L or coloured RED.

When replacing the fuse only a correctly rated approved type should be used and be sure to re-fit the fuse cover.

IF IN DOUBT — CONSULT A COMPETENT ELECTRICIAN.

CAUTION

The product shall not be exposed to dripping or splashing and that no object filled with liquids, such as vases, shall be placed on the product.

Do not install this equipment in a confined space such as a book case or similar unit.

Contents

Thank you for choosing TEAC. Read this manual carefully to get the best performance from this unit.

Important (for U.K. Customers)	2
Before Use	3
Remote Control Unit	3
Connection	4
Connecting Antennas	6
Names of Each Control	8
About Digital Audio Broadcasts	10
Setting up your DAB Tuner	10
Using the Channel List	11
Using Function Control	
Station order	12
Sig error rate	13
Preset tune	13
Sw version	14
DRC value	14
Manual tune	15
Auto Tuning	15
Changing Display Settings	16
Listening to FM/AM	17
Presetting	18
RDS	19
PTY Search	20
PTY Programmes	21
Factory Reset	21
Sleep Timer	22
Specifications	22
Troubleshooting	23



This symbol means that the product is double insulated and you do not need an earth connection



This symbol means that this product keeps to the European safety and electrical interference directives

Before Use

Read this before operation

- The voltage supplied to the unit should match the voltage as printed on the rear panel. If you are in any doubt regarding this matter, consult an electrician.
- Choose the installation location of your unit carefully. Avoid placing it in direct sunlight or close to a source of heat. Also avoid locations subject to vibrations and excessive dust, heat, cold or moisture.
- Do not place the unit on the amplifier/receiver.
- Do not open the cabinet as this might result in damage to the circuitry or electrical shock. If a foreign object should get into the set, contact your dealer.
- When removing the power plug from the wall outlet, always pull directly on the plug, never yank the cord.
- Do not attempt to clean the unit with chemical solvents as this might damage the finish. Use a clean, dry cloth.
- Keep this manual in a safe place for future reference.

Maintenance

If the surface of the unit gets dirty, wipe with a soft cloth or use diluted mild soap liquid. Be sure to remove any excess completely. Do not use thinner, benzine or alcohol as they may damage the surface of the unit.

CAUTION Regarding Placement

To maintain proper ventilation, be sure to leave a space around the unit (from the largest outer dimensions including projections) equal to, or greater than, shown below.

Left and Right Panels	: 10 cm
Rear Panel	: 5 cm
Top Panel	: 2 cm

Remote Control Unit

The provided Remote Control Unit allows the unit to be operated from a distance.

When operating the remote control unit, point it towards the REMOTE SENSOR on the front panel of the unit.

- Even if the remote control unit is operated within the effective range, remote control operation may be impossible if there are any obstacles between the unit and the remote control.
- If the remote control unit is operated near other appliances which generate infrared rays, or if other remote control devices using infrared rays are used near the unit, it may operate incorrectly. Conversely, the other appliances may operate incorrectly.

Battery Installation

- 1 Remove the battery compartment cover.
- 2 Insert two "AAA" (R03, UM-4) dry batteries. Make sure that the batteries are inserted with their positive "⊕" and negative "⊖" poles positioned correctly.
- 3 Close the cover.

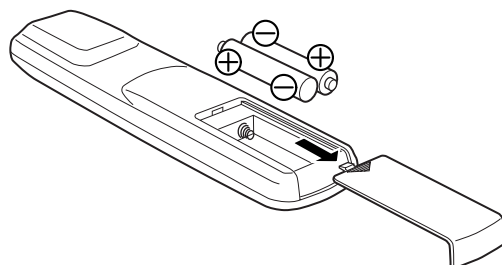

Battery Replacement

If the distance required between the remote control unit and main unit decreases, the batteries are exhausted. In this case replace the batteries with new ones.

Precautions concerning batteries

- Be sure to insert the batteries with correct positive "⊕" and negative "⊖" polarities.
- Use batteries of the same type. Never use different types of batteries together.
- Rechargeable and non-rechargeable batteries can be used. Refer to the precautions on their labels.
- When the remote control unit is not to be used for a long time (more than a month), remove the batteries from the remote control unit to prevent them from leaking. If they leak, wipe away the liquid inside the battery compartment and replace the batteries with new ones.
- Do not heat or disassemble batteries and never dispose of old batteries by throwing them in a fire.

Connection

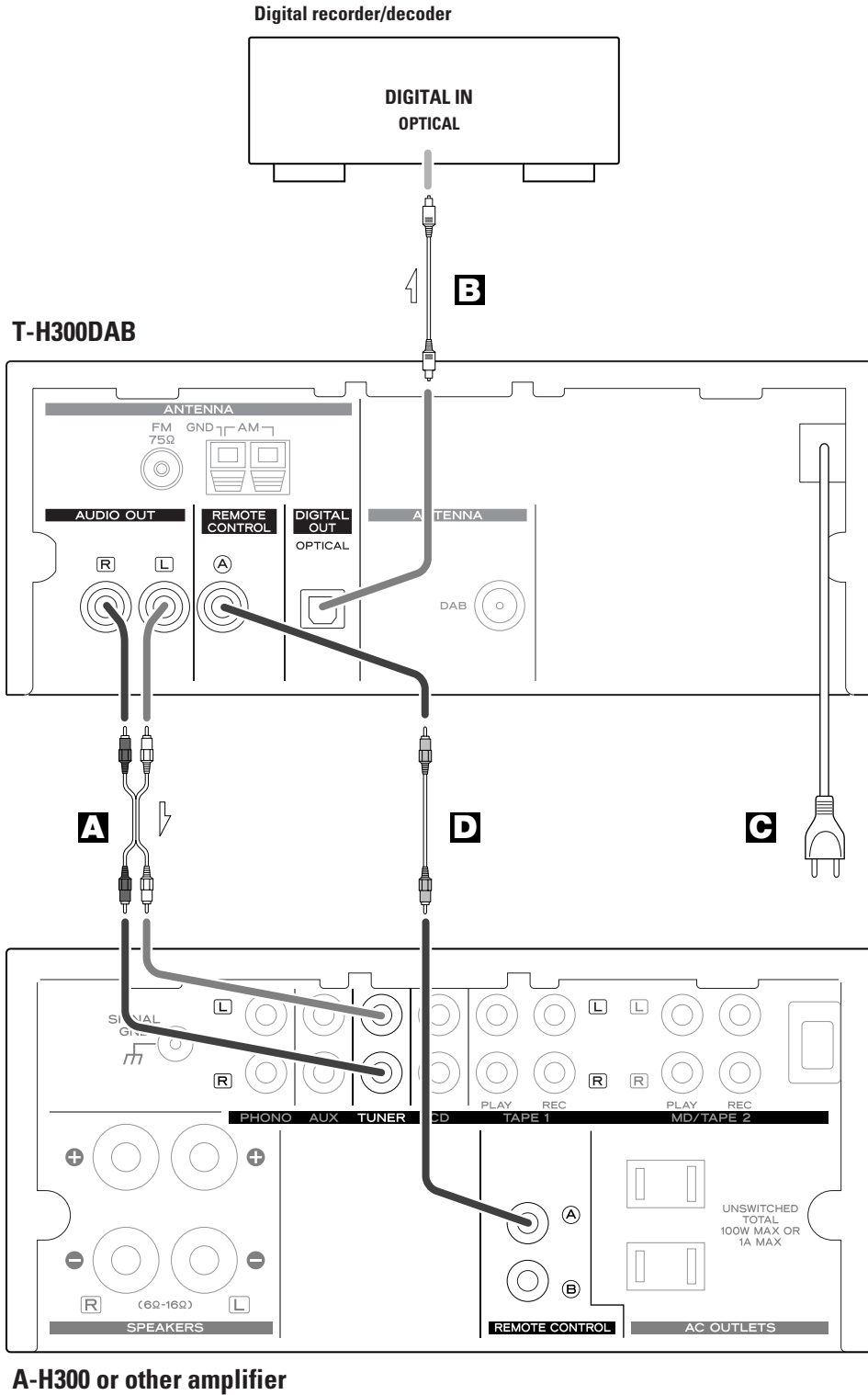

CAUTION

Turn off the power of all the equipment before making connections.
Read instructions of each component you intend to use with this unit.

- Be sure to insert each plug securely. To prevent hum and noise, do not bundle the connection cords with the power cord.

A AUDIO OUT jack

Analogue 2-channel audio signal is output from this jack.

Connect the component with RCA pin cable.

AUDIO OUT (T-H300DAB) → TUNER IN (amplifier)

Make sure to connect :

white plug → white jack (L: left)
red plug → red jack (R: right)

B DIGITAL OUT terminal

DAB's digital audio signal is output from this terminal. If you want to record digitally, or decode the signal using an external digital decoder, connect the component with an optical cable.

DIGITAL OUT (T-H300DAB)
→ **DIGITAL IN (decoder, CD-R, MD, etc.)**

C Power cord (AC)

Be sure to connect the power cord to an AC outlet which supplies the correct voltage.
Hold the power plug when plugging or unplugging the power cord.

D REMOTE CONTROL jack

If you have TEAC Reference 300 series, Convenient system control operations are possible.

- By pressing the POWER STANDBY button of the Reference 300 series Amplifier/Receiver, you can switch ON/standby all the unit connected with remote control cord.
- When you press the PLAY button of the source, the INPUT SELECTOR of the Reference 300 series Amplifier/Receiver will be set to the source automatically.
- The source you select by the INPUT SELECTOR of the Reference 300 series Amplifier/Receiver will start playback automatically.
- When you turn ON the system, the source that was selected last time will start playback automatically.
- You can use the system remote control unit to operate all the unit connected with remote control cords.

Connect the remote control jack (A or B) of each component with remote control cords.

Connecting Antennas

A AM Indoor Loop Antenna

A high-performance AM loop antenna provided with this unit is sufficient for good reception in most areas.

To stand the loop antenna on a surface, insert the claw into the slot.

Connect the loop antenna's wires to the AM antenna terminals as shown.

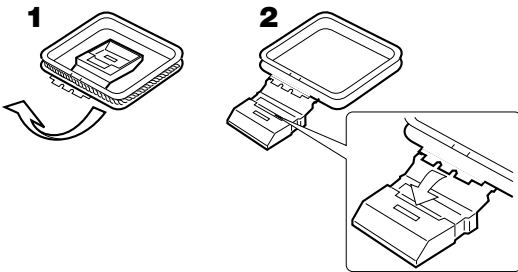

Place the antenna on a shelf, for example, or hang it on a window frame, etc., in the direction which gives the best reception, as far away as possible from the entire system, speaker cords and the power cord to prevent unwanted noise.

If there is no room for the AM loop antenna, you may mount it on the wall using screws (not supplied).

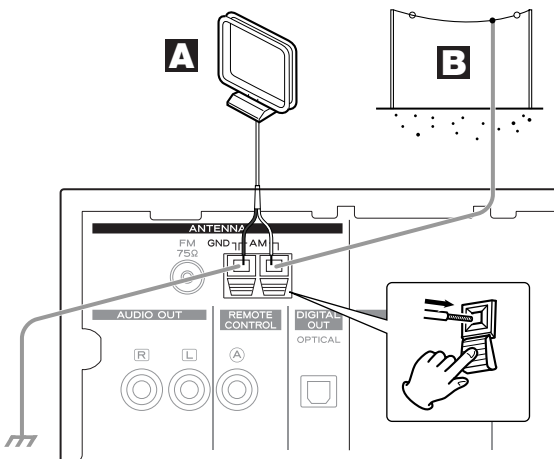

B AM Outdoor Antenna

If the AM loop antenna provided does not deliver sufficient reception (because you are too far from the transmitter or in a concrete building, etc.), it may be necessary to use an outdoor AM antenna. Strip one end of a 5-m or longer, insulated wire and connect it to the terminal as shown. The antenna wire should be strung outdoors or if indoors, near a window. For better reception, connect the GND terminal to a reliable ground.

Note:

Even when using an outdoor AM antenna, do not disconnect the AM loop antenna.

C FM Indoor Antenna

Connect the lead-type FM antenna to the FM 75Ω socket, extend the lead and attach it to a window frame or wall with thumbtacks, or the like, where reception is best.

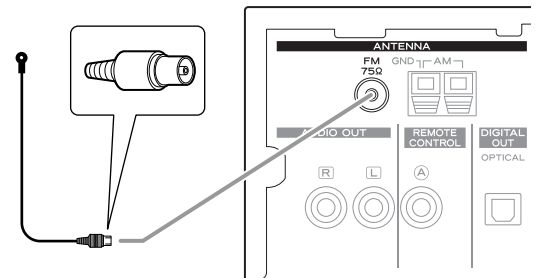

D FM Outdoor Antenna

In an area where FM signals are weak, it will be necessary to use an outdoor FM antenna. Generally, a 3-element antenna will be sufficient; if you live in an area where the FM signals are particularly weak, it may be necessary to use one with 5 or more elements.

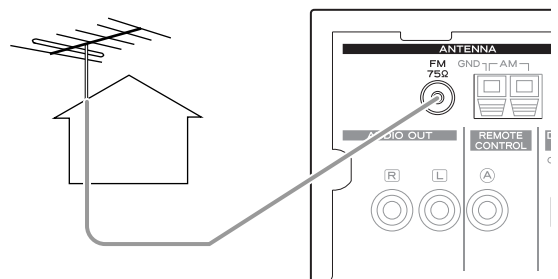

DAB Indoor Antenna

Connect the T-type DAB antenna to the DAB socket, extend the lead vertically and attach it to a window frame or wall with thumbtacks, or the like, where reception is best.

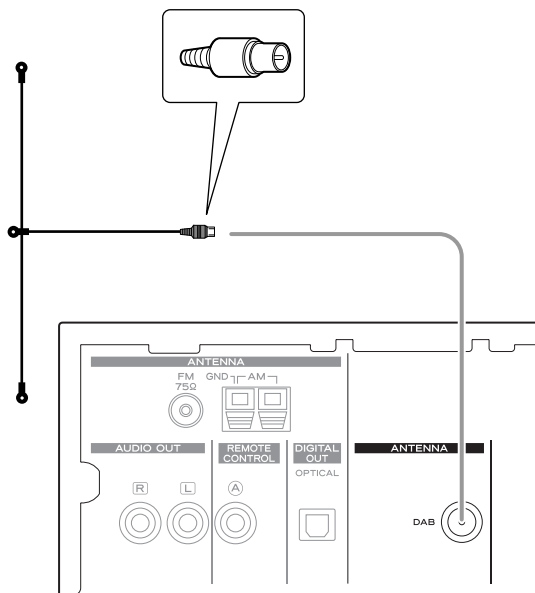

- You can check the antenna adjustment or positioning for the best reception by viewing the signal strength on the display. The signal strength is displayed as a bar graph by pressing the SELECT/TUNING MODE knob once.

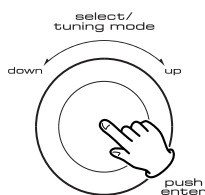

BBC 6
0000000

DAB Outdoor Antenna

In an area where DAB signals are weak, it will be necessary to use an outdoor DAB antenna. There are two main types available.

Dipole:

For use in marginal signal areas. This type of antenna is omnidirectional and should increase the strength of all DAB stations being received.

Multi-element antenna:

Also for use in marginal or poor signal areas. This type of antenna is directional and has high gain. This antenna needs to be pointed at the transmitter you want to listen to.

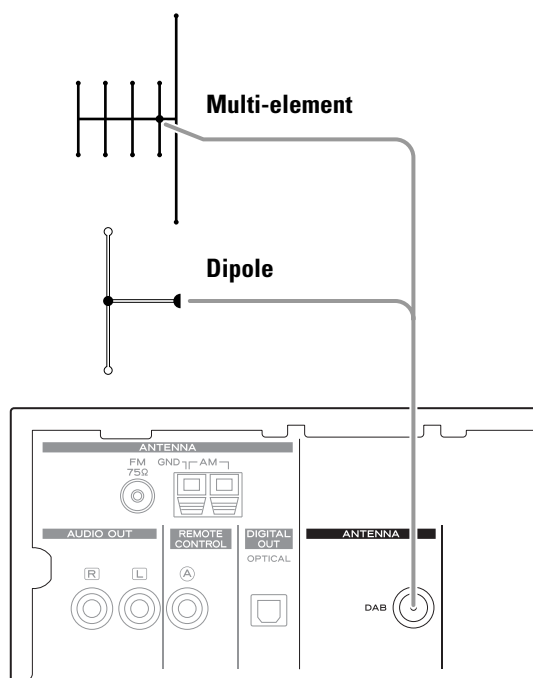

- It is possible to use a TV or FM antenna with your DAB tuner as this is normally mounted externally. This may give a stronger signal than a simple internal antenna, however it would not be tuned specifically for DAB reception. You would need to change the plug on your TV/FM antenna to an F type, and it may also be necessary to use a signal booster to enhance the signal.

Names of Each Control

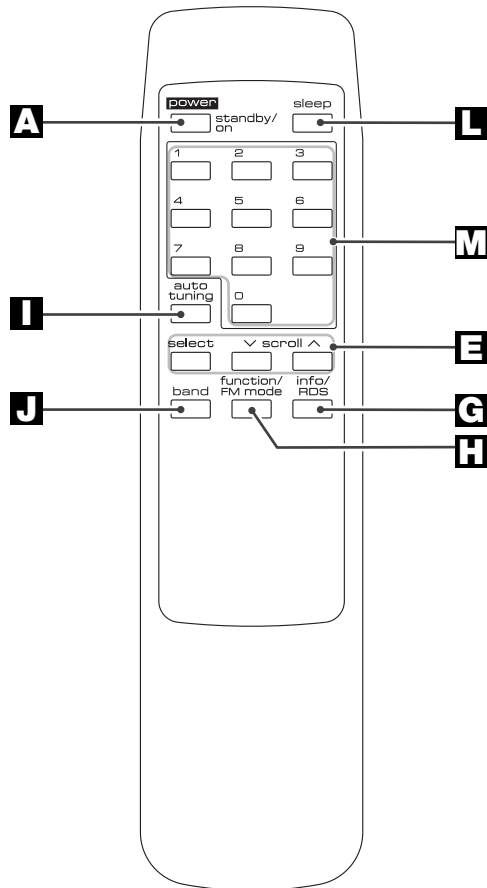
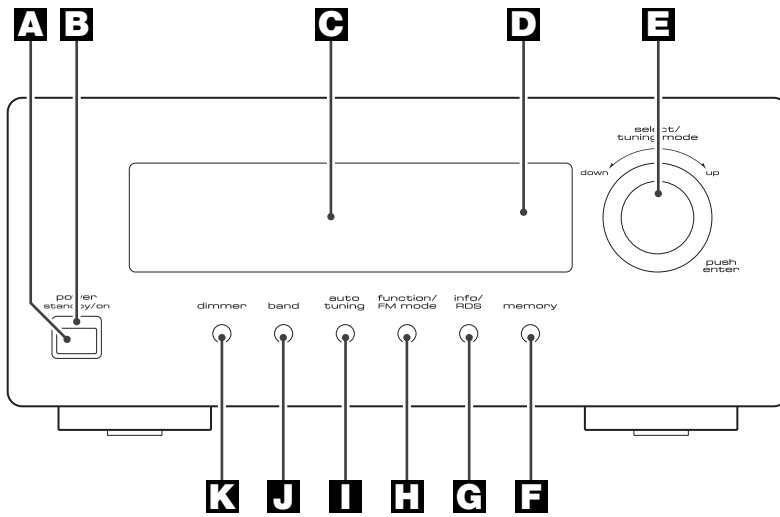

A POWER switch

Press this switch to turn the unit on or off (standby).

The equipment draws nominal non-operating power from the AC outlet with its POWER switch in the OFF position.

B STANDBY indicator

This indicator lights when the unit is in the standby mode.

When the unit is turned on, it goes off.

C Display

When the unit is on, the current status of the unit is displayed.

D Remote sensor

When operating the remote control unit, point it towards the remote sensor.

E SELECT/TUNING MODE knob

(SELECT and SCROLL on the remote control unit)

To adjust the parameters such as changing stations, turn this knob (or press SCROLL on the remote). Pressing the knob (or SELECT on the remote) selects the displayed station.

Also operates the commands in the function menus.

Press once to show signal strength, press again to remove signal strength display.

F MEMORY button

Press this button to store the station. Up to 70 stations (DAB:10, FM:30, AM:30) can be stored in preset memories.

G INFO/RDS button

In DAB mode, this button is used to change the text content on the second line of the display, to show DLS (Dynamic Label Segment, info text supplied by each radio station), Programme type (classification given by the radio station ie: Pop music or Rock), Multiplex name (name of multiplex broadcaster), Time & date, Bitrate, or Channel and frequency.

In FM mode, this button is used to select the RDS mode.

H FUNCTION/FM MODE button

In DAB mode, activates features such as station order, manual tune, DRC value, SW version indication, signal error rate. It is also possible to 'tidy' the station list to remove stations which are in the memory but have no service provided.

In FM mode, pressing this button alternates between stereo mode and mono mode.

I AUTO TUNING button

Press this button to activate auto location of all available DAB services.

Press once for UK services or, hold for longer than 2 seconds to activate international search.

J BAND button

Press this button to select the band (FM, AM or DAB).

K DIMMER button

This button is used to dim the display.

L SLEEP button

Use this button to set the sleep timer.

M Numeric buttons

Use these buttons (0–9) to select the desired preset channel.

About DAB

With this unit you can receive and listen to Digital Audio Broadcast (DAB) programmes. DAB uses digital, not analogue signals, resulting in near CD-quality audio with virtually interference-free reception. Along with superior quality audio, DAB can also deliver additional audio channels and text. In the future, computer data and images are also possible.

Digital radio is broadcast as groups of data called ensembles or multiplexes. Each multiplex can contain a number of stations (services) and each station contains a primary service and can contain secondary services as illustrated in the following diagram.

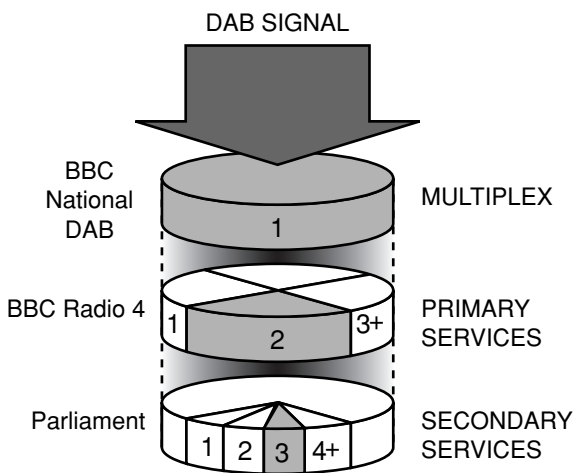

Each multiplex is transmitted in a set frequency range and received by this unit for decoding. You can receive multiplexes broadcast in the 174–240 MHz frequency band and store the services in each multiplex for you to access. The number of multiplexes you receive depend on your location. Channels used in the UK are in the range 10A to 12D.

Multiplexes and stations have labels (names) that are used to identify them. Instead of needing to know the particular frequency of your favourite broadcast, you can simply select the station name. Secondary services and additional data such as text or multiplex info are also available.

Setting up your DAB Tuner

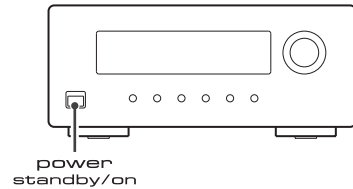

The first time you turn on the unit, it will scan for DAB channels and build a channel list.

Press the POWER switch to turn the unit on.

The following screen will display for 2 seconds.

```
DAB initialize
Please wait
```

The unit will scan for broadcast services in the local area and add them to the channel list as they are found. The scan should take about 10 seconds.

```
Autoscan local 0
>>>>
```

As channels are added to the channel list the number of channels found is displayed.

```
Autoscan local10
>>>>>>>>>>
```

After broadcast services have been found the channels are listed in alphanumeric order.

- If no broadcast services are found, please check that the antenna is correctly connected to the unit.

Using the Channel List

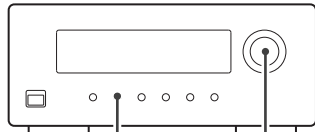

BAND SELECT/TUNING MODE

Follow the steps below to tune in and listen to the channels found by the unit.

1 Select DAB by pressing the BAND button.

band



2 Turn the SELECT/TUNING MODE knob to the left or right to scroll through the channels in the channel list.

The present channel is displayed on the first line and the changing list is displayed on the second line.

3 When you have found a channel that you want to listen to, press the SELECT/TUNING MODE knob once.

The channel is tuned in and channel information is displayed.

Now tuning...



BBC 6
01:01 15-07-2003

- To display the signal strength of a channel, press the SELECT/TUNING MODE knob again. The signal strength is display. Press the SELECT/TUNING MODE knob once again to cancel the signal strength display.
- Channels are displayed in alphanumeric order in the channel list, with numbers coming first. So, stations such as 6 Music from the BBC will be listed early in the list.
- If a channel is no longer broadcasting or the unit is moved out of the area of a broadcast channel, the unit will no longer be able to tune in the channel. If the channel cannot be tuned in a question mark (?) is displayed in front of the channel name. If you select this channel to tune in by pressing the SELECT/TUNING MODE knob, "No stations Available" is displayed.
- You can remove a channel that is no longer available from the channel list. See Tidy station, page 12.

Using Function Control 1

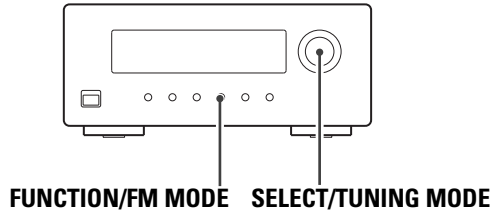

In DAB mode, use function control to set system options. There are 6 options in the function control.

- Station order
- Signal error rate
- Preset tune
- Software version
- DRC value
- Manual tune

Station order

Use station order to set the order in which stations are listed. There are four orders: Favourite, Alphanumeric, Active and Tidy.

1 While listening to a DAB broadcast press the **FUNCTION/FM MODE** button.

function/
FM mode



2 Turn the **SELECT/TUNING MODE** knob until "Station order" is displayed in the second line of the display.

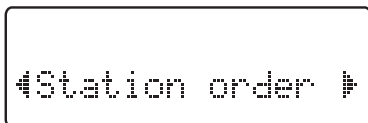

3 Press the **SELECT/TUNING MODE** knob.

The current option is displayed in the first line of the display.

4 Turn the **SELECT/TUNING MODE** knob until the desired option is displayed in the second line of the display.

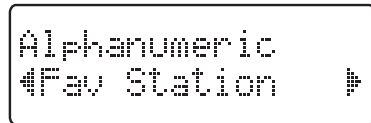

5 Press the **SELECT/TUNING MODE** knob.

Fav Station (Favourite station)

As you tune in stations and listen to them the unit will memorize the top ten stations you listen to and list them at the top of the channel list. A Favourite station in the channel list has "♥" displayed after the station name on the first line of the display.

Alphanumeric

This is the default order. Channels are listed by name with numbers first and then alphabetically by letters in the channel name.

Active station

This option will list active stations at the top of the channel list and channels that are in the list but have no service in your area to be listed last in the channel list.

Tidy station

This option will list active stations and remove any channels that are in the list but have no service in your area from the channel list.

♥ -> preset

This option takes your top ten Favourite channels and assigns them to preset numbers 1 – 10.

This option is only available after "Fav Station" option has been turned on. See above.

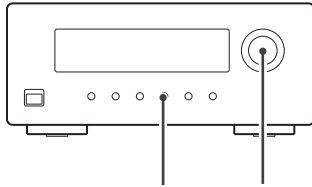

FUNCTION/FM MODE SELECT/TUNING MODE

Sig error rate (Signal error rate)

This option shows the digital bit error rate (0–99) of the currently tuned channel. This is for information only and no adjustment is available. The lower the figure the better the quality of the received broadcast.

- 1 While listening to a DAB broadcast press the **FUNCTION/FM MODE** button.

function/
FM mode



- 2 Turn the **SELECT/TUNING MODE** knob until “Sig error rate” is displayed in the second line of the display.

- 3 Press the **SELECT/TUNING MODE** knob.

The digital bit error rate of the current tuned channel is displayed.



Preset tune

Use this option to select the DAB preset station.

- 1 While listening to a DAB broadcast press the **FUNCTION/FM MODE** button.

function/
FM mode



- 2 Turn the **SELECT/TUNING MODE** knob until “Preset tune” is displayed in the second line of the display.

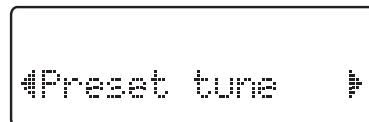

- 3 Press the **SELECT/TUNING MODE** knob.

The currently tuned station is displayed.

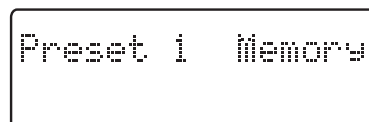

- 4 Turn the **SELECT/TUNING MODE** knob until the desired preset station is displayed.

- 5 Press the **SELECT/TUNING MODE** knob to select the preset station.

- If the station is not broadcasting, “Empty” is displayed.
- If the station is available, “Memory” is displayed.

Using Function Control 2

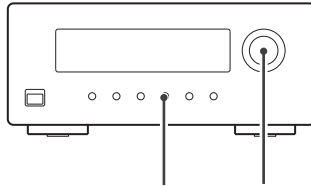

FUNCTION/FM MODE SELECT/TUNING MODE

Sw version (Software version)

This option shows the version number of the installed software. This is for information only and no adjustment is available.

- 1 While listening to a DAB broadcast press the FUNCTION/FM MODE button.

function/
FM mode



- 2 Turn the SELECT/TUNING MODE knob until "Sw version" is displayed in the second line of the display.

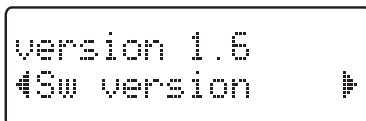

DRC value

This option sets the Dynamic Range Control (DRC) value to be applied to received broadcasts. DRC is used to reduce the range between high and low volumes of audio and is sometimes applied at the broadcast source. Pop music may have a high value of DRC applied, appropriate for constantly high listening levels, while classical music broadcasts may have no DRC applied to allow the listener to hear the full dynamic range of the source volume.

There are three values of DRC you can apply.

- 0 : None
- 1/2 : Medium
- 1 : Maximum

- 1 While listening to a DAB broadcast press the FUNCTION/FM MODE button.

function/
FM mode



- 2 Turn the SELECT/TUNING MODE knob until "DRC value" is displayed in the second line of the display.

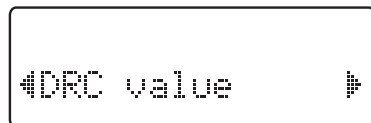

- 3 Press the SELECT/TUNING MODE knob.

- 4 Turn the SELECT/TUNING MODE knob until the desired level of DRC is displayed in the second line of the display.

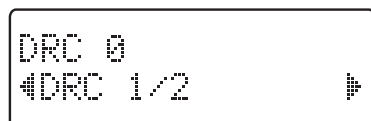

- 5 Press the SELECT/TUNING MODE knob.

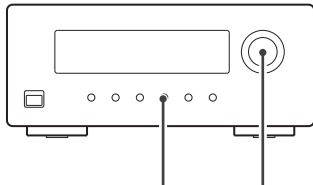

FUNCTION/FM MODE SELECT/TUNING MODE

Manual tune

This option allows you to manually tune in a channel and view a continuously updated display of the strength of the signal. This may be useful when adjusting or positioning an antenna for better reception.

- 1** While listening to a DAB broadcast press the **FUNCTION/FM MODE** button.

function/
FM mode



- 2** Turn the **SELECT/TUNING MODE** knob until "Manual tune" is displayed in the second line of the display.

- 3** Press the **SELECT/TUNING MODE** knob.

"Manual tune" is displayed on the first line of the display.

- 4** Turn the **SELECT/TUNING MODE** knob to scroll through the channel list.

- 5** Press the **SELECT/TUNING MODE** knob when the channel you wish to tune in is displayed in the second line of the display.

The signal strength indicator is displayed.

- 6** While viewing the indicator, adjust or reposition the antenna until the best reception is indicated.

- 7** Press the **SELECT/TUNING MODE** knob to cancel Manual tune and resume normal reception.

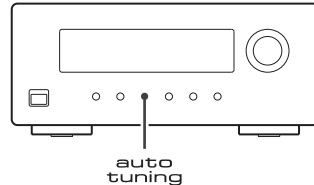

auto
tuning



If you move the unit to a new area or you want to check to see if there are new channels available in your area, you can scan to find new channels automatically.

- Press the AUTO TUNING button.**

The unit will scan for any new channels and add the channels found to the channel list.

- Press and hold the AUTO TUNING button for longer than 2 seconds to activate international search.

Changing Display Settings

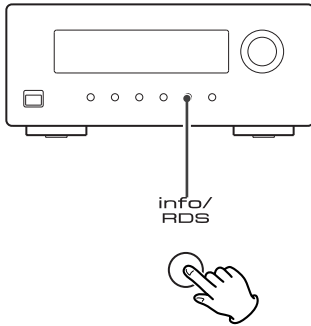

You can choose the type of information displayed in the second line of the display while listening to a DAB channel.

Each time the INFO/RDS button is pressed, the information is displayed as follows.

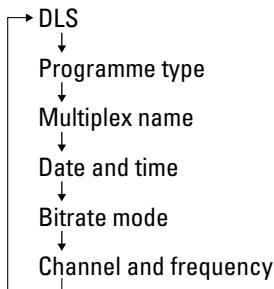

DLS

The Dynamic Label Segment (DLS) is the scrolling text label supplied by the radio station. It may be information on music titles or details regarding the programme or station.

```
BBC Radio 5 Live  
WEEKDAY NEWS & D
```

Programme type

This is a description of the type of broadcast supplied by the radio station such as Pop, Rock or Classical music.

```
BBC Radio 5 Live  
Drama
```

Multiplex name

This displays the name of the Multiplex that is broadcasting the programme.

```
BBC Radio 5 Live  
BBC National DAB
```

Date and time

This displays the current date and time, which is supplied by the radio station and should always be accurate.

```
BBC Radio 5 Live  
01:01 15-07-2003
```

Bitrate mode

This displays the bitrate of the current playing broadcast.

```
BBC Radio 5 Live  
192Kbps STEREO
```

Channel and frequency

This displays the channel and frequency of the current playing broadcast.

```
BBC Radio 5 Live  
11C 220.35MHz
```

Listening to FM/AM

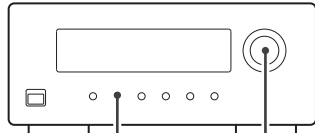

BAND **SELECT/TUNING MODE**

1 Select AM or FM by pressing the BAND button.

band



2 Select the desired tuning mode by pressing the SELECT/TUNING MODE knob.

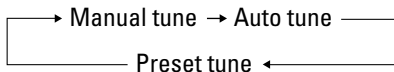

3 Select the station you want to listen to. (Follow the instructions on the right in A through C.)

- "STEREO" is displayed when a stereo broadcast is tuned in.

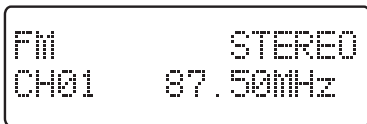

A Manual tuning mode

Turn the SELECT/TUNING MODE knob repeatedly until the station you want to listen to is found.

The frequency changes by a fixed step.

FM: 50 kHz steps / AM: 9 kHz steps

B Auto tuning mode

Turn the SELECT/TUNING MODE knob slightly to begin auto tuning.

When a station is found, the tuning process stops automatically.

Turn the SELECT/TUNING MODE knob again to stop the auto tuning.

C Preset tuning mode

Press a preset number on the remote control unit.

To select a station with a one-digit preset number press 0 then the number. For example, if you want to tune in preset number 2, press 0 then 2.

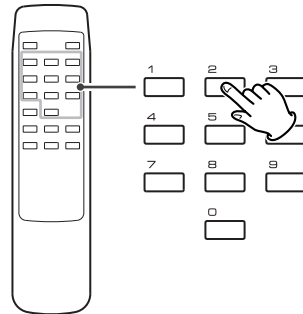

Preset stations can also be selected by the SELECT/TUNING MODE knob. Turn the SELECT/TUNING MODE knob repeatedly until the desired preset station is found.

FUNCTION/FM MODE Button

Pressing this button switches between Stereo mode and Mono mode.

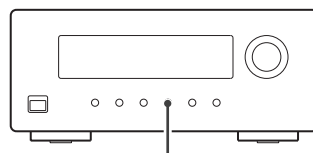

function/
FM mode



Stereo

FM stereo broadcasts are received in stereo and the STEREO appears on the display.

Mono

To compensate for weak FM stereo reception, select this mode. Reception will now be monaural, reducing unwanted noise.

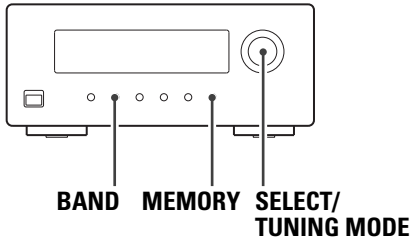

Preset Manually (FM/AM/DAB)

You can store FM and AM stations from Channel 1 to 30 respectively.

1 Select DAB, AM or FM by pressing the **BAND** button.



2 Tune in a station.

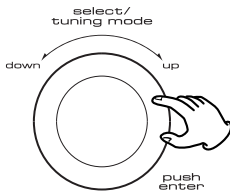

3 Press the **MEMORY** button briefly.

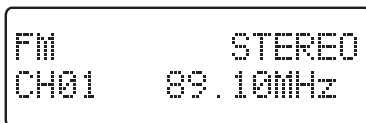

4 Select a preset channel to store the station by turning the **SELECT/TUNING MODE** knob.

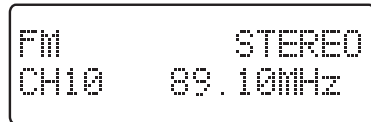
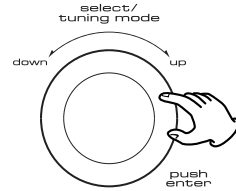

● Preset channels can also be selected by the numeric buttons on the remote control unit.

5 Within 4 seconds, press the **MEMORY** button.



● If you don't press the memory button within 4 seconds after selecting the channel:
With DAB: the station will be automatically stored.
With FM/AM: the selection will be canceled.

To store more stations, repeat steps **1** to **5**.

Preset Auto (FM/AM)

1 Select AM or FM by pressing the **BAND** button.



2 Press the **MEMORY** button for more than 3 seconds.



Up to 30 of the best received stations in your area will be stored automatically.

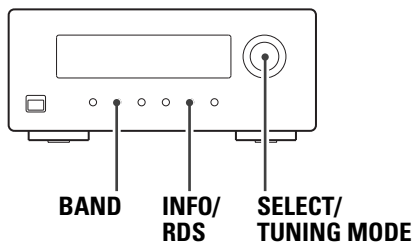

RDS is a broadcasting service which allows stations to send additional information along with the regular radio programme signal.

RDS works on the FM waveband only.

1 Select FM by pressing the BAND button.



2 Tune in a station.

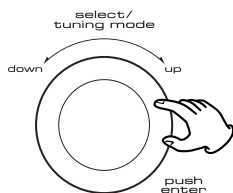

3 Every time the INFO/RDS button is pressed, the mode is changed as follows:



PROGRAM SERVICE

When you select PROGRAM SERVICE, "PROGRAM SERVICE" will blink for about 3 seconds and then the programme service name will be displayed. If there is no programme service name data, the frequency will be displayed.

RDS CLOCK TIME

When you select RDS CLOCK TIME, "RDS CLOCK TIME" will blink for about 3 seconds and then the time provided from the station will be displayed. If there is no time data, "NO CT" will be displayed.

RDS PROGRAM TYPE

When you select RDS PROGRAM TYPE, "RDS PROGRAM TYPE" will blink for about 3 seconds and then the programme type will be displayed.

RDS RADIO TEXT

When you select RDS RADIO TEXT, "RDS RADIO TEXT" will blink for about 3 seconds and then the news of stations composed of up to 64 alphanumeric characters will be displayed. If there is no RDS RADIO TEXT data, RDS mode will be automatically switched to PROGRAM SERVICE mode.

TRAFFIC ANNOUNCE

When you select TRAFFIC ANNOUNCE, "TRAFFIC ANNOUNCE" will blink for about 3 seconds and then the the unit searches for a traffic programme.

- When a traffic programme is found, the TRAFFIC ANNOUNCE mode is switched to PROGRAM SERVICE mode.
- In the case the station currently selected is transmitting a traffic program signal, the PROGRAM SERVICE mode is switched to without searching for a traffic program.

PTY Search

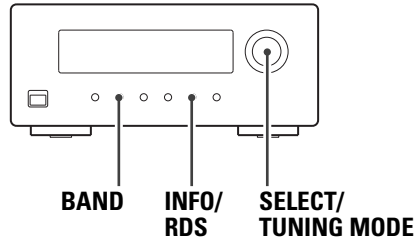

You can search for stations by programme type.

1 Select FM by pressing the **BAND** button.



2 Press the **INFO/RDS** button for more than 3 second.



3 Select the desired **PTY** programme type by turning the **SELECT/TUNING MODE** knob.

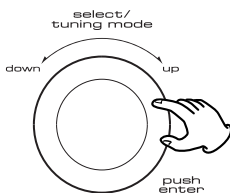

Select your desired one from among 31 kinds of **PTY** programmes. The programme type will blink.

4 Press the **SELECT/TUNING MODE** knob.

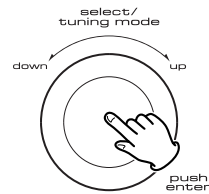

The programme type stops blinking.

5 Turn the **SELECT/TUNING MODE** knob.

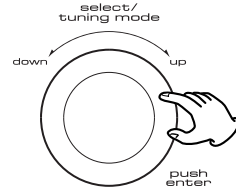

Search starts.

- When the programme that you have selected is found, searching stops and the programme type will be displayed.
- If the same programme type is not found during **PTY** Search, it will stop at the beginning frequency.
- If you want to stop searching, press the **INFO/RDS** button.

PTY Programmes

- News : brief announcements, events, public opinion, reports, actual situations.
- Current Affairs : a kind of suggestion including practical announcements other than news, documents, discussion, analysis and so on.
- Information : daily information or reference such as weather forecast, consumer guide, medical assistance and so on.
- Sport : sports related programs.
- Education : educational and cultural information.
- Drama : all kinds of radio concert and serial drama.
- Cultures : all aspects of national or local culture including religious events, philosophy, social science, language, theatre, and so on.
- Science : programmes on natural science and technology
- Varied Speech : popular programmes such as quiz, entertainment, private interview, comedy, satire and so on.
- Pop Music : programme on commercial, practical and popular songs, and sale volume of discs, etc.
- Rock Music : practical modern music generally composed and played by young musicians.
- Easy Listening : popular music usually lasting for less than 5 minutes.
- Light Classics M : classical music, instrumental music, chorus, and light music favored by non-professionals.
- Serious Classical: orchestra including great operas, symphony, chamber music and so on.
- Other Music : other music styles (Rhythm & Blues, Reggae, etc.)
- Weather & Metr : weather reports, forecast
- Finance : financial reports, commerce, trading
- Children's Progs : children's programmes
- Social Affairs : social affairs
- Religion : religious programmes
- Phone In : programme in which the public expresses its view by phone.
- Travel & Touring : travel reports
- Leisure & Hobby : programmes concerning recreational activities
- Jazz Music : jazz music
- Country Music : country music
- National Music : national music
- Oldies Music : music from the so-called golden of popular music
- Folk Music : folk music
- Documentary : documentaries
- Alarm Test
- Alarm-Alarm ! : a programme notifying an emergency or a natural disaster.

Factory Reset

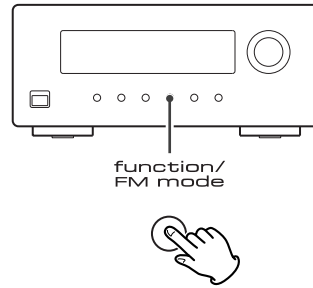

To clear the station list/memory

To clear the station list and memory, it is possible to operate a factory reset function. To do this hold down the FUNCTION/FM MODE button for a period longer than 4 seconds, "Factory reset..." appears on the display.

Sleep Timer

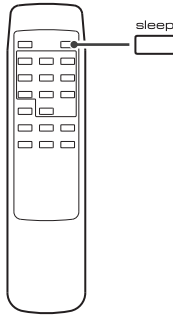

The power can be switched off (standby mode) at the desired time.

Press the SLEEP button in the on mode. "SLEEP 90" is shown on the display. The sleep time can be changed in 10-minute steps. Press the SLEEP button repeatedly until the desired time appears.

SLEEP 90: The power switches off in 90 minutes.

SLEEP 80, SLEEP 70 ... SLEEP 10

(off): Sleep timer is off.

- You can check the remaining time by pressing the SLEEP button once.
- To change the preset sleep timer, press the SLEEP button again while the remaining sleep timer is shown. The display will show the next sleep time.
- To deactivate the sleep timer, press the SLEEP button repeatedly until "SLEEP" disappears.

Specifications

FM Tuner

Tuning range 87.50 – 108.00 MHz (50 kHz steps)

Signal-to-Noise ratio 65 dB (Mono)
60 dB (Stereo)

AM Tuner

Tuning range 522 – 1620 kHz (9 kHz steps)

Signal-to-Noise ratio 35 dB

DAB Tuner

Tuning range Band 3, 174 MHz – 240 MHz

Input 50 ohms, nominal

Max signal –3 dBm typ

Sensitivity –96 dBm typ

Adjacent Channel Rejection 35 dB typ

Digital output 24 bit/48 kHz resolution

Audio output Stereo, 2.5 Vp-p

General

Power requirements 230 V AC, 50Hz

Power consumption 9 W (STANDBY: 3 W)

Dimensions (W x H x D) 215 x 85 x 270 mm

Weight 2.4 kg

Operating temperature 0 °C – 50 °C

Accessories:

AM loop antenna x 1

FM antenna x 1

DAB antenna x 1

RCA pin cable x 1

Remote control unit x 1

Batteries (AAA, R03, UM-4) x 2

- Design and specifications are subject to change without notice.
- Illustrations may differ slightly from production models.

In case of any trouble with this unit, please take the time to look through this chart and see if you can solve the problem yourself before you call your dealer or a TEAC service center.

General

No sound.

- Check the connection to the AC wall outlet.
- Check the connection to the amplifier.
- Check that speakers are connected to the amplifier.
- Ensure that T-H300DAB and connected amplifier are turned on.

Cannot listen to any station, or signal is too weak.

- Tune in the station properly.
- If a TV is near the unit, turn it off.
- Install the antenna again after locating the best reception position.
- An external antenna may be required.

Noise is excessive.

- Poor location and/or direction of the antenna.
- Transmitting station is too far away.

Excessive distortion in the sound of stereo broadcasts.

- Check the speaker system connections.

Though the FM broadcast is stereo, it sounds monaural.

- Press the FUNCTION/FM MODE button.

Remote control doesn't work.

- Press the POWER switch of the main unit to turn it to standby.
- If the batteries are dead, change the batteries.
- Use the remote control within a 5-m range and point it at the front panel.
- Clear obstacles between the remote control unit and the main unit.
- If a strong light is near the unit, turn it off.

All the preset stations are erased.

- If the power supply is interrupted for 15 days or longer, the setting kept in memory (such as preset stations) are erased. When this happens, the internal battery that is used to retain settings in memory is exhausted and must be recharged by having the unit connected to power for at least 3 days.

DAB tuner

No sound.

- Ensure that the T-H300DAB has been able to locate DAB stations.

"NO stations Available" appears on the display.

- Check that antenna is connected.
- Ensure that DAB coverage exists in your area.

Cannot access secondary services.

- At the time of publishing not many secondary services are available, this will increase as more DAB stations start broadcasting. If a secondary service station is available, the secondary indicator >> will be displayed next to the station name.

Display goes out or displayed "service off air".

- This may occur if a broadcaster changes the label of a service or removes a label whilst you are listening to it. The T-H300DAB will try to retune to this station, or alternatively follow the procedure for auto tune on page 15.

Cannot listen to the selected station.

- Ensure you have pressed the SELECT/TUNING MODE knob when you want to listen to your selection. The station you are currently listening to will be displayed on the first line of the display, as you scroll through the station order list the second line will show other station options. Press the SELECT/TUNING MODE knob to activate your selection.

A burbling sound is heard on some stations.

- DAB like other digital media is good at producing quality audio from a low level signal, however if this signal level is too low a 'burbling' sound can sometimes be heard. To reduce this, try repositioning your antenna to gain maximum signal strength.

If normal operation cannot be recovered, unplug the power cord from the outlet and plug it in again. This resets the internal micro-computer which can be disturbed during electrical storms, power interruptions, et cetera.

TEAC

TEAC CORPORATION	3-7-3, Nakacho, Musashino-shi, Tokyo 180-8550, Japan Phone: (0422) 52-5081
TEAC AMERICA, INC.	7733 Telegraph Road, Montebello, California 90640 Phone: (323) 726-0303
TEAC CANADA LTD.	5939 Wallace Street, Mississauga, Ontario L4Z 1Z8, Canada Phone: (905) 890-8008
TEAC MEXICO, S.A. De C.V	Campesinos N°184, Colonia Granjas Esmeralda, Delegacion Iztapalapa, CP 09810 México DF Phone: (525) 581-5500
TEAC UK LIMITED	5 Marlin House, Croxley Business Park, Watford, Hertfordshire, WD18 8TE, U.K. Phone: 01923-819699
TEAC DEUTSCHLAND GmbH	Bahnstrasse 12, 65205 Wiesbaden-Erbenheim, Germany Phone: 0611-71580
TEAC FRANCE S.A.	17, Rue Alexis-de-Tocqueville, CE 005 92182 Antony Cedex, France Phone: (1) 42.37.01.02
TEAC ITALIANA S.p.A.	Via C. Cantù 11, 20092 Cinisello Balsamo, Milano, Italy Phone: 02-66010500
TEAC AUSTRALIA PTY., LTD.	280 William Street, Melbourne, Victoria 3000, Australia Phone: (03) 9672-2400 A.B.N. 80 005 408 462

This appliance has a serial number located on the rear panel. Please record the model number and serial number and retain them for your records.

Model number

Serial number

0603·MA-0819A

Free Manuals Download Website

<http://myh66.com>

<http://usermanuals.us>

<http://www.somanuals.com>

<http://www.4manuals.cc>

<http://www.manual-lib.com>

<http://www.404manual.com>

<http://www.luxmanual.com>

<http://aubethermostatmanual.com>

Golf course search by state

<http://golfingnear.com>

Email search by domain

<http://emailbydomain.com>

Auto manuals search

<http://auto.somanuals.com>

TV manuals search

<http://tv.somanuals.com>