

### The disc menu language is not the correct one.

- The disc menu language has not been set up.
- The language of your choice is not available on the disc.

### You have forgotten your password (Parental control).

- Open the disc tray, press **CLEAR** and then enter 00001 with the numeric buttons. Turn off the player and then turn it on again.

### Precautions

#### Use

- If your appliance has been stored in a cool place for any length of time, during a journey for example, wait for about 2 hours before using it.
- The openings located on the top and bottom are for ventilation and must not be obstructed.
- During thunderstorms, we recommend that you isolate the appliance from the electrical supply so that it is not damaged by electrical or electromagnetic surges.
- This appliance is designed for continuous use. Switching off the DVD player to stand-by mode does not disconnect it from the mains supply. To completely isolate the equipment, remove the plug from the mains socket as some components remain connected to the electrical supply.
- If you notice any burning or smoke, disconnect the appliance immediately to avoid any risk of electrocution.
- Do not attempt to look inside the appliance through the disk tray opening or any other opening. You may be electrocuted or exposed to laser radiation.
- This appliance is for domestic use only and must not be used for industrial purposes.
- Total or partial copying of recordings protected by copyright legislation, without the explicit permission of the holder of the rights, contravenes current legislation. Copying or downloading music files for sale or any other business purpose constitutes or could constitute a violation of copyright law.

#### Cleaning

- Use a soft, dry, clean cloth. Regularly dust the vents at the back or sides.
- Using solvents, abrasive or alcohol-based products risks damaging the appliance.
- If an object or liquid enters inside the appliance, unplug it immediately and have it checked by an authorised engineer.

#### Handling and caring for discs

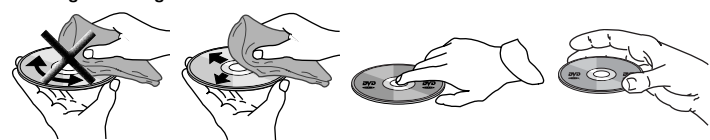

- Handle your discs with care. Hold the disc with your fingers at the edges or through the hole.
- Insert the disc with the label facing up (for a single-sided disc).
- Place the disc properly into the tray in the allotted holder.
- Use a soft cloth to clean discs if necessary, always wiping from the centre to the edge.
- Always put discs back in their cases after use and store in a vertical position.
- Do not close the tray with two discs in it or with a disc not sitting correctly in the holder.
- Do not play cracked, chipped or warped discs nor try to repair them with adhesive tape or glue.
- Do not write on a disc.
- Do not move the player when a disc is being played.
- Do not scratch discs or store them in places exposed to direct sunlight, high humidity or high temperatures.
- Do not use aerosol cleaners, benzene, anti-static liquids or any other solvent for cleaning discs. When cleaning, wipe gently with a soft damp (water only) cloth from the centre to the edge, avoiding circular motions, which could cause scratches and interference during playback.

#### Guarantee

- The type and production number of your appliance are printed on the guarantee certificate supplied with your appliance. Keep this certificate as well as the invoice. These documents are required in the event of claiming your guarantee rights.
- All repairs during the guarantee period must be carried out by an authorised engineer for our brand. If this condition is not met, your rights will no longer be valid.
- Never open the appliance yourself, since this may put you at risk or damage the equipment. THOMSON does not accept any liability if the appliance is used in any way other than in accordance with this manual.

DISCLAIMER OF WARRANTIES: TO THE MAXIMUM EXTENT PERMITTED BY APPLICABLE LAW, DECLARATIONS AND WARRANTIES OF NON-INFRINGEMENT OF COPYRIGHT OR OTHER INTELLECTUAL PROPERTY RIGHTS RESULTING FROM THE USE OF THE PRODUCT IN CONDITIONS OTHER THAN THOSE SPECIFIED ABOVE ARE HEREBY DISCLAIMED.

#### Discs you can play

In spite of progress made to ensure playability of all discs types, it is not possible to guarantee playback of discs which are not in conformity with DVD, CD, VCD or SVCD standards. This unit may not play some recordings or files on CD-R, CD-RW, DVD-R, DVD-RW, DVD+R, DVD+RW due to differences in recording formats, software used and disc types.

**DVD-Video**  
Digital video discs - 12 cm and 8 cm, single or double sided, single or dual layer. DVDs are high-density optical discs on which high quality picture and audio are recorded by means of digital signals.

**DVD-R, DVD-RW, DVD+R, DVD+RW**  
Most DVD-R and DVD+R (one recording only), DVD-RW and DVD+RW discs (rewritable). Depending on the DVD writer and discs used. Recordings using DVD-R and DVD-RW discs must be made in Video DVD mode. Recordings using DVD+RW discs must be made in accordance with the specifications for DVD+RW discs with a 4.7 GB capacity.

**VCD - Video Compact Disc**  
CD on which you can record up to 74 min. of VHS-quality video associated with still images, audio tracks and interactive menus.

**SVCD - Super Video Compact Disc**  
Most SVCDs comply with the IEC62107 standard. SVCDs can be used to record up to 70 minutes of digital sound and images in accordance with MPEG-2 standards for video and MPEG-1 standards for audio.

**Audio CDs**  
Audio CDs (8 and 12 cm).



#### CD-R, CD-RW

Most CD-R (one recording only) and CD-RW discs (rewritable). This player can play most CD-R discs. CD-Rs written during a multisession recording can also be played, provided that the session has ended before the disc is played (depending on the write software). However, depending on the condition of the CD-writer, computer and the disc used, you may find that not all discs will play successfully. When playing a CD-R disc, it is completely normal for the unit to take up to 20 seconds to recognise the disc before starting to play. If the disc is not recognised after a period of 20 seconds, remove the disc, and then insert it again.

- Irrespective of the actual recording capacity of the CD-R, do not use its full capacity.
- CD-Rs should be preferably used instead of CD-RWs (rewritable CDs) as, in certain cases, CD-RW playback may be faulty.
- Use reliable, good-quality CD write software.
- Close all other applications on the computer to ensure reliable CD-R disc recording.



#### DivX files

DivX is the name of a revolutionary new video codec which is based on the new MPEG-4 compression standard for video. Whether DivX files play correctly on your player or not depends on the preparation and production of the audio and video files, the codecs and the type of recording equipment used, as well as on your computer's parameters. It is therefore possible that you cannot play a DivX file or that part or all of it is defective. It also sometimes happens that you can play the images (video) but not the sound (audio). DivX disc compatibility with this player is limited as follows: • The maximum resolution of the DivX file is below 720x576 (W x H) pixels. • DivX filenames should not exceed 56 characters. • If the video and audio structure of the recorded file is not interleaved, either video or audio is outputted. • If the file is recorded with GMC, the unit supports only 1-point GMC. GMC is the acronym for Global Motion Compensation. It is an encoding tool specified in the MPEG4 standard. Some MPEG4 encoders, like DivX or XviD, have this option. There are different levels of GMC encoding, usually called 1-point, 2-point, or 3-point GMC. • DivX files with subtitles in .SRT, .SUB and .SMI formats can be played. Correct playback of all languages may not be possible as some characters may be missing.



#### mp3 files

CD-R and CD-RW discs containing audio files in mp3 format. With regard to CD-R mp3 discs, please follow all the recommendations for CD-R above, along with the comments below: • Your mp3 files should be ISO 9660 or JOLIET format. ISO 9660 format and Joliet mp3 files are compatible with Microsoft DOS and Windows, as well as with Apple Mac. These two formats are the most widely used. • mp3 filenames should not exceed 8 characters and should end with the ".mp3" extension. General name format: Title.mp3. When composing your title ensure that you use 8 characters or less, have no spaces in the name, and avoid the use of special characters including (., /, \, =, +). • The total number of files on a disc should be less than 999. The total number of folders should be less than 499. • Use a decompression transfer rate of at least 128 kB/sec (kilobytes/second) when recording mp3 files. Sound quality with mp3 files basically depends on the rate of compression/ decompression you choose. Obtaining audio CD quality sound requires an analogue/digital sampling rate, that is conversion to mp3 format, of at least 128 kB/sec and up to 160 kB/sec. Choosing higher rates, such as 192 kB/sec or more, only rarely produces even better sound quality. Conversely, files with sampling rates below 128 kB/sec will not play properly. • Do not try recording copyright-protected mp3 files. "Securized" files are encrypted and code-protected to prevent illegal copying. You must not copy such files.



#### WMA (Windows Media Audio) files

CD-R with WMA files. • WMA filenames should not exceed 8 characters, and should end with the ".wma" extension. General name format: Title.wma. When composing your title ensure that you use 8 characters or less, have no spaces in the name, and avoid the use of special characters including (., /, \, =, +). • The total number of files on a disc should be less than 999. *Important: The above recommendations cannot be taken as a guarantee that the DVD player will play mp3 or WMA recordings, or as an assurance of sound quality. You should note that certain technologies and methods for mp3 file recording on CD-Rs prevent optimal playback of these files on your DVD player (i.e. degraded sound quality and even, in some cases, inability of the player to read the file).*



#### JPEG files

• CD-R and CD-RW with JPEG files. Certain JPEG files, including progressive JPEG files, cannot be read by this player.



#### Kodak Picture CDs

#### Technical data

Power requirements: AC 230V, 50 Hz - Power consumption: 15W - Operating temperature: 5°C to 35°C (41°F to 95°F) - Operating humidity: 5% to 90% (no condensation)

#### DVD copy protection

In accordance with the DVD standard, your DVD player is equipped with a Copy Protection system, which can be switched on and off by the DVD disc itself, in order to make any recording of the relevant DVD disc onto a videotape of very poor picture quality, or even impossible. This product incorporates copyright protection technology that is protected by method claims of certain U.S. patents and other intellectual property rights owned by Macrovision Corporation and other rights owners. Use of this copyright protection technology must be authorized by Macrovision Corporation, and is intended for home use only unless otherwise authorized by Macrovision Corporation. Reverse engineering or disassembly is prohibited.

#### Note on DivX files

Before playing DivX or mpeg4 files, please be sure of their origin and that you have legally purchased or rented the contents. Pirate copying is illegal and may result in sanctions. Private copies of your own material for your own use may be legal in some countries. Make sure you are aware of any applicable laws.

#### THOMSON Multimedia Sales Europe

46, quai A. Le Gallo

92648 Boulogne Cedex

FRANCE

322 019 464 RCS NANTERRE

<http://www.thomson-europe.com>

35888990 © Copyright THOMSON 2005

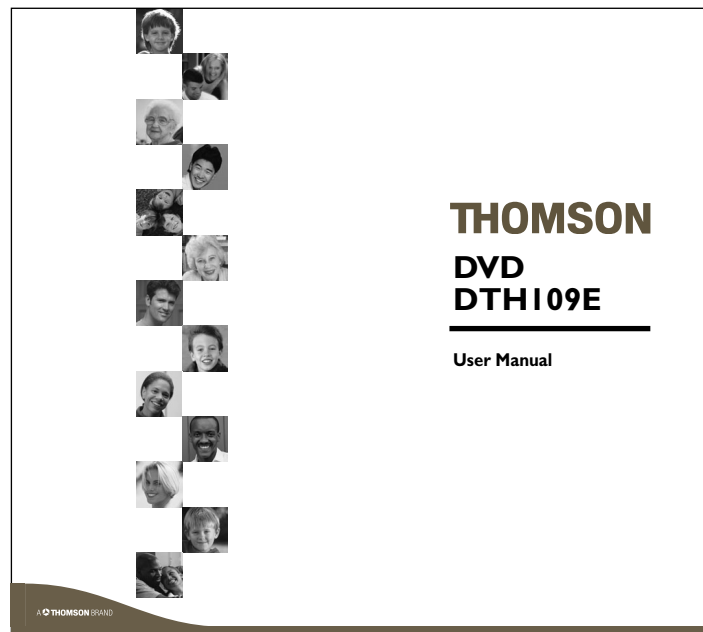

### Connections and Setup

#### Some points to check before you connect your TV set

- Ensure that the mains supply in your house complies with that indicated on the identification sticker located on the back of your appliance.
- Install your appliance horizontally, away from any source of heat (fireplace) or appliances generating strong magnetic or electric fields. The components of this appliance are sensitive to heat. The maximum ambient temperature should not exceed 35° Celsius.
- Leave sufficient space around the appliance to allow adequate ventilation: 10 cm on either side and at the back, as well as 7 cm above it are ideal.
- The humidity of the room should not exceed 75%. If you have to use the appliance outdoors, do not expose it to rain or splashing water. The appliance should not be exposed to dripping or splashing and no objects filled with liquids, such as vases, should be placed on top of it.
- Moving it from a cold environment to a warm one is likely to cause condensation on some components inside the appliance. Let the condensation disappear of its own accord before turning the appliance on again.
- Before moving the player, make sure the disc tray is empty.

#### The remote control

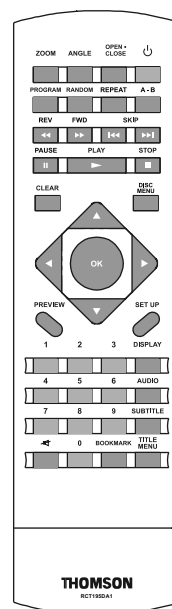

- ZOOM** To access the Zoom function.
- ANGLE** To access the Camera angle function.
- OPEN-CLOSE** To open and close the disc tray.
- PROGRAM** To switch the appliance on and off.
- RANDOM** To access the Program menu.
- REPEAT** To access the Repeat playback function.
- A-B** To access the A-B repeat playback function.
- REV** To start reverse accelerated play and reverse slow motion.
- FWD** To start forward accelerated play and forward slow motion.
- SKIP** To start a reverse or forward search for a chapter or track.
- PAUSE** To activate freeze frame, frame advance, slow motion.
- PLAY** To start playing a disc.
- STOP** To stop play.
- CLEAR** To clear entered items in a menu.
- DISC MENU** To call the disc menu (if there is one). To access the PBC menu.
- <>>>** To navigate through the menus.
- OK** To confirm a selection.
- PREVIEW** To access the Digest or the Introscan function.
- SET UP** To access the player's menu.
- 0 - 9** Number entry.
- DISPLAY** To display the Status menu.
- AUDIO** To change the dialogue language or audio format.
- SUBTITLE** To select a subtitle language and turn the subtitle menu on and off.
- MUTE** To mute and restore the sound.
- BOOKMARK** To access the Bookmark function.
- TITLE MENU** To access the title menu of the disc (if there is one). To turn the PBC function on and off.

#### Inserting batteries in the remote control

Insert two LR06 or AA batteries in the remote control.

- Do not mix different types of batteries or new and old batteries. Do not use rechargeable batteries.
- In order to avoid any risk of explosion, observe the polarities indicated inside the battery compartment. Replace only with the type of batteries specified above. Do not dispose of them in a fire or recharge them.
- If you are not using the remote control for a long period of time, remove the batteries.

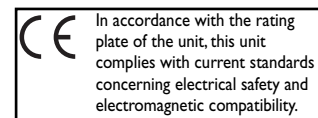

EN CAUTION - LASER RADIATION WHEN OPEN. DO NOT STARE INTO BEAM.



CLASS I LASER PRODUCT

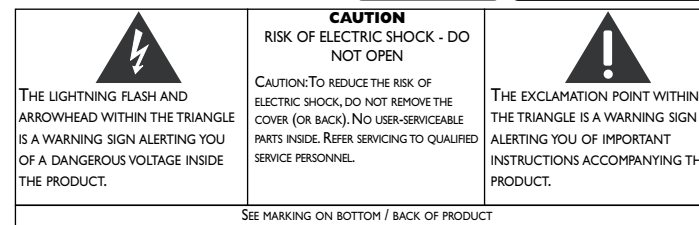

SEE MARKING ON BOTTOM / BACK OF PRODUCT

#### HELPLINE THOMSON

You can contact THOMSON by dialling: 0871 712 1312 (for United Kingdom, £0.10/min inc VAT)

[www.thomson-europe.com](http://www.thomson-europe.com)

Please respect the environment and prevailing regulations. Before you dispose of batteries or accumulators, ask your dealer whether they are subject to special recycling and if they will accept them for disposal.

#### Front panel controls

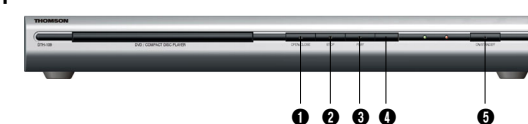

- 1 OPEN/CLOSE** - To open and close the disc tray.
- 2 STOP** - To stop disc playback.
- 3 PLAY** - To start playing a disc.
- 4 SENSOR** - Remote sensor. Point the remote control here.
- 5 ON/STANDBY** - To switch the appliance on and off.

#### Basic connections (DVD player + TV + video recorder)

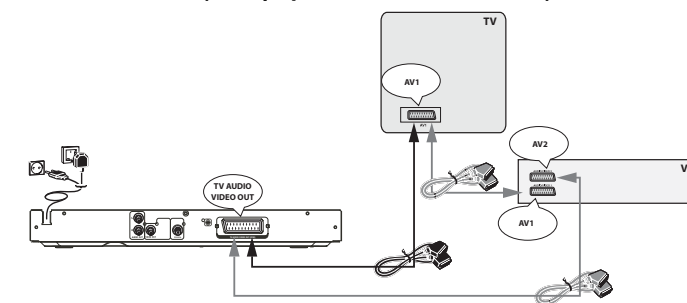

1. Connect the DVD player Scart socket (TV AUDIO VIDEO OUT) to the television set's Scart socket (AV1, EXT1, AUX1) using a Scart lead (not provided).

- OR -

1. If your television set does not have two Scart sockets, connect the DVD player to the video recorder's AV2 socket using a Scart lead (not provided). If you have a satellite or cable receiver you can also connect the DVD player to the receiver's second Scart socket.

Note: If your video recorder only has one Scart socket, but has a modulator, use the aerial cable to connect the video recorder to the television set, adjust the video recorder's modulator, then connect the DVD player to the video recorder's Scart socket.

2. Connect the video recorder (or satellite receiver) to the television set as shown in the video recorder's (or satellite receiver's) user guide.

3. Connect the DVD player to the mains socket using the mains lead.

4. Switch on the devices.

Note: If one of the devices is not working, check that all the cables have been inserted properly into the sockets which they should be connected to.

#### Other connection options

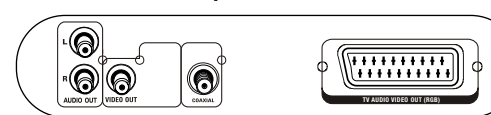

Video cable (yellow) VIDEO OUT socket

#### VIDEO OUT socket

This socket (yellow) is also known as a composite video socket. The video cable (not supplied) usually comes with two audio cables (white and red). The picture quality obtained using a video connection is poorer compared to that obtained using a Scart connection.





## Free Manuals Download Website

<http://myh66.com>

<http://usermanuals.us>

<http://www.somanuals.com>

<http://www.4manuals.cc>

<http://www.manual-lib.com>

<http://www.404manual.com>

<http://www.luxmanual.com>

<http://aubethermostatmanual.com>

Golf course search by state

<http://golfingnear.com>

Email search by domain

<http://emailbydomain.com>

Auto manuals search

<http://auto.somanuals.com>

TV manuals search

<http://tv.somanuals.com>