

# PDS-ST410A-VP Manual

## 1. Key features

Color / Monochrome (Mono) scan selection  
600/300 dpi scan selection  
Directly save JPG file to microSD card  
Supports microSD/microSDHC card up to 32GB  
Driver free to download for Windows® XP, Windows® Vista™, Windows® 7 and Mac OS® 10.4 or above (direct plug-in, driver installation not required)

## 2. Functional parts

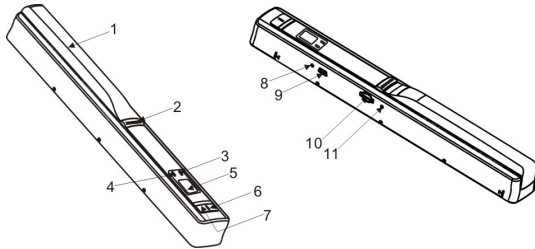

Part	Function
1	Battery door For 2x AA alkaline batteries
2	Power/Scan Power On/ Off: Press and hold this key for 2 seconds to turn power on or off. In power on mode, press this button to start scan, press this button again to stop
3	Error LED indicator Over speed: Red LED on
4	Scan LED indicator Ready for scan: Green LED on
5	LCD screen Scanning status display
6	Resolution Select High(600dpi)/Low(300dpi) resolution; High/Low resolution mode icon will be displayed on status LCD
7	C/BW Select Color/Mono scan. Color/Mono mode icon will be displayed on status LCD
8	Time set Press this button to enter Time and Date setting mode
9	USB interface Download photo to a computer via USB cable provided.
10	microSD card slot microSD card storage location.
11	Format button Press this button with a thin, blunt object, such as the end of a paperclip to format the microSD card.

## 3. Explanation of the status icons



Item	Function	Description
1	SD card indicator	Photos will be stored in microSD card
2	Battery indicator	Battery is full Empty battery
3	Effect indicator	Color or Mono
4	Counting indicator	Show scanned files in microSD card
5	Selected resolution	High:600 dpi / Low:300 dpi

## 4. LED light indications

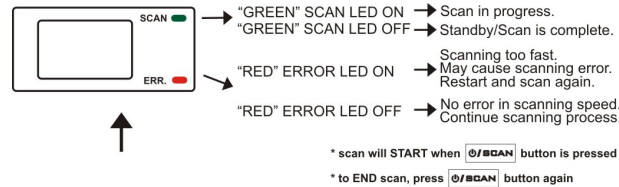

## 5. Using the scanner

### 5.1 Installing the battery

- Open the battery door by sliding the battery compartment downwards as indicated by the arrow in the diagram below.
- Insert 2x AA alkaline batteries into the battery compartment.
- Turn on the scanner by pressing the [POWER] button for 2 seconds.

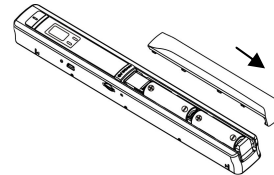

### 5.2 Inserting a microSD memory card (not included)

To operate the scanner, you must insert a microSD Card (not supplied) to record and store your pictures. Inserting the microSD memory card:

- Turn OFF the scanner.
  - Insert the microSD card into the microSD card slot (with metal side facing up). Gently press in until card is clicked in and latched. The SD card indicator must appear on the LCD screen.
- Note:** - Do not force the card into the slot; forcing may damage the scanner and the microSD memory card. Align microSD card position and try again.

### 5.3 Formatting the microSD memory card

**Note:** All content on the microSD card will be erased during formatting. It is recommended, but not necessary.

- Insert a microSD card into the scanner with metal side facing up.
- Turn on the scanner by pressing the [Power/Scan] button for 2 seconds.
- Press the [FORMAT] button with a thin, blunt object, such as the end of a paperclip to access the button. An "F" will show on the LCD status display screen.
- Press the [SCAN] button once to begin formatting the microSD card.
- The microSD card indicator will blink until the formatting process is complete.

### 5.4 Time and Date setting

- Press [TIME SET] button once to enter time setting mode by using a thin, blunt object, such as the end of a paperclip to access the button. The LCD status display screen will show "1##" (step 1) for the year. "##" is a set of number that would be changed to correspond to the actual time/date setting. The numbers 1-5 in front of the "##" indicates each step in the settings.
- Press the [C/BW] or [DPI] button to select the current Year.
- Press [SCAN] button once to confirm setting.
- Repeat step 2 and 3 to continue the Time and Date setting process

Indicator	Setting
1##	Year
2##	Month
3##	Date
4##	Hour
5##	Minute

- After setting the Minute, "5##", press the [TIME SET] button again to complete the Time and Date setting.

### 5.5 Setting the resolution

Press the [DPI] button to select High/Low resolution. High/Low resolution icon will be displayed on status LCD.

### 5.6 Setting the scan mode

Press the [C/BW] button to select Color/Mono mode. Color/Mono icon will be displayed on status LCD.

## 5.7 How to scan

**NOTE:** To scan, make sure your scanner is not connected to the computer.

1. Turn on scanner by pressing the [Power/Scan] button for 2 seconds.
2. Hold the document firmly with one hand on a flat surface.
3. Place the scanner on the edge of the paper approximately 5/8 to 3/4 of an inch onto the page to ensure the whole document can be scanned. Make sure to keep the scanning area in between the scanning width indicators marked on the side of the scanner.

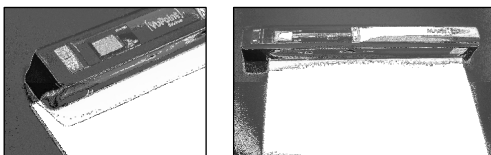

4. Hold the scanner flat against the material and then press the [SCAN] button once.



5. Slide the scanner slowly, keeping your hand stable to get the best quality picture.
6. Press the [SCAN] button again to stop scanning.

## 6. Viewing your scans

1. Connect your scanner to your computer and then turn on your scanner.
2. Your computer should recognize the scanner as a "Removable Disk."

Click "Open folder to view files" to view and import scans.

**Note:** If the Removable Device Window did not launch automatically, go to your "My Computer" and find the device under Removable Storage.

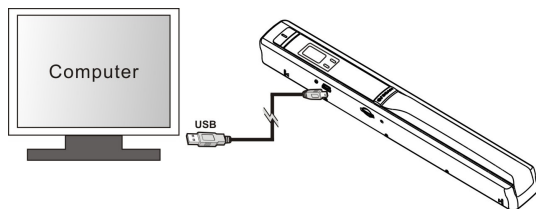

## 7. Specifications

Image sensor	Color Contact Image Sensor	
Number of sensor	5136 dots(1st~5104 dots available)	
Resolution	Low resolution : 300dpi(default) High resolution: 600dpi	
Maximum scanning speed for Letter size document	Color High resolution Mono High resolution Color Low resolution Mono Low resolution	13 Seconds 6.0 Seconds 3.0 Seconds 2.0 Seconds
Capacity (Based on 1GB microSD card. Scan Letter size file, the quantity of scans vary depending on the content complexity)	600dpi color	220 Photos(Min.)
	600dpi mono	290 Photos(Min.)
	300dpi color	780 Photos(Min.)
	300dpi mono	1280 Photos(Min.)
Scan width	8.27"	
Scan length	300dpi: 50"(Max), 600dpi: 25"(Max)	
File format	JPEG	
LCD	Scanning status display	
Auto Power Off	3 Minutes	
USB Port	USB 2.0 high speed	
External memory	microSD/microSDHC Card	
Standard Battery	2XAA alkaline batteries	

## 8. Computer system minimum requirement

Operating System	Windows® XP, Windows® Vista™, Windows® 7 and Mac OS® 10.4 or above (direct plug-in, driver installation not required)
CPU	Pentium II or above
RAM	64MB
Interface	USB port

## 9. Troubleshooting

Problem	Cause	Solution
Cannot turn on the scanner	1. Low battery power. 2. Battery not inserted properly	Replace or install the battery correctly

Pictures cannot be saved when you are scanning them	1. microSD card has not been installed 2. Memory is full 3. The microSD card has not been formatted properly	1. Install microSD card 2. Download the pictures from the scanner to the computer to create storage space 3. Reformat your microSD card. Please refer to section 5.3
Computer does not recognize your scanner when connected. (You cannot find removable disk)	Connection failure.	Make sure all cable connections are secured. Restart the computer if necessary
The battery life is very short	Use wrong type of battery	Replace with new 2x AA alkaline batteries
Blurry images	The lens of scanner is dirty	Clean the lens with soft dry cloth
ERR. LED is on when scanning a document	Scanning speed is too fast	Press the Power/Scan button to reset your scan. Scan the document again.

## 10. ABBYY® OCR Software

(Optional, not required to install to operate scanner)

Compatible with Windows® XP, Windows® Vista™, Windows® 7

To access the software User's Manual go to the Help menu for instructions on how to use the OCR software application:

1. Load and open the ABBYY software.
2. Press the "F1" key located on your keyboard to launch the "Help" menu from the software.
3. OR, locate the ABBYY icon found next to the Time indicator on your computer's taskbar and then right click on the icon to access the "Help" menu.

## FCC (Federal Communications Commission)

This device complies with Part 15 of the FCC Rules.

Operation is subject to the following two conditions:

- (1) This device may not cause harmful interference, and
- (2) this device must accept any interference received, including interference they may cause undesired operation.

Windows® XP, Windows® Vista™, Windows® 7 are registered trademarks of Microsoft Corporation.  
Mac OS® 10.4 is a registered trademark of Apple Inc.  
ABBYY® is a registered trademark of ABBYY Software Ltd.  
microSD and microSDHC logo is a trademark of SD-3C, LLC.  
All trademarks are the property of their respective owner.

FC CE  
AM-N410A-GB-VPS-3  
PDS-ST410A-VP\_Manual\_11-0706

## Free Manuals Download Website

<http://myh66.com>

<http://usermanuals.us>

<http://www.somanuals.com>

<http://www.4manuals.cc>

<http://www.manual-lib.com>

<http://www.404manual.com>

<http://www.luxmanual.com>

<http://aubethermostatmanual.com>

Golf course search by state

<http://golfingnear.com>

Email search by domain

<http://emailbydomain.com>

Auto manuals search

<http://auto.somanuals.com>

TV manuals search

<http://tv.somanuals.com>