

**Warranty
Registration:**

register online today for a
chance to win a FREE Tripp Lite
product—www.tripplite.com/warranty



Owner's Manual

Industrial USB 2.0 Hub

Model:

U223-004-IND (4-Port)

Safety Instructions	2
Features	3
System Requirement	3
Package Contents	3
Powering the Hub	4
Mounting Kit Installation	5
Specifications	6
Warranty & Warranty Registration	6



Manufacturing
Excellence.

1111 W. 35th Street, Chicago, IL 60609 USA • www.tripplite.com/support

Copyright © 2012 Tripp Lite. All rights reserved. All trademarks are the property of their respective owners.

Before attempting to connect, operate or adjust this product, please save and read the Owner's Manual completely.

Safety Instructions

Always read the safety instructions carefully:

- Keep this Owner's Manual for future reference
- Keep this equipment away from humidity
- If any of the following situations arise, get the equipment checked by a service technician:
 - The equipment has been exposed to moisture.
 - The equipment has been dropped and damaged.
 - The equipment has obvious sign of breakage.
 - The equipment has not been working well or you cannot get it to work according to the Owner's Manual.

Features

- Compliant with USB 2.0 specification, Hi-Speed USB data transmission rate up to 480 Mbps
- Bus-power (no external power adapter required) and self-power mode selection
- Dual power input (AC or DC) supply
- Plug-and-Play; no software required
- Over-current detection and protection circuit design
- ESD protected to ± 15 kV
- Automatic link and speed detection
- Industrial-grade rugged metal enclosure design
- DIN rail mount and wallmount support

System Requirement

- Compatible with all USB-enabled operating systems

Package Contents

- U223-004-IND
- USB cable x1
- 3-pin power terminal block
- DIN mounting hardware x1
- Wallmount hardware

Powering the Hub

To power the hub, plug the user-supplied power adapter into the wall outlet.

DC-In

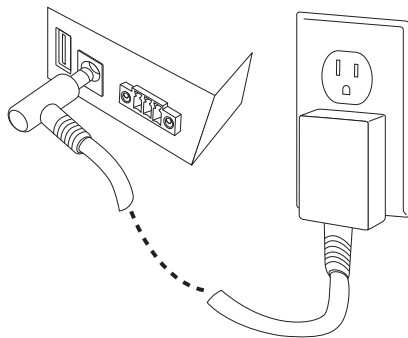

Power terminal

To power the hub using a power terminal, plug the supplied power terminal block into the hub according to the connector's orientation.

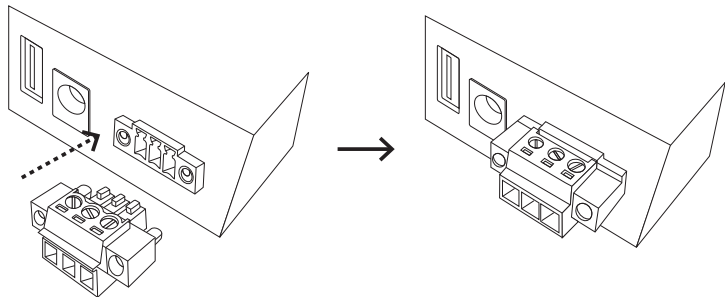

4

Mounting Kit Installation

This hub can be placed on a flat surface, mounted on a wall or attached to a standard DIN-Rail. To mount the hub to a DIN-Rail, please follow the steps below.

Note: The description below is an example due to the various DIN mounting modules and conditions.

Step 1: Fasten the included DIN rail hardware to the side of the unit using the screws provided in the packaging (See Figure A).

Step 2: Affix the hub to your DIN rail

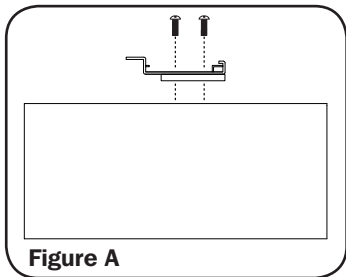

Figure A

To wallmount the hub, fasten the included mounting brackets to the bottom of the unit, with the wallmount holes sticking out. You can then wallmount the hub accordingly.

Notice

- Prior to connecting the hub, it is recommended that you first install your USB device drivers. This will ensure your device will be recognized upon connecting it to the hub.
- The transmission rate is up to 480Mbps when connecting the hub to a USB 2.0 port.

Specifications

Item	Description
Ports	4 x USB2.0
ESD Protection	15KV ESD
Transmission Speed	12M~480Mbps
Power Requirement	Bus-power/5V 3A DC/9~36V DC
Operating Temperature	0°C to 60°C (32°F to 140°F)
Operating Humidity	5 to 95% RH
Dimension (LxWxH)	142 x 63.6 x 24.6 mm (5.6 x 2.5 x 1 in)
Enclosure Material	Metal
Regulatory Approvals	FCC/CE

Specification is subject to change without further notice.

Warranty & Warranty Registration

1-Year Limited Warranty

TRIPP LITE warrants its products to be free from defects in materials and workmanship for a period of one (1) year from the date of initial purchase. TRIPP LITE's obligation under this warranty is limited to repairing or replacing (at its sole option) any such defective products. To obtain service under this warranty, you must obtain a Returned Material Authorization (RMA) number from TRIPP LITE or an authorized TRIPP LITE service center. Products must be returned to TRIPP LITE or an authorized TRIPP LITE service center with transportation charges prepaid and must be accompanied by a brief description of the problem encountered and proof of date and place of purchase. This warranty does not apply to equipment, which has been damaged by accident, negligence or misapplication or has been altered or modified in any way.

EXCEPT AS PROVIDED HEREIN, TRIPP LITE MAKES NO WARRANTIES, EXPRESS OR IMPLIED, INCLUDING WARRANTIES OF MERCHANTABILITY AND FITNESS FOR A PARTICULAR PURPOSE.

Some states do not permit limitation or exclusion of implied warranties; therefore, the aforesaid limitation(s) or exclusion(s) may not apply to the purchaser.

Warranty & Warranty Registration continued

EXCEPT AS PROVIDED ABOVE, IN NO EVENT WILL TRIPP LITE BE LIABLE FOR DIRECT, INDIRECT, SPECIAL, INCIDENTAL OR CONSEQUENTIAL DAMAGES ARISING OUT OF THE USE OF THIS PRODUCT, EVEN IF ADVISED OF THE POSSIBILITY OF SUCH DAMAGE. Specifically, TRIPP LITE is not liable for any costs, such as lost profits or revenue, loss of equipment, loss of use of equipment, loss of software, loss of data, costs of substitutes, claims by third parties, or otherwise.

Use of this equipment in life support applications where failure of this equipment can reasonably be expected to cause the failure of the life support equipment or to significantly affect its safety or effectiveness is not recommended. Do not use this equipment in the presence of a flammable anesthetic mixture with air, oxygen or nitrous oxide.

FCC Notice, Class B

This device complies with part 15 of the FCC Rules. Operation is subject to the following two conditions: (1) This device may not cause harmful interference, and (2) this device must accept any interference received, including interference that may cause undesired operation.

Note: This equipment has been tested and found to comply with the limits for a Class B digital device, pursuant to part 15 of the FCC Rules. These limits are designed to provide reasonable protection against harmful interference in a residential installation. This equipment generates, uses and can radiate radio frequency energy and, if not installed and used in accordance with the instructions, may cause harmful interference to radio communications. However, there is no guarantee that interference will not occur in a particular installation. If this equipment does cause harmful interference to radio or television reception, which can be determined by turning the equipment off and on, the user is encouraged to try to correct the interference by one or more of the following measures:

- Reorient or relocate the receiving antenna.
 - Increase the separation between the equipment and receiver.
 - Connect the equipment into an outlet on a circuit different from that to which the receiver is connected.
 - Consult the dealer or an experienced radio/TV technician for help.
- Any changes or modifications to this equipment not expressly approved by Tripp Lite could void the user's authority to operate this equipment.

Warranty & Warranty Registration continued



WEEE Compliance Information for Tripp Lite Customers and Recyclers (European Union)

Under the Waste Electrical and Electronic Equipment (WEEE) Directive and implementing regulations, when customers buy new electrical and electronic equipment from Tripp Lite they are entitled to:

- Send old equipment for recycling on a one-for-one, like-for-like basis (this varies depending on the country)
- Send the new equipment back for recycling when this ultimately becomes waste

WARRANTY REGISTRATION

Visit www.tripplite.com/warranty today to register the warranty for your new Tripp Lite product. You'll be automatically entered into a drawing for a chance to win a FREE Tripp Lite product!*

* No purchase necessary. Void where prohibited. Some restrictions apply. See website for details.

Tripp Lite follows a policy of continuous improvement. Product specifications are subject to change without notice.



1111 W. 35th Street, Chicago, IL 60609 USA • www.tripplite.com/support

201205147 • 933218-EN

Free Manuals Download Website

<http://myh66.com>

<http://usermanuals.us>

<http://www.somanuals.com>

<http://www.4manuals.cc>

<http://www.manual-lib.com>

<http://www.404manual.com>

<http://www.luxmanual.com>

<http://aubethermostatmanual.com>

Golf course search by state

<http://golfingnear.com>

Email search by domain

<http://emailbydomain.com>

Auto manuals search

<http://auto.somanuals.com>

TV manuals search

<http://tv.somanuals.com>