

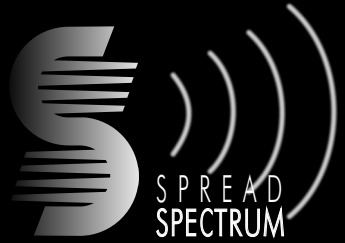

THE EXS 9650



OWNER'S MANUAL

Digital Spread Spectrum

provides the longest

range, the clearest sound

and the best privacy.

Uniden®

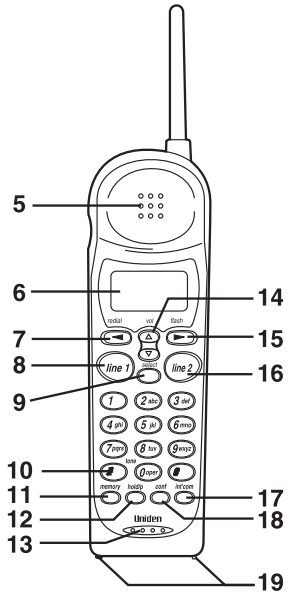
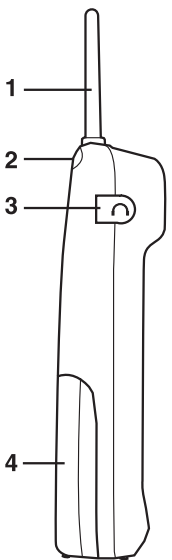

1. Handset Antenna
2. Beltclip Cover
3. Headset Connection
4. Handset Battery Compartment
5. Handset Speaker
6. LCD Display
7. Redial/Cursor Backspace Key
8. Line 1 Key
9. Select Key
10. Tone Key
11. Memory Key
12. Hold/Pause Key
13. Handset Microphone
14. Volume/
15. Flash/Cursor Forward Key
16. Line 2 Key
17. Intercom Key
18. Conference Key
19. Handset Contacts

20. Wall Mount/Desktop
21. Battery Charger
22. Base Microphone
23. Handset Retainer
24. Line 1 Status LED
25. Status LED
26. Memory Key
27. Page/Intercom Key
28. Redial/Pause Key
29. Flash Key
30. Base Contacts
31. Tone Key
32. Base Speaker
33. Line 1 Key
34. Conference Key
35. Line 2 Key
36. Line 2 Status LED
37. Hold Key
38. Mute Key
39. Base Antenna
40. Base Speaker Volume
41. Beltclip/Slot Cover
42. Ring Volume Switch
43. Pulse-Tone Switch
44. DC Power Input
45. Phone Jack (2nd Line)
46. Phone Jack (1- and 2-)

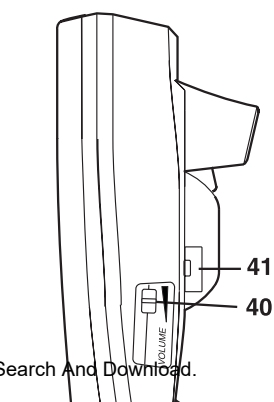
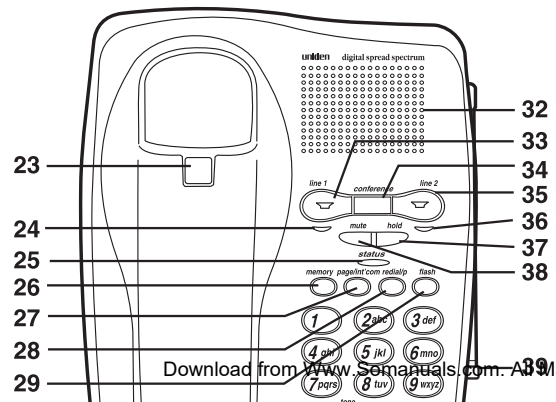
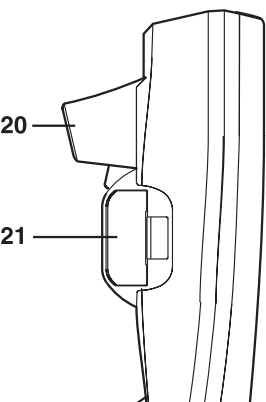

CONTENTS

OF YOUR OWNERS MANUAL

NOTE

Fold out the front cover of this owner's manual to use the handy CONTROLS AND FUNCTIONS page for reference.

CONTENTS

Controls and Functions	Inside Front Cover
Introduction to Your New Phone	2
Features	2
Welcome	2
Included in Your Package	3
Installing Your New Phone	4
Selecting a Location	4
Desk/Tabletop Installation	5
Wall Installation	6
Installing the Handset Battery Pack	10
Charging the Battery Pack	11
Cleaning the Battery Contacts	12
Setting the Pulse-Tone Switch	12
Adjusting the Volume Controls	13
Installing the Beltclip	14
Headset Installation	15
Automatic Digital Code Security	15
Using Your New Phone	16
Making and Receiving Calls	16
Answering a Call from the Base	17
Answering a Call from the Handset	17
Making a Call from the Base	18
Making a Call from the Handset	18
Using the Tone Feature	18
Flash and Call Waiting	19
Using Redial	19
Placing a Call on Hold	20
Using the Mute Feature	20
Using the Page Feature	21
2-Line Operation	22
3-Way Conferencing	23
4-Way Conferencing	24
Using Your EXS 9650 Intercom	25
Transferring a Call	26
Traveling Out-of-Range	27
Storing a Phone Number in Memory	28
Editing a Phone Number in Memory	30
Erasing a Number from Memory	32
Using Memory Dialing	34
Troubleshooting	36
Quick Reference Chart	36
Specifications	37

Introduction

Installing and Adjusting

Using Your New Phone

Troubleshooting

Specifications

WELCOME

Congratulations on your purchase of the Uniden EXS 9650 cordless telephone. This phone is designed for reliability, long life, and outstanding performance utilizing the latest 900 MHz Spread Spectrum Technology.

FEATURES

- 900 MHz Digital Spread Spectrum Technology
- 2-Line Operation
- 3 and 4-Way Conference Calling
- Speakerphone
- Back-up Power Supply with Optional Battery Pack
- 3-Line, 16 Character LCD Handset Display
- Headset Compatible
- Handset Earpiece and Ringer Volume Control
- 20 Memory Dialing Locations
- 32 Digit Redial
- 2-way Page/Intercom
- Hearing Aid Compatible
- Redial, Flash, and Pause
- Pulse/Tone Dialing
- 7-Day Standby Battery Time
- 4-Hour Talk Time

Digital Spread Spectrum Technology utilizes a “wider frequency band” vs. a “single narrow band” used in standard digital transmissions. The result is a more secure conversation with the clarity of digital sound, extended range, and minimal interference from other cordless phones.

Random Code™ digital security automatically selects one of over 65,000 codes for the handset and base. This feature prevents unauthorized calls as a result of your phone being activated by other equipment.

INCLUDED IN YOUR PACKAGE

TIP

To get the most from your phone, please read this owner's manual thoroughly. Be sure to complete and mail the product registration form.

NOTE

If any of these items are missing or damaged, contact the Uniden Parts Department at (800) 554-3988. Hours are from 8:30 a.m. to 5:00 p.m. Central Time, Monday through Friday. We can also be reached on the web at www.uniden.com.

HINT

You must have a two-line subscription from your phone company to realize the capability of your two-line phone.



Handset



Base



AC Adapter

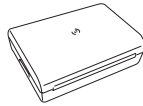

Rechargeable Battery



Short Telephone Cord



Beltclip



Long Telephone Cord

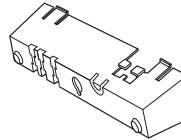

Desktop/Wall Mount Adapter

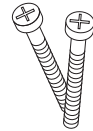

Wall Mounting Screws

- This Owner's Manual
- Precautions and Important Safety Instructions
- Registration Card

SELECTING A LOCATION

Before choosing a location for your new phone, read the INSTALLATION CONSIDERATIONS included in the PRECAUTIONS AND IMPORTANT SAFETY INSTRUCTIONS brochure. Here are some important guidelines you should consider:

- The location should be close to both a phone jack and a continuous power outlet. (A continuous power outlet is an AC outlet which does not have a switch to interrupt its power.)
- Keep the base and handset away from sources of electrical noise such as motors and fluorescent lighting.
- Be sure there is sufficient space to rotate the base antenna fully vertical.
- The base can be placed on a desk, tabletop or mounted on a standard wall plate.
- You should charge your handset for 15-20 hours before connecting the phone line.
- If your second phone line has a separate jack, place your phone so you can access both jacks.



NOTE

Before using your phone, charge the Nickel-Cadmium battery pack for 15-20 hours.

DESK/TABLETOP INSTALLATION

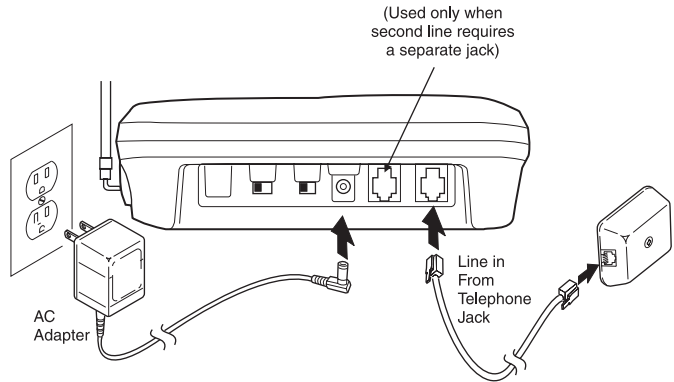

1. Snap the desk/wall mount adapter into the top of the base as shown.
2. Plug the AC adapter cord into the 10V DC input jack on the back of the base.
3. Wrap the AC adapter cord around the strain relief notch.
4. Plug the AC adapter into a standard 120V AC wall outlet.
5. Charge the battery (refer to CHARGING THE BATTERY PACK, page 11).
6. Plug one end of the long telephone cord into the **TEL LINE 1/2** jack on the back of the base.
7. Plug the other end of the cord into the telephone jack on the wall.
8. Set the base on a desk or tabletop. Place the handset on the base with the keypad facing up or down. Raise the antenna to a vertical position.

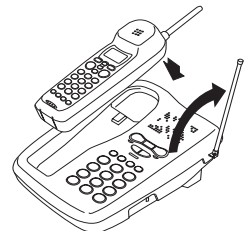
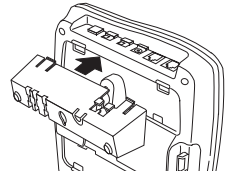

Place the power cord so that it does not create a trip hazard or where it could become chafed and create a fire or electrical hazard.

Use only the Uniden AC adapter supplied with this phone. DO NOT use an outlet controlled by a wall switch.

WALL INSTALLATION

▼ Standard wall plate mounting

This phone can be mounted on any standard telephone wall plate.

1. Snap the desktop/wall mount adapter into the bottom of the base as shown.
2. Plug the AC adapter into the base.
3. Place the AC adapter cord inside the molded wiring channel. Wrap the cord around the strain relief notch.
4. Plug the AC adapter into a standard 120V AC wall outlet.
5. Plug one end of the short telephone cord into the **TEL LINE 1/2** jack on the back of the base. Plug the other end into a standard telephone jack.

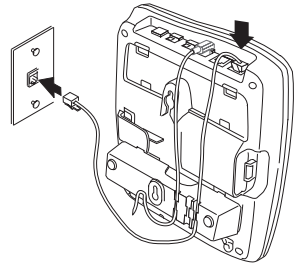
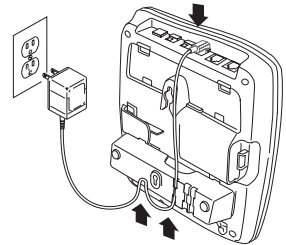
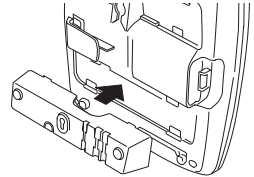

If your second line has a separate jack, plug the other cord into the base and wall jack.



Place the power cord so that it does not create a trip hazard or where it could become chafed and create a fire or electrical hazard.



DO NOT use an outlet controlled by a wall switch.

NOTE

Before you plug the other end of the telephone cord into the modular jack on the wall, charge the battery (See CHARGING THE BATTERY PACK, page 11).

6. Align the mounting slots on the base with the mounting posts on the wall. Push in and down until the phone is firmly seated.

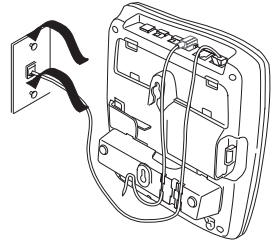

7. On the base, pull the handset retainer out of the slot. Rotate clockwise 180°.

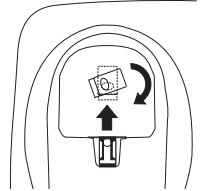

8. Flip the retainer from front to back. Slide it back into the slot so that the lip of the retainer is up and the oval is down. The retainer holds the handset in place.

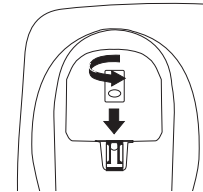

▼ *Direct wall mounting*

If you don't have a standard wall plate, you can mount your phone directly to the wall. Before doing this, consider the following:

- Select a location away from electrical cables, pipes, or other items behind the mounting location that could cause a hazard when inserting the screws into the wall.
- Mount your phone near a working phone jack to avoid excessive cord lengths.
- Make sure the wall material is capable of supporting the weight of the base and the handset.

1. Insert two mounting screws (with the appropriate anchoring device) into the wall 3-15/16 inches apart. Allow about 3/16 of an inch between the wall and screw heads for mounting the phone.

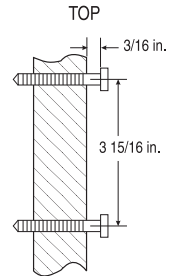

2. Snap the desktop/wall mount adapter into the bottom of the base as shown.

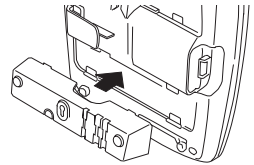

3. Plug the AC adapter cord into the 10V DC input jack on the back of the base.

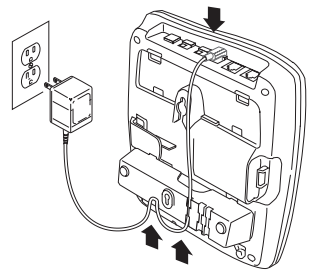

4. Put the AC adapter cord inside the molded wiring channel. Wrap it around the strain relief notch. Plug the AC adapter into a standard 120V AC wall outlet.

5. Plug one end of the long telephone cord into the **TEL LINE 1/2** jack on the back of the base. Plug the other end into a telephone jack.

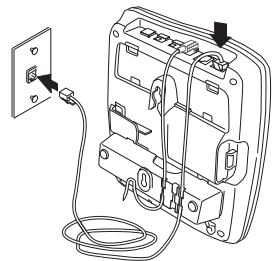

6. Align the mounting slots on the base with the mounting screws on the wall. Push in and down until the phone is firmly seated.

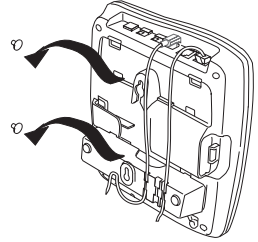

7. On the base, pull the handset retainer out of the slot. Rotate clockwise 180°.

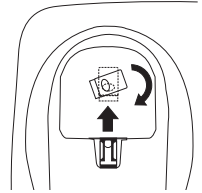

8. Flip the retainer from front to back. Slide it back into the slot so that the lip of the retainer is up and the oval is down. The retainer holds the handset in place.

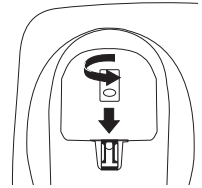

Be careful not to insert the mounting screws into possible electrical hazards such as cables, wiring or pipes.

INSTALLING THE HANDSET BATTERY PACK



Use only Uniden Battery (model BT-990) supplied with your phone.

1. Press the battery cover release.
Slide cover off.

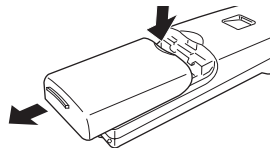

2. Install the nickel-cadmium battery with the label down.

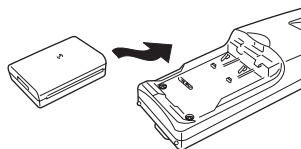

3. Slide the battery cover forward until it snaps into place.

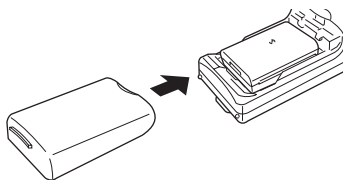

CHARGING THE BATTERY PACK

▼ Initial battery charging

Before connecting your phone for the first time, charge the rechargeable battery pack for 15-20 hours without interruption.

1. Place the handset on the base.
2. Make sure that **status** LED lights.
If the LED doesn't light, be sure the AC adapter is plugged in and the handset makes good contact with the base charging contacts.

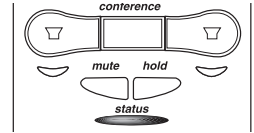

▼ Charging optional battery packs

The base of your phone is equipped with a compartment for charging an extra battery pack for use in your handset. **You can obtain an extra battery pack from your authorized Uniden dealer.**

1. Position the battery pack so the contacts are face up.
2. Slide the battery pack into the charging compartment until it locks into place.

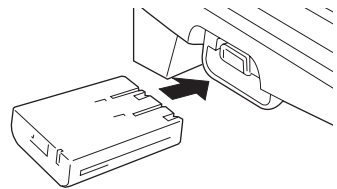

3. Charge the battery for 24 hours. When charging is complete, lift the latch to remove the battery pack. To install the charged battery into the handset, see INSTALLING THE HANDSET BATTERY PACK, page 10.

NOTE

Please visit your authorized Uniden dealer to obtain an extra battery pack or contact the Uniden Parts Department at (800) 554-3988. Hours are from 8:30 a.m. to 5:00 p.m. Central Standard Time, Monday through Friday.

NOTE

In the event of a power failure, your spare battery pack temporarily provides power for the base so you can still use your phone.

▼ *Low battery indicator*

When the battery pack is very low and needs to be charged, the phone is programmed to eliminate some functions to save power. If the phone is not in use, **Low Battery** flashes.

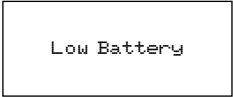

Low Battery

If the phone is in use, **Low Battery** flashes and the handset beeps.



NOTE

All rechargeable nickel-cadmium batteries develop a "memory effect." The memory effect gradually reduces your talk and standby time.

▼ *To avoid Memory Effect*

On a monthly basis, use the phone until the "Low Battery" indicator display flashes. Then charge the battery for 15-20 hours.

With normal usage, your battery should last about one year.

CLEANING THE BATTERY CONTACTS

To maintain a good charge, clean all charging contacts on the handset and base about once a month. Use a pencil eraser or other contact cleaner. DO NOT use liquids or solvents; you may damage your phone.

SETTING THE PULSE-TONE SWITCH

Be sure the **PULSE-TONE** switch is the **TONE** position unless your local phone system uses pulse dialing.

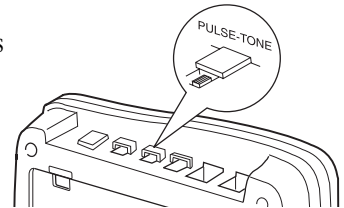

TIP

Most phone systems use tone dialing. Check with your local phone company if you're not sure whether your system is tone or pulse.

ADJUSTING THE VOLUME CONTROLS

▼ Handset ringer volume

Remove the handset from the base.
Press the **vol ▲** or **▼** key on the handset to set the handset ringer volume. There are two ringer volume settings; high and low.

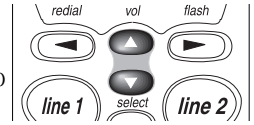

To select the high volume setting, press **vol ▲**. The following screen displays:

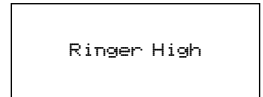

To select the low volume setting, press **vol ▼**. The following screen displays:

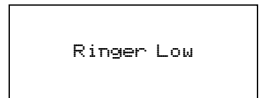

▼ Handset earpiece volume

There are three volume settings for the handset earpiece; high, normal and low. The handset earpiece volume can be adjusted only during a call.

To lower the volume, press **vol ▼**. To raise the volume, press **vol ▲**. The handset displays **Volume High**, **Volume Normal** or **Volume Low** indicating the current volume setting.

▼ Base ringer volume

The ringer control for the base of your EXS 9650 allows you to turn the ringer **OFF** or to select **LO** or **HI** volume.

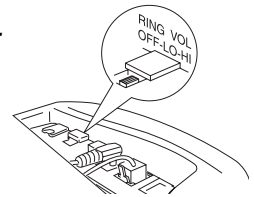

▼ Base speaker volume

To control the speaker volume of the base, adjust the **VOLUME** slide switch as desired.

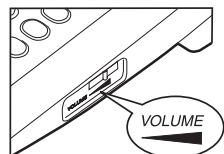

INSTALLING THE BELTCLIP

▼ *To attach the beltclip*

1. Remove the slot cover.

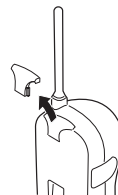

2. Insert the beltclip into the empty slot and press down until it clicks.

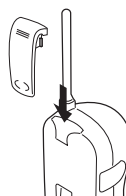

▼ *To remove the beltclip*

1. Pull back on the release tab and lift the beltclip up.

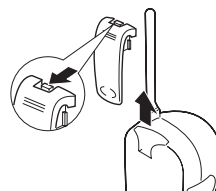

2. Replace the slot cover. You can store either the beltclip or slot cover in the bottom of the base.

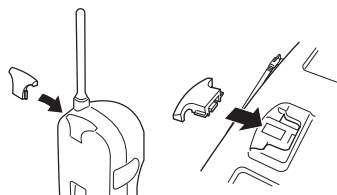

IMPORTANT

Use only the Uniden HS910 headset specifically designed for Spread Spectrum phones. You may hear a buzz or hum on other headsets.

NOTE

Keep headset wire away from handset and base antennas.

HEADSET INSTALLATION

Your phone may be used with an optional headset, the Uniden HS910. To use this feature, simply plug the headset plug into the headset jack. Your phone is ready for hands-free conversation.

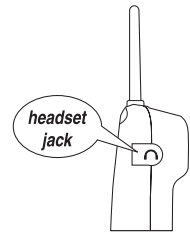

NOTE

If you are using an optional headset, you must still use the handset keypad for phone operations.

AUTOMATIC DIGITAL CODE SECURITY

To prevent other parties from making unauthorized calls on your phone line, a digital code was added to the EXS 9650. Your phone's handset and base share this code. This code is randomly set each time you place the handset in the base. If the phone experiences a power failure, you must reset the digital security code by placing the handset in the base.

▼ To reset the digital security code

1. Restore power to the base.
2. Place the handset on the base. The **status** LED flashes to indicate that the digital security code is reset.

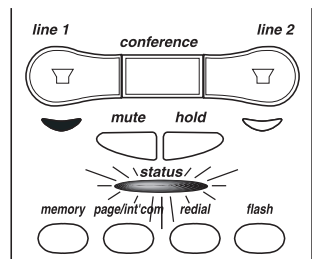

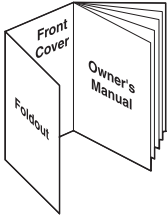



Fold out the front cover of this owner's manual to use the CONTROLS AND FUNCTIONS diagram for reference.

MAKING AND RECEIVING CALLS

▼ Basic 2-line operation

	Handset On Base	Handset Off Base	Base Only
			
To answer a call	Pick up handset.	Press line 1 or line 2 .	Press any key.
To make a call	1. Pickup handset. 2. Press line 1 or line 2 . 3. Listen for dial tone. 4. Dial number. <i>or</i> 1. Pickup handset. 2. Dial number. 3. Press line 1 or line 2 .	1. Press line 1 or line 2 . 2. Listen for dial tone. 3. Dial number. <i>or</i> 1. Dial number. 2. Press line 1 or line 2 .	1. Press line 1 or line 2 . 2. Listen for the dial tone. 3. Dial the number.
To hang up	Press line 1 or line 2 , or return the handset to the base (AutoStandby).		Press line 1 or line 2 .
To redial	1. Pickup handset. 2. Press line 1 or line 2 . 3. Listen for dial tone. 4. Press redial . <i>or</i> 1. Pickup handset. 2. Press redial . 3. Press line 1 or line 2 .	1. Press line 1 or line 2 . 2. Listen for dial tone. 3. Press redial . <i>or</i> 1. Press redial . 2. Press line 1 or line 2 .	1. Press line 1 or line 2 . 2. Listen for the dial tone. 3. Press redial .

USING YOUR NEW PHONE

NOTE

You must have a 2-line subscription from your phone company to use the 2-line features.

When you have connected power and a telephone line to your EXS 9650, the phone is in “**Standby mode**,” ready to receive and make calls.

For clarity, the instructions in this Owner’s Manual designates line 1 unless the procedure requires using line 2. The same instructions apply to line 2.

ANSWERING A CALL FROM THE BASE

1. The base rings. The corresponding line 1 LED on the base flashes.
2. Press the **line 1** button and speak.
3. When you finish the call, press **line 1** to hang up.

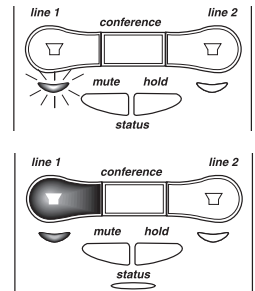

NOTE

The base microphone is located under the phone. Position yourself approximately 12 inches away from the base and speak clearly.

ANSWERING A CALL FROM THE HANDSET

1. The handset rings and the following screen appears:
2. Press **line 1** to answer your call.
3. When you finish the call press **line 1** on the handset, or return the handset to the base.

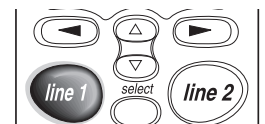
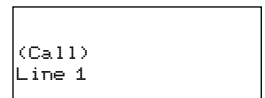

HINT

AutoStandby automatically hangs up when you place the handset on the base. There is no need to press **line 1** or **line 2** to hang up.

MAKING A CALL FROM THE BASE

1. Press **line 1**.
2. Dial the number on the keypad or use the memory feature. (See USING MEMORY DIALING, page 34.)
3. When you finish the call, press **line 1** to hang up.

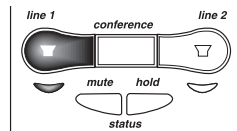

MAKING A CALL FROM THE HANDSET

▼ Off-Hook Dialing

1. Pick up the handset.
2. Press **line 1**.
3. Dial the number on the keypad, or use one of the memory features. (See USING MEMORY DIALING, page 34).
4. When you finish the call, press **line 1**, or return the handset to the base.

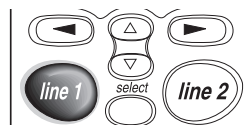

▼ On-Hook Dialing

1. Pick up the handset.
2. Dial the number on the keypad, or use one of the memory features. (See USING MEMORY DIALING, page 34).
3. Press **line 1**.
4. When you finish the call, press **line 1**, or return the handset to the base.

USING THE TONE FEATURE

If you are dialing in the pulse mode and need to enter tone digits, press **tone** then enter the digits. Once the call has ended, tone mode is canceled and pulse dialing resumes.

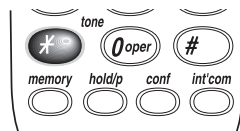

NOTE

The tone feature applies only when the base is set to pulse.

FLASH AND CALL WAITING

If you have Call Waiting service and a call waiting tone sounds, press **flash** to accept the call. After a short pause you will hear the new caller. To return to the original caller, press **flash** again. The flash function on the base and handset are independent of each other. You can use your flash feature from either the handset or the base.

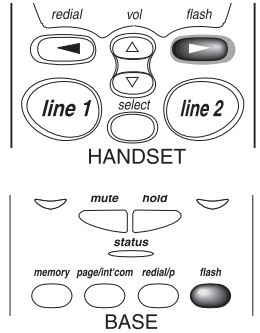

NOTE

The flash feature does not function when **line 1** and **line 2** are on a conference call. (See the 3-WAY CONFERENCE and 4-WAY CONFERENCE, pages 23 and 24.)

USING REDIAL

The **redial** key redials the last number dialed. The redialed number can be up to 32 digits long.

1. To call the last number dialed from the handset, press **line 1**, then press **redial**.

or

Press **redial**, then press **line 1**.

*If any key is pressed before **redial**, the last number will not redial.*

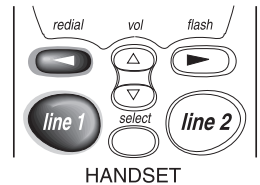

2. To call the last number dialed from the base, press **line 1**, then press **redial/p**.

*If any key is pressed before **redial/p**, the last number will not redial.*

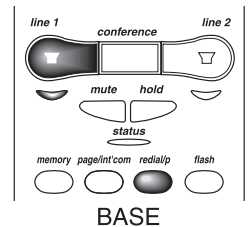

TIP

The EXS 9650 has two independent Last Number Redial memories, one in the handset, the other in the base.

NOTE

Do not use the base and the handset keypads at the same time to place a call on hold.

PLACING A CALL ON HOLD

Use either the keypad on the handset or the keypad on the base.

1. To place **line 1** on hold at the base, press **hold**. The **line 1** LED turns from green to red.
2. To place **line 1** on hold at the handset, press **hold/p**.

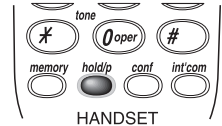
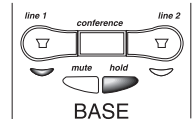

The following screen appears:

```
(Hold)  
Line 1
```

3. To pick up the call that is holding, press **line 1** on the base or handset.

USING THE MUTE FEATURE

You can mute your conversation from the base. This prevents the party you are speaking to from hearing what you, or someone else in the room, is saying.

For example, to use this privacy feature while using line 1.

1. Press **mute**. The **line 1** LED flashes red.
You can hear the party on line 1, but they cannot hear you.

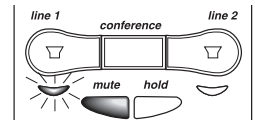

2. When you are ready to continue your conversation with the party on line 1, press **mute** again. The **line 1** LED changes to green.

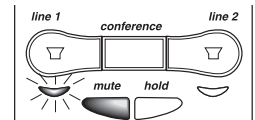

NOTE

Do not press **line 1** to take the phone off mute or you will disconnect the call.

USING THE PAGE FEATURE

To locate the handset when it is off the base, press **page/int'com** on the base.

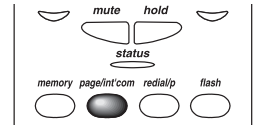

The handset beeps for 60 seconds.
The following screen appears:

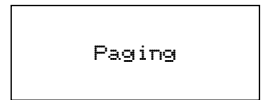

*To cancel the page, press **page/int'com** on the base again.*

Press **int'com** on the handset to connect to the base. Press **int'com** again on either the handset or the base to return to standby.

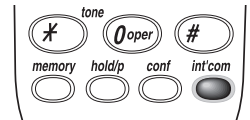

2-LINE OPERATION

The handset and the base can be used on separate telephone lines at the same time. For example, if the handset is on a call with **line 1**, you can make, or receive calls, at the base on **line 2**.

The **line 1** LED on the base blinks green to indicate line 1 is In Use at the handset.

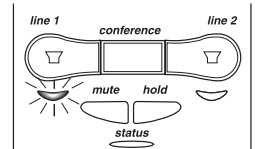

When **line 1** is In Use at the base the LCD screen displays the following:

```
(Base)  
Line 1
```

NOTE

When you attempt to make a call, the EXS 9650 informs you if a line is currently in use.

▼ Extension In Use

The Extension In Use feature prevents you from accidentally interrupting a call.

If you attempt to make a call and another phone is In Use on line 1, the handset LCD displays "In Use". (The line 1 LED at the base blinks.) If you press line 1, you will hear a beep. This warns you the line is In Use. To make your call, you must use line 2.

NOTE

If you want to join a conversation, press the line button twice which is in use. (The second press should be while you hear a beep.)

NOTE

The Flash feature does not function when the phone is in Conference mode.

3-WAY CONFERENCING

This feature lets you add a third party to your conversation from either the handset or the base.



For example, to add a party to the current call on **line 1** at the base:

1. Press **hold** to place the caller on hold. The **line 1** LED turns from green to red.

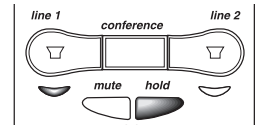

2. Press **line 2**.

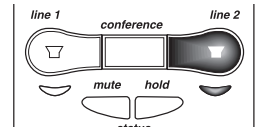

3. Dial the number of the person you want to add to the conversation. When the person answers, you can speak privately before bringing the original caller back on the line.

4. Press the **conference** button to bring original call back on line. The **line 1** and **line 2** LEDs turn green.

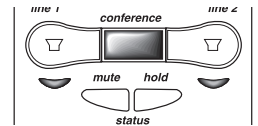

The handset display shows:

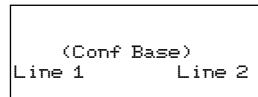

*If the third person's number is busy or doesn't answer, press **line 2** to hang up. Return to the original call by pressing **line 1**.*

5. To remove either caller from your conversation, ask one of the parties to hang up. Press the corresponding line button to end the call.

Follow steps 1-5 to conference using the handset. When you return the handset to the base, all calls are disconnected.

4-WAY CONFERENCING

A fourth person, at either the handset or the base, may be added to a conference call.

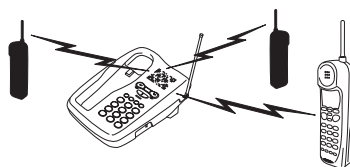

For example, to add a fourth party at the handset to an ongoing conference call at the base:

1. Press **hold**. The **line 1** and **line 2** LEDs turn red.

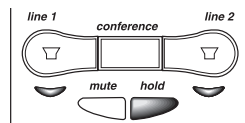

2. Press **page/int'com** to contact the handset.

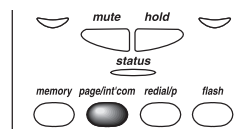

3. Press **int'com** on the handset to answer the page.

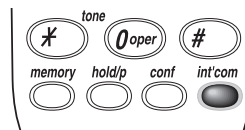

4. Press **conference** at the base to bring the party at the handset in on the call. The **line 1** and **line 2** LEDs turn green.

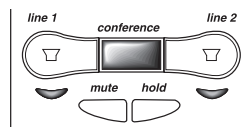

The following screen appears:

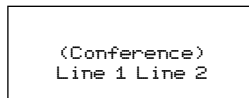

5. To remove either call from your conversation, ask one of the parties to hang up. Press the corresponding line button to end the call.

USING YOUR EXS 9650 INTERCOM

TIP

When a call is on **hold** at the handset, and the base is paged, the base will ring even when the **RING VOL** switch is set to **OFF**.

TIP

The person at the handset can join the conversation by pressing the button for the line in use twice.

▼ *Paging from the Base to the Handset*

1. Press **page/int'com** on the base. The handset beeps. (If no answer, press **page/int'com** again to disconnect.)

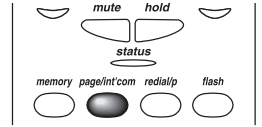

2. Press **int'com** on the handset to answer the page.
3. To turn off the intercom, press **page/int'com** on the base or **int'com** on the handset.

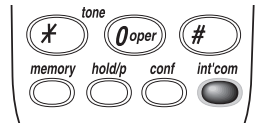

▼ *Paging from the Handset to the Base*

1. Press **int'com** on the handset. (If no answer, press **int'com** to disconnect.)
2. At the base, press **page/int'com** to answer the page.

Speak within 12 inches of the base microphone.

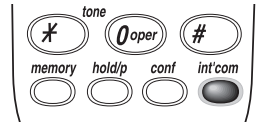

3. To turn off the intercom, press **page/int'com** at the base or **int'com** on the handset.

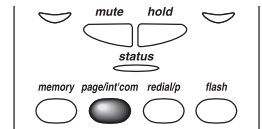

TRANSFERRING A CALL

▼ From Handset to Base

- To transfer a call from the handset to the base, press **hold/p**.

The **line 1** LED turns red.

- On the handset, press **int'com**.

The following screen appears:

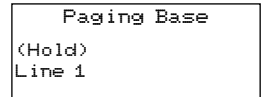
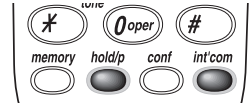

The **status** LED flashes.

- Answer at the base by pressing **page/int'com**. You may then announce the call with the intercom.

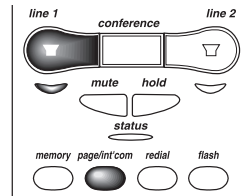

- On the base, press **line 1** to talk.

*If no one is available to take the call at the base, return to the caller by pressing **line 1** or **int'com** on the handset to take a message or complete the call.*

▼ From Base to Handset

- To transfer a call from the base to the handset, press **hold**.

The **line 1** LED turns red.

- On the base, press **page/int'com**.

The following screen appears:

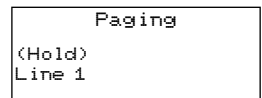
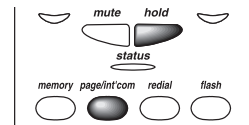

The **status** LED flashes.

- Answer at the handset by pressing **int'com**. You may then announce the call with the intercom.

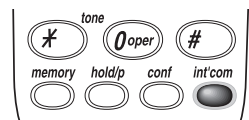

4. On the handset, press **line 1** to talk.

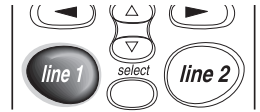

*If no one is available to take the call at the handset, return to the caller by pressing **line 1** or **page/int'com** on the base ,to take a message or complete the call.*

TRAVELING OUT-OF-RANGE

As you begin to move too far from the base, you first hear a clicking sound. As you travel further, the noise increases. If you travel out-of-range, your call terminates.

STORING A PHONE NUMBER IN MEMORY

Your EXS 9650 stores up to 10 name/numbers in the handset plus 10 numbers in the base. Memory locations are shared by both lines.

▼ On the Handset

1. Remove the handset from the base.
2. Press and hold **memory** for two seconds.

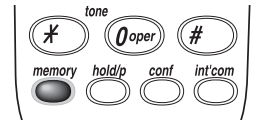

The following screen appears:

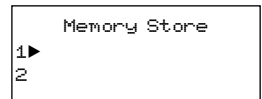

3. Use the ▲ and ▼ keys or number keypad to choose the memory location to store a name/number.

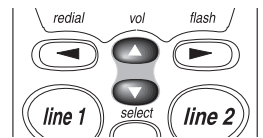

4. Press **select**.

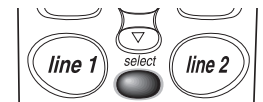

The following screen appears:

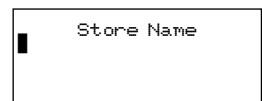

5. Enter a name by using the ▲ and ▼ keys to scroll through the character menu. Stop scrolling when you see the desired character. Use the ◀ or **del** key to clear a character and the ▶ key to move right or to create a blank space.
6. When you have finished entering a name, press **select**.

The following screen appears:

The cursor flashes indicating that the display is ready for a number to be entered.

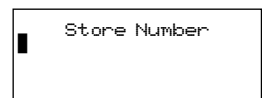

HINT

The “-” does nothing to the dialing sequence. It simply allows you to display a dash.

NOTE

Whenever you are using a menu screen, you must press a key within 20 seconds or the phone will return to standby. You may also press **memory** to exit a **memory** menu at any time.

7. Enter the phone number with the number keypad (direct entry). Or scroll through numbers with the ▲ and ▼ keys. Use the ▲ and ▼ keys to enter symbols, such as dashes. Use the ◀ and ▶ keys to position the cursor.

NOTE

*When entering name/numbers, you may press **hold/p** to enter a pause in the dialing sequence. The display shows a P. The pause feature is useful for long distance calling, credit card dialing, or any other dialing sequence requiring a pause between digits.*

8. When you have finished entering a name/number, press **select**.

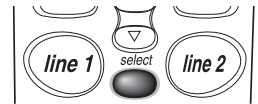

The handset beeps and displays a confirmation screen.

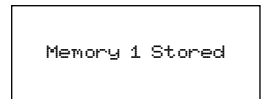

▼ On the Base

1. Press **memory**. The **status** LED blinks.
2. Dial the number you wish to store.
3. Press **memory**. Enter the memory location number (0-9) on the keypad. The **status** LED stops flashing. A confirmation beep indicates the number is stored.

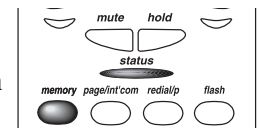
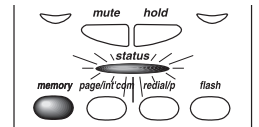

EDITING A PHONE NUMBER IN MEMORY

To edit a number you have stored in the handset:

1. Remove the handset from the base.
2. Press and hold **memory** for two seconds.

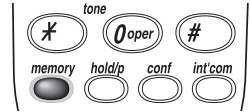

The display shows the Memory Store screen and any saved name/numbers.

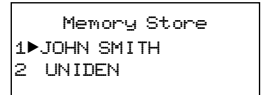

3. Use the ▲ and ▼ keys or number keypad to select the memory location you would like to edit.

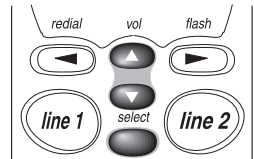

4. Press **select**.

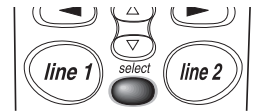

The display shows the memory location you have selected.

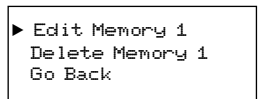

5. Press **select** again to enter the Edit Memory mode.

6. Edit the name with the ▲ and ▼ keys.

Use the ▲ and ▼ keys to enter symbols.

Use the ◀ key to clear a character and the ▶ key to move the cursor right.

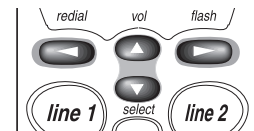

NOTE

If you select **Go Back**, no changes are made and the handset shows the Memory Store screen.

7. Press **select**.

The following screen appears:

A cursor flashes indicating that the display is ready for the number to be edited.

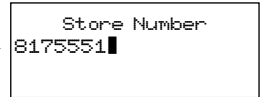

8. Enter the phone number with the number keypad (direct entry) *or* with the ▲ and ▼ keys.

Use the ▲ and ▼ keys to enter symbols.

Use the ◀ and ▶ keys to move the cursor left and right.

9. Press **select**.

The handset beeps and displays the confirmation screen.

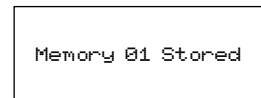

10. The display then returns to the Memory Store screen. You may select another number to edit (return to step 3) or press **memory** to return to standby.

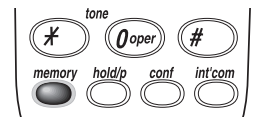

ERASING A NUMBER FROM MEMORY

After erasing a number, you may add a new address to memory.

▼ From the Handset

1. Remove the handset from the base.
2. Press and hold **memory** for two seconds.

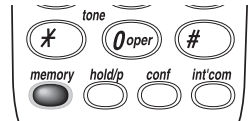

The handset shows the Memory Store screen with saved name/numbers displayed.

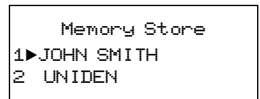

3. Use the ▲ and ▼ keys, or number keypad, to select the memory location you would like to delete. The ◀ and ▶ keys toggle between the name display and the number display.
4. Press **select**.

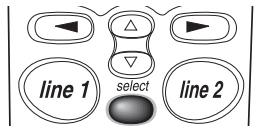
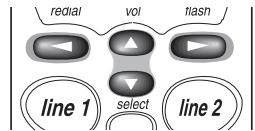

The following screen appears:

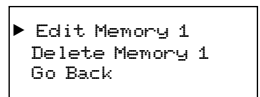

5. Use the ▼ key to move the ▶ cursor to **Delete Memory**.

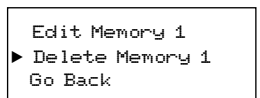

6. Press **select**.
7. Use the ▲ key to move the ▶ cursor to **Yes**.

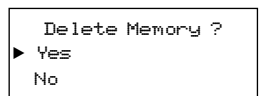

NOTE

If you select **No**, no changes are made and the handset shows the Memory Store screen.

- Press **select**.

There is confirmation tone.

The following screen appears:



- The display then returns to the Memory Store screen. You may select another number to delete (return to step 3) or you may press **memory** to return to standby.

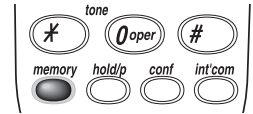

▼ *From the Base*

- Press **memory**. The **status** LED blinks.

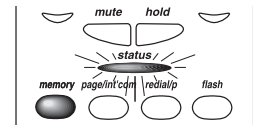

- Press **memory** again. Enter the memory location (0-9) of the number you wish to delete. The **status** LED quits flashing. A confirmation beep indicates the number has been erased.

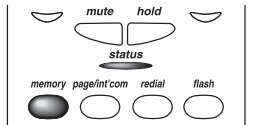

USING MEMORY DIALING

Follow the steps below to dial a number using a programmed memory location:

▼ From the Handset

1. Press **memory**.

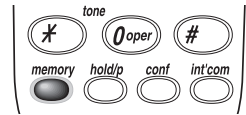

The handset displays your programmed memory locations.

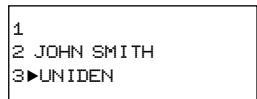

2. Use the ▲ and ▼ keys to select the memory location you would like to dial. Or, you may enter the memory location number from the keypad.

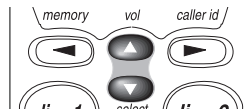

The following screen appears:

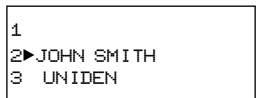

3. Press **line 1**. The number dials.

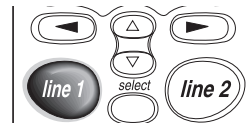

or

1. Press **line 1**. Listen for the dial tone.

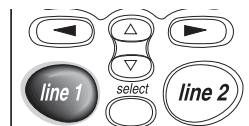

2. Press **memory**.

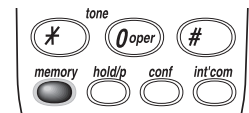

3. Enter the memory location number from the keypad.
The number dials.

▼ *At the Base*

1. Press **line 1**. The **line 1** LED lights.

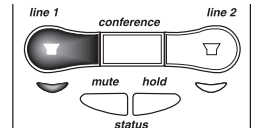

2. Press **memory**. Enter the memory location number (0-9), to dial the number.

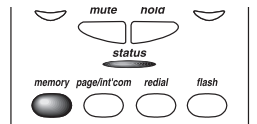

QUICK REFERENCE CHART

If your phone is not performing to your expectations, please try these simple steps before calling Uniden customer service at **(800) 297-1023**.

PROBLEM	SUGGESTION
The charge light won't come on when the handset is placed in the base.	<ul style="list-style-type: none"> • Make sure the AC adapter is plugged into the base and wall outlet. • Make sure the handset is properly seated in the base. • Make sure the charging contacts on the handset and base are clean.
The audio sounds weak and/or scratchy.	<ul style="list-style-type: none"> • Make sure that the base antenna is in a vertical position. • Move the handset and/or base to a different location away from metal objects or appliances and try again.
Can't make or receive calls.	<ul style="list-style-type: none"> • Check both ends of the base telephone line cord. • Make sure the AC adapter is plugged into the base and wall outlet. • Disconnect the AC adapter for a few minutes, then reconnect it. • Place the handset back on the charging cradle for a few seconds. The status LED blinks indicating that the phone has been reset.
The handset doesn't ring or receive a page.	<ul style="list-style-type: none"> • The Nickel-Cadmium battery pack may be weak. Charge the battery on the base for 15-20 hours. • Be sure the antenna is in a vertical position. • The handset may be too far away from the base. Place the base away from appliances or metal objects. • Place the handset back on the charging cradle for a few seconds. The status LED blinks indicating that the phone has been reset.

GENERAL

The EXS 9650 complies with FCC Parts 15 and 68.

Frequency control:	PLL
Modulation:	Direct Sequence Spread Spectrum; DBPSK
Operating temperature:	0° to +50° C (+32° F to +122° F)

BASE UNIT

Frequency:	904.2 to 925.8 MHz (20 channels)
Power requirements:	10V 500 mA (from AC adapter)
Size:	7-3/8 in. (W) x 3-1/2 in. (D) x 8-3/4 in. (H)
Weight:	Approx. 110.9 oz. (including optional battery)

HANDSET

Frequency:	904.2 to 925.8 MHz (20 channels)
Power requirements:	Rechargeable Nickel-Cadmium battery pack
Size (without antenna):	2-1/4 in. (W) x 1-3/4 in. (D) x 7-1/4 in. (H)
Weight:	Approx. 9.3 oz. (including battery)
Battery:	BT-990
Capacity	600 mA _H , 3.6V
Talk mode	4 hours
Standby mode	7 days

Specifications, features, and availability of optional accessories are all subject to change without prior notice.

At Uniden, we'll take care of you!

If you need any assistance with this product, please call our Customer Hotline at

1-800-297-1023

PLEASE DO NOT RETURN THIS PRODUCT TO THE PLACE OF PURCHASE.

Our Uniden representatives will be happy to help you with any matters regarding the operation of this unit, available accessories, or any other related matters.

Hours M-F 7:00 a.m. to 7:00 p.m. CST

Thank you for purchasing a Uniden product.

THANK YOU

FOR PURCHASING A UNIDEN PHONE

Uniden®

Covered by one or more of the following patents:

4,511,761	4,523,058	4,595,795	4,797,916	5,381,460
5,426,690	5,434,905	5,491,745	5,533,010	5,574,727
5,650,790	5,660,269	5,661,780	5,663,981	5,671,248
5,717,312	5,754,407	5,768,345	5,787,356	5,838,721

© 1999 Uniden America Corporation
All rights reserved. • Printed in China UCZZ01602BZ

Free Manuals Download Website

<http://myh66.com>

<http://usermanuals.us>

<http://www.somanuals.com>

<http://www.4manuals.cc>

<http://www.manual-lib.com>

<http://www.404manual.com>

<http://www.luxmanual.com>

<http://aubethermostatmanual.com>

Golf course search by state

<http://golfingnear.com>

Email search by domain

<http://emailbydomain.com>

Auto manuals search

<http://auto.somanuals.com>

TV manuals search

<http://tv.somanuals.com>