



Uniden[®]

UHF RADIO TRANSCEIVER

UH400SX
UH400SX-RM
UH500SX
UH500SX-RM

OWNER'S MANUAL







UNIDEN Model UH400SX, UH400SX-RM, UH500SX, UH500SX-RM OM

Contents

Introduction

- Features 3
- Preventive Maintenance..... 4
- Troubleshooting..... 4

Controls / Connectors..... 5

Indicators 9

Included with Your UHF CB Radio 10

Optional Accessories 11

DIN-E Installation (UH500SX, UH500SX-RM only) 12

Connecting the Microphone 14

Mounting the MIC Hanger 15

Operation

- Turning on the Power 17
- Setting the Manual Squelch (Base only) 17
- Setting the Auto Squelch..... 18
- Monitor 19
- Selecting a Channel 19
- Programming the Instant Priority Channel 20
- Recalling the Instant Channel 20
- Transmitting..... 20
- Call Function 20
- Dual Watch..... 20
- Using Repeater Channels 21
- Operating the UHF CB Radio in Duplex Mode 22
- Scanning 22
- Open Scan (OS) Mode..... 23
- Group Scan (GS) Mode 23
- Priority Watch..... 24
- Add/Remove Channels from SCAN Memory 24
- 40 RX Channels 25
- Manual Programming..... 25
- Deleting a programmed RX Channel frequency 25
- Selecting the Call tone 26
- Roger Beep 26
- Busy Channel Lockout 27
- VOX Operation (optional VOX headset required) 27
- CTCSS (Continuous Tone Coded Squelch System) 28
- DCS (Digital Coded Squelch)..... 28
- Beep On/Off 29
- Back Light 29
- LCD Contrast for Remote SPK/MIC 30

UHF CB Channels & Frequency List 31

CTCSS & DCS Code List 32

Warranty 33



UNIDEN Model UH400SX, UH400SX-RM, UH500SX, UH500SX-RM OM





UNIDEN Model UH400SX, UH400SX-RM, UH500SX, UH500SX-RM OM

Introduction

The Uniden UH400SX, UH400SX-RM, UH500SX and UH500SX-RM is designed to provide you with years of trouble free service. Its rugged components and materials are capable of withstanding harsh environments. Please read this Operating Manual carefully to ensure you gain the optimum performance of the unit.

NOTE

The citizen band radio service is licenced in Australia by ACMA Radio-communications (Citizen Band Radio Stations) Class Licence and in New Zealand by MED General User Licence for Citizen Band Radio and operation is subject to conditions contained in those licenses.

Features

- Transmit & Receive FM 40CH (UHF- CB, TX Power 5W)*
- 40 Programmable Receive channels (450 - 512MHz in 12.5khz steps)
- LCD Display with Backlight
- LCD Backlight brightness control ("HI", "LO", "Off")
- Compact Size**
- Mobile DIN Size***
- Front Fire Speaker***
- Signal Strength/ Power Meter
- Instant Channel Programming
- One touch Instant Channel recalling
- Dual Watch with Instant Channel
- Duplex Capability (from CH01 - CH08 per channel)
- Group Scan and Priority Channel Watch
- Open Scan
- Scan Channel Memory On/Off separately with Open Scan, Group Scan
- Rotary Channel Select
- Busy Channel Lock-out Function
- Roger Beep Function On/Off
- 5 Different Call Tones
- 38 Built-in CTCSS (Continuous Tone Coded Squelch System) and 104 additional DCS (Digital Coded Squelch) codes that are user selectable
- Volume Control with Power On/Off Push Switch
- VOX (Voice Activated Function)
- 10 Step VOX Mic sensitivity adjustment
- Remote LCD Speaker Microphone (Remote SPK/MIC)****
- Front and Rear MIC Jacks for increased mounting options
- Variable Squelch Level adjust or Auto Squelch with Remote SPK/MIC

* Transmission is inhibited at CH22 and CH23

** UH400SX

*** UH500SX

****The optional Remote SPK/MIC is included with UH400SX-RM and UH-500SX-RM models.



UNIDEN Model UH400SX, UH400SX-RM, UH500SX, UH500SX-RM OM

Introduction

Preventive Maintenance:

The following system checks should be made every six to twelve months:

- Check the Standing Wave Ratio (SWR).
- Inspect the tightness of all electrical connections.
- Inspect the antenna coaxial cable for wear or breaks on the shielding.
- Inspect the tightness of all screws and other mounting hardware.

Troubleshooting:

Should the unit malfunction or perform poorly, follow these procedures:

If the transceiver is completely inoperative: Check the power cord and fuse.

If there is trouble with receiving: Check the VOLUME control setting. Be sure the SQUELCH is adjusted properly. Possibly the radio is over-squelched.

If there is trouble with transmitting: Check that the transmission line (coaxial cable) is securely connected to the ANTENNA connector. Check that the antenna is fully extended for proper operation. Check that all transmission line (coaxial cable) connections are secure and free of corrosion.

NOTE

Blackening may occur on the Liquid Crystal Display if the UHF CB Radio or Remote SPK/MIC has been subjected to extreme high temperature (above 60°C). This is not a fault. Normal LCD operation resumes when the temperature stabilizes back to standard operating condition (0-55°C).

Controls/Connectors

UH400SX Front View

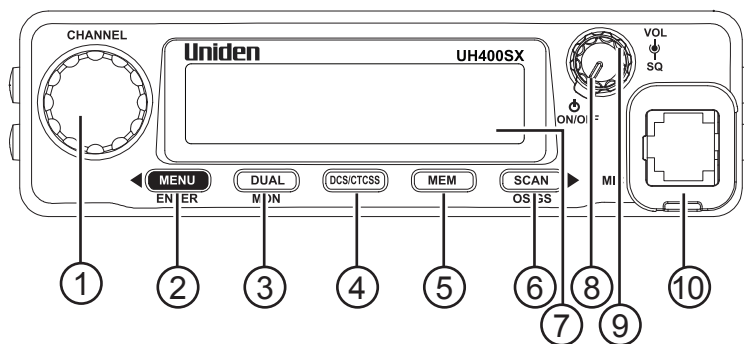

UH500SX Front View

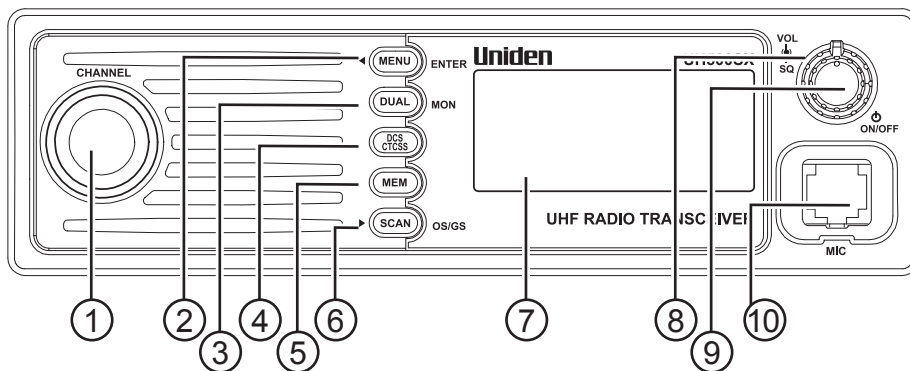

Controls and Connectors

- | | |
|--|---|
| <ol style="list-style-type: none"> 1. Rotary CHANNEL Selector 2. MENU/ENTER - Menu and Select Button 3. DUAL - Dual Watch
MON - Monitor Button 4. DCS/CTCSS - DCS and CTCSS Tone Button 5. MEM - Memory Scan Channels | <ol style="list-style-type: none"> 6. SCAN - Scan On/Off
OS/GS - Open or Group Scan 7. Liquid Crystal Display (LCD) 8. SQ - Rotary Squelch control 9. VOL - Rotary Volume control
ON/OFF - On/Off PUSH control 10. MIC - Front Microphone Jack |
|--|---|



UNIDEN Model UH400SX, UH400SX-RM, UH500SX, UH500SX-RM OM

Controls/Connectors

UH400SX Rear View

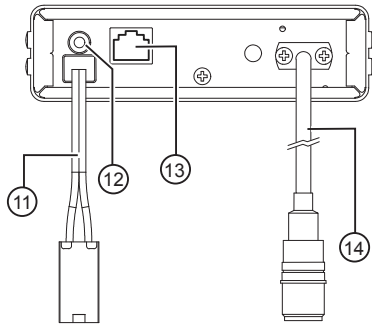

UH500SX Rear View

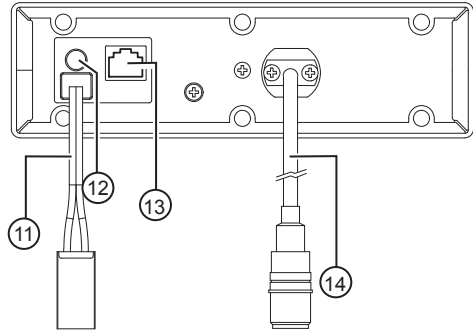

Connectors

11. Power Input Connection (13.8VDC)
12. Ext. Speaker Jack
13. Rear MIC Jack
14. UHF Antenna Connection

Controls/Connectors

Remote LCD Speaker Microphone (Remote SPK/MIC)

(optional accessory, included with UH400SX-RM, UH500SX-RM)

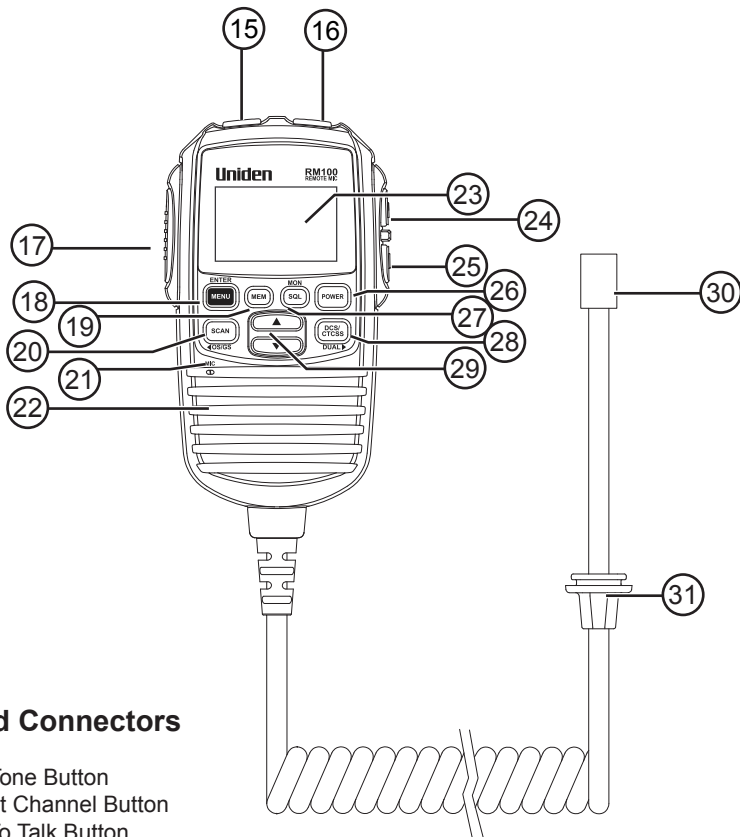

Controls and Connectors

- | | |
|---|-------------------------------------|
| 15 CALL - Call Tone Button | 26 POWER - Power ON/OFF Button |
| 16 INST - Instant Channel Button | 27 SQL - Auto Squelch |
| 17 PTT - Push To Talk Button | MON - Monitor Button |
| 18 MENU/ENTER - Menu and Select Button | 28 DCS/CTCSS -- DCS & CTCSS Button |
| 19 MEM - Memory Scan Channel | DUAL - Dual Watch Button |
| 20 SCAN - Scan Button | 29 ▲ ▼ - Select Up and Down Buttons |
| OS/GS - Open Scan/Group Scan | 30 RJ45 type plug |
| 21 MICROPHONE | 31 Front MIC Jack Cover |
| 22 SPEAKER | |
| 23 Liquid Crystal Display (LCD) | |
| 24 VOL ▲ - Volume Up Button
(for Remote SPK/MIC) | |
| 25 VOL ▼ - Volume Down Button
(for Remote SPK/MIC) | |



UNIDEN Model UH400SX, UH400SX-RM, UH500SX, UH500SX-RM OM

Controls/Connectors

Standard Microphone

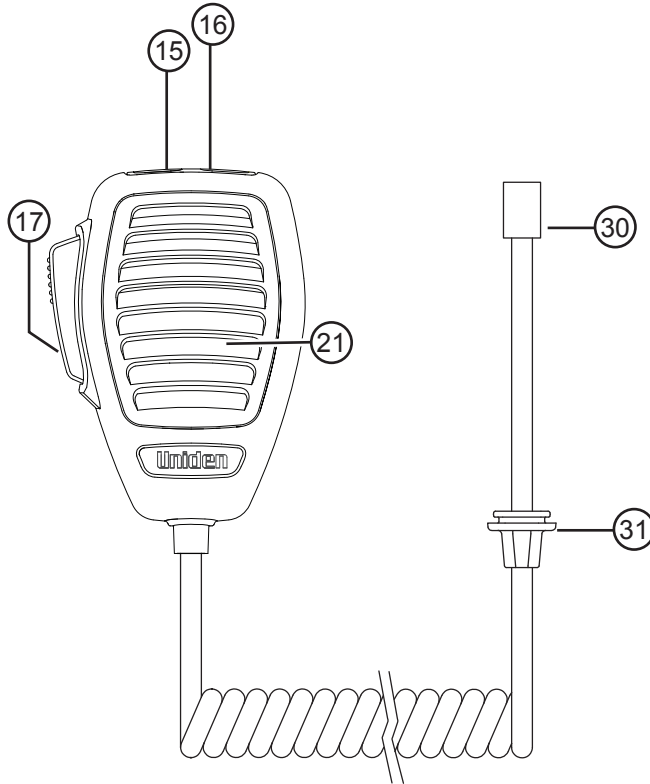

Controls and Connectors

- 15 CALL - Call Tone Button
- 16 INST - Instant Channel Button
- 17 PTT - Push To Talk Button
- 21 MICROPHONE
- 30 RJ45 type plug
- 31 Front MIC Jack Cover

Indicators

UH500SX and UH400SX LCD (not to scale)

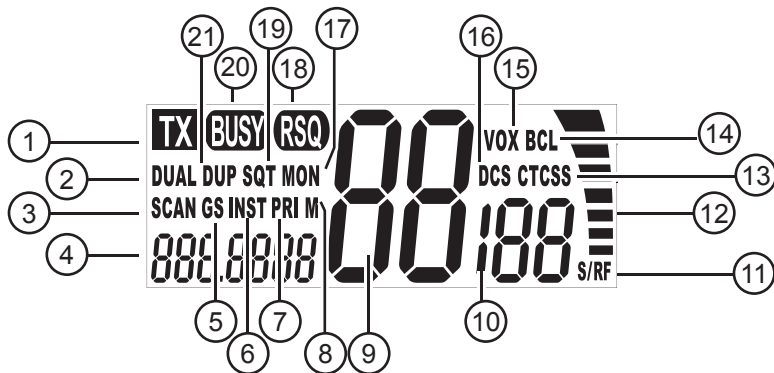

Remote MIC LCD

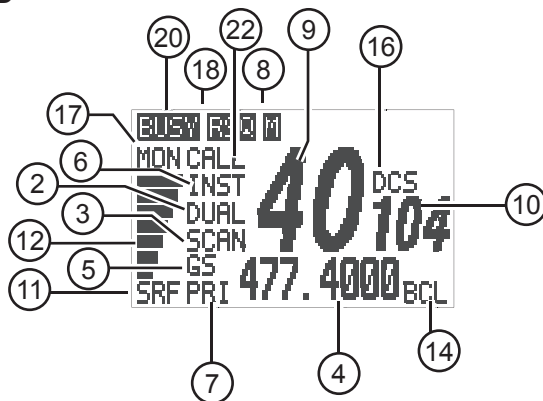

Indicators

- | | |
|--|--|
| <ol style="list-style-type: none"> 1. TX - Transmit 2. DUAL - Dual Watch 3. SCAN - Scan mode 4. Channel Frequency 5. GS - Group Scan 6. INST - Instant Channel 7. PRI - Priority Channel 8. M - Channel in Memory 9. Channel Number 10. DCS/CTCSS Code Number 11. S/RF - Receive Signal or Transmit 12. Signal Power Level | <ol style="list-style-type: none"> 13. CTCSS -Continuous Tone Coded Squelch System 14. BCL - Busy Channel Lockout 15. VOX - Voice Operated Microphone 16. DCS - Digital Coded Squelch 17. MON - Monitor 18. RSQ - Remote Mic Squelch 19. SQT - Tight Squelch Level 20. BUSY - Channel Active 21. DUP - Duplex Channel 22. CALL - Call Tone |
|--|--|



UNIDEN Model UH400SX, UH400SX-RM, UH500SX, UH500SX-RM OM

Included with your UHF CB Radio



Standard Microphone

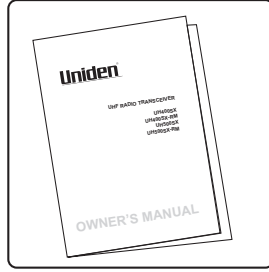

UHF CB Radio Owners Manual

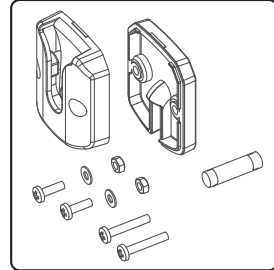

Microphone Hanger & Screws Washers and spare fuse

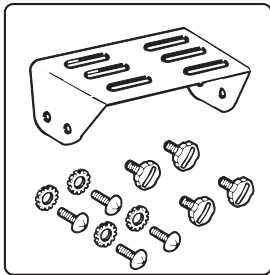

Mounting Bracket, Mounting Screws, Washer Stars And Screws (UH400SX and UH400SX-RM models only)

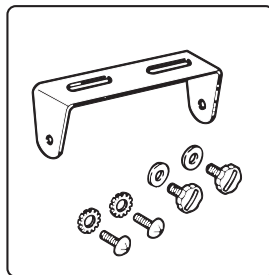

Mounting Bracket, Mounting Screws, Washer Stars And Screws (UH500SX and UH500SX-RM models only)

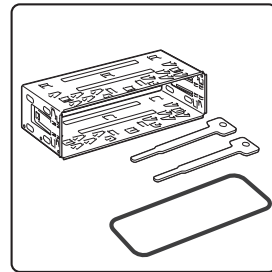

DIN-E Sleeve, DIN-E rubber ring and keys for vehicle installation (UH500SX and UH500SX-RM models only)



Remote LCD Speaker Microphone (UH400SX-RM and UH500SX-RM models only)

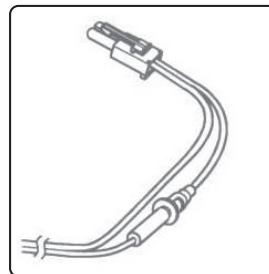

DC Power Cord with fuse



UNIDEN Model UH400SX, UH400SX-RM, UH500SX, UH500SX-RM OM

Optional Accessories

Optional Accessories

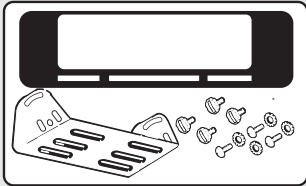

DIN Mounting Kit (DMK8990)
for compact models



Remote LCD Speaker
Microphone (RM100)



External Speaker (MS100)

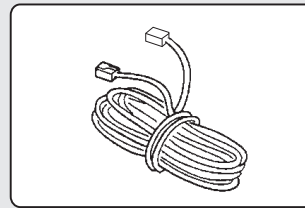

Extension cable kit RM100
(EC100)

- VOX Headset (VM091)



UNIDEN Model UH400SX, UH400SX-RM, UH500SX, UH500SX-RM OM

DIN-E Installation (UH500SX, UH500SX-RM Only)

Mounting Using the DIN-E Sleeve

If you are unsure about how to install your UH500SX in your vehicle using the DIN-E sleeve, consult your automobile manufacturer, dealer, or a qualified installer. Before installing, confirm that your UH500SX fits in the desired mounting area and you have all the necessary materials to complete the task. Your UH500SX requires a 53 x 183 x 135 mm mounting area. Allow an additional 60 mm space behind the unit for connectors and wires.

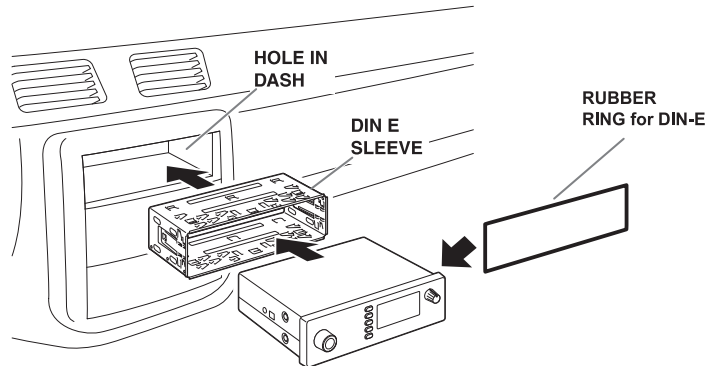

1. Remove the bracket if previously attached.
2. Install the DIN-E sleeve into the opening in your dashboard, lip facing out.
3. Push out the top and bottom tabs to hold the sleeve firmly in place.
4. Remove the flat rubber ring fitted around the cabinet sides near the front of the UH500SX. Fit the supplied DIN-E rubber ring in its place. When fitted the rubber ring will act as a seal against the DIN-E sleeve. At the left and right sides of the ring there will be a slot space.

NOTE

The slots in the fitted DIN-E Rubber Ring will enable proper removal of radio from the DIN-E sleeve.

5. Before inserting the UH500SX in the sleeve, attach the cable from the previously mounted antenna. Attach the DC Power leads. RED goes to a positive (+) connection on your fuse block while BLACK connects to the vehicle's chassis ground (-). Be sure all the connections are routed away from any potentially pinching or slicing sheet metal.
6. Slowly slide the UH500SX into the sleeve until it locks in place.

NOTE

If you plan to use the Rear MIC Jack or connect an external speaker at a later time, expect to remove the unit for ease of making those connections.



UNIDEN Model UH400SX, UH400SX-RM, UH500SX, UH500SX-RM OM

DIN-E Installation (UH500SX, UH500SX-RM Only)

Removing the UH500SX from the DIN-E Sleeve

If you plan to use the Rear MIC Jack or connect an external speaker, at a later time, you should plan to remove the UH500SX from the DIN-E sleeve. This is easily done using the provided Removal Keys.

Fully insert both Removal Keys straight into the slot spaces provided by the DIN-E rubber ring on the left and the right edges of the radio's dress panel. You cannot remove the radio if only one key is available.

Press in fully and the radio will unlock from the sleeve making withdrawal from the sleeve possible. Store the keys in a safe place for future use.

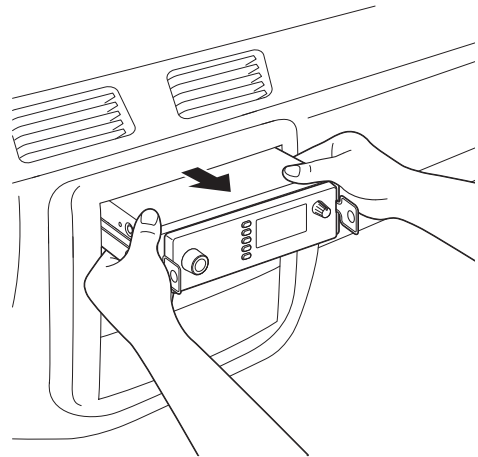
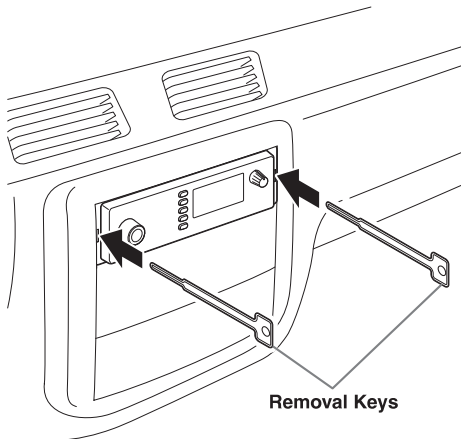



UNIDEN Model UH400SX, UH400SX-RM, UH500SX, UH500SX-RM OM

Connecting the Microphone

UH400SX

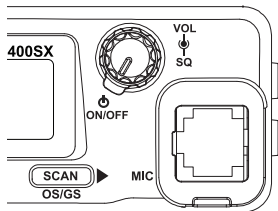

UH500SX

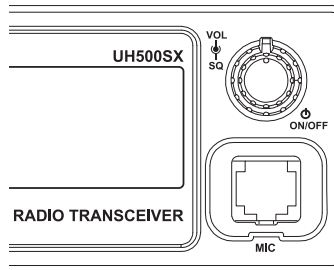

FRONT MIC JACK

Push the MIC plug at the end of the microphone into the MIC jack until the connection locks into place. Gently tug the MIC cord to test that the connection is locked. Use the Front MIC Jack cover which is threaded onto the MIC cord to seal the MIC jack entry from dust.

Disconnecting the MIC from the Front MIC Jack

Pull away the threaded rubber collar and move it down along the cord. Using the flat blade of a screwdriver or similar object carefully press the lock tab at the bottom (UH500SX) or left (UH400SX) side of the MIC plug and push it upwards (UH500SX) or to the right (UH400SX). At the same time tug on the MIC cord to draw back the MIC plug.

REAR MIC JACK

Use the Rear MIC Jack if the main base is mounted where a front MIC connection is intrusive or if you wish to use the Remote LCD Speaker MIC with an optional extension cable.

Peel the dust cover from the rear MIC jack. Push the MIC plug at the end of the microphone into the MIC jack until the connection locks into place. An optional 2m extension cable kit is available to enable mounting the main base in a hidden location.

NOTE

The Front and Rear MIC JACKs can not be used at the same time.



UNIDEN Model UH400SX, UH400SX-RM, UH500SX, UH500SX-RM OM

Mounting the MIC Hanger

MIC Hanger mounted over MIC Cable

NOTE

The curly cord of the Standard MIC and Remote SPK/MIC can extend up to 1.5m.

For practical mounting of the MIC Hanger using the threaded cord technique it is highly recommended to use this technique with the optional Extension Cable.

Using the second part of the MIC Hanger as a template mark and drill a single 13mm hole. The hole needs to be large enough (13mm min) to allow for the MIC plug of the microphone to fit through.

Feed RJ45 MIC plug through the hole and connect to the optional Extension Cable. Connect the other end of the Extension Cable to a MIC Jack on the radio.

Mount the MIC Hanger using the Screw (single part) or Double Sided Tape (two part) option described on the previous page, making sure the MIC Hanger is centred over the hole where the MIC cable is fed through. The single or two part MIC assembly has a routing cavity to allow fitting over the MIC cable.

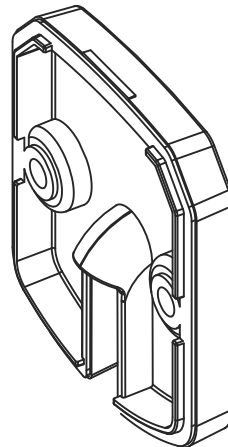



UNIDEN Model UH400SX, UH400SX-RM, UH500SX, UH500SX-RM OM

Operation

Turning on the Power

Press and hold the ON/OFF control at the base or the **[POWER]** button on the Remote SPK/MIC.

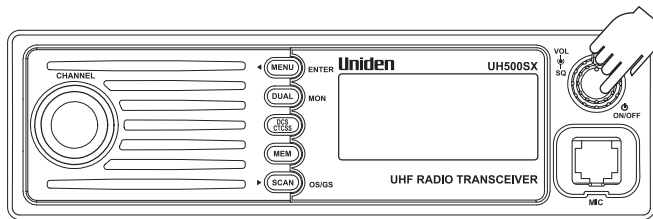
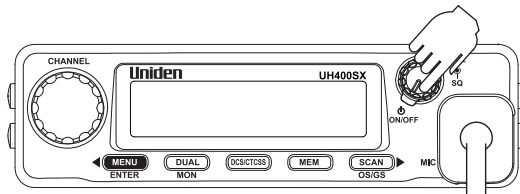

Setting the Manual Squelch (base only)

Turn the outer ring of the SQ control at the base to adjust the Squelch.



You must select a channel which is not in use before setting the SQUELCH control. (see p.19 for "Selecting a Channel").

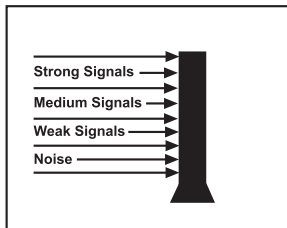

Think of the squelch control as a gate. If you turn Squelch fully clockwise it raises the 'Squelch gate' so high that no signals get through.

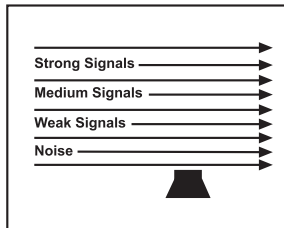

If you turn the Squelch fully counterclockwise it lowers the 'Squelch Gate' to the extent that all signals get through - weak, medium and strong signals and noise.

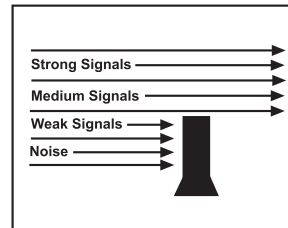

To set the 'Squelch Gate' to the desired level, turn the squelch knob counterclockwise until you hear noise. Then carefully turn the Squelch knob clockwise until the noise fades. Now only strong signals get through.



UNIDEN Model UH400SX, UH400SX-RM, UH500SX, UH500SX-RM OM

Operation

Setting the Auto Squelch

The Auto Squelch feature is available only when the Remote SPK/MIC is connected. It has an Off setting and 3 preset squelch levels:

- oFF - Auto Squelch OFF
- 1 - max sensitivity (min squelch)
- 2 - med sensitivity (med squelch)
- 3 - min sensitivity (max/tight squelch)
It requires no adjustment.



1. Press **[SQL/MON]** on the Remote SPK/MIC. The squelch setting flashes.
2. Rotate the channel knob at the base or press ▼ ▲ on the Remote SPK/MIC to change the setting. RSQ icon displays when Auto Squelch is active. If tight squelch is selected SQT icon will also flash.
3. Press **[MENU/ENTER]** to store the setting.

Operation

Monitor

Press and hold **[DUAL/MON]** at the base or **[SQL/MON]** on the Remote SPK/MIC to open the squelch and receive all weak signals. Press and hold **[DUAL/MON]** at the base or **[SQL/MON]** on the Remote SPK/MIC again to cancel.

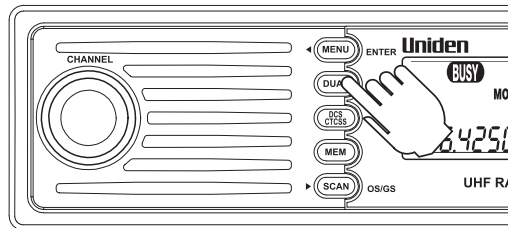
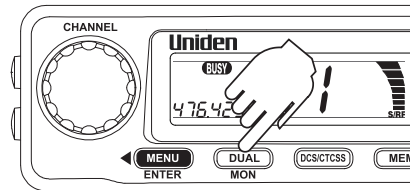
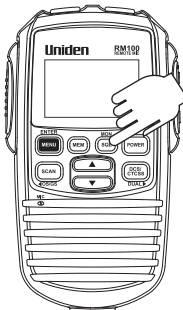

Selecting a Channel

Turn the Rotary Channel Selector at the base or press **▼▲** on the Remote SPK/MIC to select the desired channel.

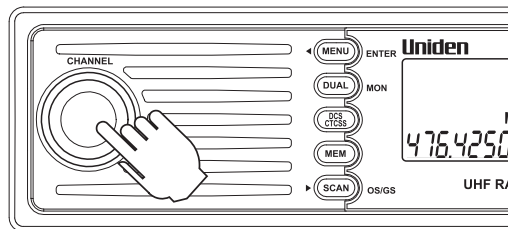
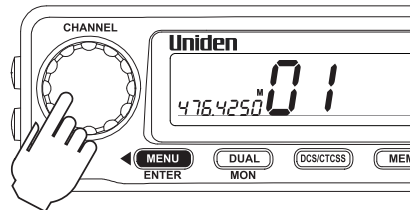
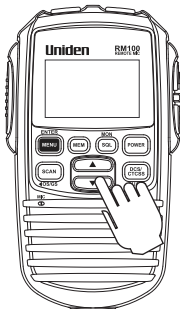

For your reference a list of the available channels, corresponding frequencies and guidelines for their use is printed on page 31. For Australia, Channels 05 and 35 are reserved for Emergency Calls.



UNIDEN Model UH400SX, UH400SX-RM, UH500SX, UH500SX-RM OM

Operation

Programming the Instant Priority Channel

Turn the Rotary Channel Selector at the base or press ▼ ▲ on the Remote SPK/MIC to select the Priority Channel you prefer.

Press and hold [INST] button on the microphone for 3 seconds to store the new setting. INST icon appears.

Recalling the Instant Channel

Momentarily press the [INST] button on the microphone at any time to return to the Instant Channel.

Transmitting

The UHF CB Radio uses the 40 UHF-CB Channels (Channels 22 and 23 are for telemetry and telecommand applications. Transmit is inhibited on these channels).

Select the desired channel. Press the microphone's PTT button and speak normally into the microphone. Hold it approx. 7cm from your mouth. Release the PTT button to end the transmission and listen for a reply.

Call Function

Press the microphone Call Button. A three second ringing tone will be transmitted.

You may select from 5 types of tones (see p.26).



Current regulations require calling tones to be restricted to one transmission per minute. If a second transmission is attempted within one minute then an error tone will sound.

DUAL Watch

Dual watch will continuously monitor the Instant channel no matter what other channel is on (see Programming the Instant Priority Channel above)

Press [DUAL/MON] on the base or press and hold [DCS/CTCSS/DUAL] on the Remote SPK/MIC. DUAL icon appears and a short tone beep is heard.

To cancel DUAL Watch press [DUAL/MON] on the base or press and hold [DCS/CTCSS/DUAL] on the Remote SPK/MIC. DUAL icon disappears.

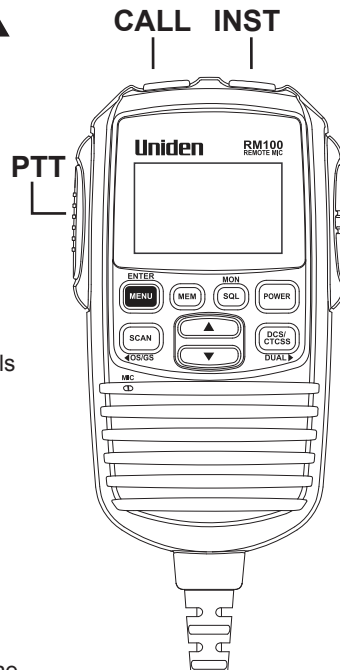



UNIDEN Model UH400SX, UH400SX-RM, UH500SX, UH500SX-RM OM

Operation

Using Repeater Channels

UHF CB repeaters are used to retransmit or relay your signal. Repeaters will extend the range of your radio and overcome the shielding effect caused by solid obstructions. In normal Simplex operation, your radio transmits on one particular frequency and receives on that same frequency.

If there is a barrier that partially blocks your transmitted signal, the probability of another radio receiving the signal is very slim. Hills, tall buildings, metallic structures,...etc tend to act as a screen between radios.

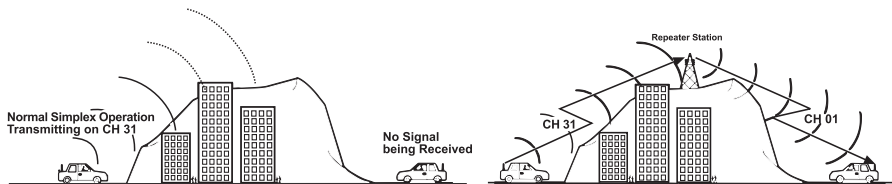

Standard Operation without the aid of a Repeater Station.

Operation with the aid of a Repeater Station (Duplex).

The signal coming from your radio is received by the Repeater Station and the re-transmitted at the same time on another channel. This operation is called "Duplexing".

For example,

CH01 on Duplex Mode will Receive on CH01 but Transmit on CH31

CH02 on Duplex Mode will Receive on CH02 but Transmit on CH32 etc...

If you transmit on CH01 Duplex mode, you are actually transmitting on CH31 the repeater station down-converts your signal and retransmits on CH01.

Operation

Operating the UHF CB Radio in Duplex Mode

For this example we are adopting CH01 as the channel being used in your area for repeater use.

1. Press **[MENU/ENTER]**. The duplex setting flashes.
2. Turn the Rotary Channel Selector at the base or press ▼ ▲ on the Remote SPK/MIC to change the setting between ON or OFF on the base or "0" or "r" on the Remote SPK/MIC.
3. Press **[MENU/ENTER]** to store the setting.
4. Press and hold **[MENU/ENTER]** to exit from the menu mode. Only channels 01 - 08 are available for Duplex.

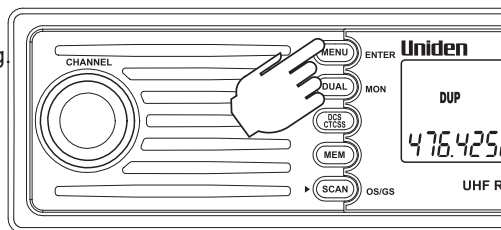
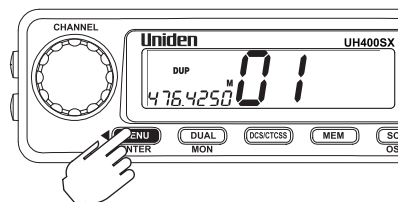

NOTE

Check with your local Retailer for information on available repeaters.

Scanning

The UHF CB Radio has a scanning feature that allows you to search for active channels automatically.

Furthermore, the UHF CB Radio is designed to have two types of scanning; Open Scanning (OS) and Group Scanning (GS), to give you flexibility and allow you to use the radio more effectively. Press **[SCAN/OS/GS]** and Scanning starts.

The SCAN icon appears. The scan direction can be changed at any time by rotating the channel selector left or right or pressing ▼ ▲ on the Remote SPK/MIC.

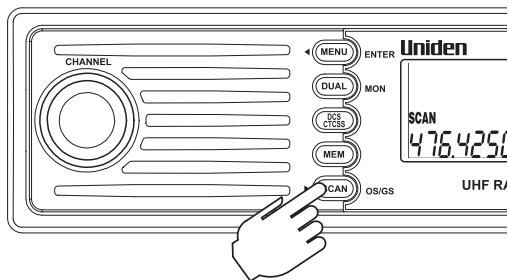
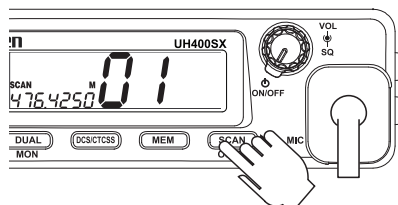

Operation

Open Scan (OS) Mode

Allows continuous scanning of all selected channels. If an active channel is found, scanning will stop on that channel. If the received signal ceases, the unit will wait 3 seconds for the signal to return, otherwise scanning resumes.



After transmission in scan mode, the unit will wait 20 seconds for the signal to return, otherwise scanning resumes.

To skip the active channel, turn the Rotary Channel Selector at the base or press ▼ ▲ on the Remote SPK/MIC momentarily. To deactivate SCAN, press **[SCAN/OS/GS]**.



If SCAN is deactivated while on an active channel, the UHF CB Radio will stay on that active channel. If no channels are active, the UHF CB Radio will reinstate the starting channel.



OS Mode is indicated by the absence of the GS icon.

Group Scan (GS) Mode

Includes the accessory feature Priority Watch which allows you to monitor the Instant Priority Channel while scanning (see p.20 for setting Instant Priority Channel and p.24 to turn on Priority Watch).

To use GS Mode Scanning, press and hold **[SCAN/OS/GS]**. GS icon appears on the display.

GS Scanning checks the Instant Priority Channel for activity regularly when Priority Watch is ON. If the Priority Channel becomes active the radio will stay on that channel for as long as the signal is present. If the received signal ceases, Priority Scanning continues after 3 seconds.

If scanning stops on a channel which is not a Priority Channel, UHF CB Radio will continue monitoring the Priority Channel for activity while listening to the active one.

To deactivate SCAN, press the **[SCAN/OS/GS]** button.

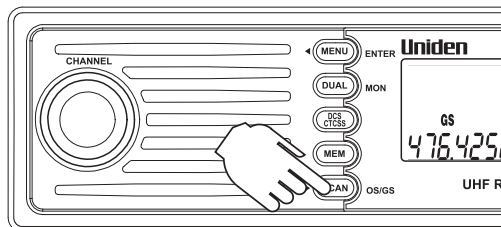
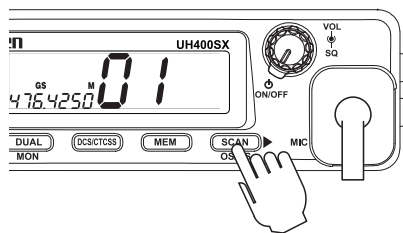

UNIDEN Model UH400SX, UH400SX-RM, UH500SX, UH500SX-RM OM

Operation

Priority Watch

To switch Priority Watch On/Off;

1. Press **[MENU/ENTER]** two times. The Priority Watch setting flashes.
2. Turn the Rotary Channel Selector at the base or press ▼ ▲ on the Remote SPK/MIC to change the setting between ON or OFF.
3. Press **[MENU/ENTER]** to store the setting.
4. Press and hold **[MENU/ENTER]** to exit from the menu mode.



*If SCAN is deactivated while it is tuned to an active channel, the UHF CB Radio will stay on that active channel.
If none of the channels are active, the UHF CB Radio will reinstate the scan start channel.*



If OS/GS Scanning is initiated when there are no channels programmed in OS/GS memory, an error tone will be heard and scanning will not start (see Programming Scan Channels - below).

Add/Remove Channels from SCAN Memory

Select which Scanning Mode you wish to use
- OS or GS.

Select the channel you want to store.

Press to **[MEM]** store. MEM icon appears
and a short tone beep is heard.

To remove the channel from SCAN memory,
press **[MEM]** once more.
The MEM icon disappears.

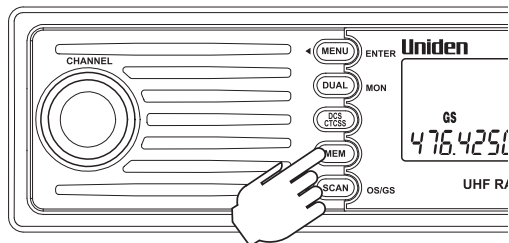
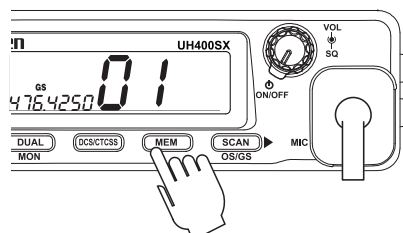



UNIDEN Model UH400SX, UH400SX-RM, UH500SX, UH500SX-RM OM

Operation

40 RX Channels

The radio has 40 receive only channels (CH41 to CH80) which can be programmed with frequencies ranging from 450-512MHz (in 12.5kHz steps).

Manual Programming

Turn power off.

Press and hold **[DUAL/MON]** at the base or **[SQL/MON]** on the Remote SPK/MIC while turning power on (pressing power switch on the base or **[POWER]** on the Remote SPK/MIC).

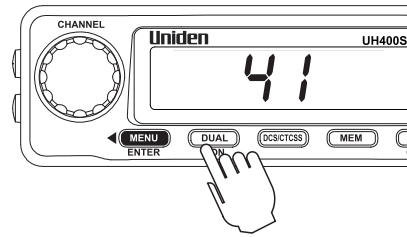

The channel indicator flashes the lowest available empty channel. You may use the rotary channel selector at the base or **▼ ▲** on the Remote SPK/MIC to select another channel from CH41 - CH80.

Press **[MEM]**. The MHz digits of the frequency indicator flashes. Turn the rotary channel selector at the base or press **▼ ▲** on the Remote SPK/MIC to select the desired MHz.

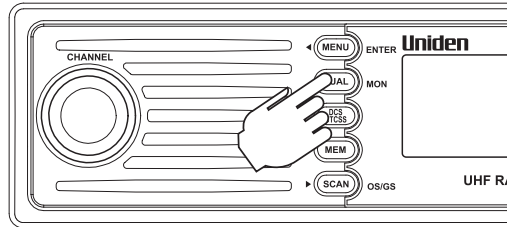

Press **[◀/MENU/ENTER]** and **[SCAN/OS/GS/▶]** at the base or **[◀/OS/GS/SCAN]** and **[DCS/CTCSS/DUAL/▶]** on the Remote SPK/MIC to change from the MHz digits to the kHz digits of the frequency, turn the rotary channel selector at the base or press **▼ ▲** on the Remote SPK/MIC to select the desired kHz.

When finished press **[MEM]**. The channel indicator flashes. Turn rotary channel selector at the base or press **▼ ▲** on the Remote SPK/MIC to select next channel for programming or press and hold **[MENU/ENTER]** to store setting.

A confirmation tone sounds. The channel is also entered into OS scan memory.

Deleting a programmed RX Channel frequency:

Follow the steps in Manual Programming to enter a frequency for a desired channel. Select 000 for the MHz digits and then press **[MEM]**. Select another channel to edit or press and hold **[MENU/ENTER]** again to exit programming mode.

Operation

Selecting the Call tone

1. Press **[MENU/ENTER]** four times.
The call tone setting flashes.
2. Turn the Rotary Channel Selector at the base or press **▼ ▲** on the Remote SPK/MIC to change the setting between 1, 2, 3, 4 and 5.
3. Press **[MENU/ENTER]** to store the setting.
4. Press and hold **[MENU/ENTER]** to exit from the menu mode.

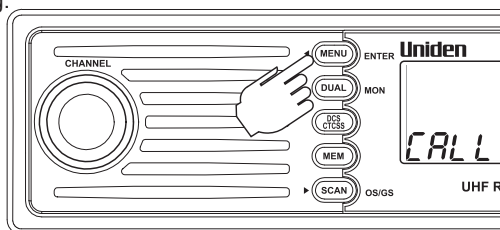
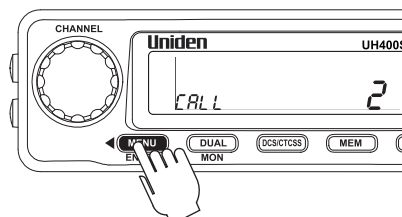

NOTE

If a button is not pressed within 10 seconds the UHF CB Radio will automatically exit the Menu Mode.

Roger Beep

1. Press **[MENU/ENTER]** six times.
The roger beep setting flashes.
2. Turn the Rotary Channel Selector at the base or press **▼ ▲** on the Remote SPK/MIC to change the setting between ON or OFF.
3. Press **[MENU/ENTER]** to store the setting.
4. Press and hold **[MENU/ENTER]** to exit from the menu mode.

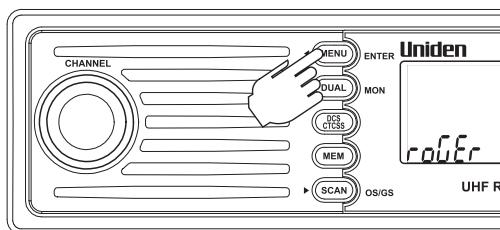
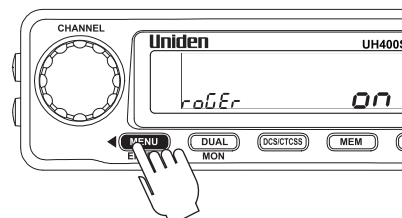

NOTE

If a button is not pressed within 10 seconds the UHF CB Radio will automatically exit the Menu Mode.



UNIDEN Model UH400SX, UH400SX-RM, UH500SX, UH500SX-RM OM

Operation

Busy Channel Lockout

If the channel is already in use, you can prevent the UHF CB Radio from transmitting. This is particularly important when using CTCSS/DCS.

1. Press **[MENU/ENTER]** five times.
The BCL setting flashes.
2. Turn the Rotary Channel Selector at the base or press ▼ ▲ on the Remote SPK/MIC to change the setting between ON or OFF.
3. Press **[MENU/ENTER]** to store the setting.
4. Press and hold **[MENU/ENTER]** to exit from the menu mode.

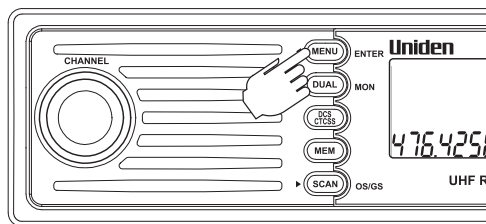
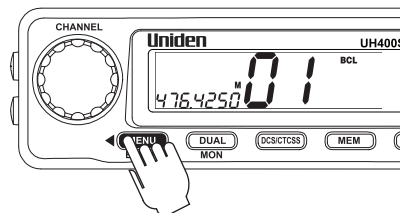

NOTE

If a button is not pressed within 10 seconds the UHF CB Radio will automatically exit the Menu Mode.

VOX Operation (optional VOX headset required)

1. Press **[MENU/ENTER]** three times.
The VOX setting flashes.
2. Turn the Rotary Channel Selector at the base or press ▼ ▲ on the Remote SPK/MIC to change the VOX sensitivity (oF (OFF), 1 (highest) - 9 (lowest)).
3. Press **[MENU/ENTER]** to store the setting.
4. Press and hold **[MENU/ENTER]** to exit from the menu mode.
5. Disconnect standard or Remote MIC and connect the VOX headset.

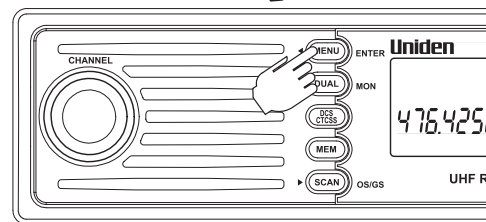
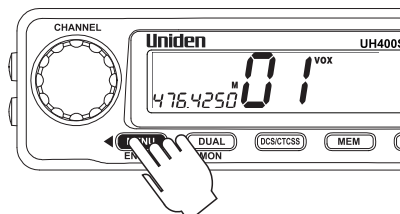

NOTE

- The VOX function works only with base in place of the standard MIC and Remote SPK/MIC.
- If a button is not pressed within 10 seconds the UHF CB Radio will automatically exit the Menu Mode.



UNIDEN Model UH400SX, UH400SX-RM, UH500SX, UH500SX-RM OM

Operation

CTCSS (Continuous Tone Coded Squelch System)

Turn the Rotary Channel Selector at the base or press ▼ ▲ on the Remote SPK/MIC the desired channel to use CTCSS. Press **[DCS/CTCSS]**. CTCSS icon appears.

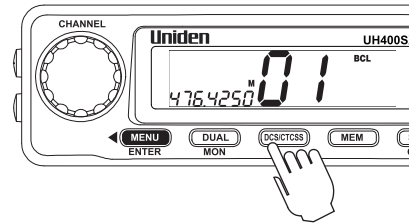

Turn the Rotary Channel Selector at the base or press ▼ ▲ on the Remote SPK/MIC to select the desired CTCSS code 01 - 38. Press **[DCS/CTCSS]** once to store the new setting. To turn off CTCSS (or DCS) select the of code during setting.

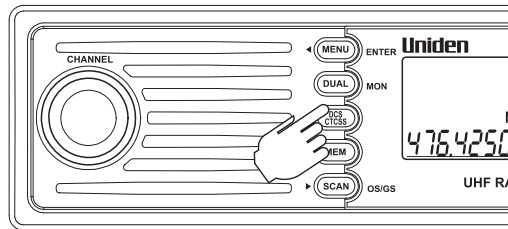

DCS (Digitally Coded Squelch)

DCS is a digital extension of CTCSS. It provides 104 extra, digitally coded, squelch codes that follow after the 38 CTCSS codes. CTCSS 1-38, followed by DCS 1-104.

Follow the steps for setting a CTCSS code. Turn the Rotary Channel Selector at the base or press ▼ ▲ on the Remote SPK/MIC until the DCS codes appear. Press **[DCS/CTCSS]** to set. The DCS icon and code will display.



UNIDEN Model UH400SX, UH400SX-RM, UH500SX, UH500SX-RM OM

Operation

Beep On/Off

1. Press **[MENU/ENTER]** seven times. The Beep setting flashes.
2. Turn the Rotary Channel Selector at the base or press ▼ ▲ on the Remote SPK/MIC to change the setting between ON or OFF.
3. Press **[MENU/ENTER]** to store the setting.
4. Press and hold **[MENU/ENTER]** to exit from the menu mode.

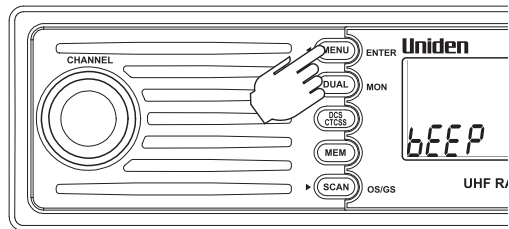
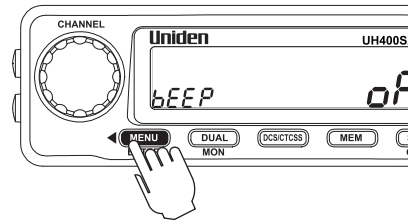

Back Light

1. Press **[MENU/ENTER]** eight times. The Backlight setting flashes.
2. Turn the Rotary Channel Selector at the base or press ▼ ▲ on the Remote SPK/MIC to change the setting between OFF, LO and HI.
3. Press **[MENU/ENTER]** to store the setting.
4. Press and hold **[MENU/ENTER]** to exit from the menu mode.

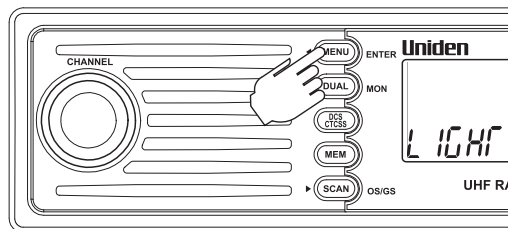
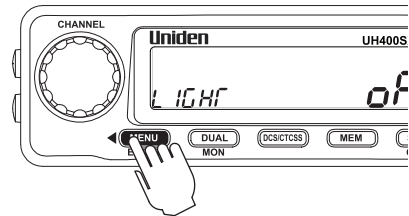



UNIDEN Model UH400SX, UH400SX-RM, UH500SX, UH500SX-RM OM

Operation

LCD Contrast for Remote SPK/MIC

The LCD Contrast option becomes available only when the Remote SPK/MIC is connected.

1. Press **[MENU/ENTER]** nine times. The LCD Contrast setting flashes.
2. Turn the Rotary Channel Selector at the base or press **▼ ▲** on the Remote SPK/MIC to change the setting between 01 (low contrast) to 10 (high contrast).
3. Press **[MENU/ENTER]** to store the setting.
4. Press and hold **[MENU/ENTER]** to exit from the menu mode.

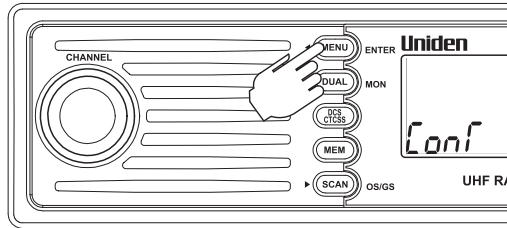
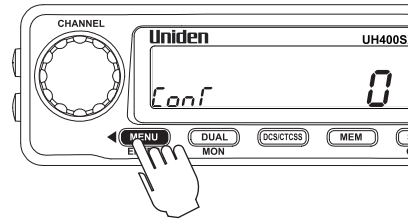

NOTE

The base LCD has a fixed contrast which cannot be changed.

UHF CB Channels & Frequencies

NOTE

Channels 5 and 35 are used for emergency channels. CTCSS and DCS will not operate on these channels.

Please follow these guidelines for channel use in Australia:

- *Channels 05 and 35 are Emergency Channels.*
- *Channel 11 is a Calling Channel.*
- *Channels 22 and 23 are for telemetry and telecommand applications and TX is inhibited on these channels.*

General communication is accepted on all other channels with these guidelines:

- *Channel 40 - road channel (Australia).*
- *Channels 01-08 (and 31-38) are repeater channels.*

CH No.	Simplex Mode Transmit / Receive Frequency (MHz)	Duplex Mode Transmit Frequency (MHz)	CH No.	Simplex Mode Transmit/Receive Frequency (Mhz)
1	476.425	477.175 CH31	21	476.925
2	476.450	477.200 CH32	22	476.950 (RX only)
3	476.475	477.225 CH33	23	476.975 (RX only)
4	476.500	477.250 CH34	24	477.000
5	476.525	477.275 CH35	25	477.025
6	476.550	477.300 CH36	26	477.050
7	476.575	477.325 CH37	27	477.075
8	476.600	477.350 CH38	28	477.100
9	476.625		29	477.125
10	476.650		30	477.150
11	476.675		31	477.175
12	476.700		32	477.200
13	476.725		33	477.225
14	476.750		34	477.250
15	476.775		35	477.275
16	476.800		36	477.300
17	476.825		37	477.325
18	476.850		38	477.350
19	476.875		39	477.375
20	476.900		40	477.400

CTCSS & DCS Code List

CTCSS Code LIST

Code No.	Frequency (Hz)	Code No.	Frequency (Hz)	Code No.	Frequency (Hz)
"oF"	OFF	13	103.5	26	162.2
1	67.0	14	107.2	27	167.9
2	71.9	15	110.9	28	173.8
3	74.4	16	114.8	29	179.9
4	77.0	17	118.8	30	186.2
5	79.7	18	123.0	31	192.8
6	82.5	19	127.3	32	203.5
7	85.4	20	131.8	33	210.7
8	88.5	21	136.5	34	218.1
9	91.5	22	141.3	35	225.7
10	94.8	23	146.2	36	233.6
11	97.4	24	151.4	37	241.8
12	100.0	25	156.7	38	250.3

DCS Code LIST

Code No.	DCS Code (Octal)	Code No.	DCS Code (Octal)	Code No.	DCS Code (Octal)	Code No.	DCS Code (Octal)
1	023	27	152	53	311	79	466
2	025	28	155	54	315	80	503
3	026	29	156	55	325	81	506
4	031	30	162	56	331	82	516
5	032	31	165	57	332	83	523
6	036	32	172	58	343	84	526
7	043	33	174	59	346	85	532
8	047	34	205	60	351	86	546
9	051	35	212	61	356	87	565
10	053	36	223	62	364	88	606
11	054	37	225	63	365	89	612
12	065	38	226	64	371	90	624
13	071	39	243	65	411	91	627
14	072	40	244	66	412	92	631
15	073	41	245	67	413	93	632
16	074	42	246	68	423	94	654
17	114	43	251	69	431	95	662
18	115	44	252	70	432	96	664
19	116	45	255	71	445	97	703
20	122	46	261	72	446	98	712
21	125	47	263	73	452	99	723
22	131	48	265	74	454	100	731
23	132	49	266	75	455	101	732
24	134	50	271	76	462	102	734
25	143	51	274	77	464	103	743
26	145	52	306	78	465	104	754



UNIDEN Model UH400SX, UH400SX-RM, UH500SX, UH500SX-RM OM

Warranty

UNIDEN UH400SX, UH400SX-RM, UH500SX and UH500SX-RM UHF CB TRANSCEIVER RADIO Two Year Limited Warranty

IMPORTANT Evidence of the original purchase is required for warranty service.

Warrantor: Uniden Australia Pty Limited ABN 58 001 865 498
Uniden New Zealand Limited

Elements of Warranty: Uniden warrants to the original retail owner for the duration of this warranty its UH400SX, UH400SX-RM, UH500SX and UH500SX-RM UHF CB TRANSCEIVER RADIO (hereinafter referred to as the Product), to be free from defects in materials and craftsmanship with only the limitations or exclusions set out below.

Warranty Duration: This warranty to the original retail owner only is only valid in the original country of purchase and shall be of no further effect 2 years after the date of original retail sale. This warranty will be deemed invalid if the Product is: (A) Damaged or not maintained as reasonable and necessary, (B) Modified, altered or used as part of any conversion kits, subassemblies, or any configurations not sold by Uniden, (C) Improperly installed, (D) Repaired by someone other than an authorized Uniden Repair Agent for a defect or malfunction covered by this warranty, (E) Used in conjunction with any equipment or parts or as a part of a system not manufactured by Uniden. (F) Only available in the original country of sale.

Parts Covered: This warranty covers for two (2) years, the Product and included accessories.

Statement of Remedy: In the event that the Product does not conform to this warranty at any time while this warranty is in effect, the warrantor, at its discretion, will repair the defect or replace the Product and return it to you without charge for parts and service. This warranty does not provide for reimbursement or payment of incidental or consequential damages. This EXPRESS WARRANTY is in addition to and does not in any way affect your rights under the TRADE PRACTICES ACT 1974 (Cth) (Australia) or the CONSUMER GUARANTEES ACT (New Zealand).

Procedure for obtaining performance or warranty: in the event that the Product does not conform to this warranty, the Product should be shipped or delivered, freight prepaid, with evidence of original purchase (e.g. a copy of the sales docket) to the warrantor at:

UNIDEN AUSTRALIA PTY LTD
Service Division
345 Princes Highway,
Rockdale, NSW 2216
Fax (02) 9599 3278
www.uniden.com.au

UNIDEN NEW ZEALAND LTD
Service Division
150 Harris Road, East Tamaki,
Auckland
Fax (09) 274 4253
www.uniden.co.nz



Uniden®

© 2008 Uniden Australia Pty Limited/Uniden New Zealand Limited
Printed in China UTZZ01940ZZ(0)



Free Manuals Download Website

<http://myh66.com>

<http://usermanuals.us>

<http://www.somanuals.com>

<http://www.4manuals.cc>

<http://www.manual-lib.com>

<http://www.404manual.com>

<http://www.luxmanual.com>

<http://aubethermostatmanual.com>

Golf course search by state

<http://golfingnear.com>

Email search by domain

<http://emailbydomain.com>

Auto manuals search

<http://auto.somanuals.com>

TV manuals search

<http://tv.somanuals.com>