



Project: _____
 Location: _____
 Item #: _____
 Quantity: _____

Undercounter Refrigerators

Two Section Model with Stainless Steel Top

UR-48-SST

Case front, doors, top and ends of stainless steel. One piece ABS interior liner with stainless steel coil housing.

Two Section Model with Stainless Steel Top and Backsplash

UR-48-SBS

Case front, doors, top and ends of stainless steel. One piece ABS interior liner with stainless steel coil housing.



Standard Features:

- Interior Thermometer
- Easy Closing Doors with One Piece Magnetic Gasket
- One Piece Heavy-Duty Door Handles
- Heavy-Duty Vinyl Coated Steel Shelves
- High Density Foamed-in-Place Polyurethane Insulation
- High Impact One Piece ABS Interior Liner
- Plasticized Fin Coil
- Automatic Condensate Evaporator
- Energy Efficient Refrigeration System with Automatic Defrost
- Environmentally Friendly R-134a Refrigerant
- Cord and Plug Attached
- Adjustable Legs
- Completely Enclosed Cabinet Back

Optional Features and Accessories:

- Door Lock(s)
- Change Door Swing
- Stainless Steel Back
- 5" Diameter Heavy-Duty Swivel Casters with Brakes
- 3" Diameter Heavy-Duty Swivel Casters with Brakes
- Adjustable Stainless Steel Legs

Standard Features:

- Interior Thermometer
- Easy Closing Doors with One Piece Magnetic Gasket
- One Piece Heavy-Duty Door Handles
- Heavy-Duty Vinyl Coated Steel Shelves
- High Density Foamed-in-Place Polyurethane Insulation
- High Impact One Piece ABS Interior Liner
- Plasticized Fin Coil
- Automatic Condensate Evaporator
- Energy Efficient Refrigeration System with Automatic Defrost
- Environmentally Friendly R-134a Refrigerant
- Cord and Plug Attached
- Adjustable Legs
- Completely Enclosed Cabinet Back

Optional Features and Accessories:

- Door Lock(s)
- Change Door Swing
- Stainless Steel Back
- 5" Diameter Heavy-Duty Swivel Casters with Brakes
- 3" Diameter Heavy-Duty Swivel Casters with Brakes
- Adjustable Stainless Steel Legs

Approvals:



Victory Refrigeration specification sheets are available online at www.victory-refrig.com.

| CHARACTERISTICS | UR-48-SST | UR-48-SBS |
|-----------------------------------|-----------|-----------|
| Width, Overall | 48 | 48 |
| Depth, Overall (incl. handles) | 30 1/2 | 30 1/2 |
| Height, Overall (incl. adj. legs) | 36 | 40 3/8 |
| Depth, Open Door 90° | 52 1/8 | 52 1/8 |
| Clear Door Opening, Width | 23 3/8 | 23 3/8 |
| Clear Full Door Opening, Height | 25 3/4 | 25 3/4 |
| Capacity Net (cubic feet) | 12.5 | 12.5 |
| No. of Full Doors | 2 | 2 |
| No. of Shelves | 4 | 4 |
| Shelf Area (square feet) | 12.7 | 12.7 |
| Cabinet Voltage | 115/60/1 | 115/60/1 |
| Feed Wires | 2 | 2 |
| Condensing Unit Voltage | 115/60/1 | 115/60/1 |
| Condensing Unit Size (HP) | 1/5 | 1/5 |
| Total Amperes | 6.7 | 6.7 |

| Crated dim. & wts. | Ht. | Width | Depth | Cu. Ft. | Lbs. |
|--------------------|-----|--------|-------|---------|------|
| UR-48-SST | 43 | 53 1/2 | 33 | 44.6 | 225 |
| UR-48-SBS | 43 | 53 1/2 | 33 | 44.6 | 225 |

Dimensional tolerance ± 1/4" Metric dimensions (MM)

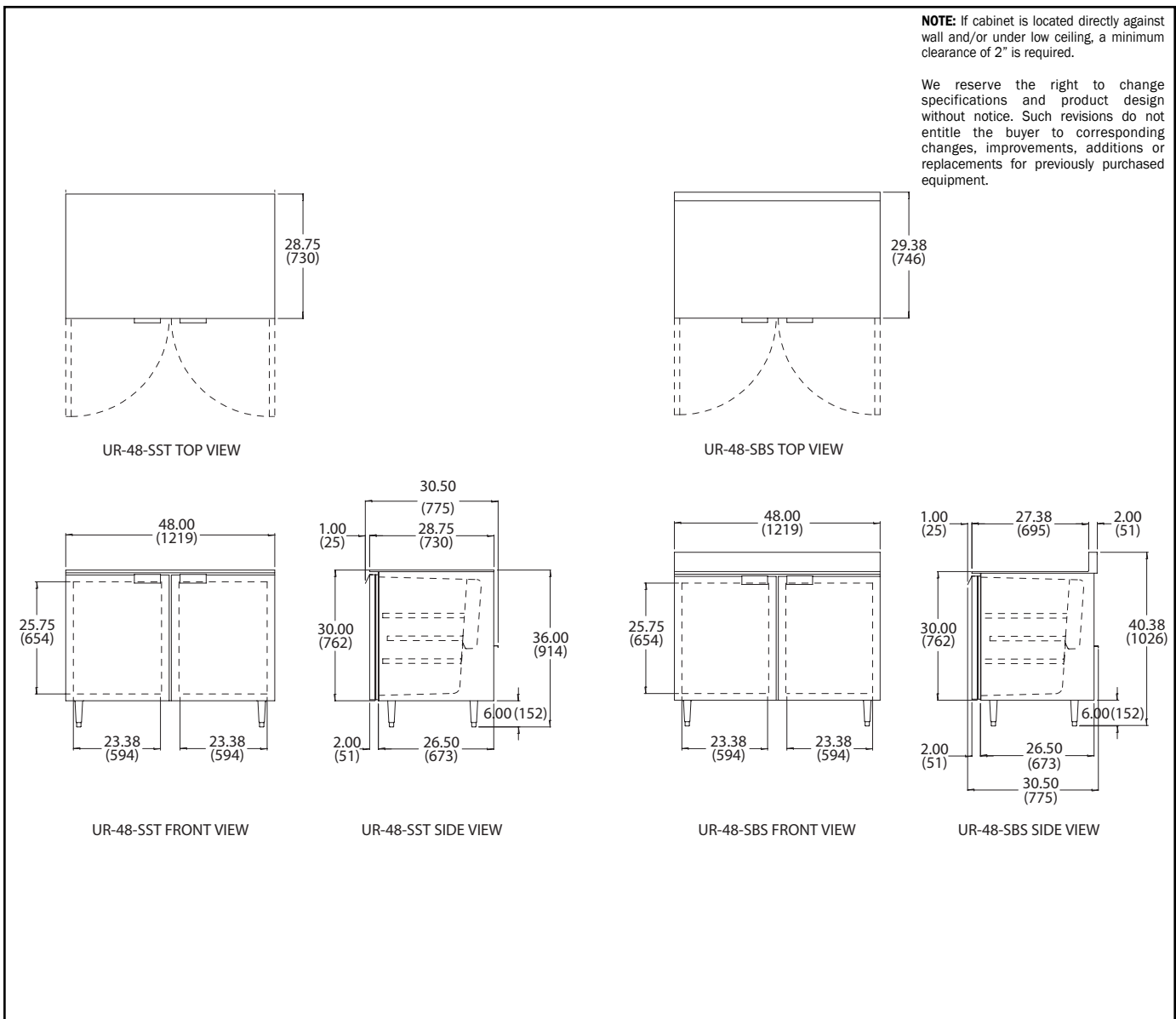

Continuous product development may necessitate specification changes and design without notice.



Victory participates in the KCL CADalog, the most current source of CAD symbols for foodservice designers worldwide. Symbols include standard equipment in plan, side, front and 3-D views, layered for FEDA/FCSI recommended guidelines.

Free Manuals Download Website

<http://myh66.com>

<http://usermanuals.us>

<http://www.somanuals.com>

<http://www.4manuals.cc>

<http://www.manual-lib.com>

<http://www.404manual.com>

<http://www.luxmanual.com>

<http://aubethermostatmanual.com>

Golf course search by state

<http://golfingnear.com>

Email search by domain

<http://emailbydomain.com>

Auto manuals search

<http://auto.somanuals.com>

TV manuals search

<http://tv.somanuals.com>