

# Viking Use & Care Manual

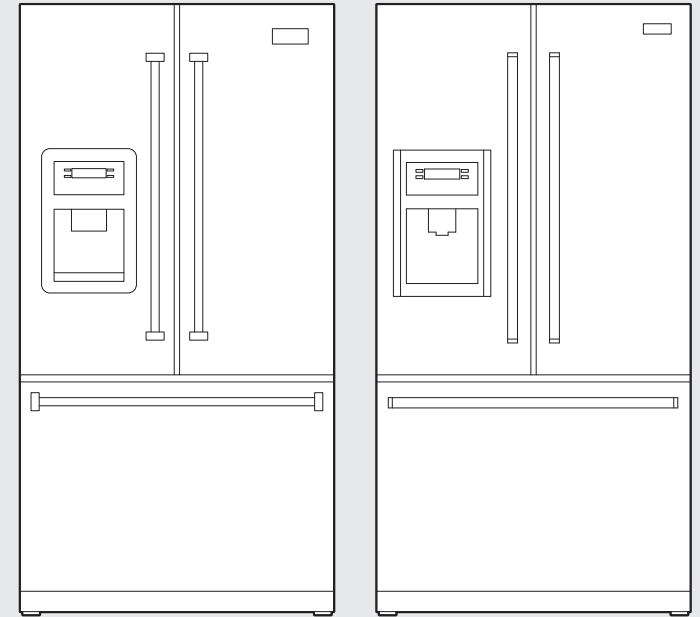

Viking Range Corporation  
111 Front Street  
Greenwood, Mississippi 38930 USA  
(662) 455-1200

For product information,  
call 1-888-VIKING1 (845-4641)  
or visit the Viking Web site at  
[vikingrange.com](http://vikingrange.com)

Freestanding French Door  
Bottom-Mount Refrigerator/Freezer  
with Dispenser

# Congratulations

Congratulations and welcome to the elite world of Viking ownership. We hope you will enjoy and appreciate the care and attention we have put into every detail of your new, state-of-the-art refrigerator.

Your Viking appliance is designed to offer years of reliable service. This Use and Care Guide will provide you with the information you need to become familiar with your refrigerator's care and operation.

Your complete satisfaction is our ultimate goal. If you have any questions or comments about this product, please contact the dealer from whom you purchased it, or contact our Consumer Support Center at 1-888-VIKING1.

We appreciate your choice of a Viking refrigerator and hope that you will again select our products for your other major appliance needs.

For more information about the complete and growing selection of Viking products, contact your dealer or visit us online at [vikingrange.com](http://vikingrange.com)

# Table of Contents

## Getting Started

Refrigerator Safety	4
Important Safety Instructions	5
Proper Disposal (of old refrigerator)	6
Using the Controls	7

## Product Controls

Temperature Controls	8
Adjusting Controls	9
Options	10
User Settings	12

## Operation

Opening & Closing Doors	15
Ice Maker & Ice Storage Bin	15
Water & Ice Dispenser	17
Water Filtration System	19
Water Filter	21
Water Filter Certifications	23

## Product Care

Cleaning	24
Changing the Light Bulb	25
Troubleshooting	26
Service Information	32
Warranty	33

# Refrigerator Safety

## Your safety and the safety of others are very important.

We have provided many important safety messages in this manual and on your appliance. Always read and obey all safety messages.



This is the safety alert symbol.

This symbol alerts you to potential hazards that can kill or hurt you and others.

All safety messages will follow the safety alert symbol and either the word "DANGER" or "WARNING."

## DANGER

You can be killed or seriously injured if you don't immediately follow instructions

## WARNING

You can be killed or seriously injured if you don't follow instructions.

All safety messages will tell you what the potential hazard is, tell you how to reduce the chance of injury, and tell you what can happen if the instructions are not followed.

# Important Safety Instructions

**WARNING:** To reduce the risk of fire, electric shock, or injury when using your refrigerator, follow these basic precautions:

- Plug into a grounded 3-prong outlet.
- DO NOT remove ground prong.
- DO NOT use an adapter.
- DO NOT use an extension cord.
- Disconnect power before servicing.
- Replace all parts and panels before operating.
- Remove doors from your old refrigerator.
- Use nonflammable cleaner.
- Keep flammable materials and vapors, such as gasoline, away from refrigerator.
- Use two or more people to move and install refrigerator.
- Disconnect power before installing ice maker (on ice maker kit ready models only).
- Use a sturdy glass when dispensing ice (on some models).

**SAVE THESE INSTRUCTIONS**

## Proper Disposal (of old refrigerator)

### **⚠ WARNING**

#### **Suffocation Hazard**

**Remove doors from your old refrigerator.**

**Failure to do so can result in death or brain damage.**

#### **IMPORTANT:**

Child entrapment and suffocation are not problems of the past. Junked or abandoned refrigerators are still dangerous—even if they will sit for “just a few days”. If you are getting rid of your old refrigerator, please follow these instructions to help avoid accidents.

#### **Before You Throw Away Your Old Refrigerator or Freezer:**

- Take off the doors.
- Leave the shelves in place so that children may not easily climb inside.

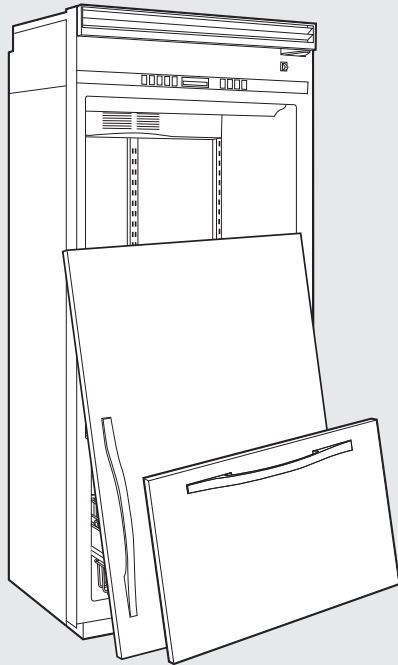

## Using the Controls

- The control panel is located on the front of the ice and water dispenser.
- To access the main control menu, press any of the four touch pads located on either side of the display. Then, touch the pad next to the desired option or user setting to access the various features.

**Note:** Press only the touch pads next to your selection on the display screen, not the selection itself.

**IMPORTANT:** Wait 24 hours for your refrigerator to cool completely before adding food. If you add food before the refrigerator has cooled completely, your food may spoil.

**Note:** Adjusting the refrigerator and freezer temperature controls to a colder than recommended setting will not cool the compartments any faster.

- The recommended settings should be correct for normal household refrigerator use. The controls are set correctly when milk or juice is as cold as you like and when ice cream is firm.
- If the temperature is too warm or too cold in the refrigerator or freezer, first check the air vents to be sure they are not blocked before adjusting the controls.

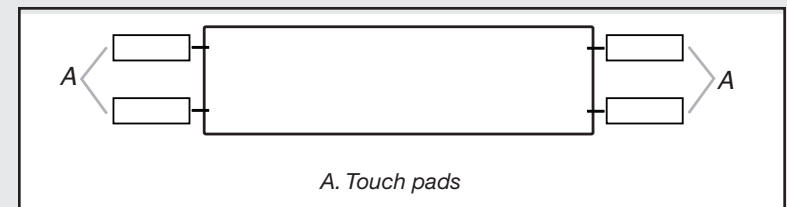

# Temperature Controls

For your convenience, your temperature controls are preset at the factory. When you first install your refrigerator, make sure the controls are still set to the recommended set points.

- Press the touch pad next to "FRESH FOOD TEMP" on the main menu to display the current set point of the compartment. Press the touch pad next to "WARMER" or "COLDER" to adjust the set point to the recommended 38°F. Press the touch pad next to "DONE" to lock in the setting.
- Press the touch pad next to "FREEZER TEMP" on the main menu to display the current set point of the compartment. Press the touch pad next to "WARMER" or "COLDER" to adjust the set point to the recommended 0°F. Press the touch pad next to "DONE" to lock in the setting.

## To Turn Cooling Off/On:

Cooling Off controls all cooling functions, the control panel and the dispenser. It does not disconnect power to the refrigerator.

- Press and hold the "COOLING OFF" touch pad for three seconds. The LED will light up to indicate that cooling is OFF. Neither compartment will cool.
- Press the "COOLING OFF" touch pad again to turn "ON" the cooling. The LED will turn off.

# Adjusting Controls

## Adjusting Controls

The Fresh Food Temp control adjusts the refrigerator compartment temperature. The Freezer Temp control adjusts the freezer compartment temperature.

If you need to adjust the temperature in either the refrigerator or freezer compartment, use the settings listed in the chart as a guide.

## To Adjust Set Point Temperatures:

The display will show the set point for approximately three seconds.

- Press the touch pad next to "WARMER" or "COLDER" to adjust the set point to the desired temperature. Then, press the touch pad next to "DONE" to lock in the new set point temperature.

**Note:** Except when first turning on the refrigerator, DO NOT adjust either temperature control more than one setting at a time. Wait 24 hours for the temperature to stabilize between adjustments.

## Temperature Adjustment Chart

Condition/Reason	Adjustment
Refrigerator too warm	Fresh Food Control 1° lower
Freezer too warm/too little ice	Freezer Control 1° lower
Refrigerator too cold	Fresh Food Control 1° higher
Freezer too cold	Freezer Control 1° higher

# Options

## Door Alarm

The Door Alarm feature sounds an audible alarm every few seconds when either refrigerator door has been left open for three continuous minutes. The alarm will sound until the door is closed or Door Alarm is turned off.

1. On the main menu, press the touch pad next to "OPTIONS".
2. Press the touch pad next to "DOOR ALARM IS ON" to switch between ON and OFF. Press the touch pad next to "DONE" to lock in the desired setting and return to the main menu.

## Humidity Control

The Humidity Control feature turns on a heater to help reduce moisture on the door hinge seal. Use in humid environments or when you notice moisture on the door hinge seal. The refrigerator uses more energy when Humidity Control is on.

1. On the main menu, press the touch pad next to "OPTIONS".
2. Press the touch pad next to "HUMID CTRL IS ON" to switch between ON and OFF. Press the touch pad next to "Done" to lock in the desired setting and return to the main menu.

## Vacation Mode

The Vacation Mode feature decreases the number of automatic defrost cycles. Once set, Vacation Mode will remain on until a door is opened or the feature is turned "OFF" on the control panel.

**Note:** Door openings are ignored for the first hour after Vacation Mode is activated.

1. On the main menu, press the touch pad next to "OPTIONS".
2. In each of the following screens, continue to press the touch pad next to "MORE OPTIONS" until "VAC. MODE IS OFF" appears on the display.
3. Press the touch pad next to "VAC. MODE IS OFF" to switch between ON and OFF. Press the touch pad next to "DONE" to lock in the desired setting and return to the main menu.

# Options

## Max Cool

The Max Cool feature assists with periods of high refrigerator or freezer use, full grocery loads, or temporarily warm room temperatures by lowering the freezer and refrigerator to the minimum temperatures.

1. On the main menu, press the touch pad next to "OPTIONS".
2. In each of the following screens, continue to press the touch pad next to "MORE OPTIONS" until "MAX COOL IS OFF" appears on the display.
3. Press the touch pad next to "MAX COOL IS OFF" to switch between ON and OFF. Press the touch pad next to "DONE" to lock in the desired setting and return to the main menu.

**Note:** The Max Cool feature will automatically shut off in approximately two hours.

## Sabbath Mode

The Sabbath Mode feature turns off all lights, disables the water and ice dispenser, disables all alarms and tones, disables the automatic defrost feature and disables the control panel.

While the refrigerator is operating in Sabbath Mode, any touch of the control panel will display the Sabbath Mode control which will allow you to turn OFF the Sabbath Mode feature.

### Turn Sabbath Mode on:

1. On the main menu, press the touch pad next to "OPTIONS".
2. In each of the following screens, continue to press the touch pad next to "MORE OPTIONS" until "SABBATH IS OFF" appears on the display.
3. Press the touch pad next to "SABBATH IS OFF" to switch between ON and OFF. Press the touch pad next to "DONE" to lock in the desired setting and return to the main menu.

## Temp Alarm

The Temp Alarm feature alerts you if the temperature exceeds normal operating temperatures, for an hour or longer, in either or both the refrigerator and freezer compartments. An audible alarm will sound repeatedly and the highest temperature reached in each compartment will be displayed.

**Note:** Touch any pad on the control panel to turn off the audible alarm. Temp Alarm will automatically reset once the warm condition has been corrected for 30 minutes.

# Options

## Temp Alarm (cont.)

1. On the main menu, press the touch pad next to "OPTIONS".
2. In each of the following screens, continue to press the touch pad next to "MORE OPTIONS" until "TEMP ALARM IS OFF" appears on the display.
3. Press the touch pad next to "TEMP ALARM IS OFF" to switch between ON and OFF. Press the touch pad next to "DONE" to lock in the desired setting and return to the main menu.

## Replace H2O Water Filter

See "Water Filtration System" section.

# User Settings

The control center allows you to set user preferences, if desired.

## Language

The Language preference allows you to change the control panel display to English, French or Spanish.

1. On the main menu, press the touch pad next to "USER SETTINGS".
2. Press the touch pad next to "SELECT LANGUAGE".
3. Press the touch pad next to either "METTRE EN FRANÇAIS" or "CAMBIAR EN ESPAÑOL." Press the touch pad next to "CONFIRM" to lock in the setting and return to the main menu.

## Temperature Display

The temperature display preference allows you to change the control panel display from degrees Fahrenheit to degrees Celsius.

1. On the main menu, press the touch pad next to "USER SETTINGS".
2. Press the touch pad next to "FAHRENHEIT IS ON" to switch between Fahrenheit and Celsius. Press the touch pad next to "DONE" to lock in the desired setting and return to the main menu.

# User Settings

## Display Brightness

The Display Brightness preference adjusts the backlight level of the control panel.

1. On the main menu, press the touch pad next to "USER SETTINGS".
2. In each of the following screens, continue to press the touch pad next to "MORE SETTINGS" until "DISPLAY BRIGHTNESS" appears on the display.
3. Press the touch pad next to "LIGHTER" or "DARKER" to adjust the setting between 1 (darkest) and 5 (lightest). Press the touch pad next to "DONE" to lock in the desired setting and return to the main menu.

## Adjust Light Sensor

The Adjust Light Sensor preference allows you to adjust the level at which the Light Sensor will detect darkness and activate the Auto On mode for the dispenser light.

1. On the main menu, press the touch pad next to "USER SETTINGS".
2. In each of the following screens, continue to press the touch pad next to "MORE SETTINGS" until "ADJUST LIGHT SENSOR" appears on the display.
3. Press the touch pad next to "LIGHTER" or "DARKER" to adjust the setting between 1 (darkest) and 9 (lightest). Press the touch pad next to "DONE" to lock in the desired setting.

## Alarm Sound

The Alarm Sound preference allows you to turn off any audible alarms (door open, too warm etc.) when quick and simple remedies are not possible. It will not disable alarm features or visual displays.

1. On the main menu, press the touch pad next to "USER SETTINGS".
2. In each of the following screens, continue to press the touch pad next to "MORE SETTINGS" until "ALARM SOUND IS ON" appears on the display.
3. Press the touch pad next to "ALARM SOUND IS ON" to switch between ON and OFF. Press the touch pad next to "DONE" to lock in the desired setting and return to the main menu.

## User Settings

### Moisture Adjustable Produce Drawer

You can control the amount of humidity in the moisture adjustable produce drawer. Adjust the control to any setting between LOW and HIGH. LOW (open) for best storage of fruits and vegetables with skins. HIGH (closed) for best storage of fresh, leafy vegetables.

### MeatSavor™/Produce Drawer

The MeatSavor™ drawer is a full-width drawer with adjustable temperature control. This drawer can be used for large party trays, deli items, beverages or miscellaneous items. There is a divider to organize the drawer into sections if desired.

### MeatSavor Control

The control, located on the right of the drawer, regulates the air temperature inside the drawer. Set control to "COLD" to provide normal refrigerator temperature. Use the COLDEST setting for meats or other deli items.

- Cold air directed to the MeatSavor™ can decrease refrigerator temperature. Refrigerator control may need to be adjusted.
- DO NOT place leafy vegetables in the MeatSavor™ drawer. Colder temperatures could damage leafy produce.

#### To Remove:

- Lift lid. Pull drawer out to full extension. Tilt the drawer front up and pull straight out.

#### To Install:

- Push metal glide rails to the back of the refrigerator. Place drawer onto rails and slide drawer back until it falls into place.

#### To Remove Divider:

- Pull drawer completely out and raise the front of the divider to unhook it from rear wall of the drawer and lift it out.

#### To Install Divider:

- Hook back of divider over rear wall of drawer and lower into place.

## Opening & Closing Doors

There are two refrigerator compartment doors. The doors can be opened and closed either separately or together. There is a vertically-hinged seal on the left refrigerator door.

- When the left side door is opened, the hinged seal automatically folds inward so that it is out of the way.
- When both doors are closed, the hinged seal automatically forms a seal between the two doors.

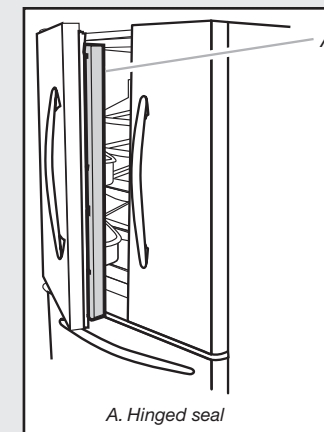

## Ice Maker & Ice Storage Bin

### Alarm Sound

The ice maker and storage bin are located in the upper left-hand side of the refrigerator compartment.

### Turning the Ice Maker On/Off

The On/Off switch is located on the ice maker.

To turn on the ice maker, press the switch to the "ON" position.

To manually turn off the ice maker, press the switch to the "OFF" position.

**Note:** Your ice maker has an automatic shutoff. The ice maker sensors will automatically stop ice production, but the control will remain in the ON position.



# Ice Maker & Ice Storage Bin (cont.)

## Removing and Replacing Ice Storage Bin

### To Remove the Ice Storage Bin:

1. Hold the base of the storage bin and press the release button on the lower right.
2. Pull the storage bin out until resistance is felt. Lift up the front of the ice bin and remove.
3. Press the switch to the "OFF" position.

### To Replace the Ice Storage Bin:

**IMPORTANT:** It may be necessary to turn the auger driver, behind the ice bin, counterclockwise to properly align the ice bin with the auger driver. The ice storage bin must be locked in place for proper ice dispensing.

1. Press the switch to the "ON" position.
2. Slide the ice bin into the guide rails located on either side of the enclosure.
3. Push the ice bin in until resistance is felt. Raise the front slightly and push the ice bin in until an audible "click" is heard.

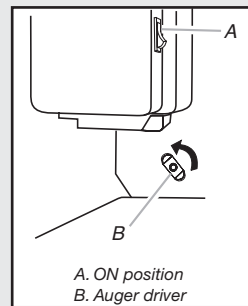

### Ice Production Rate

- Allow 24 hours to produce the first batch of ice. Discard the first three batches of ice produced.
- The ice maker should produce approximately 8 to 12 batches of ice in a 24-hour period.
- To increase ice production, lower the freezer and refrigerator temperature. See "Using the Controls." Wait 24 hours between adjustments.

### Remember

- The quality of your ice will be only as good as the quality of the water supplied to the ice maker. AVOID connecting the ice maker to a softened water supply. Water softener chemicals (such as salt) can damage parts of the ice maker and lead to poor quality ice. If a softened water supply cannot be avoided, make sure the water softener is operating properly and is well maintained.
- DO NOT use anything sharp to break up the ice in the bin. This can cause damage to the ice bin and dispenser mechanism.
- DO NOT store anything on top of the ice maker or in the ice storage bin.

# Water & Ice Dispenser

### IMPORTANT:

- After connecting the refrigerator to a water source, flush the water system. Press the "WATER" touch pad on the control panel. Use a sturdy container to depress and hold the dispenser lever for five seconds, then release it for five seconds. Repeat until water begins to flow. Once water begins to flow, continue depressing and releasing the dispenser lever (five seconds on, five seconds off) for an additional five minutes until a total of 4 gal. (15L) has been dispensed. This will flush air from the filter and water dispensing system. Additional flushing may be required in some households. As air is cleared from the system, water may spurt out of the dispenser.

**Note:** After five minutes of continuous dispensing, the dispenser will stop dispensing water to avoid flooding. To continue dispensing, remove the container and press the dispensing lever again.

- Allow 24 hours for the refrigerator to cool down and chill water. Dispense enough water every week to maintain a fresh supply.
- Allow 24 hours to produce the first batch of ice. Discard the first three batches of ice produced.

## ⚠ WARNING



### Cut Hazard

Use a sturdy glass when dispensing ice.

Failure to do so can result in cuts.

## Dispense Ice and Water

- The dispenser will dispense either water or cubed ice.
- The EASY FILL control allows you to fill containers that will not fit within the dispenser area, such as sport bottles.

## Water & Ice Dispenser (cont.)

### Dispense Ice and Water (cont.)

1. Select either water or cubed ice by touching "WATER" or "ICE" on the control panel. The light above the control indicates your selection.



2. Press a sturdy container against the dispenser lever.  
**IMPORTANT:** You do not need to apply a lot of pressure to the lever in order to activate the dispenser. Pressing hard will not make the water or ice dispense faster or in greater quantities.
3. Remove the container to stop dispensing.

### Dispenser Light

- The dispenser lights are LEDs which should not need to be changed.
- When you use the dispenser, the lever will automatically turn the light on. If you want the light to be on continuously, you may choose either ON or AUTO.

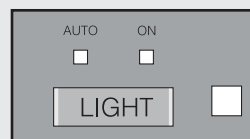

**Auto:** The light sensor monitors the light level in the room. The dispenser light will illuminate at half-power when the light level is low. To activate the Auto option press the "LIGHT" touch pad. The Auto indicator light will illuminate.

**On:** For continuous light, press the "LIGHT" touch pad a second time. The ON indicator light will illuminate.

**Off:** To turn the dispenser light OFF, press the "LIGHT" touch pad a third time.

### Dispenser Lock

The dispenser can be locked for easy cleaning or to avoid unintentional dispensing by small children and pets.

**Note:** The dispenser lock does not shut off power to the product, to the ice maker, or to the dispenser light. It just deactivates the dispenser lever.

## Water & Ice Dispenser (cont.)

### To Lock and Unlock Dispenser:

Press and hold the "LOCKED" touch pad for three seconds to lock the dispenser. The indicator light will illuminate when Lock is on.

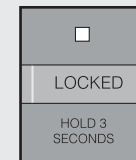

Press and hold the "LOCKED" touch pad again for three seconds to unlock dispenser. The indicator light will turn OFF.

## Water Filtration System

The water filter is located in the upper right-hand corner of the refrigerator compartment.

**Note:** DO NOT use with water that is microbiologically unsafe or of unknown quality without adequate disinfection before or after the system. Systems certified for cyst reduction may be used on disinfected waters that may contain filterable cysts.

### Water Filter Status

The control panel will remind you when it is time to order and replace your water filter by displaying a message when you dispense water. ORDER WATER FILTER means it is almost time to change the water filter and REPLACE WATER FILTER means a new water filter should be installed. It is recommended that you replace the water filter when you see the REPLACE WATER FILTER message OR earlier if the flow of water to your water dispenser or ice maker decreases noticeably.

### Reset Water Filter Status

After replacing the water filter, you must reset the water filter status to turn off the message.

1. On main menu, press the touch pad next to "OPTIONS".
2. In each of the following screens, continue to press the touch pad next to "MORE OPTIONS" until you reach the "REPLACE FILTER" screen.
3. Press the touch pad next to "YES" to reset the water filter status. Press the touch pad next to "NO" if you do not wish to reset the water filter status.

# Water Filtration System (cont.)

## Replacing the Water Filter

Replacement water filters are available through your local Viking Range Dealer. You may also order filters by calling 1-888-845-4641 or online at vikingrange.com

**IMPORTANT:** Air trapped in the water system may cause water and filter to eject. Always dispense water for at least 2 minutes before removing the filter or blue bypass cap.

1. Turn filter counterclockwise to remove.
2. Remove sealing label from replacement filter and insert the filter end into the filter head.
3. Turn the filter clockwise until it stops. Snap the filter cover closed.

**Note:** The dispenser feature may be used without a water filter installed. Your water will not be filtered. If this option is chosen, replace the filter with the blue bypass cap.

## Refrigerator Water Filter Cartridge Model RWFFR

### Specifications

Service Flow Rate (Maximum) .....	0.78 GPM
.....	(2.9 L/min)
Rated Service Life RWFFR (750 gal. Max) .....	750 gal./2838 liters
Maximum Operating Temperature .....	100°F/38°C
Minimum Pressure Requirement .....	35 psi/241 kPA
Minimum Operating Temperature.....	33°F/1°C
Maximum Operating Pressure.....	120 psi/827 kPA

# Water Filter



Tested and certified by NSF International against ANSI/NSF Standards 42 & 53 in models RWFFR for the reduction of:	
<b>Standard No. 42</b> <b>Aesthetic Effects:</b> Taste and Odor Reduction Chlorine Taste & Odor Mechanical Filtration Unit Particulate Reduction Class I	<b>Standard No. 53</b> <b>Health Effects:</b> Chemical Reduction Unit Lead, Atrazine, Lindane, Benzene, Carbofuran, p-Dichlorobenzene, Mercury, & Toxaphene Reduction Mechanical Filtration Unit Cyst, Turbidity & Asbestos Reduction

## General Use Conditions

Read this Performance Data Sheet and compare the capabilities of this refrigerator with your actual water treatment needs. DO NOT use this product where water is microbiologically unsafe or of unknown quality without adequate disinfection before or after the system. System certified for cyst reduction may be used on disinfected water that may contain filterable cysts. **USE ONLY WITH COLD WATER SUPPLY. CHECK FOR COMPLIANCE WITH THE STATE AND LOCAL LAWS AND REGULATIONS.**

The retractable water filtration system uses a RWFFR replacement cartridge. Timely replacement of filter cartridge is essential for performance satisfaction from this filtration system. Please refer to the applicable section of your Use & Care Guide for general operation, maintenance requirements and troubleshooting.

This system has been tested according to ANSI/NSF 42 and 53 for reduction of the substance listed above. The concentration of the indicated substances in water entering the system was reduced to a concentration less than or equal to the permissible limit for water leaving the system, as specified in ANSI/NSF 42 and 53.

# Water Filter

Standard No. 42: Aesthetic Effects								
Parameter	USEPA MCL	Influent Challenge Concentration	Influent Average	Effluent		% Reduction		Min. Required Reduction
				Avg.	Max.	Avg.	Min.	
Chlorine	—	2.0 mg/L + 10%	1.88 mg/L	<0.051363 mg/L	0.06 mg/L	>97.26%	96.84%	50%
T & O	—	—	—	—	—	—	—	—
Particulate**	—	at least 10,000 particles/ml	57,000,000 #/ml	30,583 #/ml	69,000 #/ml	99.52%	98.94%	85%

Standard No. 53: Health Effects								
Parameter	USEPA MCL	Influent Challenge Concentration	Influent Average	Effluent		% Reduction		Min. Required Reduction
				Avg.	Max.	Avg.	Min.	
Turbidity	1NTU**	11 + 1 NTU***	10.7 NTU	.031 NTU	0.49 NTU	97.09%	95.20%	0.5NTU
Cysts	99.5% Red	Minimum 50,000/L	166,500 #/L	L <1 #/L	<1 #/L	>99.99%	>99.99%	>99.95%
Asbestos	99% Red	107 108 fibers/L; fibers >10 micrometers in length	155 MF/L	<1 MF/L	<1 MF/L	>99.99%	>99.99%	99%
Lead at pH 6.5	0.015 mg/L	0.15 mg/L + 10%	0.153 mg/L	<0.001 mg/L	<0.001 mg/L	>99.35%	>99.29%	0.10 mg/L
Lead at pH 8.5	0.015 mg/L	0.15 mg/L + 10%	0.150 mg/L	<0.001 mg/L	<0.001 mg/L	>99.33%	>99.29%	0.10 mg/L
Mercury at pH 6.5	0.002 mg/L	0.06 mg/L + 10%	0.006 mg/L	<0.003 mg/L	<0.005 mg/L	95.70%	90.91%	0.002 mg/L
Mercury at pH 8.5	0.002 mg/L	0.06 mg/L + 10%	0.006 mg/L	<0.008 mg/L	<0.015 mg/L	86.22%	75.93%	0.002 mg/L
Atrazine	0.003 mg/L	0.09 mg/L + 10%	0.009 mg/L	<0.002 mg/L	<0.002 mg/L	76.99%	75.31%	0.003 mg/L
Benzene	0.005 mg/L	0.15 mg/L + 10%	0.014 mg/L	<0.006 mg/L	<0.011 mg/L	95.71%	92.14%	0.005 mg/L
Carbofuran	0.04 mg/L	0.08 mg/L + 10%	0.081 mg/L	<0.001 mg/L	<0.001 mg/L	98.74%	98.46%	0.04 mg/L
p-Dichlorobenzene	0.075 mg/L	0.225 mg/L + 10%	0.208 mg/L	<0.005 mg/L	<0.005 mg/L	99.76%	99.74%	0.075 mg/L
Lindane	0.0002 mg/L	0.002 mg/L + 10%	0.002 mg/L	<0.000 mg/L	<0.001 mg/L	98.72%	96.50%	0.0002 mg/L
Toxaphene	0.003 mg/L	0.15 mg/L + 10%	0.015 mg/L	<0.001 mg/L	<0.001 mg/L	92.97%	91.67%	0.003 mg/L

\*Tested using a flow rate of 0.78 gpm; pressure of 60psig; pH of 7.5 + 0.5; temp of 68° + 5°F (20° + 3°C).

\*\*Measurement in Particles/ml. Particles used were 0.5 - 1 microns

\*\*\*NTU - Nephelometric Turbidity Units

# Water Filter Certifications

State of California  
 Department of Health Services  
 Water Treatment Device  
 Certificate Number  
 06 - 1790

Date Issued: June 1, 2006

Trademark /Model Designation: RWFFR-750  
 Replacement Elements: RWFFR  
 Manufacturer: CUNO, Incorporated, a 3M Company

The water treatment device(s) listed on this certificate have met the testing requirements pursuant to Section 116830 of the Health and Safety Code for the following health related contaminants:

Microbiological Contaminants and Turbidity: Cysts, Turbidity  
 Inorganic/Radiological Contaminants: Asbestos, Lead, Mercury

Organic Contaminants

Atrazine  
 Lindane  
 Benzene  
 Carbofuran  
 p-dichlorobenzene  
 Toxaphene

Rated Service Capacity: 750 gal.

Rated Service Flow: 0.78 gpm

Conditions of Certification:

Do not use with water that is microbiologically unsafe or with water of unknown quality without adequate disinfection before or after the system. Systems certified for cyst reduction may be used on disinfected waters that may contain filterable cysts.

Operation

## Cleaning



Both the refrigerator and freezer sections defrost automatically. However, clean both sections about once a month to avoid buildup of odors. Wipe up spills immediately.

**IMPORTANT:** Because air circulates between both sections, any odors formed in one section will transfer to the other. You must thoroughly clean both sections to eliminate odors. To avoid odor transfer and drying out of food, wrap or cover foods tightly.

### To Clean Your Refrigerator:

**Note:** *DO NOT use abrasive or harsh cleaners such as window sprays, scouring cleansers, flammable fluids, cleaning waxes, concentrated detergents, bleaches or cleansers containing petroleum products on plastic parts, interior and door liners or gaskets. DO NOT use paper towels, scouring pads, or other harsh cleaning tools.*

1. Unplug refrigerator or disconnect power.
2. Hand wash, rinse, and dry removable parts and interior surfaces thoroughly. Use a clean sponge or soft cloth and a mild detergent in warm water.
3. Wash stainless steel and painted metal exteriors with a clean sponge or soft cloth and a mild detergent in warm water.
4. There is no need for routine condenser cleaning in normal home operating environments. If the environment is particularly greasy or dusty, or there is significant pet traffic in the home, the condenser should be cleaned every 2 to 3 months to ensure maximum efficiency.

#### If you need to clean the condenser:

- Remove the base grille.
  - Use a vacuum cleaner with a soft brush to clean the grille, the open areas behind the grille and the front surface area of the condenser.
  - Replace the base grille when finished.
5. Plug in refrigerator or reconnect power.

## Changing the Light Bulb

**Note:** *Not all appliance bulbs will fit your refrigerator. Be sure to replace the bulb with an appliance bulb of the same size, shape, and wattage (no greater than 40 watts).*

1. Unplug refrigerator or disconnect power.
2. Remove the light shield, if necessary.
  - Top of the refrigerator compartment—squeeze both sides of the light shield while pulling downward to remove.
  - Beneath ice storage enclosure—press along upper edge of light shield and roll light shield forward to remove.

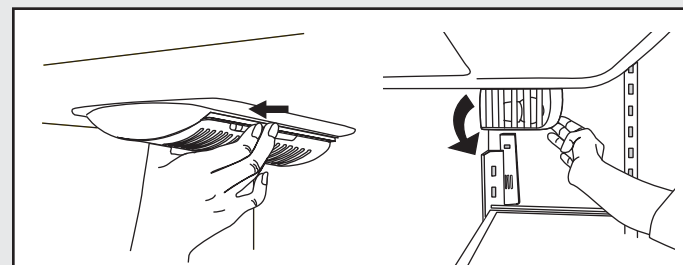

3. Replace burned-out bulb(s) with appliance light bulb(s) no greater than 40 watts.
4. Replace the light shield(s) by inserting the tabs on the shield into the liner holes and snap into place.

**Note:** *To avoid damaging the light shield, do not force the shield beyond the locking point.*

5. Plug in refrigerator or reconnect power.

# Troubleshooting

**⚠ WARNING**



**Electrical Shock Hazard**  
**Plug into a grounded 3 prong outlet.**  
**Do not remove ground prong.**  
**Do not use an adapter.**  
**Do not use an extension cord.**  
**Failure to follow these instructions can result in death, fire, or electrical shock.**

## Refrigerator Operation

Problem	Cause	Solution
The refrigerator will not operate	Power cord unplugged? Is outlet working? Household fuse blown or circuit breaker tripped? Are controls on? New installation?	Plug into a grounded 3-prong outlet. Plug in a lamp to see if the outlet is working. Replace the fuse or reset the circuit breaker. If the problem continues, call an electrician. Make sure the refrigerator controls are on. See "Using the Controls". Allow 24 hours following installation for the refrigerator to cool completely. <b>Note:</b> Adjusting the temperature controls to coldest setting will not cool either compartment more quickly.
The motor seems to run too much	Normal operation	Your new refrigerator may run longer than your old one due to its high-efficiency compressor and fans. The refrigerator may run even longer if the room is warm, a large food load is added, doors are opened often, or if the doors have been left open.

# Troubleshooting (cont.)

**⚠ WARNING**



**Explosion Hazard**  
**Use nonflammable cleaner.**  
**Failure to do so can result in death, explosion, or fire.**

## Refrigerator Operation

Problem	Cause	Solution
The refrigerator seems noisy	Refrigerator noise has been reduced over the years. Due to this reduction, you may hear intermittent noises from your new refrigerator that you did not notice from your old model. Listed on the right are some normal sounds with explanations.	Buzzing—heard when the water valve opens to fill the ice maker Pulsating—fans/compressor adjusting to optimize performance Hissing/Rattling—flow of refrigerant, movement of water lines, or from items placed on top of the refrigerator Sizzling/Gurgling—water dripping on the heater during defrost cycle Popping—contraction/expansion of inside walls, especially during initial cool-down Water running—may be heard when water melts during the defrost cycle and runs into the drain pan Creaking/Cracking—occurs as ice is being ejected from the ice maker mold.
The doors will not close completely	Door blocked open? Bin or shelf in the way?	Move food packages away from door. Push bin or shelf back in the correct position.
The doors are difficult to open	Gaskets dirty or sticky?	Clean gaskets and contact surfaces with mild soap and warm water. Rinse and dry with soft cloth.

# Troubleshooting (cont.)

## Temperature and Moisture

Problem	Cause	Solution
Temperature is too warm	<p>New installation?</p> <p>Door(s) opened often or left open?</p> <p>Large load of food added?</p> <p>Controls set correctly for the surrounding conditions?</p>	<p>Allow 24 hours following installation for the refrigerator to cool completely.</p> <p>Allows warm air to enter refrigerator. Minimize door openings and keep doors fully closed.</p> <p>Allow several hours for refrigerator to return to normal temperature.</p> <p>Adjust the controls a setting colder. Check temperature in 24 hours. See "Using the Controls".</p>
<p>There is interior moisture buildup</p> <p><b>Note:</b> Some moisture buildup is normal.</p>	<p>High humidity?</p> <p>Door(s) left open?</p>	<p>Minimize door openings and keep door(s) fully closed.</p> <p>Keep door(s) fully closed.</p>

# Troubleshooting (cont.)

## Ice and Water

Problem	Cause	Solution
The ice maker is not producing ice or not enough ice	<p>Refrigerator connected to a water supply and the supply shutoff valve turned on?</p> <p>Kink in the water source line?</p> <p>Ice maker turned on?</p> <p>New installation?</p> <p>Freezer door closed completely?</p> <p>Large amount of ice recently removed?</p> <p>Ice cube jammed in the ice maker ejector arm?</p> <p>Water filter installed on the refrigerator?</p> <p>Reverse osmosis water filtration system connected to your cold water supply?</p>	<p>Connect refrigerator to water supply and turn water shutoff valve fully open.</p> <p>A kink in the line can reduce water flow. Straighten the water source line.</p> <p>Make sure wire shutoff arm or switch (depending on model) is in the ON position.</p> <p>Wait 24 hours after ice maker installation for ice production to begin. Wait 72 hours for full ice production.</p> <p>Firmly close the freezer compartment door. If the freezer compartment door will not close all the way, see "The doors will not close completely".</p> <p>Allow 24 hours for ice maker to produce more ice.</p> <p>Remove ice from the ejector arm with a plastic utensil.</p> <p>Remove filter and operate ice maker. If ice volume improves, then the filter may be clogged or incorrectly installed. Replace filter or reinstall it correctly.</p> <p>This can decrease water pressure. See "Water Supply Requirements".</p>
<p>The ice cubes are hollow or small</p> <p><b>Note:</b> This is an indication of low water pressure.</p>	<p>Water shutoff valve not fully open?</p> <p>Kink in the water source line?</p> <p>Water filter installed on the refrigerator?</p> <p>Reverse osmosis water filtration system connected to your cold water supply?</p>	<p>Turn the water shutoff valve fully open.</p> <p>A kink in the line can reduce water flow. Straighten the water source line.</p> <p>Remove filter and operate ice maker. If ice quality improves, then the filter may be clogged or incorrectly installed. Replace filter or reinstall it correctly.</p> <p>This can decrease water pressure. See "Water Supply Requirements".</p>



## Troubleshooting (cont.)

**⚠ WARNING**



**Cut Hazard**

**Use a sturdy glass when dispensing ice.**

**Failure to do so can result in cuts.**

### Ice and Water

Problem	Cause	Solution
Off-taste, odor or gray color in the ice	<p>New plumbing connections?</p> <p>Ice stored too long?</p> <p>Odor transfer from food?</p> <p>Are there minerals (such as sulfur) in the water?</p> <p>Water filter installed on the refrigerator?</p>	<p>New plumbing connections can cause discolored or off-flavored ice.</p> <p>Discard ice. Wash ice bin. Allow 24 hours for ice maker to make new ice.</p> <p>Use airtight, moisture proof packaging to store food.</p> <p>A water filter may need to be installed to remove the minerals.</p> <p>Gray or dark discoloration in ice indicates that the water filtration system needs additional flushing. Flush the water system before using a new water filter. Replace water filter when indicated. See "Water Filtration System".</p>
The water and ice dispenser will not operate properly	<p>Refrigerator connected to a water supply and the supply shutoff valve turned on?</p> <p>Kink in the water source line?</p> <p>New installation?</p> <p>Is the water pressure at least 35 psi (241 kPa)?</p>	<p>Connect refrigerator to water supply and turn water shutoff valve fully open.</p> <p>Straighten the water source line.</p> <p>Flush and fill the water system. See "Water and Ice Dispenser".</p> <p>The water pressure to the home determines the flow from the dispenser. See "Water Supply Requirements".</p>

## Troubleshooting (cont.)

### Ice and Water

Problem	Cause	Solution
The water and ice dispenser will not operate properly	<p>Water filter installed on the refrigerator?</p> <p>Refrigerator door closed completely?</p> <p>Recently removed the doors?</p> <p>Reverse osmosis water filtration system connected to your cold water supply?</p>	<p>Remove filter and operate dispenser. If water flow increases, the filter may be clogged or incorrectly installed. Replace filter or reinstall it correctly.</p> <p>Close the door firmly. If it does not close completely, see "The doors will not close completely".</p> <p>Make sure the water dispenser wire/tube assembly has been properly reconnected at the bottom of the refrigerator door. See "Refrigerator Doors and Drawer".</p> <p>This can decrease water pressure. See "Water Supply Requirements".</p>
Water is leaking from the dispenser system <b>Note:</b> One or two drops of water after dispensing is normal.	<p>Glass not being held under the dispenser long enough?</p> <p>New installation?</p> <p>Recently changed water filter?</p> <p>Water on the floor near the base grille?</p>	<p>Hold the glass under the dispenser two to three seconds after releasing the dispenser lever.</p> <p>Flush the water system. See "Water and Ice Dispenser".</p> <p>Flush the water system. See "Water and Ice Dispenser".</p> <p>Make sure the water dispenser tube connections are fully tightened. See "Refrigerator Doors and Drawer".</p>
Water from the dispenser is warm <b>Note:</b> Water from the dispenser is only chilled to 50°F (10°C).	<p>New installation?</p> <p>Recently dispensed large amount of water?</p> <p>Water not been recently dispensed?</p> <p>Refrigerator connected to a cold water pipe?</p>	<p>Allow 24 hours after installation for the water supply to cool completely.</p> <p>Allow 24 hours for water supply to cool completely.</p> <p>The first glass of water may not be cool. Discard the first glass of water.</p> <p>Make sure the refrigerator is connected to a cold water pipe. See "Water Supply Requirements".</p>



# Service Information

If service is required after checking the troubleshooting guide, call your Viking dealer or authorized service agency. The name of the authorized service agency can be obtained from the dealer or distributor in your area.

When you make a service call, be sure to have the following information handy:

- Model Number
- Serial Number
- Date of Purchase
- Name of dealer from whom purchased

Be ready to clearly describe the problem that you are having with your Viking refrigerator.

If you are unable to obtain the name of an authorized service agency, or if you continue to have service problems, contact Viking Range Corporation at (888) 845-4641 or write to:

**VIKING RANGE CORPORATION  
PREFERRED SERVICE  
1803 Hwy 82W  
Greenwood, Mississippi 38930 USA**

Record the following information indicated below. You will need it if service is ever required.

The serial number and model numbers for your refrigerator are located on the upper wall, behind the lighting:

Model No. \_\_\_\_\_ Serial No. \_\_\_\_\_

Date of Purchase \_\_\_\_\_ Date Installed \_\_\_\_\_

Dealer's Name \_\_\_\_\_

Address \_\_\_\_\_

If service requires installation of parts, use only authorized parts to insure protection under the warranty.

**Keep this manual with your refrigerator for future reference.**

# Warranty

## **FREESTANDING FRENCH DOOR BOTTOM MOUNT REFRIGERATOR/FREEZER WITH DISPENSER WARRANTY TWO YEAR FULL WARRANTY**

Freestanding Refrigerators/Freezers and all of their components and accessories, except as detailed below\*, are warranted to be free from defects in material or workmanship under normal household use for a period of two (2) years from the date of original retail purchase. Viking Range Corporation, warrantor, agrees to repair or replace, at its option, any part which fails or is found to be defective during the warranty period.

\*Painted, decorative items and water filters are warranted to be free from defective materials or workmanship for a period of ninety (90) days from the date of original retail purchase. ANY DEFECTS MUST BE REPORTED TO THE SELLING DEALER WITHIN NINETY (90) DAYS FROM DATE OF ORIGINAL RETAIL PURCHASE.

Viking Range Corporation uses the most up-to-date processes and best materials available to produce all color finishes. However, slight color variation may be noticed because of the inherent differences in painted parts and porcelain parts as well as differences in kitchen lighting, product locations, and other factors.

### **SIX YEAR FULL WARRANTY**

Any sealed refrigeration system component, as listed below, is warranted to be free from defective materials or workmanship in normal household use during the third through the sixth year from the date of original retail purchase. Viking Range Corporation, warrantor, agrees to repair or replace, at its option, any part which fails or is found to be defective during the warranty period.

**Sealed Refrigeration System Components:**  
Compressor, Evaporator,  
Condenser, Connecting Tubing, Dryer/Strainer

### **TWELVE YEAR LIMITED WARRANTY**

Any sealed refrigeration system component, as listed above, which fails due to defective materials or workmanship in normal household use during the seventh through the twelfth year from the date of original retail purchase will be repaired or replaced, free of charge for the part itself, with the owner paying all other costs, including labor.

### **NINETY (90) DAY RESIDENTIAL PLUS WARRANTY**

This warranty applies to applications where use of the product extends beyond normal residential use. Examples are, but not limited to, bed and breakfasts, fire stations, private clubs, churches, etc. This warranty excludes all commercial locations such as restaurants, food service locations and institutional food service locations.

This warranty extends to the original purchaser of the product warranted hereunder and to each transferee owner of the product during the term of the warranty.

This warranty shall apply to products purchased and located in the United States and Canada. Products must be purchased in the country where service is requested. Warranty labor shall be performed by an authorized Viking Range Corporation service agency or representative. Warranty shall not apply to damage resulting from abuse, accident, natural disaster, loss of electrical power to the product for any reason, alteration, improper installation, improper operation or repair or service to the product by anyone other than an authorized Viking Range Corporation service agency or representative. Warranty shall not apply to damage resulting from indoor units being used in outdoor situations. This warranty does not apply to commercial usage. This warranty does not cover any food or medicine loss due to product failure. Warrantor is not responsible for consequential or incidental damage whether arising out of breach of warranty, breach of contract, or otherwise. Some jurisdictions do not allow the exclusion or limitation of incidental or consequential damages, so the above limitation or exclusion may not apply to you.

Owner shall be responsible for proper installation, providing normal care and maintenance, providing proof of purchase upon request, and making the appliance reasonably accessible for service. If the product or one of its component parts contains a defect or malfunction during the warranty period, after a reasonable number of attempts by the warrantor to remedy the defects or malfunctions, the owner is entitled to either a refund or replacement of the product or its component part or parts. Replacement of a component part includes its free installation. Warrantor's liability on any claim of any kind, with respect to the goods or services covered hereunder, shall in no case exceed the price of the goods or service or part thereof which gives rise to the claim.

**WARRANTY SERVICE:** Under the terms of this warranty, service must be performed by a factory authorized Viking Range Corporation service agent or representative. Service will be provided during normal business hours, and labor performed at overtime or premium rates shall not be covered by this warranty. To obtain warranty service, contact the dealer from whom the product was purchased, an authorized Viking Range Corporation service agent, or Viking Range Corporation. Provide model and serial number and date of original purchase. For the name of your nearest authorized Viking Range Corporation service agency, call the dealer from whom the product was purchased or Viking Range Corporation. **IMPORTANT:** Retain proof of original purchase to establish warranty period.

The return of the Owner Registration Card is not a condition of warranty coverage. You, however, should return the Owner Registration Card so that Viking Range Corporation can contact you should any question of safety arise which could affect you.

Any implied warranties of merchantability and fitness applicable to the above described built-in all refrigerators/all freezers are limited in duration to the period of coverage of the applicable express written limited warranties set forth above. Some jurisdictions do not allow limitations on how long an implied warranty lasts, so the above limitation may not apply to you. This warranty gives you specific rights, and you may also have other rights which may vary from jurisdiction to jurisdiction.

Specifications subject to change without notice.

# Notes

---

---

---

---

---

---

---

---

---

---

---

---

---

---

---

---

---

---

---

---

---

---

---

---

---

---

---

---

---

---

# Notes

---

---

---

---

---

---

---

---

---

---

---

---

---

---

---

---

---

---

---

---

---

---

---

---

---

---

---

---

---

---

## Free Manuals Download Website

<http://myh66.com>

<http://usermanuals.us>

<http://www.somanuals.com>

<http://www.4manuals.cc>

<http://www.manual-lib.com>

<http://www.404manual.com>

<http://www.luxmanual.com>

<http://aubethermostatmanual.com>

Golf course search by state

<http://golfingnear.com>

Email search by domain

<http://emailbydomain.com>

Auto manuals search

<http://auto.somanuals.com>

TV manuals search

<http://tv.somanuals.com>