



Assembly Guide



X6600iNetTV
COMMERCIAL ELLIPTICAL TRAINER

Assembly Guide

X6600iNetTV COMMERCIAL ELLIPTICAL TRAINER

To avoid possible damage to this Elliptical Trainer, please follow these assembly steps in the correct order. Before proceeding, find your new Elliptical Trainer's serial number located on the front axle tube, and enter here:

Refer to this number when calling for service, and enter this serial number on your Warranty Card and in your own records. Be sure to read your Owner's Guide before using your new Elliptical Trainer. **If any parts, hardware or tools are missing, please call 1.800.335.4348, Extension 12**

NOTE: It is recommended that you apply grease to the threads of each screw as you assemble your Elliptical Trainer to prevent loosening and noise. Also, during each assembly step, ensure that ALL screws are in place and partially threaded in before completely tightening any ONE screw.

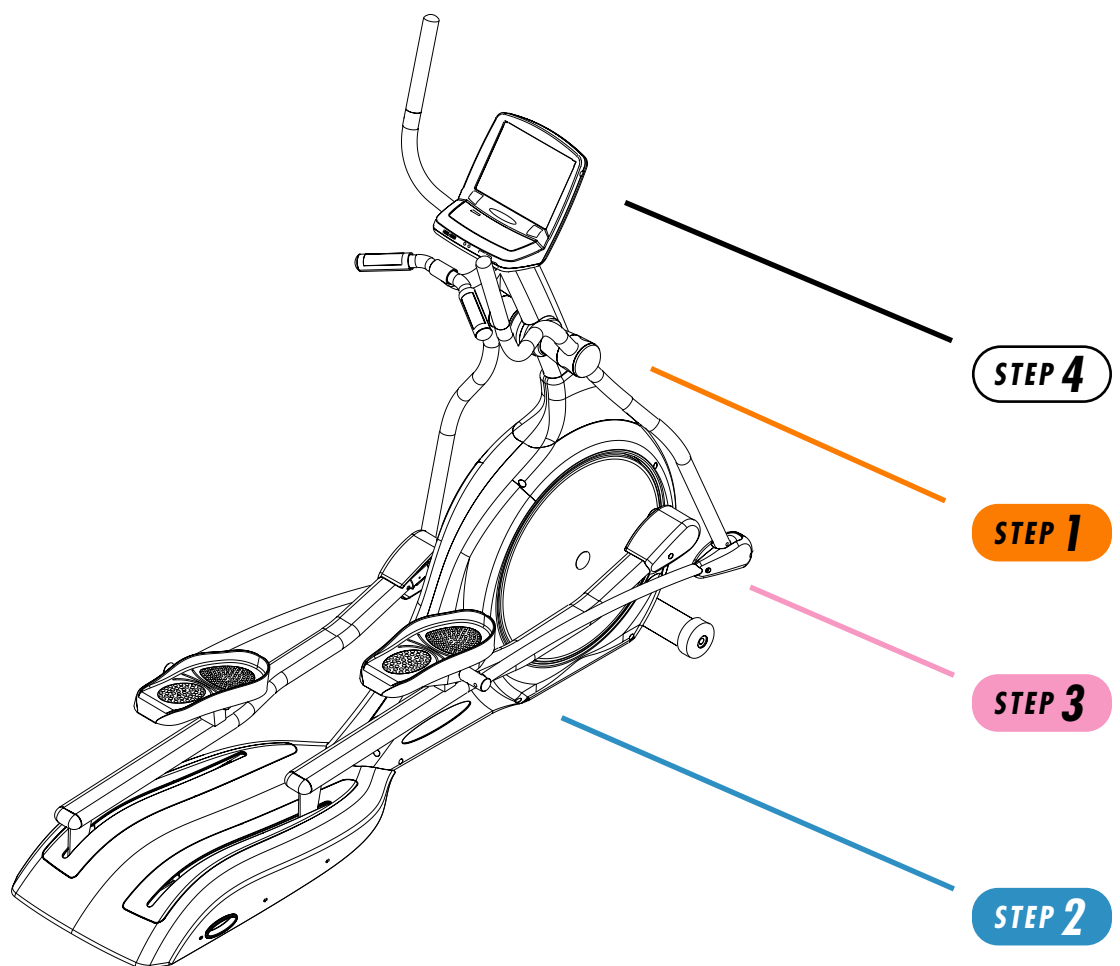

Screwdriver

TOOLS & PARTS INCLUDED

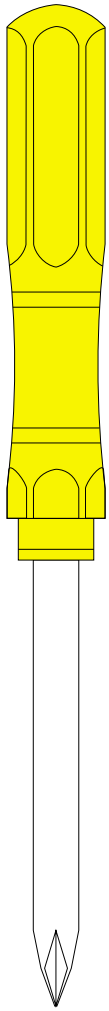

6^{mm} Allen Wrench

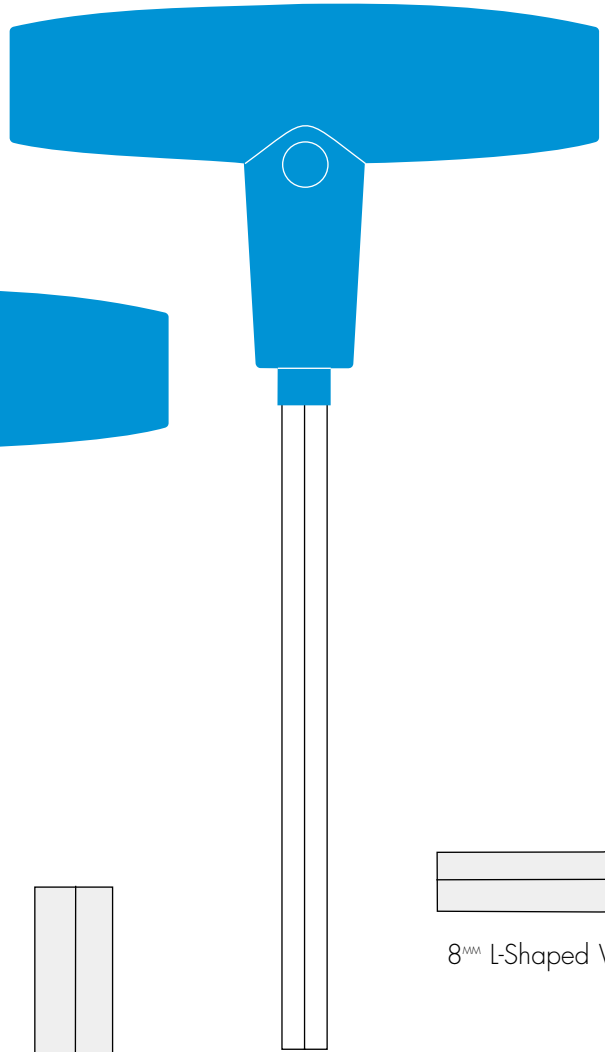

5^{mm} Allen Wrench

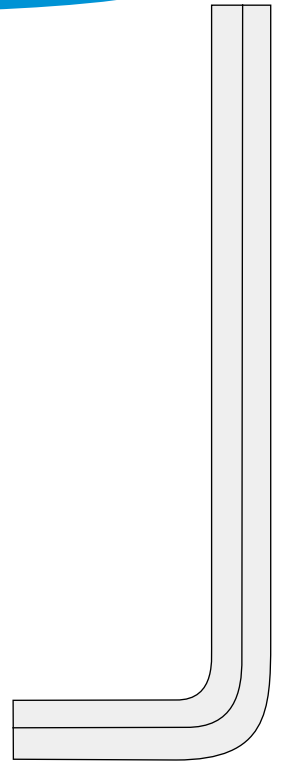
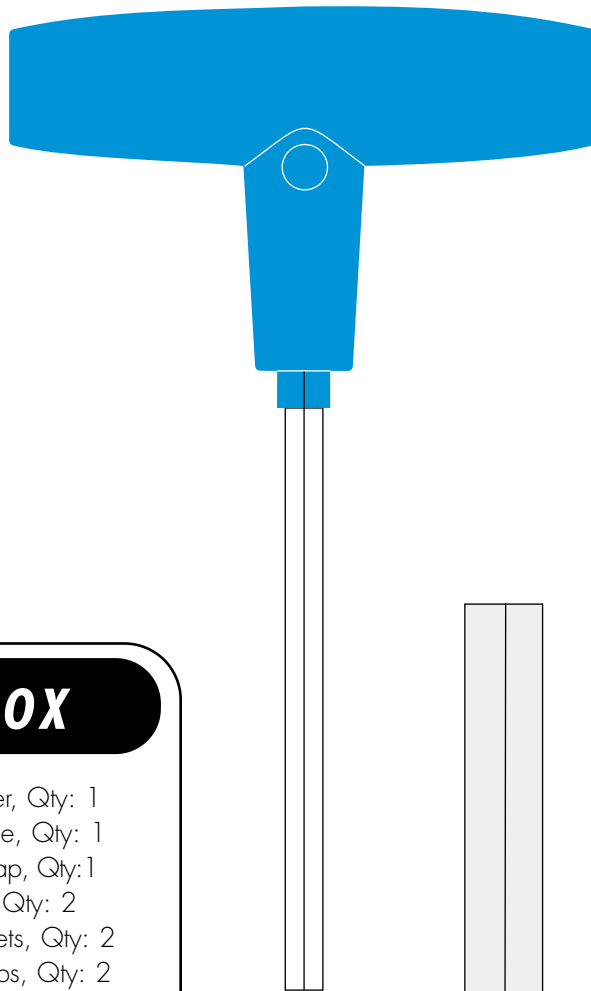

8^{mm} L-Shaped Wrench

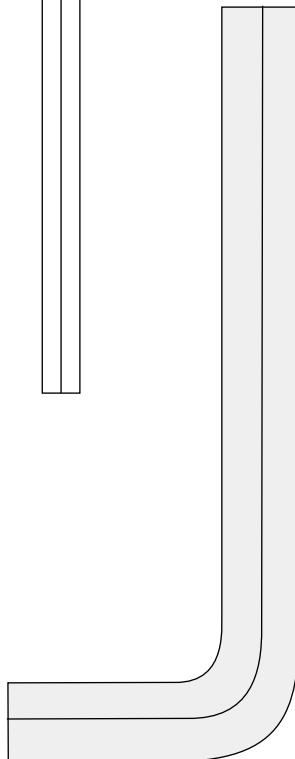

10^{mm} L-Shaped Wrench

17^{mm} Socket Wrench

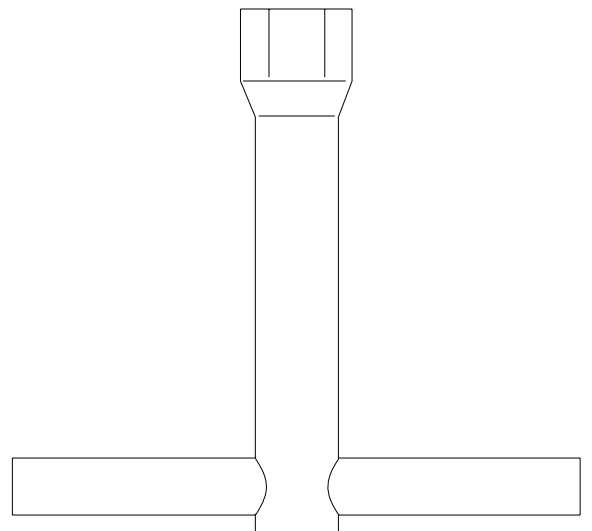

PARTS BOX

Console Mast Cover, Qty: 1
Water Bottle & Cage, Qty: 1
Heart Rate Chest Strap, Qty: 1
Link Arm Covers, Qty: 2
Pedal Support Brackets, Qty: 2
Dual Action End Caps, Qty: 2
Color-coded Hardware Bags
Owner's Guide
Assembly Guide
Warranty Card

CONSOLE BOX

iNetTV Console
Owner's Guide

HARDWARE INCLUDED

ORANGE BAG

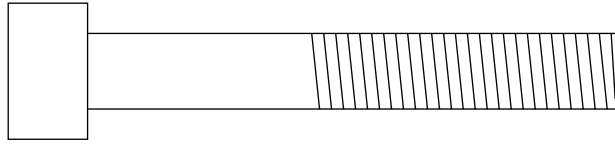
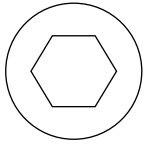

M10x70L CapScrew
Quantity: 2

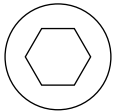

M8x80L SocketHead CapScrew
Quantity: 1

BLUE BAG

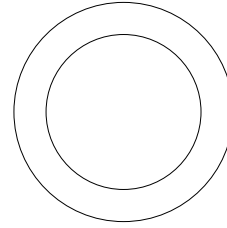

M20x30x1.5T
Wavy Washer
Quantity: 2

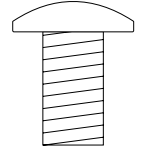
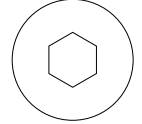

M8x15L Screw
Quantity: 2

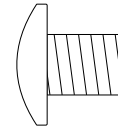
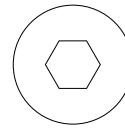

M8x10L Screw
Quantity: 4

PINK BAG

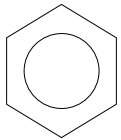

M10 Nut
Quantity: 2

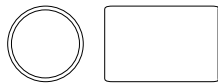
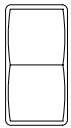

Link Arm Bushing
Quantity: 2

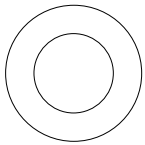

M10x18x2T Washer
Quantity: 4

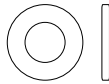

M5.3x10x1T Washer
Quantity: 4

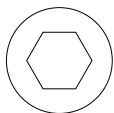

M8x30L CapScrew
Quantity: 8

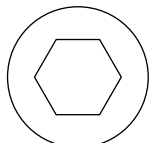
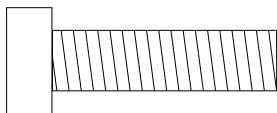

M10x40L CapScrew
Quantity: 2

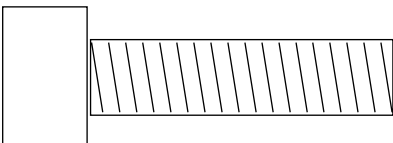

FOR SERVICE ONLY

6^{mm} L-Shaped Wrench

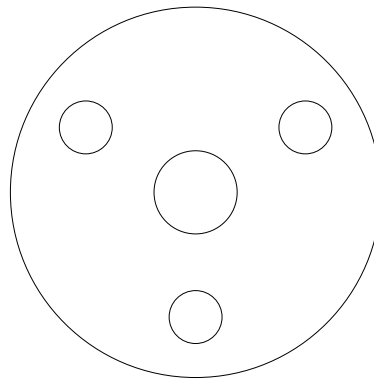

M49x7 Round Tool
Quantity: 1

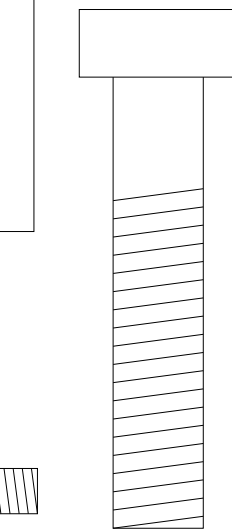
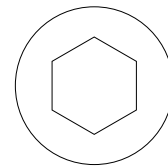

M12x60L CapScrew
Quantity: 1



M6x40L CapScrew
Quantity: 3

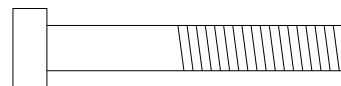

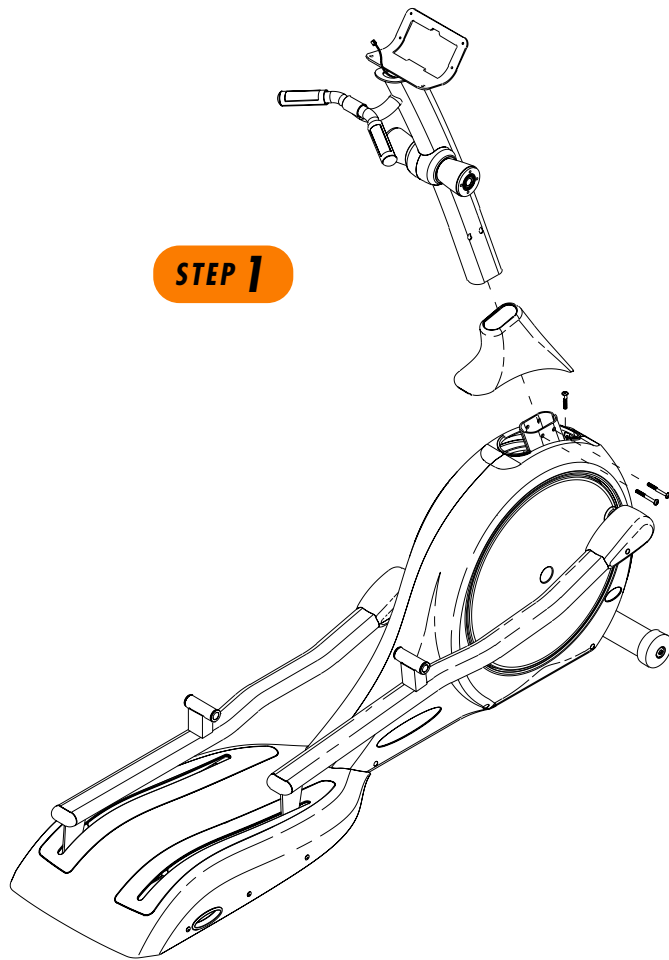

STEP 1

STEP 1

ORANGE BAG

- Place the rubber console mast boot on the end of the console mast.
- Connect the wire tie that exits the bottom of the console mast to the bundle of wires that comes from the bracket at the top of the frame. Pull the wire tie and wire harness up through the console mast while at the same time inserting the console mast into the frame bracket.
- Secure the console mast to the frame with two capscrews (M10 x 70L). Tighten with the 8^{mm} L-shaped Allen wrench.
- Stabilize the console mast to the frame with the socket head cap screw (M10x70L). Tighten with the 10^{mm} L-shaped Allen wrench.
- Slide the rubber boot down the console mast and snap it in place so it integrates with the side covers.

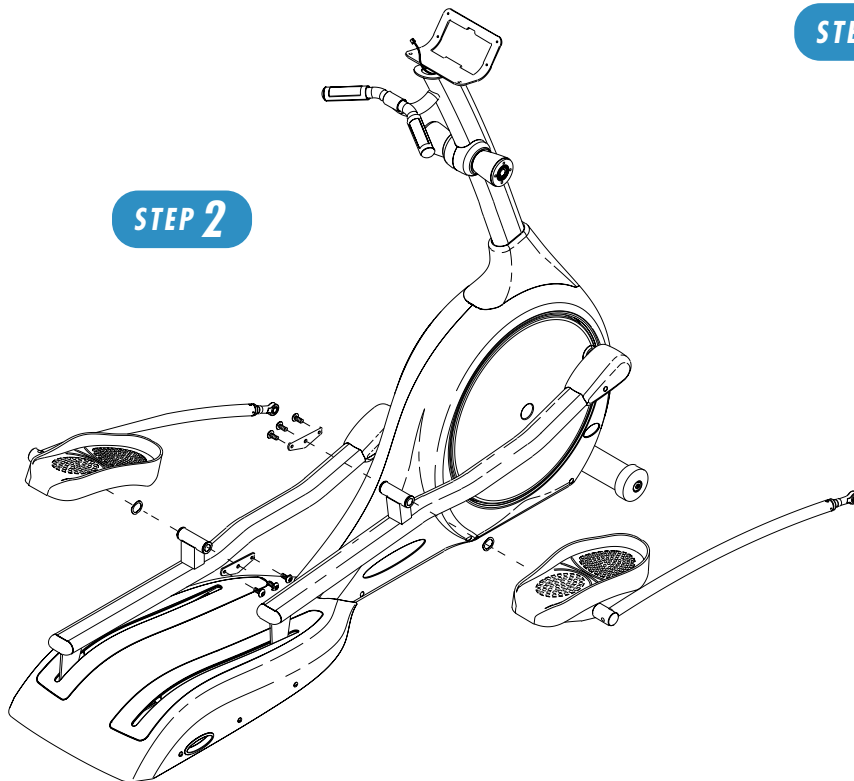

STEP 2

STEP 2

BLUE BAG

- Place a wavy washer (M20x30x1.5t) on the axle located under the foot plate of the right lower link arm.
- Slide the axle of the lower link arm into the bracket located on the top of the right pedal arm. Secure lower link arm by attaching the pedal support bracket and screw (M8x1.5L) to the end of the axle. Secure the outside holes in the bracket to the footplate with two screws (M8x1.0L). Tighten screws with the 5^{mm} Allen wrench.
- Repeat the same steps on the left side.

STEP 3**PINK BAG**

- Connect the right dual-action arm to the right console mast rotation housing, being sure to line up the holes. Secure the dual action arm in place with four screws (M8x30L) and tighten with a 6^{mm} T-handled Allen wrench. Snap the dual action end cap into place.

- Connect the right lower link arm to the right dual-action arm by lining up the holes on the end of each arm. Slide the Link Arm Bushing into the hole of the socket joint. Place a washer (M10.5x18x2t) on the capscrew (M10x40L) and slide the capscrew through the hole. Place a second washer followed by a nut (M10) on the capscrew and tighten using the 17^{mm} socket wrench and 8^{mm} L-shaped Allen wrench.

- Position the link arm cover into place over the joint of the lower link arm and dual-action arm. With a screw (M5x12L) and Phillips screwdriver, connect the two halves of the cover through the hole located in the front of the cover. Attach the cover to each side of the lower link arm with the two washers (M5.3x10x1t) and two screws (M5x12L).

- Repeat these steps on the left side.

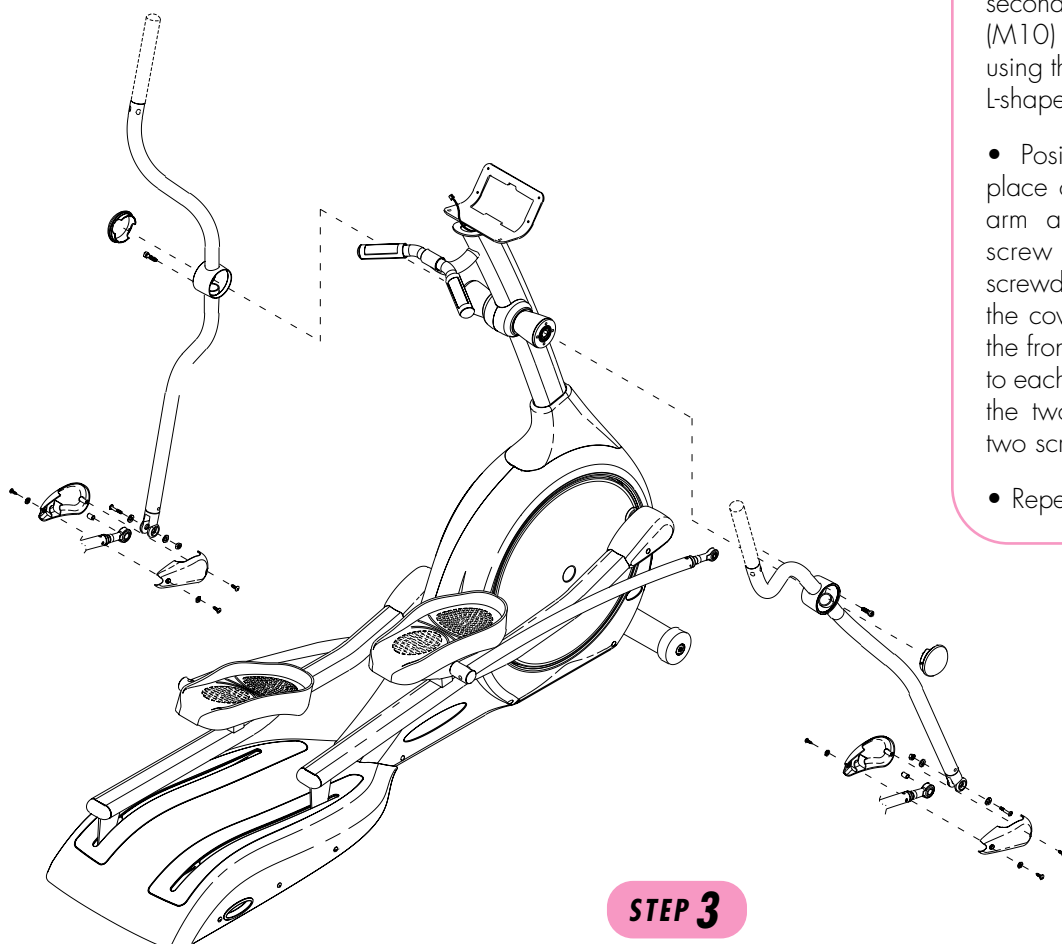
**STEP 3**

STEP 4**CONSOLE**

- Remove the six mounting screws from the back of the console with the Phillips screwdriver. Set the console in place and secure it to the console mast with the screws you just removed. Connect all the wires to the proper locations in the back of the console (see diagram).

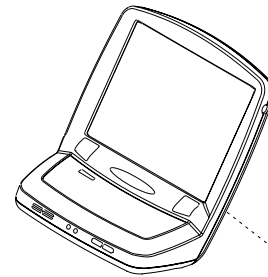
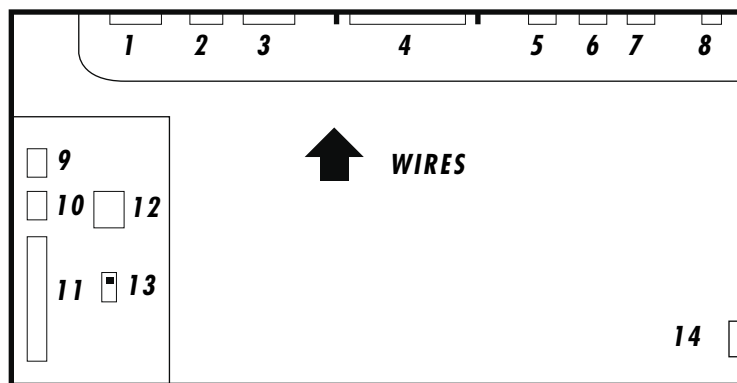
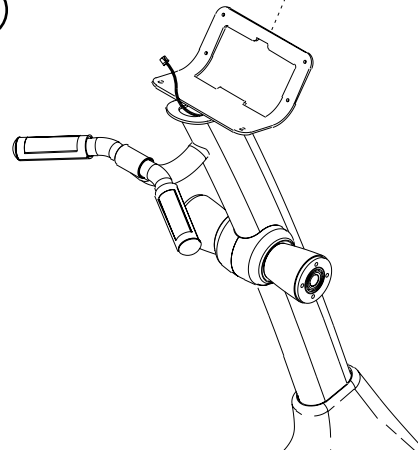
**STEP 4**

- 1 - Co-Axial Cable TV
- 2 - USB - B
- 3 - USB - A
- 4 - VGA (PC Video)
- 5 - Video IN
- 6 - Audio - R
- 7 - Audio - L
- 8 - Microphone
- 9 - Heart Rate Receiver 1
- 10 - Heart Rate Receiver 2
- 11 - 20 Pin Connector
- 12 - Power Plug
- 13 - Miles/Kilometers Switch
- 14 - Data Port



500 South CP Avenue • P.O. Box 280 • Lake Mills, WI 53551
 toll free 1.800.335.4348 • phone 1.920.648.4090 • fax 1.920.648.3373
www.visionfitness.com

©2002 Vision Fitness. All Rights Reserved. 8.02 Part #Z66EP24-AG1826PRD
 AG18.26PRD
 REV1

Free Manuals Download Website

<http://myh66.com>

<http://usermanuals.us>

<http://www.somanuals.com>

<http://www.4manuals.cc>

<http://www.manual-lib.com>

<http://www.404manual.com>

<http://www.luxmanual.com>

<http://aubethermostatmanual.com>

Golf course search by state

<http://golfingnear.com>

Email search by domain

<http://emailbydomain.com>

Auto manuals search

<http://auto.somanuals.com>

TV manuals search

<http://tv.somanuals.com>