



# **ECKMF-6**

# **HOW TO INSTALL YOUR AUTOMATIC ICE MAKER**

**Use These Instructions  
For Top And Bottom  
Freezer Refrigerators Only**

THE PARTS IN THIS KIT ARE USED FOR MORE THAN ONE MODEL

# KEEP ALL PARTS IN THEIR OWN PACKAGE UNTIL USED.

Parts are listed in order of usage.  
Arrange in order before starting installation.

PART NAME AND NUMBER	NUMBER REQUIRED	USED IN STEP NUMBER
627649 TUBING	1	A1
538532 BRACKETS	2	A4
538533 CLIPS	2	A4
488644 SCREWS	3	2-A4—1-A8
502037 GROMMET	1	A4
627131 ADAPTER PLUG	1	A5
849909 ALUMINUM FILL TUBE	1	A6
835649 GROMMET	1	A6
626456 ICE MAKER	1	A8
939529 ICE BUCKET	1	A9
488649 SCREWS	2	B3
488878 CLAMP	1	C1
841707 TUBE INSERTS	2	1-C1—1-C4
488645 SCREWS	4	1-C1—2-C2—1-C5
488366 CLAMPS	2	C2
627018 NUT AND SLEEVE	1	C4
836200 COPPER TUBING, WITH WASHER AND NUT	1	C5
836074 SLEEVE	1	C5
510716 CLAMP	1	C5

## OTHER ITEMS AND TOOLS YOU WILL NEED

The following materials must be obtained locally to connect the water line to Ice Maker.

¼" O.D. Copper Tubing—See Step D2 for length

1—Shut-off valve—¼" outlet

1—Tube union—¼" x ¼"

These parts are available from your Whirlpool dealer or local hardware store.

- 5" (overall length) slot head screwdriver
- ¼" spinner wrench
- Two 6" or 8" adjustable open end wrenches
- Sharp knife
- Table knife
- Hacksaw

# A. CONNECTING ICE MAKER TO FREEZER

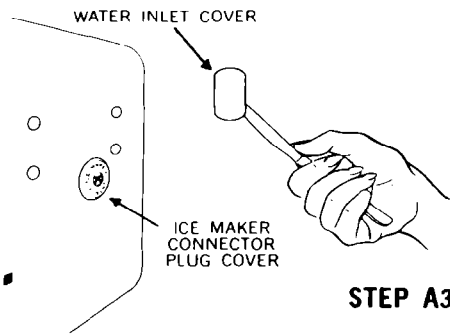

**A1.** Put tubing (#627649) in pan of hot tap water to soften it. This will make it easier to install.

**A2.** Unplug electrical cord from wall.

**A3.** With a table knife, pry out all the plastic plugs. Do not remove Ice Maker connector plug cover.

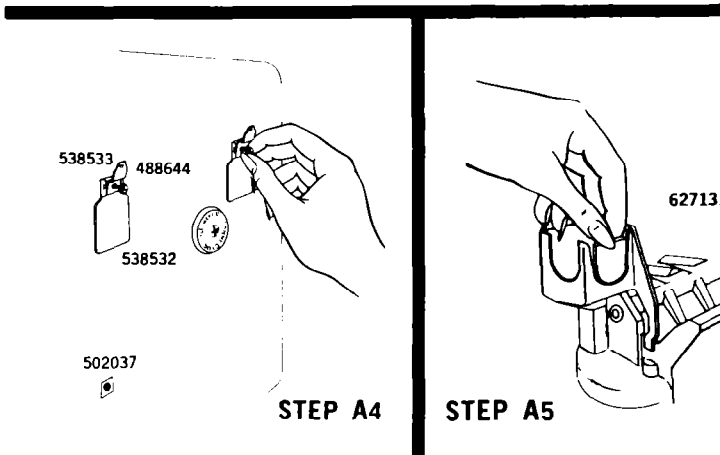

**A4.** Insert the 2 brackets (#538532) into the side of the freezer wall. Attach one clip (#538533) and screw (#488644) to each of the two brackets. Leave screw loose. Insert grommet (#502037) into square hole on left wall.

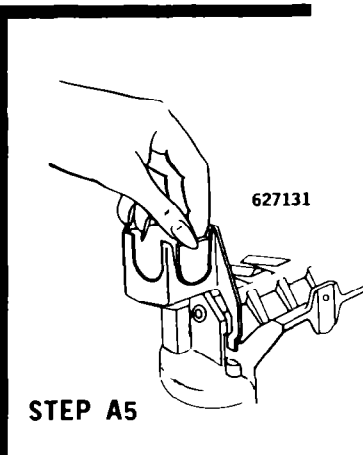

**A5.** Be sure the sliding adapter plug (#627131) is in the side of the water fill trough as shown.

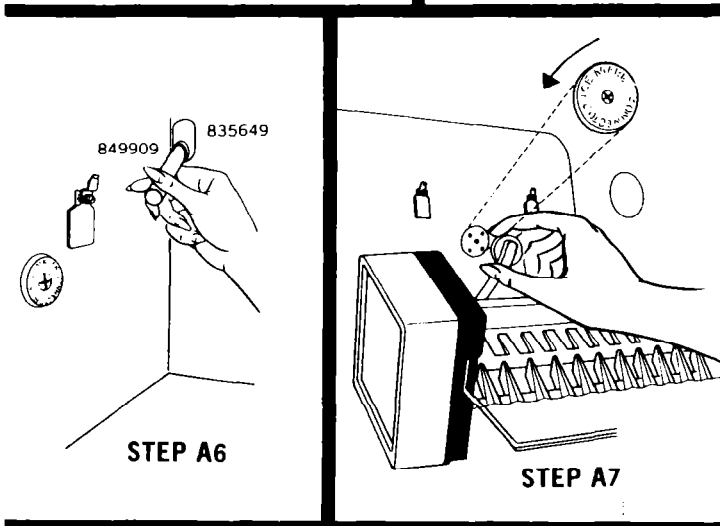

**A6.** Remove (#849909) aluminum fill tube from package. Cut off tube as shown on instructions for top freezer models packed with tube. Slip #849909 up over water inlet tube (factory installed). Make sure that tubes are properly engaged by looking in oblong hole. Move grommet (#835649) up over tube to cover oblong hole.

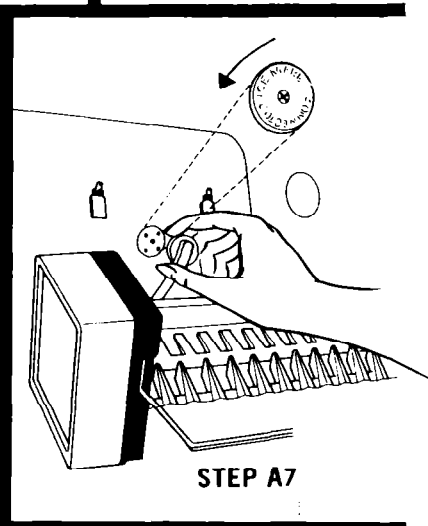

**A7.** Remove ICE MAKER CONNECTOR plug cover by inserting screw driver in slot and rotating driver to left. Insert Ice Maker connector into the receptacle under "ICE MAKER CONNECTOR" plug cover.

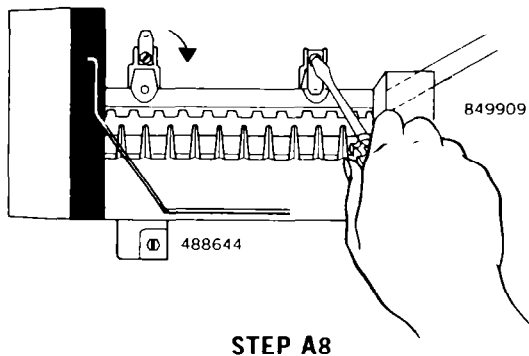

**A8.** Attach the Ice Maker to the side of the freezer by inserting screw (#488644) through bracket on bottom front of Ice Maker, and into grommet (#502037). Rotate clips down and tighten screws. Be sure that water fill tube (#849909) is in water fill trough of Ice Maker as shown in A8.

**A9.** Place ice bucket under Ice Maker.

## B. INSTALLING WATER VALVE ON LOWER BACK OF CABINET LEG

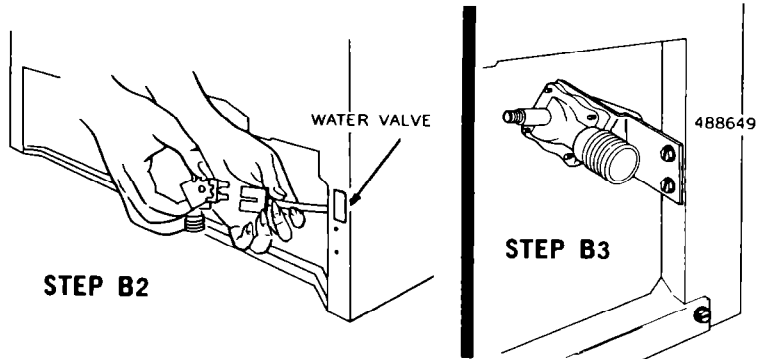

- B1.** Temporarily remove screws from right end of lower back cover, if present.
- B2.** Insert water valve into receptacle terminals completely so terminals are not exposed.
- B3.** Fasten valve to right rear leg of the refrigerator with two screws (#488649).

## C. INSTALLING WATER LINE BETWEEN INLET TUBE (top) AND WATER VALVE (bottom)

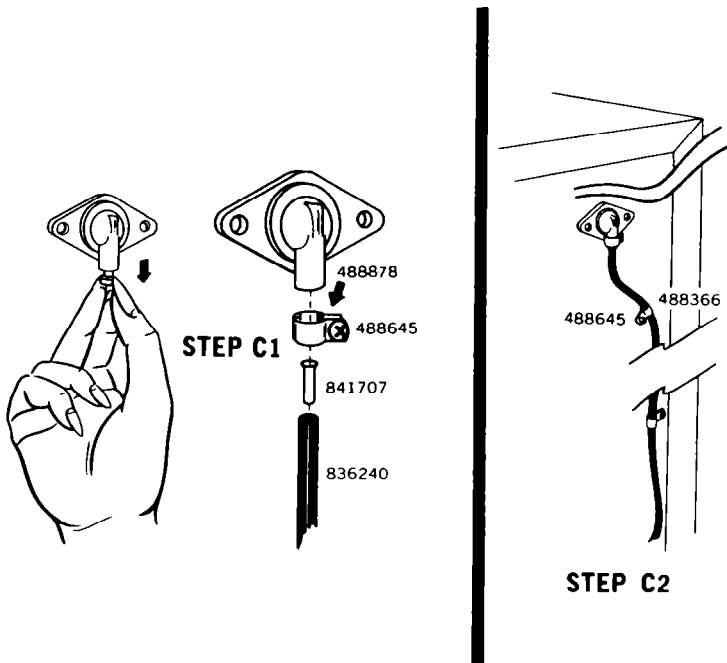

- C1.** Remove plug from factory installed inlet tube on back. Place one clamp (#488878) over the spout. Put tube insert (#841707) in one end of tubing that has been soaking in hot water. Put end of tubing into spout. Tighten clamp with screw (#488645).
- C2.** Place 2 clamps (#488366) over tubing. Remove two upper sealing screws in back of cabinet and throw away. Anchor clamps to cabinet with screws (#488645). (If lower back cover is not present or on bottom freezer refrigerator, use 1 clamp and 1 screw.)
- C3.** Be sure that tube is clear of fan. Cut off extra tubing.

#### STEP C4

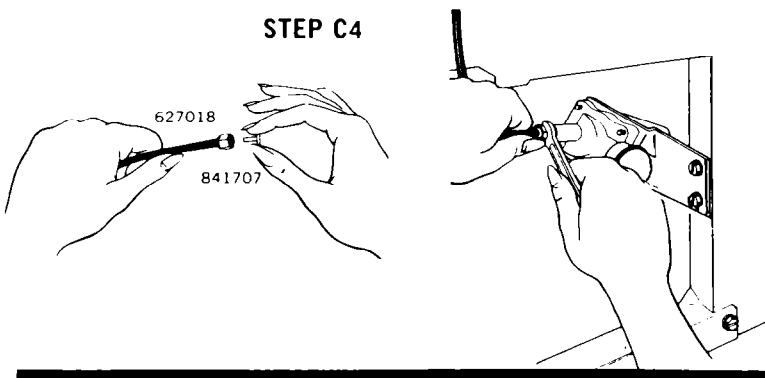

**C4.** Slide nut and sleeve (#627018) over tubing. Push tube insert (#841707) into end of tubing. Push end of tubing into water valve. Tighten the retaining nut, but do not overtighten.

**C5.** Attach copper tubing and hose connector (#836200) to water valve. Be sure that rubber washer is in place, and tighten hose connector. Anchor to refrigerator with sleeve (#836074), clamp (#510716) and screw (#488645).

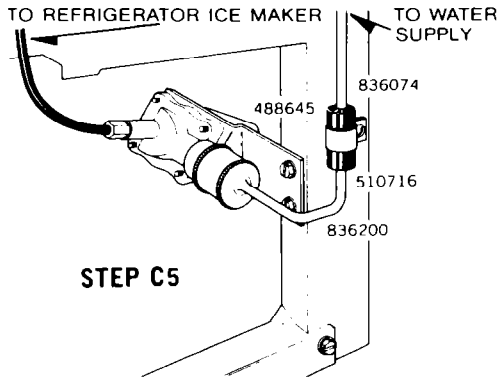

#### STEP C5

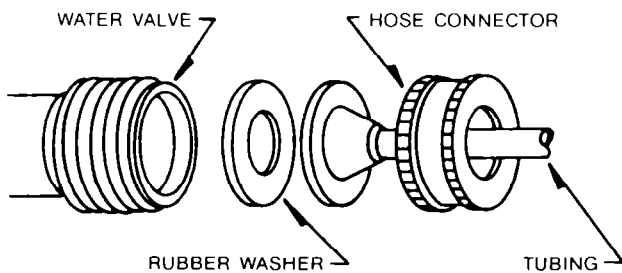

## D. CONNECTING ICE MAKER TO WATER SUPPLY

You will need enough 1/4-inch O.D. copper tubing to connect refrigerator to water source.

### TYPICAL WAYS TO CONNECT TO WATER SUPPLY

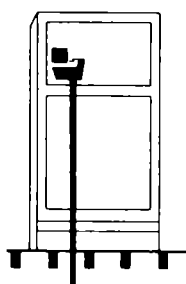

Through floor to basement cold water pipe.

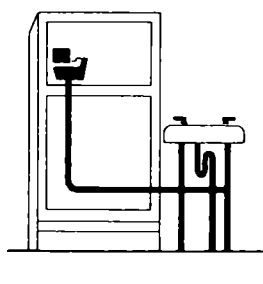

Under sink to cold water pipe.

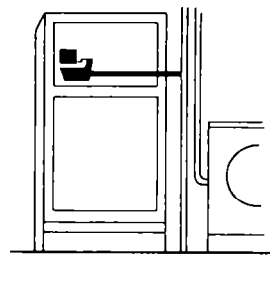

Through wall to utility room cold water pipe.

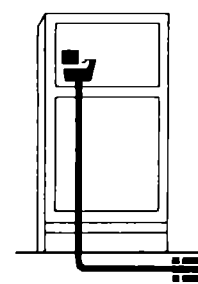

In crawl space under home.

**CAUTION:** Ice Maker tubing should not be installed where temperature may fall below freezing.

**D1.** Find a  $\frac{3}{8}$ -inch to 1-inch vertical COLD water pipe near the refrigerator. (Horizontal pipe will work ... but extra precautions must be taken.)

**D2.** Measure from inlet on rear of refrigerator to water pipe. Add 7 feet to allow for moving refrigerator for cleaning. This is the length of  $\frac{1}{4}$ -inch O.D. copper tubing you will need for the job (length from inlet tube to water pipe PLUS 7 feet). Be sure both ends of copper tubing are cut square.

**D3.** Turn OFF main water supply. Turn ON nearest faucet long enough to clear line of water.

**D4. Using a grounded drill,** drill a  $\frac{3}{16}$ -inch hole in the vertical cold water pipe you have selected.

Some water almost always remains in pipes. If it enters the drill, it can cause lethal shock. **BE SURE YOUR DRILL IS GROUNDED.**

Fasten a separate ground wire from drill to a good ground that complies to local electrical codes. (If in doubt, consult a licensed electrician.) **UNLESS PROPER GROUNDING IS FOLLOWED, YOU ARE NOT PROTECTED AGAINST SEVERE OR LETHAL SHOCK.**

**If you must use a horizontal pipe, take extra precautions:**

**Drill on the top or side of the pipe, not bottom.** This helps keep water away from the drill. Also, it keeps normal sediment from collecting in the valve.

**D5.** Fasten *shutoff valve* to cold water pipe with pipe clamp. Be sure *inlet end* is solidly in the  $\frac{3}{16}$ -inch drilled hole in the water pipe and that *washer* is under the *pipe clamp*. Tighten packing nut. Tighten the *pipe clamp* screws carefully and evenly so *washer* makes a watertight connection. Do not overtighten or you may crush copper tubing, especially if soft copper tubing is used. Now you are ready to connect the copper tubing.

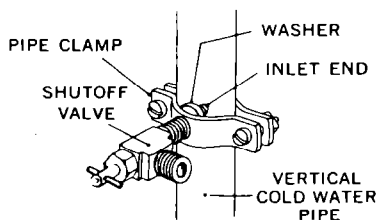

**D6.** Slip *compression nut* and *compression sleeve* on copper tubing as shown in diagram. Insert end of tubing into *outlet end* squarely as far as it will go. Screw *compression nut* to *outlet end* with adjustable wrench. Do not overtighten. Turn ON main water supply and flush out tubing until water is clear. Turn OFF *shutoff valve* on the water pipe. You are now ready to connect other end of  $\frac{1}{4}$ -inch copper tubing to inlet tube or water valve on back of refrigerator.

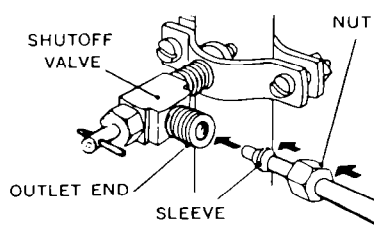

**D7.** Assemble *compression nuts* on tubing as shown in diagram. Insert ends of tubing into *connector* and tighten *compression nuts*. Be sure ends of tubing are squarely in connector as far as they will go. Do not overtighten.

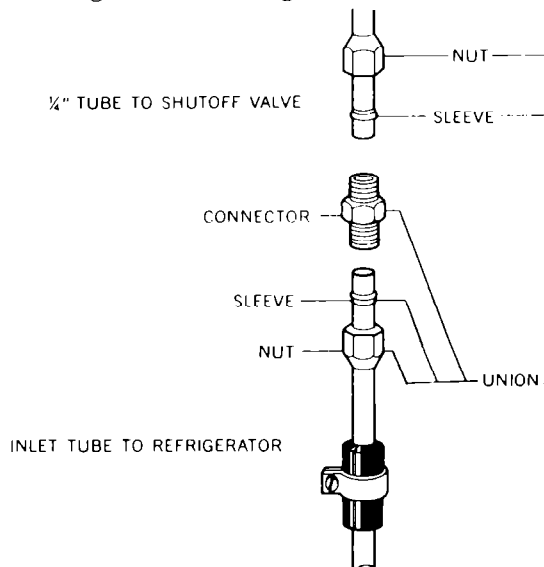

**D8.** Turn shutoff valve on. **TIGHTEN ANY CONNECTIONS OR NUTS THAT LEAK.**

**D9.** REPLACE LOWER BACK COVER PREVIOUSLY REMOVED.

**D10.** Copper tubing may now be fastened to base-board.

**D11.** The Ice Maker is equipped with a built-in water strainer located on the inlet side of the water valve. If local water conditions require periodic cleaning or a well is your source of water supply, a second water strainer should be installed in the  $\frac{1}{4}$ -inch water line.

**D12. Water Pressure Limitations:** Not below (15 P.S.I.) or above (125 P.S.I.). If a problem occurs call your Utility Company.

**D13. PLUG IN YOUR REFRIGERATOR.**

When you have your first batch of ice you may throw away extra parts.

**IMPORTANT:**

**It may take up to 24 hours for your Ice Maker to begin producing ice crescents.**

**To enjoy your Ice Maker most PLEASE READ CAREFULLY THE ICE MAKER SECTION OF YOUR USE AND CARE GUIDE.**

## Free Manuals Download Website

<http://myh66.com>

<http://usermanuals.us>

<http://www.somanuals.com>

<http://www.4manuals.cc>

<http://www.manual-lib.com>

<http://www.404manual.com>

<http://www.luxmanual.com>

<http://aubethermostatmanual.com>

Golf course search by state

<http://golfingnear.com>

Email search by domain

<http://emailbydomain.com>

Auto manuals search

<http://auto.somanuals.com>

TV manuals search

<http://tv.somanuals.com>