

RANGE COMPOSITION

A complete and flexible range of cold rooms ideal for storing and conserving perishable food (meat, fish, cold cuts, cheese, fruit, vegetables), in addition to chilled and frozen food. Constructed in top quality, reliable materials, they are manufactured with the utmost attention paid to eliminating possible ecological damage. All models can be connected to a refrigeration unit installed directly inset on the wall of the cold room or to a remote refrigeration unit. The availability of a remote condenser unit is particularly useful when using cold rooms in environments with critical ambient temperatures, ventilation or space problems. The models detailed on this sheet are 4 cold rooms (-2°+8°C) with built-in refrigerating unit and with usable volume of 6,7 to 8 m³ with panel insulation 60 mm in thickness. All models come with panels, gas precharged cooling unit and piping.



Shelving as accessory

6.7/ 8 m³

SPLIT UNIT COLD ROOMS -2° + 8°C ZANUSSI PROFESSIONAL

FUNCTIONAL AND CONSTRUCTION FEATURES

- ◆ Assembly system that guarantees minimal temperature loss through twin hook fasteners which allow perfect alignment of the panels. This fastener is made of high resistant composite material and guarantees perfect grip of all components that can be easily disassembled and reassembled.
- ◆ Wall panels and inside ceiling panels are clad with anti-scratch prepainted galvanized steel
- ◆ All panels are insulated with injected polyurethane.CFC and HCFC free
- ◆ All panels have PVC gaskets foamed in place to assure airtight and secure fitting. Any other sealing between panels on site is eliminated.
- ◆ Galvanized steel floor covered with a non-abrasive, non-slip, ribbed plastic coat
- ◆ Rounded internal and external corners.
- ◆ The right-hinged door is available as standard (left-hinged door on request) and constructed with smooth rounded profiles, cam-lift action hinges, airtight magnetic door, gaskets and high insulation for saving energy and operating costs. As an option a microswitch switches on automatically the internal light and turns off the fans
- ◆ Newly designed handle, complete with lock has an internal safety release to prevent

entrapment when the door is accidentally locked from outside.

- ◆ Powerful tropicalized refrigeration system designed to operate more efficiently and without failure in the most extreme temperatures (up to 43°C).
- ◆ Prefitted and insulated pipes for connection between evaporator and condensing unit with fast connectors.
- ◆ Defrosting through heated gas permits to reduce the total power installed shorten defrosting time and limited warming of the cold room.
- ◆ The control panel includes: luminous ON/OFF switch, internal lighting switch, cold room functioning indicator, defrosting cycle

indicator, temperature and thermostat control with digital display.

- ◆ All models comply with the standards required by the main international approval bodies and are H marked.

| CHARACTERISTICS | MODELS | | | |
|--------------------------------------|----------------------|----------------------|----------------------|----------------------|
| | MN06720RCL 102256 | MN06716RCL 102273 | MN08024RCL 102257 | MN08016RCL 102278 |
| External dimensions - mm | | | | |
| width | 1750 | 2150 | 1750 | 2550 |
| depth | 2150 | 1750 | 2550 | 1750 |
| height | 2150 | 2150 | 2150 | 2150 |
| Internal dimensions - mm | | | | |
| width | 1630 | 2030 | 1630 | 2430 |
| depth | 2030 | 1630 | 2430 | 1630 |
| height | 2030 | 2030 | 2030 | 2030 |
| Power - kW | | | | |
| installed-electric | 0.85 | 0.85 | 0.85 | 0.85 |
| Noise level - dBA | 60 | 60 | 60 | 60 |
| Net weight - kg. | 316 | 316 | 446 | 385 |
| Power supply - V, phases, Hz | 230 V, 1N, 50 | 230 V, 1N, 50 | 230 V, 1N, 50 | 230 V, 1N, 50 |
| Usable surface area - m ² | 3,31 | 3,31 | 3,96 | 3,96 |
| Usable volume - m ³ . | 6,7 | 6,7 | 8,0 | 8,0 |
| Refrigeration unit | | | | |
| Compressor power - HP | 0,75 | 0,75 | 0,75 | 0,75 |

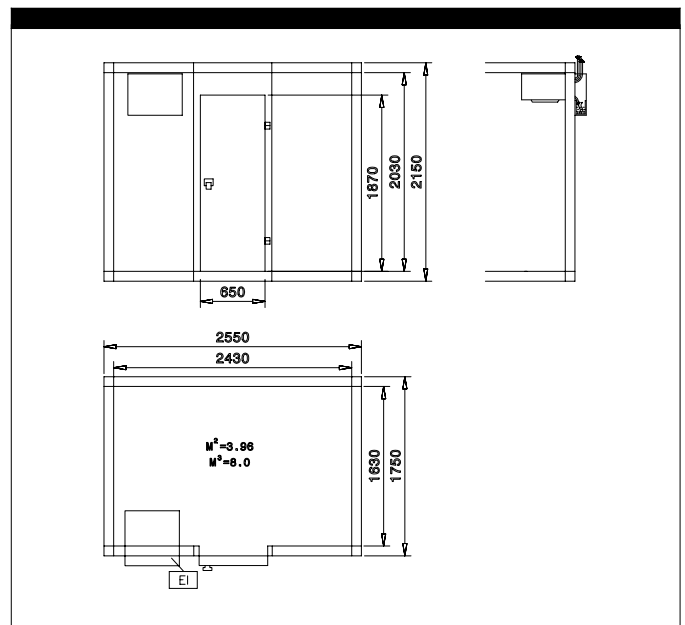
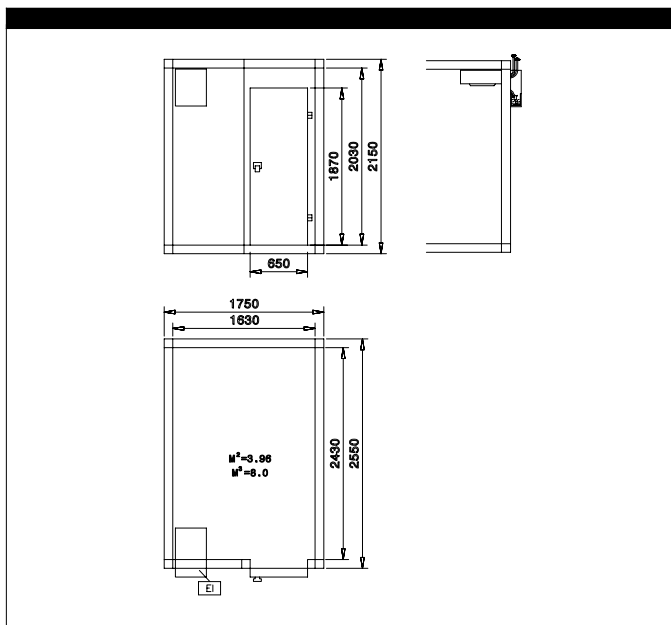
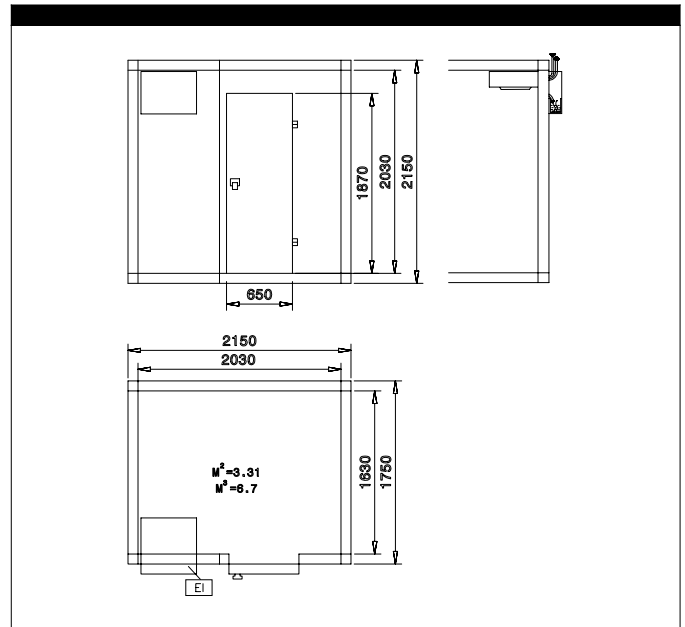
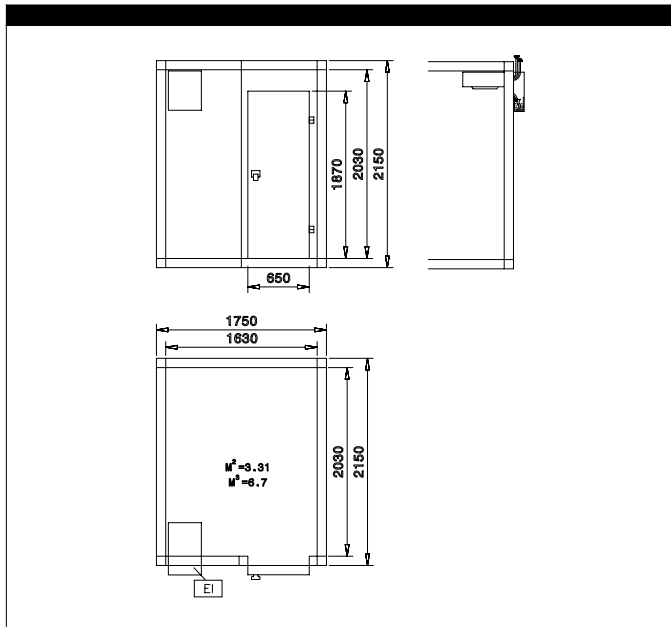

| | MN06720RCL 102256 | MN06716RCL 102273 | MN08024RCL 102257 | MN08016RCL 102278 |
|--------------------------------------|----------------------|----------------------|----------------------|----------------------|
| EI - Electrical connection | 230 V, 1N, 50 | 230 V, 1N, 50 | 230 V, 1N, 50 | 230 V, 1N, 50 |
| RI - Remote refrigeration connection | ● | ● | ● | ● |



| ACCESSORIES | MODELS | | | |
|---|----------------------|----------------------|----------------------|----------------------|
| | MN06720RCL 102256 | MN06716RCL 102273 | MN08024RCL 102257 | MN08016RCL 102278 |
| ALUM.SHELV.,POLY.TIERS-COLDROOM 163X203 | 137092 | | | |
| ALUM.SHELV.,POLY.TIERS-COLDROOM 163X243 | | | 137093 | |
| ALUM.SHELV.,POLY.TIERS-COLDROOM 203X163 | | 137096 | | |
| ALUM.SHELV.,POLY.TIERS-COLDROOM 243X163 | | | | 137101 |
| DOOR MICROSWITCH | 102441 | 102441 | 102441 | 102441 |
| GRAPHIC TEMPERATURE RECORDER | 102025 | 102025 | 102025 | 102025 |
| KIT HACCP ADV.CONNECTION FOR COLD ROOMS | 102021 | 102021 | 102021 | 102021 |
| PLASTIC CURTAIN FOR 65CM DOOR CLEARANCE | 102027 | 102027 | 102027 | 102027 |
| PRINTER FOR HACCP BASIC VERSION REFRIG. | 881457 | 881457 | 881457 | 881457 |
| PRINTER FOR TEMPERATURE RECORDER | 102026 | 102026 | 102026 | 102026 |



www.zanussiprofessional.com

Free Manuals Download Website

<http://myh66.com>

<http://usermanuals.us>

<http://www.somanuals.com>

<http://www.4manuals.cc>

<http://www.manual-lib.com>

<http://www.404manual.com>

<http://www.luxmanual.com>

<http://aubethermostatmanual.com>

Golf course search by state

<http://golfingnear.com>

Email search by domain

<http://emailbydomain.com>

Auto manuals search

<http://auto.somanuals.com>

TV manuals search

<http://tv.somanuals.com>