

Your ThinkPad® X1 Carbon computer (20A7 and 20A8) comes with many innovative features designed to provide a pleasurable ownership experience whether you use it for work, personal projects, or entertainment.

### In the box

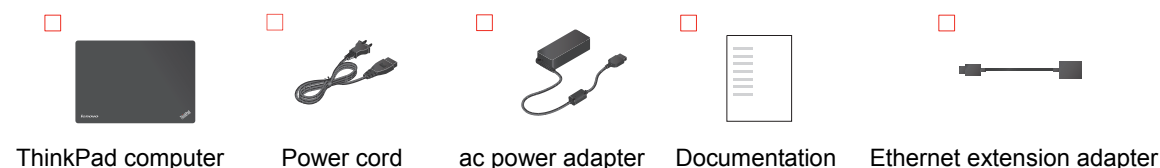

### Getting started

Read the safety information in the accompanying *Safety and Warranty Guide* before you begin the setup instructions.

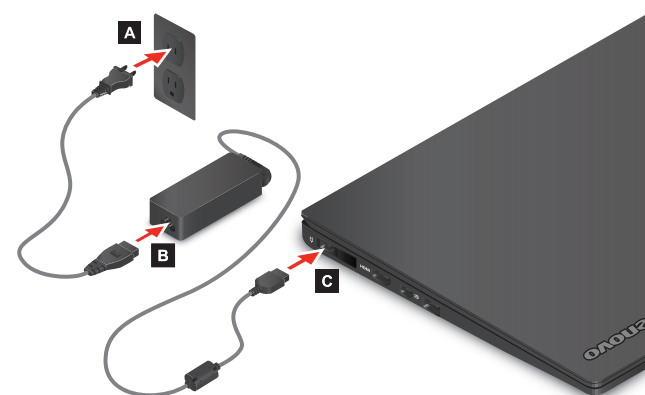

1. Connect to power as shown. Ensure that all power cord connectors are securely and completely plugged into receptacles.
2. Press the power button to turn on the computer.
3. Configure the operating system following the on-screen instructions to complete the initial setup. This process takes several minutes.

Additional information about using your ThinkPad computer is in the *User Guide*. See "Accessing your *User Guide*" later in this document.

### Connectors

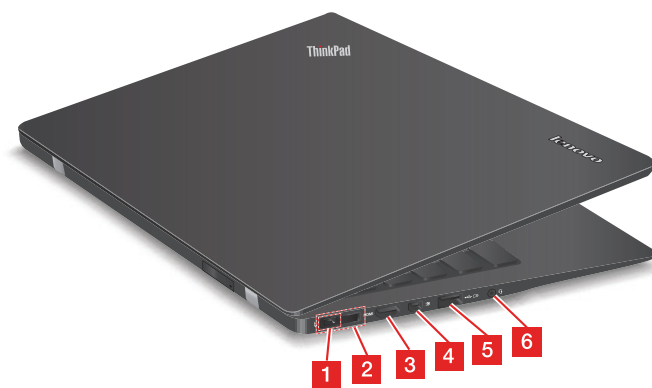

- 1 Power connector
- 2 Lenovo OneLink connector
- 3 HDMI™ connector
- 4 Mini DisplayPort® connector
- 5 Always-on USB 3.0 connector
- 6 Audio connector



- 1 USB 3.0 connector
- 2 Ethernet extension connector
- 3 Security-lock slot
- 4 Micro-SIM-card tray (on some models)

### Accessing your User Guide

Your *User Guide* is preinstalled on your computer in an electronic format. To access your *User Guide*, do the following:

- Windows® 8.1: Press the Windows key + F1. Windows Help and Support opens. Click or tap **Lenovo User Guide**.
- Windows 7: Click or tap **Start** → **Help and Support**. Windows Help and Support opens. Click or tap **Lenovo User Guide**.

The most up-to-date version of your *User Guide* is available at <http://www.lenovo.com/UserManuals>.

### Controls

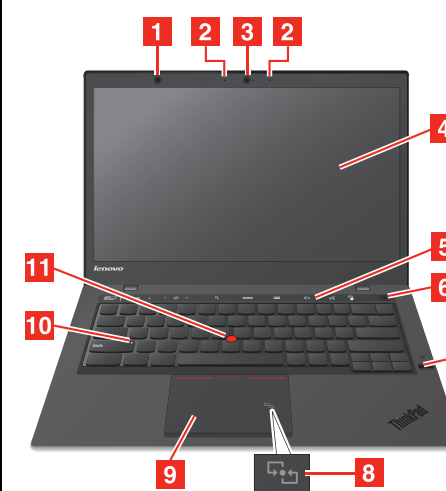

- 1 Ambient light sensor
- 2 Microphones
- 3 Camera
- 4 Screen (multi-touch or non-touch)
- 5 Adaptive Keys
- 6 Power button with indicator
- 7 Fingerprint reader
- 8 NFC control
- 9 ThinkPad trackpad
- 10 Shift key with indicator
- 11 TrackPoint® pointing stick

\* Double-tap the shift key to enable or disable Caps Lock mode. When the indicator is on, the Caps Lock mode is enabled.

**Note:** The Adaptive Keyboard integrates dynamically changing keys that provide additional functionality based on the type of application that is active. Refer to the accompanying *Adaptive Keys, Gestures, and Voice* booklet for details.

### ThinkPad OneLink dock accessory



You can attach your computer to any of the ThinkPad OneLink dock series to expand the working capability of your computer.

The ThinkPad OneLink dock attaches to monitors and USB devices, and also provides power to your computer all from one cable.

To purchase a ThinkPad OneLink dock, go to:

<http://www.lenovo.com/essentials>

## Camera gestures

Tap the Camera-gestures icon  on your keyboard to enable or disable the camera gestures. The green indicator illuminates when the camera gestures function is enabled.

Camera gestures are available only for certain applications, for example: **1** Media Players, **2** PowerPoint® (full-screen mode), **3** PDF/E-books (full-screen mode), **4** Picture viewer (slide-show mode), and **5** Supported games (full-screen mode).



### Hold

Enable hand-tracking  
Supported applications: **2 3**



### Up

Show blank slide  
Supported applications: **2**



### Wave left to right

Previous track/slide/page/photo  
Supported applications: **1 2 3 4**



### Wave right to left

Next track/slide/page/photo  
Supported applications: **1 2 3 4**

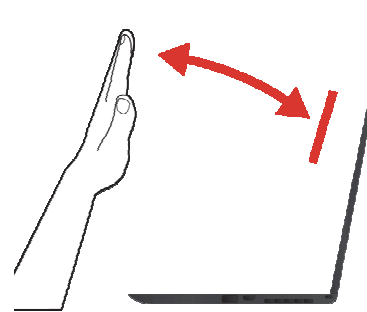

### Tap

Pause/play  
Supported applications: **1**

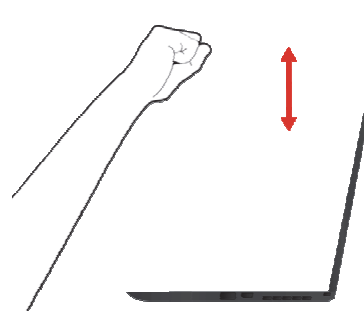

### Up/down

Adjust volume  
Supported applications: **1 2 3 4**

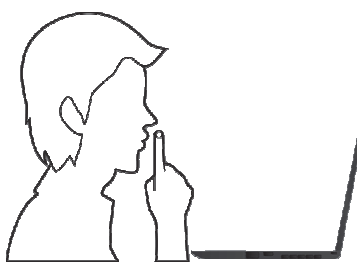

### Finger to mouth

Mute/unmute the speakers  
Supported applications: **1 2 3 4**



### Hand movement

Mouse pointer control  
Supported applications: **2 3 5**

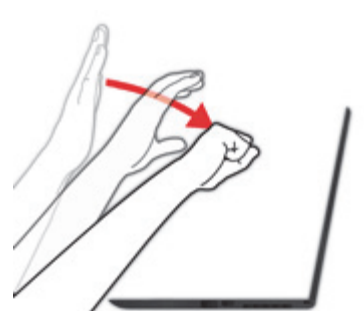

### Grab

Select/drag/drop  
Supported applications: **2 3 5**

## Lenovo Support telephone list

Refer to your *Safety and Warranty Guide* or <http://www.lenovo.com/support/phone> for a listing of Worldwide Lenovo Support phone numbers. Telephone numbers are subject to change without notice. The most up-to-date list of telephone numbers is available at <http://www.lenovo.com/support/phone>

## Voice recognition

Tap the Voice-recognition icon  on your keyboard and then speak your voice command. The green indicator illuminates when the voice-recognition function is enabled. Your computer might support only some of the following voice commands.

**Note:** The voice-recognition application supports certain languages, dialects, and geographic locations only. If your operating-system language or geographic location is not supported, the voice recognition application is not provided with your computer.



### General

- Goodbye Dragon
- Go to sleep
- Next page
- Previous page
- Cancel
- Launch <program name>



### E-mail

- Check my e-mail
- Show me number <n>
- Read it to me
- Reply <message>



### Get Help

- What can I say?
- What can I say in Calendar?
- What can I say in Facebook?
- What can I say in Media?
- What can I say in Skype?



### Skype

- Open Skype
- Make a call
- Skype <contact's name>



### Search

- Search Amazon for <search item>
- Search eBay for <search item>
- Search Pandora for <search item>
- Search YouTube for <search item>



### Twitter

- Post to Twitter <item to post>
- Check my Twitter timeline
- Check my Twitter messages
- Reply to number <n>



### Media

- Play artist <artist name>
- Play album <album name>
- Play song <song name>
- Pause/play
- Volume up/down



### Facebook

- Post to Facebook <item to post>
- Check my Facebook
- Check my Facebook messages
- Check my Facebook notifications
- Show me number <n>
- Reply to number <n>



### Calendar

- Check my calendar
- Show my appointments for today
- Show me number <n>
- Read it to me

## Legal notices

Lenovo, For Those Who Do., the Lenovo logo, ThinkPad, and TrackPoint are trademarks of Lenovo in the United States, other countries, or both.

Windows and PowerPoint are trademarks of the Microsoft group of companies.

The term HDMI is a trademark of HDMI Licensing LLC in the United States and other countries.

Mini DisplayPort (mDP) is a trademark of the Video Electronics Standards Association.

Other company, product, or service names may be trademarks or service marks of others.

For additional legal notices, refer to the *User Guide* for your computer. See "Accessing your *User Guide*" for additional information.

## Free Manuals Download Website

<http://myh66.com>

<http://usermanuals.us>

<http://www.somanuals.com>

<http://www.4manuals.cc>

<http://www.manual-lib.com>

<http://www.404manual.com>

<http://www.luxmanual.com>

<http://aubethermostatmanual.com>

Golf course search by state

<http://golfingnear.com>

Email search by domain

<http://emailbydomain.com>

Auto manuals search

<http://auto.somanuals.com>

TV manuals search

<http://tv.somanuals.com>