

User's Guide

M197WA

Make sure to read the **Safety Precautions** before using the product.

Keep the User's Guide(CD) in an accessible place for future reference.

See the label attached on the product and give the information to your dealer when you ask for service.



Before Connecting to the PC

Stand Installation

- Before setting up the product, ensure that the power supply, the computer system, and other attached devices is turned off.

1 Carefully place the product screen side down on a cushioned surface that will protect product and screen from damage.

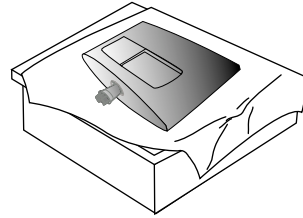

2 Insert the **stand base** into the product

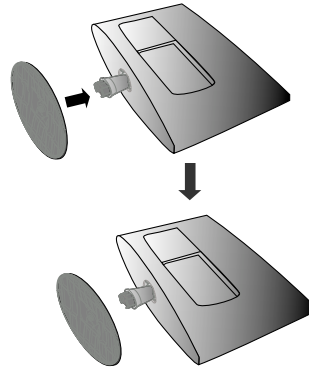

3 Attach the monitor to the Stand Base by turning the screw to the right.

* Turn the screw by using the screw handle

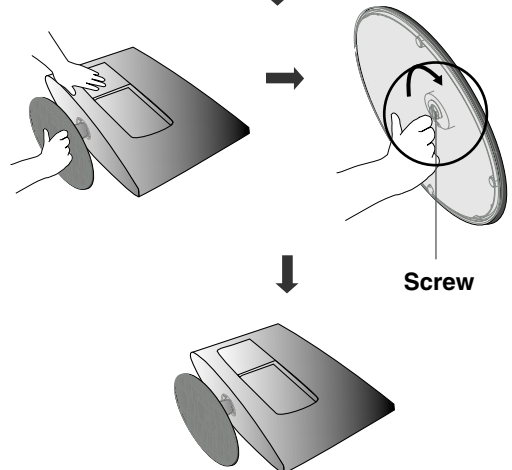

Before Connecting to the PC

Detaching Stand

- Before setting up the product, ensure that the power supply, the computer system, and other attached devices is turned off.

1 Place the set screen side down on a cushion or soft cloth.

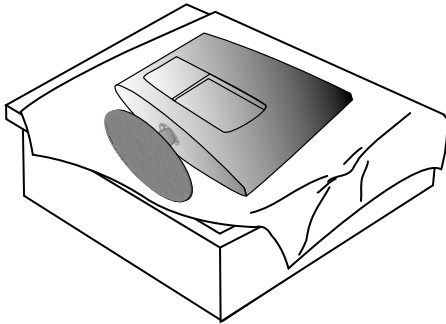

2 Detach the monitor to the Stand Base by turning the screw to the left.

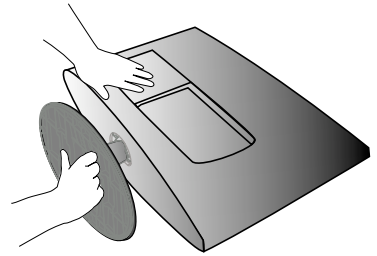

3 Turn the screw by using the screw handle

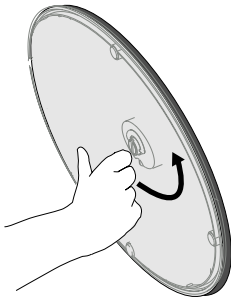

4 Pull the stand base.

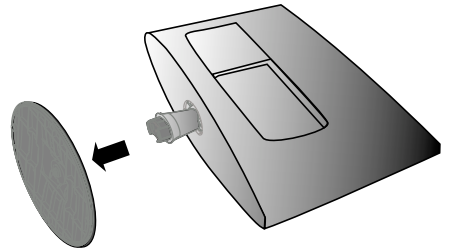

5

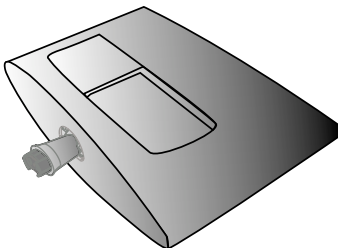

Before Connecting to the PC

- Before setting up the product, ensure that the power supply, the computer system, and other attached devices is turned off.

Positioning your display

1. Adjust the position of the panel in various ways for maximum comfort.

- Tilt Range

-6° ~ -2°

12° ~ 18°

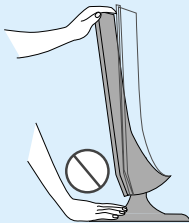
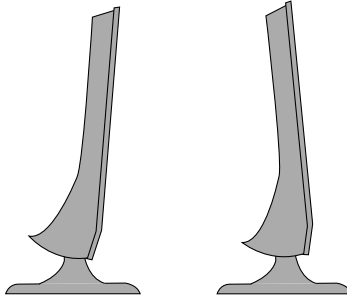

Warning:

When adjusting the angle of the screen, do not put your finger(s) in between the head of the monitor and the stand body. You can hurt your finger(s).

Theft prevention locking device

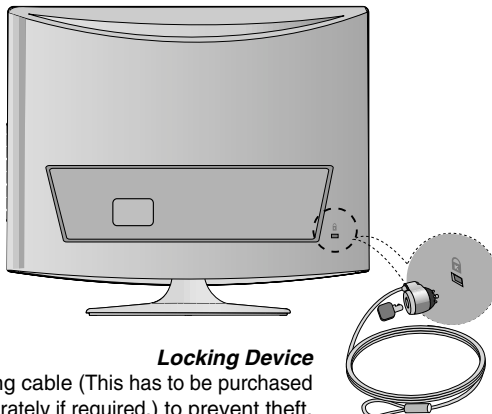

Locking Device

Use this locking cable (This has to be purchased separately if required.) to prevent theft.

Before Connecting to the PC

WALL MOUNT:HORIZONTAL INSTALLATION

For proper ventilation, allow a clearance of 4 inches on each side and from the wall. Detailed installation instructions are available from your dealer, see the optional Tilt Wall Mounting Bracket Installation and Setup Guide.

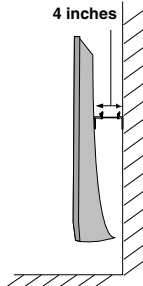
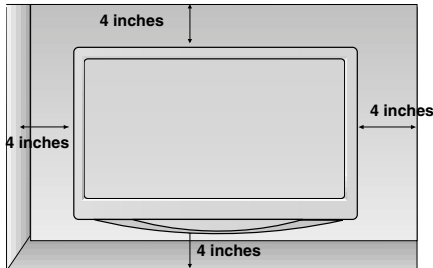
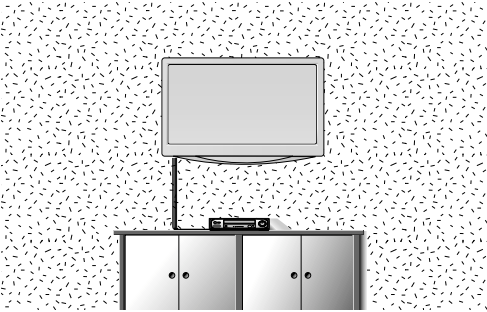

Name and Function of the Parts

● Name of the Remote Control Buttons

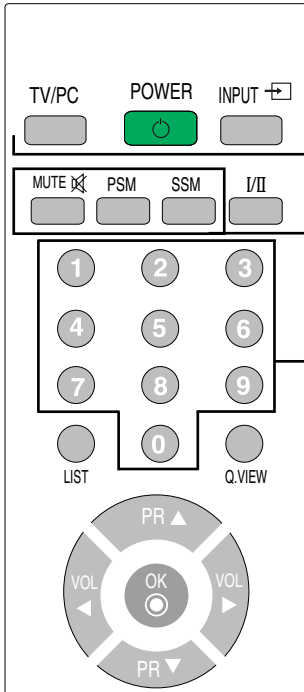

TV/PC : Selects TV or PC mode.
Switches the set on.

POWER INPUT



Each time you press the Input button it will change to
TV → AV → Component →
RGB → DVI → HDMI
If nothing is inputted for several seconds the screen will automatically move to the selected menu.

MUTE

Switches the sound on or off.

PSM (Picture Status Memory) Button

Press repeatedly to select **Dynamic, Standard, Mild, Game** or **User** picture mode.

SSM (Sound Status Memory) Button

Use this button to select the sound tone.
Press repeatedly to select **Flat, Music, Movie, Sports, User** sound tone.

Number buttons

Able to directly select and change channel.

■ **NOTE** : In case of weak stereo sound signals, with stereo or Nicam stereo transmission, select mono reception.

● Inserting batteries into remote control.

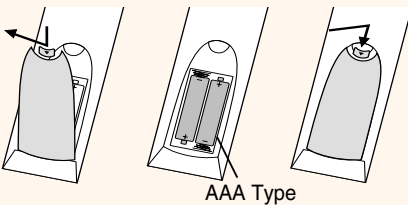

AAA Type

1. Take out the battery cap.
2. Insert the batteries with correct polarity (+/-).
3. Close the battery cap.
 - Dispose of used batteries in the recycle bin to prevent environmental pollution.

Name and Function of the Parts

● Name of the Remote Control Buttons

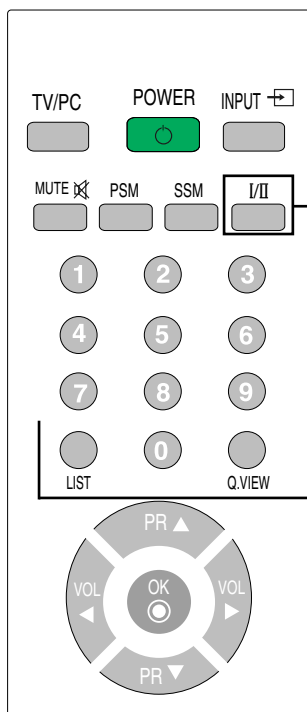

I/II : Bilingual choice and sound mode selection

[TV]

- To switch from **Stereo** to **Mono** sound in case of stereo transmission, or from **Nicam Stereo** to **Nicam Mono**, in case of digital transmission.
- to switch from **Nicam Dual I** to **Nicam Dual II** or **Nicam Dual I+II** in case of Nicam Dual transmission.
- to choose between **Dual I**, **Dual II** or **Dual I+II** in case of bilingual transmission :
Dual I sends the primary broadcast language to the loudspeakers ;
Dual II sends the secondary broadcast language to the loudspeakers ;
Dual I+II sends a separate language to each loudspeakers.

[AV / Component]

In AV/Component mode, you can select output sound for the left and right loudspeakers. Repeatedly press the I/II button to select the sound output.

- L+R : Audio signal from audio L input is sent to left loud-speaker and audio signal from audio R input is sent to right loud-speaker.
- L+L : Audio signal from audio L input is sent to left and right loud-speakers.
- R+R : Audio signal from audio R input is sent to left and right loud-speakers.

LIST : Programme list

To display the programme list (0~ 99).

| Programme List | | | |
|----------------|---|----|--------|
| 0 | C | 01 | 5 C 07 |
| 1 | C | 35 | 6 C 50 |
| 2 | C | 05 | 7 C 51 |
| 3 | C | 11 | 8 C 41 |
| 4 | C | 04 | 9 C 63 |

▲▼ ◀▶ OK MENU

Note: TV channels displayed in blue have been setup to be skipped in the Programme Edit menu.

Q.VIEW : QUICK VIEW Button

To display the previously selected TV channel

Name and Function of the Parts

● Name of the Remote Control Buttons

(Depends on the country the remote control can be provided different.)

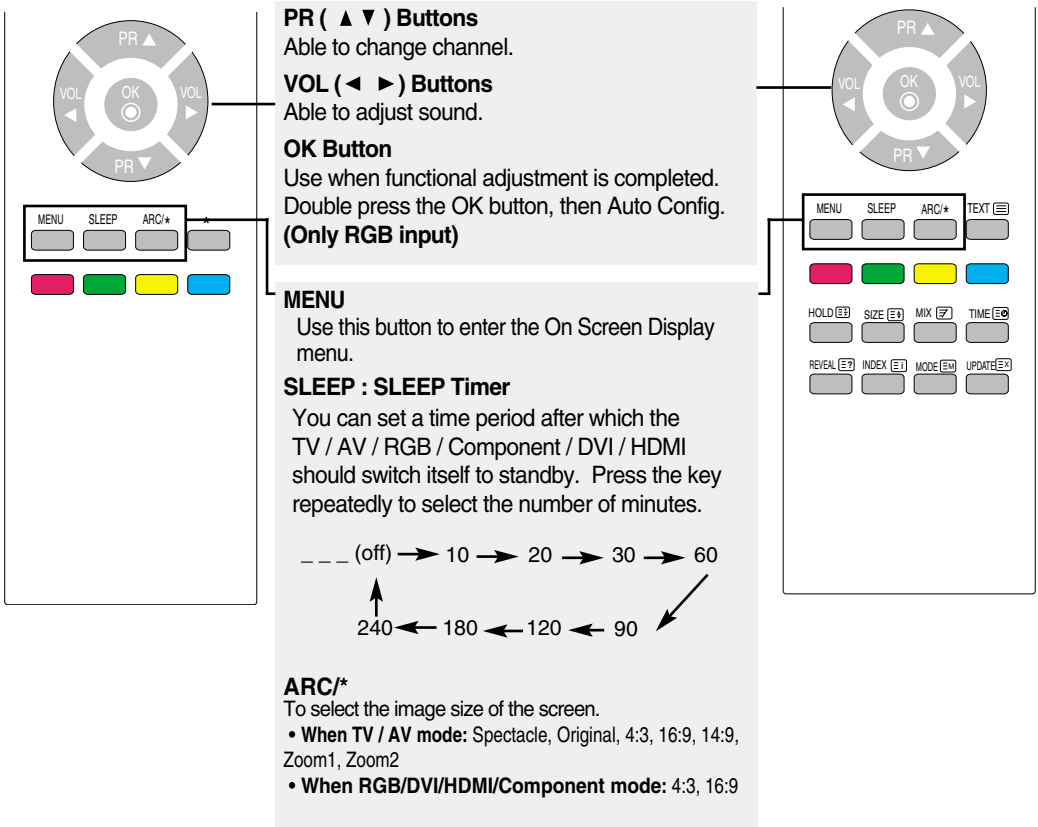

Name and Function of the Parts

Remote Control - Using the Teletext function

If you don't, the teletext may not appear correctly on the screen.

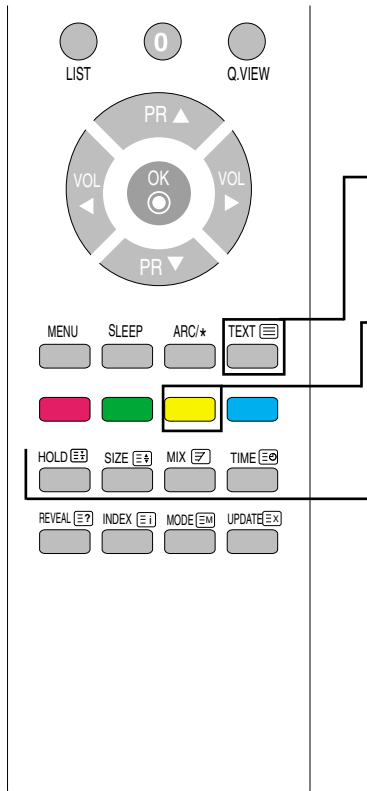

TEXT

To select the teletext on or off. The main index page or the last selected page appears on the screen together with an information headline and an option line at the bottom of the screen.

Yellow key

Favourite Program On : Rotate favourite channel
Favourite Program Off : To display the previously selected TV channel.

HOLD

Press the button to stop the automatically rotating of the sub pages. Press the button again to continue the automatic rotating again.

SIZE

Press the button repeatedly to display the upper part, the lower part and then to return to the normal page size.

MIX

Display the teletext pages superimposed on the TV picture. To switch the TV picture off press this button again.

TIME

Press this button to select a sub page number. The sub page number is displayed at the bottom of the screen. To hold or change the sub page, press the RED/GREEN, ▲ ▼ or NUMBER buttons. Press again to exit this function.

Name and Function of the Parts

Remote Control - Using the Teletext function

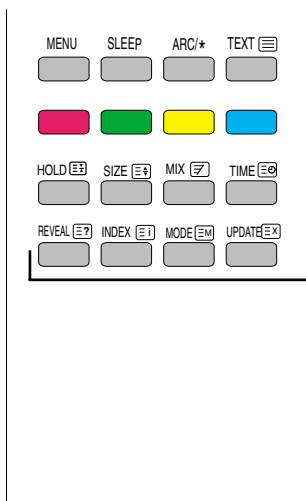

REVEAL

Press the button to reveal/conceal the hidden information, such as solutions to riddles and puzzles. Press this button again to remove the information from the display.

INDEX

To display the main index.

MODE

The mode will be switched in the Teletext mode.

UPDATE

Press the button to appear the TV programme. At the top of screen indicates that you are still in the teletext mode. Before interrupting teletext, you may select a page number. When the page has been found, the information line appears briefly on your screen. Press the button again to reappear teletext.

Name and Function of the Parts

● Rear View

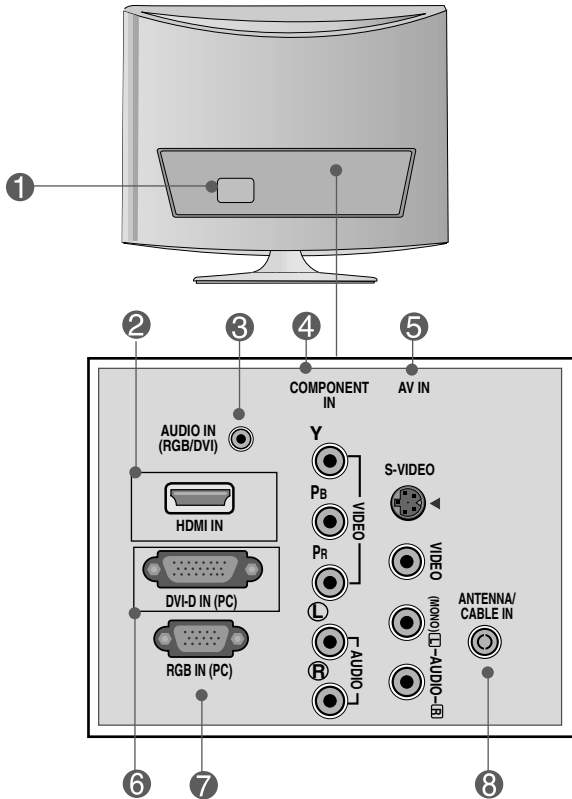

- ① Power Connector : Connect the power cord.
- ② HDMI Digital Signal Connector
- ③ RGB, DVI Sound Jack : Connect to the jack in the PC sound card.
- ④ Component Input Terminal
- ⑤ AV Input Terminal
- ⑥ DVI Digital Signal Connector
- ⑦ D-Sub Analog Signal Connector
- ⑧ TV Tuner Jack : Connect the antenna.

Name and Function of the Parts

● AV Input Terminal

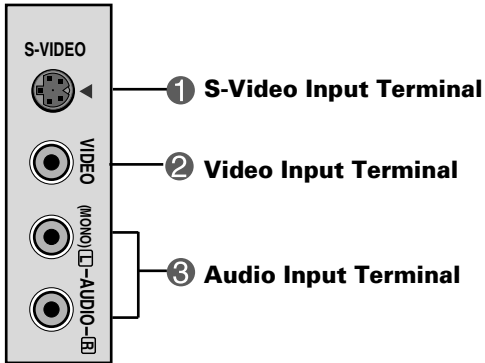

Connecting to External Devices

■ ■ ■ Connecting to your PC

1. First of all, see if the computer, product and the peripherals are turned off. Then, connect the signal input cable.

Rear side of the product.

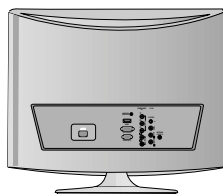

- A Connecting with the D-Sub signal input cable.

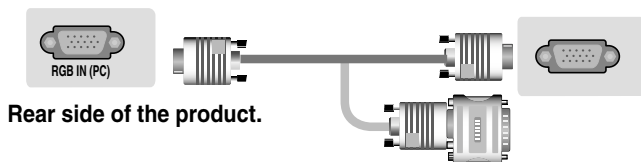

Rear side of the product.

Macintosh Adapter (Not included)
Use the standard Macintosh adapter since an incompatible adapter is available in the market. (Different signaling system)

- B Connecting with the DVI signal input cable.



Rear side of the product.

2. Connect the audio cable.

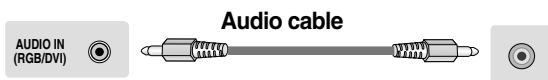

Rear side of the product.

- Make sure to check the sound card connection terminal in the PC before connecting to the product.

If the PC sound card supports both Speaker Out and Line Out, change it to Line Out by setting the jumper or the PC application. (For more details, refer to the sound card user's guide.)

- **Speaker Out** : The terminal connected to the speaker that is not equipped with an amplifier.

- ***Line Out** : The terminal connected to the speaker equipped with an amplifier.

If Audio Out in the PC sound card has only Speaker Out, reduce the PC volume. This product is integrated with an amplifier.

Connecting to External Devices

3. Connect the power cord.

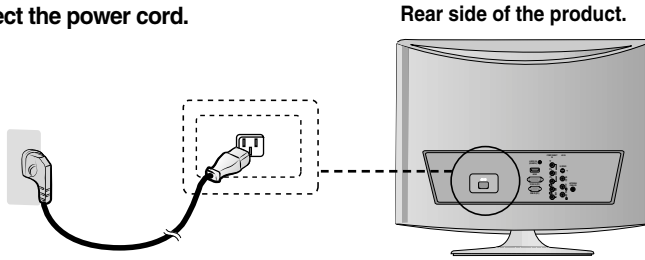

Rear side of the product.

4. ① Turn on power by pressing the power button on the product.

② Turn on the PC.

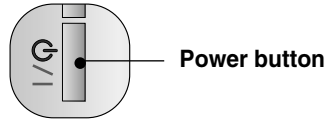

5. Select an input signal.

Press the **INPUT** button on the remote control to select the input signal.

INPUT → OK

Or, press the **INPUT** button at the top side of the product.

INPUT → OK

A • Select RGB

| Input |
|-----------|
| TV |
| AV |
| Component |
| ✓ RGB |
| DVI |
| HDMI |
| ▲▼ OK |

B • Select DVI

| Input |
|-----------|
| TV |
| AV |
| Component |
| RGB |
| ✓ DVI |
| HDMI |
| ▲▼ OK |

Each time you press the Input button it will change to TV → AV → Component →

RGB → DVI → HDMI

If nothing is inputted for several seconds the screen will automatically move to the selected menu.

● PC Mode – Preset Mode

| | Preset mode | Horizontal Frequency (kHz) | Vertical Frequency (Hz) | | Preset mode | Horizontal Frequency (kHz) | Vertical Frequency (Hz) |
|---|-------------|----------------------------|-------------------------|----|-------------|----------------------------|-------------------------|
| 1 | 720 x 400 | 31.468 | 70 | 6 | 1024 x 768 | 48.363 | 60 |
| 2 | 640 x 480 | 31.469 | 60 | 7 | 1024 x 768 | 60.123 | 75 |
| 3 | 640 x 480 | 37.500 | 75 | 8 | 1280 x 768 | 47.776 | 60 |
| 4 | 800 x 600 | 37.879 | 60 | 9 | 1360 x 768 | 47.712 | 60 |
| 5 | 800 x 600 | 46.875 | 75 | 10 | 1366 x 768 | 47.7 | 60 |



Note

- Directly connect to a grounded power outlet on the wall or a power bar with a ground wire.

Connecting to External Devices

■ ■ ■ Connecting to VCR/DVD

1. Connect the video/audio cable as shown in the figure below and then connect the power cord (See page 13).

- (A) When using the RCA cable.**
- Connect the input terminal with a proper colour match.

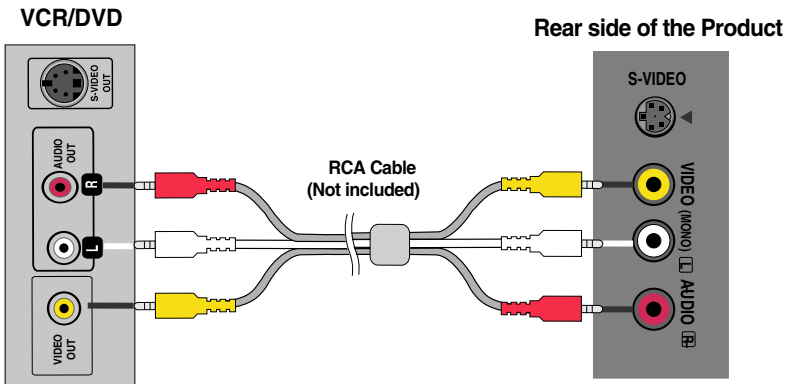

- (B) When using the S-Video cable.**
- Connect to the S-Video input terminal to watch high image quality movies.

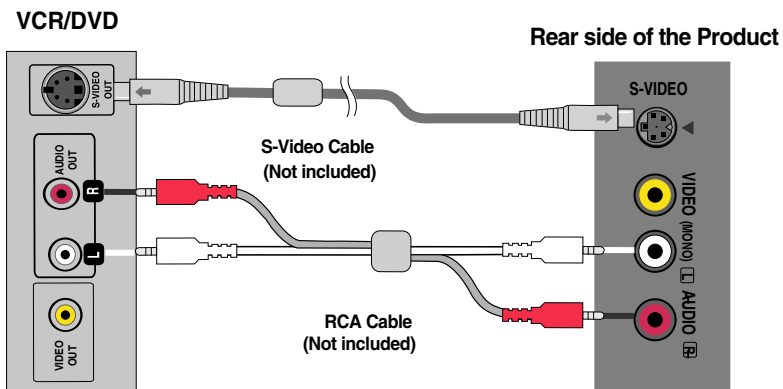

Note • In case the RCA cable is connected simultaneously as S-Video cable is connected, S-Video cable is first.

Connecting to External Devices

2. Select an input signal.
Press the **INPUT** button on the remote control to select the input signal.

INPUT → OK

Or, press the **INPUT** button at the top side of the product.

INPUT → OK

- A** When connecting with a RCA cable.
• Select **AV**
- B** When connecting with a S-Video cable.
• Select **AV**

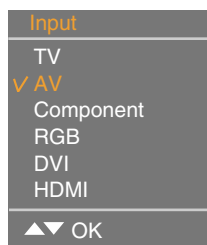

Each time you press the Input button it will change to TV → AV → Component → RGB → DVI → HDMI
If nothing is inputted for several seconds the screen will automatically move to the selected menu.

Connecting to External Devices

■ ■ ■ Connecting to Set-top Box /DVD (480p/576p/720p/1080i/480i/576i)

1. Connect the video/audio cable as shown in the figure below and then connect the power cord (See page 13).

- Connect the input terminal with a proper colour match.

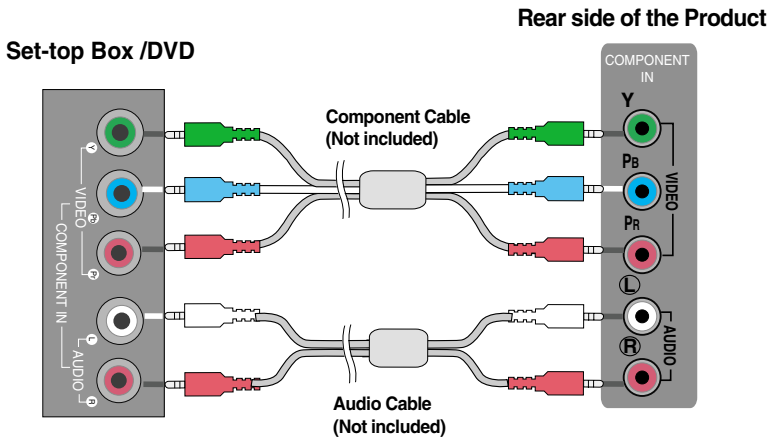

2. Select an input signal.
Press the **INPUT** button on the remote control to select the input signal.

INPUT → OK

Or, press the **INPUT** button at the top side of the product.

INPUT → OK

- Select **Component**

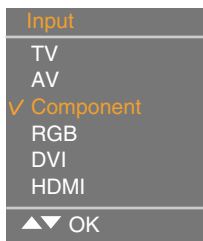

Each time you press the Input button it will change to TV → AV → Component → RGB → DVI → HDMI

If nothing is inputted for several seconds the screen will automatically move to the selected menu.

Connecting to External Devices

■ ■ ■ When watching HDMI from the DVD/Set-top Box

1. Connect the HDMI cable as shown in the below figure and then connect the power cord. (see page 13)

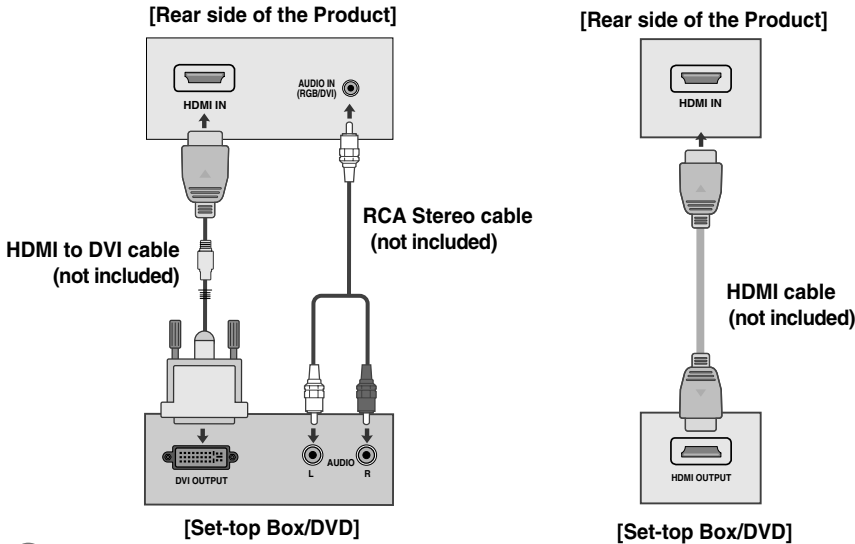

2. Select an input signal.
Press the INPUT button on the remote control to select the input signal.

INPUT → OK

Or, press the INPUT button at the top side of the product.

INPUT → OK

• Select HDMI

| Input |
|-----------|
| TV |
| AV |
| Component |
| RGB |
| DVI |
| ✓ HDMI |
| ▲ ▼ OK |

Each time you press the Input button it will change to TV → AV → Component → RGB → DVI → HDMI.
If nothing is inputted for several seconds the screen will automatically move to the selected menu.

● DTV-Timing

| | Preset mode | Horizontal Frequency (kHz) | Vertical Frequency (Hz) | | Preset mode | Horizontal Frequency (kHz) | Vertical Frequency (Hz) |
|---|----------------|----------------------------|-------------------------|---|-----------------|----------------------------|-------------------------|
| 1 | 720 x 480/60p | 31.47 | 60 | 6 | 1280 x 720/60p | 45 | 60 |
| 2 | 720 x 480/60p | 31.5 | 60 | 7 | 1920 x 1080/60i | 33.72 | 60 |
| 3 | 720 x 576/50p | 31.25 | 50 | 8 | 1920 x 1080/60i | 33.75 | 60 |
| 4 | 1280 x 720/50p | 37.5 | 50 | 9 | 1920 x 1080/50i | 28.125 | 50 |
| 5 | 1280 x 720/60p | 44.96 | 60 | | | | |

Note

• HDMI Input does not support PC mode. If it is connected PC, the screen may not be displayed properly.

Connecting to External Devices

■ ■ ■ When Watching TV

1. Check if the antenna cable is connected at the rear side of the product and then, connect the power cord.

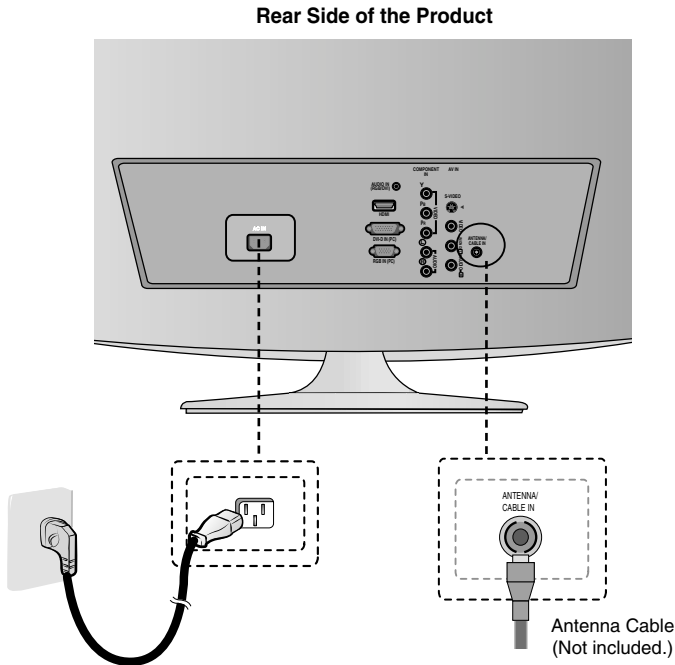

2. Select an input signal.
Press the INPUT button on the remote control to select the input signal.

INPUT → OK

Or, press the INPUT button at the top side of the product.

INPUT → OK

- Select TV

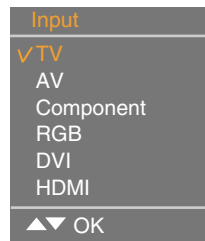

Each time you press the Input button it will change to TV → AV → Component → RGB → DVI → HDMI
If nothing is inputted for several seconds the screen will automatically move to the selected menu.

To arrange cables using cable management

1. Tie cables together with a cable management as shown in the illustration.

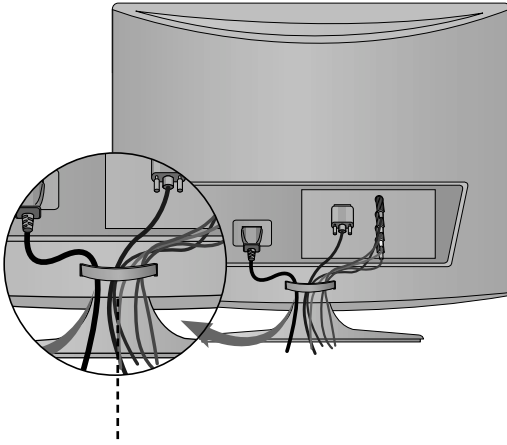

Cable management

Adjusting the Screen

● Name of the Buttons in the Screen Adjustment Unit

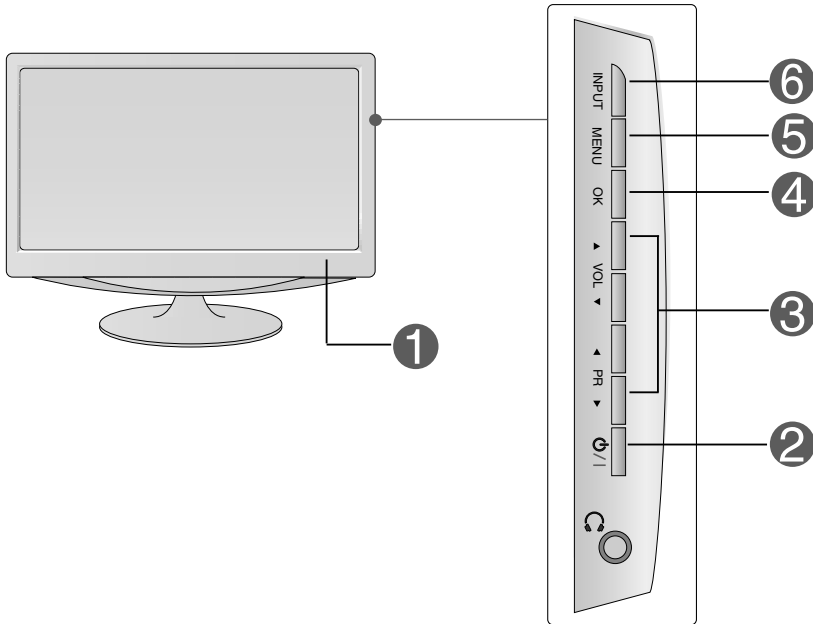

1 Power Indicator

- This Indicator lights up blue when the display operates normally (On Mode). If the display is in Sleep (Energy Saving) Mode, this indicator colour changes to amber.

2 Power Button

- Use this button to turn the product on and off.

3 OSD Select/Adjust Button

- Use this button to select an icon or adjust the setting in the OSD screen.

▼▲ • Use this button to control the channel for the TV signal.

◀▶ • Adjust the volume.

Volume

30

4 OK Button

- OK button is usually used in choosing the MENU. When there is no MENU on the screen pushing the OK button will give the information about the current input source.

Adjusting the Screen

5 Name of the Buttons in the Screen Adjustment Unit

5

MENU Button

- Use this button to show/hide the OSD (On Screen Display) menu screen.

6

INPUT Button

| | |
|------------------|---------------------|
| TV | Television |
| AV | CVBS, S-Video |
| Component | HDTV, DVD |
| RGB | D-Sub analog signal |
| DVI | DVI Digital signal |
| HDMI | HDMI Digital signal |

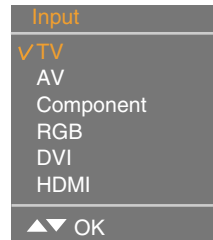







Each time you press the Input button it will change to TV → AV → Component → RGB → DVI → HDMI

If nothing is inputted for several seconds the screen will automatically move to the selected menu.

Adjusting the Screen

● OSD (On Screen Display) Menu

| Icon | Function Description |
|--|--|
|  Station | Set/Select the channel when using the TV |
|  Picture | Adjusting the picture function. |
|  Sound | Adjusting the sound function. |
|  Time | Adjusting the time function. |
|  Special | Selecting the special function. |
|  Screen | Adjusting the screen function. |



Note OSD(On Screen Display)

The OSD function enables you to adjust the screen status conveniently since it provides graphical presentation.

Adjusting the Screen

● OSD (On Screen Display) Screen Tracking Order

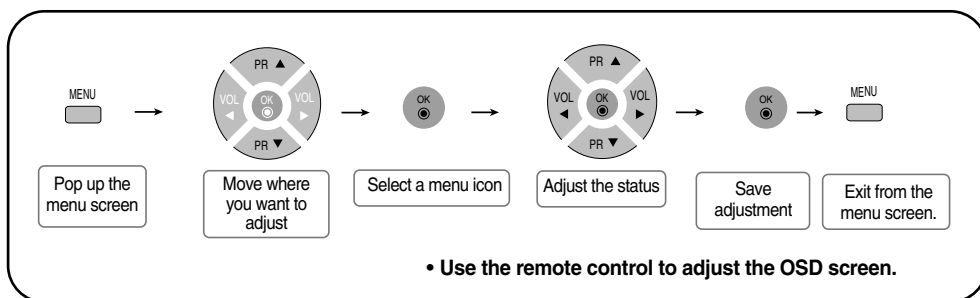

1 Press the **MENU** Button, then the main menu of the OSD will appear.

2 To access a control, use the ▼▲ Buttons.

3 When the icon you want becomes highlighted, press the **OK** Button.

4 Use the ▼▲◀▶ Buttons to adjust the item to the desired level.

5 Accept the changes by pressing the **OK** Button.

6 Exit the OSD by pressing the **MENU** Button repeatedly .

Adjusting the Screen



STATION ID set/Select the channel when using the TV

Auto programme

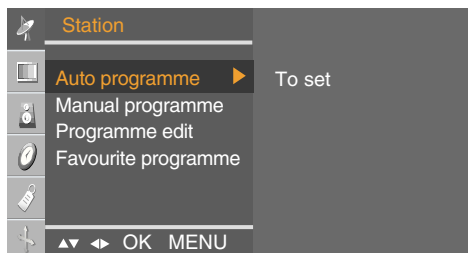

System It should be set before run auto searching.
Press the **▼▲** buttons to select the TV system of the country or part of the world from where you want to receive the TV channels.

* Supporting channel : C(V/UHF 02~69) S(Cable 01~41)

BG : PAL B/G, SECAM B/G (Europe/East Europe)

I : PAL I/II (U.K/Ireland)

DK : PAL D/K, SECAM D/K (East Europe)

M : NTST M

Storage from To select a programme number or enter the programme number with the number buttons from where you want to start searching for new channels. If e.g. you want to keep the channels 1 to 10 stored earlier, enter programme number 11. Your TV search for new channels from number 11 onwards.

* Numbers available to store : 0~99

Search Press **OK** or **▶** button to start automatic programming. All available TV channels will be searched and stored automatically. To stop auto programming, press the **MENU** button. When auto programming is completed, the programme list menu appears.

Manual programme



To change the channel.
(Change each item in Manual Program and press the "MENU" button to save the settings)

Storage Press the **◀▶** buttons to select the channel number or enter the programme number with the number buttons in where you want to store channel.

System Press the **▼▲** buttons to select the TV system of the country or part of the world from where you want to receive the TV channels.

BG : PAL B/G, SECAM B/G (Europe/East Europe)

I : PAL I/II (U.K/Ireland)

DK : PAL D/K, SECAM D/K (East Europe)

M : NTST M

Adjusting the Screen



STATION ID set/Select the channel when using the TV

- Band** Press the ▼▲ buttons to select **VHF/UHF** for aerial channels or **Cable** for cable channels.
To select the channel reception type. : **VHF/UHF / Cable**.
- Channel** If you know the channel number, enter it directly with the digit buttons 0 to 9.
- Fine** In case of poor reception, you can improve the reception by fine tuning. Use the ▼▲ buttons to fine tune for the best picture and sound.
- Search** Use the ◀▶ buttons to search next channel backward or forward direction.
- Name** To see the assigned channel name.
It is possible to change the name stored in the memory or to assign a name to a TV channel which has not yet been entered. A name with up 5 letters or numbers can be given to the programme numbers 0 to 99.
Press the ◀▶ buttons to move cursor to be changed. -> Press the ▼▲ buttons to select a character.(space, number 0-9, and alphabet A-Z, +,-) -> Press **OK** button or **MENU** button.

Programme edit

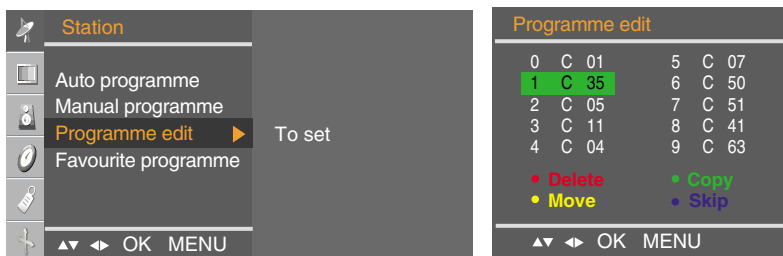

- Delete** Press the ▼▲◀▶ buttons to select a TV channel to be deleted. -> Press the red key on the remote control -> The background colour of the selected channel will change to red.
Press the Delete button one more time to delete the selected channel. All the following channels are shifted up one position.
- Copy** Press the ▼▲◀▶ buttons to select a TV channel to be copied. -> Press the green key on the remote control. All the following channel numbers are shifted down one position.
- Move** Press the ▼▲◀▶ buttons to select a channel number to be moved. -> Press the yellow key on the remote control. -> Press the ▼▲◀▶ buttons to move the TV channel to the desired channel number. -> Press the yellow key again to release this function.
- Skip** Press the ▼▲◀▶ buttons to select a channel number to be skipped. -> Press the blue key on the remote control. The skipped TV channel is displayed in blue.

Adjusting the Screen



STATION ID set/Select the channel when using the TV

Favourite programme



This function lets you select your favourite programmes directly. (8 channel)
Press the ▼▲◀▶ buttons to select a channel.

* Yellow key (remote control) :

Favourite Program On : Rotate favourite channel

Favourite Program Off : To display the previously selected TV channel.

Adjusting the Screen



PICTURE ID adjust the picture function(RGB/DVI)

PSM

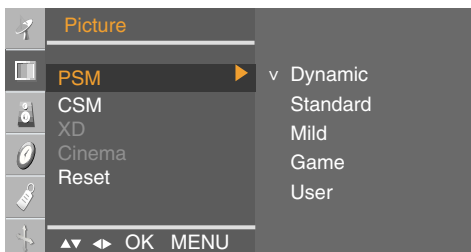

The **PSM** function automatically adjusts the screen image quality.

- **Dynamic**
Select this option to display with a sharp image.
- **Standard**
The most general and natural screen display status.
- **Mild**
Select this option to display with a mild image.
- **Game**
Select this option to enjoy dynamic image when playing a game.
- **User**
Select this option to use the user-defined settings.

CSM

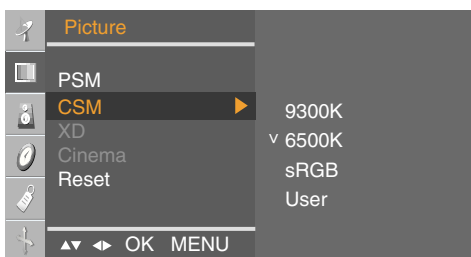

The **CSM** function automatically adjusts the screen colour set.

- **9300K**
Slightly purplish white.
- **6500K**
Slightly bluish white.
- **sRGB**
Slightly lower brightness.
- **User**
Select this option to use the user-defined settings.
Red / Green / Blue
Set your own colour levels.

RESET

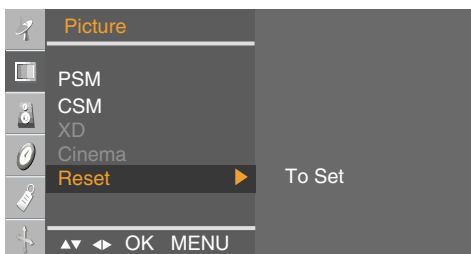

Reset

Return to the default settings **PSM**, **CSM** at the factory.

Adjusting the Screen



PICTURE ID adjust the picture function (TV/AV/Component/HDMI)

PSM

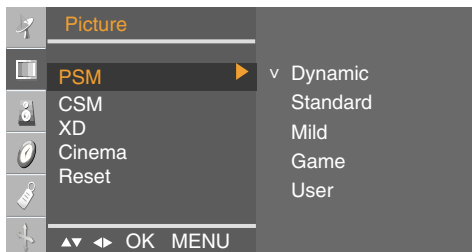

The **PSM** function automatically adjusts the screen image quality.

- **Dynamic**
Select this option to display with a sharp image.
- **Standard**
The most general and natural screen display status.
- **Mild**
Select this option to display with a mild image.
- **Game**
Select this option to enjoy dynamic image when playing a game.
- **User**
Select this option to use the user-defined settings.

CSM

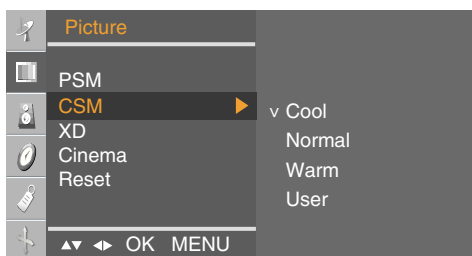

The **CSM** function automatically adjusts the screen colour set.

- **Cool**
Slightly purplish white.
- **Normal**
Slightly bluish white.
- **Warm**
Slightly reddish white.
- **User**
Select this option to use the user-defined settings.
Red / Green / Blue
Set your own colour levels.

XD

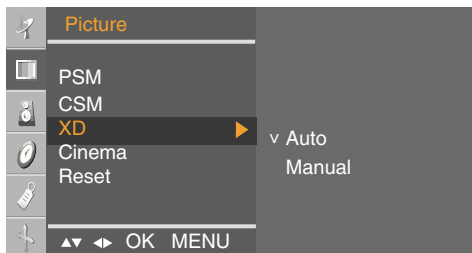

XD is LG Electronics unique picture improving technology to display a real **HD** source through an advanced digital signal processing algorithm. It's not available to use this function in **RGB-PC** or **DVI-PC** modes. **Manual** is activated after selecting the user of **PSM**.

Cinema (Function works in the following mode - TV, AV, Component 480i/576i)
When you watch the movie, this function adjusts the set to the best picture appearance.

Reset Return to the default settings **PSM**, **CSM**, **XD**, **Cinema** at the factory.

Adjusting the Screen



SOUND ID to adjust the sound function

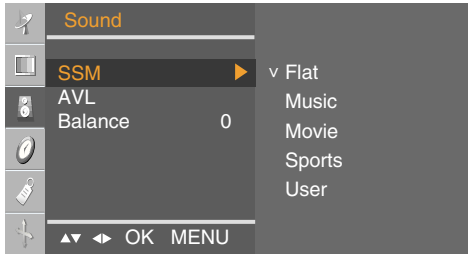

SSM

The best sound tone quality will be selected automatically depending on the video type that you're currently watching.

- **Flat** : The most commanding and natural audio.
- **Music** : Select this option to enjoy the original sound when listening to the music.
- **Movie** : Select this option to enjoy sublime sound.
- **Sports** : Select this option to watch sports broadcasting.
- **User** : Select this option to use the user-defined audio settings.

AVL

To adjust uneven sound volumes across all channels or signals automatically to the most appropriate level. To use this feature, select **On**.

Balance

Use this function to balance sound from the left and right speakers.

Adjusting the Screen



TIME ID to adjust the time function

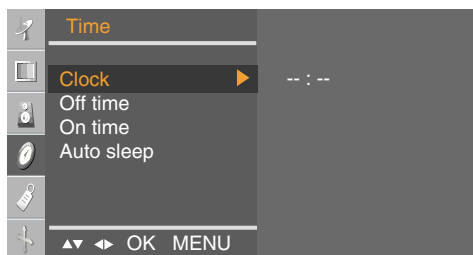

Clock

This function is used to set up of current time.

You must set the time correctly before using **On/Off time** function.

- 1) Press the **MENU** button and then use **▼▲** button to select the **TIME** menu.
- 2) Press the **▶** button and then use **▼▲** button to select the **Clock** menu.
- 3) Press **▶** button and then use **▼▲** button to set the hour(00~23).
- 4) Press **▶** button and then use **▼▲** button to set the minutes(00~59).

The default value is -- : --.

- 5) Press the **OK/MENU** button to save.

Off/On time

The **Off time** automatically switches the set to off mode at the pre-set time.

- 1) Press the **MENU** button and then use **▼▲** button to select the **TIME** menu.
- 2) Press the **▶** button and then use **▼▲** button to select **Off time** or **On time**.
- 3) Press the **▶** button and then use **▼▲** button to set the hour(00~23).
- 4) Press the **▶** button and then use **▼▲** button to set the minutes(00~59).
- 5) Press the **▶** button and then use **▼▲** button to select **On** or **Off**.
- 6) Only **On time** function; Press the **▶** button and then **▼▲** button to adjust volume level and programme number.
- 7) Press the **OK/MENU** button to save.

Auto sleep

If **Auto sleep** is active and there is no input signal, the set switches to off mode automatically after 10 minutes. (It is not working in PC)

- 1) Press the **MENU** button and then use **▼▲** button to select the **Auto sleep** menu.
- 2) Press the **▶** button and then use **▼▲** button to select **On** or **Off**.
- 3) Press the **OK/MENU** button to save .



Note

- In the event of power interruption (disconnection or power failure), the **Clock** must be reset.
- Two hours after the set is switched on by the **On time** function it will automatically switch back to off mode unless a button has been pressed.
- Once the **On** or **Off time** is set, these functions operate daily at the preset time.
- **Off time** function overrides **On time** function if they are set to the same time.
- The set must be in off mode for the **On time** to work.
- **On time** will move on to auto off if no activity is received in 2hours after setting the **On time**.

Adjusting the Screen



SPECIAL ID to Select the special function

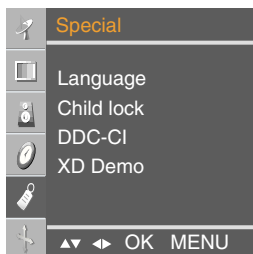

Language To choose the language in which the control names are displayed.

Child lock Use the ▼▲ buttons to select **On** or **Off**. It can be set up so that it can only be used with the remote control. This feature can prevent unauthorized viewing.
In order to lock the OSD screen adjustment, set the **Child lock** tab to the 'On' position.
In order to unlock it, do the following :
* Push the **MENU** button on the remote control and set **Child lock** to the 'Off' position.

DDC-CI DDC/CI(Display Data Channel Command Interface) is communication protocol for communications between PC and monitor.
DDC/CI makes it possible to adjust and setup detailed functions on PC instead of the monitor OSD.
Monitor can be adjusted with PC by connecting communication between PC and monitor when DDC/CI is ON, and monitor cannot be adjusted with PC because communication between PC and monitor is disconnected when DDC/CI is OFF.

XD Demo Use it to see the difference between XD demo on and XD Demo off.
(XD Demo function is not available in RGB PC/ DVI PC mode.)

Adjusting the Screen



SCREEN ID to adjust the screen function

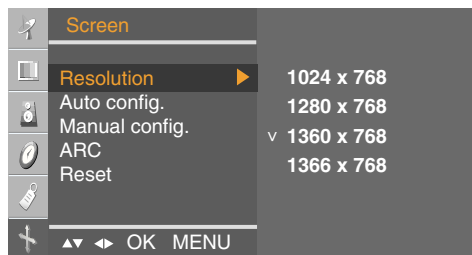

- Resolution** To view the best resolution of RGB-PC mode. Select the same resolution on OSD with PC's. It's working at RGB-PC mode when vertical frequency is 60Hz.
- Auto config.** This button is for the automatic adjustment of the screen **Position**, **Clock** and **Phase**. (It is not working in DVI.)
- Manual config.** This button is for the manual adjustment of the screen **Position**, **Clock** and **Phase**.
- **H-Position (It is not working In DVI-PC mode.)**
To move the displayed image left or right.
 - **V-Position (It is not working In DVI-PC mode.)**
To move the displayed image up or down.
 - **Clock (It is not working In DVI-PC mode.)**
To minimize any vertical bars or stripes visible on the screen background.
The horizontal screen size will also change.
 - **Phase (It is not working In DVI-PC mode.)**
To adjust the focus of the display. This item allows you to remove any horizontal noise and clear or sharpen the image of characters.
- ARC** To select the image size of the screen.
- **When TV/Video mode:** Spectacle, Original, 4:3, 16:9, 14:9, Zoom1, Zoom2
 - **When RGB/DVI/HDMI/Component mode:** 4:3, 16:9
- Reset** Use this function to reset the product to the factory default. However, language selection will not be initialized.(It is working in RGB-PC mode.)

Troubleshooting

No image is displayed

- Is the product's power cord connected?
 - Is the power indicator turning on?
 - Power is on, power indicator is blue but the screen appears extremely dark.
 - Does the power indicator look amber?
 - Does the 'Out of range' message appear?
 - Does the 'Check signal cable' message appear?
- Check if the power cord is properly connected to the outlet.
 - See if the power switch is turned on.
 - Adjust brightness and contrast again.
 - If the product is in power saving mode, move the mouse or press any key.
 - In DVD Player or Settop Box, check the power status of connected device.
 - The signal from the PC (video card) is out of the vertical or horizontal frequency range of the product. Adjust the frequency range by referring to the Specifications in this user's guide.
 - * **Maximum resolution**
1366 X 768 @60 Hz
 - The signal cable between PC and product is not connected. Check the signal cable.
 - Press the 'INPUT' button in the remote control to check the input signal.

'Unknown Product' message appears when the product is connected.

- Did you install the driver?
- Install the product driver, which is provided with the product, or download it from the web site. (<http://www.lge.com>)
 - See if the plug&play function is supported by referring to the video card user's guide.



Note

* **Vertical frequency:** To enable the user to watch the product display, screen image should be changed tens of times every second like a fluorescent lamp. The vertical frequency or refresh rate is the times of image display per second. The unit is Hz.

* **Horizontal frequency:** The horizontal interval is the time to display one vertical line. When the 1 is divided by horizontal interval, the number of horizontal lines displayed every second can be tabulated as the horizontal frequency. The unit is kHz.

Troubleshooting

The screen image looks abnormal.

- Is the screen position wrong?
 - Adjust the Position menu in OSD .
 - See if the video card resolution and frequency are supported by the product. If the frequency is out of range, set to the recommended resolution in the Control Panel – Display – Setting menu.
- Do thin lines appear on the background screen?
 - Adjust the Clock menu in OSD.
- Horizontal noise appears or the characters look blurred.
 - Adjust the Phase menu in OSD.

After-image appears on the product.

- After-image appears when the product is turned off.
 - If you use a fixed image for a long time, the pixels may be damaged quickly. Use the screen saver function.

Troubleshooting

The audio function does not work.

- No sound?
 - Check if the audio cable is connected properly.
 - Adjust the volume.
 - Check if the sound is set properly.
- Sound is too low.
 - Adjust the volume.

The TV function does not work.

- The TV signal is not being received.
 - See if you have selected the proper channel mode.
 - Use the automatic channel setup function.
 - Check if the TV antenna is properly connected.

Screen colour is abnormal.

- Screen has poor colour resolution (16 colours).
 - Set the colour resolution to more than 24 bits (true colour)
Select Control Panel – Display – Settings
– Colour Table menu in Windows.
- Screen colour is unstable or mono-colour.
 - Check the connection status of the signal cable.
Or, re-insert the PC video card.
- Do black spots appear on the screen?
 - Several pixels (red, green, white or black colour) may appear on the screen, which can be attributable to the unique characteristics of the LCD panel. It is not a malfunction of the LCD.

Specifications

The product specifications can change without prior notice for product improvement.

| | | |
|---------------------------------|---|---|
| LCD Panel | Screen Type | 18.51 inches Wide (47.01 cm) TFT (Thin Film Transistor) LCD (Liquid Crystal Display) Panel Visible diagonal size: 47.01 cm |
| | Pixel Pitch | 0.10(H) x 0.30(V) mm |
| Video Signal | Max. Resolution | 1366 X 768 @60 Hz |
| | Recommended Resolution | 1360 X 768 @60 Hz |
| | Horizontal Frequency | 30 - 61 kHz |
| | Vertical Frequency | 56 - 75 Hz |
| | Synchronization Type | Separate Sync, Digital |
| Input Connector | S-Video, Composite video, TV, D-Sub Analog, DVI-D, HDMI, PC Audio In, Headphone/Earphone, component | |
| Power | Rated Voltage | AC 100-240V~ 50/60Hz 0.6A |
| | Power Consumption | On Mode : 35 W (Typ.) Sleep Mode ≤ 1 W Off Mode ≤ 1 W |
| Tilt | Tilt Range | -5° ~ 15° |
| Dimension/Weight | Size (WxLxH) | 454.7 mm x 193.2 mm x 362.8 mm |
| | Weight (excl. package) | 3.8 kg (8.38 lbs) |
| Environmental Conditions | Operational Condition | Temperature: 10°C ~ 35°C , Humidity: 20% ~ 80% |
| | Storage Condition | Temperature: -10°C ~ 60°C , Humidity: 5% ~ 90% |

Power Indicator

| Mode | Product |
|------------|---------|
| On Mode | Blue |
| Sleep Mode | Amber |
| Off Mode | Off |

Free Manuals Download Website

<http://myh66.com>

<http://usermanuals.us>

<http://www.somanuals.com>

<http://www.4manuals.cc>

<http://www.manual-lib.com>

<http://www.404manual.com>

<http://www.luxmanual.com>

<http://aubethermostatmanual.com>

Golf course search by state

<http://golfingnear.com>

Email search by domain

<http://emailbydomain.com>

Auto manuals search

<http://auto.somanuals.com>

TV manuals search

<http://tv.somanuals.com>