

Mini Hi-Fi System

FWV182

User manual

使用説明



PHILIPS

CAUTION

Use of controls or adjustments or performance of procedures other than herein may result in hazardous radiation exposure or other unsafe operation.



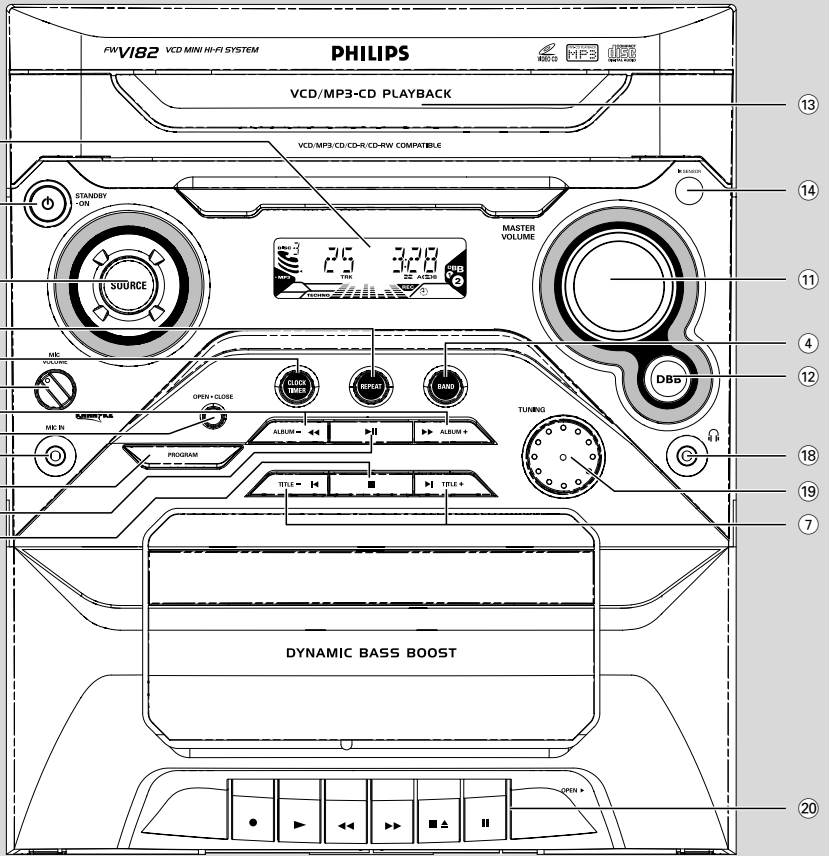

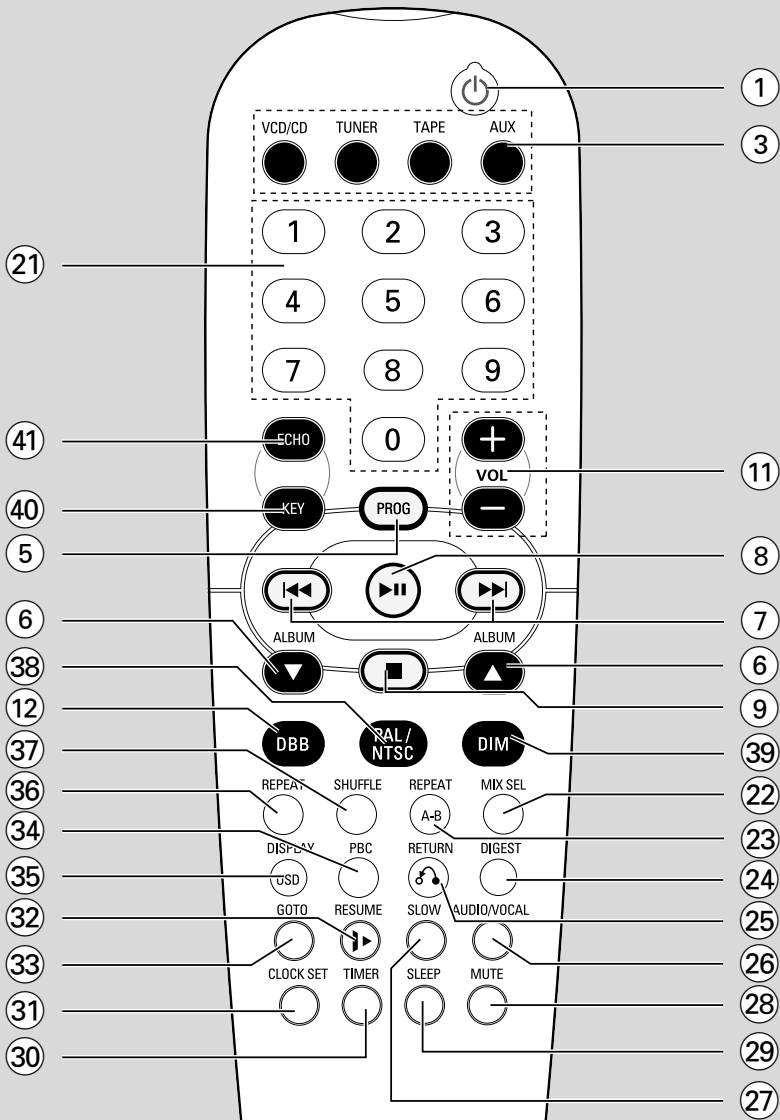

PHILIPS

English 6

中文 26

Contents

General Information

Environmental information	7
Supplied accessories	7
Safety information	7

Preparations

Rear connections	8 – 9
Optional connection	9
Inserting batteries into the Remote Control	9

Controls

Controls on the system and remote control	10-11
--	-------

Basic Functions

Switching the system on	12
Power-saving automatic standby	12
Adjusting volume and sound	12
Dimming the system's display	12

CD/VCD/MP3-CD Operation

Discs for Playback	13
Playing a disc	14
Selecting a different track	14
Finding a passage within a track	14
Different play modes: SHUFFLE and REPEAT	14
Text display and ID3 Text	15
Programming the disc tracks	15
Erasing the program	15
Playing a mixed mode disc	15

VIDEO CD

Adjusting the TV System	16
OSD – On Screen Display	16
Playing a Video CD with PBC	16
Return	16
Digest	17
A-B Repeat	17
Go To	17
Resume	17
Slow	17
Microphone Mixing	18
Vocal	18
Key Control	18
Echo	18

Radio Reception

Tuning to radio stations	19
--------------------------------	----

Tape Operation/Recording

Tape playback	19
General information on recording	20
Synchro start CD recording	20
Recording from the radio	20

Clock/Timer

View clock	21
Clock setting	21
Timer setting	21-22
Sleep timer setting	22

Specifications

Maintenance

Troubleshooting

IMPORTANT!

PLEASE NOTE THAT THE VOLTAGE SELECTOR LOCATED AT THE REAR OF THIS SYSTEM IS PRESET AT 220V FROM THE FACTORY. FOR COUNTRIES THAT OPERATE AT 110V-127V, PLEASE ADJUST TO 110V-127V BEFORE YOU SWITCH ON THE SYSTEM.

Environmental Information

All unnecessary packaging has been omitted. We have tried to make the packaging easy to separate into three materials: cardboard (box), polystyrene foam (buffer) and polyethylene (bags, protective foam sheet).

Your system consists of materials which can be recycled and reused if disassembled by a specialized company. Please observe the local regulations regarding the disposal of packaging materials, exhausted batteries and old equipment.

Supplied accessories

- Remote control
- MW loop antenna
- One Video cinch cable
- 2 speaker boxes
- AC adapter (not for all versions)

Safety Information

- Before operating the system, check that the operating voltage indicated on the typeplate (or the voltage indication beside the voltage selector) of your system is identical with the voltage of your local power supply. If not, please consult your dealer.
- Place the system on a flat, hard and stable surface.
- Place the system in a location with adequate ventilation to prevent internal heat build-up in your system. Allow at least 10 cm (4 inches) clearance from the rear and the top of the unit and 5 cm (2 inches) from each side.
- The ventilation should not be impeded by covering the ventilation openings with items, such as newspapers, table-cloths, curtains, etc.
- Do not expose the system, batteries or discs to excessive moisture, rain, sand or heat sources caused by heating equipment or direct sunlight.
- No naked flame sources, such as lighted candles, should be placed on the apparatus.
- No objects filled with liquids, such as vases, shall be placed on the apparatus.
- The apparatus shall not be exposed to dripping or splashing.
- Install this unit near the AC outlet and where the AC power plug can be reached easily.
- If the system is brought directly from a cold to a warm location, or is placed in a very damp room, moisture may condense on the lens of the disc unit inside the system. Should this occur, the CD player would not operate normally. Leave the power on for about one hour with no disc in the system until normal playback is possible.
- The mechanical parts of the set contain self-lubricating bearings and must not be oiled or lubricated.
- **When the system is switched to Standby mode, it is still consuming some power. To disconnect the system from the power supply completely, remove the AC power plug from the wall socket.**

Preparations

English

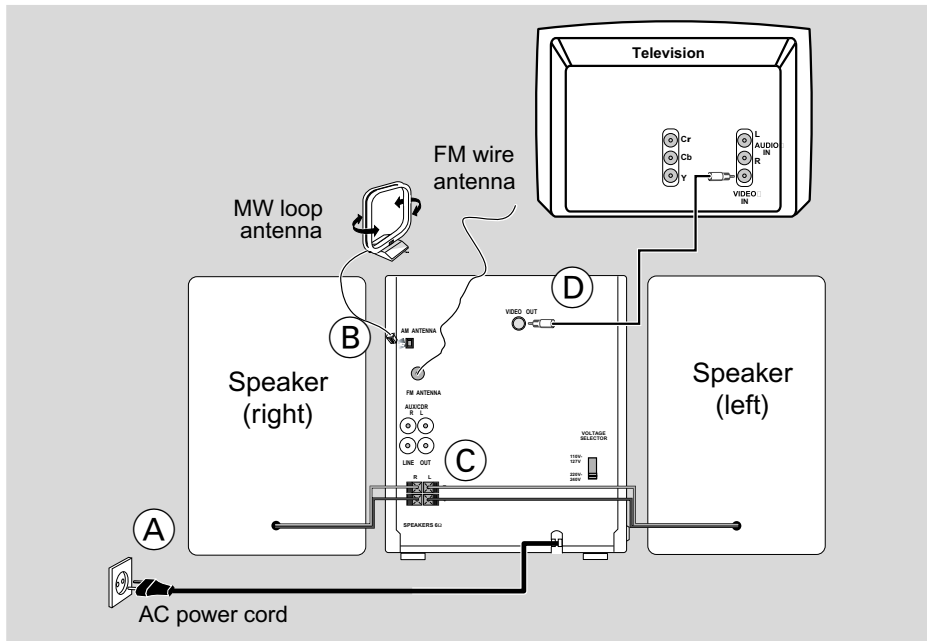

Rear connections

The type plate is located at the rear of the system.

A Power

Before connecting the AC power cord to the wall outlet, ensure that the following are done;

- If your system is equipped with a Voltage Selector; set the VOLTAGE SELECTOR to the local power line voltage.
- All other connections have been made.



WARNING!

- For optimal performance, use only the original power cable.
- Never make or change any connections with the power switched on.

To avoid overheating of the system, a safety circuit has been built in. Therefore, your system may switch to Standby mode automatically under extreme conditions. If this happens, let the system cool down before reusing it (not available for all versions).

B Antennas Connection

MW Antenna

Connect the supplied MW loop antenna to the "AM antenna" terminal. Adjust the position of the antenna for optimal reception.

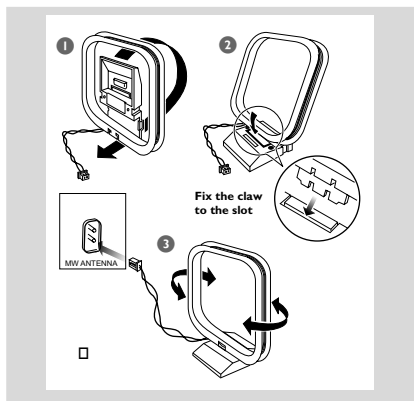

- Position the antenna as far as possible from a TV, VCR or other radiation source.

FM Antenna

It is unnecessary to connect the FM pigtail antenna since it is fixed to the main unit.

- Adjust the FM antenna for optimal FM stereo reception.

C Speakers Connection

Connect the speaker wires to the SPEAKERS terminals, right speaker to "R" and left speaker to "L", colored (marked) wire to "+" and black (unmarked) wire to "-".

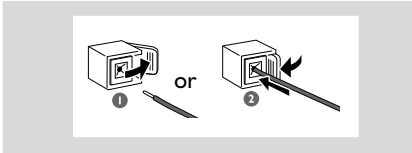

- Fully insert the stripped portion of the speaker wire into the terminal as shown.

Notes:

- For optimal sound performance, use the supplied speakers.
- Do not connect more than one speaker to any one pair of + / - speaker terminals.
- Do not connect speakers with an impedance lower than the speakers supplied. Please refer to the SPECIFICATIONS section of this manual.

D Video Out Connection

Connect the **VIDEO OUT** terminal at the rear of the system to the TV or VCR VIDEO IN for viewing or recording.

Optional connection

The optional equipment and connecting cords are not supplied. Refer to the operating instructions of the connected equipment for details.

Connecting other equipment to your system

Connect the audio left and right OUT terminals of a TV, VCR, Laser Disc player, DVD player or CD Recorder to the **AUX** terminals.

Note:

- If you are connecting equipment with a mono output (a single audio out terminal), connect it to the AUX left terminal. Alternatively, you can use a "single to double" cinch cable (the output sound still remain mono).

Inserting batteries into the Remote Control

Insert two batteries (type R06 or AA) into the remote control with the correct polarity as indicated by the + and - symbols inside the battery compartment.

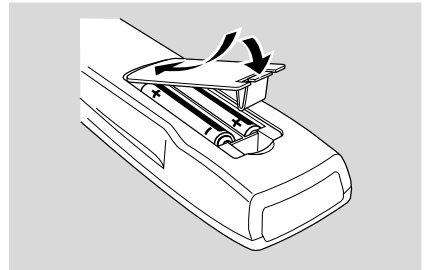



CAUTION!

- Remove batteries if they are exhausted or not to be used for a long time.
- Do not use old and new or different types of batteries in combination.
- Batteries contain chemical substances, so they should be disposed off properly.

Controls (illustrations on page 3&4)

Controls on the system and remote control

- ① **STANDBY ON** 
 - switches the system on or to standby mode.
- ② **Display screen**
 - views the current status of the system.
- ③ **SOURCE**
 - selects the respective sound source :VCD/CD TUNER, TAPE or AUX.
- ④ **BAND**
 - for Tuner selects waveband : FM or MW.
- ⑤ **PROGRAM (PROG)**
 - for VCD/CD/MP3-CD.....programs disc tracks.
- ⑥ **ALBUM/+ <<|>▶▶ (ALBUM ▲/▼)**
 - for MP3-CD selects previous/next album.
 - for Clock/Timer adjusts the hours.
 - *for VCD/CD/MP3-CD.....(on the set only) fast reverses/forwards the disc.
- ⑦ **TITLE-/+ |<|>▶| (|<<|>▶▶|)**
 - for VCD/CD/MP3 CD.....selects a desired track/
preset.
 - for Clock/Timer adjusts the minutes.
 - *for VCD/CD/MP3-CD.....(on the remote only) fast reverses/forwards the disc.
- ⑧ **▶ ||**
 - for VCD/CD/MP3-CD.....starts or interrupts
playback.
- ⑨ **■**
 - for VCD/CD/MP3-CD...stops playback or clears
a program.
- ⑩ **CLOCK/TIMER**
 - sets the clock/timer function.
- ⑪ **MASTER VOLUME (VOL + / -)**
 - increases or decreases the volume.
- ⑫ **DBB (Dynamic Bass Boost)**
 - enhances the bass.
- ⑬ **Disc tray**
- ⑭ **iR sensor**
 - infrared sensor for remote control.

- ⑮ **OPEN-CLOSE**
 - opens or closes the disc tray.
- ⑯ **MIC IN**
 - connects microphone.
- ⑰ **MIC VOLUME**
 - adjusts the mixing level for Karaoke.
- ⑱ ****
 - connects headphones.
- ⑲ **TUNING**
 - tunes to a lower or higher radio frequency.
- ⑳ **Tape deck operations**
 - RECORD ●** ... starts recording.
 - PLAY ▶** starts playback.
 - SEARCH << / >>** fast rewinds/winds the tape.
 - STOP-OPEN ■ ▲**
 - stops the tape; opens the tape
compartment.
 - PAUSE II** interrupts recording or playback.
- ㉑ **Numeric Keypad (0-9)**
 - for CD/VCD/MP3-CD - to select a track
number: (numbers consisting more than 2 figures
must be keyed in within 2 seconds)
- ㉒ **MIX SEL**
 - selects disc format (CD/MP3-CD) from a mixed
mode disc.
- ㉓ **REPEAT A - B**
 - plays a certain scene or passage of a CD/VCD
repeatedly. (REPEAT A - B is not possible for
MP3-CD)
- ㉔ **DIGEST**
 - scans through a VCD or a specific track.
- ㉕ **RETURN **
 - returns to the previous MENU level during
playback (for VCD with PBC on)
- ㉖ **AUDIO/VOCAL**
 - fades out the original vocal from a Karaoke VCD
or switches between mono or stereo mode
during audio disc playback.
 - selects channel left / channel right / stereo
suond, or selects a language in a bilingual VCD.

* = Press and hold the button for more than two seconds.

Basic Functions

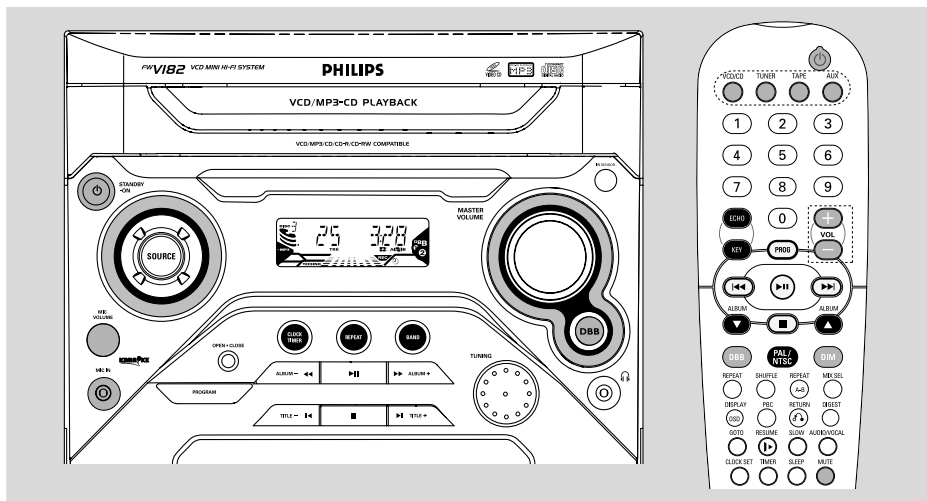

IMPORTANT!

Before you operate the system, complete the preparation procedures.

Switching the system on

- Press **STANDBY ON** .
→ The system will switch to the last selected source.
- Press **SOURCE** on the system or **VCD/CD**, **TUNER**, **TAPE** or **AUX** on the remote control.
→ The system will switch to the selected source.

To switch the system to standby mode

- Press **STANDBY ON** .
→ The volume level (up to a maximum level of 20), interactive sound settings and last selected source will be retained in the player's memory.

Power-saving automatic standby

As a power-saving feature, the system automatically switches to standby 15 minutes after a tape or disc has reached the end and no control is operated.

Adjusting volume and sound

- Adjust the **VOLUME** control (or press **VOL +/-** on the remote) to decrease or increase the volume of the system.
→ Display shows the volume level **VOL** and a number from 0, 1, ...39, 40.
- Press **DBB** to switch bass enhancement on or off.
→ Display shows: **DBB ON** or **DBB OFF**.

To listen through the headphones

- Connect the headphones plug to the socket at the front of the system.
→ The speakers will be muted.

To switch off the volume temporarily

- Press **MUTE** on the remote control.
→ Playback will continue without sound and **"MUTE"** is displayed.
- To restore the volume, press **MUTE** again or increase the volume level.

Dimming the system's display

You can select the desired brightness for the display panel.

- In any active mode, press **DIM** on the remote control.
→ **DIM** is shown, except for DIM OFF mode.

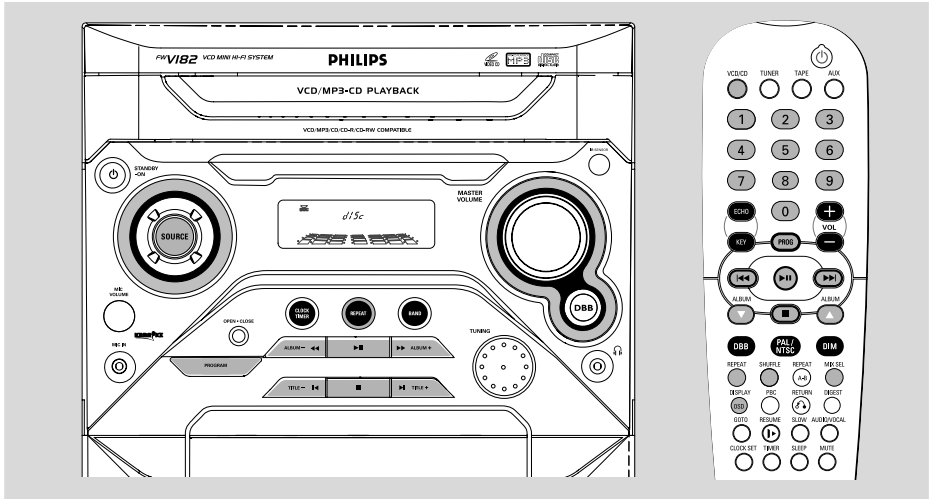

IMPORTANT!

– This system is designed for regular discs. Therefore, do not use any accessories such as disc stabiliser rings or disc treatment sheets, etc., as offered on the market, because they may jam the disc mechanism. – Do not load more than one disc into the tray.

Before viewing the Video CD, ensure that the set is switched to corresponding PAL or NTSC system of your TV set (except Multi-system TV).

Discs for Playback

This system can play all digital audio CD, video CD, MP3-CD format discs, finalised digital audio CD-Recordable (CDR) discs and finalised digital audio CD-Rewritable (CDRW) discs.



Support following MP3-CD formats (ISO9660 format):

- The max. track number plus album number is: 416
- The max. nested directory: 8 levels

- Supported variable bit rate.
- The max. number of programmed MP3 tracks: 20
- Supported sampling frequencies for MP3 disc : 32 kHz, 44.1 kHz, 48 kHz
- Supported Bit-rates of MP3 disc: 56, 64, 96, 128, 192, 256 (kbps)

Formats not supported

- Files such as *.WMA, *.AAC, *.DLF, *.M3U, *.PLS
- Non-English album/title names
- CD-ROM, CD-I, CDV, DVD or computer CDs, however, are not possible.

IMPORTANT!

The lens of the CD player should never be touched.

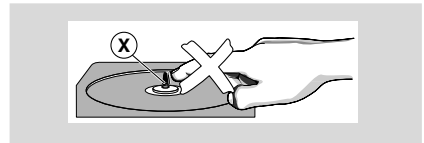

CD/VCD/MP3-CD Operation

Playing a disc

- 1 Select **VCD/ CD** source.
- 2 Press **OPEN•CLOSE** to open the disc tray.
→ **OPEN** is displayed when you open the CD compartment.
- 3 Load a disc with the printed side facing up. Press **OPEN•CLOSE** again to close the disc tray.
→ **READY** is displayed as the system scans the contents of a disc.
- 4 Playback starts automatically.
→ The current track number and elapsed playing time of the track are displayed during disc playback.
- 5 To interrupt playback, press **▶ II**. Press it again to resume playback.
- 6 To stop playback, press **■**.
→ (For VCD/CD) The total number of tracks and playing time are shown.
→ (For MP3) The total album number and total title/ track number are displayed.
- Playback will also stop when;
 - the CD door is opened.
 - the disc has reached the end.
 - you select another source: TAPE, TUNER or AUX.

Notes:

- To ensure good system performance, wait until the disc is completely read before proceeding.
- For MP3-CD, the disc reading time may exceed 10 seconds due to the large number of songs and different formats compiled in one disc.

Selecting a different track/title

- Press **TITLE-/+** **◀/▶** (**◀◀/▶▶** on the remote) once or repeatedly until the desired track/title number appears in the display.
- Use the **Numeric Keypad (0-9)** to select the desired track.(numbers consisting more than 2 figures must be keyed in within 2 seconds).

For MP3-CD only

To select a desired Album

- Press **ALBUM-/+** **◀◀/▶▶** (**ALBUM ▲/▼** on the remote) repeatedly until the desired Album appears on the display.

Finding a passage within a track

To search for a particular passage during playback:

For CD/MP3-CD

- 1 Press and hold **ALBUM-/+** **◀◀/▶▶** (**◀◀/▶▶** on the remote).
- 2 When you recognise the passage you want, release **ALBUM-/+** **◀◀/▶▶** (**◀◀/▶▶** on the remote).
→ Normal playback continues.

For VCD

- Press and hold **ALBUM-/+** **◀◀/▶▶** (**◀◀/▶▶** on the remote) to select a different search speed and release the button until the desired rewind or forward speed is shown on the display or the TV.
→ "REWINDX1", "REWINDX2", "REWINDX3" or "REWINDX4" will be displayed on the TV screen when you select a fast rewind search.
→ "FORWARDX1", "FORWARDX2", "FORWARDX3" or "FORWARDX4" will be displayed on the TV screen when you select a fast forward search.
→ Normal playback will begin at the end of the fast rewinding or forwarding of the selected track.
- Playback returns to normal when **▶ II** is pressed or when a new track is selected.

Different play modes: SHUFFLE and REPEAT

You can select and change the various play modes before or during playback.

SHUF tracks of the entire disc are played in random order

SHUF REP ALL...repeats the entire disc continuously in random order

REP ALL repeats the entire disc/ program

REP plays the current track repeatedly

- 1 To select your play mode, press **REPEAT** or **SHUFFLE** on the remote control before or during playback until the display shows the desired function. (SHUF, REP, REP ALL)
- 2 Press **▶ II** to start playback if in the STOP position.
- 3 To return to normal playback, press **REPEAT** or **SHUFFLE** until the various SHUFFLE / REPEAT modes are no longer displayed.

- You can also press **STOP ■** to cancel your play mode.

Text display and ID3 Text

In CD mode

- Press **DISPLAY (OSD)** repeatedly to see the following information on the display panel.
 - Elapsed play time of current track.
 - Remaining play time of current track.
 - Total remaining play time.

In MP3-CD mode

This feature is used to display the ID3 information for MP3-CD.

- Press **DISPLAY (OSD)** repeatedly to display the ID3 Text (if available) on the TV screen.

Programming the disc tracks

Programming tracks is possible when playback is stopped. Up to 20 tracks can be stored in the memory in any order.

- 1 In the disc mode and when disc playback is stopped, press **PROGRAM (PROG)** on the remote) to start programming.
 - For VCD/CD, **PROG** flashes.
 - For MP3-CD, an album and title numbers are shown and **PROG** flashes.
- 2 Press **TITLE-/+** **⏪/⏩** (**⏪⏪/⏩⏩** on the remote) repeatedly (or use the **Numeric Keypad (0-9)** on the remote control) to select the desired track.
 - For MP3-CD, press **ALBUM-/+** **⏪/⏩** (**ALBUM ▲/▼** on the remote) and **TITLE-/+** **⏪/⏩** (**⏪⏪/⏩⏩** on the remote) repeatedly (or use the **Numeric Keypad (0-9)** on the remote control) to select the desired Album and Title for programming.
- 3 Press **PROGRAM (PROG)** on the remote) to store the track.
 - Repeat **steps 1-3** to store other tracks.
- 4 Press **▶||** to start programme playback.
- To end programming without starting playback, press **■** once.

Notes:

- Programme cannot be used for VCDs when PBC is switched on. Switch off PBC before storing tracks.
- If you attempt to programme more than 20 tracks, "FULL" will be displayed.

To review the programme

- Stop playback and press **TITLE-/+** **⏪/⏩** (**⏪⏪/⏩⏩** on the remote) repeatedly.
- To exit review mode, press **■**.

Erasing the program

You can erase the program by:

- pressing **■** twice during playback;
- opening the CD compartment;
- change to other source.

Playing a mixed mode disc

This set can play a mixed mode disc.

- mixture of audio CD and MP3-CD
- mixture of other combination may not be operated normally.

- 1 As default, audio CD tracks will be read first.
- 2 Press **MIX/SEL** on the remote control repeatedly to select other disc modes.
 - **MP3-CD:**
 - **MP3** is displayed.
 - On the TV screen, an MP3 menu is displayed.

Note :

For protected CDs, "MIX CD-DA" is displayed on your TV screen even if the disc does not have other format. The MIX/SEL normal functions are not available for protected CDs.

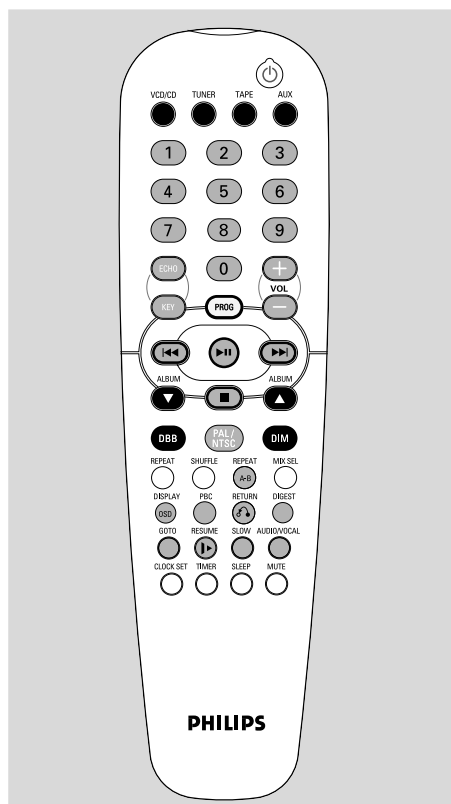

Below is an example of the OSD message.

- Elapsed playback time of current track
- Remaining playback time of current track
- Total remaining time of current disc
- OFF

XX-MM:SS
SINGLE REMAIN

- "XX" is the current track.
- "MM" is in minutes.
- "SS" is in seconds.

Note:
– You can also view the information from an MP3-CD or normal CD.

Playing a Video CD with PBC

VCD with PBC (Playback Control) will be indicated on the display of the set as soon as the disc is inserted. PBC is a predefined play sequence stored in the VCD.

- 1 Switch on the TV, insert a VCD with PBC and press **▶||** to start playback.
- 2 A menu appears on the TV screen.

If the menu consists of a list of titles, you can select a sequence directly

- Use the **Numeric Keypad (0-9)** on the remote control to select your choice.
 - The VCD starts to play in the selected sequence automatically.

Switching off PBC

- Press **PBC** on the remote control.
 - "PBC OFF" appears on the TV screen.

Notes:

- The programme mode is not available whenever the PBC mode is switched on.
- The menu structure depends on the information stored on the VCD. Please refer to the information supplied with the disc.
- PBC will be set to OFF if **■** is pressed. To play the same VCD with PBC on, please press PBC on the remote control again.

Adjusting the TV System

Before viewing the Video CD, ensure that the set is switched to corresponding PAL or NTSC system of your TV set (except Multi-system TV).

- Press and hold **PAL/NTSC** on the remote control for more than **3 seconds** to switch between PAL or NTSC TV system.

OSD – On Screen Display

If you insert a VCD/ CD/ MP3 disc, your TV screen will serve as an additional display for messages (e.g. PLAY, STOP), and information stored on the VCD.

- Press **DISPLAY (OSD)** on the remote control repeatedly to switch on or off the On Screen Display. When OSD is switched ON, you can see the following display on the TV screen.

Return

- Press **RETURN** to return to the previous VCD disc MENU level. PBC mode must be switched on.

Digest

This feature allows you to scan through a VCD for a quick review.

In the stop mode

- 1 Press **DIGEST** on the remote control.
→ The first 6 seconds of each track are played.
- 2 Use the **Numeric Keypad (0-9)** on the remote control to play the desired tracks.
→ Press **TITLE-/+** **◀/▶** (**◀◀/▶▶** on the remote) to view the previous or next page for additional information.

During playback

- 1 Press **DIGEST** on the remote control.
→ The current track of the selected disc will be divided into 9 parts and displayed on the TV screen.
- 2 Use the **Numeric Keypad (0-9)** on the remote control to play from the desired position.
- 3 Press **TITLE-/+** **◀/▶** (**◀◀/▶▶** on the remote) to digest the previous or next track.

To exit the DIGEST mode

- Press **DIGEST** again.
- Press **▶▶** on the remote control.
- Press **■** on the remote control.

A-B Repeat

This feature is also applicable to audio CD (except for MP3-CD). To play a certain scene or passage of the disc repeatedly:

- 1 Press **REPEAT A- B** on the remote control during playback to mark the start of the chosen scene or passage.
→ "REP A" appears on the display panel.
- 2 Press **REPEAT A- B** again to mark the end of the chosen scene or passage.
→ "REP A- B" appears on the display panel.
- The selected scene or passage is played repeatedly.
- 3 Press **REPEAT A- B** once more to return to normal playback.
→ "REP A- B" disappears from the display panel.

Notes:

- You can also cancel the **A-B Repeat** by pressing **TITLE-/+** **◀/▶** (**◀◀/▶▶** on the remote).
- You can set the **A-B mark** within the same track.
- If the track is completed before you set the end point, "REP A" will disappear at the end of the track and "REPEAT AB CANCEL" will appear on the TV screen.

GOTO

- 1 Press **GOTO** on the remote control.
→ "GOTO--:--" appears on the TV screen.
- 2 Use the **Numeric Keypad (0-9)** on the remote control to key in the disc time from which you want the disc to begin.

Notes:

- Switch off **PBC** before selecting **GOTO**.
- This function is also available for **CD**.

Resume

- In the stop mode, press **RESUME** on the remote control to start playback again from where you have stopped.

Note:

- The resume information is lost if the disc tray is opened, the source is changed or the system is disconnected from the power supply.
- For **VCD**, it may take more than 20 seconds to resume playback due to the large number or size of tracks.
- This function is also available for **CD/MP3**.

Slow

- 1 Press **SLOW** on the remote control to watch a VCD at a slower speed. There are 4 types of slow modes to select.
→ The sound is muted.
→ On TV screen, "SLOW 1/2", "SLOW 1/4", "SLOW 1/8", **SLOW 1/16** or **PL AY** is displayed.
- 2 To resume playback at normal speed, press **PLAY•PAUSE ▶▶**

Microphone Mixing

Connect microphones (not supplied) to the system to sing along with the music source.

- 1 Connect microphones to **MIC** jack.
- 2 Before connecting the microphone, set the microphone **MIC VOLUME** to the minimum level to prevent howling sound.
- 3 Select **VCD/CD** to start playback.
- 4 Press **ECHO** to select ECHO ON.
- 5 Adjust the volume level of the source with the **VOLUME** control (or by pressing **VOL +/-** on the remote).
- 6 Start singing or talking through the microphone.
- 7 Press **KEY** to select key tone if necessary.

Notes:

- *Keep the microphones away from the speakers to prevent howling.*
- *Microphone mixing is only available in VCD mode.*

Vocal

This feature allows you to fade out the original vocal from a karaoke VCD. This feature is used together with Echo mode. You can also use it to select the different audio modes.

- Pressing **AUDIO/VOCAL** on the remote control repeatedly allows you to select the following modes.
→ STEREO → VOCAL L - VOCAL R → MONO L → MONO R → STEREO ...

VOCAL LEFT/RIGHT - fade out the original vocal for specially recorded karaoke discs only (press ECHO to select MIC ON)

STEREO – same effect as the original recorded disc.

MONO L/R – select the language on a bilingual VCD.

Ensure that the MIC mode is switched on

when pressing **VOCAL** to fade out the original vocal during STEREO VOCAL L/R mode.

Key Control

This feature allows you to change the key tone of your vocal range.

- Press **KEY** on the remote control.
→ "-KEY SHIFT+" appears on the TV screen.
- Press **VOLUME +/-** to decrease or increase the vocal key level between -6 and +6.

Echo

This feature allows you to add echo while singing or talking through a microphone.

- Press **ECHO** on the remote control.
- Press **VOLUME +/-** to decrease or increase the echo level.

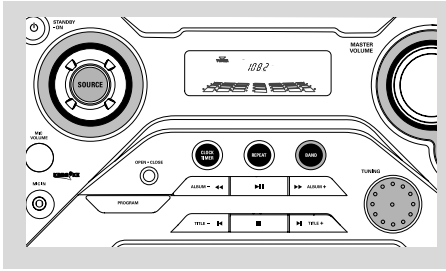

Tuning to radio stations

- 1 Select **TUNER** source.
- 2 Press **BAND (TUNER)** on the remote) to select the desired waveband : FM or MW.
- 3 Turn the **TUNING** control knob to tune to a desired radio frequency.

Tape Operation/Recording

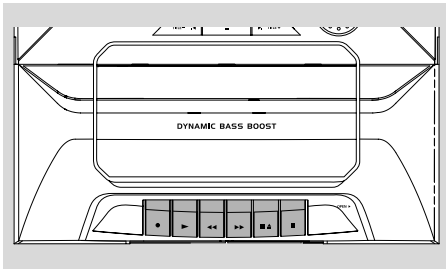

IMPORTANT!

- Before playing a tape, check and tighten slack tape with a pencil. Slack tape may get jammed or may burst in the mechanism.
- C-120 tape is extremely thin and is easily deformed or damaged. It is not recommended for use in this system.
- Store the tapes at room temperature and do not put them too close to a magnetic field (for example, a transformer, TV or speaker).

Tape playback

- 1 Select **TAPE** source.
- 2 Open the tape key flap marked "**OPEN▶**" on the front panel.
- 3 Press **STOP•OPEN ■▲** to open the tape door.

- 4 Insert a recorded tape and close the tape door.
- 5 Load the tape with the open side downward and the full spool to the left.
- 6 Press **PLAY ▶** to start playback.
- 7 The key is automatically released at the end of a tape, except if **PAUSEII** has been activated.
- 8 To pause, press **PAUSEII** Press again to resume.
- 9 By pressing **SEARCH ◀◀** or **▶▶** on the system fast winding of tape is possible in both directions.
- 10 To stop the tape, press **STOP•OPEN ■▲**.

Notes:

- The sound source cannot be changed while playing or recording a tape.
- The system will change to the tape mode from any other active mode as long as you press down **PLAY ▶**.

General information on recording

- If you do not intend to record via the microphone, unplug the microphone to avoid accidental mixing with other recording source.
- Recording is permissible insofar as copyright or other rights of third parties are not infringed.
- For recording, use only NORMAL (IEC type I) tapes on which the tabs have not yet been broken. This deck is not suited for recording on METAL (IEC IV) type tapes.
- The recording level is set automatically, regardless of the position of the Volume, DBB, DSC and so forth.
- The recording sound quality might differ depending on the quality of your recording source and the recording tape.
- The tape is secured at both ends with leader tape. At the beginning and end of the tape, nothing will be recorded for six to seven seconds.
- To protect a tape from accidental erasure, have the tape in front of you and break out the left tab. Recording on this side is no longer possible. If, however, you wish to record over this side again, cover the tabs with a piece of adhesive tape.

Synchro start CD recording

- 1 Select **VCD/CD** source.
- 2 Insert a disc and if desired, programme track numbers.
- 3 Press **STOP-OPEN ■ ▲** to open the tape door.
- 4 Insert a suitable tape into the deck and close the tape door.
- 5 Press **RECORD ●** to start recording.

To select and record a particular passage within a CD track:

- Press and hold down on **ALBUM-/+ ◀◀/▶▶** (**ALBUM ▲/▼** on the remote). Release the control when you recognize the passage you want.
- To pause CD playback press **▶II**
- Recording starts from this exact point in the track when you press **RECORD ●**.
- 6 To pause, press **PAUSE II**. Press again to resume.
- 7 To stop recording, press **STOP-OPEN ■ ▲**.

Recording from the radio

- 1 Tune to the desired radio station (see Tuning to radio stations).
- 2 Press **STOP-OPEN ■ ▲** to open the tape door.
- 3 Insert a suitable tape into the deck and close the tape door.
- 4 Press **RECORD ●** to start recording.
- 5 To interrupt playback press **PAUSE II**. To resume, press this key again.
- 6 To stop recording, press **STOP-OPEN ■ ▲**.

The making of unauthorized copies of copy-protected material, including computer programmes, files, broadcasts and sound recordings, may be an infringement of copyrights and constitute a criminal offence. This equipment should not be used for such purposes.



**Be responsible
Respect copyrights**

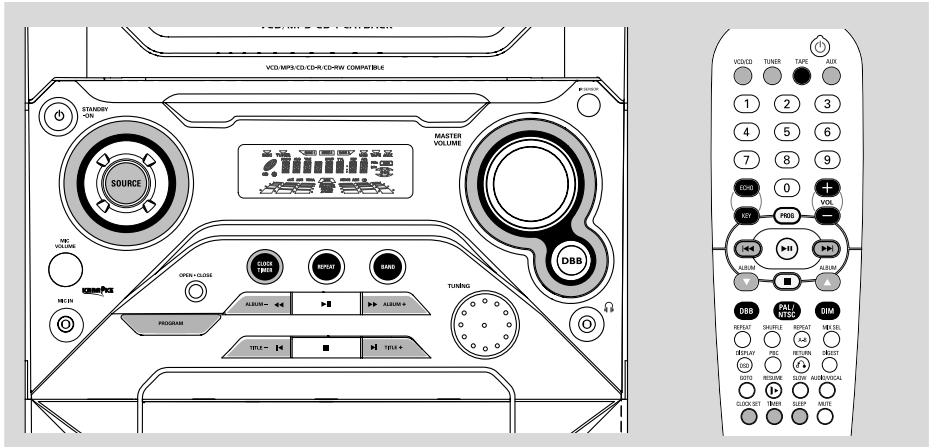

View clock

The clock (if it is set) will be shown in standby mode.

To view the clock in any source mode (CD or TUNER for example)

- Press **CLOCK•TIMER (CLOCK SET)** on the remote.
 - The clock is displayed for a few seconds.
 - If the clock has not been set, "-- : --" is displayed.

Clock setting

- 1 In standby or view clock mode, press **CLOCK•TIMER (CLOCK SET)** on the remote **once**. In other source mode, press **CLOCK•TIMER (CLOCK SET)** on the remote **twice**.
 - The clock digits flash on the display panel.
 - If the clock has not been set, "-- : --" flashes
- 2 Press **ALBUM-/+ ◀◀/▶▶ (ALBUM ▲/▼)** on the remote repeatedly to set the hour.
- 3 Press **TITLE-/+ ◀/▶ (◀◀/▶▶)** on the remote repeatedly to set the minute.
- 4 Press **CLOCK•TIMER (CLOCK SET)** on the remote again to store the setting.
 - The clock starts working.

To exit without storing the setting

- Press **■** on the system.

Notes:

- The clock setting will be cancelled when the power cord is disconnected or if a power failure occurs.
- During clock setting, if no button is pressed within 20 seconds, the system will exit clock setting mode automatically.

Timer setting

The system can switch on to CD or TUNER mode automatically at a preset time, serving as an alarm to wake you up.

IMPORTANT!

– Before setting the timer, ensure that the clock is set correctly.

- 1 In standby mode, press and hold **CLOCK•TIMER** for more than **two seconds** (or press **TIMER** on the remote) to select timer mode.
 - The current source and timer digits flash on the display panel.
 - If the timer has not been set before, "-- : --" flashes.

Clock/Timer

- 2 Press **CD** or **TUNER** to select the desired source.
- Before setting timer, make sure the music source has been prepared.
CD – load the disc.
TUNER – tune to the desired radio station.
- 3 Press **ALBUM-/+** **◀◀/▶▶** (**ALBUM ▲/▼** on the remote) repeatedly to set the hour for the timer to start.
- 4 Press **TITLE-/+** **◀/▶** (**◀◀ / ▶▶** on the remote) repeatedly to set the minute for the timer to start.
- 5 Press **CLOCK•TIMER** (**TIMER** on the remote) to store the start time.
→  remains on the display.
- At the preset time, the selected source will play.

To exit without storing the setting

- Press **■** on the system.

Note:

– During timer setting, if no button is pressed within 20 seconds, the system will exit timer setting mode automatically.

Sleep timer setting

The sleep timer enables the system to switch off by itself after a set period of time.

- 1 Press **SLEEP** on the remote control repeatedly to select a preset time.
→ The selections are as follows (time in minutes):
OFF → 15 → 30 → 45 → 60 → 90 → 120
→ "SLEEP xx" or "SLEEP OFF" is displayed.
"xx" is the time in minutes.
- 2 When you reach the desired length of time, stop pressing the **SLEEP** button.

To deactivate the sleep timer

- Press **SLEEP** repeatedly until "SLEEP OFF" is displayed, or press the **STANDBY ON**  button.

Note:

– **ZZZ** will start flashing when the remaining length of time after activation of the sleep timer is less than 10 seconds.

Specifications

AMPLIFIER

Output power	2 × 25 W RMS
.....	1000 W PMPO
Signal-to-noise ratio	≥ 65 dBA
Frequency response	125 – 16000 Hz, ± 3 dB
Input sensitivity AUX	0.5 V
Impedance loudspeakers	6 Ω
Impedance headphones	32 Ω

DISC PLAYER

Number of programmable tracks	20
Frequency response	125 – 16000 Hz
Signal-to-noise ratio	≥ 62 dBA
Channel separation	≥ 50 dB (1 kHz)
Total harmonic distortion	< 0.6% (1 kHz)
MPEG 1	VCD version 2.0
MPEG 1 Layer 3 (MP3-CD)	MPEG AUDIO
MP3-CD bit rate	32 – 256 kbps
sampling frequencies ...	48 kHz, 44.1 kHz, 32 kHz

TUNER

FM wave range 87.5 (±0.5) – 108.5 (±0.5) MHz	
MW wave range	515 (±8)– 1650 (±30) kHz
Sensitivity at 75 Ω	
– mono, 26 dB signal-to-noise ratio	3.2 μV
– stereo, 46 dB signal-to-noise ratio	61.4 μV
Selectivity	≥ 28 dB
Total harmonic distortion	≤ 5%
Frequency response	63 – 12500 Hz (± 3 dB)
Signal-to-noise-ratio	≥ 50 dBA

TAPE DECK

Frequency response	
Normal tape (type I)	125 – 8000 Hz (8 dB)
Signal-to-noise ratio	
Normal tape (type I)	45 dBA
Wow and flutter	≤ 0.4% JJS

SPEAKERS

System 1-way; port bass reflex	
Impedance	6 Ω
Woofer	1 × 4"
Dimensions (w × h × d) ..	207 × 310 × 190 (mm)
Weight	2.45 kg each

GENERAL INFORMATION

AC Power	
For Version /98/55	110–127 / 220–240 V~;
	50/60 Hz Switchable
Dimensions (w × h × d) ...	265 × 310 × 384 (mm)
Weight (with/without speakers)	10 / 5.1 kg
Standby power consumption	<15W

Specifications and external appearance are subject to change without notice.

Cleaning the Cabinet

- Use a soft cloth slightly moistened with a mild detergent solution. Do not use a solution containing alcohol, spirits, ammonia or abrasives.

Cleaning Discs

- When a disc becomes dirty, clean it with a cleaning cloth. Wipe the disc from the centre out.
- Do not use solvents such as benzene, thinner, commercially available cleaners, or antistatic spray intended for analogue records.

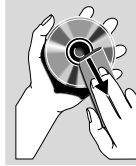

Cleaning the disc lens

- After prolonged use, dirt or dust may accumulate at the disc lens. To ensure good playback quality, clean the disc lens with Philips CD Lens Cleaner or any commercially available cleaner. Follow the instructions supplied with cleaner.

Cleaning the Heads and the Tape Paths

- To ensure good recording and playback quality, clean the heads (A), the capstan (B), and pressure roller(s) (C) after every 50 hours of tape operation.

Caution: Do not rotate the heads during cleaning.

- Use a cotton swab slightly moistened with cleaning fluid or alcohol.
- You can also clean the heads by playing a cleaning tape once.

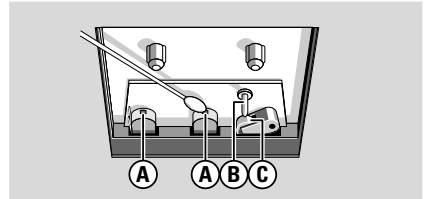

Demagnetising the heads

- Use a demagnetising tape available at your dealer.

Troubleshooting

WARNING

Under no circumstances should you try to repair the system yourself, as this will invalidate the warranty. Do not open the system as there is a risk of electric shock.

If a fault occurs, first check the points listed below before taking the system for repair. If you are unable to remedy a problem by following these hints, consult your dealer or Philips for help.

Problem	Solution
"NO DISC" is displayed.	<ul style="list-style-type: none"> ✓ Insert a disc. ✓ Check if the disc is inserted upside down. ✓ Wait until the moisture condensation at the lens has cleared. ✓ Replace or clean the disc, see "Maintenance". ✓ Use a finalised CD-RW or CD-R.
No picture on TV screen.	<ul style="list-style-type: none"> ✓ Connect the cable between the system and TV.
No colour on TV.	<ul style="list-style-type: none"> ✓ Change the system to the respective PAL or NTSC setting.

Troubleshooting

Problem	Solution
Radio reception is poor.	<ul style="list-style-type: none">✓ If the signal is too weak, adjust the antenna or connect an external antenna for better reception.✓ Increase the distance between the Mini HiFi System and your TV or VCR.
Recording or playback cannot be made.	<ul style="list-style-type: none">✓ Clean deck parts, see "Maintenance".✓ Use only normal (IEC I) tape for recording.✓ Apply a piece of adhesive tape over the missing tab space.
The system does not react when buttons are pressed.	<ul style="list-style-type: none">✓ Remove and reconnect the AC power plug and switch on the system again.
Sound cannot be heard or is of poor quality.	<ul style="list-style-type: none">✓ Adjust the volume.✓ Disconnect the headphones.✓ Check that the speakers are connected correctly.✓ Check if the stripped speaker wire is clamped.
The left and right sound outputs are reversed.	<ul style="list-style-type: none">✓ Check the speaker connections and location.
The remote control does not function properly.	<ul style="list-style-type: none">✓ Select the source (VCD/CD or TUNER, for example) before pressing the function button (▶ , ◀◀, ▶▶).✓ Reduce the distance between the remote control and the system.✓ Insert the battery with its polarities (+/- signs) aligned as indicated.✓ Replace the battery.✓ Point the remote control directly toward IR sensor on the front of the system.
The timer is not working.	<ul style="list-style-type: none">✓ Set the clock correctly.✓ If a recording is in progress, stop the recording.
The Clock/Timer setting is erased.	<ul style="list-style-type: none">✓ Power has been interrupted or the power cord has been disconnected. Reset the clock/timer.

Free Manuals Download Website

<http://myh66.com>

<http://usermanuals.us>

<http://www.somanuals.com>

<http://www.4manuals.cc>

<http://www.manual-lib.com>

<http://www.404manual.com>

<http://www.luxmanual.com>

<http://aubethermostatmanual.com>

Golf course search by state

<http://golfingnear.com>

Email search by domain

<http://emailbydomain.com>

Auto manuals search

<http://auto.somanuals.com>

TV manuals search

<http://tv.somanuals.com>