

# Uniden®

**TCX 805**

**Accessory Handset**

**OWNER'S**

**MANUAL**

**OWNER'S MANUAL**

# Welcome

Congratulations on your purchase of the Uniden TCX805 accessory handset and charger. This expansion handset is compatible with the TRU8866 2-line base (model numbers may vary.) You can place a fully featured cordless handset anywhere in your home where you have AC power.

## IMPORTANT

The TCX805 expansion handset will not operate unless it has been registered to your main base. This manual describes how to set up and connect your new handset; for more detailed instructions on operating your new handset, refer to the owner's manual supplied with your main base.

## Backward / Forward Compatibility

Your phone is compatible with other Uniden 5.8GHz Digital Expandable Systems. Compatible models include the Elite series (ELT560, ELBT585, ELBT595), the CLX Series (CLX485 and CLX465), and the TRU8 series (TRU8860, TRU8865, TRU8866, TRU8880, TRU8885, and TRU8888). The Elite and CLX series bases contain advanced features that may not be supported by this handset. Please visit our website at [www.uniden.com](http://www.uniden.com) for feature comparisons.



**Two-line operation is supported only when the handset is registered to a two-line base.**

## Checking the Package Contents

Make sure you have received the following items in the package. If any items are missing or damaged, contact Customer Service.

- Cordless Handset
- Charging Cradle
- AC Adapter (AD-0005)  
(INPUT: 120V AC 60Hz)  
(OUTPUT: 9V DC 210 mA)
- Battery Pack (BT-446)  
(Capacity: 800 mA, 3.6V)
- Beltclip
- This Owner's Manual
- Other Printed Material

For answers to questions and to order genuine Uniden parts and accessories 24 hours a day, visit our website at [www.uniden.com](http://www.uniden.com). Customer support is also available by calling 1-800-297-1023, Mon-Fri 7 a.m. to 7 p.m., Sat/Sun 9 a.m. to 5 p.m. CST. (Phone support is closed on holidays.)

## Help for our Special Needs Customers

If you need special assistance due to a disability or have questions on the accessibility features of this product, please call 1-800-874-9314 (voice or TTY).

# Basic Setup

## Install the Battery Pack

- 1** Press down on the handset battery case cover (use the finger indentation for a better grip) and slide the cover downward to remove.
- 2** Plug the battery pack connector (red & black wires) into the jack inside the battery compartment. (The connector notches fit into the grooves of the jack only one-way.) Match the wire colors to the polarity label in the battery compartment, and push the connector in until you hear a click.
- 3** Make sure you have a good connection by slightly pulling on the battery wires. If the connection is secure, the battery jack will remain in place.
- 4** Place the battery case cover back on the handset by sliding it upwards until it clicks into place.
- 5** Place the handset in the charging cradle with the keypad facing forward.

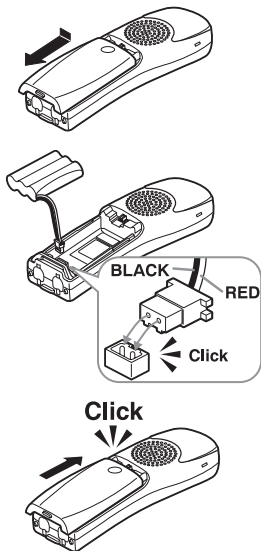

- **Use only the Uniden battery (BT-446) supplied with your phone.**
- Recharge your handset on a regular basis by returning the handset to the charger after each phone call.

Rechargeable Nickel-Metal-Hydride Batteries Must Be Recycled or Disposed of Properly

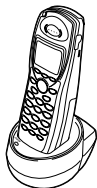

## Connect the Charger

- 1 Connect the AC adapter to the **DC IN 9V** jack and to a standard 120V AC wall outlet.
- 2 Set the charger on a desk or tabletop, and place the handset in the charger with the keypad facing forward.
- 3 Make sure the **charge LED** illuminates. If the LED does not illuminate, check to see that the AC adapter is plugged in and that the handset makes good contact with the charger's contacts.

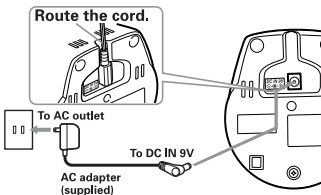

**Caution:** To avoid risk of fire or shock, use only the supplied AD-0005 AC adapter. Do not use any other AC adapter.

- 4 Charge the handset for 15-20 hours before using.

## Register the Handset

**YOU NEED TO REGISTER THE TCX805 TO THE MAIN BASE BEFORE USE!**



If the handset was registered to a different base, you must de-register the handset before you can register it to a new base. (See page 5.)

**For Main Base Models TRU8860, TRU8865, TRU8866, TRU8880 and TRU8885**

- 1 Be sure the handset battery is fully charged.
- 2 With the main base in standby mode (i.e., not being used), place the expansion handset in the main base to begin registration.
- 3 While the handset is registering, Handset Registering will appear in the handset LCD. When Registration Complete is displayed, the handset has been registered to the base. If Registration Failed appears, please try these steps again.

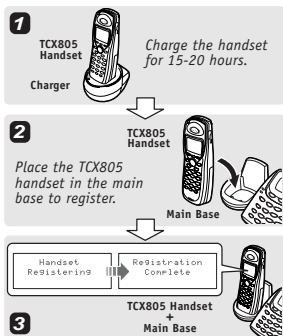

### For Main Base Model TRU8888 (corded base model)

- 1 With the main base in standby mode (i.e. not being used), press the **MENU** soft key on the base.
- 2 Use the up/down key to select HS Registration, and then press the **OK** soft key.
- 3 Use the up/down key to select Register Handset.
- 4 Base LCD screen will display the following prompt:  
On handset press & hold "#" key for 2 sec
- 5 On the handset, press and hold the # key until you hear a beep.

### For Main Base Model ELT560

- 1 Remove the battery compartment cover from the back of the main base.
- 2 Press and hold the Registration button in the battery compartment.
- 3 Keep pressing the Registration button until the handset charge LED on main base starts to blink.
- 4 On the handset, press and hold the # key until you hear a beep.

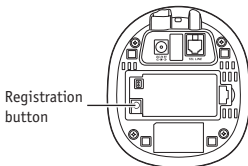

### For Main Base Models ELBT585, ELBT595, CLX465, and CLX485

- 1 With the main base in standby mode (i.e. not being used), press **menu/select**.
- 2 Use the up/down key to select System Setup.
- 3 Use the up/down key to select Register Handset.
- 4 The base LCD screen will display the following prompt:  
On handset, press & hold "#" key for 2 sec
- 5 On the handset, press and hold the # key until you hear a beep.

### De-register the handset

Press the **MENU** soft key. Scroll down to Deregister HS and press the **OK** soft key. When the handset asks you to confirm, select Yes and press the **OK** soft key.

## Installing the Beltclip

### To attach the beltclip

Insert the beltclip into the holes on each side of the handset. Press down until it clicks.

### To remove the beltclip

Pull either side of the beltclip to release the tabs from the holes.

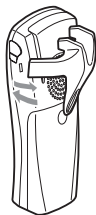

## Using Your Handset

Now that your new handset is registered, it can perform all the same functions as the handsets originally included with your phone. With your new handset, you can

- Transfer calls between handsets
- Use two handsets as an intercom
- Use two handsets as 2-way radios in DirectLink mode
- Use two handsets as a baby/room monitor
- Hold conference calls

See the owner's manual that came with your main base unit for complete instructions on operating your new expanded digital phone.

You can also download owner's manuals from our website at [www.uniden.com](http://www.uniden.com).



- **Two-line operation is supported only when the handset is registered to a two-line base.**
- **The Elite and CLX series bases contain advanced features that may not be supported by this handset. Please visit our website at [www.uniden.com](http://www.uniden.com) for feature comparisons.**

# Controls & Functions

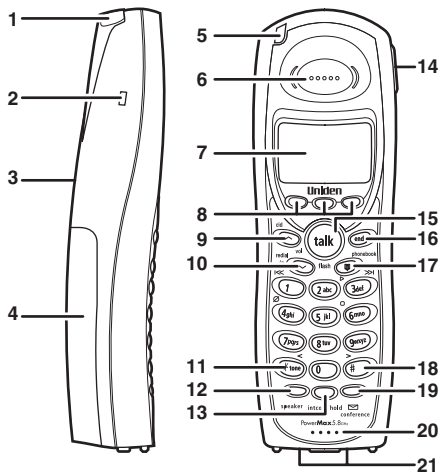

- |  |                                      |
|--|--------------------------------------|
| 1. Handset Antenna                             | 11. <b>*/tone/&lt;</b>               |
| 2. Beltclip Hole                               | 12. <b>speaker</b>                   |
| 3. Speakerphone Speaker and Ringer             | 13. <b>intcom/hold</b>               |
| 4. Handset Battery Compartment                 | 14. Headset Jack Cover               |
| 5. New Message LED                             | 15. <b>talk/flash</b>                |
| 6. Handset Earpiece                            | 16. <b>end</b>                       |
| 7. LCD Display                                 | 17. <b>phonebook</b>                 |
| 8. <b>soft</b> Keys                            | 18. <b>#/&gt;</b>                    |
| 9. <b>cid/vol</b> $\wedge$ (volume up)         | 19. <b>[speaker icon]/conference</b> |
| 10. <b>redial/p/vol</b> $\nabla$ (volume down) | 20. Handset Microphone               |
|  | 21. Handset Charging Contacts        |

# Reading the Display

## Example of the standby mode display

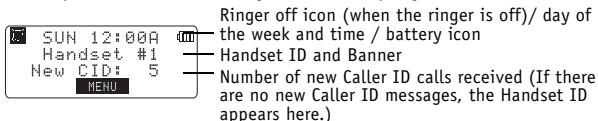

ICON	Appears During	DESCRIPTION
	Standby/ Talk	<b>Battery</b> icons indicate the handset battery status. This icon changes depending on the battery status (empty, low, medium and full).
  (for two-line base model)	Standby	The <b>Ringer off</b> icon indicates that ringer is turned off.
  (for two-line base model)	Standby/ Talk	The <b>Line</b> icon indicates the line in use or the line received a new Caller ID message (Line1 and/or Line2).
	Talk	The <b>Mute</b> icon appears when you mute the handset.
	Talk	The <b>Speaker</b> icon appears when the handset speaker phone is used.
	Talk	The <b>Privacy</b> icon appears when the Privacy Mode is turned on.



# Main Menu Options

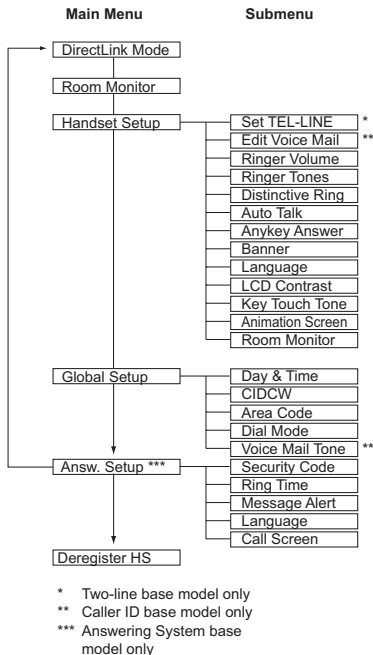

## Adjusting the Volume

- To adjust ringer volume, press the **MENU** soft key, select the Handset Setup menu, and then the Ringer Volume submenu. Use **∇** or **∧** to select "High", "Low", or "Off." Press the **OK** soft key.
- To adjust the earpiece or speaker volume, press the **∧** and **∇** keys while the handset is on a call. The new setting will remain in effect after the call has ended.

## Making and Receiving Calls

<b>Making a call</b>	Remove the handset from the charger. Dial the number you want to call and press <b>talk/flash</b> . To make a call with the speakerphone, dial the number and press <b>speaker</b> .
<b>Answering a call</b>	Remove the handset from the charger and press <b>talk/flash</b> . To answer with the speakerphone, press <b>speaker</b> .
<b>Hanging up</b>	Press <b>end</b> .
<b>Using Call Waiting</b>	If the call waiting tone sounds while you are on the phone, press <b>talk/flash</b> to speak to the waiting caller. Use <b>talk/flash</b> to switch back and forth between the callers.
<b>Putting a Call on Hold</b>	Press <b>intcom/hold</b> to put the caller on hold. Press <b>talk/flash</b> or <b>speaker</b> to talk to the caller again.

## Using a Headset

Your phone may be used with an optional headset. To use this feature, insert the headset plug into the headset jack. Your phone is ready for hands-free conversations. (Headset may be purchased by calling the Uniden Parts Department or visiting the web site. See page 2.)



## Transferring Calls

1. To transfer a call, press **intcom/hold**. The call will be placed on hold, and the display will show the list of available stations.
2. Select the station you want to transfer the call to and press the **OK** soft key. To page all stations at once, select the **ALL** soft key.
3. When the other station answers, you can talk to the other station; the call will still be on hold. If the other station connects to the call, your handset will be disconnected.

If another station transfers a call to this handset, press **talk/flash** to answer the transfer page. Press **talk/flash** again to connect to the outside caller (the other station will be disconnected).

## Conferencing

To join a call already in progress, press **talk/flash**. If there are already two handsets on a call or another station is in privacy mode, the display will show **Unavailable**.

## Intercom

To page another station, press **intcom/hold**. The display will show the list of available stations. Select the station you want to page and press the **OK** soft key. To page all stations at once, select **All**.

To answer an incoming page, press **talk/flash**.

## Using the Phonebook

Press **phonebook** to enter the Phonebook. Once in the phonebook, you have the following options:

Scroll through the entries	Use the <b>^</b> and <b>v</b> keys to highlight an entry.
Jump to entries beginning with a particular letter	Press the number key corresponding to the letter to you want to jump to.
Store a new entry	Press the <b>STORE</b> soft key.
Dial and entry	Highlight the entry and press <b>talk/flash</b> .

## Using Caller ID

Press **cid/vol ^** to bring up the caller ID list. You have the following options:

Scroll through the entries	Use the <b>^</b> and <b>v</b> keys to highlight an entry.
Delete entries	Press the <b>EDIT</b> soft key. Select <b>Delete?</b> and then press the <b>OK</b> soft key. Select <b>Yes</b> , and then the <b>OK</b> soft key.
Store an entry in the phonebook	Press the <b>EDIT</b> soft key. Select <b>Store into PB?</b> and then press the <b>OK</b> soft key.
Dial an entry	Highlight the entry and press <b>talk/flash</b> .

## Using the Redial List

Press **redial/p/vol**  $\vee$  to bring up the redial list. You have the following options:

Scroll through the entries	Use the $\wedge$ and $\vee$ keys to highlight an entry.
Delete entries	Press the <b>EDIT</b> soft key. Select <b>Delete?</b> and then press the <b>OK</b> soft key. Select <b>Yes</b> , and then the <b>OK</b> soft key.
Store an entry in the phonebook	Press the <b>EDIT</b> soft key. Select <b>Store into PB?</b> and then press the <b>OK</b> soft key.
Dial an entry	Highlight the entry and press <b>talk/flash</b> .

## Getting Your Messages (Answering Machine Base Only)

With the phone in standby mode, press  $\boxtimes$ /**conference** to access your voice mail or your answering machine (depending on the main base). You have the following options:

- 1) When the phone is in standby mode, press  $\boxtimes$ /**conference** on the handset. **Remote AnsweringMachine operation** appears on the handset display. The answering system announces the current time and the number of messages stored in the memory. Messages will be played in the order in which they were received. The time and day that each message was received is announced after the message is played.
- 2) The phone will announce, "To play incoming messages, press two. For help, press zero." You will hear a beep.

- If you press **end** before the answering system answers, the phone will return to standby.
- When the answering system does not answer within 6 seconds, you hear a beep and the phone will return to standby.
- When you receive a call, the remote operation is canceled.
- You can change the handset volume during a remote operation.
- During the remote operation **AnsweringMachine operation** appears on the base.
- If you have new messages and old messages, after you have reviewed your new messages, you can play your old messages by pressing 2 again.

note

- 3) Enter a command within 30 seconds. Select a command from the following chart:

## Remote Key Function

<</1	Repeat a Message*	<b>6</b>	Answering System On
▷/2	Playing incoming Messages	<b>7</b>	Memo Record/Stop**
>>/3	Skipping a Message	<b>8</b>	Greeting Message Record/Stop**
∅/4	Deleting a Message	<b>9</b>	Answer System Off
□/5	Stop Operation	<b>0</b>	Help Guidance

- \* For the Repeat a Message function, press **1** within about four seconds to repeat the previous message, or press **1** after about four seconds to repeat the current message.
- \*\* For the Memo Record and Greeting Message Record function, the first time you enter the corresponding command, it starts the Recording function. If you want to stop the recording, press **7**, **8** or **5**.
- 4) After the command has finished, you will hear intermittent beeps indicating that the system is waiting for a command. You may enter another command at this time from the chart above.
- 5) When you are finished, press **end** to exit the system.

## Battery Information

### Low battery alert

When the batteries are very low and need to be charged, the phone is programmed to eliminate functions in order to save power.

The batteries need to be charged when:

- The empty battery icon  appears.
- Low Battery appears in the display.

If the phone is in standby mode, none of the keys will operate.

If you are on a call, complete your conversation as quickly as possible, and return the handset to the charging cradle.

## Cleaning the battery charging contacts

To maintain a good charge, clean the charging contacts on the handset once a month. Dampen a cloth with plain water, and wipe the charging contacts clean. Be sure to dry the contacts thoroughly before returning the handset to the charger.

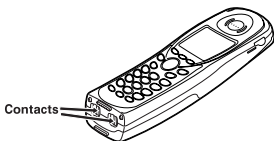

**Caution:** Do not use paint thinner, benzene, alcohol, or other chemical products. Doing so may discolor the surface of the telephone and damage the finish.

## I.C. Notice

### TERMINAL EQUIPMENT

**NOTICE:** This equipment meets the applicable Industry Canada Terminal Equipment Technical Specifications. This is confirmed by the registration number. The abbreviation, IC, before the registration number signifies that registration was performed based on a Declaration of Conformity indicating that Industry Canada technical specifications were met. It does not imply that Industry Canada approved the equipment.

**NOTICE:** The Ringer Equivalence Number (REN) for this terminal equipment is marked on the equipment itself. The REN assigned to each terminal equipment provides an indication of the maximum number of terminals allowed to be connected to a telephone interface. The termination on an interface may consist of any combination of devices subject only to the requirement that the sum of the Ringer Equivalence Numbers of all the devices does not exceed five.

### RADIO EQUIPMENT

The term "IC:" before the radio certification number only signifies that Industry Canada technical specifications were met.

Operation is subject to the following two conditions: (1) this device may not cause interference, and (2) this device must accept any interference, including interference that may cause undesired operation of the device. "Privacy of communications may not be ensured when using this telephone."



As an Energy Star® Partner, Uniden has determined that this product or product models meets the Energy Star® guidelines for energy efficiency. Energy Star® is a U.S. registered mark.

### THE FCC WANTS YOU TO KNOW

Changes or modifications to this product not expressly approved by Uniden, or operation of this product in any way other than as detailed by the owner's manual, could void your authority to operate this product.

This device complies with part 15 of the FCC rules. Operation is subject to the following two conditions: (1) This device may not cause harmful interference, and (2) This device must accept any interference received, including interference that may cause undesired operation. Privacy of communications, may not be ensured when using this phone.

To insure the safety of users, the FCC has established criteria for the amount of radio frequency energy various products may produce depending on their intended usage. This product has been tested and found to comply with the FCC's exposure criteria. For body worn operation, the FCC RF exposure guidelines were also met when used with the Uniden accessories supplied or designed for this product. Use of other accessories may not ensure compliance with FCC RF exposure guidelines and should be avoided.

Uniden works to reduce lead content in our PVC coated cords in our products and accessories.

#### **Warning!**

The cords on this product and/or accessories contain lead, a chemical known to the State of California to cause birth defects or other reproductive harm. ***Wash hands after handling.***

## One Year Limited Warranty

**Important:** Evidence of original purchase is required for warranty service.

**WARRANTOR:** UNIDEN AMERICA CORPORATION ("Uniden")

**ELEMENTS OF WARRANTY:** Uniden warrants, for one year, to the original retail owner, this Uniden Product to be free from defects in materials and craftsmanship with only the limitations or exclusions set out below.

**WARRANTY DURATION:** This warranty to the original user shall terminate and be of no further effect 12 months after the date of original retail sale. The warranty is invalid if the Product is (A) damaged or not maintained as reasonable or necessary, (B) modified, altered, or used as part of any conversion kits, subassemblies, or any configurations not sold by Uniden, (C) improperly installed, (D) serviced or repaired by someone other than an authorized Uniden service center for a defect or malfunction covered by this warranty, (E) used in any conjunction with equipment or parts or as part of any system not manufactured by Uniden, or (F) installed or programmed by anyone other than as detailed by the owner's manual for this product.

**STATEMENT OF REMEDY:** In the event that the product does not conform to this warranty at any time while this warranty is in effect, warrantor will either repair or replace the defective unit and return it to you without charge for parts, service, or any other cost (except shipping and handling) incurred by warrantor or its representatives in connection with the performance of this warranty.

Warrantor may replace the unit with a new or refurbished unit. THE LIMITED WARRANTY SET FORTH ABOVE IS THE SOLE AND ENTIRE WARRANTY PERTAINING TO THE PRODUCT AND IS IN LIEU OF AND EXCLUDES ALL OTHER WARRANTIES OF ANY NATURE WHATSOEVER, WHETHER EXPRESSED, IMPLIED OR ARISING BY OPERATION OF LAW, INCLUDING, BUT NOT LIMITED TO ANY IMPLIED WARRANTIES OF MERCHANTABILITY OR FITNESS FOR A PARTICULAR PURPOSE. THIS WARRANTY DOES NOT COVER OR PROVIDE FOR THE REIMBURSEMENT OR PAYMENT OF INCIDENTAL OR CONSEQUENTIAL DAMAGES.

Some states do not allow this exclusion or limitation of incidental or consequential damages so the above limitation or exclusion may not apply to you.

**LEGAL REMEDIES:** This warranty gives you specific legal rights, and you may also have other rights which vary from state to state. This warranty is void outside the United States of America and Canada.

**PROCEDURE FOR OBTAINING PERFORMANCE OF WARRANTY:** If, after following the instructions in the owner's manual you are certain that the Product is defective, pack the Product carefully (preferably in its original packaging). Disconnect the battery from the Product and separately secure the battery in its own separate packaging within the shipping carton. The Product should include all parts and accessories originally packaged with the Product. Include evidence of original purchase and a note describing the defect that has caused you to return it. The Product should be shipped freight prepaid, by traceable means, to warrantor at:

Uniden Service Inc.

4700 Amon Carter Blvd.

Fort Worth, TX 76155

FOR  
ACCESSORIES,  
GO ONLINE @  
WWW.UNIDEN.COM

**REGISTER ONLINE TODAY!**

**THANK YOU FOR BUYING A UNIDEN PRODUCT.**

A World Without Wires

**Uniden®**

©2005 Uniden America Corporation, Fort Worth, Texas. Contains additional foreign articles. Custom manufactured in China.

UZZZ01424BZ(0)

May be covered under one or more of the following U.S. patents:

4,797,916	5,381,460	5,426,690	5,434,905	5,491,745	5,493,605	5,533,010
5,574,727	5,581,598	5,650,790	5,660,269	5,661,780	5,663,981	5,671,248
5,696,471	5,717,312	5,732,355	5,754,407	5,758,289	5,768,345	5,787,356
5,794,152	5,801,466	5,825,161	5,864,619	5,893,034	5,912,968	5,915,227
5,929,598	5,930,720	5,960,358	5,987,330	6,044,281	6,070,082	6,125,277
6,253,088	6,314,278	16,418,209	6,618,015	6,671,315	6,714,630	6,782,098
6,788,920	6,788,953					

Other patents pending



## Free Manuals Download Website

<http://myh66.com>

<http://usermanuals.us>

<http://www.somanuals.com>

<http://www.4manuals.cc>

<http://www.manual-lib.com>

<http://www.404manual.com>

<http://www.luxmanual.com>

<http://aubethermostatmanual.com>

Golf course search by state

<http://golfingnear.com>

Email search by domain

<http://emailbydomain.com>

Auto manuals search

<http://auto.somanuals.com>

TV manuals search

<http://tv.somanuals.com>