

Uniden®

XS1210

OWNER'S

MANUAL

OWNER'S MANUAL

Introduction

Uniden 2.4GHz cordless phones are designed and engineered to exacting standards for reliability, long life, and outstanding performance.

NOTE: *Illustrations in this manual are used for explanation purposes. Some illustrations in this manual may differ from the actual unit. The color of your cordless phone may vary.*

Features

- 2.4 GHz Extended Range Technology
- Tone Dialing
- Last Number Redial
- AutoStandby
- Hearing Aid Compatible
- One Touch RocketDial Number
- AutoTalk
- 20 Channel Autoscan
- 10-Number Memory Dialing
- Earpiece Volume Control
- Find Handset Locator

The cordless phone features **AutoTalk** and **AutoStandby**. **AutoTalk** allows you to answer a call by just removing the handset from the base so you don't have to waste time pushing buttons. **AutoStandby** allows you to hang up by simply returning the handset to the base.

The **UltraClear Plus** true compander circuitry virtually eliminates background noise. This innovative technology, together with 20 different channels, provides you with the best possible reception during all your conversations.

To protect you against misbilled calls which might result from your phone being activated by other equipment, the cordless phone has **Random Code** digital security which automatically selects one of 262,144 digital security codes for the handset and base. Also, the **AutoSecure** feature electronically locks your phone when the handset is in the base.

RocketDial is a one-touch speed dial key that automatically dials your most important or frequently called number. The number dialed, is a preset number stored by the user.

For more information on Uniden products and accessories, be sure to visit our web site: www.uniden.com.au or www.uniden.co.nz

Controls and Functions

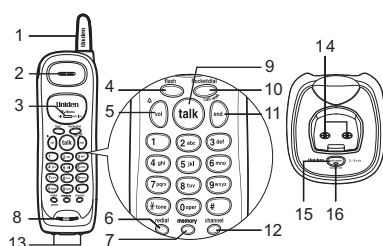

1. Handset antenna
2. Handset earpiece
3. **talk/batt low** LED - indicates when phone is in use or the battery is low
4. **flash** - accesses call waiting (if available) (p. 5)
5. **vol/ Δ** - sets the ringer tone and earpiece volume (p. 5)

6. **redial/pause** - redials the last number /adds a timed pause in a memory dialing sequence. (p. 5, 7)
7. **memory** - enters or recalls numbers in memory (p. 6, 7)
8. Handset Microphone
9. **talk** - answers or places calls (p. 5)
10. **Rocketdial/call wait** - one touch priority key/call waiting key (Australia only) (p. 7, 5)
11. **end** - hangs up a phone call /mutes the ringing tone temporarily (p. 5)
12. **channel** - selects another channel for clearer reception (p. 5)
13. Handset charging contacts
14. Base charging contacts
15. **find handset** - locates the handset (p. 6, 8)
16. **charge / in use** LED

Included with Your Phone

- Base Unit
- Rechargeable Battery
- This owner's manual
- Handset
- Telephone Cord
- AC adaptor
- Wall Mount adaptor

Terminology

Throughout this manual, terms such as Standby and Talk Mode are used. Below is the terminology explanation.

- **Talk Mode** - The handset is off the base and the *talk* key has been pressed, enabling a dial tone.
- **Standby Mode** - The handset may be sitting in or off the base, but is NOT in use. The *talk* key has not been pressed and there is no dial tone.

Installing the Phone

Do the following steps:

- Choose the best location
- Install the rechargeable battery pack into the handset
- Connect the base unit and charge the handset
- Mount the base unit on a wall

A. Choose the best location

When choosing a location for your new phone, here are some important guidelines you should consider:

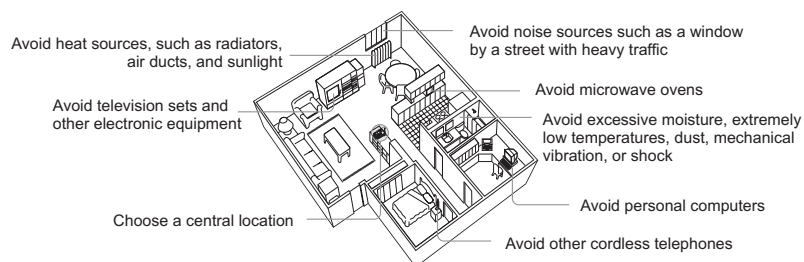

- The location should be close to both a phone jack and a continuous power outlet (one which is not connected to a switch).
- The base and handset should be kept away from sources of electrical noise such as motors and fluorescent lighting.
- The base can be placed on a desk, tabletop, or mounted on a standard wall plate. For better reception, place the base as high as possible.
- The base should be placed in an open area for optimum range and reception.

B. Install the rechargeable battery pack into the handset

The handset is powered by a rechargeable battery pack. The battery recharges automatically when the handset is placed in the base unit.

NOTE: *If your home has specially wired alarm equipment connected to the telephone line, be sure that installing the system does not disable your alarm equipment. If you have questions about what will disable your alarm equipment, contact your telephone company or a qualified installer.*

1. Press down on the handset battery case cover (use the finger indentation for a better grip) and slide the cover downward to remove.
2. Plug the battery pack connector (red & black wires) into the jack inside the battery compartment (the connector notches fit into the grooves of the jack only one way). Match the wire colours to the polarity label in the battery compartment, connect the battery and listen for a click to insure connection.
3. Before replacing the battery cover, pull on the battery wires slightly. If the connection is secure, the jack will stay in place. Then place the battery case cover back on the handset by sliding it upwards until it clicks into place.

NOTE: *For optimum performance, use only the Uniden battery (BT- 905) supplied with your phone.*

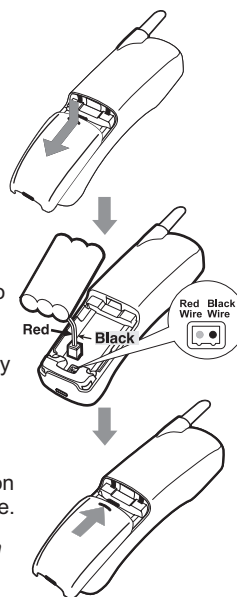

C. Connect the base unit and charge the handset

1. Connect the AC adaptor to the **DC IN 9V** jack and a standard **240V AC** wall outlet.
2. Set the base unit on a desk or tabletop, and place the handset in the base unit with the keypad facing forward.
3. Make sure the **charge/in use** LED illuminates. If the LED does not illuminate, check to see that the AC adaptor is plugged in and the handset makes good contact with the base charging contacts.

NOTICE: *Do not place the power cord where it creates a trip hazard or where it could become chafed and create a fire or electrical hazard.*

- NOTE:**
- Use only the supplied AAD-210 AC adaptor. Do not use any other AC adaptor.
 - Connect the AC adaptor to a continuous power supply.
 - Place the base unit close to the AC outlet to avoid long extension cords.

4. Charge your handset at least **15-20 hours** before plugging the phone line. When fully charged the battery will provide up to 7hrs talk time and 14 days standby time.

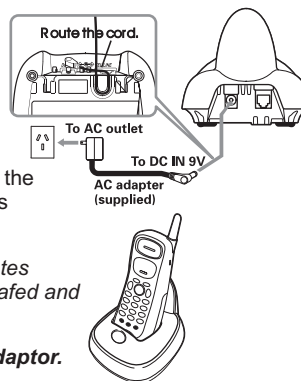



- Once the handset battery pack is fully charged, connect the telephone line cord to the **TEL LINE** jack and a telephone outlet.

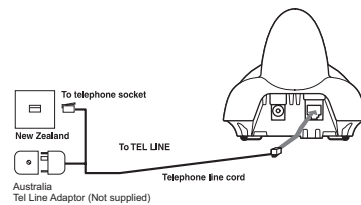

D. Mount the base unit on a wall

Standard wall plate mounting

This phone can be mounted on any standard wall plate.

- Locate the base unit on the wall mount adaptor as shown and slide the wall mount adaptor into the notches on the base bottom with the tab pressed.
- Plug the AC adaptor into the **DC IN 9V** jack.
- Route the AC adaptor cord through the molded wiring channel as shown.
- Plug the AC adaptor into a standard **240V AC** wall outlet.
- Plug the telephone line cord into the **TEL LINE** jack. Route the cord through the molded wiring channel as shown.
- Plug the telephone line cord into the telephone outlet (socket image shown is indicative only).
- Align the mounting slots on the base with the mounting posts on the wall. Then push in and down until the phone is firmly seated.

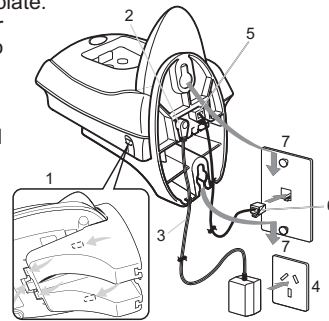

Direct wall mounting

If you don't have a standard wall plate, you can mount your phone directly to the wall. Before doing this, consider the following:

- Avoid electrical cables, pipes, or other items behind the mounting location that could cause a hazard when inserting screws into the wall.
- Try to mount your phone within 1.5m of a working phone jack to avoid excessive cord lengths.
- Make sure the wall material is capable of supporting the weight of the base and handset.
- Use #10 screws (minimum length of 35mm) with anchoring devices suitable for the wall material where the base unit will be placed.

- Insert two mounting screws into the wall, (with their appropriate anchoring device), 100mm apart. Allow about 3mm between the wall and screw heads for mounting the phone.
- Refer to steps 1 through 7 above to mount the telephone.

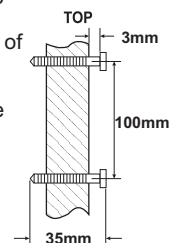

Making and Receiving Calls

Making a call

1. Remove the handset from the base.
2. Press the **talk** key. The **talk/batt low** LED flashes and turns on.
3. Listen for the dial tone.
4. Dial the number.

Receiving a call

If the handset is in the base, simply remove the handset from the base. AutoTalk will automatically answer the call.

If the handset is off the base, press the **talk** key or any number key.

Hanging up

Press the **end** key or return the handset to the base.

Redialing the last dialed number

1. Remove the handset from the base.
2. Press the **talk** key. The **talk/batt low** LED flashes and turns on.
3. Listen for the dial tone.
4. Press the **redial/pause** key.

Flash and Call Waiting

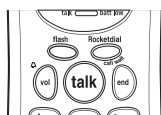

If a call waiting tone sounds while you are on a call:

Australia: Press **Rocketdial/call wait** to switch between callers.

New Zealand: Press **flash** to switch between callers.

NOTE: You must subscribe to call waiting through your telephone company.

Adjusting the Ringer and Earpiece Volume

Ringer tone and volume

When the phone is in standby mode, press the **vol/Δ** key repeatedly to listen to the four ringer tones and volume combinations. The last ringer tone heard will be selected as the phone's ring tone setting.

Earpiece volume

The handset earpiece volume settings (low, medium and high) can only be adjusted during a call. Use the **vol/Δ** key to scroll through the volume levels and select the one that works best for you. When you hang up, the phone keeps the volume setting.

Temporarily Mute Ringer

If the handset is off the base, simply press the **end** key to temporarily mute the incoming ring. The ringer will sound with the next incoming call.

Travelling Out-of-Range

During a call, as you begin to move your handset too far from your base unit, noise increases. If you pass the range limits of the base, your call will terminate within one minute.

Selecting a Different Channel

If you encounter interference while using your phone, you can manually change the phone's channel for clear operation. This function works only when the phone is in use. Press the **channel** key. The **talk/batt low** LED flashes, indicating the phone is changing to another channel.



Find Handset

To locate the handset, press the **find handset** key on the base. The handset beeps for 60 seconds. The handset stops beeping when any key is pressed, when it is returned to the base, or when the **find handset** key is pressed. The handset also stops beeping when an incoming call is received.

Low Battery Alert

When the battery pack is very low and needs to be charged, the phone is programmed to eliminate functions in order to save power. If the phone is not in use, the **talk/batt low** LED flashes when the battery pack is low. If the phone is in use, the **talk/batt low** LED flashes and the handset beeps. Complete your conversation as quickly as possible and return the handset to the base for charging.

- NOTE:**
- *Even when the battery pack is not being used, it will gradually discharge over a long period of time. For optimum performance, be sure to return the handset to the base unit after each telephone call.*
 - *Last number dialed and numbers stored in memory locations (including RocketDial), are retained for up to one minute while you replace the battery pack.*

Cleaning the battery charging contacts

To maintain a good charge, clean the charging contacts on the handset once a month.

Dampen a cloth with plain water.

Gently rub the damp cloth over the charging contacts until all visible dirt is removed.

Dry the contacts thoroughly before returning the handset to the base.



Caution: Do not use paint thinner, benzene, alcohol, or other chemical products. Doing so may discolour the surface of the telephone and damage the finish.

Using the Speed Dial Memory and RocketDial

Storing Numbers in Speed Dial/RocketDial Memory

Your cordless phone can store up to ten numbers in the speed dial memory. An additional number can be stored in the one-touch RocketDial memory. Store your most frequently dialed number in the one-touch RocketDial location.

1. When the phone is in standby mode, press the **memory** key. The **talk/batt low** LED flashes.
2. Use the keypad to enter the phone number; each number can be up to 20 digits.



3. If you need the phone to pause during the dialing sequence, press the **redial/pause** key to insert a two-second delay between the numbers. You can enter multiple pauses to increase the delay. Each pause counts as a digit.
4. Press the **memory** key again.
5. To store this number in the RocketDial memory, press the **Rocketdial/call wait** key. You will hear a confirmation tone indicating that the number has been stored.
6. To store this number as one of the ten speed dial numbers, enter a digit from **0** to **9**. If there is already a number in that speed dial setting, it will overwrite the previously stored number without warning. You will hear a confirmation tone indicating that the number has been stored.

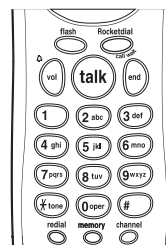

NOTE: When storing numbers into memory, if the handset is idle (i.e., no key is pressed) for more than 30 seconds, it will beep rapidly, and the phone will return to standby mode.

Dialing a Speed Dial Number

1. When the phone is in standby mode, press the **talk** key, and listen for a dial tone.
2. Press the **memory** key and enter the speed dial entry (0-9) that has the stored number you want to dial. (If you enter a digit that does not contain a stored number, the handset will beep rapidly, and the phone will not dial.)

Chain Dialing

The speed dial memory is not limited to phone numbers. You can store any number (up to 20 digits) that you need to enter once your call connects. This is referred to as Chain Dialing.

For example, you can save your bank account number to speed dial memory. When you call your bank's telephone teller service and are prompted to enter your account number, simply press the **memory** key and the speed dial number where you stored your account number.

Making Calls With Rocketdial/call wait

When the phone is in the standby mode, simply press **Rocketdial/call wait**. The number stored in the RocketDial memory location is instantly dialed.

Erasing a Stored Number from Memory

1. With the phone in standby mode, press the **memory** key twice.
2. Press the number of the speed dial entry or the **Rocketdial/call wait** key. A tone indicates that the stored number is erased from memory.



Changing the Digital Security Code



The digital security code is an identification code used to connect the handset and the base unit. Normally, setting the code is not necessary.

The first time you charge your handset, the security code is automatically set. In the rare situation that you suspect another cordless telephone is using the same security code, you can change the code.

1. Remove the handset from the base unit. Press and hold the **find handset** key on the base.
2. While holding the **find handset** key, place the handset in the base unit. Leave the handset in the base for more than three seconds. A new random security code is set.

NOTE: *If the handset battery pack is completely discharged or the battery pack is removed, the digital security code will be lost. If this happens, a new security code is set automatically next time the battery pack is charged.*

Warning!

Uniden DOES NOT represent this unit to be waterproof. To reduce the risk of fire, electrical shock, or damage to the unit, DO NOT expose this unit to rain or moisture.



Troubleshooting

If your cordless telephone is not performing to your expectations, please try these simple steps first. If these steps do not solve your problem, please visit our website www.uniden.co.au or www.uniden.co.nz

NOTE: Do not attempt to service this unit yourself. Servicing must be performed by qualified personnel.

Symptom	Suggestion
The charge/in use LED won't illuminate when the handset is placed in the base.	<ul style="list-style-type: none"> • Make sure the AC adaptor is plugged into the base and a wall outlet. • Make sure the handset is properly seated in the base. • Make sure that the charging contacts on the handset are clean.
The audio sounds weak and/or scratchy.	<ul style="list-style-type: none"> • Move the handset and/or base away from metal objects or appliances and try again. • Press the channel key to help eliminate background noise. • Check both ends of the telephone line cord.
Can't make or receive calls.	<ul style="list-style-type: none"> • Make sure the AC adaptor is plugged into the base and a wall outlet. • Disconnect the AC adaptor for a few minutes. Then reconnect it. • Change the digital security code. (see page 8.) • Make sure that the handset is not too far from the base. • Check the dialing mode used by your telephone company.
The handset doesn't ring or receive a page.	<ul style="list-style-type: none"> • The battery pack may be weak. Charge the battery for 15-20 hours. • The handset may be too far away from the base. • Move the base away from appliances or metal objects. • Change the digital security code. (see page 8.)
Severe noise interference	<ul style="list-style-type: none"> • Keep the handset away from microwave ovens, computers, remote control toys, wireless microphones, alarm systems, intercoms, room monitors, fluorescent lights, and electrical appliances. • Move the base to another location or turn off the source of interference.

Liquid Damage

Moisture and liquid can damage your cordless phone. In case of accidental submersion, please follow these steps.

Case	Action
If the handset or base is exposed to moisture or liquid, but it only affects the exterior plastic housing.	Wipe off the liquid, and use as normal.
If moisture or liquid has entered the plastic housing (i.e. liquid can be heard in the phone or liquid has entered the handset battery compartment or vent openings on the base).	<p>Handset:</p> <ol style="list-style-type: none"> 1. Remove the battery cover and leave it off for ventilation. 2. Remove the battery pack by disconnecting. 3. Leave the battery cover off and the battery pack disconnected for at least 3 days. 4. Once the handset is completely dry, reconnect the battery pack and the battery cover. 5. Recharge the handset's battery pack for 20 hours before using again. <p>Base:</p> <ol style="list-style-type: none"> 1. Disconnect the AC adaptor from the base unit, cutting off electrical power. 2. Disconnect the telephone cord from the base unit. 3. Let dry for at least 3 days. <p>IMPORTANT: You must unplug the telephone line while recharging the battery pack to avoid charge interruption.</p> <p>CAUTION: DO NOT use a microwave oven to speed up the drying process. This will cause permanent damage to the handset, base and the microwave oven. After following these steps, if your cordless telephone does not work, please visit our website www.uniden.co.au or www.uniden.co.nz</p>



Warranty



UNIDEN XS1210 Cordless Phone

Limited One Year Warranty

Note: Please keep your sales docket as it provides evidence of warranty.

Warrantor: Uniden Australia Pty Limited ABN 58 001 865 498

Uniden New Zealand Limited

Warranty only available in original country of purchase

Elements of Warranty: Uniden warrants to the original retail owner for the duration of this warranty, its XS1210 Cordless Phone (hereinafter referred to as the Product) to be free from defects in materials and craftsmanship with only the limitations or exclusions set out below.

Warranty Duration: This warranty to the original retail owner only, shall terminate and be of no further effect ONE (1) Year after the date of original retail sale. This warranty will be deemed invalid if the product is: (A) Damaged or not maintained as reasonable and necessary, (B) Modified, altered or used as part of any conversion kits, subassemblies, or any configurations not sold by Uniden, (C) Improperly installed, (D) Repaired by someone other than an authorised Uniden Repair Agent for a defect or malfunction covered by this warranty, (E) Used in conjunction with any equipment or parts or as part of a system not manufactured by Uniden, (F) Installed, programmed or serviced by anyone other than an authorised Uniden Repair Agent, or (G) Where the Serial Number label of the product has been removed or damaged beyond recognition.

Parts Covered: This warranty covers for 1 year, the Handset and Base Unit only.

Accessories: Batteries, AC adaptor etc are covered for 90 days.

Statement of Remedy: In the event that the product does not conform to this warranty at any time while this warranty is in effect, the warrantor at its discretion, will repair the defect or replace the product and return it to you without charge for parts and service. THIS WARRANTY DOES NOT COVER OR PROVIDE FOR THE REIMBURSEMENT OR PAYMENT OF INCIDENTAL OR CONSEQUENTIAL DAMAGES. THIS GUARANTEE IS IN ADDITION TO AND DOES NOT AFFECT YOUR RIGHTS UNDER THE CONSUMER GUARANTEES ACT.

Procedure for obtaining performance or warranty: In the event that the Product does not conform to this warranty, the Product should be shipped or delivered, freight prepaid, with evidence of original purchase, (eg. a copy of the sales docket), to the warrantor at:

UNIDEN AUSTRALIA PTY LTD

Service Division
345 Princes Highway,
Rockdale, NSW 2216
Fax (02) 9599 3278
www.uniden.com.au

UNIDEN NEW ZEALAND LTD

Service Division
150 Harris Road, East Tamaki,
Auckland
Fax (09) 274 4253
www.uniden.co.nz

Customers in other states should ship or deliver the Product freight pre-paid to the nearest Uniden Authorised Repair Centre. (Contact Uniden for the Warranty Agent nearest you.)

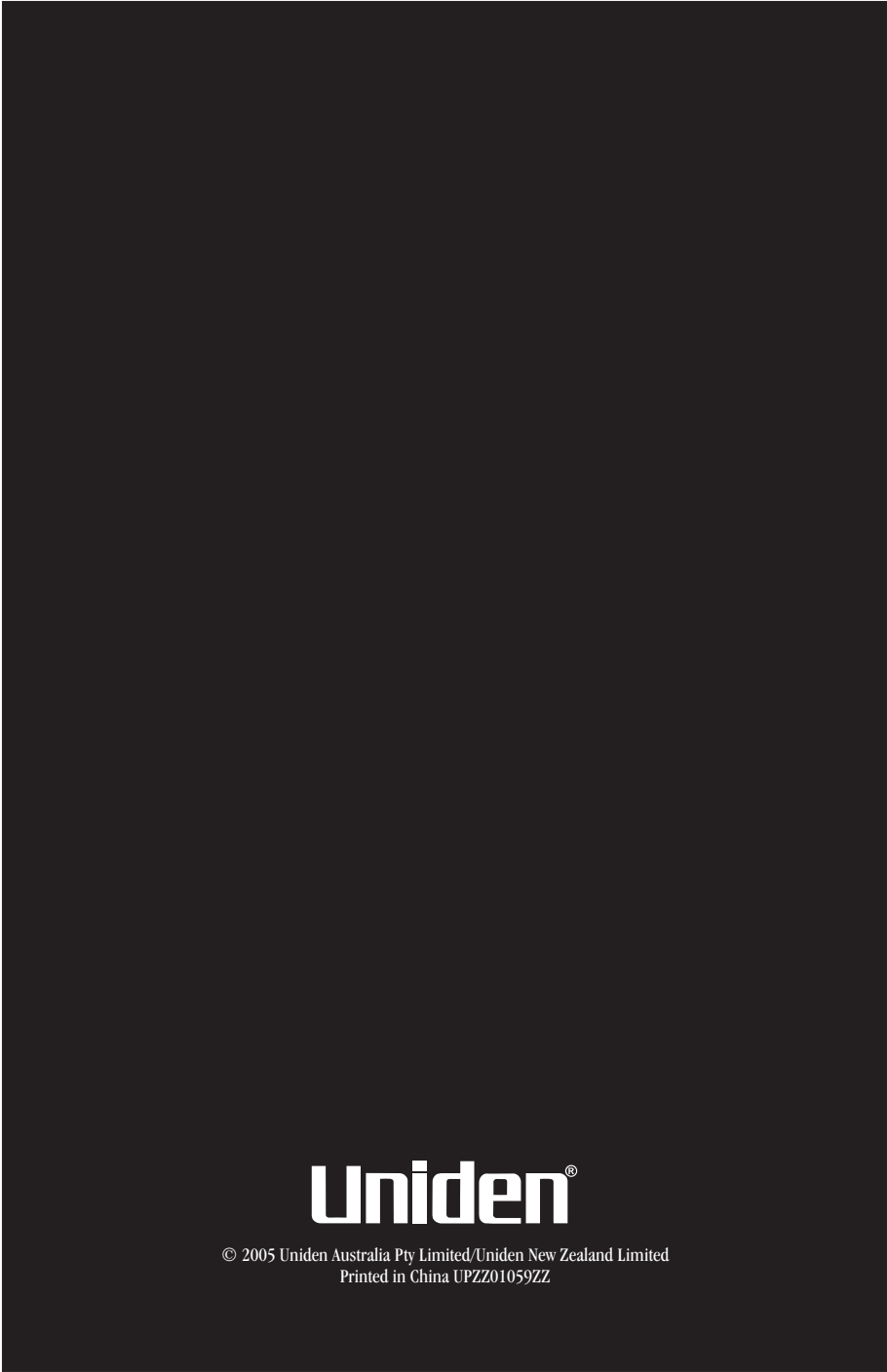

Uniden®

© 2005 Uniden Australia Pty Limited/Uniden New Zealand Limited
Printed in China UPZZ01059ZZ

Free Manuals Download Website

<http://myh66.com>

<http://usermanuals.us>

<http://www.somanuals.com>

<http://www.4manuals.cc>

<http://www.manual-lib.com>

<http://www.404manual.com>

<http://www.luxmanual.com>

<http://aubethermostatmanual.com>

Golf course search by state

<http://golfingnear.com>

Email search by domain

<http://emailbydomain.com>

Auto manuals search

<http://auto.somanuals.com>

TV manuals search

<http://tv.somanuals.com>