

ELECTRIC GUITAR RGX A2 SERVICE MANUAL



WARNING: CHEMICAL CONTENT NOTICE!

The solder used in the production of this product contains LEAD. In addition, other electrical/electronic and/or plastic (Where applicable) components may also contain traces of chemicals found by the California Health and Welfare Agency (and possibly other entities) to cause cancer and/or birth defects or other reproductive harm.

DO NOT PLACE SOLDER, ELECTRICAL/ELECTRONIC OR PLASTIC COMPONENTS IN YOUR MOUTH FOR ANY REASON WHAT SO EVER!

Avoid prolonged, unprotected contact between solder and your skin! When soldering, do not inhale solder fumes or expose eyes to solder/flux vapor!

If you come in contact with solder or components located inside the enclosure of this product, wash your hands before handling food.

■ CONTENTS

OVERALL ASSEMBLY	2
ELECTRICAL PARTS	4
CIRCUIT BOARD	4
CIRCUIT DIAGRAM	4
WIRING	5
SPECIFICATIONS	5

OVERALL ASSEMBLY

E11 Bridge Assembly Installation

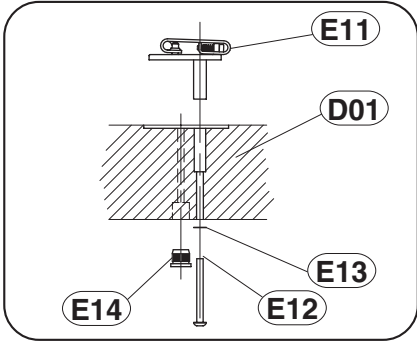

F15 Jack Installation

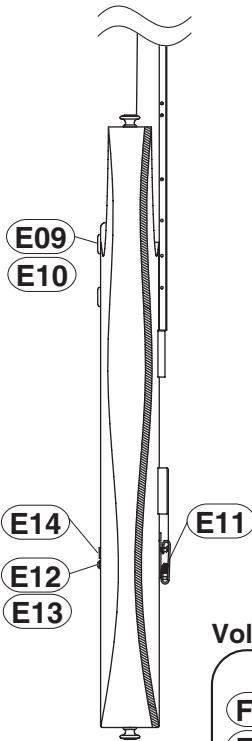
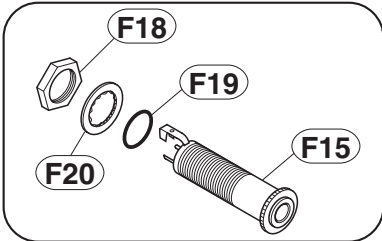

A01d

A seal is attached on the rear of the neck.

RGX A2

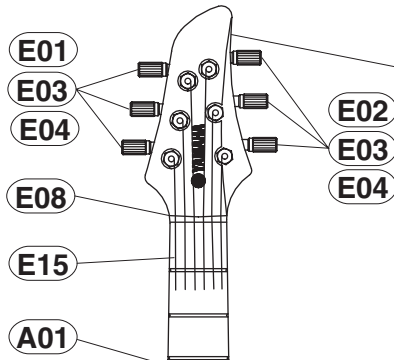

E01 E02 Tuning Machine Assembly

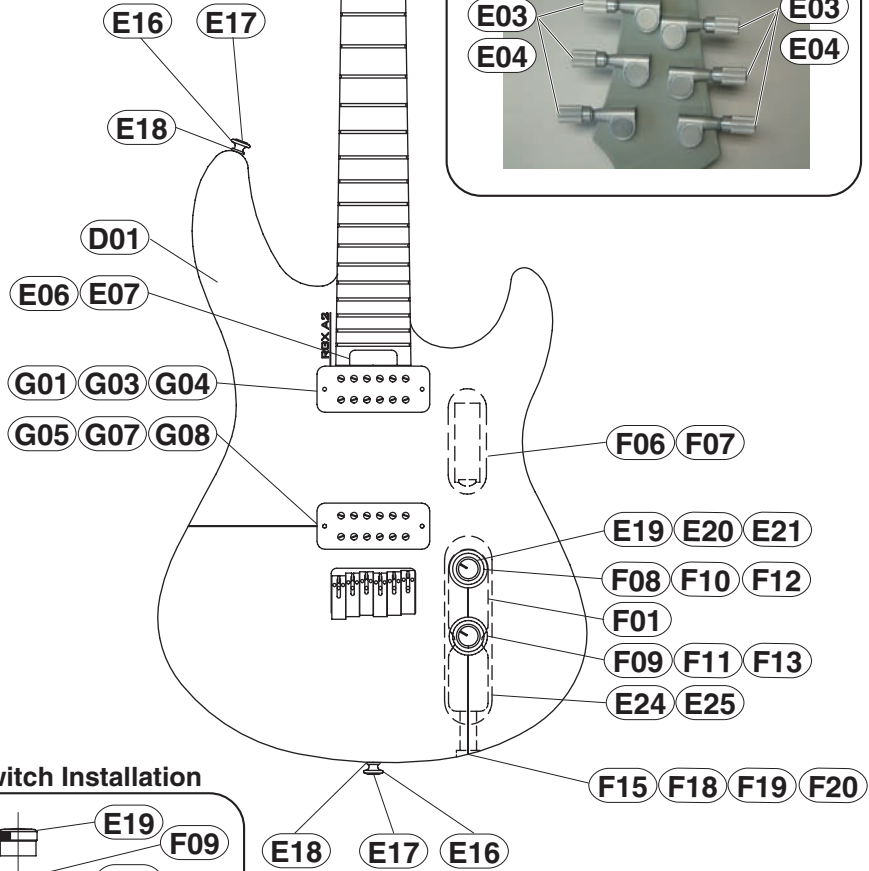
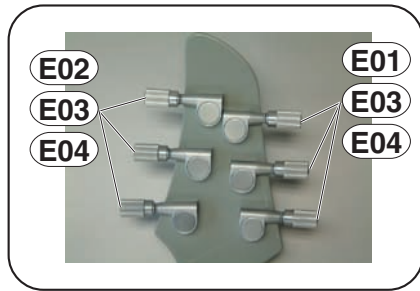

Volume/Pickup Switch Installation

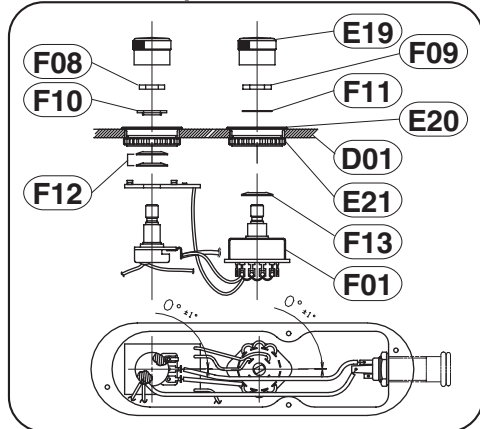

F10 Flat Washer (QC887400)



REF NO.	PART NO.	DESCRIPTION	REMARKS	QTY	RANK
* A01	AA71450	OVERALL ASSEMBLY	RGX-A2		
A01d	---	Neck Assembly	ACG		
		Seal	(WF64920)		
D01	---	Body			
* E01	QC846100	Tuning Machine Assembly	4, 5, 6 string Satin Chrome	3	
* E02	QC846200	Tuning Machine Assembly	1, 2, 3 string Satin Chrome	3	
E03	---	Nut	Satin Chrome	6	
E04	---	Washer	Satin Chrome	6	
E06	QC683100	Rod Cover	Black		03
E07	VE210700	Flat Head Wood Screw	2. 4x16 MFC2BL	2	01
E08	QC692800	Nut	43mm UREA		
E09	QC205200	Neck Joint Bush	Black	4	04
E10	QC685200	Oval Head Wood Screw	4. 5x40 MFC2BL	4	01
* E11	QC845000	Bridge Assembly			
* E12	QC844200	Cap Screw	3x30 MFC2BL	3	
* E13	QC844300	Spacer	3x6	3	
E14	QC668600	Bushing	Black	6	02
E15	---	Strings	XL-120	1set	(QC16510)
* E16	QC846300	Strap Button	Satin Chrome	2	
E17	QA132800	Oval Head Tapping Screw	3. 5x25 MFCR33	2	01
E18	VB793700	Spacer	Felt	2	01
* E19	QC845900	Knob Assembly	Aluminum	2	
* E20	QC845400	Control Ring		2	
* E21	QC845500	Ring		2	
* E24	QC845600	Back Cover	Black		
E25	20454100	Oval Head Tapping Screw	2. 4x16 MFC2BL	4	01
F01	---	Electrical Unit		1set	(QC84580)
* F01a	QC884200	Circuit Board	with LED		
F01b	HS120071	Variable Resistor	15A 500K ohm		03
* F01c	QC884300	Pickup Switch	RSL25-1-4-3-15KC		
F06	QC800100	Battery Box	4pole 3position Rotary Switch		05
F07	03706220	Round Head Wood Screw	2. 1x10 MFC2BL	2	
F08	---	Hexagonal Nut	with Volume		
F09	---	Hexagonal Nut	with Pickup Switch		
* F10	QC887400	Flat Washer			
F11	---	Flat Washer	with Pickup Switch		
F12	ET800060	Toothed Lock Washer		2	01
F13	ET800150	Toothed Lock Washer			01
F14	03704270	Round Head Wood Screw	2. 7x13 MFC2BL	2	01
F15	QA209900	Jack			07
F18	---	Hexagonal Nut	with Jack		
F19	---	Rubber Ring	with Jack		
F20	---	Toothed Lock Washer	with Jack		
* G01	QC844800	Pickup Assembly	FRONT		
G03	QC556200	Pan Head Tapping Screw	2. 6x35 MFCR33	2	01
G04	QC556400	Pickup Cushion	Chrome		02
* G05	QC844800	Pickup Assembly	REAR		
G07	QC556200	Pan Head Tapping Screw	2. 6x35 MFCR33	2	01
G08	QC556400	Pickup Cushion	Chrome		02
H01	QC354000	Accessory Unit	G-1	1set	07
	QC583200	Cord	D		05
	AA804050	Wrench	#1. 5		01
	AA805430	Wrench	#5		04
*	QC845000	Bridge Assembly			
B01	---	Bridge Base	Satin Chrome		
B02	---	Bridge Saddle	Satin Chrome	6	
B03	---	Aluminum Pipe		3	
B04	---	Cap Screw (Flat Head)	3x10 MFN133	3	
B05	---	Cap Screw	2x10 MFC2BL	6	
B06	---	Set Screw	3x6 MFC2BL	12	
B07	---	Bridge Spring	L=8	6	

*: New Parts

RANK: Japan only

ELECTRICAL PARTS

REF NO.	PART NO.	DESCRIPTION	REMARKS	QTY	RANK
*	QC884200	Circuit Board	(QC88470)		
*	QC884200	Circuit Board	(QC88470)		
* LD01	QC884500	LED	T670TGKT		
* LD02	QC884600	LED	T670TBKT		
R01	RD357100	Carbon Resistor (Chip)	10K 1/16W J		01
R02	RD356270	Carbon Resistor (Chip)	2.7K 1/16W J		01

*: New Parts

RANK: Japan only

CIRCUIT BOARD

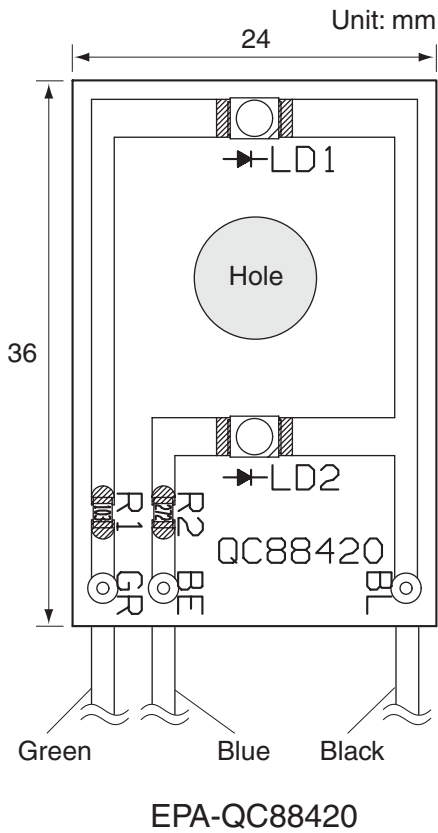

CIRCUIT DIAGRAM

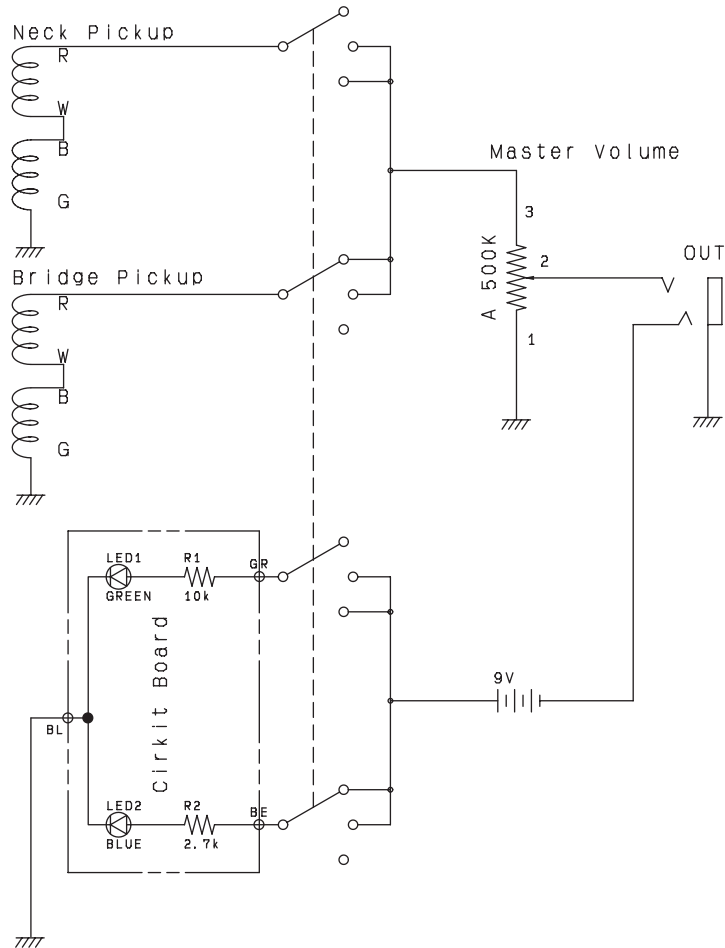

WIRING

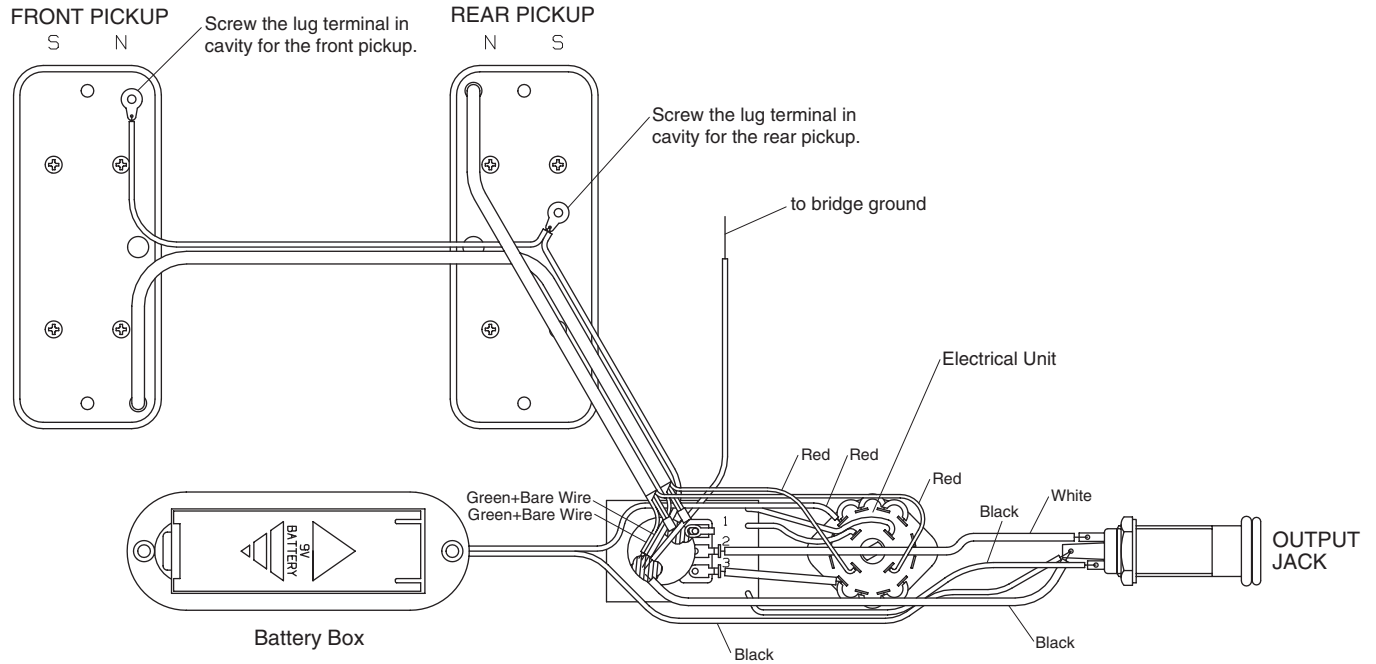

SPECIFICATIONS

STANDARD SPECIFICATIONS

Scale Length.....	648 mm
Body-Neck Construction.....	Bolt On
Length.....	953.7 mm
Width.....	325.5 mm
Net Weight.....	2.5 kg

COLOR

Head	
WH.....	White
Neck	
ACG.....	Aircraft Gray
Body	
WH/ACG.....	White/Aircraft Gray

BODY

Material.....	Agathis/Falcata
Body Depth.....	44.5 mm

FINGERBOARD

Material.....	Rosewood
Fingerboard Width.....	0-F 43.0 mm, 12-F 52.4 mm

NECK

Material.....	Maple
Neck Thickness.....	1-F 20.0 mm, 12-F 23.0 mm

PARTS

Hardware.....	Satin Chrome Plated
Nut.....	Urea
Bridge.....	Fixed type (Satin Chrome)
Strings.....	D'addario (XL-120)

CONTROLS

Volume.....	A 500 K Ω x 1
Pickup Switch.....	4pole 3position Rotary Switch

PICKUPS

Front/Rear.....	Humbucking
Magnet.....	
Front/Rear.....	Alnico

Free Manuals Download Website

<http://myh66.com>

<http://usermanuals.us>

<http://www.somanuals.com>

<http://www.4manuals.cc>

<http://www.manual-lib.com>

<http://www.404manual.com>

<http://www.luxmanual.com>

<http://aubethermostatmanual.com>

Golf course search by state

<http://golfingnear.com>

Email search by domain

<http://emailbydomain.com>

Auto manuals search

<http://auto.somanuals.com>

TV manuals search

<http://tv.somanuals.com>