



YDS-12

Universal Dock for iPod
Dock Universal pour iPod
iPod 用ユニバーサルドック

OWNER'S MANUAL
MODE D'EMPLOI
BEDIENUNGSANLEITUNG
BRUKSANVISNING
MANUALE DI ISTRUZIONI
MANUAL DE INSTRUCCIONES
GEBRUIKSAANWIJZING
ИНСТРУКЦИЯ ПО ЭКСПЛУАТАЦИИ
使用说明书
사용 설명서
取扱説明書



Made for
iPod



Works with
iPhone

English

Français

Deutsch

Svenska

Italiano

Español

Nederlands

Русский

中文

한국어

日本語

FCC INFORMATION (for US customers only)

1. IMPORTANT NOTICE : DO NOT MODIFY THIS UNIT!

This product, when installed as indicated in the instructions contained in this manual, meets FCC requirements. Modifications not expressly approved by Yamaha may void your authority, granted by the FCC, to use the product.

2. IMPORTANT : When connecting this product to accessories and/or another product use only high quality shielded cables. Cable/s supplied with this product **MUST** be used. Follow all installation instructions. Failure to follow instructions could void your FCC authorization to use this product in the USA.

3. NOTE : This product has been tested and found to comply with the requirements listed in FCC Regulations, Part 15 for Class "B" digital devices. Compliance with these requirements provides a reasonable level of assurance that your use of this product in a residential environment will not result in harmful interference with other electronic devices.

This equipment generates/uses radio frequencies and, if not installed and used according to the instructions found in the users manual, may cause interference harmful to the operation of other electronic devices.

Compliance with FCC regulations does not guarantee that interference will not occur in all installations. If this product is found to be the source of interference, which can be determined by turning the unit "OFF" and "ON", please try to eliminate the problem by using one of the following measures:

Relocate either this product or the device that is being affected by the interference.

Utilize power outlets that are on different branch (circuit breaker or fuse) circuits or install AC line filter/s.

In the case of radio or TV interference, relocate/reorient the antenna. If the antenna lead-in is 300 ohm ribbon lead, change the lead-in to coaxial type cable.

If these corrective measures do not produce satisfactory results, please contact the local retailer authorized to distribute this type of product. If you can not locate the appropriate retailer, please contact Yamaha Electronics Corp., U.S.A. 6660 Orangethorpe Ave, Buena Park, CA 90620.

The above statements apply **ONLY** to those products distributed by Yamaha Corporation of America or its subsidiaries.

COMPLIANCE INFORMATION STATEMENT

This device complies with Part 15 of the FCC Rules. Operation is subject to the following conditions:

- 1) This device may not cause harmful interface, and
- 2) This device must accept any interference received including interference that may cause undesired operation of this device.

See user manual instructions if interference to radio reception is suspected.

Informations de la FCC (Pour les clients résidents aux États-Unis)

1. AVIS IMPORTANT: NE PAS APPORTER DE MODIFICATIONS À CET APPAREIL !

Ce produit est conforme aux exigences de la FCC s'il est installé selon les instructions du mode d'emploi. Toute modification non approuvée expressément par Yamaha peut invalider l'autorisation, accordée par la FCC, d'utiliser ce produit.

2. IMPORTANT: N'utiliser que des câbles blindés de haute qualité pour le raccordement de ce produit à des accessoires et/ou à un autre produit. Seuls le ou les câbles fournis avec le produit DOIVENT être utilisés. Suivre les instructions concernant l'installation. Le non respect des instructions peut invalider l'autorisation, accordée par la FCC, d'utiliser ce produit aux États-Unis.

3. REMARQUE: Ce produit a été testé et déclaré conforme aux normes relatives aux appareils numériques de Classe "B", telles que fixées dans l'Article 15 de la Réglementation FCC. Ces normes sont destinées à assurer une protection suffisante contre les interférences nuisibles avec d'autres appareils électroniques dans une installation résidentielle.

Cet équipement génère et utilise des fréquences radio qui, en cas d'installation et d'utilisation non conformes aux instructions du mode d'emploi, peuvent être à l'origine d'interférences empêchant d'autres appareils de fonctionner.

Cependant, la conformité à la Réglementation FCC ne garantit pas l'absence d'interférences dans une installation particulière. Si ce produit devait produire des interférences, ce qui peut être déterminé en "ÉTEIGNANT" et en "RALLUMANT" le produit, l'utilisateur est invité à essayer de corriger le problème d'une des manières suivantes :

Réorienter ce produit ou le dispositif affecté par les interférences.

Utiliser des prises d'alimentation branchées sur différents circuits (avec interrupteur de circuit ou fusible) ou installer un ou des filtres pour ligne secteur.

Dans le cas d'interférences radio ou TV, changer de place l'antenne et la réorienter. Si l'antenne est un conducteur plat de 300 ohms, remplacer ce câble par un câble de type coaxial.

Si ces mesures ne donnent pas les résultats escomptés, prière de contacter le détaillant local autorisé à commercialiser ce type de produit. Si ce n'est pas possible, prière de contacter Yamaha Electronics Corp., États-Unis, 6660 Orangethorpe Ave, Buena Park, CA 90620.

Les déclarations précédentes NE concernent QUE les produits commercialisés par Yamaha Corporation of America ou ses filiales.

INFORMATIONS CONCERNANT LA CONFORMITÉ

Cet appareil est conforme à l'article 15 de la Réglementation FCC.

Son fonctionnement est soumis aux deux conditions suivantes:

- 1) cet appareil ne doit pas causer d'interférences pernicieuses, et
- 2) cet appareil doit accepter toutes les interférences, y compris les interférences pouvant lui causer un fonctionnement indésirable.

Se reporter au mode d'emploi si des interférences semblent perturber la réception radio.

Warranty policy for European Economic Area (EEA) and Switzerland, Australia customer

In the unlikely event that your Yamaha product needs guarantee service, please contact the dealer from whom it was purchased. If you experience any difficulty, please contact Yamaha representative office in your country. You can find full details on our website EEA and Switzerland: (<http://www.yamaha-hifi.com/> or <http://www.yamahauk.com/> for U.K. resident).

Australia: (<http://www.yamahamusic.com.au/>)

Information for Users on Collection and Disposal of Old Equipment



This symbol specified in the Directives 2002/96/EC indicates that used electrical and electronic products should not be mixed with general household waste.

For proper treatment to avoid harmful effect on human health and environment, please contact your local municipality, your waste disposal service or the point of sale where you purchased the items.

Conditions de garantie pour la Communauté économique européenne (CEE) et la Suisse

Si votre produit Yamaha a besoin d'une réparation pendant sa période de garantie, veuillez contacter votre revendeur. En cas de diffi culté, veuillez contacter le représentant Yamaha de votre pays. Vous trouverez toutes les informations nécessaires sur notre site Web (CEE et Suisse) à l'adresse suivante : (<http://www.yamaha-hifi.com/> ou <http://www.yamahauk.com/> pour les résidents au Royaume-Uni)

Information concernant la Collecte et le Traitement des piles Usagées et des déchets d'équipements électriques et électroniques



Ce symbole, spécié dans la Directive 2002/96/CE, signifi e que les produits électriques ou électroniques usagés ne doivent pas être mis au rebut avec les déchets ménagers. Pour traiter ces équipements de manière appropriée, et éviter ainsi les eff ets néfastes sur la santé humaine et sur l'environnement, contactez votre municipalité, votre service de traitement des déchets ou le point de vente où vous avez acheté les produits.

■ Precautions

Read this before using this unit.

- To assure the finest performance, please read this manual carefully. Keep it in a safe place for future reference.
- Install this unit in a cool, dry, clean place away from windows, heat sources, and sources of excessive vibration, dust, moisture and cold. Avoid sources of humming (transformers, motors, etc.). To prevent fire or electrical shock, do not expose this unit to rain or water.
- To prevent the enclosure from warping or discoloring, do not place this unit where it will be exposed to direct sunlight or excessive humidity.
- Do not place this unit where foreign objects such as water drips may fall. It may cause a fire, or damage to this unit.
- Do not attempt to clean this unit with chemical solvents as this may damage the finish. Use a clean, dry cloth.
- Do not attempt to modify or fix this unit. Contact qualified Yamaha service personnel when any service is needed. The cabinet should never be opened for any reasons.

Secure placement or installation is the owner's responsibility.

Yamaha shall not be liable for any accident caused by improper placement or installation of this unit.

“Made for iPod” means that an electronic accessory has been designed to connect specifically to iPod and has been certified by the developer to meet Apple performance standards.

“Works with iPhone” means that an electronic accessory has been designed to connect specifically to iPhone and has been certified by the developer to meet Apple performance standards.

Apple is not responsible for the operation of this device or its compliance with safety and regulatory standards.

■ Introduction

With the Yamaha YDS-12 Universal Dock for iPod, you can play the content stored on your iPod through a Yamaha dock-compatible audio component. Operation and functionality depends on your iPod model and Yamaha dock-compatible audio component. See the owner's manuals supplied with your Yamaha dock-compatible audio component or iPod for details. This unit is compatible with the iPod and iPhone. References in this manual to "iPod" also apply to the iPhone.

As of April 2010, the following iPod models are compatible with this unit:

- iPhone
- iPod nano
- iPod touch
- iPod mini
- iPod (4th Gen/5th Gen/Classic)

iPod™, iPhone™

iPod is a trademark of Apple Inc., registered in the U.S. and other countries.

iPhone is a trademark of Apple Inc.

■ Package contents

Following items are included in the package. Make sure you have them all (iPod or iPhone not included).

YDS-12 (Main unit)

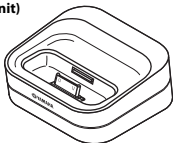

Dock cable (2 m (6.5 ft))

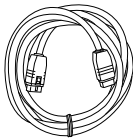

iPod dock adapters (A, B, C)

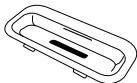

A iPod with color display (20 GB or 30 GB) or U2 Special Edition



B iPod with color display (40 GB or 60 GB) or iPod (40 GB)

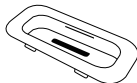

C iPod mini (4 GB or 6 GB)

- The included iPod dock adapters are for use with iPod models that do not come with their own adapters.
- If your iPod came with its own adapter, use it instead.
- Each adapter has an identification letter (A, B, or C) printed on its underside.
- A dock adapter for the iPhone is not included. You'll need to purchase one separately.

■ Controls and functions



Upper side

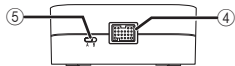

Back side

- 1 iPod connector terminal**
Connects your iPod.
- 2 Slits**
Hold an iPod dock adapter.
- 3 Adapter holder**
Holds an iPod dock adapter.
- 4 Dock cable terminal**
Connects the supplied dock cable.
- 5 Mode switch**
Selects the mode (A or B) depending on the Yamaha dock-compatible audio component you connect to this unit. See next page for details.

■ Inserting an iPod dock adapter

Insert the iPod dock adapter supplied with your iPod into the slot of the main unit. Depending on the type of your iPod, you may need to insert one of the iPod dock adapters supplied with this unit. See page 1 for details about the iPod dock adapter.

- 1. Insert the stoppers of the iPod dock adapter into the slits on the slot of this unit.**

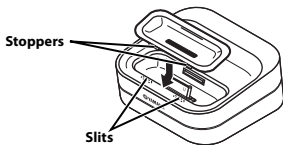

- 2. Insert the iPod dock adapter until it snaps into the slot of this unit.**

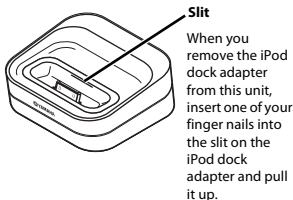

■ Connecting the dock

1. Set the Mode switch to A (default). If you're using a Yamaha dock-compatible audio component sold in 2009 or before, set the Mode switch to B.

Mode switch

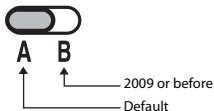

2. Connect one of the plugs of the dock cable to the dock cable terminal of this unit firmly.

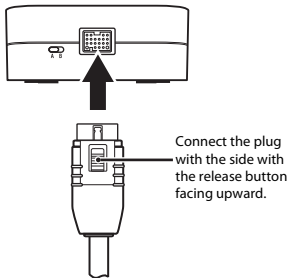

3. Make sure the power of the dock-compatible audio component is turned off.

Note

Connecting the dock connection cable while the dock-compatible audio component's power is on could result in damage.

4. Connect the other plug of the dock cable to the DOCK jack of the dock-compatible audio component.

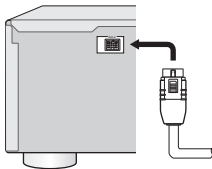

Note

Be sure to connect the plugs of the dock cable firmly to both the dock cable terminal of this unit and the DOCK jack of the dock-compatible audio component. When the connection is loose, this unit may output some unwanted noise.

■ Connecting your iPod

Insert the dock connector port of your iPod into the iPod connector terminal of this unit firmly.

 Refer to the owner's manual supplied with your Yamaha dock-compatible audio component or iPod for operating information.

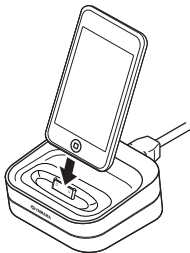

Note

- **When this unit is connected with an iPhone and placed near the Yamaha dock-compatible audio component, noise may occur. Place this unit away from the Yamaha dock-compatible audio component.**
- **Make sure that the output level of the dock-compatible audio component is set to minimum.**
- To protect the dock connector from damage, do not twist or sway back and forth your iPod when inserting or taking it off from this unit, and be careful not to knock over this unit when your iPod is inserted.
- Always use the correct iPod dock adapter (this may be the one supplied with your iPod, one supplied with this unit, or a commercially available adapter). Using this unit with the wrong iPod dock adapter may result in a poor connection and malfunction.
- Do not take off your iPod from this unit when you play back the music, photo, or movie stored on your iPod with the dock-compatible audio component.
- Connect your iPod without any other iPod accessories (such as headphones, a wired remote control, an FM transmitter etc.) connected.
- It is recommended that you update your iPod software before using it with this unit.

■ Disconnecting the dock cable

1. **Make sure the power of the dock-compatible audio component is turned off.**
2. **Press and hold the release button and then pull off the plug of the dock cable.**

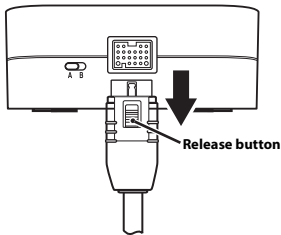

Note

Disconnecting the dock connection cable while the dock-compatible audio component's power is on could result in damage.

■ Troubleshooting

Refer to the items listed below when this unit does not function properly.

- Make sure the Mode switch is set appropriately for the Yamaha dock-compatible audio component you've connected to the YDS-12.
- Connect your iPod to this unit firmly.
- Connect the dock cable to the dock-compatible audio component firmly.
- Connect the dock cable to this unit firmly.
- Update the software of your iPod to the latest version.

If the instructions above do not help, refer to the instructions of your iPod or dock-compatible audio component.

■ Specifications

| | |
|------------------------------|---|
| Dimensions (W x H x D) | 89 x 37 x 86 mm (3 1/2 x 1 1/2 x 3 3/8 in) |
| Weight | 160g (5.6 oz) |

* Specifications are subject to change without notice.



©2010 YAMAHA CORPORATION All rights reserved

YAMAHA CORPORATION

Printed in China (®) WU92840

Free Manuals Download Website

<http://myh66.com>

<http://usermanuals.us>

<http://www.somanuals.com>

<http://www.4manuals.cc>

<http://www.manual-lib.com>

<http://www.404manual.com>

<http://www.luxmanual.com>

<http://aubethermostatmanual.com>

Golf course search by state

<http://golfingnear.com>

Email search by domain

<http://emailbydomain.com>

Auto manuals search

<http://auto.somanuals.com>

TV manuals search

<http://tv.somanuals.com>