



UAB

Digital Sound Projector

YSP-2700

[YSP-CU2700 + NS-WSW121]



Quick Reference Guide



For more detailed information, refer to the Owner's Manual on the CD-ROM.

Caution: Do not attempt to play this CD-ROM in an audio player.

IMPORTANT SAFETY INSTRUCTIONS

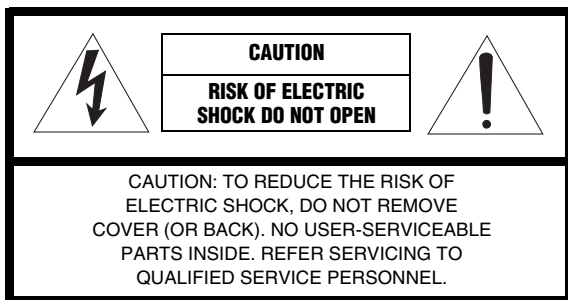

- Explanation of Graphical Symbols



The lightning flash with arrowhead symbol, within an equilateral triangle, is intended to alert you to the presence of uninsulated “dangerous voltage” within the product’s enclosure that may be of sufficient magnitude to constitute a risk of electric shock to persons.



The exclamation point within an equilateral triangle is intended to alert you to the presence of important operating and maintenance (servicing) instructions in the literature accompanying the appliance.

- 1 Read these instructions.
- 2 Keep these instructions.
- 3 Heed all warnings.
- 4 Follow all instructions.
- 5 Do not use this apparatus near water.
- 6 Clean only with dry cloth.
- 7 Do not block any ventilation openings. Install in accordance with the manufacturer’s instructions.
- 8 Do not install near any heat sources such as radiators, heat registers, stoves, or other apparatus (including amplifiers) that produce heat.
- 9 Do not defeat the safety purpose of the polarized or grounding-type plug. A polarized plug has two blades with one wider than the other. A grounding type plug has two blades and a third grounding prong. The wide blade or the third prong are provided for your safety. If the provided plug does not fit into your outlet, consult an electrician for replacement of the obsolete outlet.
- 10 Protect the power cord from being walked on or pinched particularly at plugs, convenience receptacles, and the point where they exit from the apparatus.
- 11 Only use attachments/accessories specified by the manufacturer.
- 12 Use only with the cart, stand, tripod, bracket, or table specified by the manufacturer, or sold with the apparatus. When a cart is used, use caution when moving the cart/apparatus combination to avoid injury from tip-over.
- 13 Unplug this apparatus during lightning storms or when unused for long periods of time.
- 14 Refer all servicing to qualified service personnel. Servicing is required when the apparatus has been damaged in any way, such as power-supply cord or plug is damaged, liquid has been spilled or objects have fallen into the apparatus, the apparatus has been exposed to rain or moisture, does not operate normally, or has been dropped.



FCC INFORMATION (for US customers)

1 IMPORTANT NOTICE: DO NOT MODIFY THIS UNIT!

This product, when installed as indicated in the instructions contained in this manual, meets FCC requirements. Modifications not expressly approved by Yamaha may void your authority, granted by the FCC, to use the product.

2 **IMPORTANT:** When connecting this product to accessories and/or another product use only high quality shielded cables. Cable/s supplied with this product **MUST** be used. Follow all installation instructions. Failure to follow instructions could void your FCC authorization to use this product in the USA.

3 **NOTE:** This product has been tested and found to comply with the requirements listed in FCC Regulations, Part 15 for Class "B" digital devices. Compliance with these requirements provides a reasonable level of assurance that your use of this product in a residential environment will not result in harmful interference with other electronic devices.

This equipment generates/uses radio frequencies and, if not installed and used according to the instructions found in the users manual, may cause interference harmful to the operation of other electronic devices.

Compliance with FCC regulations does not guarantee that interference will not occur in all installations. If this product is found to be the source of interference, which can be determined by turning the unit "OFF" and "ON", please try to eliminate the problem by using one of the following measures:

Relocate either this product or the device that is being affected by the interference.

Utilize power outlets that are on different branch (circuit breaker or fuse) circuits or install AC line filter/s.

In the case of radio or TV interference, relocate/reorient the antenna. If the antenna lead-in is 300 ohm ribbon lead, change the lead-in to coaxial type cable.

If these corrective measures do not produce satisfactory results, please contact the local retailer authorized to distribute this type of product. If you can not locate the appropriate retailer, please contact Yamaha Corporation of America A/V Division, 6600 Orangethorpe Avenue, Buena Park, CA 90620, USA.

The above statements apply **ONLY** to those products distributed by Yamaha Corporation of America or its subsidiaries.

- This device complies with Part 15 of FCC Rules and Industry Canada licence-exempt RSS standard(s).
- Operation is subject to the following two conditions: 1) this device may not cause harmful interference, and 2) this device must accept any interference received including interference that may cause undesired operation.

NOTICE

This equipment has been tested and found to comply with the limits for a Class B digital device, pursuant to part 15 of the FCC Rules. These limits are designed to provide reasonable protection against harmful interference in a residential installation. This equipment generates, uses and can radiate radio frequency energy and, if not installed and used in accordance with the instructions, may cause harmful interference to radio communications. However, there is no guarantee that interference will not occur in a particular installation. If this equipment does cause harmful interference to radio or television reception, which can be determined by turning the equipment off and on, the user is encouraged to try to correct the interference by one or more of the following measures:

- Reorient or relocate the receiving antenna.
- Increase the separation between the equipment and receiver.
- Connect the equipment into an outlet on a circuit different from that to which the receiver is connected.
- Consult the dealer or an experienced radio/TV technician for help.

This equipment complies with FCC/IC radiation exposure limits set forth for an uncontrolled environment and meets the FCC radio frequency (RF) Exposure Guidelines and RSS-102 of the IC radio frequency (RF) Exposure rules. This equipment should be installed and operated keeping the radiator at least 20cm or more away from person's body.

This transmitter must not be co-located or operated in conjunction with any other antenna or transmitter.

COMPLIANCE INFORMATION STATEMENT (DECLARATION OF CONFORMITY PROCEDURE)

Responsible Party: Yamaha Corporation of America A/V Division
Address: 6600 Orangethorpe Avenue, Buena Park, CA 90620
Telephone: 714-522-9011
Type of Equipment: Digital Sound Projector
Model Name: YSP-2700

This device complies with Part 15 of the FCC Rules. Operation is subject to the following conditions:

- 1) this device may not cause harmful interference, and
- 2) this device must accept any interference received including interference that may cause undesired operation.

FOR CANADIAN CUSTOMERS

To prevent electric shock, match wide blade of plug to wide slot and fully insert.
CAN ICES-3 (B)/NMB-3 (B)

CAUTION: READ THIS BEFORE OPERATING YOUR UNIT.

- To assure the finest performance, please read this manual carefully. Keep it in a safe place for future reference.
- Install this sound system in a well ventilated, cool, dry, clean place - away from direct sunlight, heat sources, vibration, dust, moisture, and/or cold. For proper ventilation, allow the following minimum clearances.
Top: 5 cm (2 in), Rear: 5 cm (2 in), Sides: 5 cm (2 in)
- Locate this unit away from other electrical appliances, motors, or transformers to avoid humming sounds.
- Do not expose this unit to sudden temperature changes from cold to hot, and do not locate this unit in an environment with high humidity (i.e. a room with a humidifier) to prevent condensation inside this unit, which may cause an electrical shock, fire, damage to this unit, and/or personal injury.
- Avoid installing this unit where foreign object may fall onto this unit and/or this unit may be exposed to liquid dripping or splashing. On the top of this unit, do not place:
 - Other components, as they may cause damage and/or discoloration on the surface of this unit.
 - Burning objects (i.e. candles), as they may cause fire, damage to this unit, and/or personal injury.
 - Containers with liquid in them, as they may fall and liquid may cause electrical shock to the user and/or damage to this unit.
- Do not cover this unit with a newspaper, tablecloth, curtain, etc. in order not to obstruct heat radiation. If the temperature inside this unit rises, it may cause fire, damage to this unit, and/or personal injury.
- Do not plug in this unit to a wall outlet until all connections are complete.
- Do not operate this unit upside-down. It may overheat, possibly causing damage.
- Do not use force on switches, knobs and/or cords.
- When disconnecting the power cable from the wall outlet, grasp the plug; do not pull the cable.
- Do not clean this unit with chemical solvents; this might damage the finish. Use a clean, dry cloth.
- Only voltage specified on this unit must be used. Using this unit with a higher voltage than specified is dangerous and may cause fire, damage to this unit, and/or personal injury. Yamaha will not be held responsible for any damage resulting from use of this unit with a voltage other than specified.
- To prevent damage by lightning, keep the power cable and outdoor antennas disconnected from a wall outlet or this unit during a lightning storm.
- Do not attempt to modify or fix this unit. Contact qualified Yamaha service personnel when any service is needed. The cabinet should never be opened for any reasons.
- When not planning to use this unit for long periods of time (i.e. vacation), disconnect the AC power plug from the wall outlet.
- Be sure to refer to the "Troubleshooting" section of the Owner's Manual on the CD-ROM for common operating errors before concluding that this unit is faulty.
- Before moving this unit, press ϕ to set it to standby mode and disconnect the AC power plug from the wall outlet.
- Condensation will form when the surrounding temperature changes suddenly. Disconnect the power cable from the outlet, then leave this unit alone.
- When using this unit for a long time, this unit may become warm. Turn the power off, then leave this unit alone for cooling.
- Install this unit near the AC outlet and where the AC power plug can be reached easily.
- The batteries shall not be exposed to excessive heat such as sunshine, fire or the like. When you dispose of batteries, follow your regional regulations.
- Excessive sound pressure from earphones and headphones can cause hearing loss.
- Keep the product out of reach of children to avoid them swallowing small parts.
- Do not put a hand or foreign object into the port on the subwoofer.
- When moving the subwoofer, do not hold the port, as it may cause personal injury and/or damage to this unit.
- Do not place a fragile object near the port of the subwoofer. If the object falls as a result of the air pressure, it may cause personal injury and/or damage to the subwoofer and the object.

This unit is not disconnected from the AC power source as long as it is connected to the wall outlet, even if this unit itself is turned off by ϕ . This state is called the standby mode. In this state, this unit is designed to consume a very small quantity of power.

WARNING

TO REDUCE THE RISK OF FIRE OR ELECTRIC SHOCK, DO NOT EXPOSE THIS UNIT TO RAIN OR MOISTURE.

Do not use this unit within 22 cm (9 inches) of persons with a heart pacemaker implant or defibrillator implant.

Radio waves may affect electro-medical devices.

Do not use this unit near medical devices or inside medical facilities.

The name plate for YSP-CU2700 is located on the bottom of the unit.



Caution

Do not touch the surface marked with this label.
The surface may become hot during operation.

We, Yamaha Music Europe GmbH hereby declare that this unit is in compliance with the essential requirements and other relevant provisions of Directive 1999/5/EC.



Yamaha Music Europe GmbH

Siemensstr. 22-34 25462 Rellingen, Germany
Tel: +49-4101-303-0

■ Notes on remote controls and batteries

- Do not spill water or other liquids on the remote control.
- Do not drop the remote control.
- Do not leave or store the remote control in the following conditions:
 - places of high humidity, such as near a bath
 - places of high temperatures, such as near a heater or stove
 - places of extremely low temperatures
 - dusty places
- Insert the battery according to the polarity markings (+ and -).
- If the batteries grow old, the effective operation range of the remote control decreases considerably. If this happens, replace the batteries with two new ones as soon as possible.
- If the batteries run out, immediately remove them from the remote control to prevent an explosion or acid leak.
- If you find leaking batteries, discard the batteries immediately, taking care not to touch the leaked material. If the leaked material comes into contact with your skin or gets into your eyes or mouth, rinse it away immediately and consult a doctor. Clean the battery compartment thoroughly before installing new batteries.
- Do not use old batteries together with new ones. This may shorten the life of the new batteries or cause old batteries to leak.
- Do not use different types of batteries (such as alkaline and manganese batteries) together. Danger of explosion may happen if batteries are incorrectly replaced. Specification of batteries may be different even though they look the same.
- Before inserting new batteries, wipe the compartment clean.
- Keep batteries away from children. If a battery is accidentally swallowed, contact your doctor immediately.
- When not planning to use the remote control for long periods of time, remove the batteries from the remote control.
- Do not charge or disassemble the supplied batteries.

Information for users on collection and disposal of old equipment and used batteries:



These symbols on the products, packaging, and/or accompanying documents mean that used electrical and electronic products and batteries should not be mixed with general household waste.

For proper treatment, recovery and recycling of old products and used batteries, please take them to applicable collection points, in accordance with your national legislation.



By disposing of these products and batteries correctly, you will help to save valuable resources and prevent any potential negative effects on human health and the environment which could otherwise arise from inappropriate waste handling.



For more information about collection and recycling of old products and batteries, please contact your local municipality, your waste disposal service or the point of sale where you purchased the items.

Information on Disposal in other Countries outside the European Union:



These symbols are only valid in the European Union. If you wish to discard these items, please contact your local authorities or dealer and ask for the correct method of disposal.

Note for the battery symbol (bottom two symbol examples):

This symbol might be used in combination with a chemical symbol. In this case it complies with the requirement set by the EU Battery Directive for the chemical involved.

Pb

■ For U.K. customers

If the socket outlets in the home are not suitable for the plug supplied with this appliance, it should be cut off and an appropriate 3 pin plug fitted. For details, refer to the instructions described below.

Note

The plug severed from the mains lead must be destroyed, as a plug with bared flexible cord is hazardous if engaged in a live socket outlet.

■ Special Instructions for U.K. Model

IMPORTANT

THE WIRES IN MAINS LEAD ARE COLOURED IN ACCORDANCE WITH THE FOLLOWING CODE:

Blue: NEUTRAL

Brown: LIVE

As the colours of the wires in the mains lead of this apparatus may not correspond with the coloured markings identifying the terminals in your plug, proceed as follows:

The wire which is coloured BLUE must be connected to the terminal which is marked with the letter N or coloured BLACK. The wire which is coloured BROWN must be connected to the terminal which is marked with the letter L or coloured RED.

Making sure that neither core is connected to the earth terminal of the three pin plug.

For more detailed information, refer to the Owner's Manual on the CD-ROM. To view the Owner's Manual, click on "English" in the screen displayed automatically when you insert the CD-ROM into your PC, or click on the model name if the screen to select models is displayed, and then click on "English" in the next screen. Then, follow the onscreen instructions. If the screen is not displayed automatically, open the "index.html" in the CD-ROM.

Caution: Do not attempt to play this CD-ROM in an audio player.

The Owner's Manual contained in the CD-ROM can be downloaded from the following website.



<http://download.yamaha.com/>

About this Quick Reference Guide

This Quick Reference Guide provides basic setup to use the unit and feature of the unit.

For more information, refer to the Owner's Manual in the supplied CD-ROM.

Read the safety instructions described in this booklet before using the unit. For instructions on how to operate or set the external devices, refer to documentation supplied with each device.

-  indicates supplementary explanations for better use.
-  indicates precautions for use of the unit and its feature limitations.

Supplied accessories

Before using the unit, make sure you have received all of the following items.

Remote control



Batteries
(AAA, R03, UM-4) (x2)

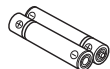

Optical digital audio cable
(1.5 m (4.9 ft))



IntelliBeam microphone
(6 m (19.7 ft))



Cardboard microphone stand

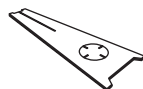

Stands (x2)

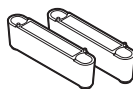

- Owner's Manual CD-ROM

- Quick Reference Guide (this booklet)

- MusicCast Setup Guide

Supplied accessories for SPM-K20

See page 19 in the Owner's Manual.

Spacers (x2)



Pads (x3)



Screws
(M4, 22 mm) (x2)



Mounting template



Devices and cables required for connection

- TV
- BD/DVD player
- HDMI cables (x2)

Preparing remote control

Before installing batteries or using the remote control, be sure to read battery and remote control precautions in this booklet.

Installing the batteries

Press down on the arrow and slide the cover in the direction in which it points.

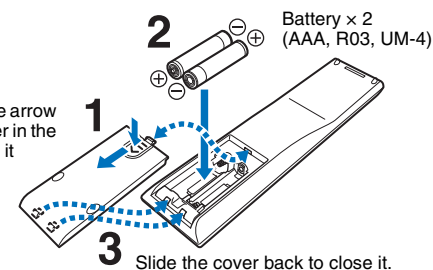

Operation range

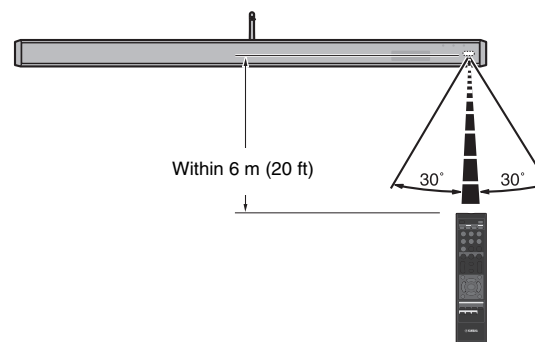

1 Installation

This unit reflects sound beams off of walls to create the surround sound effect. The position of this unit in relation to the listening position and walls is important to achieving the desired surround sound effects. Refer to pages 7 to 9 when installing the unit. When installing this unit on a rack behind which there is limited space, for example, it may be easier to connect external devices to this unit first. This will depend upon the installation location. See page 10 for information regarding the connection of external devices.

Notes

- Be sure to install the center unit on a large, stable stand where it does not fall subject to vibrations, such as from an earthquake, and where it is out of the reach of children.
- The subwoofer speaker is not magnetically shielded. Do not install hard disk drives or similar devices near the subwoofer.
- Do not stack the center unit and subwoofer directly on top of other playback devices, or vice versa. Heat and vibrations may result in damage or malfunction.

Recommended place for installation

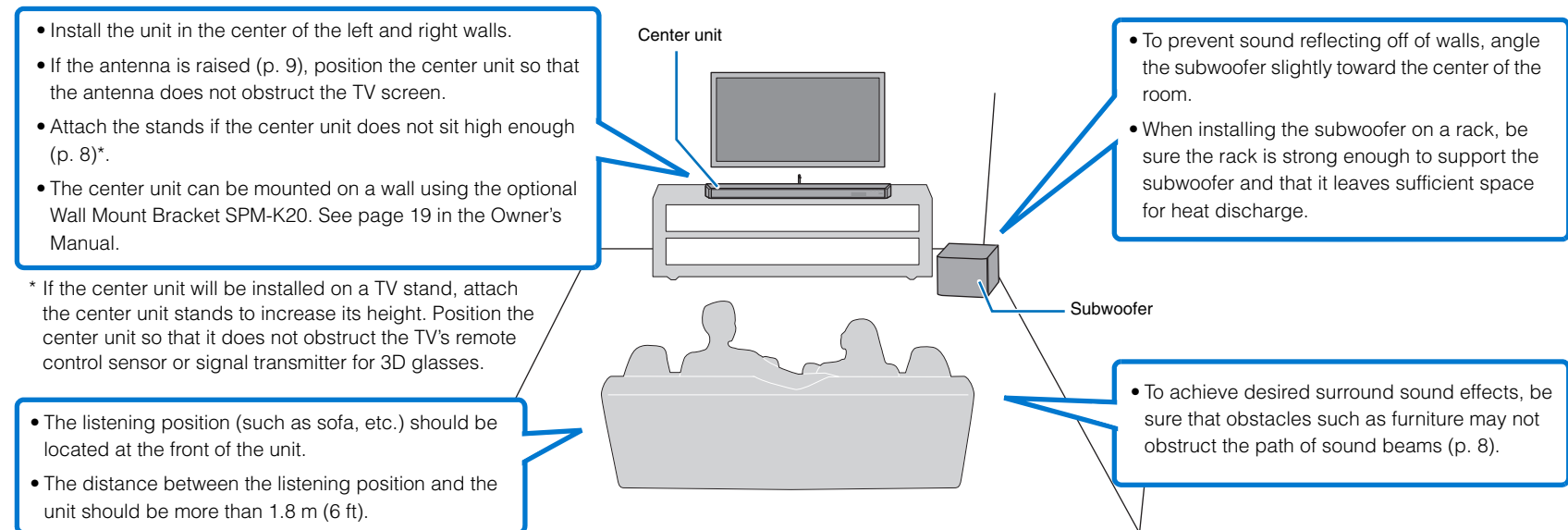

Connecting the center unit and subwoofer via a wireless connection

The center unit and subwoofer communicate wirelessly. Subwoofer performance may be affected if the subwoofer is placed on a metal rack, or if there is a metal plate between the subwoofer and the center unit. Use a wired connection to connect the subwoofer to the center unit if sounds are interrupted due to the installation condition. See page 29 in the Owner's Manual.

Example for installing the unit

This unit outputs sound beam as shown in the illustrations below. Install this unit where there are no obstacles such as furniture obstructing the path of sound beams. Otherwise, the desired surround sound effects may not be achieved.



• See pages 15 to 17 in the Owner's Manual for additional installation examples.

Parallel installation

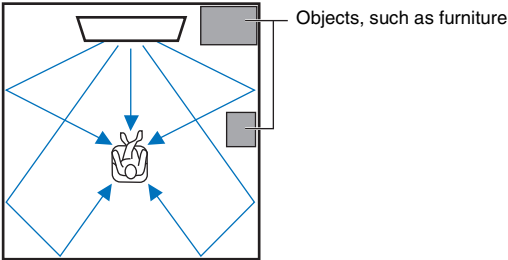

Corner installation

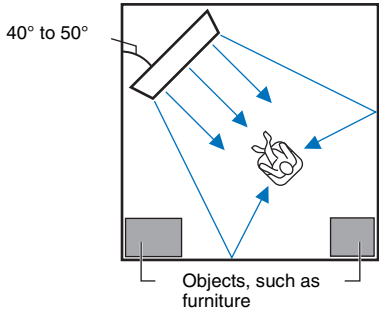

Installing the stands

If the center unit does not sit high enough, attach the stands supplied with the unit to the center unit to increase the height at which it sits.

1 Remove the seal from the stand.

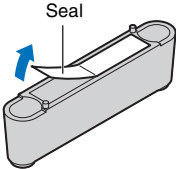

2 Align the protrusions on the stand with, and insert them into, the holes on the rear panel.

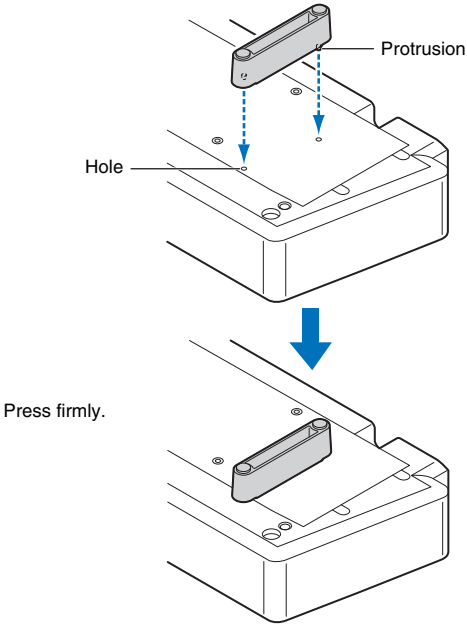

Install the left and right stands.

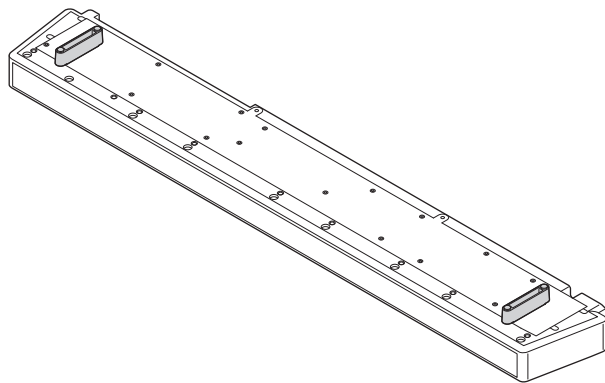

□ Removing the stands

Pull the stands straight out.

■ Raising the antenna

Raise the antenna on the rear panel of the unit when connecting a wireless router (access point) to use a network.

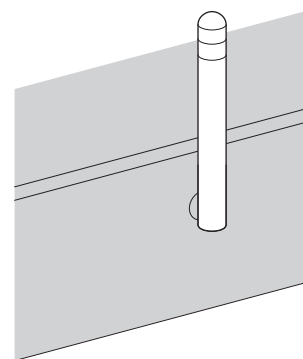

Hold the base of the antenna while raising it to its upright position.



- Do not apply excessive force on the antenna. Doing so may damage it.
- Be sure to check the direction in which the antenna moves, and angle it in the proper direction.
- Do not remove the antenna.



- For details on the wireless connection, refer to page 27 in the Owner's Manual.

2 Connections

Connecting a TV and BD/DVD player

For the cable connection, follow the procedure below.

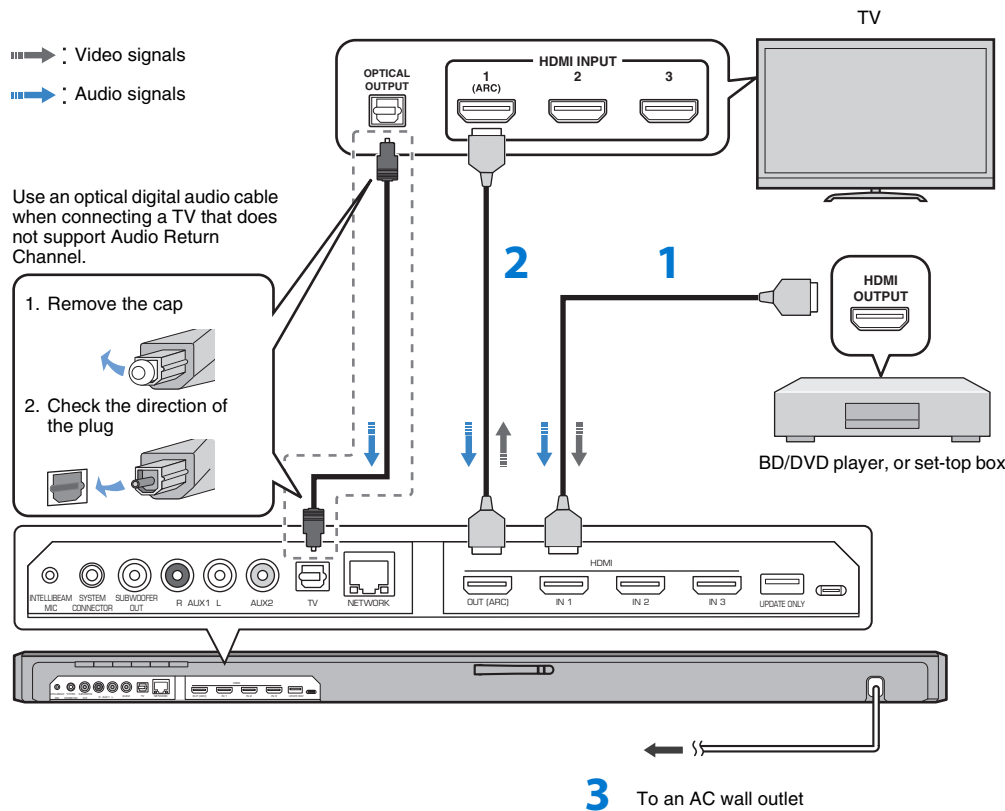

See pages 25 to 26 in the Owner's Manual when connecting other playback devices such as a game console.

1 HDMI cable (optional)

The digital audio/video signals from the BD/DVD player are input to this unit.



- This unit supports HDCP version 2.2, a copy protection technology.

2 HDMI cable (optional)

Digital video from the BD/DVD player is displayed on the TV.



- Connect the unit to the HDMI input jack (one compatible with HDCP 2.2) on an HDCP 2.2-compliant TV to enjoy playback of 4K video.

3 Power cable

Plug the unit's power cable into an AC wall outlet after all the connections are complete.



Audio Return Channel (ARC) supported TV

- Connect an HDMI cable to the audio return channel supported jack (the jack with "ARC" indicated) on TV.
- Enable the HDMI control function of this unit to activate the Audio Return Channel (ARC). See page 80 in the Owner's Manual.

What is Audio Return Channel (ARC)?

- In order for the unit to play audio from a TV, the TV must usually be connected to the unit via an audio cable as well as an HDMI cable. If, however, the TV supports Audio Return Channel (ARC), TV audio signals can be input to the unit via the HDMI cable that outputs video signals from the unit to the TV.

For a wired network connection, connect one end of the network cable to the NETWORK jack on the rear panel of the unit and the other end to a router. For details, see page 27 in the Owner's Manual.

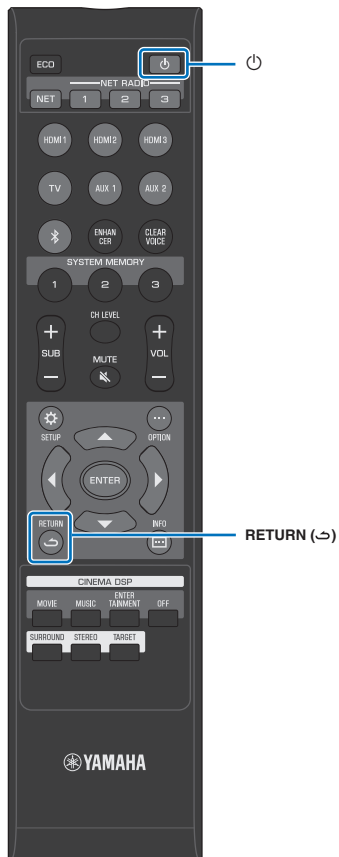

3 Turning on the unit

This section explains wireless connection of the center unit and subwoofer, and methods for connecting this unit to a network.

Connecting the subwoofer wirelessly

Plug the subwoofer's power cable into a wall outlet. When the center unit is turned on, the center unit and subwoofer are automatically connected via wireless connection.

1 Plug the subwoofer's power cable into an AC wall outlet.

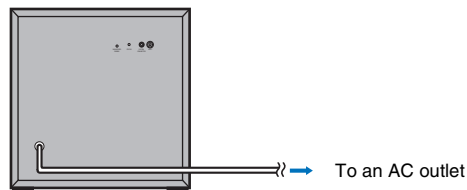

2 Press the ⏻ key to turn on the unit.

STATUS indicator
Glow green

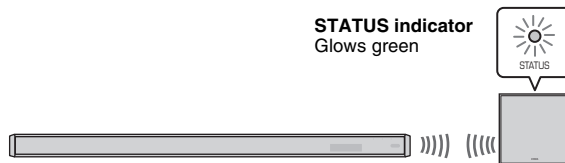

- If the STATUS indicator does not glow properly the first time the unit is turned on, pair the center unit and subwoofer manually. See "Pairing the center unit and subwoofer" (page 105 in the Owner's Manual).

Screen displayed on a TV when the unit is turned on

When the unit is turned on for the first time after purchase, the screen shown at right will be displayed on the TV. ("ViewScreen" is shown in the front panel display.)



- When the screen is not displayed, use the input button on the TV's remote control to switch input so that video input from this unit is displayed. When this unit is connected to the TV as shown on page 10, select "HDMI 1".
- The language used for menu display (OSD Language) can be selected from the screen shown above. Use the ◀▶ key to select the language, and follow the on-screen instructions. The OSD language can also be changed from the setup menu at any time. Press and hold the SETUP (⚙) key until the "OSD Language" menu is displayed on the TV, and use the ▲/▼ key to select the language. Press the SETUP (⚙) key to exit the setup menu.

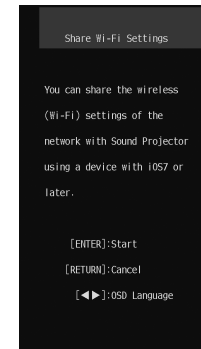

Follow the on-screen instructions to use an iOS device (iPhone, etc.) to connect the unit to a wireless network.

Connecting the unit to a wireless network is simpler when the MusicCast CONTROLLER app* installed on your mobile device is used. Press the RETURN (←) key to cancel this screen, and then refer to "Connecting with the MusicCast CONTROLLER app (registering the unit as a MusicCast-enabled device)".

* MusicCast CONTROLLER is a free app for mobile devices.



- This screen will not be displayed if the unit is connected to a router via its NETWORK jack (wired connection).
- See page 50 in the Owner's Manual for more information regarding networks.

Connecting with the MusicCast CONTROLLER app (registering the unit as a MusicCast-enabled device)

Install the MusicCast CONTROLLER app on your mobile device to connect the unit to a network and register it as a MusicCast-enabled device.

When the unit is connected to a network, Internet radio stations or music files on your computer (media server) can be played using the MusicCast CONTROLLER app.



- Confirm that your mobile device is connected to your home router before beginning.
- This section uses MusicCast CONTROLLER app screens displayed on an iPhone as examples.
- MusicCast CONTROLLER app screens and menu labels are subject to change without prior notice.

1 Install the MusicCast CONTROLLER app on your mobile device, and open the app.

Search for “MusicCast CONTROLLER” on the App Store or Google Play.

2 Tap “Setup”.

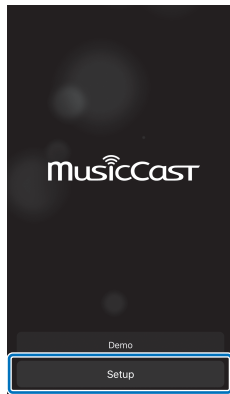

3 Turn on the unit, and then tap “Next”.

4 Hold down the CONNECT key on the unit until “CONNECT” is displayed on the front panel display.



- When a screen like that below is displayed, follow the on-screen instructions to configure network settings.

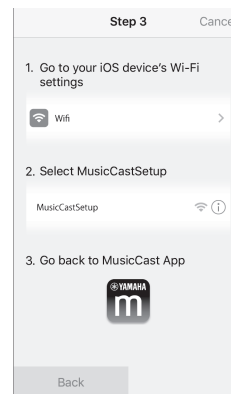

1. Use the Home button on your mobile device to return to the Home screen.
2. Select “Wi-Fi” from “Settings”.
3. Select “MusicCastSetup” from “CHOOSE A NETWORK...”.
4. Use the Home button to return to the MusicCast CONTROLLER app.

- When a screen like that at left below is displayed, select the network to which the unit will be connected and enter the router's password.

The router's password is often noted on the router itself. Refer to documentation supplied with the router for details.

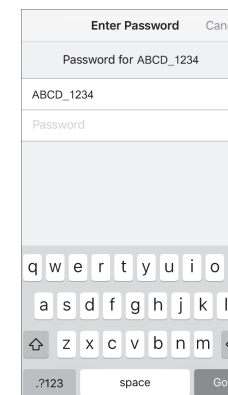
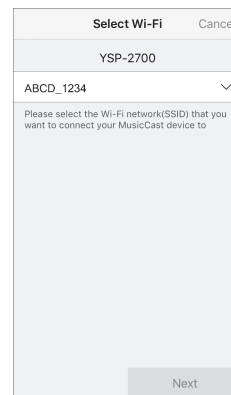

5 To register the unit as a MusicCast-enabled device, configure the following items.

- Location name (“home”, “John’s house”, etc.)
- Name and photo of the room where the unit is installed

The location name, and the name and photo of the room where the unit is installed can be changed later.

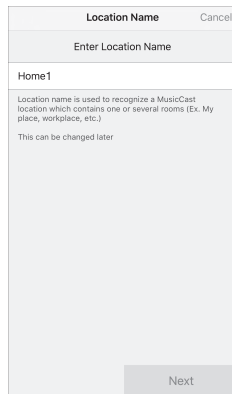

Network connection with the MusicCast CONTROLLER app is now complete, and the unit has been registered as a MusicCast-enabled device.



- If a different MusicCast-enabled device is already registered with the MusicCast CONTROLLER app, tap  (Setup) in the room selection screen, and then select “Add New Device” to add the unit to the app.

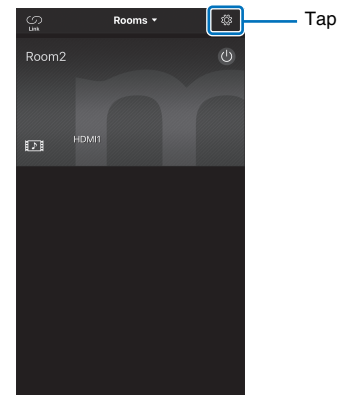

4 Auto setup for appropriate surround effects (IntelliBeam)

First use the “IntelliBeam” function to adjust each channel so that this unit provides the optimal viewing and listening environment.



- Do not connect the IntelliBeam microphone to an extension cable as doing so may result in an inaccurate sound optimization.

Installing the IntelliBeam microphone

1 Assemble the supplied cardboard microphone stand, and then position the IntelliBeam microphone.

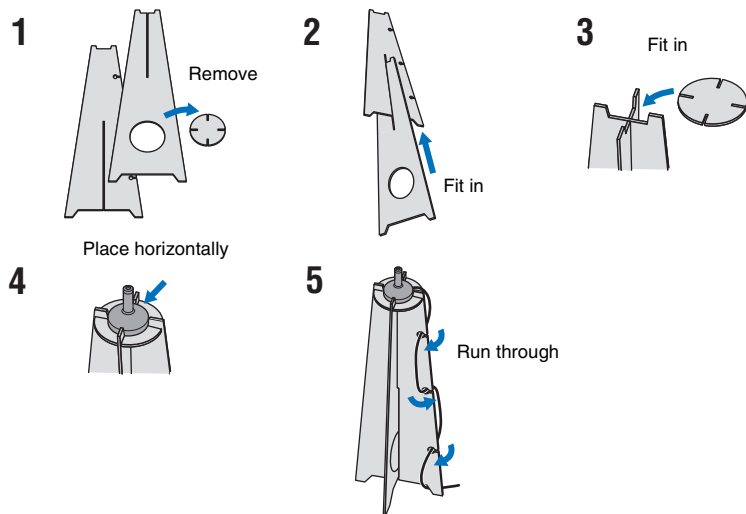

2 Position the supplied cardboard microphone stand and IntelliBeam microphone at your listening position.



- Position the IntelliBeam microphone at the same height as your ears would be when you are seated.
- Position the IntelliBeam microphone so that it is parallel with the floor.
- A camera tripod or stool may also be used instead of the supplied cardboard microphone stand.

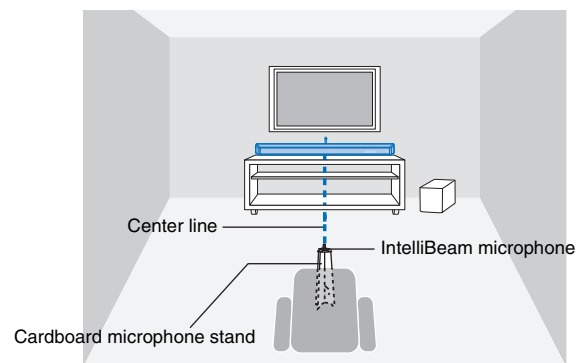
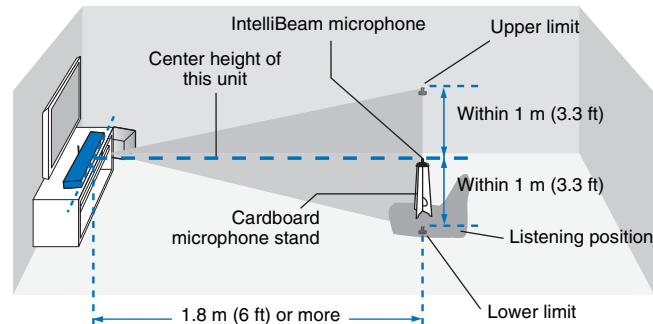

Make sure that there are no obstacles between the IntelliBeam microphone and the walls in your listening room as these objects obstruct the path of sound beams. However, any objects that are in contact with the walls will be regarded as a protruding part of the walls.

Using AUTO SETUP (IntelliBeam)



- Test tones output during measurement are loud. Perform AUTO SETUP when no children are around and there is no possibility of their entering the listening room, as their hearing may be impaired.
- If there are curtains in your listening room, we recommend following the procedure below.
 1. Open the curtains to improve sound reflection.
 2. Run “Beam optimize only” (page 35 in the Owner’s Manual).
 3. Close the curtains.
 4. Run “Sound optimize only” (page 35 in the Owner’s Manual).
- Make sure that your listening room is as quiet as possible. For accurate measurement, turn off air conditioner or other devices that make noises.

1 Turn the unit and your TV on.

2 Switch TV input to the input jack (HDMI 1, etc.) to which this unit is connected (page 30 in the Owner’s Manual).

3 Connect the IntelliBeam microphone to the INTELLIBEAM MIC jack on the rear panel of the unit.

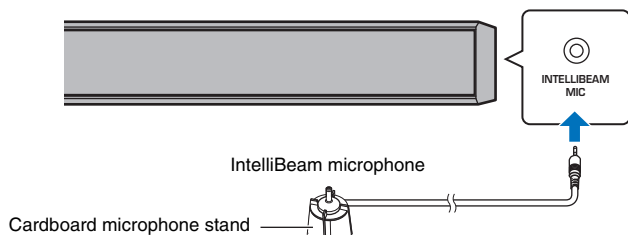

The screen below is displayed after connecting IntelliBeam microphone to the unit.

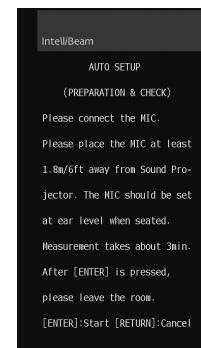

“AUTO SETUP” in the “IntelliBeam” menu can automatically adjust the following two settings.

Beam optimize only	This feature optimizes the beam angle so that the parameter best matches your listening environment.
Sound optimize only	This feature optimizes sound quality for each channel by measuring the acoustic characteristics of the listening environment.

“Beam optimize only” or “Sound optimize only” can be measured separately in the setup menu (page 35 in the Owner’s Manual).



- Follow the instructions below and then leave the room. If you remain in the room, you may obstruct the beam, or the microphone may pickup any sounds you make, possibly resulting in improper measurement.

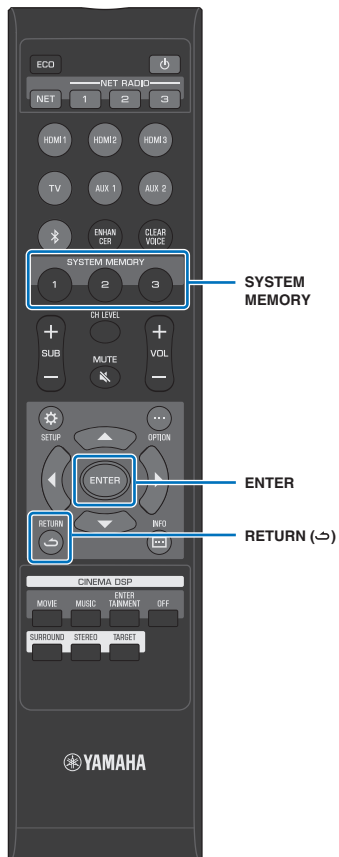

4 Press the ENTER key to start the AUTO SETUP procedure and then leave the room within 10 seconds.



The screen changes automatically as measurement progresses.

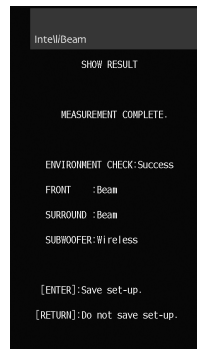

If the AUTO SETUP procedure is complete, this unit rings the chimes.



- The AUTO SETUP procedure takes about 3 minutes.
- To cancel the AUTO SETUP procedure after it is started, or if you do not want to apply the results, press the RETURN (↩) key.
- If an error occurs, an error buzzer sounds and an error message is displayed. For details on error messages, see page 36 in the Owner's Manual.

5 Press the ENTER key.

The measurement results are applied and saved in the unit.



- You can save several measurement results by pressing the SYSTEM MEMORY 1, 2, or 3 key. When the SYSTEM MEMORY 1 key is pressed, “M1 Saving” is displayed, and settings are saved.
- If ambient noise is picked up after measurement begins, an error message is displayed in the “AUTO SETUP COMPLETE” screen prompting you to begin measurement again. Press the ENTER key to exit the error message screen, and begin measurement again.



- See page 46 in the Owner's Manual for more information on the system memory function.

6 Remove the IntelliBeam microphone.

The “AUTO SETUP COMPLETE” screen closes.

The IntelliBeam microphone is sensitive to heat, so should not be placed anywhere where it could be exposed to direct sunlight or high temperatures (such as on top of AV equipment).

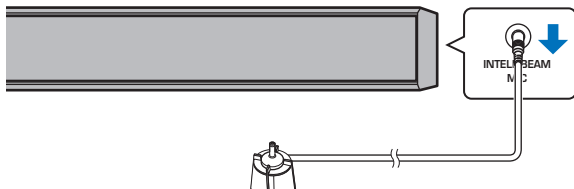



5 Playback

Enjoying TV

1 Select the desired TV channel.

2 Press the TV key.



- When audio is output from the TV speaker, set TV's audio output to an option (output to the unit) other than TV. Refer to documentation supplied with TV for more information.
- **HDMI control function**
You can use the TV remote control to operate this unit if your TV supports the HDMI control function. See page 37 in the Owner's Manual.

Playing a DVD or BD

The following explains the playback procedure when this unit is connected to the TV and BD/DVD player as shown in "Connecting a TV and BD/DVD player" (p. 10).

1 Turn on the TV and BD/DVD player connected to this unit.

2 Press the HDMI 1 key to select the BD/DVD player as the input source.



3 Use the TV's remote control to switch the TV's input to HDMI 1.

4 Play back a DVD or BD.

5 Press the VOL (+/-) key to adjust the volume.

6 Press the SURROUND, STEREO, or TARGET key according to your preferences.

See page 40 in the Owner's Manual for details.



When this unit does not play back, check the following

- The unit and BD/DVD player are connected correctly.
- The audio output settings of the BD/DVD player is set to digital sound output (bitstream).
- The TV's input is switched to this unit.



CINEMA DSP

SURROUND

Playback with surround sound

5-channel sound beams create a sound field for surround sound playback.

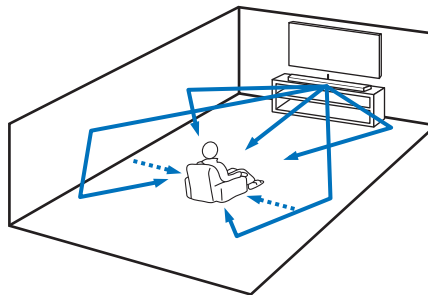

← Sound beams

← Channels created from the front and rear sound beams

- 1 Press the **SURROUND** key to switch to surround mode.

“SURROUND” is shown in the front panel display.

SURROUND

Enjoying three-dimensional surround sound (CINEMA DSP)

Select the desired CINEMA DSP program according to the audio source and your preferences. Yamaha’s exclusive sound field reproduction technology (CINEMA DSP) easily reproduces realistic sound fields comparable to those found in movie theaters and concert halls, allowing users to enjoy a natural and three-dimensional listening environment.

- 1 Press the **SURROUND** key to enable surround playback mode.
- 2 Press the **CINEMA DSP (MOVIE, MUSIC, or ENTERTAINMENT)** key repeatedly to select the desired program.

The CINEMA DSP program name is shown in the front panel display.



- Press the OFF key to disable CINEMA DSP. Audio content is played in surround mode.
- Refer to page 41 in the Owner’s Manual for more information.

The unit is equipped with a number of other functions not described in this booklet. See the Owner’s Manual for details.

**Important Notice: Guarantee Information for
customers in EEA* and Switzerland****English**

For detailed guarantee information about this Yamaha product, and Pan-EEA* and Switzerland warranty service, please either visit the website address below (Printable file is available at our website) or contact the Yamaha representative office for your country. *EEA:European Economic Area

<http://europe.yamaha.com/warranty/>

Yamaha Global Site
<http://www.yamaha.com/>

Yamaha Downloads
<http://download.yamaha.com/>

Manual Development Group
© 2016 Yamaha Corporation

Published 06/2016 KS-A0
Printed in Indonesia

ZV06820

Free Manuals Download Website

<http://myh66.com>

<http://usermanuals.us>

<http://www.somanuals.com>

<http://www.4manuals.cc>

<http://www.manual-lib.com>

<http://www.404manual.com>

<http://www.luxmanual.com>

<http://aubethermostatmanual.com>

Golf course search by state

<http://golfingnear.com>

Email search by domain

<http://emailbydomain.com>

Auto manuals search

<http://auto.somanuals.com>

TV manuals search

<http://tv.somanuals.com>