

MASSIVELY
mini
MEDIA

Docking Station



CAUTION: ELECTRICALLY OPERATED PRODUCT:

Not recommended for children under 8 years of age. As with all electric products, precautions should be observed during handling and use to prevent electric shock.

AC Adaptor Specifications:

Model Number = TPCA - 050050U2

Input = 120V AC ~60Hz

Output = 5V DC

Current = 500mA

NOTE: Your AC Power Adaptor should be periodically examined for potential hazards and used with floor or wall receptacles only. If any potential hazards are found, please contact Tiger Electronics Consumer Affairs at 1-800-844-3733 or PO Box 200, Pawtucket, RI, 02862-0200 for repair or replacement.

FCC STATEMENT - This device complies with part 15 of the FCC Rules. Operation is subject to the following two conditions: (1) This device may not cause harmful interference, and (2) this device must accept any interference received, including interference that may cause undesired operation. Warning: Changes or modifications to this unit not expressly approved by the party responsible for compliance could void the user's authority to operate the equipment. This equipment has been tested and found to comply with the limits for a Class B digital device, pursuant to Part 15 of the FCC Rules. These limits are designed to provide reasonable protection against harmful interference in a residential installation. This equipment generates, uses and can radiate radio frequency energy, and, if not installed and used in accordance with the instructions, may cause harmful interference to radio communications. However, there is no guarantee that interference will not occur in a particular installation. If this equipment does cause harmful interference to radio or television reception, which can be determined by turning the equipment off and on, the user is encouraged to try to correct the interference by one or more of the following measures:

- Reorient or relocate the receiving antenna.
- Increase the separation between the equipment and the receiver.
- Consult the dealer or an experienced radio/TV technician for help.
- Connect the equipment into an outlet on a circuit different from that to which the receiver is connected.

Shielded cables must be used with this unit to ensure compliance with the Class B FCC limits.

© 2006 Hasbro. All Rights Reserved.
TM & ® denote U.S. Trademarks.
76885 PN 6632180000

TIGER
ELECTRONICS™
Where Technology Comes to Play!™



Note: The power adaptor should be used with floor or wall receptacles only.

PN 6643680000

THE MASSIVELY
SMALL MEDIA PLAYER

MASSIVELY
mini™
MEDIA

Drop your massively
mini™ MEDIA player into
the Docking Station
and enjoy your media!

docking station

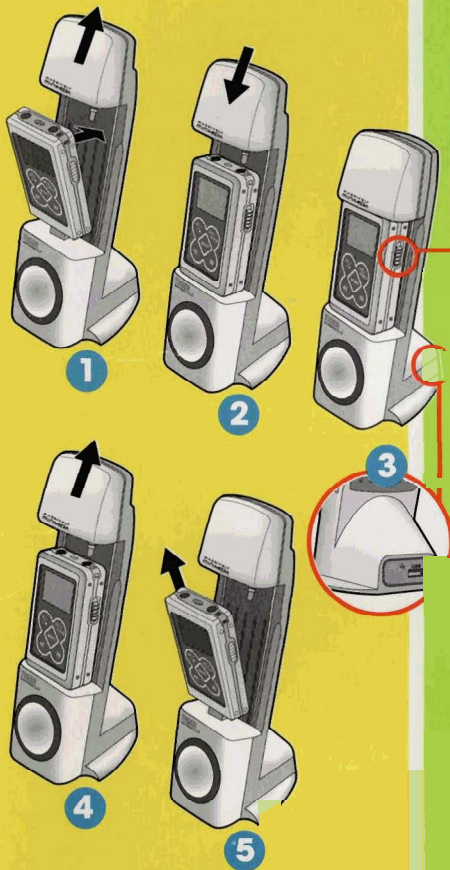

Major sound for your player!

on/off switch

- 1 Slide the Docking Station top up and insert your massively mini™ MEDIA player bottom first, lining up the USB port.
- 2 Slide the Docking Station top down and snap it into place, making sure the headphone jack lines up with the player.
- 3 Use the USB cable/AC Adaptor to connect the Docking Station to either an electric outlet or a computer, for viewing or charging. Switch your massively mini™ MEDIA player on, using the on/off switch on the side of the player. Adjust volume and choose functions on the player.
- 4 To remove the player, slide the Docking Station top up...
...and gently lift the player up, then out, as shown.

If your massively mini™ MEDIA player is in the Docking Station, connected either to an electric outlet or to a computer, it will recharge, even when not turned on. The player will also recharge during use.

© 2006 Hasbro, Pawlucket, RI 02862 USA. All Rights Reserved. TM & ® denote U.S. Trademarks. Hasbro Canada, Longueuil, QC, Canada J4G 1G2. Please retain our address for future reference. Product and colors may vary. Patent Pending.
MADE IN CHINA

P/N 6607110000

visit

tigerelectronics.com

Questions? Call 1-800-844-3733

TIGER
ELECTRONICS™



Free Manuals Download Website

<http://myh66.com>

<http://usermanuals.us>

<http://www.somanuals.com>

<http://www.4manuals.cc>

<http://www.manual-lib.com>

<http://www.404manual.com>

<http://www.luxmanual.com>

<http://aubethermostatmanual.com>

Golf course search by state

<http://golfingnear.com>

Email search by domain

<http://emailbydomain.com>

Auto manuals search

<http://auto.somanuals.com>

TV manuals search

<http://tv.somanuals.com>