

Accton

Making Partnership Work

Zilla Dual-Speed Hub-3008R Quick Installation Guide



Introduction

Accton's Zilla Hub is a compact dual-speed hub featuring 8 10BASE-T/100BASE-TX auto-sensing ports. This hub is completely plug and play, no configuration necessary. This dual-speed hub contains two internal repeater buses – one for 10Mbps traffic and another for 100Mbps traffic. Traffic passing between attached devices that operate at the same speed is confined within the appropriate repeater bus.

The components of the Zilla Hub are shown in the figure below:

Daisy-Chain Switch

One slide-switch to change Port 8 from station port (computer) to cascade port (hub).

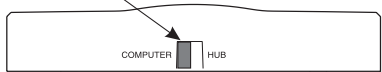

Status Indicators Link/Activity

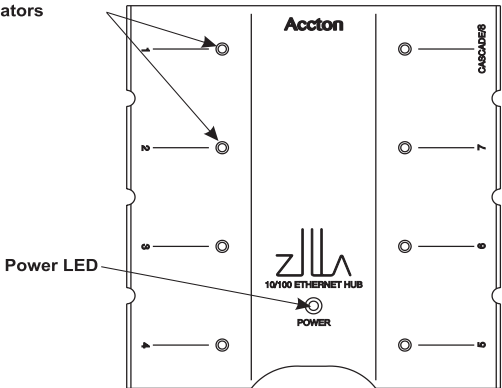

Power LED

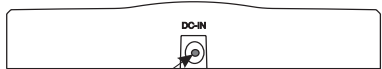

Power Socket

Only use the power adapter supplied with this hub.

Check the Package

The Zilla Hub includes:

- 1 Zilla Hub
- 1 DC Power Adapter
- This user guide
- 1 registration card (please return)

RJ-45 Connectors

Accton's Zilla Hub features 8 10BASE-T/100BASE-TX ports with RJ-45 connectors located on the side panel of the hub. Ports 1-8 are (computer) station ports. To connect to a workstation or server, attach straight-through unshielded or shielded twisted-pair cabling to any station port on this hub.

Port 8 doubles as a station (computer) port and a cascade (uplink) port. The cascade port makes it convenient to connect cable from the hub to a station port on another hub or a switch.

Mount the Hub

The Zilla Hub can be placed directly on your desktop or stuck to a metallic vertical surface (using the magnetic foot pads on the bottom of the hub).

Before you start installing the hub, be sure you find a suitable location at the center of the devices you want to link and near a power outlet.

Connect PCs to the Hub

1. Remove the rubber cover from an RJ-45 port.

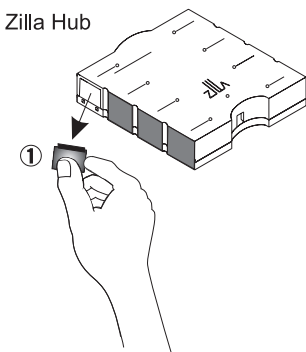

2. Install a 10 or 100 Mbps (10BASE-T or 100BASE-TX) network adapter card and driver in each computer you want to network.
3. Prepare straight-through twisted-pair cables with RJ-45 plugs. Attach one end of the cable to the RJ-45 port of the computer's network adapter card and the other end to any available port on the hub.

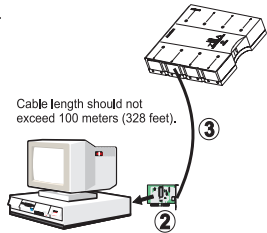

Notes: If you are using port 8, be sure the Daisy-Chain switch is set to "COMPUTER."

Cascade Devices to the Hub

If you need more ports, connect a station port on another device to the cascade port on the Zilla hub with straight-through twisted-pair cable, maximum 5 meters (19.68 feet).

1. To make a direct connection to another compatible hub or switch, use the RJ-45 cascade port 8. Set the port selection switch to HUB and then connect to any station port on the other device. Alternatively, you can connect from any RJ-45 station port on the hub to an uplink port on the other device.
2. Prepare straight-through shielded or unshielded twisted-pair cables with RJ-45 plugs at both ends. Use 100 Ω Category 3, 4 or 5 cable for standard 10Mbps Ethernet connections, or 100 Ω Category 5 cable for 100Mbps Fast Ethernet connections. When inserting an RJ-45 plug, be sure the tab on the plug clicks into position to ensure that it is properly seated.

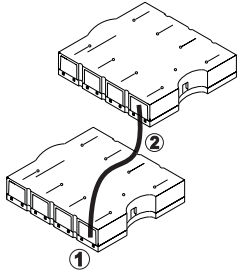

- Notes:**
1. Make sure each twisted-pair cable does not exceed 100 meters (328 feet).
 2. To connect to another hub or switch, you may also attach to station ports at both ends if you use crossover cabling.

Verify System Operation

Check each connection by viewing the port status indicators shown in the following table. The hub monitors the link status for each port. If the Port indicator fails to light when you connect a device to the hub, follow the troubleshooting advice detailed in the next section.

| Port and Hub Status LEDs | | |
|--------------------------|-----------|--|
| LEDs | Condition | Status |
| Power | On | Hub is receiving power. |
| Link | On | Port has established a valid 10/100 Mbps network connection. |
| Activity | Flashing | Traffic is traversing the port. |

Troubleshooting

Symptom: Power LED does not light after power on.

Cause: Power outlet or power cord may be defective.

Solution:

1. Check for loose connections.
2. Check the power outlet by using it for another device.
3. Replace the power cord.

Symptom: Port LED does not light after connection is made.

Cause: Hub port, network card or cable may be defective.

Solution:

1. Check that the hub and attached device are both powered on.
2. Be sure the network cable is connected to both devices.
3. Verify that Category 5 cable is used for 100Mbps connections and that the length of any cable does not exceed 100 meters (328 feet).
4. Check the network card and cable connections for defects.
5. Replace the defective card or cable if necessary.

Application Diagram

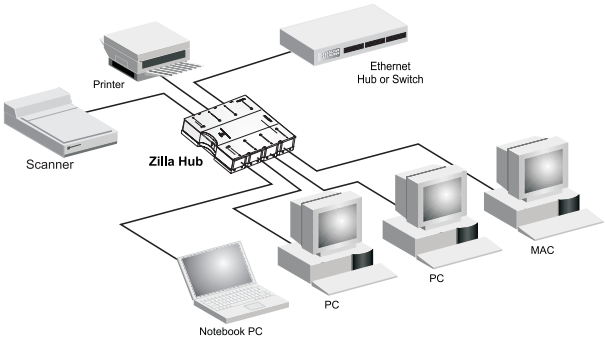

Specifications

| | |
|-----------------------|---|
| Standards Conformance | IEEE 802.3 10BASE-T, IEEE 802.3u 100BASE-TX |
| Number of Ports | 8 10/100 Mbps RJ-45 ports (one of which serves as a daisy-chain port) |
| Network Interface | RJ-45: 100 Ω , UTP cable 10BASE-T: Category 3, 4 or 5 100BASE-TX: Category 5 |
| Switching Method | Store-and-forward |
| MAC Address Table | 2K entries per system |
| Memory Buffer | 128 Kbytes per system |
| Filtering Rate | Line speed |
| Forwarding Rate | 14,810 pps (at 10 Mbps), 148,810 pps (at 100 Mbps) |
| Learning Rate | Line speed |
| Dimensions | 90 x 97.5 x 24 mm |
| Weight | 160 gm |
| Power Requirements | 10 VDC,0.6 A (from external power adapter) |
| Power Consumption | 6 Watts maximum |
| Heat Dissipation | 20.5 BTU/hr |
| Maximum Current | 0.6 A @ 10 VDC |
| Access Method | CSMA/CD, 10 Mbps and 100 Mbps |
| Status LEDs | Power, Link, Activity |
| Environmental | |
| Temperature | 0°C to 40°C -40° - 70°C / -40° - 158°F (storage) |
| Humidity | IEC721-2-1, 10% to 85% (non-condensing) |
| Certification | CE Mark |
| Emissions | FCC Class B, VCCI Class B, CISPR 22 Class B, EN55022 Class B |
| Safety | CSA/NRTL, TÜV/GS,CB |

Certification

FCC Class B Certification

This device complies with Part 15 of the FCC Rules. Operation is subject to the following conditions:

1. This device may not cause harmful interference, and
2. This device must accept any interference received, including interference that may cause undesired operation.

Warning: This equipment has been tested and found to comply with the limits for a Class B digital device, pursuant to Part 15 of the FCC Rules. These limits are designed to provide reasonable protection against harmful interference in a residential installation. This equipment generates, uses and can radiate radio frequency energy and, if not installed and used in accordance with the instructions, may cause harmful interference to radio communications. However, there is no guarantee that interference will not occur in a particular installation. If this equipment does cause harmful interference to radio or television reception, which can be determined by turning the equipment off and on, the user is encouraged to try to correct the interference by one or more of the following measures:

- Reorient or relocate the receiving antenna
- Increase the separation between the equipment and receiver
- Connect the equipment into an outlet on a circuit different from the one which the receiver is connected to
- Consult the dealer or an experienced radio/TV technician for help

You are cautioned that changes or modifications not expressly approved by the party responsible for compliance could void your authority to operate the equipment.

Note: In order to maintain compliance with the limits of a Class B digital device, Accton requires that you use a quality interface cable when connecting to this device. Changes or modifications not expressly approved by Accton could void your authority to operate this equipment. Suggested cable type is unshielded or shielded (UTP/STP) cable – Category 3 or greater for 10Mbps connections, and Category 5 for 100Mbps connections.

Class B (Canada Department of Communications)

This digital apparatus does not exceed the Class B limits for radio noise emissions from digital apparatus as set out in the interference-causing equipment standard entitled "Digital Apparatus", ICES-003 of the Department of Communications.

Cet appareil numérique respecte les limites de bruits radioélectriques applicables aux appareils numériques de Classe B prescrites dans la norme sur le matériel brouilleur: "Appareils Numériques", NMB-003 édictée par le ministère des Communications.

VCCI Class B Compliance (Japan)

この装置は、情報処理装置等電波障害自主規制協議会（VCCI）の基準に基づくクラスB情報技術装置です。この装置は、家庭環境で使用することを目的としていますが、この装置がラジオやテレビジョン受信機に近接して使用されると受信障害を引き起こすことがあります。

取り扱い説明書に従って正しい取り扱いをして下さい。

CE Mark Declaration of Conformance (for EMI and Safety - Europe)

This is to certify that this product complies with ISO/IEC Guide 22 and EN45014. It conforms to the following specifications:

| | |
|-----------------------------------|--|
| EMC: EN55022(1988)/CISPR-22(1985) | class B |
| EN60555-2(1995) | class B |
| EN60555-3 | |
| IEC1000-4-2(1995) | 4kV CD, 8kV AD |
| IEC1000-4-3(1995) | 3V/m |
| IEC1000-4-4(1995) | 1kV - (power line), 0.5kV - (signal line) |
| IEC1000-4-6(1995) | 3Vrms |

This product complies with the requirements of the Low Voltage Directive 73/23/EEC and the EMC Directive 89/336/EEC.

Warning! Do not plug a phone jack connector in the RJ-45 port. This may damage this device. Les raccordeurs ne sont pas utilisé pour le système téléphonique!

Wichtige Sicherheitshinweise (German Safety Statement)

1. Bitte lesen Sie diese Hinweise sorgfältig durch.
2. Heben Sie diese Anleitung für den späteren Gebrauch auf.
3. Vor jedem Reinigen ist das Gerät vom Stromnetz zu trennen. Verwenden Sie keine Flüssigoder Aerosolreiniger. Am besten eignet sich ein angefeuchtetes Tuch zur Reinigung.
4. Die Netzanschlußsteckdose soll nahe dem Gerät angebracht und leicht zugänglich sein.
5. Das Gerät ist vor Feuchtigkeit zu schützen.
6. Bei der Aufstellung des Gerätes ist auf sicheren Stand zu achten. Ein Kippen oder Fallen könnte Beschädigungen hervorrufen.
7. Die Belüftungsöffnungen dienen der Luftzirkulation, die das Gerät vor Überhitzung schützt. Sorgen Sie dafür, daß diese Öffnungen nicht abgedeckt werden.
8. Beachten Sie beim Anschluß an das Stromnetz die Anschlußwerte.
9. Verlegen Sie die Netzanschlußleitung so, daß niemand darüber fallen kann. Es sollte auch nichts auf der Leitung abgestellt werden.
10. Alle Hinweise und Warnungen, die sich am Gerät befinden, sind zu beachten.
11. Wird das Gerät über einen längeren Zeitraum nicht benutzt, sollten Sie es vom Stromnetz trennen. Somit wird im Falle einer Überspannung eine Beschädigung vermieden.
12. Durch die Lüftungsöffnungen dürfen niemals Gegenstände oder Flüssigkeiten in das Gerät gelangen. Dies könnte einen Brand bzw. elektrischen Schlag auslösen.
13. Öffnen sie niemals das Gerät. Das Gerät darf aus Gründen der elektrischen Sicherheit nur von autorisiertem Servicepersonal geöffnet werden.
14. Wenn folgende Situationen auftreten ist das Gerät vom Stromnetz zu trennen und von einer qualifizierten Servicestelle zu überprüfen:
 - a. Netzkabel oder Netzstecker sind beschädigt.
 - b. Flüssigkeit ist in das Gerät eingedrungen.
 - c. Das Gerät war Feuchtigkeit ausgesetzt.
 - d. Wenn das Gerät nicht der Bedienungsanleitung entsprechend funktioniert oder Sie mit Hilfe dieser Anleitung keine Verbesserung erzielen.
 - e. Das Gerät ist gefallen und/oder das Gehäuse ist beschädigt.
 - f. Wenn das Gerät deutliche Anzeichen eines Defektes aufweist.
15. Stellen Sie sicher, daß die Stromversorgung dieses Gerätes nach der EN 60950 geprüft ist. Ausgangswerte der Stromversorgung sollten die Werte von AC 7,5-8V, 50-60Hz nicht über oder unterschreiten sowie den minimalen Strom von 1A nicht unterschreiten.

Der arbeitsplatzbezogene Schalldruckpegel nach DIN 45 635 Teil 1000 beträgt 70dB(A) oder weniger.

Warranty

Accton warrants to the original owner that the product delivered in this package will be free from defects in material and workmanship for a period of three (3) years from the date of purchase from Accton or its authorized reseller. For the warranty to apply, you must register your purchase by returning the registration card indicating the date of purchase and including proof of purchase. There will be a minimal charge to replace consumable components, such as fuses, power transformers, and mechanical cooling devices. The warranty does not cover the product if it is damaged in the process of being installed. Accton recommends that you have the company from whom you purchased this product install it.

THE ABOVE WARRANTY IS IN LIEU OF ANY OTHER WARRANTY, WHETHER EXPRESS, IMPLIED OR STATUTORY, INCLUDING BUT NOT LIMITED TO ANY WARRANTY OF MERCHANTABILITY, FITNESS FOR A PARTICULAR PURPOSE, OR ANY WARRANTY ARISING OUT OF ANY PROPOSAL, SPECIFICATION OR SAMPLE. ACCTON SHALL NOT BE LIABLE FOR INCIDENTAL OR CONSEQUENTIAL DAMAGES. ACCTON NEITHER ASSUMES NOR AUTHORIZES ANY PERSON TO ASSUME FOR IT ANY OTHER LIABILITY.

Copyright

Copyright © 2000 by Accton Technology Corporation. All rights reserved.

No part of this document may be copied or reproduced in any form or by any means without the prior written consent of Accton Technology Corporation.

Trademarks

Accton is a trademark of Accton Technology Corporation. Other trademarks or brand names mentioned herein are trademarks or registered trademarks of their respective companies.

Disclaimer

Accton makes no warranties with respect to this documentation and disclaims any implied warranties of merchantability, quality, or fitness for any particular purpose. The information in this document is subject to change without notice. Accton reserves the right to make revisions to this publication without obligation to notify any person or entity of any such changes.

Accton

International Headquarters

No. 1 Creation Road III,
Science-based Industrial Park
Hsinchu 300, Taiwan, R.O.C.
Phone: 886-3-5770-270
FAX: 886-3-5770-267
Internet: support@accton.com.tw

USA Headquarters

6 Hughes
Irvine, CA 92618
Phone Numbers -
Sales: 800-926-9288
Support: 888-398-4101 or 949-707-4847
RMA: 800-762-4968
FAX: 949-707-2460

EH3008R
E042000-R02
150160-102

Free Manuals Download Website

<http://myh66.com>

<http://usermanuals.us>

<http://www.somanuals.com>

<http://www.4manuals.cc>

<http://www.manual-lib.com>

<http://www.404manual.com>

<http://www.luxmanual.com>

<http://aubethermostatmanual.com>

Golf course search by state

<http://golfingnear.com>

Email search by domain

<http://emailbydomain.com>

Auto manuals search

<http://auto.somanuals.com>

TV manuals search

<http://tv.somanuals.com>