

ACCUSPLIT®

ACCUSPLIT AE1720WPR Series Pedometer INSTRUCTIONS

Congratulations on taking the first step to wellness with your purchase of an ACCUSPLIT pedometer. It's easy to set up your new pedometer. Just follow the steps below, and start walking!



You are also helping to support the cause of breast cancer awareness and research. A portion of the proceeds from your purchase will be donated to a breast cancer initiative.

Adjusting your Pedometer's Measurement Sensitivity AE1700

AE1700 pedometers are highly accurate step counters. However, some walkers may find that their step counts tend to be a bit too high, or too low. All AE1700 models come with a sensitivity adjustment, to help account for individual differences. The adjustment switch has three positions: "+", "-", and center. The adjustment switch is located on the bottom of the pedometer, on the right-hand side when looking from the front.

Adjustment Procedure: Take 100 steps, then check STEPS display to see how many steps were actually counted. Repeat once to make sure results are about the same. If the pedometer counts fewer steps than you actually walked, slide the sensitivity adjustment towards the "+" icon. This will increase recorded steps by about 10%. If the pedometer counts more steps than you actually walked, slide the sensitivity adjustment towards the "-" icon. This will decrease recorded steps by about 10%.

WEARING YOUR PEDOMETER

While gently holding the belt clip open, slide the pedometer onto your belt or the top edge of your pants or skirt. It should fit snugly and level, above one knee.

Note: The pedometer should be as vertical as possible. Walkers with larger stomachs may find it helpful to wear the pedometer farther back on the body,

toward one hip. **The cover must be closed for the pedometer to work.** To avoid losing or dropping your pedometer, use the included leash and clip to fasten the pedometer securely to your clothing.

Attaching the Leash: Attach the pedometer to the leash by looping the leash through the pedometer leash slot. Next, loop the leash through the metal clip. Finally, clasp the waistband of your clothing with the metal clip. You can also use a safety pin to fasten the leash to your clothing, loop the leash through your belt or belt loop, or use a badge holder.

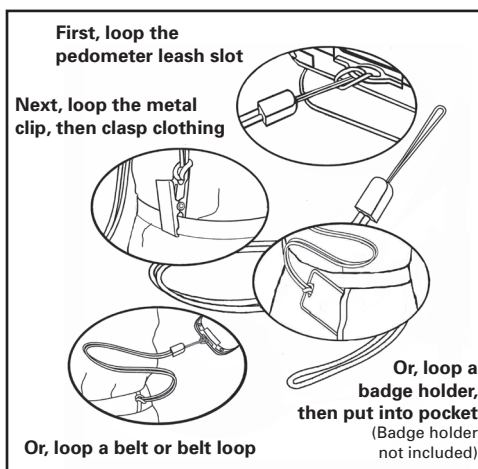

DISPLAY MODES

- **STEP:** STEP mode shows your step count since last reset, up to 1,000,000 steps.
- **⌚: ACTIVITY TIMER** MODE shows total activity time in minutes and seconds since last reset. The timer runs automatically whenever steps are being recorded.

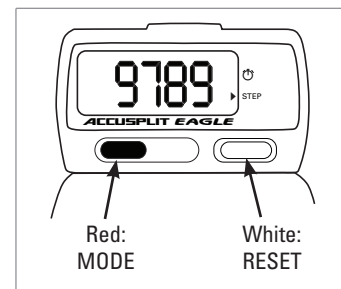

VIEWING YOUR RESULTS

Once you put on your pedometer with the cover closed, it will automatically begin to record your steps, and activity time. Repeatedly press the red MODE button to cycle through the pedometer modes: STEP → ACTIVITY TIMER → STEP

RESETTING YOUR PEDOMETER

Most people prefer to reset step counts daily. To reset: press and hold the white RESET button for at least 2 seconds.

REPLACING THE BATTERY

When the display starts to dim or goes blank, it is time to replace the battery. Your pedometer uses one Type L1142 (LR43) 1.5 volt silver oxide battery.

To replace:

1. Insert a coin into the slot on the front of the case, and twist counterclockwise to loosen the battery door.
2. Remove battery door and take out the old battery. Replace it with a new battery. The battery's positive (+) terminal should be FACE UP while you put it into the pedometer.
3. Put the battery door back on and twist the coin clockwise to tighten.

Eat Right! Walk More! Live Well!
The ACCUSPLIT Lifestyle

Free Manuals Download Website

<http://myh66.com>

<http://usermanuals.us>

<http://www.somanuals.com>

<http://www.4manuals.cc>

<http://www.manual-lib.com>

<http://www.404manual.com>

<http://www.luxmanual.com>

<http://aubethermostatmanual.com>

Golf course search by state

<http://golfingnear.com>

Email search by domain

<http://emailbydomain.com>

Auto manuals search

<http://auto.somanuals.com>

TV manuals search

<http://tv.somanuals.com>