



PDP100
OWNERS MANUAL

YOUR NEW DIGITAL PIANO CHOICE
ADAGIO

Thanks for using our digital piano

This instrument is a high-quality digital piano with 88 standard size touch sensitivity keyboard and combines the most advanced PCM tone generation technology. This instrument has 100 accompaniment styles that can be used to provide fully-orchestrated Auto Accompaniment. The multi-functional LED (MULTI DISPLAY) makes your operation more conveniently. The REGISTRATION MEMORY can be used to store four sets of VOICE and AUTO ACCOMPANIMENT settings which can be recalled at the touch of a button and they can be kept forever even the POWER is turned OFF.

In order to obtain maximum performance and enjoyment, please read this manual thoroughly while trying out the various features described.

Panel controls	2
Precaution	4
Preparation	5
Power Supply.....	5
Using Headphones or an External Sound System	5
The Sustain Pedal	5
The MIDI OUT Connector.....	6
Listen to the Demo	7
Turn the Power ON and Set the Volume.	7
Press DEMO to start.....	7
Press CZERNY to start	7
Press DEMO to stop	7
Select and Play the Voices	8
Select a Voice	8
Keyboard Percussion	8
Touch	9
Split Mode	9
Overall Control.....	10
Sustain	10
Tune	10
Auto Accompaniment	11
Select a Style	11
Auto Accompaniment Fingering	12
Accompaniment Control.....	13
Accompaniment Volume	15
Tempo Control	15
Registration Memory	16
Memorizing the settings	16
Recalling the settings	16
Recording Functions	17
Record	17
Play	17
Appendix	18
Percussion Kit List	18
Voice List.....	19
Style List.....	20
Specifications	21
Draft	22

Top Panel Controls

1.POWER Button

2.MASTER VOLUME Control

3..ACC[+/-] Button

4.TEMPO[+/-] Button

5.KEYBOARD MODE

NORMAL

S.FINGER

FINGERED

SPLIT

6.ACCOMPANIMENT CONTROL SELECT

SYNCHRO Button

START/STOP Button

INTRO/ENDING Button

FILL IN Button

7.TOUCH Button

8.MULTIDISPLAY

9.[VIOCE/STYLE] SELECT

10.SUSTAIN Button

11.NUMBER [0]-[9], [+],[-] Buttons

12.TUNE Button

13.RECORD AND PLAY Button

14.DEMO Button

15.MEMORY

STORE Button

M1-M4 SELECT

Rear Panel Controls

16.MIDI(IN/ OUT) Jack

17.PEDAL(SUSTAIN/SOFT) Jack

18.LINE OUT Jack

19.PHONE Jack

20.POWER Jack

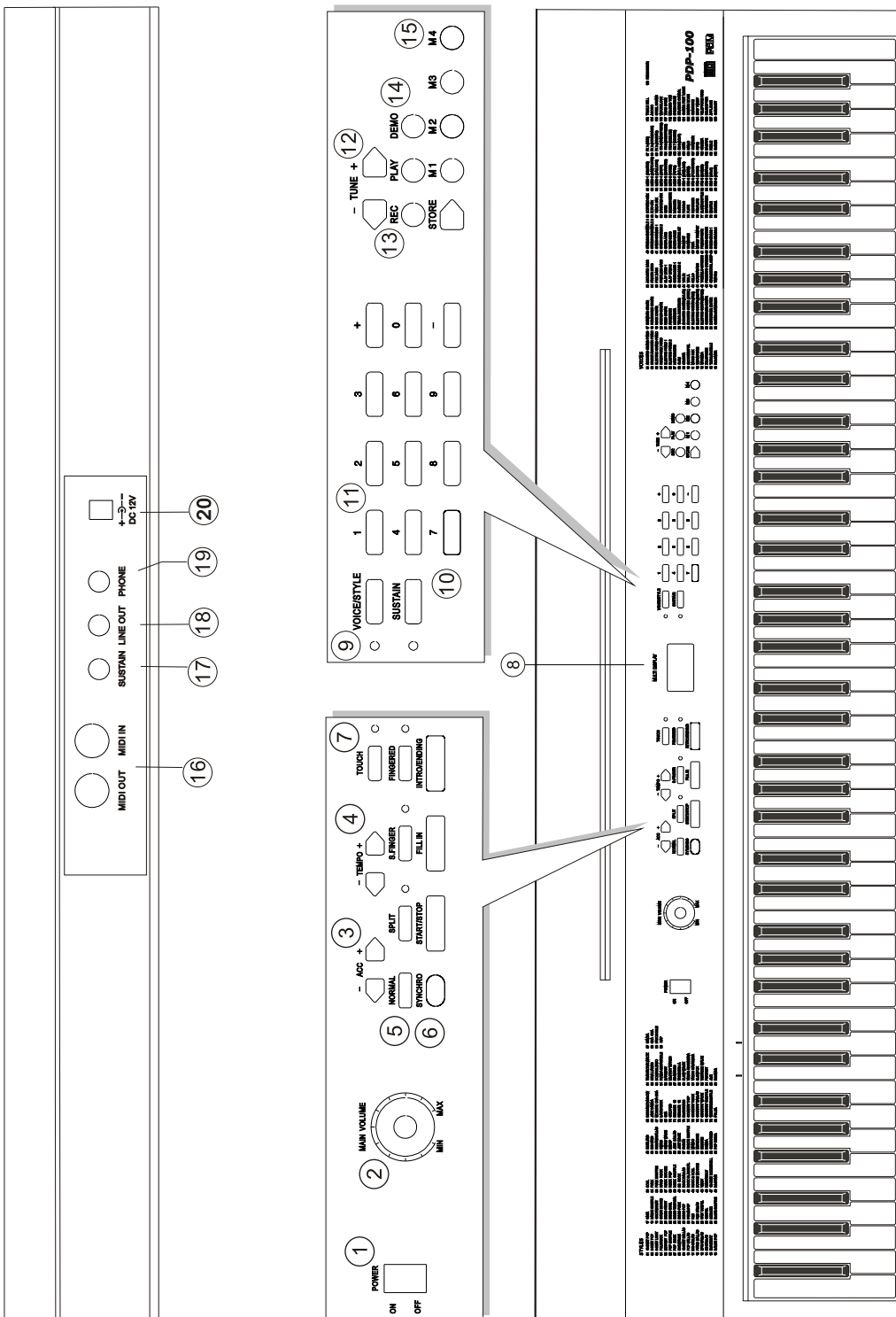

(Draft2)

(Draft1)

Precaution

DIGITAL PIANO

Thank you for purchasing this digital instrument. For perfect operation and security, please read the manual carefully and keep it for future reference.

Safety Precautions

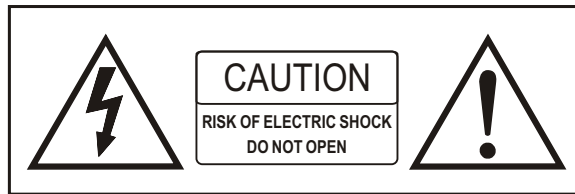

The lightning flash with arrowhead symbol within an equilateral triangle is intended to alert the user to the presence of uninsulated “dangerous voltage” within the product’s enclosure that may be of sufficient magnitude to constitute a risk of electric shock to persons.



The exclamation point within an equilateral triangle is intended to alert the user to the presence of important operating and maintenance (servicing) instructions in the literature accompanying the product.

Important Safety Instructions



(Figure 1)

- 1) Read these instructions.
- 2) Keep these instructions.
- 3) Heed all warnings.
- 4) Follow all instructions.
- 5) Do not use this apparatus near water.
- 6) Clean only with dry cloth.
- 7) Do not block any ventilation openings, install in accordance with the manufacturer's instructions.
- 8) Do not install near any heat sources such as radiators, heat registers, stoves, or other apparatus (including amplifiers) that produce heat.
- 9) Do not defeat the safety purpose of the polarized or grounding-type plug. A polarized plug has two blades with one wider than the other. A grounding type plug has two blades and a third grounding prong. The wide blade or the third prong are provided for your safety, if the provided plug does not fit into your outlet, consult an electrician for replacement of the obsolete outlet.
- 10) Protect the power cord from being walked on or pinched particularly at plugs, convenience receptacles, and the point where they exit from the apparatus.
- 11) Only use attachments/accessories specified by the manufacturer.
- 12) Use only with the cart, stand, tripod, bracket, or table specified by the manufacturer, or sold with the apparatus. When a cart is used, use caution when moving the cart/apparatus combination to avoid injury from tip-over (Figure 1).
- 13) Unplug this apparatus during lightning storms or when unused for a long period of time.
- 14) Refer all servicing to qualified service personnel. Servicing is required when the apparatus has been damaged in any way, such as power-supply cord or plug is damaged, liquid has been spilled or objects have fallen into the apparatus, the apparatus has been exposed to rain or moisture, does not operate normally, or has been dropped.

WARNING: To reduce the risk of fire or electric shock, do not expose this apparatus to rain or moisture.

CAUTION: Apparatus shall not be exposed to dripping or splashing and no objects filled with liquids, such as vases, shall be placed on the apparatus.

This section contains information about setting up your instrument and preparing to play. Be sure to go through this section carefully before using your instrument.

1. Power Supply

Your instrument will run from a power .Plug the power plug into a convenient wall AC power socket.

2 .Using Headphones or an External Sound System

A standard pair of stereo headphones can be plugged into the PHONES jack which under the left keyboard for private practice or late-night playing. The internal speaker system is automatically shut off when a pair of headphones is plugged into the PHONES jack.

The LINE OUT jack can be used to deliver the output of the piano to a keyboard amplifier, stereo sound system, mixing console or tape recorder.

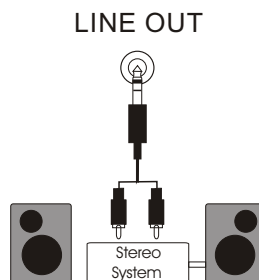
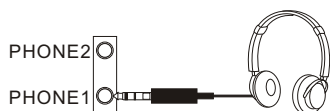

3 .The Foot Pedal

A footswitch can be plugged into the rear-panel PEDAL jack. The Sustain Pedal functions as a damper pedal controlling sustain. Press the pedal to sustain notes after the keys are released. Don't press the pedal while inserting the plug into the PEDAL jack or while turning the power on. The Soft Pedal controlling the sound volume .Pressing the pedal to decrease the output sound volume.

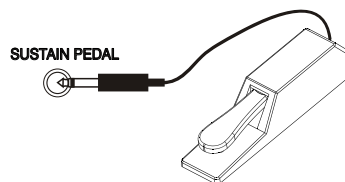

5 .THE MIDI IN/ OUT CONNECTOR

The MIDI OUT connector transmits MIDI data generated by your instrument .Most MIDI key-boards (including your instrument, of course) transmit note information via this connector. If the MIDI OUT connector is connected to the MIDI IN connector of a second keyboard. The result is that you can effectively play two instruments at once.

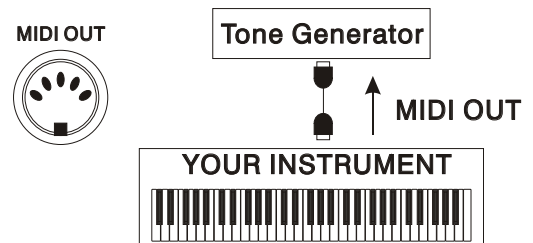

Listen to the Demo

Once you've set up your instrument, try listening to the pre-programmed demonstration songs - they'll give you a good idea of what the digital piano could do.

1. Turn the Power ON and Set the Volume.

Before playing the demo turn the power on by pressing the POWER switch (the panel indicators and MULTI DISPLAY will light) and set the MASTER VOLUME about half way between the "MIN" and "MAX" settings. You can adjust the volume to accommodate your playing.

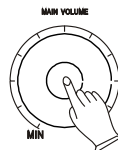
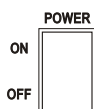

2. Press DEMO to start

Press DEMO button to start playback and use the MASTER VOLUME control to set the ideal listening level. The [d01] will appear on the MULTIDISPLAY. Now all demonstrations will play in sequence repeatedly.

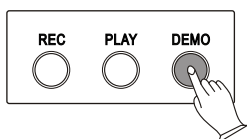

Press down the any within the left side 30 keys of keyboard, press DEMO button again at the same time. The [L01] - [L30] will appear on the MULTI DISPLAY. Now all demonstrations will play in sequence repeatedly. Your instrument has total 5 demonstrations. You can select any demonstration by press [+] or [-] buttons or number buttons [0]-[4].

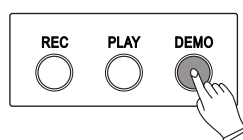

4. Press DEMO to stop

Press DEMO button again to stop demo playback.

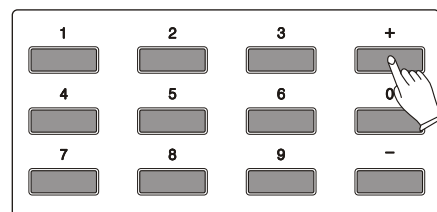

Select and Play the Voices

Your instrument has 128 stunning voices and 61 percussion kits that you can select and play.

1. Select a Voice

.Press the [VOICE/STYLE] button to turn off its indicator .The voice number will appear on the MULTI DISPLAY.

.Select a Voice Number

Use the [+] and [-] buttons or the number buttons to select the required voice number (01-129). The [+] and [-] buttons can be used to increment (increment by one) or decrement (decrement by one) the current selected voice number. Press the [+] button briefly to increase the value , or the [-] button to decrease. If you hold the [+] or [-] button down , the value will inc or dec continuously - simply release the button when the desired value has been reached.

The number buttons allow direct numeric entry of the desired value, and it's therefore the fastest way to edit in many situations. To select a voice, for example , choose one of the 129 voice - numbered "01" through "129" - shown on the VOICE list, then enter its number using the number buttons. To select "HARMONICA" (number 23), for example, first press [2] and [3]. The number "23" should show on the LED.

When selecting voice number "100" through "129", Holding the [1] button till the "1" display on the hundreds digit area, as required, prior to enter the tens and ones digits.

Values outside the range of voice number can't be entered.

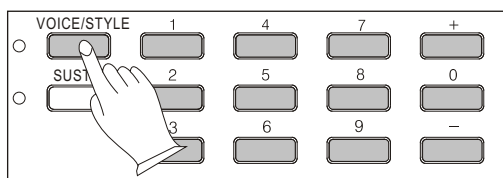

2. Keyboard Percussion

Selecting the voice number of 129, Your instrument has 61 different percussions that can be played on right 61 keys of the keyboard while selecting percussion function.

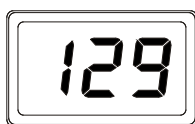

3.Touch

Press [TOUCH] button ,you can turn ON/OFF the touch function.When the touch function is ON,the volume will be varied according to how hard you play on the keyboard.

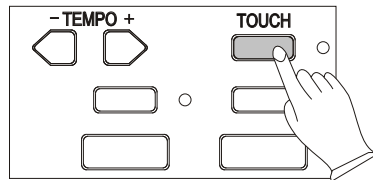

4.Split Mode

Your keyboard can be split into two sections which means different voices can be played with the left and right hands at the same time.

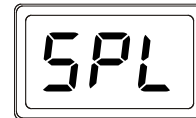
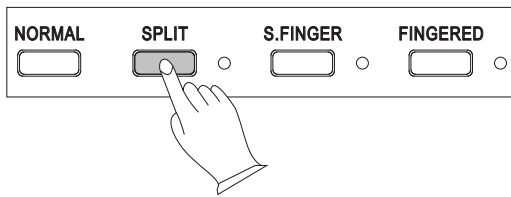

.Split Point Change

Holding [SPLIT] button simultaneously, Press any key among A1 to C9 to select splitpoint ,so that its indicator lights to turn Split ON . The split voice number will appear on the MULTIDISPLAY.use the [+] and [-] buttons or the number buttons to select the leftsplit voice ,The right split voice should be selected at the NORMAL mode.

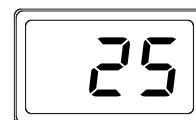
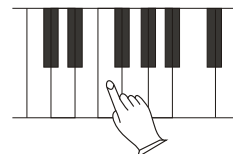
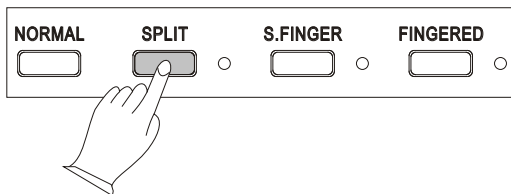

5. Overall Control

1). Sustain

Press [SUSTAIN] button so that its indicator lights to turn Sustain ON/OFF. It can be used as a damper pedal. Turning Sustain on to sustain notes after the keys are released.

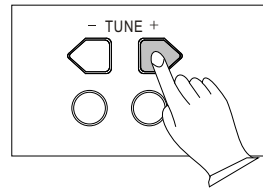
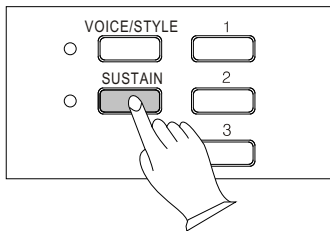

2). Tune

Your instrument [TUNE] buttons makes it possible to tune the pitch of your instrument to match other instruments. Tune can be accomplished over a 50-cents range (that's 100 cents total, or one semitone) in 35 steps (approximately 3 cents per step).

Use the [TUNE] buttons to set the desired tune value.

The normal tune value (00) can be recalled by pressing both the two [TUNE] buttons at the same time.

Auto Accompaniment

Your instrument has 100 accompaniment styles that can be used to provide fully-orchestrated Auto Accompaniment.

When the Auto Accompaniment function is turned ON, this instrument create fully-orchestrated rhythm, bass, and chord accompaniment base on chords you play with the left hand in the Auto Accompaniment section of the keyboard(i.e. all keys to the left of the Auto Accompaniment split point).The right-hand section of the keyboard is available for normal playing.

The default Auto Accompaniment split point is the G3(34) key. The Auto Accompaniment section of the keyboard consists of all keys to its left .

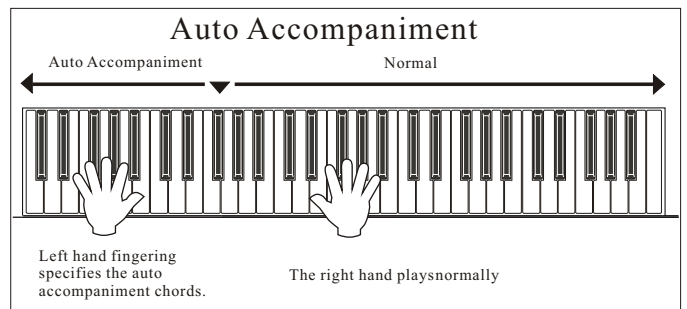

1. Selecting a Style

Any of your instrument's 100 styles can be selected via the normal editing procedure. This can be done either before or during accompaniment playback.

.Press the [VOICE/STYLE] button

Press the [VOICE/STYLE] button to light the [VOICE/STYLE] indicator.

You don't need to do this if the [VOICE/STYLE] indicator was lit.

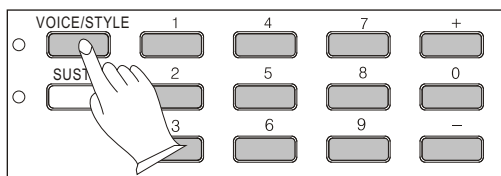

.Select a Style Number

Refer to the STYLE list ,use the [+] and [-] buttons or the number buttons to select the required style number(00 through 99).

2. Auto Accompaniment Fingering

Your instrument has two Auto Accompaniment fingering modes: FINGERED and SINGLE.

Press [FINGERED] button to select FINGERED mode, its indicator will be lit.

While Pressing [SINGLE] button to select SINGLE mode and light its indicator.

.SINGLE Mode

SINGLE Mode fingering makes it simple to produce beautiful orchestrated accompaniment using major, seventh, minor and minor-seventh chords by pressing a minimum number of keys in the Auto Accompaniment section of the keyboard. The accompaniment produced is perfectly matched to the current selected accompaniment style.

.Major Chords:

If you press a "C" key in the left-hand section of the keyboard, for example, a C-major accompaniment will be played. Pressing another key in the left hand section of the keyboard to select a new chord. The key you pressed will always determine the "root" of the chord played (i.e. "C" for a C chord).

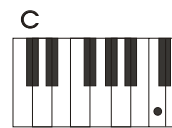

.Minor Chords:

Simultaneously press the root key and a black key to its left.



.Seventh Chords:

Simultaneously press the root key and a white key to its left.



.Minor-Seventh Chords:

Simultaneously press the root key and both a white and a black key to its left.

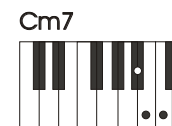

The Auto Accompaniment will continue to play even if you lift your fingers from the Auto Accompaniment keys. You only need to press the Auto Accompaniment keys while changing the chords.

.FINGERED Mode

FINGERED Mode is ideal if you have already know how to play chords on a keyboard, since it allows you to supply your own chords for the Auto Accompaniment feature.

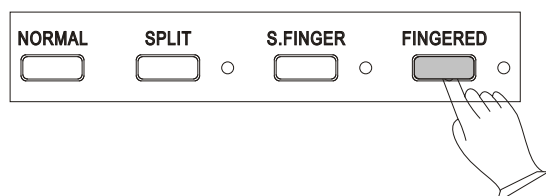

The digital piano will accept the following chord type:

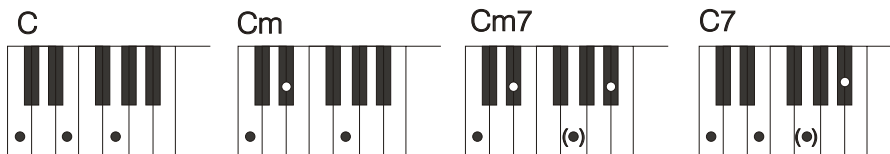

.Press [NORMAL] button to turn Auto Accompaniment function OFF.

The [SPLIT] and [FINGERED] AND [S.FINGER] indicators are unlit. There is only ONE voice over the entire keyboard, the piano is in SOLO status.

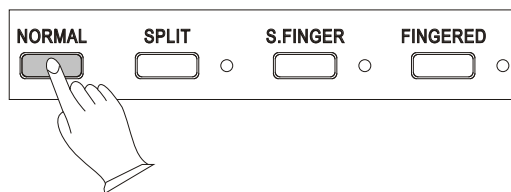

3. Accompaniment Control

Your instrument provides a range of accompaniment "sections" - introduction, fill-in, ending - that you can select to control the "flow" of the accompaniment to achieve the desired musical results. Accompaniment start/stop and sections are controlled by the ACCOMPANIMENT CONTROL buttons.

1). Straight Start

.The [START/STOP] button starts the selected accompaniment style immediately.

Press the [FINGERED] button or the [SINGLE] button so that the indicator will light before starting the accompaniment. The accompaniment will start with the rhythm sound only when the [START/STOP] button is pressed, then the bass and chord parts will play as soon as the first note or chord is played on the Auto Accompaniment section of the keyboard.

A different accompaniment style can be selected at any time while the accompaniment is playing. The style number on the MULTI DISPLAY will change as soon as the selection was made. The tempo will not change when the new style begins playing.

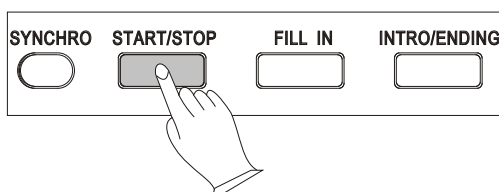

2).Synchro Start

Press the [SYNCHRO] button if you want to start the accompaniment when you play the first note or chord on the AUTO ACCOMPANIMENT section of the keyboard (It's still valid while the AUTO ACCOMPANIMENT function is OFF).

If you press the [SYNCHRO] button, the BEAT indicator dots will flash at the current tempo. The synchro start mode can be disengaged by pressing the [SYNCHRO] button again so that the BEAT indicator dots go out.

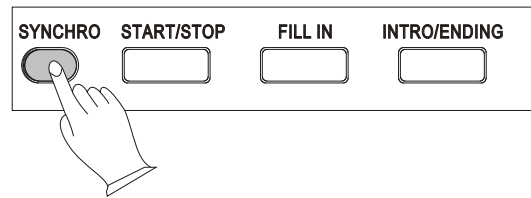

3).Starting the Accompaniment with an Introduction

Any of your instrument accompaniment patterns can start with an appropriate introduction by pressing the [INTRO/ENDING] button directly.

If you press the [SYNCHRO] button first and then the [INTRO/ENDING] button, the accompaniment will start from the introduction as soon as a chord is detected in the AUTO ACCOMPANIMENT section of the keyboard.

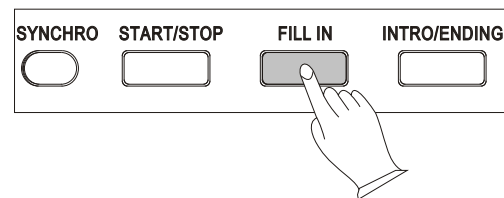

4).Adding Fill-In

Press the [FILL IN] button at any time while the accompaniment is playing to add a one-measure fill-in or return to the MAIN section.

If you hold the [FILL IN] button, the fill-in pattern will repeat until the button is released, then the MAIN section will play from the beginning of the next measure.

If the [FILL IN] button is pressed at the last beat of a measure, the fill-in will begin at the first beat of the next measure. If pressed at any other time the fill-in will begin immediately.

If you press the [SYNCHRO] button and then the [FILL IN] button, the accompaniment will start from the fill-in as soon as a chord is detected in the AUTO ACCOMPANIMENT section of the keyboard.

It's also possible to start the accompaniment with a fill-in by pressing the [FILL IN] button directly.

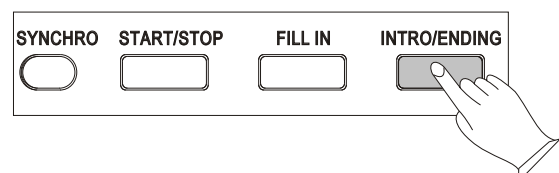

4. Accompaniment Volume

The [ACC] buttons can be used to adjust the volume of the selected accompaniment .

.Press the [ACC] buttons

Press the [ACC] buttons. The current accompaniment volume value will appear on the MULTI DISPLAY.

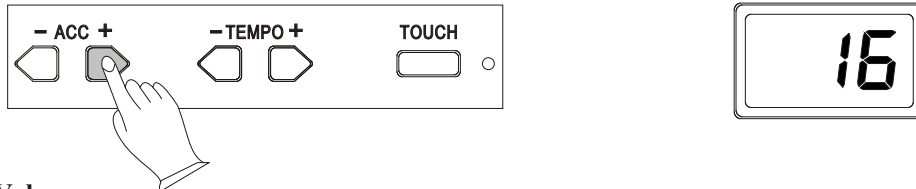

.Set the Volume

Use the [+] and [-] buttons, the number buttons, or the [ACC] buttons themselves to set the desired volume . The volume range is from 01 (no sound) to 16 (max volume). The default volume value (12) can be recalled instantly by pressing both the [ACC] buttons at the same time.

5. Tempo Control

The [TEMPO] buttons can be used to control the tempo of Auto Accompaniment, DEMO.

.Press the [TEMPO] buttons

Press the [TEMPO] buttons. The current tempo (beats per minute) will appear on the MULTIDISPLAY.

.Set the Tempo

Use the [TEMPO] + or - buttons to set the desired tempo.

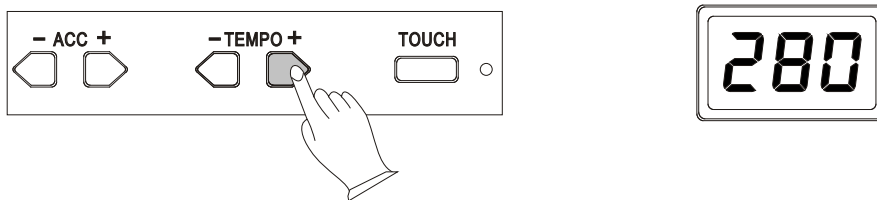

The available tempo ranges from 40 to 280 beats per minute. Each accompaniment style has a different "default" tempo which is automatically set whenever a new style is selected (but not when a new style is selected while the accompaniment is playing) . The default tempo for the current selected style can be recalled instantly by pressing both of the two [TEMPO] buttons at the same time.

Registration Memory

DIGITAL PIANO

Your instrument REGISTRATION MEMORY can be used to store four sets of VOICE and AUTO ACCOMPANIMENT settings that can be recalled during you playing at the touch of one single button.

The REGISTRATION MEMORY stores the following parameters:

- Voice numbers
- Split point
- Style number
- Accompaniment volume
- Fingering Mode

1. Memorizing the settings

The panel settings listed above can be stored to any one of the four REGISTRATION MEMORY buttons by pressing the button-[M1],[M2],[M3], or [M4] while holding the [STORE] button. The [S-1]-[S-4] will appear on the MULTI DISPLAY.

Please note that anytime you store to a REGISTRATION MEMORY button, all settings previous stored in that button will be erased and replaced by the new settings.

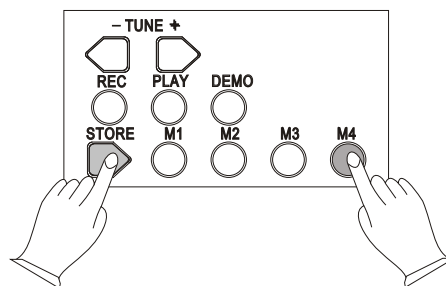
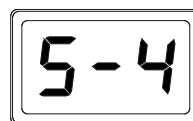

2. Recalling the settings

The settings stored to a REGISTRATION MEMORY button can be recalled simply by pressing the appropriate button. The [E-1]-[E-4] will appear on the MULTI DISPLAY.

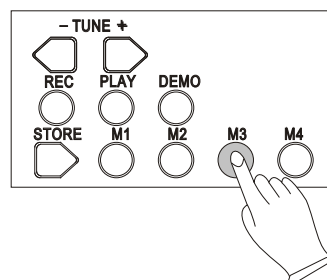
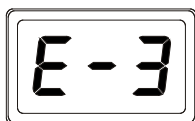

Holding the [STORE] button simultaneously, press [+] button, the default REGISTRATION MEMORY settings can be recalled. The [CAE] will appear on the MULTIDISPLAY.

Recording Functions

Your instrument allows you to record and play back song including chord sequences created using the Auto Accompaniment feature and melody like you play on the keyboard.

1. Record

.Press the [RECORD] button

Press the [RECORD] button ,the [rEC] will appear on the MULTI DISPLAY.



.Start Recording

Press any key on the keyboard, will start recording.If you press SYNCHRO button,the accompaniment will start at the same time.

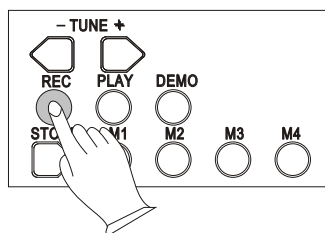

.Stop Recording

Press the [RECORD] button again will stop recording . The voice number will be shown on the MULTIDISPLAY after recording was stopped.

2. Play

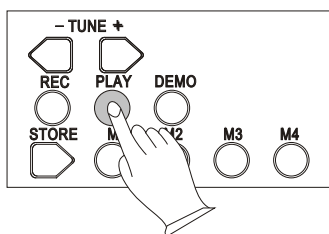
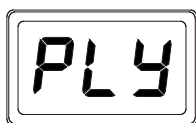

Playback will begin as the [PLAY] button is pressed, the [PLy] will appear on the MULTI DISPLAY. Play along on the keyboard if you like. You can also change the tempo during the playback.

The maximum polyphony is 16. If more than 16 notes are played at the time, some notes may be truncated.

Accompaniment and melody playback will stop automatically when all recorded data have been played back. You can also stop playback at any time by pressing the [PLAY] button again . The voice number will be shown on the MULTIDISPLAY after playback is stopped.

Holding the [STORE] button simultaneously, press [-] button, the record is erased . The [CAS] will appear on the MULTIDISPLAY.

1.Percussion list

Value	Name
C4	Click(Square Wave)
C#4	Brush Tap
D4	Brush Swirl
D#4	Brush Slap
E4	Brush Swirl W/Attack
F4	Snare Roll
F#4	Castanet
G4	Snare H Soft
G#4	Sticks
A4	Bass Drum H Soft
A#4	Open Rim Shot
B4	Bass Drum L
C5	Bass Drum H Hard
C#5	Closed Rim Shot
D5	Snare L
D#5	Hand Clap
E5	Snare H Hard
F5	Floor Tom L
F#5	Hi-Hat Closed
G5	Floor Tom H
G#5	Hi-Hat Pedal
A5	Low Tom
A#5	Hi-Hat Open
B5	Mid Tom L
C6	Mid Tom H
C#6	Crash Cymbal 1
D6	High Tom
D#6	Ride Cymbal 1
E6	Chinese Cymbal
F6	Ride Cymbal Cup
F#6	Tambourine

Value	Name
G6	Splash Cymbal
G#6	Cowbell
A6	Crash Cymbal 2
A#6	Vibraslap
B6	Ride Cymbal 2
C7	Bongo H
C#7	Bongo L
D7	Conga H Mute
D#7	Conga H Open
E7	Conga L
F7	Timbale H
F#7	Timbale L
G7	Agogo H
G#7	Agogo L
A7	Cabasa
A#7	Maracas
B7	Samba Whistle H
C8	Samba Whistle L
C#8	Guiro Short
D8	Guiro Long
D#8	Claves
E8	Wood Block H
F8	Wood Block L
F#8	Cuica Mute
G8	Cuica Open
G#8	Triangle Mute
A8	Triangle Open
A#8	Shaker
B8	Jingle Bell
C9	Bell Tree

Appendix

DIGITAL PIANO

2. Tone list

NO	MIDINO	TONE NAME	Channel
Piano			
01	00	Acoustic Grand Piano	1
02	01	Bright Acoustic Piano	1
03	02	Electric Grand Piano	2
04	03	Honky-Tonk Piano	2
05	04	Electric piano 1	2
06	05	Electric Piano 2	2
07	06	Harpsichord	1
08	07	Clavi	1
Chromatic Percussion			
09	08	Celesta	1
10	09	Glockenspiel	1
11	10	Music Box	2
12	11	Vibraphone	1
13	12	Marimba	1
14	13	Xylophone	1
15	14	Tubular Bells	1
16	15	Dulcimer	2
Organ			
17	16	Drawbar Organ	2
18	17	Percussive Organ	2
19	18	Rock Organ	2
20	19	Church Organ	2
21	20	Reed Organ	1
22	21	Accordion	2
23	22	Harmonica	1
24	23	Tango Accordion	2
Guitar			
25	24	Acoustic Guitar (Nylon)	1
26	25	Acoustic Guitar (Steel)	1
27	26	Electric Guitar (Jazz)	1
28	27	Electric Guitar (Clean)	2
29	28	Electric Guitar (Muted)	1
30	29	Overdriven Guitar	1
31	30	Distortion Guitar	1
32	31	Guitar Harmonics	1
Bass			
33	32	Acoustic Bass	1
34	33	Finger Bass	1
35	34	Pick Bass	1
36	35	Fretless Bass	1
37	36	Slap Bass 1	1
38	37	Slap Bass 2	1
39	38	Synth Bass 1	1
40	39	Synth Bass 2	1
Strings			
41	40	Violin	1
42	41	Viola	1
43	42	Cello	1
44	43	Contrabass	1
45	44	Tremolo Strings	2

NO	MIDINO	TONE NAME	Channel
46	45	Pizzicato Strings	2
47	46	Orchestral Harp	2
48	47	Timpani	1
Ensemble			
49	48	Strings Ensemble 1	1
50	49	Strings Ensemble 2	1
51	50	Synth Strings 1	2
52	51	Synth Strings 2	2
53	52	Choir Aahs	2
54	53	Voice Oohs	1
55	54	Synth Voice	1
56	55	Orchestra Hit	1
Brass			
57	56	Trumpet	1
58	57	Trombone	1
59	58	Tuba	1
60	59	Muted Trumpet	1
61	60	French Horn	1
62	61	Brass Section	1
63	62	Synth Brass 1	2
64	63	Synth Brass 2	2
Reed			
65	64	Soprano Sax	1
66	65	Alto Sax	1
67	66	Tenor Sax	1
68	67	Baritone Sax	1
69	68	Oboe	1
70	69	English Horn	1
71	70	Bassoon	1
72	71	Clarinet	1
Pipe			
73	72	Piccolo	1
74	73	Flute	1
75	74	Recorder	1
76	75	Pan Flute	1
77	76	Blown Bottle	2
78	77	Shakuhachi	1
79	78	Whistle	1
80	79	Ocarina	1
Synth Lead			
81	80	Lead 1 (Square)	2
82	81	Lead 2 (Sawtooth)	2
83	82	Lead 3 (Calliope)	2
84	83	Lead 4 (Chiff)	2
85	84	Lead 5 (Charang)	2
86	85	Lead 6 (Voice)	2
87	86	Lead 7 (Fifth)	2
88	87	Lead 8 (Ball+Lead)	2
Synth Pad			
89	88	Pad 1 (New Age)	2
90	89	Pad 2 (Warm)	2

NO	MIDINO	TONE NAME	Channel
91	90	Pad 3 (Polysynth)	2
92	91	Pad 4 (Choir)	2
93	92	Pad 5 (Bowed)	2
94	93	Pad 6 (Metallic)	2
95	94	Pad 7 (Halo)	2
96	95	Pad 8 (Sweep)	2
Synth Effects			
97	96	Fx 1 (Rain)	2
98	97	Fx 2 (Soundtrack)	2
99	98	Fx 3 (Crystal)	2
100	99	Fx 4 (Atmosphere)	2
101	100	Fx 5 (Brightness)	2
102	101	Fx 6 (Goblins)	2
103	102	Fx 7 (Echoes)	2
104	103	Fx 8 (Sci-Fi)	2
Ethnic			
105	104	Sitar	1
106	105	Banjo	1
107	106	Shamisen	1
108	107	Koto	1
109	108	Kalimba	1
110	109	Bagpipe	2
111	110	Fiddle	1
112	111	Shanai	1
Percussive			
113	112	Tinkle Bell	2
114	113	Agogo	1
115	114	Steel Drums	2
116	115	Woodblock	1
117	116	Taiko Drum	1
118	117	Melodic Tom	1
119	118	Synth Drum	1
120	119	Reverse Cymbal	1
Sound Effects			
121	120	Guitar Fret Noise	1
122	121	Breath Noise	1
123	122	Seashore	2
124	123	Bird Tweet	2
125	124	Telephone Ring	1
126	125	Helicopter	2
127	126	Applause	2
128	127	Gunshot	
129		Percussion	

3. Style list

NO	Rhythm Name	Rhythm
Pop		
01	16-Beat Pop	16
02	8-Beat Pop	16
03	8-Beat Light	8
04	Folkrock	16
05	Detroit Pop	12
06	Pop Shuffle	12
07	Pop Rock	12
08	Showtune	8
Pop Ballad		
09	16-Beat Ballad	16
10	Pop Ballad	8
11	Big Ballad	8
12	Piano Ballad	8
13	Epic Ballad	8
14	6/8 Ballad	16
Dance		
15	Eurobeat	16
16	Dance Pop	16
17	Casa	16
18	Dance Shuffle	24
19	Groundbeat	24
20	Synth Boogie	6/8
Disco		
21	Disco Party	16
22	Disco Soul	16
23	Disco Tropical	16
24	Disco Funk	16
25	Disco Pop	16
26	Polka Pop	8
Rhythm & Blue		
27	R&B	8
28	R&B Ballad	16
29	Fast Gospel	8
30	Gospel	6/8
31	6/8Blues	6/8
32	Blues Shuffle	12
33	Soul	8
34	Funk	16

NO	Rhythm Name	Rhythm
35	Funk Shuffle	24
Rock		
36	Hard Rock	8
37	Rock Boogie	12
38	Rock Pop	8
39	Rock Shuffle	12
40	6/8 Rock	6/8
41	Rock Ballad	8
42	Rock Classical	16
Rock &Roll		
43	Rock & Roll	12
44	Boogie Woogie	12
45	Twist	8
46	Rockabilly	12
47	16-Beat Rock&Roll	16
Traditional Jazz		
48	Ragtime	8
49	Dixieland	12
50	Big Band	12
51	BigBandBallad	12
52	Swing	12
53	Swing Waltz	9/8
Contemporary Jazz		
54	Bebop	12
55	Jazz Ballad	12
56	Jazz Waltz	9/8
57	Fusion	16
58	Fusion Shuffle	24
Latin		
59	Mambo	8
60	Merengue	8
61	Beguine	8
62	Bomba	16
63	Guaguanco	16
Latin Pop		
64	Pop Bossa	8
65	BossaNovaSlow	8
66	Jazz Samba	16
67	Modern Cha Cha	16

NO	Rhythm Name	Rhythm
68	Latin Rock	16
Caribbean		
69	Ska	8
70	Calypso	16
71	Reggae 16	16
72	Reggae 12	12
Country &Western		
73	Bluegrass	16
74	Country Pop	8
75	Country Rock	8
76	Country Ballad	8
77	Country Waltz	9/8
78	Country Shuffle	12
79	Western Shuffle	12
World Music		
80	Polka	8
81	TraditionalWaltz	3/4
82	Sevillianas	3/4
83	Bolero Lento	8
84	Rumba Espagnole	16
85	Dangdut	8
March		
86	Military March	8
87	6/8 March	6/8
88	Tarantella	6/8
Ballroom Standard		
89	Slow Waltz	3/4
90	Tango Argentina	8
91	Tango Habanera	8
92	Slowfox	12
93	Viennese Waltz	3/4
94	Foxtrot	12
95	Jive	12
Ballroom Latin		
96	Rhumba	8
97	Samba	16
98	Cha Cha	8
99	Pasodoble	16
00	Rap	

4. Specifications

Keyboard:

88 standard-size touch sensitivity
keys(A1 through C9)

Display:

multi-function LED

Number Buttons:

[0]-[9],[+],[=],[/]

Voice:

PCM voice:01-128
polyphony:16
percussion:61
voice control:
Sustain,tune,touch

Auto accompaniment:

100 styles

Accompaniment control:

Synchro,start/stop,intro,ending,fill in,tempo,acc

Keyboard modes:

Normal,s.finger,fingered,split

Setup:

power:ON/OFF
master volume:MIN-MAX

Midi control:

Midi out

Overall controls:

demo :5 songs
record, play
store, m1-m4

Main Amplifiers:

20W x2 ,2W x2
PHONES output

Dimensions(W x D x H)

Box A:1435mm x 548mm x 250mm
Box B:1385mm x 300mm x 180mm

Weight

Box A:33kg
Box B:17kg

Supplied Accessories:

.Music Stand
.User's Manul

ASSEMBLY INSTRUCTIONS

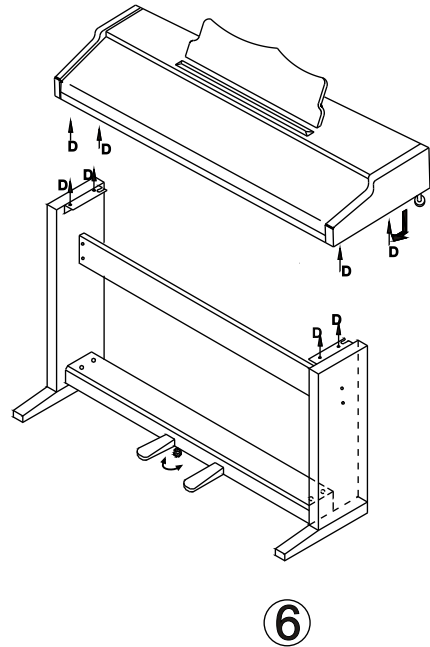
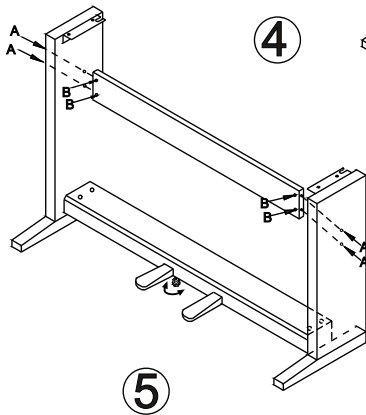
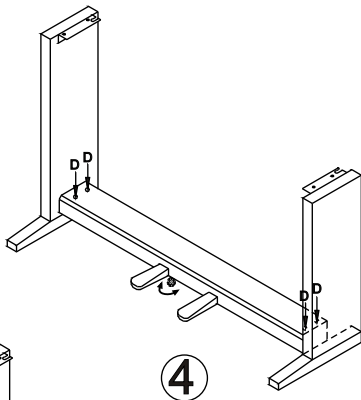
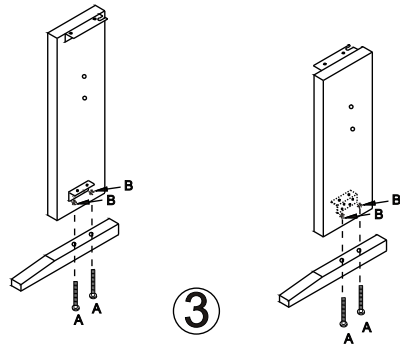
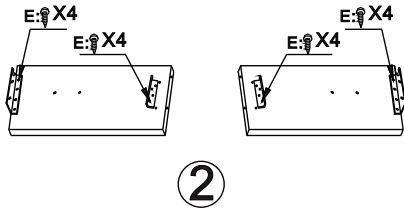
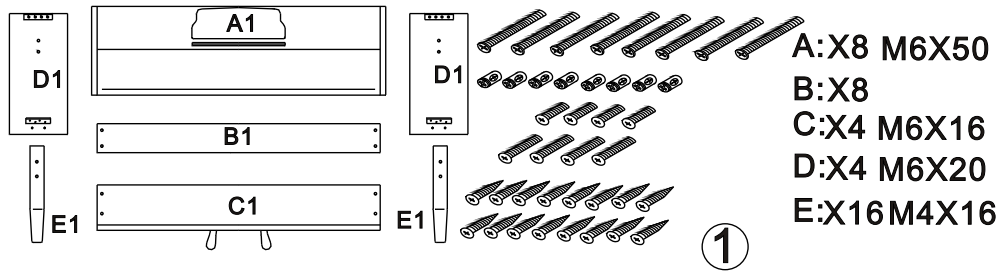

1 0 5 0 5 3 4 1

Free Manuals Download Website

<http://myh66.com>

<http://usermanuals.us>

<http://www.somanuals.com>

<http://www.4manuals.cc>

<http://www.manual-lib.com>

<http://www.404manual.com>

<http://www.luxmanual.com>

<http://aubethermostatmanual.com>

Golf course search by state

<http://golfingnear.com>

Email search by domain

<http://emailbydomain.com>

Auto manuals search

<http://auto.somanuals.com>

TV manuals search

<http://tv.somanuals.com>