

# JENSEN® Operation

## How to Enjoy the CD3010X AM/FM Stereo Radio/Compact Disc Player with Remote Control and Auxiliary Input Jack

**Welcome!**  
 What you're holding is no ordinary owner's manual. We've tried to make the instructions in this owner's manual clear and easy to follow. If you take a few minutes to look through it, you'll learn how to use all of the features on your new Jensen car stereo for maximum enjoyment.

**Warranty Service**  
 If your Jensen stereo should ever require service, you will need to have the original dated receipt. If you ever need to return the unit for any reason, always include the receipt with the product.

### Basic Operation

**Power • Volume • Audible Beep • Reset • Mute • Bass Boost**

**Power**  
 Press **PWR** to turn unit on or off.

**Programable Volume Level**  
 Press **PWR** for > 3 seconds to program initial future volume.

**Volume**  
 Adjust volume by pressing **▲** or **▼**.  
 0 = minimum  
 46 = maximum

**Audible Beep**  
 Press **SEL** for three seconds to turn beep on or off. When beep is on **⊗** appears in the display.

**Reset Display**  
 Use a pencil tip (or other non-metallic object) to press the **RESET** button.

**Mute**  
 Press **MUTE** to silence the receiver.

**Bass Boost**  
 Press **BASS** to increase bass output. **BASS** appears in the display.

**Bass**

1 Press **SEL** two times. - 6 = minimum  
 +6 = maximum

2 Adjust Bass up or down.

**Balance**

1 Press **SEL** four times. R12 = Right speakers only  
 C00 = Equal sound right and left  
 L12 = Left speakers only

2 Adjust Balance left or right.

**Treble**

1 Press **SEL** three times. - 6 = minimum  
 +6 = maximum

2 Adjust Treble up or down.

**Fader**

1 Press **SEL** five times. F12 = Front speakers only  
 C00 = Equal sound right and left  
 R12 = Rear speakers only

2 Adjust Fader front or rear.

### CD Player Operation

**Repeat • Random • Intro Scan • Elapse (CD Display) • Pause**

**Repeat**  
 Press **RPT** to continuously repeat same track. Press again to stop repeat.

**Random**  
 Press **RDM** to play all tracks on CD in random order. Press again to stop Random play.

**Intro Scan**  
 Press **INT** to play first ten seconds of each track. Press again to stop Intro Scan and listen to track.

**CD Display**  
 Press **ELAPSE** to sequence display through track number or elapsed time.

**Pause**  
 Press **\*\*** to pause CD play.

#### Insert and Eject CD

Insert CD label side up.

Push a CD into slot. The CD will begin to play.

Press **▲** (eject) to stop CD play and eject CD from slot. Unit does not have to be turned on to eject CD from slot.

#### Fast Forward and Fast Reverse

Press **<<** or **>>** for more than one second to fast forward or fast reverse. CD play starts from when you release the button.

>1 Sec

#### Program CD Tracks

Use Program function to select up to 8 CD tracks to play in any order. Program works by allowing you to select a track number for each spot in the playing sequence. A CD must be inserted to use Program.

#### Repeat Selection (RPT A-B)

The Repeat A-B function allows you to continuously repeat a selection of music.

1 Press **RPT A-B** to set the beginning point (A).

2 Press **RPT A-B** again to set the end point (B).

The chosen selection of music will repeat over and over until **RPT A-B** is pressed again.

1 Press **<<** or **>>** to choose track number.

2 Press **MEM/CLR** to enter track number into memory. Display shows next track number in sequence. Continue (up to 8 times) for all desired tracks.

3 Press **PGM** to play CD in programmed order.

**Note**

- Do not expose CD player to extremely high or low temperatures.
- Do not drive with ejected CD in the slot.

### Clock Priority

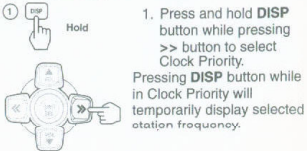

1. Press and hold **DISP** button while pressing **>>** button to select Clock Priority. Pressing **DISP** button while in Clock Priority will temporarily display selected station frequency.

### In CD Mode

When the display priority is set to clock, the clock will be displayed indicating the current time. Pressing **DISP** button will temporarily display CD track number, time remaining or elapsed time depending on current CD display option selected. After five seconds the display will return to the clock.

### Frequency Priority

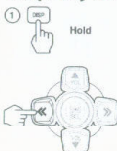

1. Press and hold **DISP** button while pressing **<<** button to select Frequency Priority. Pressing **DISP** button while in Frequency Priority will temporarily display clock.

### In CD Mode

When the display priority is set to frequency, display indicates CD track number or elapsed time, depending on current CD display option selected. Pressing **DISP** button will temporarily display clock. After five seconds the display will return to the CD display.

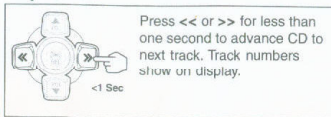

Press **<<** or **>>** for less than one second to advance CD to next track. Track numbers show on display.

## Remote Control



The Remote Control will allow you to control the basic functions of the CD3010X. The CD3010X is also compatible with the Jensen IR20 steering wheel remote control. (Purchased separately.)



Jensen CD3010X Remote Control

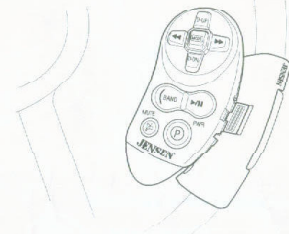

Jensen IR20 Remote Control

### Set the Clock

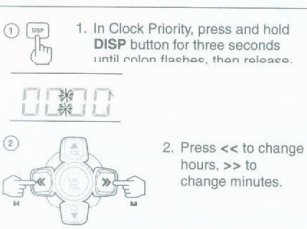

### Auxiliary Input

**Auxiliary Input Mode**  
Press **AUX** to access Auxiliary Input Mode. (Only available if an auxiliary audio device is plugged into the Auxiliary Input Jack.)

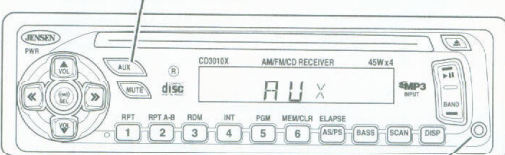

**Auxiliary Input Jack**  
Allows you to listen to an auxiliary audio source (MP3, portable cassette player, etc.). Plug audio device into unit.

### Removing Radio from Dash

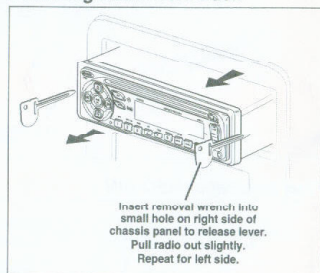

Insert removal wrench into small hole on right side of chassis panel to release lever. Pull radio out slightly. Repeat for left side.

## Specifications

<b>CD Player</b>	
Signal/noise ratio .....	>86 dB
Frequency response .....	20 Hz - 20 kHz
Channel separation .....	>85 dB
D/A converter .....	1 Bit/CH
<b>FM Tuner</b>	
Tuning range .....	87.5 MHz-107.9 MHz
FM mono sensitivity .....	12 dBµV
FM stereo sensitivity (stereo) .....	16 dBµV
Stereo separation @ 1 kHz .....	40 dB
<b>AM Tuner</b>	
Tuning range .....	530 kHz-1720 kHz
<b>Amplifier</b>	
Total system power .....	180 watts peak
Power output .....	4 x 45W
<b>General</b>	
Power supply .....	11-16 VDC, negative ground
Speaker output impedance .....	4-8 Ohms
Fuse .....	10 amp fast blow ATO
Dimensions .....	7" x 7" x 2" (178mm x 178mm x 55mm)
Specifications subject to change without notice.	

## Radio Operation

### Select a Band



Press **BAND** button to change radio between three FM bands and two AM bands. Each band stores up to six preset stations.

### Tuning

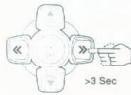

#### Seek Tuning

Press a << or >> button for more than three seconds to move radio frequency number up or down one step.

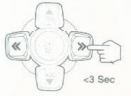

#### Manual Tuning

Press a << or >> button for less than three seconds to move to next station automatically.

### Automatically Store Stations



Select six strong stations and store them in the current band.

1. Select a band (if needed).
2. Press **AS/PS** button for more than three seconds. The new stations replace stations already stored in that band.

### Preset Scan



Scan stations stored in the current band.

1. Select a band (if needed).
2. Press **AS/PS** button for less than three seconds. Radio pauses for ten seconds at each preset station. Press **AS/PS** again to stop scanning when desired station is reached.

### Preset Stations

Six numbered preset buttons store and recall stations for each band.



#### Store a station:

1. Select a band (if needed).
2. Select a station.
3. Hold a preset button for three seconds. Preset number will appear in the display.



#### Recall a station:

1. Select a band (if needed).
2. Press a preset button to select stored station.

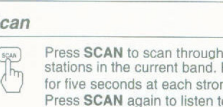

### Scan



Press **SCAN** to scan through strong stations in the current band. Radio pauses for five seconds at each strong station. Press **SCAN** again to listen to current

## WARRANTY

### 90 DAY / 12 MONTH LIMITED WARRANTY

AUDIOVOX SPECIALIZED APPLICATIONS, LLC (the Company) warrants to the original retail purchaser of this product that should this product or any part thereof, under normal use and conditions, be proven defective in material or workmanship within 90 days from the date of original purchase, such defect(s) will be repaired or replaced (at the Company's option) without charge for parts and repair labor. After the initial 90 day period and for a period of 12 months from the date of the original purchase, the Company will supply at no charge a replacement for any defective part(s).

To obtain repair or replacement within the terms of this warranty, the end user should contact the O.E.M. The product is to be delivered to the OEM or original place of purchase, with proof of warranty coverage (e.g. dated bill of sale, and serial number of the unit, and vin#), specification of defect(s), transportation prepaid, to an approved warranty station.

This warranty does not extend to the elimination of externally generated static or noise, to the correction of antenna problems, to costs incurred for removal or reinstallation of the product, or to damage to any tapes, cd's, dvd's, speakers, accessories, or electrical systems.

This warranty does not apply to any product or part thereof which, in the opinion of the Company, has been damaged through alteration, improper installation, mishandling, misuse, neglect, or accident.

THE EXTENT OF THE COMPANY'S LIABILITY UNDER THIS WARRANTY IS LIMITED TO THE REPAIR OR REPLACEMENT PROVIDED ABOVE. AND, IN NO EVENT, SHALL THE COMPANY'S LIABILITY EXCEED THE PURCHASE PRICE PAID BY THE PURCHASER FOR THE PRODUCT.

This warranty is in lieu of all other express warranties or liabilities. ANY IMPLIED WARRANTIES, INCLUDING ANY IMPLIED WARRANTY OF MERCHANTABILITY, SHALL BE LIMITED TO THE DURATION OF THIS WARRANTY. ANY ACTION FOR BREACH OF ANY WARRANTY HEREUNDER INCLUDING ANY IMPLIED WARRANTY OF MERCHANTABILITY MUST BE BROUGHT WITHIN A PERIOD OF 30 DAYS FROM THE DATE OF ORIGINAL PURCHASE. IN NO CASE SHALL THE COMPANY BE LIABLE FOR ANY CONSEQUENTIAL OR INCIDENTAL DAMAGES FOR BREACH OF THIS OR ANY OTHER WARRANTY, EXPRESS OR IMPLIED WHATSOEVER. No person or representative is authorized to assume for the Company any liability other than expressed herein in connection with the sale of this product.

Some states do not allow limitations on how long an implied warranty lasts or the exclusion or limitation of incidental or consequential damages so the above limitations or exclusions may not apply to you. This warranty gives you specific legal rights and you may also have other rights which vary from state to state.

AUDIOVOX SPECIALIZED APPLICATIONS, LLC.  
Visit us at [www.aselectronics.com](http://www.aselectronics.com)

# JENSEN® Installation

## How to Install the CD3010X AM/FM Stereo Radio/Compact Disc Player with Remote Control and Auxiliary Input Jack

### Welcome!

For your Jensen stereo to work right, it must be installed correctly. This manual will show you how to install your new stereo like a pro. It's a good idea to read all of these instructions before you begin the installation. Most installations are straightforward and can be handled by a do-it-yourselfer with the right tools and patience. But, do-it-yourself installation isn't for everyone. You may want to turn the installation job over to an experienced installer.

### Warranty Service

If your Jensen stereo should ever require service, you will need to have the original dated receipt. If you ever need to return the unit for any reason, always include the receipt with the product.

## 1. Before You Begin Installation

### Tools and Supplies Needed

- Torx type, Flat and Phillips screwdrivers
- Wire cutters and strippers
- Tools to remove existing radio (screw driver, socket wrench set or other tools)
- Radio removal tool for Ford cars (early 1980s models and newer)
- Electrical tape
- Crimping tool
- Volt meter/Test light
- Crimp connections
- 18 gauge wire for power connections
- 16-18 gauge speaker wire

### Speaker Requirements

Only connect the CD3010X to speakers rated in the load impedance range of 4 to 8 ohms. Speakers with a load impedance less than 4 ohms could damage the CD3010X.

### Disconnect Battery

Before you begin, always disconnect the battery negative terminal.



## 2. Preparation

### Radio

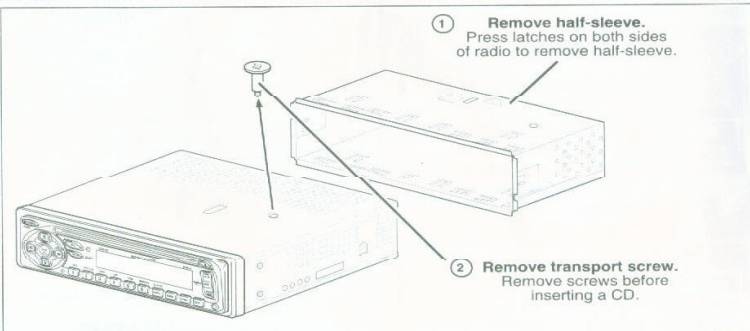

### Remove Old Radio

Standard Bracket Mounted (GM, Dodge, Jeeps)

## 3. Wiring

### Wiring with a Wiring Adapter (Purchase Separately)

#### Connect Wires

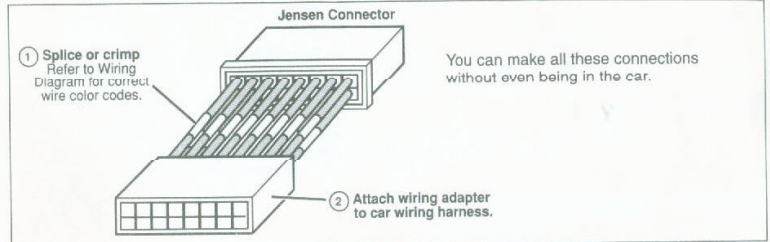

### Wiring Diagram

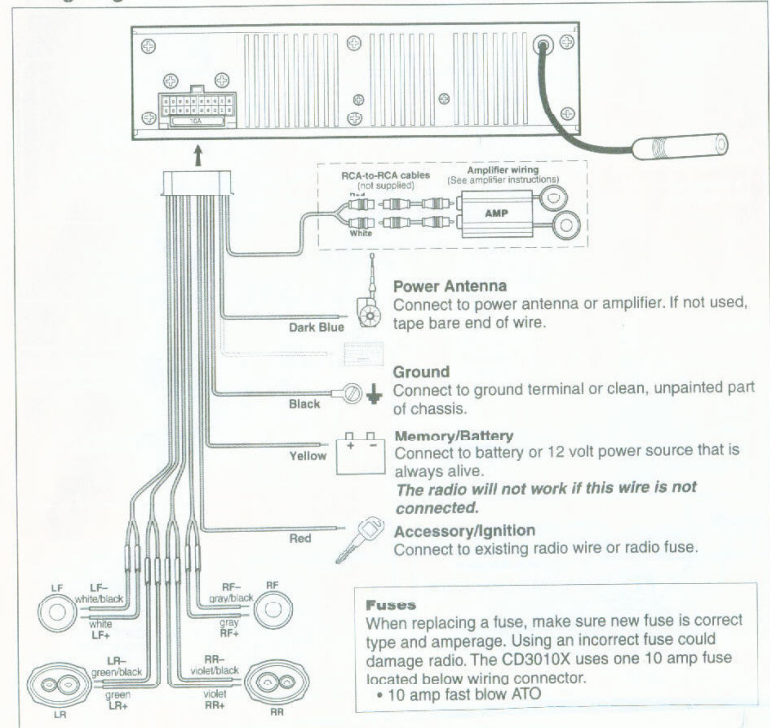

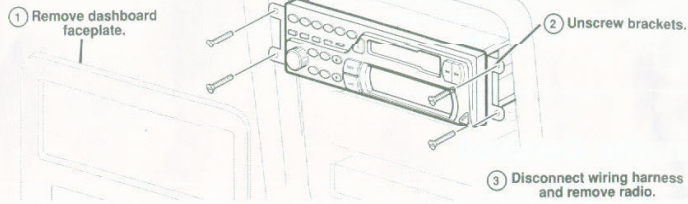

#### Front Load Mount

Some cars use a special removal tool to release the radio (Ford and Mercury).

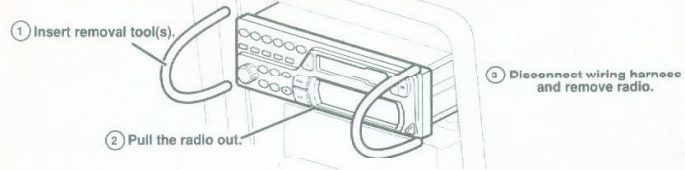

#### Replacing an Aftermarket Radio

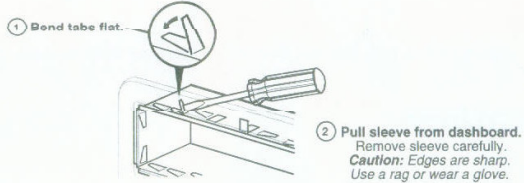

#### Import Type Mount

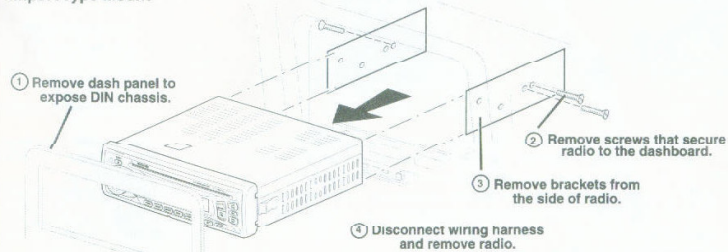

#### Install Half-sleeve

#### Reconnect Battery

When wiring is complete, reconnect the battery negative terminal.



## 4. Final Installation

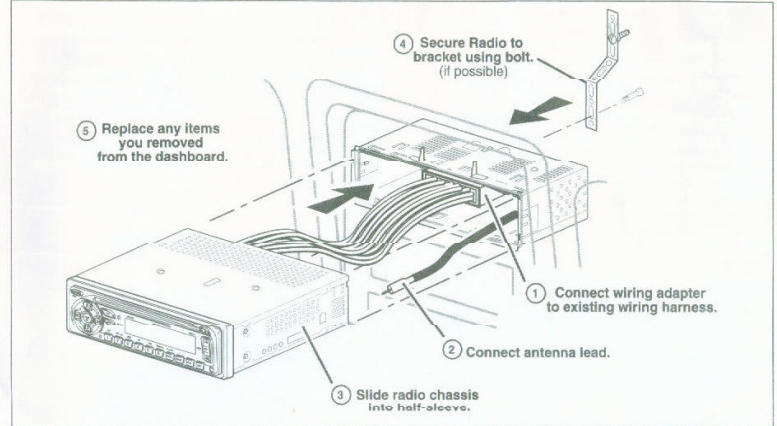

#### Final Installation—ISO-DIN

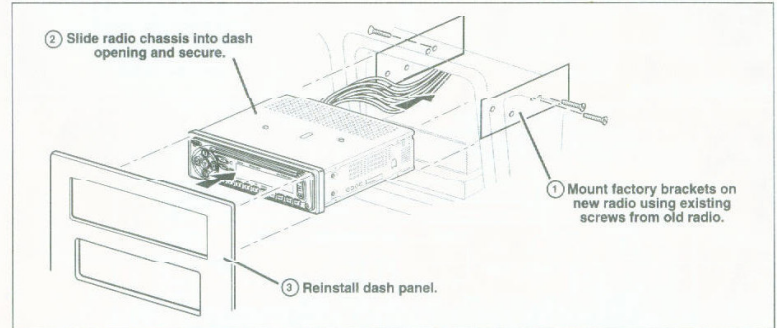

## 5. Troubleshooting

Problem	Cause	Corrective Action
---------	-------	-------------------

### Install Half-sleeve

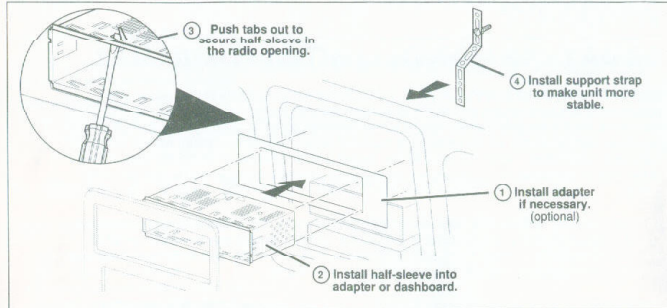

### Set Frequency Spacing Switch

There is a selectable frequency spacing switch on the bottom of the unit. Before installing the unit into the dashboard, confirm that the switch is set to the correct setting for your area of operation.



Problem	Cause	Corrective Action
Does not operate (display does not light)	No power to yellow wire No power to red wire Inline fuse blown	Check connection with test light. Check vehicle fuse with test light. Replace fuse.
No power to unit	Inline fuse blown	Check/replace fuse.
No speakers operate (display lights normally)	Speaker harness not connected	Connect speaker harness. Check speaker wires.
Not all speakers operate	Incorrect splices or connections Speaker wires shorting to chassis ground or to each other	Check all splices and connections. Check splices, insulate all bare wires.
Blown fuses	Power wire shorting to ground Speaker wires shorting to ground Incorrect fuse/fuse too small	Make sure wire is not pinched. Make sure wire is not pinched. Install fuse of correct rating.
ER-2 appears on display	Disc loading malfunction	Press <b>RESET</b> button. Insert disc and try again.
ER-3 appears on display	Disc eject malfunction	Press <b>RESET</b> button. Insert disc and try again.
ER-4, ER-7, ER-8 appears on display	Disc reading malfunction	Try a different disc. The disc may be damaged or dirty.
FR-5, FR-6 appears on display	Track change malfunction	Press <b>RESET</b> button. Insert disc and try again.
CD skips too much	Receiver mount is not solid or backstrap is not secure	Check mounting and backstrap, tighten if needed.

## Free Manuals Download Website

<http://myh66.com>

<http://usermanuals.us>

<http://www.somanuals.com>

<http://www.4manuals.cc>

<http://www.manual-lib.com>

<http://www.404manual.com>

<http://www.luxmanual.com>

<http://aubethermostatmanual.com>

Golf course search by state

<http://golfingnear.com>

Email search by domain

<http://emailbydomain.com>

Auto manuals search

<http://auto.somanuals.com>

TV manuals search

<http://tv.somanuals.com>