



Audiobahn®

AT60J / AT61J

OWNER'S MANUAL



PLEASE READ THIS MANUAL
BEFORE OPERATING THIS UNIT.
RETAIN FOR FUTURE REFERENCE.

The Audiobahn Way

To bring the product to market that excites the consumer through sound and vision from an orientation of integrity and customer service. We make you look as good as you sound. We strive to take car audio to an extreme the world has never seen, and a world that never stops evolving.

Audiobahn was established in 1997 with one long-term goal in mind, "Build it Bigger, Badder, & Better, and the people will take notice!" We back this statement with an engineering team that has brought home several Innovations, Design & Engineering Showcase Awards, and a marketing team from around the world that spends countless hours developing our no compromise products to satisfy the most discriminating enthusiasts.

Our global manufacturing facilities feature ISO9002 ratings (the highest level of quality control awarded in the electronics manufacturing industry), fully robotic assembly lines and a state of the art, California based R & D laboratory.

Our Technical Department and entire staff look to strive above and beyond the rest of the pack by going that extra mile to help you out. Whether you happen to be a veteran competitor, or a beginner car audio enthusiast who does not know a voice coil from a spider. We are all her to help you get the best system you can with what you have.

Judge for yourself, and remember what it's all about, "If it's not Bigger, Badder & Better, it's not Audiobahn." If audio is your life, Audiobahn is the brand for you! We make you look as good as you sound. People never stop trying to get the best product, so we will never stop making it.

Getting Started_____	2
Introduction_____	3
Specifications_____	4
Wiring_____	5
Installation_____	6-8
Troubleshooting_____	9
Warning and Disclaimer_____	10
Warranty_____	11-12
Notes_____	13-14

Getting Started

Welcome to Audiobahn.. This manual has been designed to provide information for the owners, salesperson, and installer. For those of you who want quick information on how to install this product, please turn to the installation section of this manual. Other information can be located by using the table of contents. We at Audiobahn have worked very hard to make sure that all information in this manual is current, but, as we are constantly finding new ways to improve our product, this information is subject to change without notice. All updated information can be found on our web page in the technical support section.

Dear Customer,

Congratulations on your purchase of the worlds finest brand of car audio products. Here at Audiobahn Inc. we are devoted to making our musical reproduction the vert best, and we are pleased you have chosen our product. Through years of engineering expertise, hand craftsmanship, and critical testing procedures, we have created a wide range of products that reproduce music with all the clarity and richness you deserve.

For maximum performance we recommend you have your Audiobahn product installed by an Authorized Audiobahn Dealer, as we provide specialized training through our Audiobahn Installer Training Programs. Please read your warranty, keep your receipt, and original carton for possible future use.

To get a free brochure on Audiobahn products in the US call (714) 452-1476 or e-mail us at sales@audiobahn.com.

WARNING

Continuous exposure to sound pressure levels over 100dB may cause permanent hearing loss. High powered autosound systems may produce sound pressure levels well over 135dB. Need we say more! Use common sense.

If after reading this manual you still have questions regarding your product, we recommend that you see your nearest Audiobahn Dealer. A list of Authorized Audiobahn Dealers can be found on our web page. If you need further assistance, feel free to call us at (714) 452-1476 and ask for the Technical Department. Be sure to have the model number, date of purchase, and invoice number available when you call.

The model number can be located on the outside of the carton. Record this in the space provided below along with the date of purchase. It is a good idea to keep your receipt with this as you will need it in the case of needing a warranty, repair service or exchange.

Date of Purchase: _____ Model Number: _____

AT60J

BLACK STEEL CASE
FERRO FLUID COOLED, HIGH-FLUX NEODYMIUM MAGNET
FLUSH, SURFACE AND FLEX MOUNT HARDWARE
12dB CROSSOVER WITH AUDIOPHILE GRADE CAPACITORS
AND POLYSWITCH PROTECTION
4 OHM IMPEDANCE
FREQUENCY RESPONSE: 2kHz - 22kHz
POWER HANDLING 100 WATTS RMS PER PAIR
SENSITIVITY 90dB 1W / 1M

AT61J

BLACK STEEL CASE
FERRO FLUID COOLED, HIGH-FLUX NEODYMIUM MAGNET
FLUSH AND ANGLE SURFACE MOUNT HARDWARE
12dB CROSSOVER WITH AUDIOPHILE GRADE CAPACITORS
AND POLYSWITCH PROTECTION
4 OHM IMPEDANCE
FREQUENCY RESPONSE: 2.5kHz - 25kHz
POWER HANDLING 100 WATTS RMS PER PAIR
SENSITIVITY 90dB 1W / 1M

Audiobahn recommends using at least 18-gauge wire with your new speaker system. Thinner gauge wire may easily be severed and can cause damage to your system should any bare wires come in contact with the vehicles chassis.

Makes sure that your audio system is off while installing and connecting your new Audiobahn Speakers. Failure to do so could result in damaging the speaker beyond repair. This is not something that would be covered under the manufacturer warranty.

Be sure to route the wires to the speakers with the insulated terminal ending at the speaker. This will insure a good contact with the speaker. If you need to shorten the speaker lead, do so on the opposite end of the insulated terminals or the bare end.

Be sure the polarity is correct at all times. The speaker leads are color coded for negative and positive. Make sure that the leads connected to the positive terminal of your amplifier or source unit is correctly connected to the positive terminal of the speaker.

To insure long-term reliability all bare wires and wire-to-wire connections should be soldered and insulated with heat shrink or electricians tape. Under no circumstances should you leave any bare wires uncovered, as this can and will lead to the failure of your speakers and possibly other components.

When mounting in a door it is imperative to have the right amount of slack in the connecting wire as to not get crimped or torn when the door is opened or closed. Avoid areas of the door jam that pinch. This will cause damage to the speaker and other components over long-term use.

Once the speaker wiring is complete, you can connect the opposite end to the amplifier or source unit. Again, be sure to observe correct polarity. Solder and wrap all stripped connections.

(AT60J MODEL ONLY)

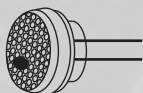
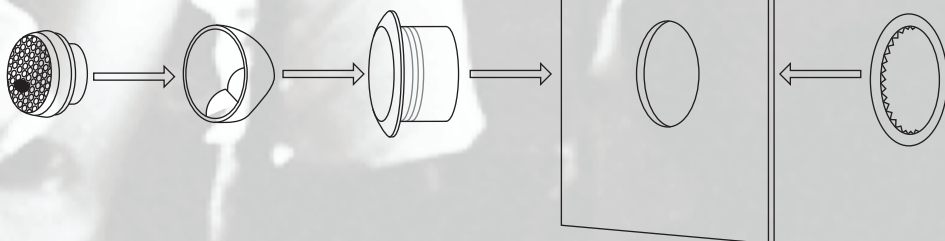
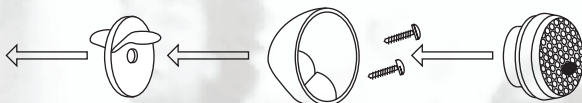
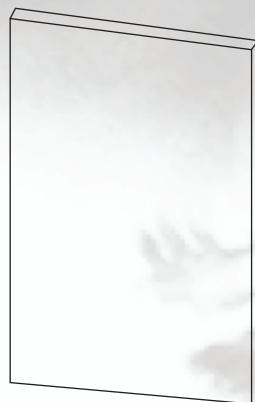
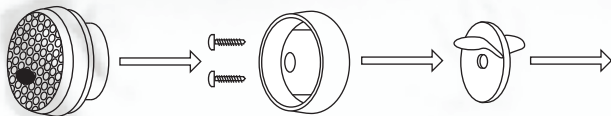

Angled Surface Mount

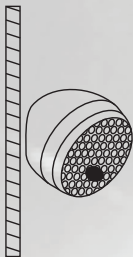

This will allow you to mount your tweeter on the surface and give you the ability to have the tweeter facing in almost any direction that you desire.

1. You will need to remove the center part of the double sided sticky tape
2. Remove one side of the protective backing of the tape and place it on the back of the angled mounting piece
3. Locate the proper position that you would like to mount the tweeter, then remove the protective backing on the sticky tape and place the tweeter where needed
4. Drill a 3/8" hole for the wire if needed
5. It is recommended to use the two supplied screws to mount the angle piece down due to the vibrations from the vehicle

ONLY FOR AT60J Surface Mount

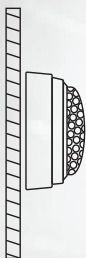

This will allow you to mount your tweeter on the surface and allow you not to have to cut a large hole in your vehicle

1. You will need to remove the center part of the double sided sticky tape
2. Remove one side of the protective backing of the tape and place it on the back of the angled mounting piece
3. Locate the proper position that you would like to mount the tweeter, then remove the protective backing on the sticky tape and place the tweeter where needed
4. Drill a 3/8" hole for the wire if needed
5. It is recommended to use the two supplied screws to mount the angle piece down due to the vibrations from the vehicle

Flush Mount



This will allow you to mount your tweeter flush with the panel and have the tweeter look like it came from the dealer.

1. First find a location that you would like to mount the tweeter
2. Draw a small dot on the location of each tweeter and make sure that both tweeters are mounted equally
3. Remove panel and double check that there is enough room behind the panel for the tweeter (At least 1" depth and 1 1/2" diameter)
4. Drill a 1 1/2" hole for the supplied flush mount cup
5. insert the flush mount cup and make sure that it fits in to the hole that you just have drilled
6. Use the supplied pressure ring behind the panel to finalized the mounting of the flush mount cup
7. Make sure when you insert the tweeter into the flush mount cup that you first put the "angled surface mount cup" on the tweeter. This will allow you to create a 360 degree swivel mount on the tweeter

Wiring the tweeter to the crossover

The crossover will allow the tweeter to play the correct frequencies without sending harmful low frequencies to the tweeter.

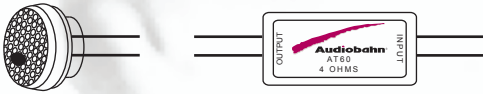

1. Make sure that you match the solid blue wire with the solid blue wire (Positive)
2. Make sure that you match the blue with black wire to the blue with black wire (Negative)

Back of Tweeter



If you are looking at the back of any of our Audiobahn tweeters, the right wire is your positive (+) and the left wire is your negative (-) wire.

In the event that your Audiobahn speakers appear to require service we ask that you first do a little troubleshooting to determine if the problem is actually the speaker, or a problem located in a different part of the vehicle such as the amplifier, wiring, fusing or possibly the source unit.

If your Audiobahn speakers have been installed professionally by an authorized Audiobahn Dealer, we recommend that you return to the dealer and demonstrate the problem to a qualified installer or repair technician. If you installed the speaker yourself, use the following guidelines to help find the problem.

1) No Sound

- *Check the source or amplifier for power and be sure they are operating properly
- *Check all signal connections
- *Check for any wiring that may be shorting together or touching the metal chassis
- *Check all ground connections

2) Distorted Sound at All Volumes

- *Check for bad speaker connections
- *Check wiring for correct polarity

3) Distorted Sound at High Volumes Only

- *Check for loose mounting of the speaker
- *Check the woofer cone for any damage or defects
- *Inspect the speaker for debris in the cone or other obstructions

4) Poor Bass Response

- *Check wiring for correct polarity
- *Check for unstable or loose mounting surface
- *Check bass & treble controls at the source unit or amplifier

5) Poor High Frequency Response

- *Check wiring for correct polarity

Investigate the layout of your automobile thoroughly before drilling or cutting any holes. Take care when you work near gas tanks, gas lines, hydraulic lines, and electrical wiring. Do not use the power amplifier unmounted. Attach the system securely to the automobile to prevent damage, particularly in the event of an accident. Do not mount the system so that the wire connections are unprotected or are subject to pinching or damage from nearby objects.

The +12V DC power wire must be fused at the battery positive terminal connection. Before making or breaking power connections at the system power terminals, disconnect the +12V wire at the battery end. Confirm your radio/head unit and/or other equipment is turned off while connecting the input jacks and speaker terminals. If you need to replace the power fuse, replace it only with a fuse identical to that supplied with the system. Using a fuse of a different type or rating may result in damage to this system which is not covered by the warranty.

Disclaimer

Specifications are subject to change without notice.
For the most updated Specifications call Audiobahn,
your local Authorized Audiobahn Dealer,
or check the Audiobahn web site.
www.audiobahn.com

Audiobahn Consumer Product Warranty Policy

Audiobahn products are manufactured with the highest quality components and some of the most advanced technology available. Because of this we recommend that you have your new products installed by an **Authorized Audiobahn Dealer**. (A list of Authorized Audiobahn Dealers can be found on our web page).

Warranty Period: One year from the original date of purchase.

Warranty Coverage: This warranty covers manufacturer defects only. The warranty is applicable to the original purchaser, and is non-transferable. You must provide a receipt from an **Authorized Audiobahn Dealer** that shows the location of purchase, price paid, and date of purchase.

(Products purchased by consumers from an **Authorized Audiobahn Dealer** outside the United States are covered only by the Distributor of that specific country and are not covered by **Audiobahn**).

NOTES:

Complete subwoofer enclosures (**Audiobahn** will replace defective subwoofers, plexiglass, or neon only. Do not send the entire enclosure, unless the enclosure is defective itself. You must receive prior authorization and an RA# before sending in any complete enclosure).

AUDIOBAHN DOES NOT WARRANTY ANY PRODUCTS NOT PURCHASED THROUGH AN AUTHORIZED DEALER.

(A list of Authorized Audiobahn Dealers can be found on our web page).

AUDIOBAHN WARRANTIES DO NOT COVER THE FOLLOWING:

- Any product not purchased from an **Authorized Audiobahn Dealer** (including Internet dealers)
- Damage caused by abuse, misuse, accident, water / flood, or theft (including any cosmetic damage to the body of the product)
- Damage caused by improper installation
- Any cost or expense related to removal or reinstallation
- Any unauthorized services
- Any product that has the serial number removed, altered, or defaced
- Subsequent damage to any other components
- Pinched, cut, or stripped wires / terminals
- Any product that is new, and/or found to be in working condition
- L.E.D. indicators on electronics (**Audiobahn** will only replace L.E.D.(s) found to be defective at the time of purchase)

How to receive warranty service: Contact your local **Authorized Audiobahn Dealer**, or call **Audiobahn** at **(714) 452.1476** between the hours of 9:00AM and 5:00PM PST.

If you are having problems with your system, we recommend you check the product carefully and thoroughly to confirm that the product truly has a manufacturer defect; as opposed to abuse, or other components in the system caused the failure. This might include having an **Authorized Audiobahn Dealer** look at the product to confirm the source of the problem. Any product found to have a manufacturer defect will be replaced with a new piece of the same or similar model, or repaired at the discretion of **Audiobahn**. Any product found to have no manufacturer defect will be returned to the sender at their cost.

You must acquire a Return Authorization Number (#) prior to returning ANY product to Audiobahn. That Return Authorization Number (RA#) must be prominently and clearly marked on the outside of the shipping carton, or product delivery will be refused (no exceptions will be made).

Please note: All shipping and handling (to and from) charges will be the sole responsibility of the consumer.

Please record and keep your Return Authorization Number (RA#) in the event that further communication is required.

Return Authorization Number (RA#): _____

Date product was sent: _____

Contact Information

Audiobahn Headquarters
7050 Village Drive Bldg. G
Buena Park, CA 90621
Phone (714) 452.1476 Fax (888) 880.8469
Pacific Coast Time: 9am - 5pm Mon. - Fri.
tech@audiobahn.com



Audiobahn

7050 Village Drive, Bldg G
Buena Park, CA 90621

714-452-1476 office
888-880-8469 fax

info@audiobahn.com

PROUD SPONSOR OF



MEMBER



Audiobahn.com

Follow us on Facebook and Twitter



Free Manuals Download Website

<http://myh66.com>

<http://usermanuals.us>

<http://www.somanuals.com>

<http://www.4manuals.cc>

<http://www.manual-lib.com>

<http://www.404manual.com>

<http://www.luxmanual.com>

<http://aubethermostatmanual.com>

Golf course search by state

<http://golfingnear.com>

Email search by domain

<http://emailbydomain.com>

Auto manuals search

<http://auto.somanuals.com>

TV manuals search

<http://tv.somanuals.com>