



# SwitchView<sup>®</sup>

Control your entire desktop with  
SwitchView KVM switches

SwitchView Desktop KVM Switches

## THE EASE OF **KVM Switching**



Avocent SwitchView desktop KVM switches offer the most complete KVM switching features for today's desktop.

With compact, space-saving designs, these switches let you easily share access to multi-platform computers, and other desktop devices. You can even connect your digital cameras, PDAs, printers and scanners to a single switch. The SwitchView series of switches adds control and flexibility to your desktop.





## SwitchView Desktop Switches at a Glance

	Users	Computers	Platforms	Resolution	Key Features
<b>SwitchView PC</b>	Single	2	PC	2048 x 1536	Multiple PS/2 Computers
<b>SwitchView PC</b>	Single	4	PC	2048 x 1536	Multiple PS/2 Computers
<b>SwitchView Multimedia (USB 1.1)</b>	Single	2	PC and USB	2048 x 1536	Multiple PS/2 or USB Computers Audio support speakers and microphone
<b>SwitchView Multimedia (USB 1.1)</b>	Single	4	PC and USB	2048 x 1536	Digital Cameras, PDAs, Scanners, Printers, CD-ROMS
<b>SwitchView Multimedia (USB 2.0)</b>	Single	2	PC and USB	2048 x 1536	Digital Cameras, PDAs, Scanners, Printers, CD-ROMS
<b>SwitchView Multimedia (USB 2.0)</b>	Single	2	PC and USB	2048 x 1536	Digital Cameras, PDAs, Scanners, Printers, CD-ROMS
<b>SwitchView DVI (USB 2.0)</b>	Single	2	USB	1920 x 1200	DVI Monitors, Flat Panel Displays
<b>SwitchView DVI (USB 2.0)</b>	Single	4	USB	1920 x 1200	DVI Monitors, Flat Panel Displays



**SwitchView  
Multimedia  
switch**

# SwitchView

## Product Series



SwitchView PC switch

The Avocent **SwitchView PC** KVM desktop switches let you control up to four PS/2 computers from one keyboard, monitor and mouse. Lighted LED indicates which computer you are accessing and audible indicators confirm channel switching. With color-coded cables for easy installation, customisable channel selections and error-free boot-up, the SwitchView PC switch offers you a complete desktop KVM solution.

### SwitchView PC Highlights

- Switch through push-button or through keyboard hotkey sequence
- Auto scan among connected computers to monitor each computer's operating status
- Color-coded cables and connectors make installation quick and easy
- Error-free boot-up with keyboard and mouse emulation
- Available in 2 and 4-port models
- Supports up to four PS/2 computers
- Backed by Avocent 2 year warranty and technical support

## SwitchView Desktop KVM Switches

Save space, time and money.

SwitchView KVM desktop switches let you control up to four computers from one keyboard, monitor and mouse.





*SwitchView DVI switch*

The **SwitchView DVI (Digital Visual Interface)** KVM switches feature 1920 x 1200 video resolution and deliver crisp images for your high-end displays and flat panel monitors. The versatile SwitchView DVI KVM switch is available in 2 and 4-port models. It easily manages up to four USB DVI computers from a single USB keyboard, mouse and DVI monitor.

#### **SwitchView DVI Highlights**

- Supports high-end applications using DVI monitor or flat panel and USB PCs, Mac G3/G4, iMac
- 1920 x 1200 video resolution is ideal for desktop graphical applications
- Use push-button or multiple keyboard hotkeys for customised channel selections
- Configurable scanning among computers to monitor each computer's operating status
- Includes two USB 2.0 hub ports
- Provides independent switching of KVM and USB hub ports
- Audio support for speakers and microphones
- Backed by Avocent 2 year warranty and technical support



SwitchView Multimedia switch

The all-in-one **SwitchView MM (Multimedia)** desktop KVM switches let you switch between USB or PS/2 systems, share your USB devices and control multimedia applications. With one SwitchView Multimedia switch, you can control multiple PCs and share access to your USB devices: digital camera, CD-ROM, PDA, scanner or printer. The SwitchView Multimedia KVM switches are available in 2 and 4 port models, with USB 1.1 and USB 2.0 support.

*Note: The SwitchView Multimedia 2 port model with USB 1.1 support does not include the hub feature.*

#### SwitchView MM1 Highlights

- Provides high 2048 x 1536 video resolution
- Push-button or hotkey switching for channel selections
- Configurable scanning among computers to monitor each computer's operating status
- Audio support for speakers and microphones
- USB or PS/2 system support
- Available in 2 and 4-port models with USB 1.1 support
- Backed by Avocent 2 year warranty and technical support

#### SwitchView MM2 Highlights

- Includes a USB 2.0 built-in hub
- Provides high 2048 x 1536 video resolution
- Push-button or configurable hotkey switching for channel selections
- Configurable scanning among computers to monitor each computer's operating status
- Audio support for speakers and microphones
- USB or PS/2 system support
- Independent switching of KVM and USB hub ports
- USB multimedia keyboard support
- Available in 2 and 4-port models
- Backed by Avocent 2 year warranty and technical support

*SwitchView KVM switches include a space-saving design to fit your multi-tasking desktop. Color-coded cables and connectors make your installation fast and easy!*

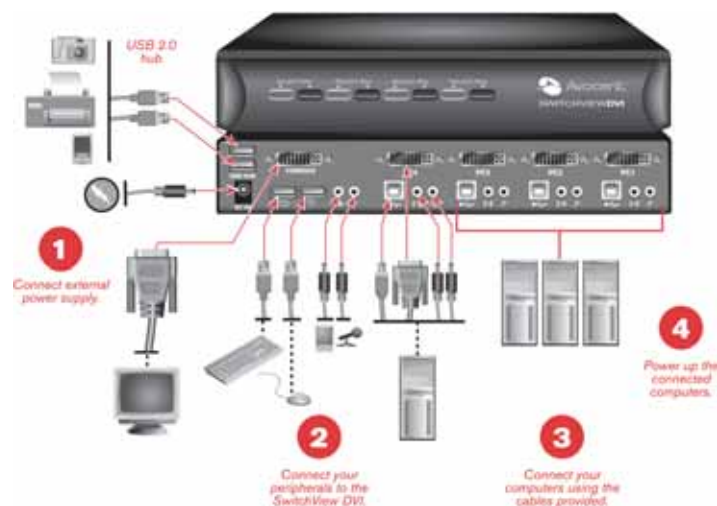

## SwitchView PC

## SwitchView DVI

## SwitchView MM1

## SwitchView MM2

## Ordering Information

### SWITCH

#### SwitchView PC

2SVP10-201	2-port PS/2 system/console
4SVP10-201	4-port PS/2 system/console

#### SwitchView MM1

4SVP10-201	2-port PS/2 USB system/console USB 1.1 hub, audio
4SVPUA10-201	4-port PS/2 USB system/console USB 1.1 hub, audio

#### SwitchView MM2

2SVPUA20-201	2-port PS/2 USB system/console USB 2.0 hub, audio
4SVPUA20-201	4-port PS/2 USB system/console USB 2.0 hub, audio

#### SwitchView DVI

2SVDVI10-201	2-port USB system/console USB 2.0 hub, audio
4SVDVI10-201	4-port USB system/console USB 2.0 hub, audio

### CABLES

#### SwitchView PC

SVP-6	6 feet PS/2 cable kit
SVP-9	9 feet PS/2 cable kit

#### SwitchView MM1/MM2

SVUSB-6	6 feet PS/2 USB audio cable kit
SVUSB-9	9 feet PS/2 USB audio cable kit

#### SwitchView DVI

SVDVI-6	6 feet DVI USB audio cable kit
SVDVI-9	9 feet DVI USB audio cable kit

### ACCESSORIES

#### SwitchView PC

SVEPS-201	9V DC @1A external transformer optional for SwitchView PC switch
-----------	---

## Switch Specifications

### SwitchView PC

MECHANICAL	Height	Width	Depth	Weight
2SVP10	1.7 in (4.3 cm)	5.0 in (12.7 cm)	3.0 in (7.62 cm)	1 lb (.45 kg)
4SVP10	1.7 in (4.3 cm)	8.0 in (20.32 cm)	3.0 in (7.62 cm)	2 lbs (.90 kg)

### ENVIRONMENTAL / POWER / HARDWARE

Power Frequency 9V DC @1A external transformer

Supported Hardware - Computer PS/2

Supported Hardware - Monitor (VGA, SVGA, XGA, QVGA, SXGA, UXGA, QXGA)  
Maximum resolution 2048 X 1536

Supported Hardware - Peripherals PS/2 keyboard, PS/2 mouse, Intellimouse (PS/2 only), IBM Scroll Point, Logitech 2 Button, Logitech Trackball Scroller, Microsoft Trackball Scroller, Microsoft Scroller, Microsoft Intelleye Five Button

### STANDARDS

Approved Agency En55022 Class B, EN55024,61000-3-2,6100-3-3, FCC 15 Class B, CE

### SwitchView DVI

MECHANICAL	Height	Width	Depth	Weight
2SVDVI10	1.7 in (4.3 cm)	6.5 in (16.51 cm)	4.0 in (10.16 cm)	2 lbs (.90 kg)
4SVDVI10	1.7 in (4.3 cm)	10 in (25.4 cm)	4.6 in (11.68 cm)	3 lbs (1.36 kg)

### ENVIRONMENTAL / POWER / HARDWARE

Power Frequency 9V DC @1A external transformer

Supported Hardware - Computer USB (2.0)

Supported Hardware - Monitor DVI - Maximum resolution 1600 x 1200

Supported Hardware - Peripherals USB (2.0) keyboard and mouse

### STANDARDS

Approved Agency En55022 Class B, EN55024,61000-3-2,6100-3-3, FCC 15 Class B, CE

### SwitchView MM1

MECHANICAL	Height	Width	Depth	Weight
2SVPUA10	1.7 in (4.3 cm)	5.5 in (13.97 cm)	3.5 in (8.89 cm)	1 lb (.45 kg)
4SVPUA10	1.7 in (4.3 cm)	8.7 in (22.09 cm)	4.0 in (10.16 cm)	2 lbs (.90 kg)

### ENVIRONMENTAL / POWER / HARDWARE

Power Frequency 9V DC @1A external transformer

Supported Hardware - Computer PS/2

Supported Hardware - Monitor (VGA, SVGA, XGA, QVGA, SXGA, UXGA, QXGA)  
Maximum resolution 2048 X 1536

Supported Hardware - Peripherals PS/2 keyboard, PS/2 mouse, Intellimouse (PS/2 only), IBM Scroll Point, Logitech 2 Button, Logitech Trackball Scroller, Microsoft Trackball Scroller, Microsoft Scroller, Microsoft Intelleye Five Button

### STANDARDS

Approved Agency En55022 Class B, EN55024,61000-3-2,6100-3-3, FCC 15 Class B, CE

### SwitchView MM2

MECHANICAL	Height	Width	Depth	Weight
2SVPUA20	1.7 in (4.3 cm)	5.5 in (13.97 cm)	3.5 in (8.89 cm)	1 lb (.45 kg)
4SVPUA20	1.7 in (4.3 cm)	8.7 in (22.09 cm)	4.0 in (10.16 cm)	2 lbs (.90 kg)

### ENVIRONMENTAL / POWER / HARDWARE

Power Frequency 9V DC @1A external transformer

Supported Hardware - Computer PS/2

Supported Hardware - Monitor (VGA, SVGA, XGA, QVGA, SXGA, UXGA, QXGA)  
Maximum resolution 2048 X 1536

Supported Hardware - Peripherals PS/2 keyboard, PS/2 mouse, Intellimouse (PS/2 only), IBM Scroll Point, Logitech 2 Button, Logitech Trackball Scroller, Microsoft Trackball Scroller, Microsoft Scroller, Microsoft Intelleye Five Button

### STANDARDS

Approved Agency En55022 Class B, EN55024,61000-3-2,6100-3-3, FCC 15 Class B, CE

# THE EASE OF KVM Switching



## SwitchView PC

Easily control up to four PS/2 computers from one keyboard, monitor and mouse.



## SwitchView Multimedia

Switch between USB or PS/2 systems, share your USB devices and control multimedia applications.



## SwitchView DVI

Manage up to four USB DVI computers from a single USB keyboard, mouse and DVI monitor.

## About Avocent

Avocent is the leading global provider of KVM switching and network connectivity solutions with more than two decades of experience in providing KVM switching, remote access and serial connectivity solutions. KVM switching systems eliminate the need for extra keyboards, monitors and mice and allow businesses to save critical space on the desktop and in data centres.

Avocent KVM and related solutions are installed in home offices, small businesses, Fortune 100 companies and other client sites around the world. Customers include Microsoft Corp., Intel, HP, Dell, Time Warner, GE, Exxon Mobile, FedEx and Home Depot, among others.

Avocent stock is traded as AVCT on the NASDAQ Stock Market. More information on Avocent is available at [www.avocent.com](http://www.avocent.com).

Avocent International Ltd  
Building A  
Trinity Court  
Wokingham Road  
Bracknell  
Berks RG421PL  
UK  
Tel: +44(0) 1344668 049  
Fax: +44(0) 1344668 149  
[www.avocent.co.uk](http://www.avocent.co.uk)

Avocent International Ltd  
Avocent House  
Shannon Free Zone  
Shannon, Co. Clare  
Ireland  
Tel: +353 (0) 61471877  
Fax: +353 (0) 61471871  
[www.avocent-europe.com](http://www.avocent-europe.com)

Avocent International -  
Cyclades Spain  
C/ Pena Gorbea 2, 40  
28053 Madrid  
Espana  
Tel: +34 (0) 91-478 6970  
Fax: +34 (0) 91-478 2956

Avocent International Ltd  
Rennweg 33  
85435 Erding  
Germany  
Tel: +49 (0) 8122 90999-99  
Fax: +49 (0) 8122 90999-33  
[www.avocent.de](http://www.avocent.de)

Avocent International Ltd  
Les collines de l'Arche  
76 route de la demi-lune  
Opéra E  
92057 Paris La Défense Cedex  
France  
Tel: +33 (0) 149 03 42 42  
Fax: +33 (0) 149 03 01 42  
[www.avocent.fr](http://www.avocent.fr)

Avocent International Ltd  
via Novara 31  
20147 Milano  
Italia  
Phone: +39 02 4079884  
Fax: +39 02 48759763  
[www.avocent.it](http://www.avocent.it)

Avocent International Ltd  
Regus Business Centre,  
Smolensky Passage  
Smolenskaya Square 3  
Moscow 121099  
Russia  
Tel: +7(095) 9378429  
Fax: +7(095) 9378290  
[www.avocent.ru](http://www.avocent.ru)

Avocent International Ltd  
Schillingweg 79  
2153 PL Nieuw Vennep  
The Netherlands  
Tel: +31 (0)252688580  
Fax: +31 (0)252688835  
[www.avocent.nl](http://www.avocent.nl)

Avocent International Ltd  
Propellervägen 4A  
S-183 62 Täby  
Sweden  
Tel: +46 8 505 571 55  
Fax: +46 8 505 571 01  
[www.avocent.se](http://www.avocent.se)

Avocent International Ltd  
Pegasus Park  
Pegasuslaan 5  
1831 Diegem  
Brussels, Belgium  
Tel: +322709 2929  
Fax: +322709 2222  
[www.avocent.be](http://www.avocent.be)



Corporate Headquarters  
4991 Corporate Drive, Huntsville, AL 35805  
TEL 866.286.2368 FAX 256.430.4030  
[www.avocent.com](http://www.avocent.com)

Avocent, the Avocent logo, The Power of Being There and SwitchView are registered trademarks of Avocent Corporation or its affiliates. All other marks are the property of their respective owners. Copyright 2005. Avocent Corporation.

1105-SV-BRO



## Free Manuals Download Website

<http://myh66.com>

<http://usermanuals.us>

<http://www.somanuals.com>

<http://www.4manuals.cc>

<http://www.manual-lib.com>

<http://www.404manual.com>

<http://www.luxmanual.com>

<http://aubethermostatmanual.com>

Golf course search by state

<http://golfingnear.com>

Email search by domain

<http://emailbydomain.com>

Auto manuals search

<http://auto.somanuals.com>

TV manuals search

<http://tv.somanuals.com>