

PRADINES®

# Lopper range

P14 P-SL P16 P160 P332 P172 P180 P19

# Viticulture



## P16 P16-40, P16-50, P16-60

Bypass lopper for pruning and training all kinds of vines. Blade with two different edge radii to benefit from powerful and smooth cut. Very robust forged counter blade.

**Cut capacity :** 30 mm / 1 1/4  
**Sizes :** 40, 50, 60 or 70 cm

### Lockable center Bolt

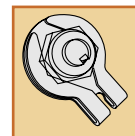

- No possible loosening while cutting



## Ultra-Light P-SL P-SL-40, P-SL-45, P-SL-60 :

Bypass Ultra light lopper for pruning and training of vines. Narrow cutting head for easy access and quick cuts. Very robust forged counter blade with sap chamber. In-tube assembled blade and counter blade for easy maintenance and weight reduction. Soft buffers together with long and thin grips makes the tool very comfortable.

**Cut capacity :** 30 mm / 1 1/4  
**Sizes :** 40, 45 or 60 cm

740 GR  
26 OZ

P-SL-60

650 GR  
23 OZ

P-SL-45

620 GR  
21 OZ

P-SL-40

# Landscaping



## P14 P14-50, P14-60 :

Bypass lopper for pruning and training of vines. Small cutting head for easy access to hidden branches and quick cuts. Stamped counter blade with sap chamber.

**Cut capacity :** 30 mm / 1 1/4  
**Sizes :** 50 or 60 cm

### Lockable center Bolt



- No possible loosening while cutting

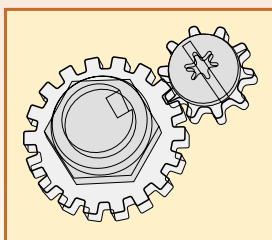
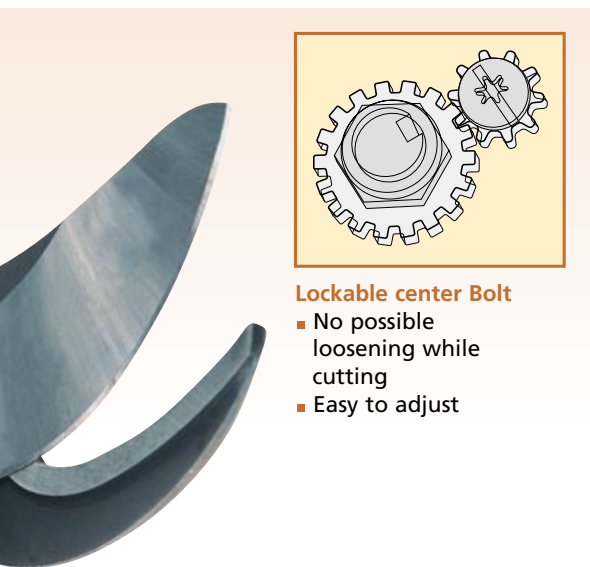

### Lockable center Bolt

- No possible loosening while cutting
- Easy to adjust



## P180 P180-70 :

Heavy-duty bypass lopper for cutting thick branches in landscaping activities. Short and thick blade withstand extreme stress.

**Cut capacity :** 45 mm / 1 3/4  
**Sizes :** 70 cm

### Lockable center Bolt

- No possible loosening while cutting

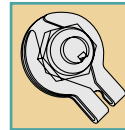

## P19 P19-80 :

Heavy-duty bypass lopper for cutting very thick and large branches on mature trees. Blade with two different edge radii for powerful and smooth cut. Long aluminium handles for long reach and overhead cutting.

**Cut capacity :** 50 mm / 2'  
**Sizes :** 80 cm

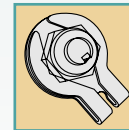

### Lockable center Bolt

- No possible loosening while cutting
- Easy to adjust



# Horticulture



**NEW**



**Lockable center Bolt**  
 ■ No possible loosening while cutting

## P332

**P332-80, P332-90 :**

Bypass lopper for pruning fruit trees. Long aluminium handles for easy reach overhead cutting. Long and narrow cutting head provides good access through branches and high cutting capacity. Very robust forged counter blade with sap chamber. In-tube assembled blade and counter blade for easy maintenance and weight reduction.

**Cut capacity :** 45 mm / 1 3/4  
**Sizes :** 80 or 90 cm

## P160 P160-60, P160-75, P160-90 :

Traditional bypass lopper for pruning fruit trees. Long aluminium handles for easy reach and overhead cutting. Very robust forged and long counter blade for catching branches and stand stress of intensive use.

**Cut capacity :** 45 mm / 1 3/4  
**Sizes :** 60, 75 or 90 cm

**NEW**

## P172

**P172-65, P172-85 :**

Heavy-duty anvil lopper for cutting thick and hard wood. Lever action system and Teflon coated blade for easy cut. Tough hard wearing aluminium anvil. Center stop system avoids fast anvil damaging of the anvil.

**Cut capacity :** 40 mm / 1 1/2  
**Sizes :** 65 or 85 cm



### Adjustable Center Stop System

When using the tool intensively, anvil gets spoiled and blade needs to be re-sharpened. Move progressively from position 1 to 4 and get a permanent higher quality of cut !

# Spare-parts for loppers

Product code	Fits	Product code	Fits	Product code	Fits
<b>Blade</b>		<b>Buffers</b>		<b>Handle bolts</b>	
R114V	All P14 loppers	R430V	P-SL-40	R615V	All P14, P16 loppers
R115V	All P-SL loppers	R440V	P-SL-45, P-SL-60, P16-40	R415V	All P-SL loppers
R116V	All P16 loppers	R515VS	P16-50, P16-60, P19-80, P180-70 P160-60, all P14 loppers	R519V	P19-80
R119V	P19-80	R444V	All P332 loppers	R532V	All P332 loppers
R132V	All P332 loppers	R516V	P160-75, P160-90	R660V	All P160 loppers
R160A	All P160 loppers			R419V	P180-70
R172A	All P172 loppers				
R180V	P180-70				
<b>Counter blade</b>		<b>Center bolt</b>		<b>Anvil</b>	
R214V	All P14 loppers	R646VS	All P14 loppers	R372H	All P172 loppers
R215V	All P-SL loppers	R315V	All P-SL loppers		
R716V	All P16 loppers	R143PV	All P16 loppers		
R619V	P19-80	R318V	P19-80, P180-70		
R732V	All P332 loppers	R319V	All P332 loppers		
R260A	All P160 loppers				
R680V	P180-70				

## THE VARIOUS PARTS OF THE LOPPER (example P-SL)

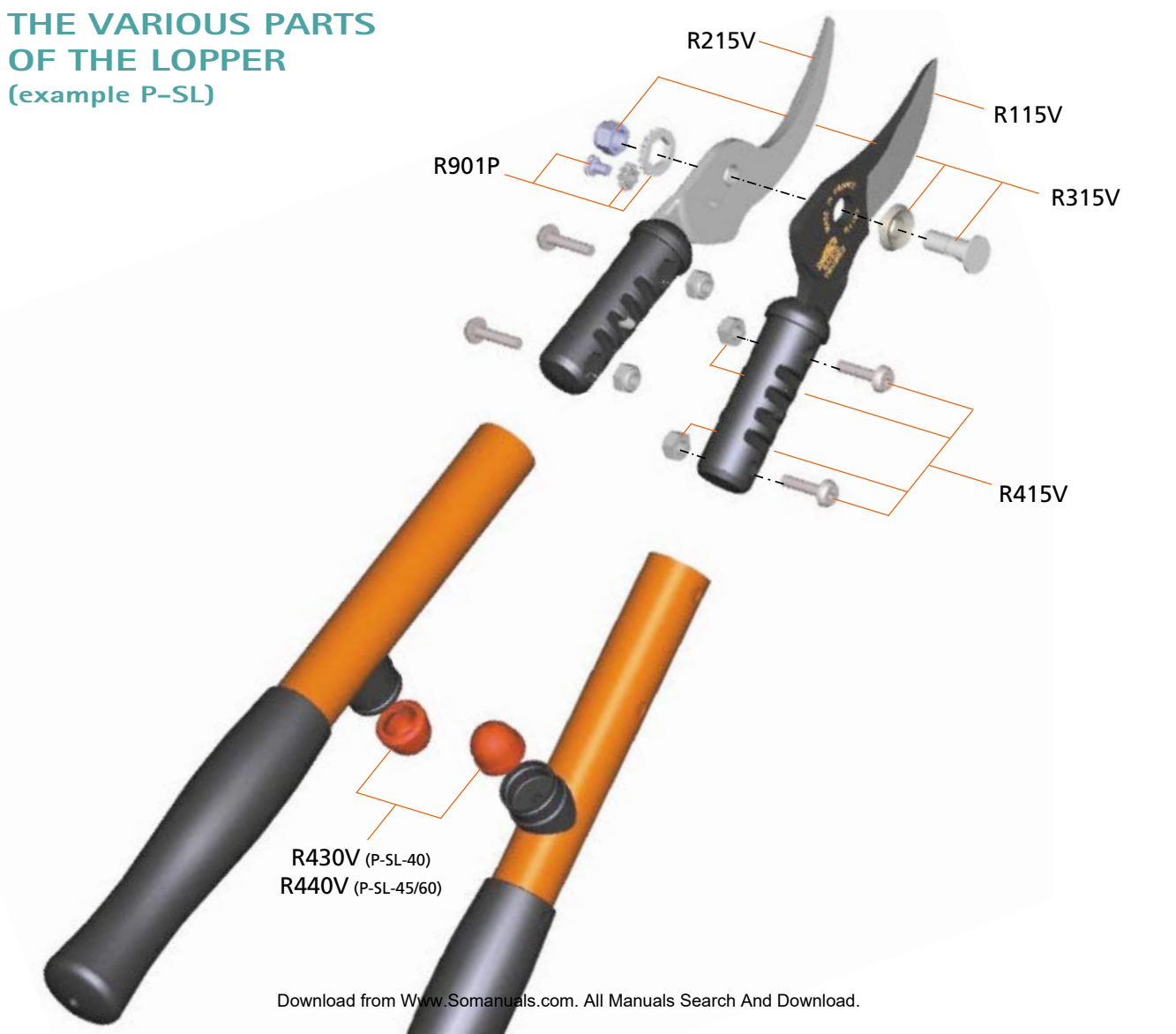

# Always one step ahead

## A particular know-how

Bahco-Pradines brand name refers to a particular know-how that has been renowned for decades. We are now recognized for our incomparable expertise in designing professional pruning tools. Bahco-Pradines is continuously looking for advanced solutions in order to make your working life easier. Our R&D department is continuously working on technical improvements that contribute to add value to our tools. We regularly launch innovations that help users to do a better job, with optimal efficiency.



## Our expertise is your choice

Bahco-Pradines broad range of loppers offers every user the opportunity of getting the tool that best fits specific requirements depending on its application. We design our tools together with the professionals, which guarantee incomparable levels of performance in each specific area of application, either it would be for pruning vines, fruit trees or for landscaping activities. Frequent field tests are performed with users of different countries. Our main concern is to deliver superior value through offering professional users high quality tools that are designed and manufactured to meet highest levels of expectations.



## Quality on a permanent basis

Professionals who work with hand tools associate closely with the tools they use. Once they have found a model that suits their style of work, they will often replace their old tool with a new one of exactly the same type. Permanent quality control of our manufacturing process enables Bahco-Pradines tools to keep the same level of reliability year after year. Our plant has for years been certified ISO 9001, which guarantees our customers permanent satisfaction. All our products are audited periodically in order to assure that production series meet all technical specifications. More of the parts that are assembled on our tools are made "in-house" and are submitted to numerous quality checkpoints. As an example, every cutting blade goes through 50 quality checkpoints. All parts and raw material are strictly inspected at reception.



BAHCO Group AB  
811-81 Sandviken  
Sweden  
[www.bahco.com](http://www.bahco.com)

## Free Manuals Download Website

<http://myh66.com>

<http://usermanuals.us>

<http://www.somanuals.com>

<http://www.4manuals.cc>

<http://www.manual-lib.com>

<http://www.404manual.com>

<http://www.luxmanual.com>

<http://aubethermostatmanual.com>

Golf course search by state

<http://golfingnear.com>

Email search by domain

<http://emailbydomain.com>

Auto manuals search

<http://auto.somanuals.com>

TV manuals search

<http://tv.somanuals.com>