

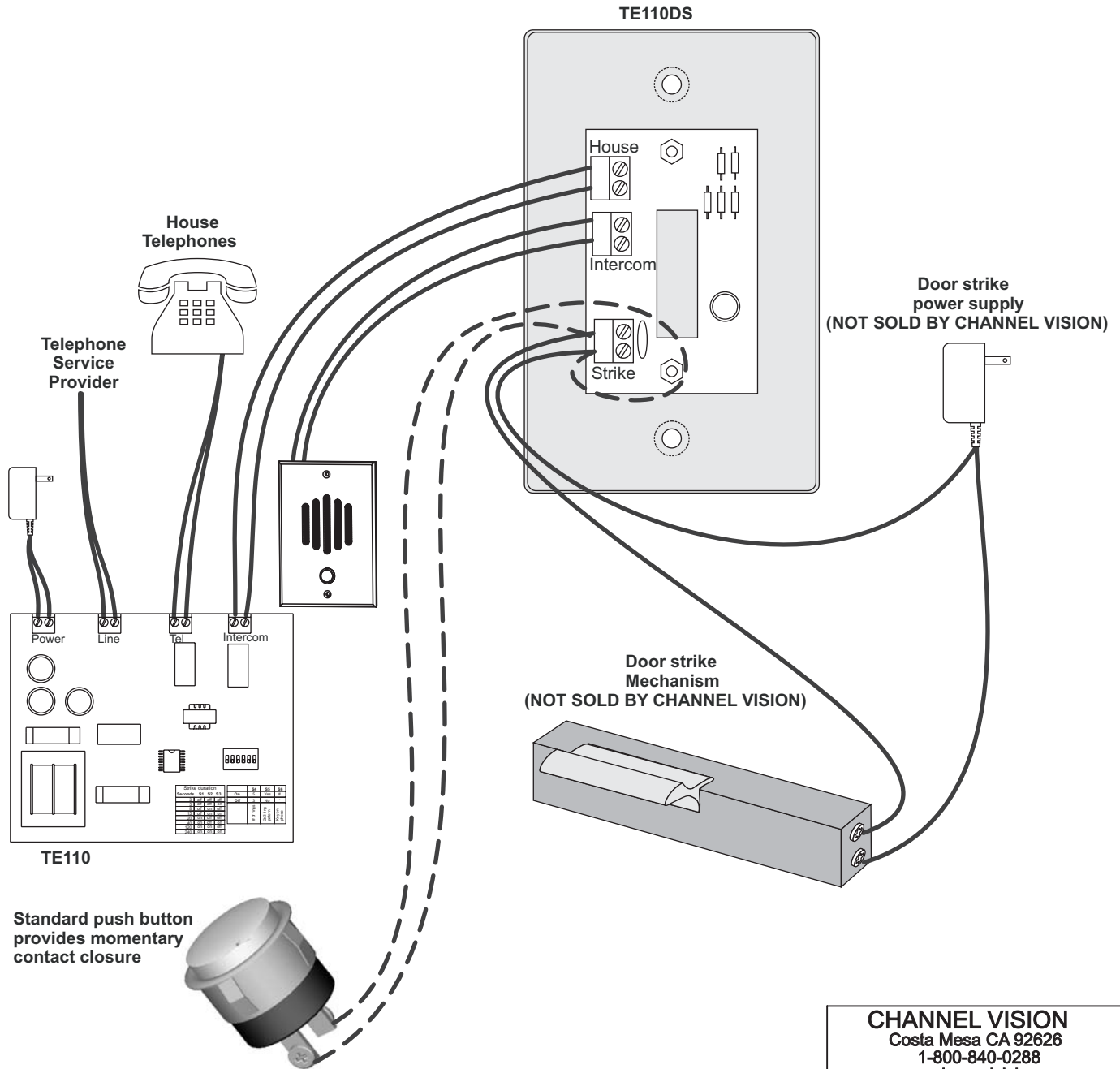

TE110DS manual override switch

In some cases, customers may require a manual button or switch that allows them to activate their doorstrike without using the TE110DS. The diagram below shows one possible wiring schematic to accomplish this.



Use a standard pushbutton or any device that will provide a momentary contact closure and wire it across the 'Strike' terminals on the TE110DS. When the button is pressed, power will be delivered to the strike mechanism causing it to activate

CHANNEL VISION Costa Mesa CA 92626 1-800-840-0288 www.channelvision.com			
Title TE110DS manual override switch			
Size A	File Name TE110DS_pushbutton override		
Scale na	Sheet 1	of 1	Date 09/04

Free Manuals Download Website

<http://myh66.com>

<http://usermanuals.us>

<http://www.somanuals.com>

<http://www.4manuals.cc>

<http://www.manual-lib.com>

<http://www.404manual.com>

<http://www.luxmanual.com>

<http://aubethermostatmanual.com>

Golf course search by state

<http://golfingnear.com>

Email search by domain

<http://emailbydomain.com>

Auto manuals search

<http://auto.somanuals.com>

TV manuals search

<http://tv.somanuals.com>