



V-1 MILLION POWER SERIES™ SPOTLIGHT INSTRUCTION MANUAL



Catalog Number SL102B

Thank you for choosing Black & Decker!
Go to www.BlackandDecker.com/NewOwner
to register your new product

**BEFORE RETURNING THIS PRODUCT
FOR ANY REASON PLEASE CALL**

1-800-544-6986

BEFORE YOU CALL, HAVE THE CATALOG No, AND DATE CODE AVAILABLE. IN MOST CASES, A **BLACK & DECKER** REPRESENTATIVE CAN RESOLVE THE PROBLEM OVER THE PHONE. IF YOU HAVE A SUGGESTION OR COMMENT, GIVE US A CALL. YOUR FEEDBACK IS VITAL TO BLACK & DECKER.

TO REDUCE THE RISK OF INJURY, THE USER MUST READ AND UNDERSTAND THE INSTRUCTION MANUAL

SAVE THIS MANUAL FOR FUTURE REFERENCE.

Cat. # SL102B
April '07

Form # 90515795
Copyright © 2007 Black & Decker

Printed in China

⚠ GENERAL SAFETY WARNINGS AND INSTRUCTIONS FOR ALL APPLIANCES

READ ALL INSTRUCTIONS

⚠ **WARNING:** Read all instructions before operating product. Failure to follow all instructions listed below may result in electric shock, fire and/or serious injury.

- **AVOID DANGEROUS ENVIRONMENTS** Don't use appliances in damp or wet locations. Don't use appliances in the rain.
- **KEEP CHILDREN AWAY.** All visitors should be kept at a distance from work area.
- **STORE IDLE APPLIANCES INDOORS.** When not in use, appliances should be stored indoors in dry, and high or locked-up place – out of reach of children.
- **DON'T FORCE APPLIANCE.** It will do the job better and with less likelihood of a risk of injury at the rate for which it was designed.
- **USE RIGHT APPLIANCE.** Do not use the appliance for any job except that for which it is intended.
- **DRESS PROPERLY.** Do not wear loose clothing or jewelry. They can be caught in moving parts. Rubber gloves and substantial, non-skid footwear are recommended when working outdoors. Wear protective hair covering to contain long hair.
- **USE SAFETY GLASSES AND OTHER SAFETY EQUIPMENT.** Use safety goggles or safety glasses with side shields, complying with applicable safety standards and, when needed, a face shield. Also use face or dust mask if operation is dusty. This applies to all persons in the work area. Also use a hard hat, hearing protection, gloves, safety shoes and dust collection systems when specified or required. Safety glasses or the like are available at extra cost at your local dealer or Black & Decker Service Center.
- **DON'T ABUSE CORD.** Never carry appliance by cord or yank it to disconnect from receptacle. Keep cord from heat, oil, and sharp edges.
- **DON'T OVERREACH.** Keep proper footing and balance at all times.
- **DISCONNECT APPLIANCES.** Disconnect the appliance from the power supply when not in use, before servicing, and when changing accessories such as blades and the like.
- **AVOID UNINTENTIONAL STARTING.** Don't carry plugged-in appliance with finger on switch. Be sure switch is off when plugging in.
- **GROUND FAULT CIRCUIT INTERRUPTER (GFCI)** protection should be provided on the circuits or outlets to be used. Receptacles are available having built in GFCI protection and may be used for this measure of safety.
- **USE OF ACCESSORIES AND ATTACHMENTS.** The use of any accessory or attachment not recommended for use with this appliance could be hazardous. Note: Refer to the accessory section of this manual for further details.
- **STAY ALERT.** Watch what you are doing. Use common sense. Do not operate tool when you are tired.
- **CHECK DAMAGED PARTS.** Before further use of the tool, a guard or other part that is damaged should be carefully checked to determine that it will operate properly and perform its intended function. Check for alignment of moving parts, binding of moving parts, breakage of parts, mounting, and any other conditions that may affect its operation. A guard or other part that is damaged should be properly repaired or replaced by an authorized service center unless otherwise indicated elsewhere in this instruction manual. Have defective switches replaced by authorized service center. Do not use tool if switch does not turn it on and off.
- **DO NOT OPERATE** portable electric tools near flammable liquids or in gaseous or explosive atmospheres. Motors in these tools normally spark, and the sparks might ignite fumes.
- **OUTDOOR USE EXTENSION CORDS.** When tool is used outdoors, use only extension cords intended for use outdoors and so marked.

Minimum Gage for Cord Sets

Volts	Total Length of Cord in Feet			
	120V	0-25 (0-7,6m)	26-50 (7,6-15,2m)	51-100 (15,2-30,4m)
240V	0-50 (0-15,2m)	51-100 (15,2-30,4m)	101-200 (30,4-60,9m)	201-300 (60,9-91,4m)
Ampere Rating		American Wire Gage		
More Than	Not more Than			
0 -	6	18	16	14
6 -	10	18	16	12
10 -	12	16	16	12
12 -	16	14	12	Not Recommended

- **EXTENSION CORDS.** Make sure your extension cord is in good condition. When using an extension cord, be sure to use one heavy enough to carry the current your product will draw. An undersized cord will cause a drop in line voltage resulting in loss of power and overheating. The following table shows the correct size to use depending on cord length and nameplate ampere rating. If in doubt, use the next heavier gage. The smaller the gage number, the heavier the cord.

SAFETY GUIDELINES / DEFINITIONS

- ⚠ **DANGER:** Indicates an imminently hazardous situation which, if not avoided, will result in death or serious injury.
 - ⚠ **WARNING:** Indicates a potentially hazardous situation which, if not avoided, could result in death or serious injury.
 - ⚠ **CAUTION:** Indicates a potentially hazardous situation which, if not avoided, may result in minor or moderate injury.
- CAUTION:** Used without the safety alert symbol indicates potentially hazardous situation which, if not avoided, may result in property damage.

RISK OF UNSAFE OPERATION. When using tools or equipment, basic safety precautions should always be followed to reduce the risk of personal injury. Improper operation, maintenance or modification of tools or equipment could result in serious injury and property damage. There are certain applications for which tools and equipment are designed. Black & Decker strongly recommends that this product NOT be modified and/or used for any application other than for which it was designed. Read and understand all warnings and operating instructions before using any tool or equipment.

SAVE THESE INSTRUCTIONS

THIS MANUAL CONTAINS IMPORTANT SAFETY AND OPERATING INSTRUCTIONS FOR THE V-1 MILLION POWER SERIES SPOTLIGHT MODEL SL102B.

⚠ **WARNING: TO REDUCE THE RISK OF INJURY:**

- Follow these instructions and those published by the manufacturer of any equipment you intend to use with this unit. Review cautionary markings on these products.

IMPORTANT SAFETY INSTRUCTIONS

- ⚠ **WARNING:** This product or its power cord contains lead, a chemical known to the State of California to cause cancer and birth defect or other reproductive harm. Wash hands after handling.
- ⚠ **WARNING: TO REDUCE THE RISK OF ELECTRIC SHOCK:**
Do not plug in a power supply without the bulb lens and cover in place.
- ⚠ **WARNING: FIRE HAZARD:** Never contact combustible material to the lens and never tape or tie the switch in the on position.
- ⚠ **CAUTION: TO REDUCE THE RISK OF INJURY OR PROPERTY DAMAGE:**
 - All halogen lights give off heat:
 - Do not touch lens while operating.
 - Keep combustibles away from spotlight lens. Extreme heat can cause fires.
 - Never place the light face-down on any surface when lit.
 - Never look directly into the light or shine the light into another person's eyes.
 - Keep sharp objects away from lens — it is glass and can break.
 - Do not immerse spotlight in water.
 - Do not drop or throw spotlight. It contains glass and a sealed lead acid battery.
 - Only replace bulb with type indicated in specifications (6 volt, H3 55 watt quartz halogen).
 - Use only with AC or DC charging adapters that are provided with unit. Plug in the charging adapter at the spotlight first, then plug into the charging source.
 - Do not overcharge:
 - AC recharge up to 14 hours maximum.
 - DC recharge up to 14 hours maximum.
 - NEVER ATTEMPT TO USE THE AC CHARGER AND DC CHARGING PORT SIMULTANEOUSLY.
 - After charging/recharging, disconnect charging adapter or extension cord and wait 5 minutes before use.
 - Do not crush, cut, pull or expose charging adapter cords to extreme heat.

- Position charging adapter cords so they do not become entangled or become a safety hazard. Keep charging adapter cords away from sharp edges.
- Use in a dry location only.
- Do not open body casing. There are no user-serviceable parts inside.
- To reduce risk of damage to electric plug and cord, pull by plug rather than cord when disconnecting from the 120 Volt AC Charger.
- Do not attempt to charge the unit if the 120 Volt AC Charger plug is damaged— return the unit to manufacturer for repair.

INTRODUCTION

Thank you for choosing the **Black & Decker® V-1 Million Power Series™ Spotlight**. Please read this guide carefully before use to ensure optimum performance and to avoid damage to the unit.

FEATURES

- Powerful, focused quartz halogen beam
- Protective rubber safety guard (bezel) around lens
- Rubber safety cap protects battery compartment
- Comfortable pistol grip
- Battery Status LED Indicator
- UL listed, built-in 120 volt AC charger that works with a standard household extension cord (not included)
- 12 volt DC charging adapter included
- Rechargeable, non-spillable, sealed lead acid battery



CHARGING/RECHARGING THE SPOTLIGHT

This unit is shipped in a partially charged state. Charge unit **BEFORE** first use using the 120 Volt AC Charger for 12-14 hours or until the red Battery Status LED flashes. Charge after each use until red LED flashes.

Charging/Recharging Using the 120 Volt AC Charger and a Standard Household Extension Cord (not included)

Plug a standard North American 120 volt AC extension cord (not included) into the 120 Volt AC Charger on the back of the unit.

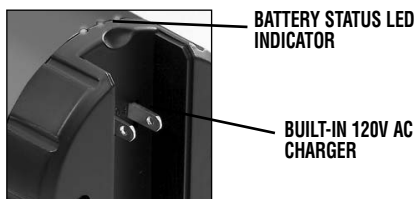

Make sure the Spotlight is OFF (the Trigger Lock is in the OFF position and the Trigger is not depressed).

Charge until the Battery Status LED Indicator red LED flashes (approximately 12-14 hours). DO NOT CHARGE FOR LONGER THAN 14 HOURS.

Charging/Recharging Using the 12 Volt DC Charging Adapter

Plug the barrel tip of the supplied 12 Volt DC Charging Adapter into the 12 Volt DC Charging Port.



12 VOLT DC CHARGING ADAPTER



12 VOLT DC CHARGING PORT

Insert the 12 volt DC plug end into the accessory outlet of your vehicle or other 12 volt DC power source. Make sure the Spotlight is OFF (the Trigger Lock is in the OFF position and the Trigger is not depressed). Charge until the Battery Status LED Indicator red LED flashes (approximately 12-14 hours). DO NOT CHARGE FOR LONGER THAN 14 HOURS.

Make sure the DC source (jump-starter, battery pack, vehicle accessory outlet, etc.) is 12 volt DC and is able to supply at least one half amp at 12 volt DC for 8 hours. This means a battery pack should be charged with at least 4 amp hours capacity.

Note: When using a vehicle's 12 volt DC accessory outlet as a charging source, be aware that some vehicles require you to turn on the ignition to power the accessory outlet.

⚠ WARNING: NEVER ATTEMPT TO USE THE AC CHARGER AND DC CHARGING PORT SIMULTANEOUSLY.

OPERATING INSTRUCTIONS

To turn the Spotlight ON, depress the Trigger. To lock the Trigger in the ON position, depress the Trigger, then slide the Trigger Lock up. The spotlight will stay on until the lock is moved to the OFF position and the trigger is released.



TRIGGER

TRIGGER LOCK

CARE AND MAINTENANCE

All batteries lose charge with time, especially when they are warm. Recharge the unit every two months when not in frequent use, preferably using the 120 volt AC method.

Never submerge the unit in water. If the unit gets dirty, gently clean the outer surfaces of the spotlight unit with a soft cloth moistened with a mild solution of water and detergent.

The quartz halogen bulb is the only user-replaceable part in the Spotlight. Periodically inspect the condition of adapters, connectors and wires. Contact Technical Support toll-free at 1-800-544-6986 to replace any components that have become worn or broken.

Spotlight Bulb Replacement

To replace the bulb, you will need a small Phillips screwdriver and a 6 volt H3 55 watt replacement bulb. During installation, avoid touching the glass part of the bulb. Bulb life may be shortened by installing a bulb with dirt or fingerprints on it. The bulb can be wiped clean with a cloth moistened with alcohol.

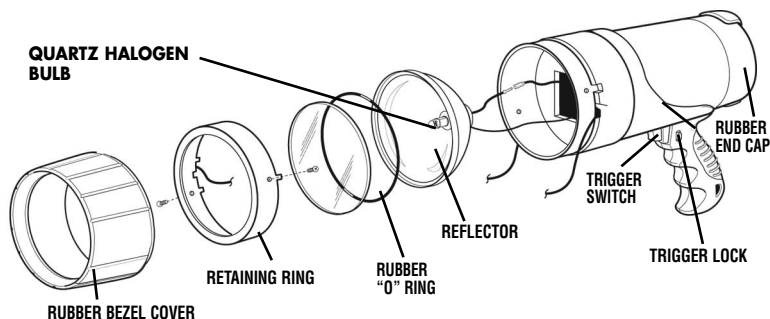

1. Disconnect the unit from any charging adapters.
2. Push the rubber bezel forward toward the front of the spotlight to reveal two small Phillips screws in the retaining ring.
3. Using the screwdriver, remove (counterclockwise) the two screws. Set them aside.
4. Lift off the retaining ring, glass lens and rubber "O" ring and set them aside.
5. Carefully remove the reflector and bulb assembly.

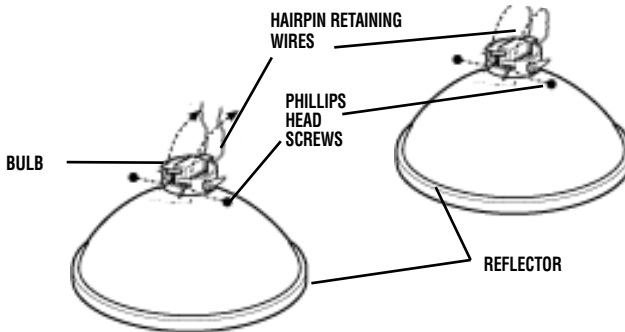

6. Disconnect the bulb wire from the red power wire.
7. Unsnap the hairpin retaining wires from the reflector's flange.
8. Using the screwdriver, loosen the retaining screw to remove the bulb from the reflector (no need to completely remove this screw).
9. Lift out the bulb and detach wire.
10. Insert the replacement bulb into the reflector's flange.
11. Put back and secure the hairpin retaining wires.
12. Connect the bulb power wire to the red power wire.
13. Tighten the retaining screw on the flange.
14. Place the reflector in position in the body of the spotlight.
15. Replace the rubber "O" ring in the groove around the perimeter of the reflector.
16. Replace glass and retaining ring so the screw holes are aligned.
17. Secure retaining ring with two screws.
18. Replace rubber bezel.
19. Operate switch to ensure proper operation of spotlight.

⚠ WARNING: To reduce the risk of electric shock, replace bulb with 6 volt H3 55 watt only.

Battery Replacement/Disposal

Battery Replacement

The battery should last the service life of the unit. Contact Technical Support toll-free at 1-800-544-6986 for any information you may need.

Safe Battery Disposal

Contains a maintenance-free, sealed, non-spillable, lead acid battery, which must be disposed of properly. Recycling is required, contact your local authority for information. Failure to comply with local, state and federal regulations can result in fines, or imprisonment.

⚠ WARNINGS:

- Do not dispose of the battery in fire as this may result in an explosion.
- Before disposing of the battery, protect exposed terminals with heavy-duty electrical tape to prevent shorting (shorting can result in injury or fire).
- Do not expose battery to fire or intense heat as it may explode.
- For more information on recycling this battery, call toll-free (877) 288-7722.



TROUBLESHOOTING

The Battery Status Indicator LED Does Not Light When Charging

1. Check connection to the 120 Volt AC Charger or 12 Volt DC Charging Port.
2. Check connection to AC or DC power source.
3. Confirm there is a functioning AC or DC current.

Unit Will Not Operate

1. The Spotlight will not operate when charging. Be sure all adapters are disconnected before Spotlight use.
2. If you suspect the bulb is blown, check the filament. If the filament is coiled and unbroken, the bulb is not blown. If bulb is blown, replace it.
3. The battery may be completely discharged. Charge the unit following the directions on page 3.
4. If the Spotlight does not operate after recharging as directed, contact Technical Support toll-free at 1-800-544-6986.

For assistance with your product, visit our website www.blackanddecker.com for the location of the service center nearest you or call the BLACK & DECKER help line at **1-800-544-6986**.

Accessories

Recommended accessories for use with your tool are available from your local dealer or authorized service center. If you need assistance regarding accessories, please call: **1-800-544-6986**.

⚠ WARNING: The use of any accessory not recommended for use with this tool could be hazardous.

SERVICE INFORMATION

All Black & Decker Service Centers are staffed with trained personnel to provide customers with efficient and reliable power tool service. Whether you need technical advice, repair, or genuine factory replacement parts, contact the Black & Decker location nearest you. To find your local service location, refer to the yellow page directory under "Tools—Electric" or call: **1-800-544-6986** or visit www.blackanddecker.com.

FULL TWO-YEAR HOME USE WARRANTY

Black & Decker (U.S.) Inc. warrants this product for two years against any defects in material or workmanship. The defective product will be replaced or repaired at no charge in either of two ways.

The first, which will result in exchanges only, is to return the product to the retailer from whom it was purchased (provided that the store is a participating retailer). Returns should be made within the time period of the retailer's policy for exchanges (usually 30 to 90 days after the sale). Proof of purchase may be required. Please check with the retailer for their specific return policy regarding returns that are beyond the time set for exchanges.

The second option is to take or send the product (prepaid) to a Black & Decker owned or authorized Service Center for repair or replacement at our option. Proof of purchase may be required. Black & Decker owned and authorized Service Centers are listed under "Tools-Electric" in the yellow pages of the phone directory and on our website www.blackanddecker.com.

This warranty does not apply to accessories. This warranty gives you specific legal rights and you may have other rights which vary from state to state or province to province. Should you have any questions, contact the manager of your nearest Black & Decker Service Center. This product is not intended for commercial use.

FREE WARNING LABEL REPLACEMENT: If your warning labels become illegible or are missing, call 1-800-544-6986 for a free replacement.

SPECIFICATIONS

Spotlight Bulb: 6 volt, H3 series, 55 watt
Battery: Maintenance-free, sealed lead acid,
6 volt, 3 amp hour
AC Charger: UL Listed Class 2, 12 volt DC (300 mA)
DC Plug Fuse: 0.5A/250 V

Imported by
Black & Decker (U.S.) Inc.,
701 E. Joppa Rd.
Towson, MD 21286 U.S.A.



Vector Products, Inc.
4140 S.W. 30th Ave.
Fort Lauderdale, FL 33312

See 'Tools-Electric'
– Yellow Pages –
for Service & Sales



Free Manuals Download Website

<http://myh66.com>

<http://usermanuals.us>

<http://www.somanuals.com>

<http://www.4manuals.cc>

<http://www.manual-lib.com>

<http://www.404manual.com>

<http://www.luxmanual.com>

<http://aubethermostatmanual.com>

Golf course search by state

<http://golfingnear.com>

Email search by domain

<http://emailbydomain.com>

Auto manuals search

<http://auto.somanuals.com>

TV manuals search

<http://tv.somanuals.com>