



V-2 MILLION POWER SERIES™ SPOTLIGHT INSTRUCTION MANUAL



Catalog Number SL202B

Thank you for choosing Black & Decker!
Go to www.BlackandDecker.com/NewOwner
to register your new product

**BEFORE RETURNING THIS PRODUCT
FOR ANY REASON PLEASE CALL
1-800-544-6986**

BEFORE YOU CALL, HAVE THE CATALOG No, AND DATE CODE AVAILABLE. IN MOST CASES, A **BLACK & DECKER** REPRESENTATIVE CAN RESOLVE THE PROBLEM OVER THE PHONE. IF YOU HAVE A SUGGESTION OR COMMENT, GIVE US A CALL. YOUR FEEDBACK IS VITAL TO BLACK & DECKER.

TO REDUCE THE RISK OF INJURY, THE USER MUST READ AND UNDERSTAND THE INSTRUCTION MANUAL

SAVE THIS MANUAL FOR FUTURE REFERENCE.

Cat. # SL202B

Form # 90518422

May '07

Copyright © 2007 Black & Decker

Printed in China

⚠ GENERAL SAFETY WARNINGS AND INSTRUCTIONS FOR ALL APPLIANCES

READ ALL INSTRUCTIONS

⚠ **WARNING:** Read all instructions before operating product. Failure to follow all instructions listed below may result in electric shock, fire and/or serious injury.

- **AVOID DANGEROUS ENVIRONMENTS** Don't use appliances in damp or wet locations. Don't use appliances in the rain.
- **KEEP CHILDREN AWAY.** All visitors should be kept at a distance from work area.
- **STORE IDLE APPLIANCES INDOORS.** When not in use, appliances should be stored indoors in dry, and high or locked-up place – out of reach of children.
- **DON'T FORCE APPLIANCE.** It will do the job better and with less likelihood of a risk of injury at the rate for which it was designed.
- **USE RIGHT APPLIANCE.** Do not use the appliance for any job except that for which it is intended.
- **DRESS PROPERLY.** Do not wear loose clothing or jewelry. They can be caught in moving parts. Rubber gloves and substantial, non-skid footwear are recommended when working outdoors. Wear protective hair covering to contain long hair.
- **USE SAFETY GLASSES AND OTHER SAFETY EQUIPMENT.** Use safety goggles or safety glasses with side shields, complying with applicable safety standards and, when needed, a face shield. Also use face or dust mask if operation is dusty. This applies to all persons in the work area. Also use a hard hat, hearing protection, gloves, safety shoes and dust collection systems when specified or required. Safety glasses or the like are available at extra cost at your local dealer or Black & Decker Service Center.
- **DON'T ABUSE CORD.** Never carry appliance by cord or yank it to disconnect from receptacle. Keep cord from heat, oil, and sharp edges.
- **DON'T OVERREACH.** Keep proper footing and balance at all times.
- **DISCONNECT APPLIANCES.** Disconnect the appliance from the power supply when not in use, before servicing, and when changing accessories such as blades and the like.
- **AVOID UNINTENTIONAL STARTING.** Don't carry plugged-in appliance with finger on switch. Be sure switch is off when plugging in.
- **GROUND FAULT CIRCUIT INTERRUPTER (GFCI)** protection should be provided on the circuits or outlets to be used. Receptacles are available having built in GFCI protection and may be used for this measure of safety.
- **USE OF ACCESSORIES AND ATTACHMENTS.** The use of any accessory or attachment not recommended for use with this appliance could be hazardous. Note: Refer to the accessory section of this manual for further details.
- **STAY ALERT.** Watch what you are doing. Use common sense. Do not operate tool when you are tired.
- **CHECK DAMAGED PARTS.** Before further use of the tool, a guard or other part that is damaged should be carefully checked to determine that it will operate properly and perform its intended function. Check for alignment of moving parts, binding of moving parts, breakage of parts, mounting, and any other conditions that may affect its operation. A guard or other part that is damaged should be properly repaired or replaced by an authorized service center unless otherwise indicated elsewhere in this instruction manual. Have defective switches replaced by authorized service center. Do not use tool if switch does not turn it on and off.
- **DO NOT OPERATE** portable electric tools near flammable liquids or in gaseous or explosive atmospheres. Motors in these tools normally spark, and the sparks might ignite fumes.
- **OUTDOOR USE EXTENSION CORDS.** When tool is used outdoors, use only extension cords intended for use outdoors and so marked.

Minimum Gage for Cord Sets					
Volts		Total Length of Cord in Feet			
120V		0-25 (0-7,6m)	26-50 (7,6-15,2m)	51-100 (15,2-30,4m)	101-150 (30,4-45,7m)
240V		0-50 (0-15,2m)	51-100 (15,2-30,4m)	101-200 (30,4-60,9m)	201-300 (60,9-91,4m)
Ampere Rating		American Wire Gage			
More Than	Not more Than				
0 -	6	18	16	16	14
6 -	10	18	16	14	12
10 -	12	16	16	14	12
12 -	16	14	12	Not Recommended	

• **EXTENSION CORDS.** Make sure your extension cord is in good condition. When using an extension cord, be sure to use one heavy enough to carry the current your product will draw. An undersized cord will cause a drop in line voltage resulting in loss of power and overheating. The following table shows the correct size to use depending on cord length and nameplate ampere rating. If in doubt, use the next heavier gage. The smaller the gage number, the heavier the cord.

SAFETY GUIDELINES / DEFINITIONS

⚠ DANGER: Indicates an imminently hazardous situation which, if not avoided, will result in death or serious injury.

⚠ WARNING: Indicates a potentially hazardous situation which, if not avoided, could result in death or serious injury.

⚠ CAUTION: Indicates a potentially hazardous situation which, if not avoided, may result in minor or moderate injury.

CAUTION: Used without the safety alert symbol indicates potentially hazardous situation which, if not avoided, may result in property damage.

RISK OF UNSAFE OPERATION. When using tools or equipment, basic safety precautions should always be followed to reduce the risk of personal injury. Improper operation, maintenance or modification of tools or equipment could result in serious injury and property damage. There are certain applications for which tools and equipment are designed. Black & Decker strongly recommends that this product NOT be modified and/or used for any application other than for which it was designed. Read and understand all warnings and operating instructions before using any tool or equipment.

IMPORTANT SAFETY INSTRUCTIONS

⚠ WARNING: This product or its power cord contains lead, a chemical known to the State of California to cause cancer and birth defect or other reproductive harm. Wash hands after handling.

FOR HOUSEHOLD USE ONLY

INSTRUCTIONS PERTAINING TO RISK OF FIRE, ELECTRIC SHOCK, OR INJURY TO PERSONS

⚠ WARNING – WHEN USING ELECTRICAL APPLIANCES, BASIC PRECAUTIONS SHOULD ALWAYS BE FOLLOWED, INCLUDING THE FOLLOWING:

- A) READ THE INSTRUCTIONS BEFORE USING THE APPLIANCE.
- B) TO REDUCE THE RISK OF INJURY, CLOSE SUPERVISION IS NECESSARY WHEN AN APPLIANCE IS USED NEAR CHILDREN.
- C) USE ONLY ATTACHMENTS RECOMMENDED OR SOLD BY THE MANUFACTURER.
- D) DO NOT USE OUTDOORS.
- E) TO REDUCE THE RISK OF ELECTRICAL SHOCK, DO NOT PUT SPOTLIGHT IN WATER OR OTHER LIQUID. DO NOT PLACE OR STORE APPLIANCE WHERE IT CAN FALL OR BE PULLED INTO A TUB OR SINK.
- F) ALWAYS UNPLUG BEFORE REPLACING THE LAMP. ONLY REPLACE BULB WITH TYPE RATED 6 VOLT, H3 55 WATT QUARTZ HALOGEN.
- G) USE ONLY THE CHARGER SUPPLIED BY THE MANUFACTURER TO RECHARGE.
- H) IF AN EXTENSION CORD IS USED:
 1. The marked rating of the detachable power supply cord or extension cord should be at least as great as the electrical rating of this appliance.
 2. The cord should be arranged so that it will not drape over the countertop or tabletop where it can be tripped over, snagged, or pulled on unintentionally (especially by children).
 3. The extension cord should be kept dry and off the ground.
 4. Do not clean this appliance with a water spray or the like.

⚠ WARNING: TO REDUCE THE RISK OF ELECTRIC SHOCK:

Do not plug in a power supply without the bulb lens and cover in place.

⚠ WARNING: FIRE HAZARD: Never contact combustible material to the lens and never tape or tie the switch in the on position.

⚠ CAUTION: TO REDUCE THE RISK OF INJURY OR PROPERTY DAMAGE:

- All halogen lights give off heat.
 - Do not touch lens while operating.
 - Keep combustibles away from spotlight lens. Extreme heat can cause fires.
 - Never place the light face-down on any surface when lit.
- Never look directly into the light or shine the light into another person's eyes.
- Keep sharp objects away from lens — it is glass and can break.

- Do not immerse spotlight in water.
- Do not drop or throw spotlight. It contains glass and a sealed lead acid battery.
- Only replace bulb with type indicated in specifications (6 volt, H3 55 watt quartz halogen).
- Use only with AC or DC charging adapters that are provided with unit. Plug in the charging adapter at the spotlight first, then plug into the charging source.
- Do not overcharge:
 - AC recharge up to 30 hours maximum.
 - DC recharge up to 4 hours maximum.
- NEVER ATTEMPT TO USE THE AC CHARGER AND DC CHARGING PORT SIMULTANEOUSLY.
- After charging/recharging, disconnect charging adapter or extension cord and wait 5 minutes before use.
- Do not crush, cut, pull or expose charging adapter cords to extreme heat.
- Position charging adapter cords so they do not become entangled or become a safety hazard. Keep charging adapter cords away from sharp edges.
- Use in a dry location only.
- Do not open body casing. There are no user-serviceable parts inside.
- To reduce risk of damage to electric plug and cord, pull by plug rather than cord when disconnecting from the 120 Volt AC Charger.
- Do not attempt to charge the unit if the 120 Volt AC Charger plug is damaged – return the unit to manufacturer for repair.

⚠ WARNING: TO REDUCE THE RISK OF INJURY:

- Follow these instructions and those published by the manufacturer of any equipment you intend to use with this unit. Review cautionary markings on these products.

SAVE THESE INSTRUCTIONS

INTRODUCTION

Thank you for choosing the **Black & Decker® V-2 Million Power Series™ Spotlight**. Please read this guide carefully before use to ensure optimum performance and to avoid damage to the unit.

FEATURES

- Powerful, focused quartz halogen beam
- LED area lights
- Protective rubber safety guard (bezel) around lens
- Rubber safety cap protects battery compartment
- Comfortable pistol grip and lanyard
- Battery Status LED Indicator
- UL listed, built-in 120 volt AC charger that works with a standard household extension cord (not included)
- 12 volt DC charging adapter included
- Rechargeable, non-spillable, sealed lead acid battery



CHARGING/RECHARGING THE SPOTLIGHT

This unit is shipped in a partially charged state. Charge unit BEFORE first use using the 120 Volt AC Charger for 20-30 hours or until the green Battery Status LED flashes. Charge after each use until green LED flashes.

Charging/Recharging Using the 120 Volt AC Charger and a Standard Household Extension Cord (not included)

Plug a standard North American 120 volt AC extension cord (not included) into the 120 Volt AC Charger on the back of the unit.

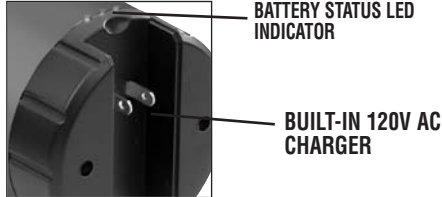

Make sure the Spotlight is OFF (the Trigger Lock is in the OFF position and the Trigger is not depressed). Charge until the Battery Status LED Indicator green LED flashes (approximately 20-30 hours). DO NOT CHARGE FOR LONGER THAN 30 HOURS.

Charging/Recharging Using the 12 Volt DC Charging Adapter

Plug the barrel tip of the supplied 12 Volt DC Charging Adapter into the 12 Volt DC Charging Port.



12 VOLT DC CHARGING ADAPTER



12 VOLT DC CHARGING PORT

Insert the 12 volt DC plug end into the accessory outlet of your vehicle or other 12 volt DC power source.

Make sure the Spotlight is OFF (the Trigger Lock is in the OFF position and the Trigger is not depressed).

Charge until the Battery Status LED Indicator green LED lights when the LED AREA LIGHTS pushbutton is pressed (approximately 3-4 hours). DO NOT CHARGE FOR LONGER THAN 4 HOURS.

Make sure the DC source (jump-starter, battery pack, vehicle accessory outlet, etc.) is 12 volt DC and is able to supply at least one half amp at 12 volt DC for 8 hours. This means a battery pack should be charged with at least 4 amp hours capacity.

Note: When using a vehicle's 12 volt DC accessory outlet as a charging source, be aware that some vehicles require you to turn on the ignition to power the accessory outlet.

⚠ WARNING: NEVER ATTEMPT TO USE THE AC CHARGER AND DC CHARGING PORT SIMULTANEOUSLY.

OPERATING INSTRUCTIONS

Operating the Spotlight

1. Disconnect from charger.
2. The ON/OFF trigger is located in the front of the pistol-grip handle of the spotlight.
3. To turn the spotlight ON, squeeze the trigger.
4. To turn OFF the spotlight, release the trigger.

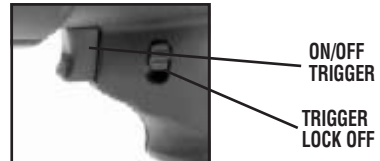

Note: The ON/OFF trigger can be locked in the OFF position using the trigger lock OFF switch on the side of the unit.

Operating the LED Area Lights

The ON/OFF pushbutton for the LED Area Lights is located on the top of the Spotlight.

Using the Built-In Carry Lanyard

The Carry Lanyard may be used to store or carry the Spotlight. Adjust the slide on the cords to keep the Lanyard secure around the supporting object.

CARE AND MAINTENANCE

All batteries lose charge with time, especially when they are warm. Recharge the unit every two months when not in frequent use, preferably using the 120 volt AC method.

Never submerge the unit in water. If the unit gets dirty, gently clean the outer surfaces of the spotlight unit with a soft cloth moistened with a mild solution of water and detergent.

The quartz halogen bulb is the only user-replaceable part in the Spotlight. Periodically inspect the condition of adapters, connectors and wires. Contact Technical Support toll-free at 1-800-544-6986 to replace any components that have become worn or broken.

Spotlight Bulb Replacement

To replace the bulb, you will need a small Phillips screwdriver and a 12 volt H3 75 watt replacement bulb. During installation, avoid touching the glass part of the bulb. Bulb life may be shortened by installing a bulb with dirt or fingerprints on it. The bulb can be wiped clean with a cloth moistened with alcohol.

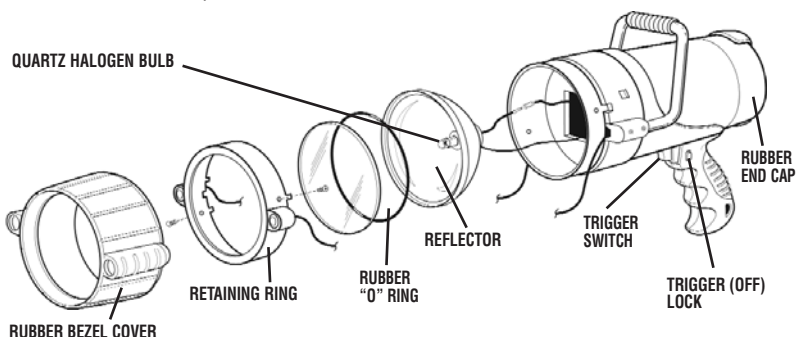

1. Disconnect the unit from any charging adapters.
2. Push the rubber bezel forward toward the front of the spotlight to reveal two small Phillips screws in the retaining ring.
3. Using the screwdriver, remove (counterclockwise) the two screws. Set them aside.
4. Lift off the retaining ring, glass lens and rubber "O" ring and set them aside.
5. Carefully remove the reflector and bulb assembly.

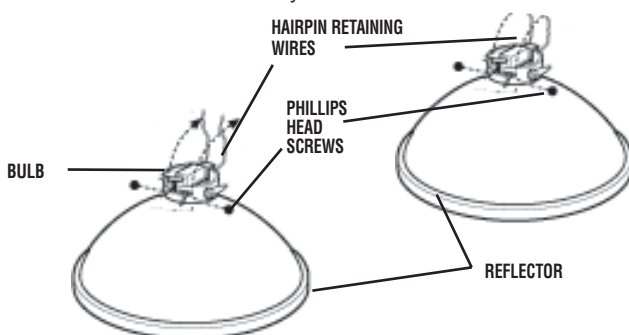

6. Disconnect the bulb wire from the red power wire.
7. Unsnap the hairpin retaining wires from the reflector's flange.
8. Using the screwdriver, loosen the retaining screw to remove the bulb from the reflector (no need to completely remove this screw).
9. Lift out the bulb and detach wire.
10. Insert the replacement bulb into the reflector's flange.
11. Put back and secure the hairpin retaining wires.

12. Connect the bulb power wire to the red power wire.
 13. Tighten the retaining screw on the flange.
 14. Place the reflector in position in the body of the spotlight.
 15. Replace the rubber "O" ring in the groove around the perimeter of the reflector.
 16. Replace glass and retaining ring so the screw holes are aligned.
 17. Secure retaining ring with two screws.
 18. Replace rubber bezel.
 19. Operate switch to ensure proper operation of spotlight.
- ⚠ WARNING:** To reduce the risk of electric shock, replace bulb with 12 volt H3 75 watt only.

Battery Replacement/Disposal

Battery Replacement

The battery should last the service life of the unit. Contact Technical Support toll-free at 1-800-544-6986 for any information you may need.

Safe Battery Disposal

Contains a maintenance-free, sealed, non-spillable, lead acid battery, which must be disposed of properly. Recycling is required, contact your local authority for information. Failure to comply with local, state and federal regulations can result in fines, or imprisonment.



⚠ WARNINGS:

- Do not dispose of the battery in fire as this may result in an explosion.
- Before disposing of the battery, protect exposed terminals with heavy-duty electrical tape to prevent shorting (shorting can result in injury or fire).
- Do not expose battery to fire or intense heat as it may explode.
- For more information on recycling this battery, call toll-free (877) 288-7722.

12 Volt DC Charging Adapter Plug Fuse Replacement

The fuse in the plug end of the 12 Volt DC Charging Adapter protects the adapter's charging circuit. If the 120 Volt AC Charger operates, but the DC charging adapter does not, then this fuse may be opened (blown).

To replace the fuse:

1. Unscrew the end cap of the DC plug (counterclockwise).
2. Remove spring center contact and fuse.
3. Check fuse with a continuity checker.
4. If blown, locate a replacement 8 amp/250 volt fuse.
5. Replace the fuse, spring, contact and end cap.
6. Screw end cap clockwise until it is finger tight – DO NOT OVER-TIGHTEN.
7. Test for proper operation of the 12 Volt DC Charging Adapter.

TROUBLESHOOTING

The Battery Status Indicator LED Does Not Light When Charging

1. Check connection to the 120 Volt AC Charger or 12 Volt DC Charging Port.
2. Check connection to AC or DC power source.
3. Confirm there is a functioning AC or DC current.

Unit Will Not Operate

1. The Spotlight will not operate when charging. Be sure all adapters are disconnected before Spotlight use.
2. If you suspect the bulb is blown, check the filament. If the filament is coiled and unbroken, the bulb is not blown. If bulb is blown, replace it.
3. The battery may be completely discharged. Charge the unit following the directions on page 3.
4. If the Spotlight does not operate after recharging as directed, contact Technical Support toll-free at 1-800-544-6986.

For assistance with your product, visit our website www.blackanddecker.com for the location of the service center nearest you or call the BLACK & DECKER help line at **1-800-544-6986**.

Accessories

Recommended accessories for use with your tool are available from your local dealer or authorized service center. If you need assistance regarding accessories, please call: **1-800-544-6986**.

⚠ WARNING: The use of any accessory not recommended for use with this tool could be hazardous.

SERVICE INFORMATION

All Black & Decker Service Centers are staffed with trained personnel to provide customers with efficient and reliable power tool service. Whether you need technical advice, repair, or genuine factory replacement parts, contact the Black & Decker location nearest you. To find your local service location, refer to the yellow page directory under "Tools-Electric" or call: **1-800-544-6986** or visit **www.blackanddecker.com**.

FULL TWO-YEAR HOME USE WARRANTY

Black & Decker (U.S.) Inc. warrants this product for two years against any defects in material or workmanship. The defective product will be replaced or repaired at no charge in either of two ways.

The first, which will result in exchanges only, is to return the product to the retailer from whom it was purchased (provided that the store is a participating retailer). Returns should be made within the time period of the retailer's policy for exchanges (usually 30 to 90 days after the sale). Proof of purchase may be required. Please check with the retailer for their specific return policy regarding returns that are beyond the time set for exchanges.

The second option is to take or send the product (prepaid) to a Black & Decker owned or authorized Service Center for repair or replacement at our option. Proof of purchase may be required. Black & Decker owned and authorized Service Centers are listed under "Tools-Electric" in the yellow pages of the phone directory and on our website www.blackanddecker.com.

This warranty does not apply to accessories. This warranty gives you specific legal rights and you may have other rights which vary from state to state or province to province. Should you have any questions, contact the manager of your nearest Black & Decker Service Center. This product is not intended for commercial use.

FREE WARNING LABEL REPLACEMENT: If your warning labels become illegible or are missing, call 1-800-544-6986 for a free replacement.

SPECIFICATIONS

Spotlight Bulb:	12 volt, H3 series, 75 watt
Battery:	Maintenance-free, sealed lead acid, 12 volt, 3 amp hour
AC Charger:	UL Listed Class 2, 12 volt DC (300 mA)
DC Plug Fuse:	8 A/250 V

Imported by
Black & Decker (U.S.) Inc.,
701 E. Joppa Rd.
Towson, MD 21286 U.S.A.



See "Tools-Electric"
– Yellow Pages –
for Service & Sales



Vector Products, Inc.
4140 S.W. 30th Ave.
Fort Lauderdale, FL 33312

Free Manuals Download Website

<http://myh66.com>

<http://usermanuals.us>

<http://www.somanuals.com>

<http://www.4manuals.cc>

<http://www.manual-lib.com>

<http://www.404manual.com>

<http://www.luxmanual.com>

<http://aubethermostatmanual.com>

Golf course search by state

<http://golfingnear.com>

Email search by domain

<http://emailbydomain.com>

Auto manuals search

<http://auto.somanuals.com>

TV manuals search

<http://tv.somanuals.com>