

Horizon MCS 100 Satellite
Horizon MCS 130 Surround
Horizon MCS 130 LCR



Specifications	MCS 100 Satellite Speaker	MCS 130 Surround Speaker	MCS 130 LCR Speaker
Frequency Response:	120Hz – 20kHz	120Hz – 20kHz	110Hz – 20kHz
Recommended Amplifier Power Range:	10 – 100 watts	10 – 150 watts	10 – 150 watts
Sensitivity:	88dB [2.8v at 1m]	88dB [2.8v at 1m]	88dB [2.8v at 1m]
Nominal Impedance:	8 ohms	8 ohms	8 ohms
Crossover Frequency:	3,000Hz	2,700Hz	2,700Hz
Midrange:	3" (76mm) treated fiber with Phase Plugs and MagnaGuard®	3 1/2" (89mm) copolymer DCD™ with Phase Plugs and MagnaGuard®	Dual 3 1/2" (89mm) copolymer DCD™ with Phase Plugs and MagnaGuard®
Tweeter:	3/4" (19mm) Kortec® Soft Dome	1" (25 mm) Kortec® Soft Dome	1" (25 mm) 1" Kortec Soft Dome
Dimensions: (H x W x D)	7 3/8 x 4 3/8 x 4 1/16" (189 x 113 x 93mm)	8 7/16 x 5 1/2 x 4" (214 x 140 x 102mm)	13 7/8 x 5 x 4 1/16" (351 x 125 x 103mm)
Weight:	2 1/2 lbs (1.14kg)	3 lbs (1.36kg)	5 lbs (2.27kg)

Introduction

Boston Acoustics Multi-Channel Solution

Thank you for choosing a Boston Acoustics Multi-Channel Solution speaker. These speakers incorporate high-quality components that produce the famous Boston sound. They are ideally suited for use in a 5.1 channel high-quality home theater or music system.

The MCS series speakers deliver exceptionally articulate on-screen dialog, music, effects, and room filling bass from a small, sleek package. Compact driver placement and quality, system specific crossovers ensure wide, uniform sound dispersion for complete coverage of a listening room. All speakers also feature MagnaGuard® magnetic shielding which ensures the speaker's magnetic field does not interfere with the television's picture.

Unpacking the Speaker

Carefully unpack the speaker. If there is any sign of damage from transit, report it immediately to your dealer and/or delivery service. Keep the shipping carton and packing materials for future use.



Placement Options

The MCS 100 Satellite, MCS 130 Surround and MCS 130 LCR speakers are easily placed on a shelf or wall-mounted. The speakers are configured for shelf use when you first unpack them. The MCS 130 LCR will have one foot installed that will keep it level when used in the vertical position. An extra foot and thumb screw is provided with the MCS 130 LCR so it can be adapted for horizontal use as a center channel speaker. The illustration shows how to reposition the foot, and install the other.

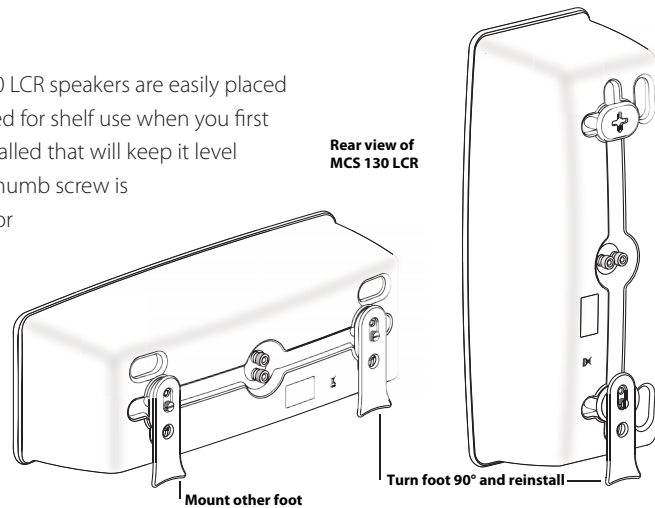

There are 2 sets of holes on the feet of the MCS 130 Surround and LCR speakers. By using the upper of the two holes, the speakers will have a slight forward angle for use on a high shelf. The foot on the MCS 100 Satellite speaker has only one screw hole and so does not offer the forward tilt option.

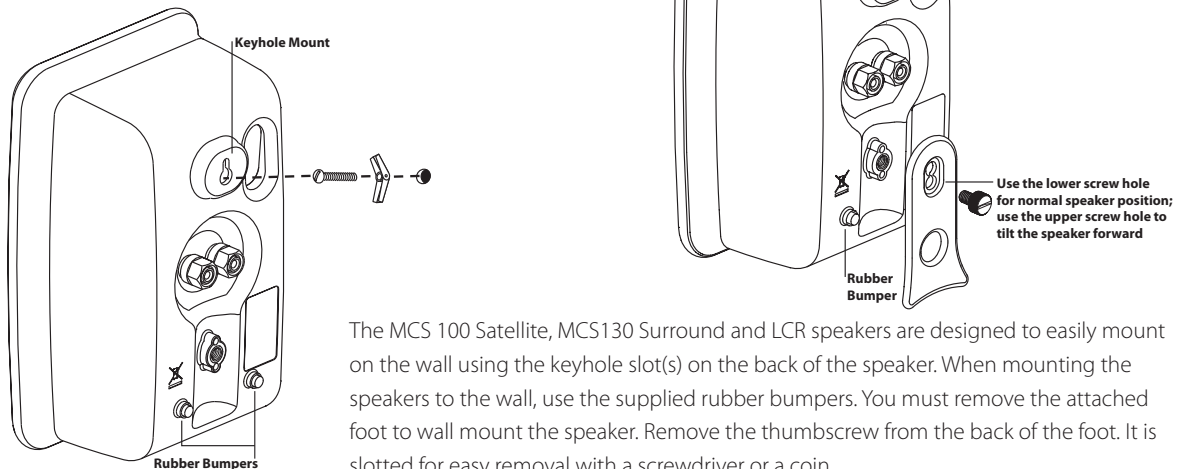

The MCS 100 Satellite, MCS130 Surround and LCR speakers are designed to easily mount on the wall using the keyhole slot(s) on the back of the speaker. When mounting the speakers to the wall, use the supplied rubber bumpers. You must remove the attached foot to wall mount the speaker. Remove the thumbscrew from the back of the foot. It is slotted for easy removal with a screwdriver or a coin.

NOTE: Because there are so many different kinds of surfaces on which the speakers could be mounted. There is no one type of fastener that we could supply that would work in all the possible situations. So taking into account the surface the speaker is being mounted on, acquire the appropriate type of fasteners. If you're not sure what type of fastener to use, take the speaker to a friendly hardware store, tell them about the wall you're mounting the speaker on, and ask them to recommend an appropriate fastener. Keep in mind the weight of the speaker.

Speaker Connections

After your speakers are properly placed, you are ready to wire your system. First, turn off all system power. We recommend using 18-gauge (1.0 mm) or larger speaker wire for runs up to 25 feet (8m), and thicker 16-gauge (2.0 mm) or larger for longer runs. Strip $\frac{1}{2}$ " (12mm) of insulation off the ends of each speaker cable to expose the two conductors and tightly twist the wire strands. See the illustrations below for examples of how to connect the wires to the MCS series speakers.

For connection to your receiver, please refer to its owner's manual.

The MCS 100 Satellite speaker uses push-to-connect terminals for speaker wire connections

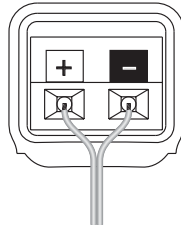

The MCS 130 Surround and MCS 130 LCR speakers use five-way binding posts for speaker wire connections

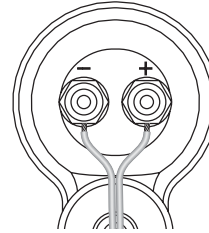

Be sure to maintain proper + and - polarity at all speaker wire connections

IMPORTANT!

Be sure to observe polarities when making speaker connections. Connect each + terminal on the back of the amplifier or receiver to the respective + (red) terminal on each speaker. Connect the - (black) terminals in the same way. Failure to do so can cause poor bass response and imaging. To avoid short circuits that may damage your equipment be careful not to let any of the bare wires touch each other.

Speaker wires can be routed through the channels on the back of the speaker and the holes in the feet

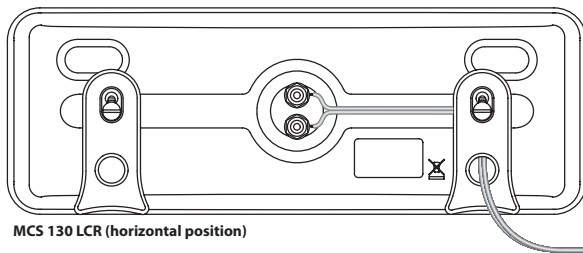

MCS 130 LCR (horizontal position)

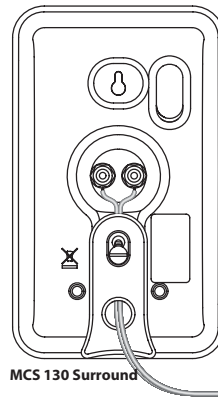

MCS 130 Surround

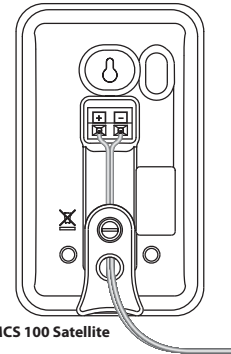

MCS 100 Satellite

Operation

When using the MCS 100 Satellite, MCS130 Surround or MCS 130 LCR speakers in a Dolby Digital or DTS home theater system, the receiver should be configured for "Small" speakers. When using the speakers in a Dolby Pro Logic® home theater system, make sure the receiver's center channel mode is set to "Normal."

Some Dolby Digital-equipped receivers/processors offer different setup options for each source or surround mode (e.g., CD-stereo, videotape, Dolby Digital, Pro Logic). In each case, follow your equipment's instructions to ensure that the subwoofer output is turned on and that the speakers are set to "Small" in each mode.

If your receiver has adjustable crossover settings, we recommend the subwoofer crossover be set at 150Hz for the MCS 100 Satellite and 120 Hz for the MCS 130 Surround and LCR. Refer to the owner's manual for your AV receiver for any additional recommendations on system operation.

Maintenance and Service

The speaker enclosures may be cleaned using a damp cloth to remove fingerprints or to wipe off dust. All wiring connections should be inspected, cleaned or reconnected at least once a year.

If a problem does occur, make sure that all connections are properly made, secure and clean. If a problem occurs in one loudspeaker reconnect that speaker to a different channel in the system. Should the problem persist in that speaker the problem is in the speaker. If the speaker sounds fine in the new position it indicates a more in-depth issue with the electronics in the system. In the event that your MCS series speaker ever needs service, contact your local Boston Acoustics dealer or visit www.bostona.com for a list of dealers in your area.

Limited Warranty

Boston Acoustics warrants to the original purchaser of our MCS series speakers that they will be free of defects in materials and workmanship in its mechanical parts for a period of 5 years from the date of purchase.

Your responsibilities are to install and use them according to the instructions supplied, to provide safe and secure transportation to an authorized Boston Acoustics service representative, and to present proof of purchase in the form of your sales slip when requesting service.

Excluded from this warranty is damage that results from abuse, misuse, improper installation, accidents, shipping, or repairs/modifications by anyone other than an authorized Boston Acoustics service representative.

This warranty is limited to the Boston Acoustics product and does not cover damage to any associated equipment. This warranty does not cover the cost of removal or reinstallation. This warranty is void if the serial number has been removed or defaced. This warranty gives you specific legal rights, and you may also have other rights which vary from state to state.

If Service Seems Necessary

First, contact the dealer from whom you purchased the product. If that is not possible, write to:

Boston Acoustics, Inc.
300 Jubilee Drive
Peabody, MA 01960 USA

Or contact us via e-mail at:
support@bostona.com

We will promptly advise you of what action to take. If it is necessary to return your MCS series speaker to the factory, please ship it prepaid. After it has been repaired, we will return it freight prepaid in the United States and Canada.

For EU Customers Only



This symbol found on the product indicates that the product must not be disposed of with household waste. Instead, it may be placed in a separate collection facility for electronic waste or returned to a retailer when purchasing similar product. The producer paid to recycle this product. Doing this contributes to reuse and recycling, minimizes adverse effects on the environment and human health and avoids any fines for incorrect disposal.

Boston Acoustics continually strives to update and improve its products. The specifications and construction details are subject to change without notice.



300 Jubilee Drive, Peabody, MA 01960 USA
www.bostonacoustics.com

© 2007 Boston Acoustics, Inc. Boston, Boston Acoustics, Kortec, BassTrac, and MagnaGuard are registered trademarks and the B/A ellipse symbol are trademarks of Boston Acoustics, Inc. Specifications are subject to change without notice. Dolby Digital, and Dolby Pro Logic are registered trademarks of Dolby Laboratories. DTS is a registered trademarks of DTS, Inc. 142-003059-0

Free Manuals Download Website

<http://myh66.com>

<http://usermanuals.us>

<http://www.somanuals.com>

<http://www.4manuals.cc>

<http://www.manual-lib.com>

<http://www.404manual.com>

<http://www.luxmanual.com>

<http://aubethermostatmanual.com>

Golf course search by state

<http://golfingnear.com>

Email search by domain

<http://emailbydomain.com>

Auto manuals search

<http://auto.somanuals.com>

TV manuals search

<http://tv.somanuals.com>