

# DM™ 604 S2

## Floor-standing loudspeaker system

### Product Summary

- The DM604 S2 is an excellent choice for high performance hi-fi systems or as a front channel speaker in a sophisticated Home Cinema system.
- The DM604 S2 has a aluminium dome tweeter, one woven Kevlar® cone mid-range driver and two paper/Kevlar® cone bass drivers. The second cone is specifically tailored to extend low frequency response and increase power handling.
- The two bass drivers incorporate our mushroom dustcap construction, where the whole diaphragm structure is stiffened in girder fashion by using a larger diameter dustcap.

### Technical highlights

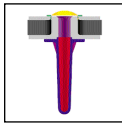

Nautilus™ Tweeter: B&W's Nautilus Tweeter technology ensures that the sound remains focused and time-sensitive and that the stereo-image is presented with unparalleled three dimensional accuracy.



Kevlar®: B&W developed and patented the method of using Kevlar® for loudspeaker cones to reduce unwanted standing waves. DuPont originally created Kevlar® for use in bulletproof vests.



<b>Description</b>	3-way vented-box system	<b>Nominal impedance</b>	8 (min 3 )
<b>Drive units</b>	1 x 25mm metal dome high-frequency 1 x 180mm woven Kevlar® cone bass/midrange 2 x 180mm paper/Kevlar® cone bass	<b>Power handling</b>	25W - 200W into 8 ohm on unclipped programme
<b>Frequency response</b>	44Hz - 20kHz ± 3dB on reference axis	<b>Dimensions</b>	Height: 996mm Width: 236mm Depth: 411mm
<b>Sensitivity</b>	90dB spl (2.83V, 1m)	<b>Finishes</b>	Cabinet: Cherry or Black Ash Vinyl, Grilles: Black cloth



LISTEN AND YOU'LL SEE

## Free Manuals Download Website

<http://myh66.com>

<http://usermanuals.us>

<http://www.somanuals.com>

<http://www.4manuals.cc>

<http://www.manual-lib.com>

<http://www.404manual.com>

<http://www.luxmanual.com>

<http://aubethermostatmanual.com>

Golf course search by state

<http://golfingnear.com>

Email search by domain

<http://emailbydomain.com>

Auto manuals search

<http://auto.somanuals.com>

TV manuals search

<http://tv.somanuals.com>