

DSP-2

instructions



Brady Worldwide Identification Solutions

6555 West Good Hope Road

P.O. Box 2131

Milwaukee, WI 53201-2131

Phone: (800) 537-8791

Fax: (800) 292-2289

www.bradyid.com

05/01



CONTENTS

Read this user's manual before use to ensure proper operation. Keep the manual on hand for reference in case there is a problem.

Warranty Information	2
Features	3
Notes	3
Repair Policy	3
Specifications	3
Set-up	4
Operation/Adjustments	5
Maintenance	6
Legend	6
Exploded View	7

WARRANTY POLICY FOR DSP SERIES LABEL DISPENSERS

Brady Corporation warrants all parts on DSP series label dispensers against defects in design, materials and workmanship for a period of 180 days. Labor to replace defective parts will be performed at no charge for the first 90 days after date of purchase. Warranty does not cover transportation costs.

Our sole obligation under this warranty is limited to repair, replacement or credit of the purchase price, at our option, for the machines listed above, which do not perform properly the function for which they were designed.

Warranty repair is contingent upon our examination and determination that alleged defects have not been caused by misuse, abuse, improper installation or application, repair, alteration, accident or neglect in use, storage, transportation or handling.

The above warranty and remedy constitutes Brady Corporation's sole liability hereunder and are in lieu and exclusive of all other warranties and remedies expressed, implied, or statutory, including, but not limited to, those of merchantability and fitness for a particular purpose.

EXPLODED VIEW

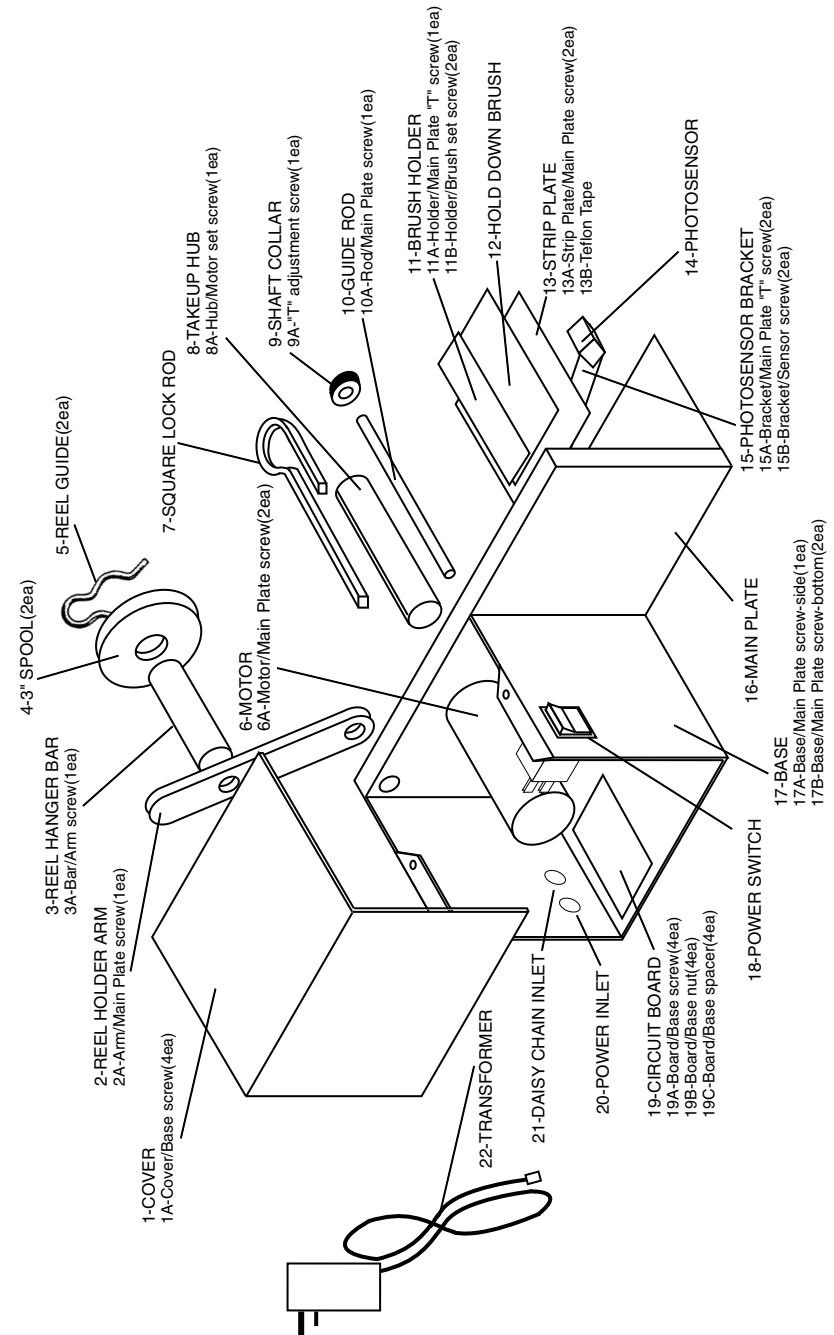

NOTE: Drawing not to scale – for reference only.

SET-UP INSTRUCTIONS

Place the label roll onto the reel hanger bar. The roll should be against a metal lock clip so that it is held straight. Place second metal lock clip onto reel hanger bar to keep the labels snug.

Thread the web under the guide rod, between the hold down brush and the strip plate and back under the strip plate. Lay the web across the slot in the take-up hub. Lock the web in position with the metal lock rod. (The take-up hub turns counter-clockwise.)

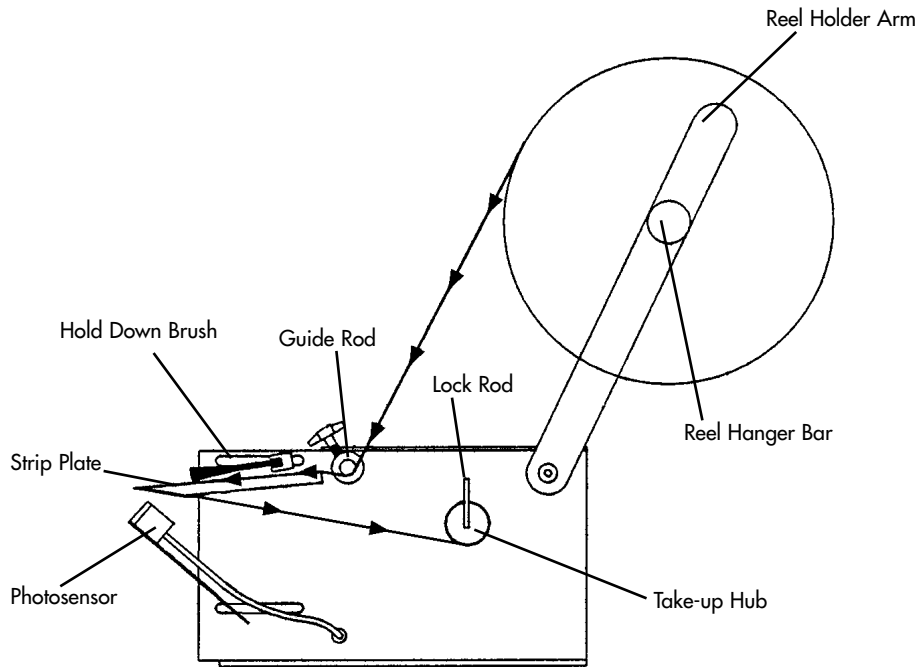

Daisy-chain option:

DSP-2 dispensers can be "daisy-chained" together to operate in series. When a label is removed from one of the machines, the next label will not feed until the labels are removed from all the machines. Example: If 3 machines are "daisy-chained" together, when a label is taken off the first machine, it will not feed; when a label is taken off the second machine, it will not feed. When the label is taken from the third machine, all machines will feed their respective labels. (DSP-2-CABLE needed to "daisy-chain" machines.)

ADJUSTMENTS

Hold Down Brush:

Using the upper thumbscrew on the side of the machine, adjust the hold down brush for tensioning. For best results, labels should be pressed firmly against the strip plate. However, if the labels are held too tightly, they will cause excessive drag on the motor.

Photosensor:

The photosensor can be adjusted in any direction by using the lower thumbscrew on the side of the machine and the thumbscrew underneath the photosensor bracket. Loosening the thumbscrew on the side of the machine allows the photosensor to move in and out. This is used to set the overhang distance of the label over the strip plate. The thumbscrew underneath the photosensor bracket is used to swivel the sensor along the front of the strip plate. When the label is being fed the correct distance, lock the bracket in place. If there are 2 or more labels across, align the photosensor with the last label to be removed. When these screws are locked in place, the machine is set.

Positioning of Photosensor

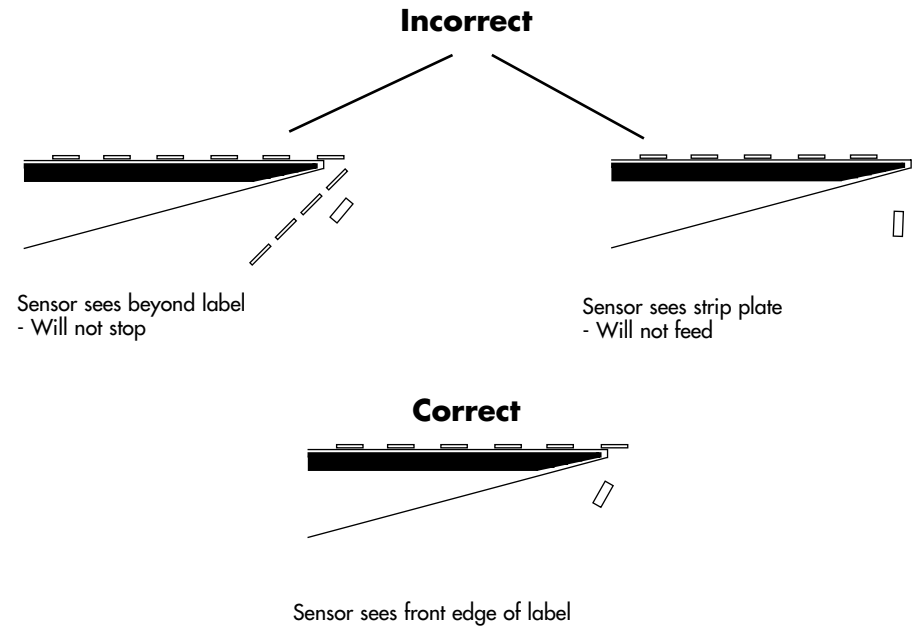

MAINTENANCE

- Turn machine off when not in use.
- Remove liner material from take-up hub when it reaches approximately 2" in diameter or if the motor appears to be straining.
- Do not operate machine without covers in place.
- Do not operate if inspection reveals a damaged power or sensor cord.
- Keep strip plate, hold down brush and hub free of adhesive build-up.

LEGEND	
Model DSP-2	
Item #	Part #
1	NV2000-12
1A	NV1000-12-1
2	NV2000-07
2A	NV1000-07-1
3	NV2000-08
3A	NV1000-07-1
4	NV-SPOOL
5	NV1000-22
6	NV1000-05
6A	NV1000-05-1
7	NV2000-10
8	NV2000-09
8A	NV1000-09-1
9	NV1000-18
9A	NV1000-13-1
10	NV2000-06
10A	NV1000-01-1
11	NV2000-03
11A	NV1000-13-1
11B	NV1000-03-1
12	NV2000-04
13	NV2000-02
13A	NV1000-01-1
13B	NV1000-02-1
14	NV1000-15
15	NV2000-13/21
15A	NV1000-13-1
15B	NV1000-15-1
16	NV2000-01
17	NV2000-11
17A	NV1000-11-1
17B	NV1000-01-1
18	NV1000-16
19	NV1000-17
19A	NV1000-17-1
19B	NV1000-17-2
19C	NV1000-17-3
20	NV1000-19
21	NV2000-23
22	NV1000-20 (115V)
	NV1000-20A (220V)

FEATURES

- Will dispense butt-cut and die-cut material.
- Adjustable photosensor for pinpoint accuracy.
- Handled lock rod makes scrap removal easy.
- No tools required for adjustment.

NOTES

- Keep strip plate free of adhesive build-up.
- Clean photosensor with compressed air or dry cloth.
- Do not drop the dispenser or subject it to heavy shock.
- Turn off machine when not in use.

REPAIR POLICY

Contact BRADY CORPORATION to determine nature of problem.

Furnish Brady with the following information:

1. Who the unit was purchased from.
2. Model number and serial number.
3. Date purchased (copy of invoice or packing slip required).

Brady will issue an RGA (Return Goods Authorization) for repair. Return machine to Brady by UPS, insured and prepaid. Brady will notify the customer if there is a repair charge.

SPECIFICATIONS:

Model#	DSP-2
Liner Capacity Width	.25" to 2.25" (6.35mm to 57.15mm)
Label Length	25" to 3" (6.35mm to 76.2mm)
Roll Capacity	6" (15.2mm)
Feed Speed	2.2" / sec* (5.6mm / sec.)
Dimensions Inches	7.3 (L) x 4.9 (W) x 9.5 (H)
Centimeters	18.5 (L) x 12.5 (W) x 24.1 (H)
Weight	2.00 lb. (.91 kg.)
Electrical Requirements	12V Dc with 115V adapter (12V Dc with 220V adapter available)

*speed calculated at 60 Hz

Free Manuals Download Website

<http://myh66.com>

<http://usermanuals.us>

<http://www.somanuals.com>

<http://www.4manuals.cc>

<http://www.manual-lib.com>

<http://www.404manual.com>

<http://www.luxmanual.com>

<http://aubethermostatmanual.com>

Golf course search by state

<http://golfingnear.com>

Email search by domain

<http://emailbydomain.com>

Auto manuals search

<http://auto.somanuals.com>

TV manuals search

<http://tv.somanuals.com>