

BRAUN

AromaSelect 12

KF 185

Type 3116

Coffeemaker

English
Use Instructions
Guarantee
Service Centers



Helpline

Should you require any further assistance please call
Braun (UK) Customer Relations on
0 19 32 / 79 22 33.



Internet:

<http://www.braun.com>

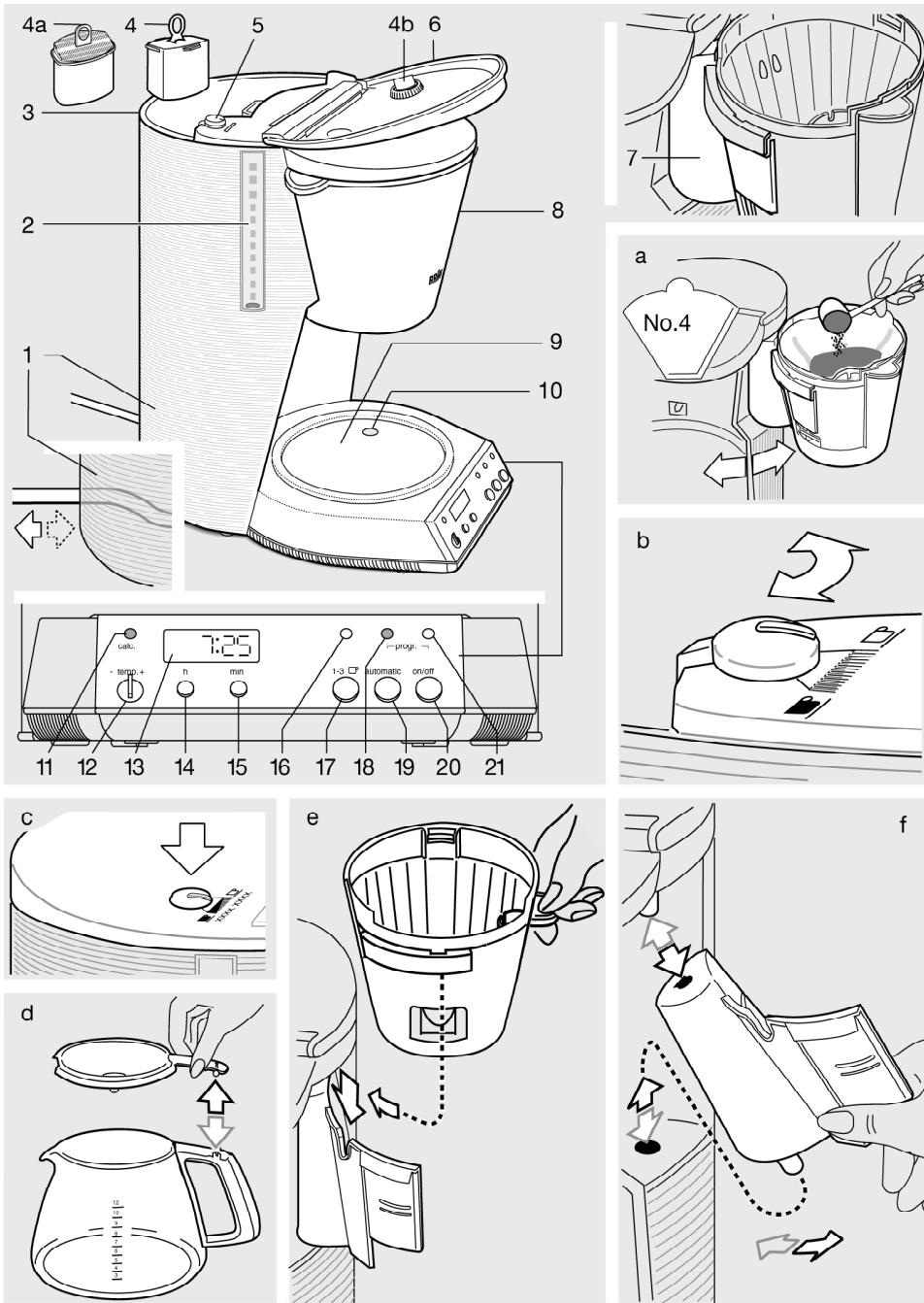

English

Our products are engineered to meet the highest standards of quality, functionality and design. We hope you thoroughly enjoy the new Braun appliance.

Caution

Read all instructions before using this product.

This appliance must be kept out of the reach of children! Before plugging into a socket, check whether your voltage corresponds with the voltage printed on the bottom of the appliance.

Do not put the carafe on other heated surfaces (such as stove plates, hot trays, etc.).

Before you start preparing coffee a second time, always allow the coffeemaker to cool down approximately for 5 minutes between brewing (switch the appliance off), otherwise steam can develop when you pour cold water into the water container and this could cause scalding.

The hotplate ⑨ heats up when the appliance is switched on. Avoid touching it and never let the cord come into contact with it.

Braun electric appliances meet applicable safety standards. Repairs on electric appliances must only be done by authorised service personnel. Faulty, unqualified repair work may cause accidents or injury to the user.

The cord of the appliance may only be replaced by an authorised Braun Service Centre as a special tool is required.

Important

This appliance was constructed to process normal household quantities. Always use cold water to make coffee. Warm water or other liquids could cause damage to the coffeemaker.

Before using the first time, or when the coffeemaker has not been used for some time, fill the water container ③ to the maximum level with cold water (i.e. without coffee and without a filter). Turn on the coffeemaker and allow the water to flow through.

Maximum cups

- 12 cups (125 ml each)
- 18 cups (83 ml each)

Functions

- AromaSelect feature
- Time display (24 hour clock)
- Manual operation
- Automatic operation (24 hours)
- Brewing small amounts (1-3 cups – 125 ml each)

- Audio-visual «coffee ready» signal
- Automatic hotplate switch-off (from 3.59 hours to 0.00 hours)
- Adjustable heating temperature (+/- 5 °C)
- Descaling/decalcifying control

Description

- ① Cord storage
- ② Water level indicator
- ③ Water container
- ④ Space compensator
- ④a Water filter cartridge
- ④b Dial for water filter exchange
- ⑤ AromaSelect dial (mild taste = ☐ /strong taste = ☐)
- ⑥ Cover for the water container
- ⑦ Filter support bracket
- ⑧ Filter holder
- ⑨ Hotplate
- ⑩ Temperature sensor
- ⑪ Decalcifying indicator «calc»
- ⑫ Temperature selector «-temp.+» (for the hotplate ⑨)
- ⑬ Display
- ⑭ Button «h» (for setting the hours)
- ⑮ Button «min» (for setting the minutes)
- ⑯ Yellow control lamp (for the small amounts operation)
- ⑰ Button for the small amounts operation «1-3 ☐»
- ⑱ Green control lamp (for the automatic operation)
- ⑲ Button for the «automatic» operation
- ⑳ «On/off» button
- ㉑ Red/green control lamp (for on/off setting and the automatic hotplate switch-off feature)

Setting the clock

Plug the appliance in. Three noughts appear on the display ⑬ of the electronic digital clock.

To activate the timer, both buttons ⑭ and ⑮ must be pressed for at least 2 seconds each. Then press the buttons «h» ⑭ or «min» ⑮ as described below until the correct time of day appears on the display ⑬. 5 seconds after the last adjustment, the coffeemaker will automatically return to the previous mode of operation.

To set the correct time of day, first press the button «h» ⑭ to programme the hours.

Then press the button «min» ⑮ to programme the minutes. Recommendation: Just before reaching the correct time, repeatedly press the buttons «h» and «min» without holding down to avoid going past the time required.

The dots between the hours and minutes will flash once the clock has been programmed.

Note: If the power supply is interrupted or the plug is pulled out of the socket, the clock will run for a further 15 minutes. All programmed functions are also stored for 15 minutes.

Filling with coffee grounds

Swing out the filter holder ⑧ (a) and insert the filter.

Put coffee grounds (not ground too finely) into the filter and close the filter holder again (a) until it snaps in place. Measure coffee according to the strength desired.

Filling with water

Important: When filling with water and during coffee preparation either the space compensator ④ or the water filter cartridge ④a must be installed in the water container ③. Otherwise the water level indicator ② will not function correctly and the carafe may overflow.

Fill the water container with as much cold water as coffee is required. To do this, lift the cover for the water container ⑥ and pour the cold water into the water container ③. The amount of water is shown on the water level indicator ② (maximum 12 cups – 125 ml each).

Space compensator

The space compensator ④ in the water container ③ takes up the space which is intended for the water filter cartridge ④a. Unless the water filter cartridge is installed in the water container, the space compensator must always be inside the water container when filling with water and brewing to avoid overflowing. **Keep the space compensator** as it has to be installed in the water container if you have to decalcify your coffeemaker.

Water filter cartridge

The water filter cartridge ④a is suitable for drinking-water only. It gives your purer tasting coffee by removing chlorine, bad tastes and odors as well as scale. Provided the cartridge is regularly replaced, it provides not only better tasting coffee, but also can increase the life of your coffeemaker by preventing calcification.

Installing the water filter cartridge

Unpack the water filter cartridge ④a. Then put the filter cartridge for 10 minutes in a receptacle filled with water.

Remove the space compensator ④ from the water container and replace it by the water filter cartridge ④a. **Make sure to keep the space compensator** as it could be needed if you do not use the water filter any longer at a future point in time or for decalcification.

After having installed a new water filter cartridge, allow the maximum amount of fresh, cold water to run through the coffeemaker.

In order to ensure the proper functioning of the filter cartridge, exchange it after 2 months of regularly using the coffeemaker. In order to remind you to replace the filter in time, you may set the dial ④b incorporated in the cover of the water container to the month when the cartridge has to be exchanged.

Dial for water filter exchange

After having installed a new filter cartridge, set the dial ④b 2 months further by turning it from the reverse side of the water container cover.

Pre-selecting the taste – AromaSelect dial

By adjusting the AromaSelect dial ⑤, you can adjust the taste of your coffee to suit your personal preference – milder with less bitter aftertaste or stronger, but always with the same full flavour. The AromaSelect dial ⑤ can be adjusted in two different ways, both before you turn on the coffeemaker. With the water container lid closed, grasp the dial by the two raised grip points and turn in the desired direction. Alternatively, with the water container lid open, turn the dial with the attached L-shaped grip.

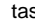
If you prefer milder coffee with less bitter aftertaste, turn the AromaSelect dial ⑤ in the direction of the  symbol (b). Should you prefer a more stronger taste, turn the AromaSelect dial towards the  symbol. Regardless of the position you select, the coffee will always have the same full coffee flavour only a milder or stronger aftertaste. With the cover of the water container closed, the selected setting can always be seen (c).

Manual operation

To switch on, press the «on/off» button ⑫. The control lamp ⑭ will light up red indicating that the coffeemaker is switched on and brewing is in process. To switch off the coffeemaker, press the «on/off» button ⑫. The red control lamp ⑭ will briefly flash and all control lamps will go off.

Automatic operation

To programme the automatic operation, press the «automatic» button ⑩ until the green control lamp ⑮ begins to flash. Three noughts or the previously programmed time appear on the display ⑬.

When the green control lamp ⑮ begins to flash, release the button ⑩ and, as described under «Setting the clock», programme the time for automatic operation by pressing the buttons «h» ⑭ and «min» ⑮. After programming is completed, the green control lamp ⑮ will go off after 5 seconds.

To activate automatic operation, briefly press the button «automatic» ⑩. The green control lamp ⑮ lights up, the pre-set brewing time is briefly shown on the display ⑬. Brewing automatically begins at the pre-set time.

When the brewing process begins, the green control lamp ⑮ goes off and the control lamp ⑭ lights up red to indicate that brewing has begun.

If, for instance, you want to make coffee at the same time on the following day, you must activate the automatic operation again (see above). However, this should only be done after brewing is finished or the programmed time for the hotplate switch-off (when none of the control lamps are on), as you could otherwise interrupt brewing or switch off the hotplate ⑨.

Making coffee

Place the carafe **with the lid** on onto the hotplate ⑨ and snap the filter holder ⑧ in place. Switch the coffeemaker on as described. Brewing time is approx. 50 seconds per cup (including dripping). A «drip stop» prevents dripping when lifting off the Carafe **shortly**. Remove the filter holder ⑧ to empty grounds (see section «Cleaning»).

Brewing small amounts (1 - 3 cups – 125 ml each)

Switch the coffeemaker on with the «on/off» button ⑫. The control lamp ⑭ lights up red. Press the button «1 - 3  » ⑦. The yellow control lamp ⑯ lights up.

This indicates that the function for brewing small amounts is activated and the coffeemaker is in operation. Brewing will begin.

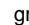
The facility for brewing small amounts can be pre-set in the automatic operation mode. Press briefly the «automatic» button ⑩. The control lamp ⑮ lights up green. Then press the button «1 - 3  » ⑦ and the yellow control lamp ⑯ lights up.

The coffeemaker will only brew small amounts of coffee in this mode if both the «1 - 3 cups» facility and the timing are pre-set.

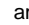
This function can be switched on or off during the brewing process. To switch off the function for small amounts, press the button «1 - 3  » ⑦. The yellow control lamp ⑯ will go off.

Audio-visual «coffee ready» signal

The signal indicates that brewing is finished and the water has run through the filter. The coffeemaker beeps 5 times and the control lamp ⑭ changes from red to green. To switch off the coffeemaker

manually, press the «on/off» button ⑫. The control lamp ⑭ lights up red briefly and all control lamps then go off.

Adjustable heating temperature

The heating temperature can be adjusted approximately 5 °C using the knob «-temp.+» ⑲. To reduce the temperature, turn the knob anti-clockwise. To increase the temperature, turn the knob clockwise.

Keeping the coffee hot

The carafe can remain on the hotplate ⑨ which begins to heat up when the coffeemaker is switched on and will keep the coffee hot until the coffeemaker is switched off (red control lamp goes out).

Automatic hotplate switch-off

The temperature sensor ⑩ in the hotplate ⑨ regulates the temperature of the coffee irrespective of the amount in the jug. The coffeemaker can be set to stay hot after brewing for up to 4 hours. Press the «on/off» button ⑫ until the control lamp ⑭ begins to flash red and the heating time appears on the display ⑬. Release the «on/off» button ⑫ and set the desired heating time with the buttons «h» ⑭ and «min» ⑮ from 3 hours 59 minutes to 0 hour 00 minutes. When the control lamp ⑭ shining red goes off, the pre-set heating time is stored in the memory and the display shows the time of day again.

After the brewing process, the control lamp ⑭ lights up green until the coffeemaker is automatically switched off at the end of the heating time. A double beep can be heard and all control lamps go off.

Cleaning

Always pull the plug out of the socket before cleaning (all programmed functions are stored for approximately 15 minutes). The appliance should never be immersed into water. Swing out the filter holder ⑧ and pull it off upwards from the filter support bracket ⑦ (e). To replace, set the curved protruding rim of the filter holder ⑧ on top of support bracket ⑦. Be sure that the rib under the rim of the filter holder ⑧ fits snugly into the groove on the support bracket ⑦ so that the filter holder ⑧ fits nearly into place and so the filter holder closes easily into the machine. To wash, take the lid off the carafe (d). The carafe, lid and filter holder can be cleaned in the dishwasher. All other parts should be cleaned with a damp cloth only. After cleaning, put the lid back on the carafe (d). Clean the hotplate ⑨ with liquid cleansers only. Do not use abrasive cleansers. The filter support bracket ⑦ can be taken off for cleaning. Swing it out, push it up and pull it off diagonally downwards (f). To replace, insert the top first.

Decalcifying

If you have hard water and you use your coffee-maker without a water filter, it has to be decalcified regularly. The frequency depends on the hardness of your water and how often you use your coffee-maker. When using the water filter cartridge (4) and exchanging it regularly, you normally will not need to decalcify.

However, if it is necessary to decalcify the coffee-maker, the decalcifying indicator «calc» (11) will flash red when the coffeemaker is switched on. When the programmed heating time is over or the coffeemaker is switched off manually, the indicator «calc» will go off, together with the control lamps.

Important: Replace the water filter by the space compensator (4) for any decalcifying procedure. When decalcifying, turn the AromaSelect dial (5) to the ☐ symbol.

You can either use a commercially available decalcifying agent which does not affect aluminium, or vinegar essence, available in food stores.

1. Follow the instructions of the manufacturer of the decalcifying agent.
2. Repeat the procedure at least twice with a newly prepared decalcifying solution, in order to ensure that all calcium residues have been removed.
3. Allow the maximum amount of fresh cold water to run through at least twice to cleanse the machine.

If you are using vinegar essence, please proceed as follows:

1. Fill the water container (3) to the mark for 3 cups with cold water.
2. Add vinegar essence to the mark for 6 cups.
3. Place the carafe with the lid onto the hotplate (9), close the filter holder (8) (without any type of filter) and switch on the coffeemaker.
4. Allow the decalcifying solution to run through.
5. Repeat this procedure at least three times with a newly prepared descaling solution, in order to remove all calcium residues.
6. Allow the maximum amount of fresh cold water to run through at least twice to cleanse the machine.

Subject to change without notice.

 This product conforms to the EMC-Requirements as laid down by the Council Directive 89/336/EEC

Guarantee

We grant a 1 year guarantee on the product commencing on the date of purchase.

Within the guarantee period we will eliminate, free of charge, any defects in the appliance resulting from faults in material or workmanship either by repairing, or exchanging parts or exchanging the whole appliance as we may choose.

Not covered by this guarantee: damage arising from improper use (operation with incorrect current/voltage, plugging it into an unsuitable power point, breakage), normal wear and defects which have a negligible effect on the value or operation of the appliance.

The guarantee becomes void if repairs are undertaken by unauthorized persons and if original Braun parts are not used.

The guarantee only comes into force if the date of purchase is confirmed by the dealer's stamp and signature on the guarantee card and registration card.

This guarantee extends to every country where this appliance is supplied by Braun or its appointed distributor and where no import restrictions or other legal regulations hinder or prevent service being given under guarantee.

Service under the guarantee does not affect the expiry date of the guarantee. The guarantee on parts or entire appliances which are exchanged ends when the guarantee on this appliance expires.

In the event of a claim under this guarantee, hand in the complete appliance with the valid guarantee card to your dealer, or send both to the nearest Braun Customer Service Centre.

All other claims including for damages resulting from this guarantee are excluded unless our liability is legally mandatory.

Those claims arising out of the sales contract with the vendor are not affected by this guarantee.

For UK only:

This guarantee in no way affects your rights under statutory law.

Free Manuals Download Website

<http://myh66.com>

<http://usermanuals.us>

<http://www.somanuals.com>

<http://www.4manuals.cc>

<http://www.manual-lib.com>

<http://www.404manual.com>

<http://www.luxmanual.com>

<http://aubethermostatmanual.com>

Golf course search by state

<http://golfingnear.com>

Email search by domain

<http://emailbydomain.com>

Auto manuals search

<http://auto.somanuals.com>

TV manuals search

<http://tv.somanuals.com>