

Canon

imageRUNNER®
5570 / 6570



CORPORATE
SYSTEMS



meap
POWERED BY I

BRINGING INNOVATION TO EVERY HIGH-VOLUME CORPORATE OFFICE

Capture, create, and communicate at network speed with the Canon imageRUNNER® 5570 and imageRUNNER 6570 devices. From high-speed scanning and local document storage to advanced finishing, electronic distribution, and Internet-ready capabilities, these next-generation imageRUNNER systems deliver unmatched performance, durability, and innovation.

Delivering output at speeds of up to 55 and 65 pages per minute, respectively, the imageRUNNER 5570 and imageRUNNER 6570 devices feature Canon's MEAP® (Multifunctional Embedded Application Platform) architecture as well as enhanced device management and security features. Send enhancements allow you to distribute documents instantaneously while usability improvements ensure ease-of-use. Plus, these devices support integration with Web-based information systems. With all these advanced features—and more—your office can achieve a new level of performance with the imageRUNNER 5570 and imageRUNNER 6570 systems.

imageRUNNER 5570/6570 Specifications

Type:	Digital, Multifunction Imaging System	Accessories		Saddle-stitching (Saddle Finisher-T2 Only)	
Imaging System:	Laser Dry Electrostatic Transfer	Universal Send™ Kit-D1 (Optional)		Acceptable Paper Sizes:	Letter-R, Legal, 11" x 17"
Developing System:	Dry Mono Component Developing System	Sending Methods:	E-mail, I-fax, Super G3 Fax (Optional), File Server (IPX, FTP, SMB), User Inbox	Capacity/Tray:	1 to 5 Sheets/25 Sets 6 to 10 Sheets/15 Sets 11 to 15 Sheets/10 Sets
Fixing System:	Induction Heating Fusing System	Address Book Capacity:	Max. 1,800 Destinations	Max. Stapling Capacity/Set:	15 Sheets
Image Server Memory:	Standard 512MB RAM/20GB HDD	File Format:		Folding:	V-fold
First-copy Time:	Approx. 3.3 Seconds or Less From Platen Glass	Standard:	TIFF, PDF,	Dimension (H x W x D):	42-3/4" x 25-1/2" x 25-7/8" (1,085mm x 648mm x 657mm)
Warm-up Time:	Approx. 30 Seconds or Less	Optional:	PDF (OCR)	Weight:	
Copy/Print Speed:	55/65 cpm/ppm (Letter)	Sending Sizes:	Statement to 11" x 17"	Finisher T1:	Approx. 88.2 lb. (40kg)
Acceptable Originals:	Sheets, Books, 3-dimensional Items (Up to 4.4 lb.)	Duplexing Automatic Document Feeder (Standard)		Saddle Finisher T2:	Approx. 163 lb. (74kg)
Max. Original Size:	11" x 17"	Acceptable Originals:	Statement to 11" x 17"	Attachable Accessories:	Puncher Unit-M1
Max. Copy Size:	11" x 17"	Capacity:	100 Sheets (20 lb. Bond)	Puncher Unit-M1 (Option for Finisher-T1/Saddle Finisher-T2)	
Min. Copy Size:	3-7/8" x 5-7/8"	Original Paper Weight:	13 lb. to 32 lb. Bond	Max. Paper Weight:	17 lb. Bond to 110 lb. Index
Max. Mail Boxes Supported:	100	Feeding Speed:	65 Sheets/Minute (Letter)	Paper Sizes:	
Max. Copy Reservation:	5 Jobs	Power Source:	From Main Unit	2-hole:	Letter-R, Legal, Executive
Actual Resolution:	600 x 600 dpi	Copy Tray-L1 (Optional)		3-hole:	Letter, 11" x 17"
Interpolated Resolution:	1200 x 600 dpi (Copy) 2400 x 600 dpi (Print)	Capacity:	250 Sheets (20 lb. Bond)	Punch Method:	Sequential Processing System (One sheet at a time)
Halftones:	256 Gradations	Dimension (H x W x D):	7-3/8" x 17-5/8" x 13-3/8" (186mm x 446mm x 340mm) (When auxiliary tray and auxiliary wire are extended)	Punch Dust Stock:	3,000 Sheets
Duplexing:	Standard Automatic Trayless Duplexing	Weight:	Approx. 1.4 lb. (670g)	Power Source:	From Main Unit
Magnification:	25% to 400% (Platen) 25% to 200% (Feeder) (in 1% Increments)	Finisher-T1 and Saddle Finisher-T2 (Optional)		Dimension (H x W x D):	32-3/4" x 4-1/4" x 24-1/2" (833mm x 107mm x 614.8mm)
Exposure Control:	Automatic or Manual (9 Levels)	Number of Trays:	3 Trays	Weight:	Approx. 15.9 lb.
Paper Sources		Tray Capacity		Paper Deck-V1 (Optional)	
Standard:	Dual Front-loading Trays (1,500 Sheets Each) Dual Front-loading Cassettes (550 Sheets Each) 50-sheet Stack Bypass 3,500-sheet Paper Deck (Total: 7,650 Sheets)	No-collate Mode		Number of Drawers:	1
Optional:		Tray A:	250 Sheets (Letter, Statement-R, Executive)	Paper Capacity:	3,500 Sheets (20 lb. Bond)
Multiple Copies:	1 to 999	Tray B:	125 Sheets (Legal, Letter-R, 11" x 17") 1,300 Sheets (Letter, Statement-R, Executive)	Paper Size:	Letter
Paper Weights (From All Sources):	17 lb. Bond to 110 lb. Index	Tray C:	650 Sheets (Legal, Letter-R, 11" x 17") 2,450 Sheets (Letter, Executive) 1,700 Sheets (Statement-R) 650 Sheets (Legal, Letter-R, 11" x 17")	Paper Weight:	17 lb. Bond to 110 lb. Index
Dimensions (H x W x D):	47" x 25-3/8" x 29-1/4" (1192mm x 643mm x 743mm)	Collate and Group Mode		Power Source:	From Main Unit
Weight:	Approx. 474 lb. (215kg)	Tray B:	1,300 Sheets (Letter, Executive) 650 Sheets (Legal, Letter-R, 11" x 17")	Dimension (H x W x D):	22-5/8" x 12-3/4" x 23" (574mm x 323mm x 583mm)
Power Requirements:	120VAC, 60Hz, 16A	Tray C:	1,700 Sheets (Letter, Executive) 650 Sheets (Legal, Letter-R, 11" x 17")	Weight:	Approx. 101 lb. (46kg)
Power Consumption:	1.85kW (Max.)	Staple Mode		Super G3 Fax Board-R1 (Optional)	
Plug:	NEMA 5-20R	Tray B/C:	1,300 Sheets/100 Sets (Letter, Executive) 650 Sheets/50 Sets (Legal, Letter-R, 11" x 17")	Applicable Line:	Public Switched Telephone Network (PSTN)
Drum:	Amorphous Silicon – Estimated Yield: 3,000,000 Impressions 220,000/250,000 Impressions per Month	Max. Stapling Capacity		Connection Lines:	1
Maximum Duty Cycle:		Corner/Double:	50 Sheets (Letter, Executive) 30 Sheets (Letter-R, Legal, 11" x 17")	Sending/Original Size:	Statement to 11" x 17"
Toner Yield:	45,000 Images (at 6% Coverage)			Recording/Printing Size:	Statement to 11" x 17"
				Transmission Times**	
				ECM-MMR:	Approx. 3.2 Seconds
				G3MR:	Approx. 13 Seconds
				G3MH:	Approx. 13 Seconds
				JBIG:	Approx. 2.6 Seconds
				Scan Line Density	
				Standard:	8 pels/mm x 3.85 lines/mm
				Fine:	8 pels/mm x 7.7 lines/mm
				Super-Fine:	8 pels/mm x 15.4 lines/mm
				Ultra-Fine:	16 pels/mm x 15.4 lines/mm
				Auto Dial Function:	Address Book: 1,800 Destinations
				Image Memory:	Approx. 8,000 Pages

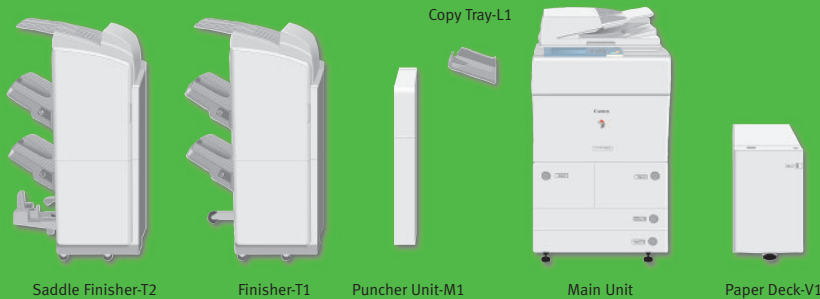

imageRUNNER®
5570/6570

imageRUNNER 5570/6570 Specifications (Continued)

Canon Multi-PDL Printer Kit-G1 (Optional)

Processor:	Canon Custom Processor—Shared
Memory:	512MB—Shared
Storage:	20GB—Shared
PDL Support:	PCL 5e/6, PostScript® 3™ Emulation, UFR II (Ultra Fast Rendering)
Interface Connections	
Standard:	10/100Base-T (RJ-45), USB 2.0 High Speed
Network OS:	Windows® 98/Me/2000/XP Windows NT® 4.0/Server 2003 Solaris™ 1.1x, 2.5x or later Macintosh® OS 8.0 or later (PPD) Novell® NetWare® v.3.2, 4.1, 4.11, 4.2, 5, 5.1, 6, 6.5 (IPX/SPX™)
Printer Drivers	
UFR II:	Windows 2000/XP Windows Server 2003 Citrix MetaFrame Macintosh OS X (OS 10.1.5 or later)
PCL 5e/6:	Windows 98/Me/2000/XP Windows NT 4.0/Server 2003 Citrix MetaFrame
PS 3 Emulation:	Windows 98/Me/2000/XP Windows NT 4.0/Server 2003 Macintosh OS X (OS 10.2 or later)
Internal Fonts	
PS:	136 Scalable Fonts
PCL 5e/6:	80 Scalable Fonts, 30 Barcode Fonts, 2 OCR Fonts, 10 Bitmap Fonts
Utility Software:	Network ScanGear Remote UI™ NetSpot® Console, NetSpot Job Monitor NetSpot Resource Downloader NetSpot Device Installer USB Class Driver, Fax Driver JBIG ImageViewer Canon LPR 2 Canon NDPS Gateway Canon Font Manager Canon Watermark Add-in DSE (Device Status Extension) Address Book Conversion Utility

imagePASS-M3 (V1.1) (Optional)

Type:	External Stand-alone Controller
Processor:	Intel® Celeron® 2.5GHz
Memory:	256MB
Storage:	40GB HDD
PDL Support:	Adobe® PostScript 3, PCL 5e, PCL 6
Interface Connections	
Standard:	10/100Base-T (RJ-45)
Optional:	Parallel Interface Adapter
Internal Fonts	
PS:	Roman PS Font (Type 1) – 126 Fonts Roman PS Font (True Type) – 10 Fonts 113 Fonts, 32 Barcode Fonts
PCL 5e/6:	
Protocol Stacks	
IPX/SPX:	Ethernet II/Ethernet 802.2/Ethernet 802.3/Ethernet SNAP
TCP/IP:	Ethernet II
AppleTalk:	Ethernet SNAP
SMB:	Ethernet II
Network OS:	Novell NetWare v.3.2, 4.1, 4.11, 4.2, 5, 5.1, 6.0, 6.5 (IPX/SPX) Windows 98/Me/2000/XP Windows NT 4.0 Solaris 2.5.1 or later Apple® Macintosh OS 9.0 or later
Dimensions (H x W x D):	15-1/2" x 6-3/8" x 15-3/4" (394mm x 162mm x 400mm)
Weight:	21 lb. (9.6kg)
Power Requirements:	110 to 240V, 1A
Utility Software:	Network ScanGear Remote UI NetSpot Console, NetSpot Job Monitor NetSpot Resource Downloader NetSpot Device Installer JBIG ImageViewer Canon LPR 2 Canon NDPS Gateway Canon Font Manager DSE (Device Status Extension) Fiery® Downloader Fiery Remote Scan Command WorkStation® E-mail Port Monitor WebTools™ Data Center Package Hot Folders Impose
EFI Options:	

Other Optional Accessories and Utilities

- Accessibility Handle-A1
- Barcode Printing Kit-B1*
- Braille Label Kit-A1
- Card Reader-C1
- Card Reader Attachment-C2
- Card Sets
- Cassette-AB1
- eCopy Suite
- Expansion Bus Board-C1
- imageRUNNER Security Kit-A2
- imageWARE™ Suite
- NetSpot Suite
- Remote Operator's Software Kit-A1
- Removable HDD Kit*
- Tab Feeding Attachment-A1
- USB Application Interface Board-D1
- Universal Send PDF Enhancement Kit-B1
- Voice Guidance Kit-A1*
- Web Access Software-A1

* Not available at time of launch. Please check with your local Authorized Canon Dealer.

** Approximate 3-second-per-page fax transmission time based on ITU-T No. 1 Chart (MMR, Standard Mode) at 33.6 Kbps modem speed when transmitting to another V.34 machine. The Public Switched Telephone Network (PSTN) currently supports 28.8 Kbps modem speeds or lower, depending on telephone line conditions.

© 2005 Canon U.S.A., Inc. All rights reserved.

As an ENERGY STAR® Partner, Canon U.S.A., Inc. has determined that these products meet the ENERGY STAR® guidelines for energy efficiency. ENERGY STAR and the ENERGY STAR certification mark are registered U.S. marks. Windows and Windows NT are registered trademarks of Microsoft Corporation in the United States and/or other countries. Adobe and PostScript are registered trademarks of Adobe Systems Incorporated in the United States and/or other countries. Apple and Macintosh are registered trademarks of Apple Computer, Inc. Intel and Celeron are registered trademarks of Intel Corporation. eCopy ShareScan is a trademark of eCopy, Inc. Novell and NetWare are registered trademarks of Novell, Inc. in the United States and other countries. IPX/SPX is a trademark of Novell, Inc. Solaris is a trademark of Sun Microsystems, Inc. in the United States and other countries. Fiery and Command WorkStation are registered trademarks, and webTools is a trademark of Electronics for Imaging, Inc. in the U.S. Patent and Trademark Office and/or certain other foreign jurisdictions. Canon, IMAGERUNNER, MEAP, NetSpot, and Canon Know How are registered trademarks, and Universal Send and the GENUINE logo are trademarks of Canon Inc. in the United States and may also be registered trademarks or trademarks in other countries. IMAGEPASS is a trademark of Canon Inc. IMAGEWARE is a registered trademark of Canon U.S.A., Inc. in the United States and is a trademark of Canon Inc. in certain other countries. Remote UI is a trademark of Canon U.S.A., Inc. IMAGEANYWARE is a service mark of Canon U.S.A., Inc. in the United States. All referenced product names and other marks are trademarks of their respective owners.

Specifications subject to change without notice.

0405-5570/6570-MC-PDF

 PRINTED ON RECYCLED
PAPER IN THE U.S.A.



Canon KNOW HOW®

1-800-OK-CANON
www.usa.canon.com

Canon U.S.A., Inc.
One Canon Plaza
Lake Success, NY 11042

Free Manuals Download Website

<http://myh66.com>

<http://usermanuals.us>

<http://www.somanuals.com>

<http://www.4manuals.cc>

<http://www.manual-lib.com>

<http://www.404manual.com>

<http://www.luxmanual.com>

<http://aubethermostatmanual.com>

Golf course search by state

<http://golfingnear.com>

Email search by domain

<http://emailbydomain.com>

Auto manuals search

<http://auto.somanuals.com>

TV manuals search

<http://tv.somanuals.com>