



4289 Bonny Oaks Drive • Chattanooga, TN 37406
TEL: (800) 426-3738 • FAX: (800) 325-8871
email: claritycs@plantronics.com website: www.clarityproducts.com

XL25s

(Line Powered)

Amplified telephone with both incoming and outgoing voice amplification



Operating Instructions

Ameriphone products are manufactured by Clarity®, a Division of Plantronics, Inc.

4289 Bonny Oaks Drive, Chattanooga, TN 37406

Tel: (800) 426-3738 Fax: (800) 325-8871

Email: claritycs@plantronics.com

Website: www.clarityproducts.com

©2004 Clarity, a Division of Plantronics, Inc. All rights reserved.

Ameriphone, Amplifying Your Life and Clarity are trademarks or registered trademarks of Plantronics, Inc.

Important safety Instructions	1
Introducing the XL-25s	
Warranty Service	4
Sales Receipt	4
Help from Ameriphone.....	4
Package checklist	5
Features	6
Setting up Your XL-25s	
Installing Back up Batteries	7
Connecting for Desk or Wall Mount	8
Desktop Use	8
Wall Mounts.....	8
Using Your XL-25s	
Outgoing Voice Volume.....	10
Incoming Voice Volume	11
Ringer Volume and Pitch	11
Hold	11
Last Number Redial.....	11
Flash	12
Special Features	
Programming the Memory Buttons	13
Direct Audio Output	14
Troubleshooting Chart	15
Specifications	15
Regulatory Compliance	16
Warranty	21

Important Safety Instructions

When using your telephone equipment, basic safety precautions should always be followed to reduce the risk of fire, electric shock and persons including the following:

1. Read and understand all instructions.
2. Follow all warnings and instructions marked on the telephone.
3. Do not use this telephone near a bathtub, wash basin, kitchen sink or laundry tub, in a wet basement, near a swimming pool or anywhere else there is water.
4. Avoid using a telephone (other than a cordless type) during a storm. There may be a remote risk of electrical shock from lightning.
5. Do not use the telephone to report a gas leak in the vicinity of the leak.
6. Unplug this telephone from the wall outlets before cleaning. Do not use liquid cleaners or aerosol cleaners on the telephone. Use a damp cloth for cleaning.
7. Place this telephone on a stable surface. Serious damage and/or injury may result if the telephone falls.
8. Do not cover the slots and openings on this telephone. This telephone should never be placed near or over a radiator or heat register. This telephone should not be placed in a built-in installation unless proper ventilation is provided.
9. Operate this telephone using the electrical voltage as stated on the base unit or the owner's manual. If you are not sure of the voltage in your home, consult your dealer or local power company.
10. Do not place anything on the power cord. Install the telephone where no one will step or trip on the cord.
11. Do not overload wall outlets or extension cords as this can increase the risk of fire or electrical shock.
12. Never push any objects through the slots in the telephone. They can touch dangerous voltage points or short out parts that could result in a risk of fire or electrical shock. Never spill liquid of any kind on the telephone.
13. To reduce the risk of electrical shock, do not take this phone

Important Safety Instructions

- apart. Opening or removing covers may expose you to dangerous voltages or other risks. Incorrect reassembly can cause electric shock when the appliance is subsequently used.
14. Unplug this product from the wall outlets and refer servicing to the manufacturer under the following conditions:
 - A. When the power supply cord or plug is frayed or damaged.
 - B. If liquid has been spilled into the product.
 - C. If the telephone has been exposed to rain or water.
 - D. If the telephone does not operate normally by following the operating instructions. Adjust only those controls that are covered by the operating instructions. Improper adjustment may require extensive work by a qualified technician to restore the telephone to normal operation.
 - E. If the telephone has been dropped or the case has been damaged.
 - F. If the telephone exhibits a distinct change in performance.
 15. Never install telephone wiring during a lightning storm.
 16. Never install telephone jacks in wet locations unless the jack is specifically designed for wet locations.
 17. Never touch uninsulated telephone wires or terminals unless the telephone line has been disconnected at the network interface.
 18. Use caution when installing or modifying telephone lines.
 19. Use only the power cord and batteries indicated in this manual. Do not dispose of batteries in a fire. They may explode. Check with local codes for possible special disposal instructions.

ADDITIONAL SAFETY NOTES FOR CANADIAN USERS

The following items are included as part of the CS-03 Requirements. The standard connecting arrangement for the equipment is CA11A. This product meets the applicable Industry Canada technical specifications.

NOTICE: The Canadian Department of Communications

Important Safety Instructions

label identifies certified equipment. This certification means that the equipment meets certain telecommunications network protective operational and safety requirements. The Department does not guarantee that the equipment will operate to the user's satisfaction. Before installing this equipment, users should ensure that it is permissible to be connected to the facilities of the local telecommunications company. The equipment must also be installed using an acceptable method of connection. In some cases, the company's inside wiring associated with a single line individual service may be extended by means of a certified connector assembly (telephone extension cord). The customer should be aware that compliance with the above conditions may not prevent degradation of service in some situations. Repairs to certified equipment should be made by an authorized Canadian maintenance facility designated by the supplier. Any repairs or alterations made by the user to this equipment, or equipment malfunctions, may give the telecommunications company cause to request the user disconnect

cause to request the user disconnect the equipment.

Users should ensure for their own protection that the electrical ground connections of the power utility, telephone lines and internal metallic water pipe system, if present, are connected together. This precaution may be particularly important in rural areas.

CAUTION: Users should not attempt to make such connections themselves, but should contact the appropriate electric inspection authority, or electrician, as appropriate. The Ringer Equivalent Number is an indication of the maximum number of terminals allowed to be connected to a telephone interface. The termination on an interface may consist of any combination of devices subject only to the requirement that the sum of the Ringer Equivalent Number of all the devices not exceed five.

SAVE THESE INSTRUCTIONS

Introducing the XL-25s

Thank you for selecting the amplified telephone XL-25s from Clarity. These Operating Instructions and the associated Quick Operating Guide provide you with the information you need to use your XL-25s effectively and safely. Read this manual thoroughly before using your telephone. Keep the manual near the telephone for easy reference.

Warranty Service

Your telephone is designed to provide years of quality service. But, should the phone malfunction and the Trouble-shooting Chart on page 11 not resolve the problem, follow the Warranty procedure on page 12.

Sales Receipt

Be sure to save your sales receipt as proof of purchase date should you need warranty service.

Help from Clarity

For help with using your XL-25s, call our Customer Service department at (800) 426-3738.

Please make sure your XL-25s package includes the items shown in Figure 1.

Package Checklist

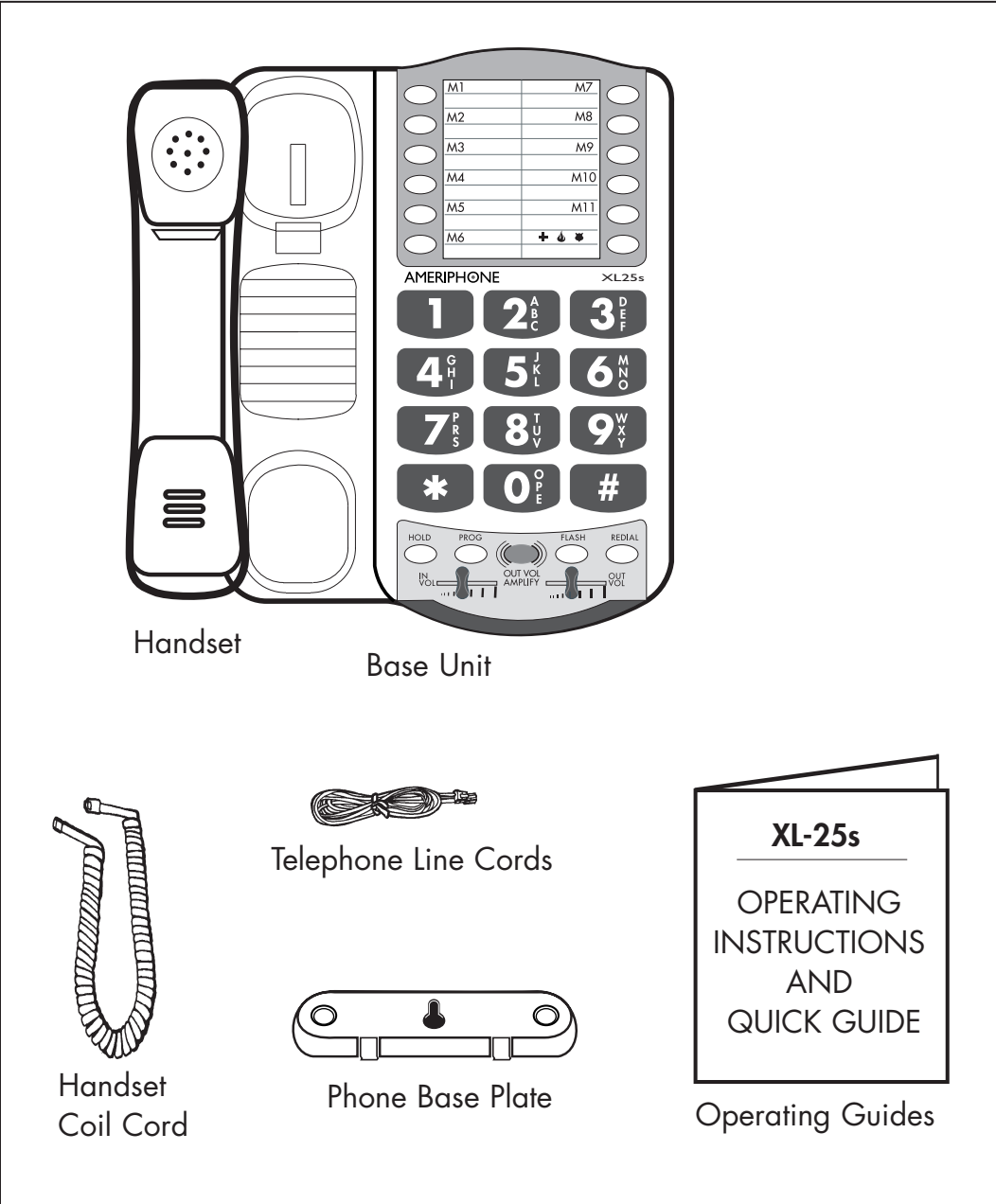

Handset

Base Unit

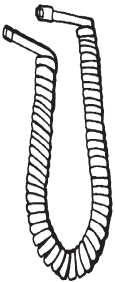

Handset
Coil Cord



Telephone Line Cords



Phone Base Plate

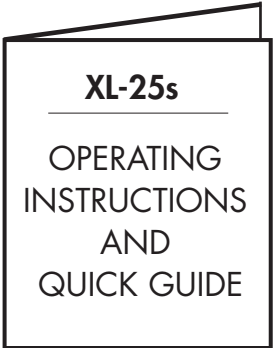

Operating Guides

Figure 1 - Package Components

Features on the XL-25s

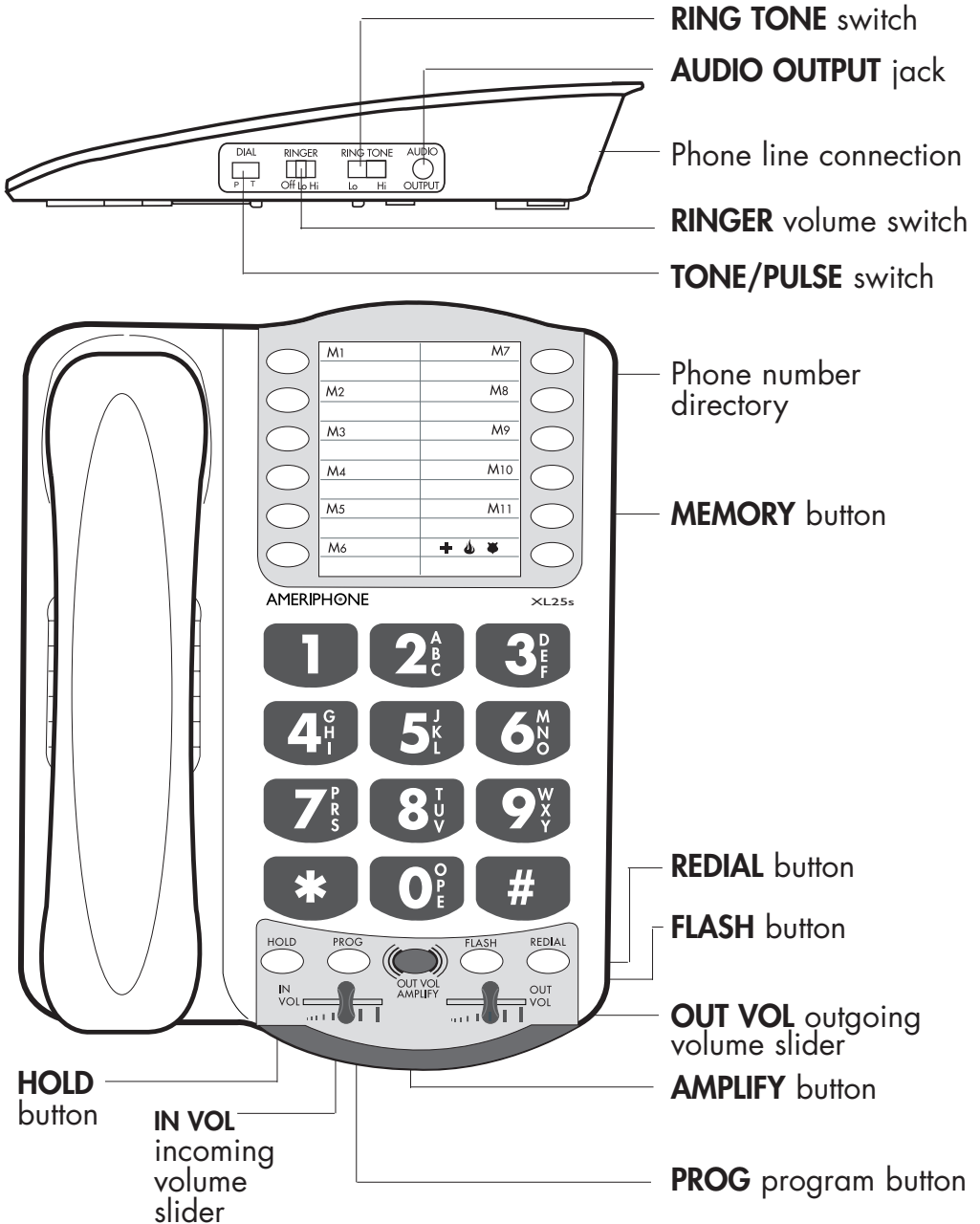

Figure 2 - Base Unit Controls

Setting up Your XL-25s

There are five steps involved in setting up your XL-25s.

1. Insert one 9 volt alkaline battery for extra bright ring flasher (optional)

Note: For your safety always unplug the phone line before you install or replace the backup battery.

2. Decide if you want the phone to sit on a desk or hang on the wall.
3. Connect the telephone components.
4. Program up to 12 telephone numbers to call with the press of a memory button.
5. Setup special features

Installing the Backup Batteries

To add extra brightness to the XL-25s's ring flasher when you receive calls, install one 9 Volt alkaline battery (not included).

Note: For your safety always unplug the phone line before you install or replace the backup battery.

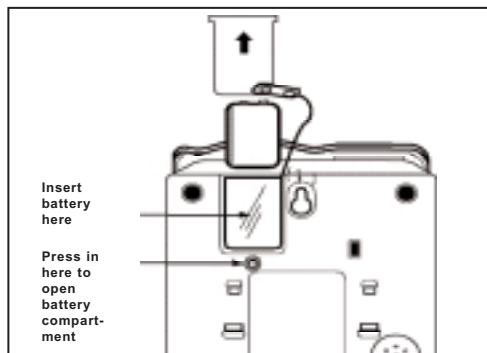

Figure 3

To install a new battery:

1. Slide open the battery compartment cover on the bottom of the telephone. (Figure 3).
2. Install one fresh 9-volt battery. The battery indicator on the base unit will light up if the battery is running low.

Setting the Dial Mode

Set the dial mode switch to **T** (tone) if you have touch tone service. Set the switch to **P** (pulse) if you have rotary dialing.

Connecting for Desk or Wall Mount

Desktop Use

1. Connect the telephone line cord and the handset cord to the telephone as shown in Figure 4.

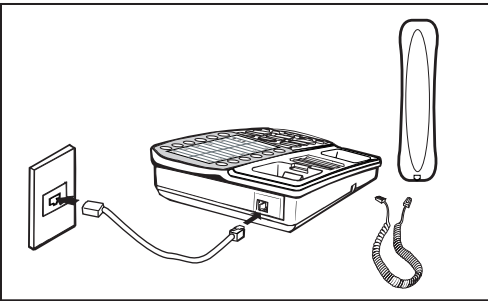

Figure 4 - Connecting the Components

2. Plug the AC adapter into an electric outlet and into the telephone as shown in Figure 4.
3. Lift the handset and listen for a dial tone.

The phone is ready to use.

Wall Mount

1. Pull the handset hook out as shown in Figure 5 and reverse its position so that the

hook points up and will hold the handset when you hang up.

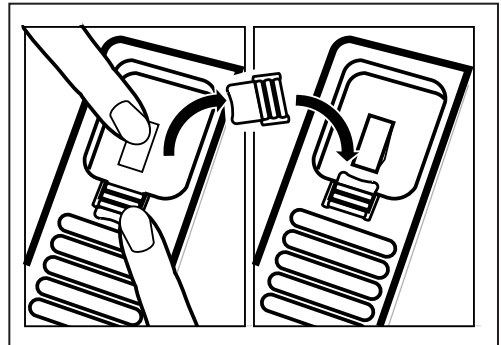

Figure 5 - Reversing the Hook

2. Insert the tabs of the phone base into the slots in the lower position of the base as shown in Figure 6. Push the phone base in and down firmly until it snaps into place.

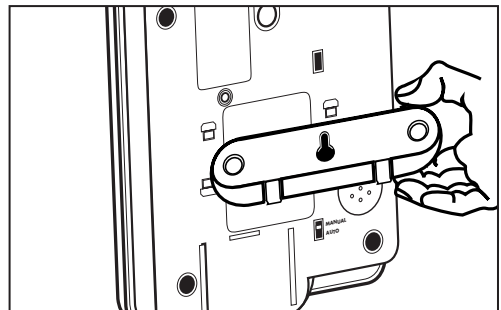

Figure 6 - Phone Base for Wall Mounting

3. Plug in the short phone line cord and mount the phone as shown in Figure 7.

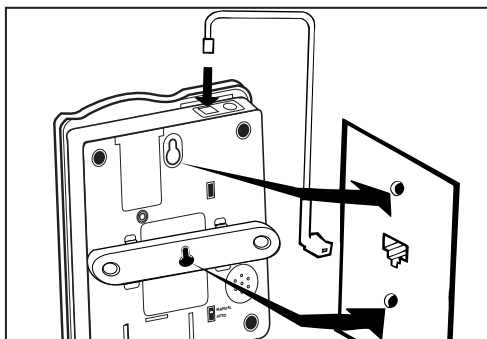

Figure 7 - Wall mounting installation

4. See Desktop Use section and follow steps 1 and 2.

Outgoing Voice Volume

1. Press the **OUT VOL AMPLIFY** button as shown in Figure 8 to turn the outgoing voice amplifier on or off.

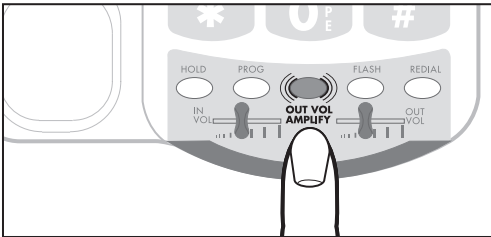

Figure 8 - AMPLIFY Button

2. Adjust the outgoing speech volume by moving the **OUT VOL** slide control in Figure 9. The amplification gives you up to 18+dB of sound boost. Slide the control button to the right to amplify your voice. Ask the person you are calling if they can hear you. Continue to adjust volume until the other party can hear you.

Note: Whether you speak loud or soft an internal Automatic Level Control Circuit will maintain a normal output level with crisp, distortion-free sound.

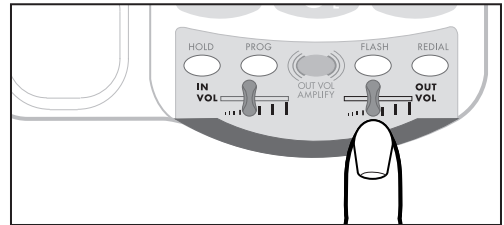

Figure 9 - Volume Slide Control

Note: In standard use of the XL-25s, the amplifier turns off whenever you hang up the telephone. This is a useful feature if many people use the phone. If you want the amplifier to always remain on at the most recent volume setting, slide the switch on the bottom of the phone, as shown in Figure 10.

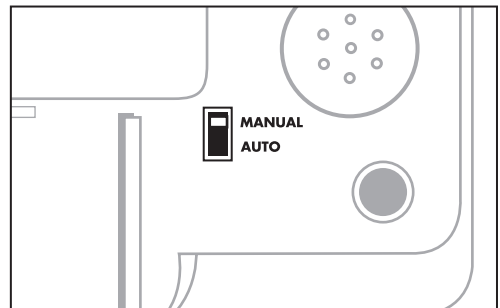

Figure 10 - Internal Amplifier On/Off

Using Your XL-25s

Incoming Voice Volume

The XL-25s provides extra volume (12dB) to increase incoming sound. To increase incoming sound:

1. Adjust the **IN VOL** slide control in Figure 11 to suit your hearing.

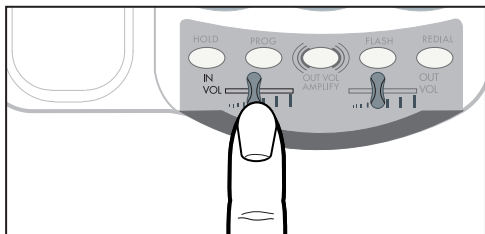

Figure 11 - Tone Slide Control

Ringer Volume and Pitch

1. You can adjust the **RINGER VOLUME** as high as 75 decibels. The settings available are **OFF**, **LO** and **HI** as shown in Figure 12.

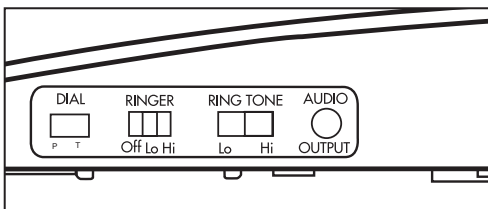

Figure 12 - Ringer Volume & Pitch

2. The **RING TONE** has two pitch settings: **LO** and **HI**.

Hold

To put the line on hold, press the **HOLD** button and return the handset to its cradle. You will notice the red indicator light comes on.

Note: If you pick up an extension phone on the same line when the XL-25s is on **HOLD**, the line will disconnect and you can continue your conversation on the extension phone.

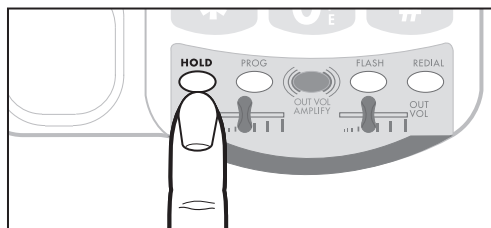

Figure 13 - Hold Button

Last Number Redial

To redial the last number dialed with the XL-25s phone, lift the handset and press **REDIAL**.

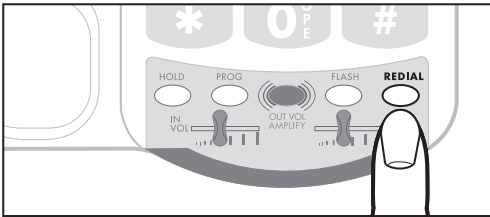

Figure 14 - Redial Button

Flash

Press the **FLASH** button shown in Figure 15 to access special services available from your local phone company such as Call Waiting and 3-Way Calling.

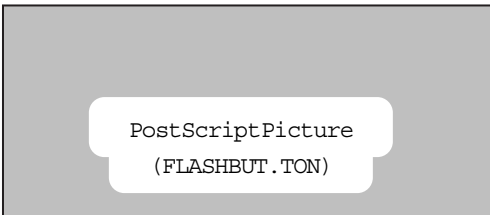

Figure 15 - Flash Button

Special Features

Programming the Memory Buttons

You can automatically dial twelve programmed telephone numbers using the memory buttons shown in Figure 16. Each button can be programmed (or reprogrammed using the same procedure) for a phone number up to 16 digits long.

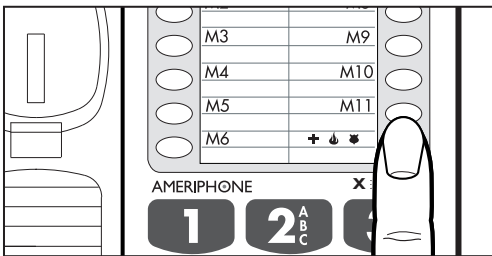

Figure 16 - Memory Buttons

To program a button, follow these steps:

1. Lift the handset and press **PROG** as shown in Figure 17.

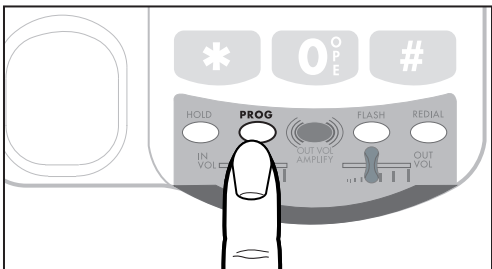

Figure 17 - PROG Button

2. Enter the phone number on the keypad (Figure 18) just as you would dial it normally.

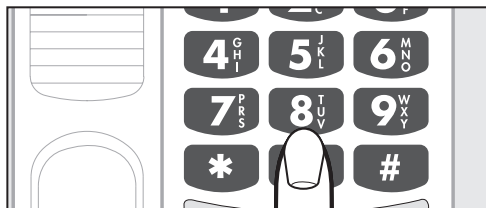

Figure 18 - Telephone Keypad

3. Press **PROG** (Figure 17) once again.
 4. Press a memory button (Figure 16) to store this number on that button.
 5. Immediately hang up the handset.
- Note: Any number previously stored at that button number will be overwritten.**
6. To change a stored number, repeat the programming process starting with step 1.

Direct Audio Output

The **AUDIO OUTPUT** socket allows you to connect the XL-25s audio output to an assistive listening devices.

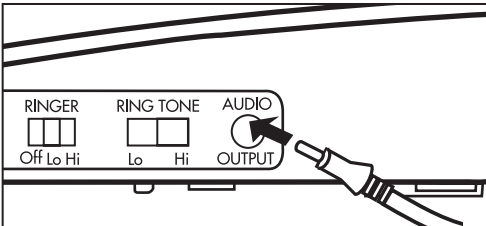

Figure 19 - Audio Output Socket

To use this port, plug in a compatible auxiliary cable and connect it to your assistive listening device. Speak into the handset when you use the Audio Output connection.

Troubleshooting Chart

Specifications

The chart below will help you solve most problems that may arise during operation of your telephone. Should the difficulty continue, contact Clarity at (800) 426-3738 or your authorized dealer for assistance.

Outgoing Volume Control
0 - 18dB

Incoming Volume Control
0 - 12dB

Dimensions
Size: 9 1/2" x 7" x 3 1/4"
Weight: 2.52 lbs.

Power Requirements
One 9 Volt alkaline battery for ring flasher operation only. (not included)

SYMPTOM	CAUSE AND CORRECTIVE ACTION
No dial tone	Check all phone cord connections.
No number dialed when memory button pressed	No number stored in that memory button. See: "Programming the Memory buttons".
Call cannot be dialed, or dials very slowly	See "Setting Up Your Phone" to reset the dial mode switch.
An incoming call does not produce an audible ring	Make sure the ringer is not set to the OFF position.
Ring flasher not very bright	Check and replace the 9 Volt battery

Part 68 of FCC Rules Information

This equipment complies with Part 68 of the FCC rules. On the bottom of this equipment is a label that contains, among other information, the FCC registration number and ringer equivalence number (REN) for this equipment. If requested, this information must be provided to the telephone company.

A plug and jack used to connect this equipment to the premises wiring and telephone network must comply with the applicable FCC Part 68 rules and requirements adopted by the ACTA. A compliant telephone cord and modular plug, RJ11 USOC, is provided with this product. It is designed to be connected to a compatible modular jack that is also compliant. See installation instructions for details.

The REN is used to determine the number of devices that may be connected to a telephone line. Excessive RENs on a telephone

line may result in the devices not ringing in response to an incoming call. In most but not all areas, the sum of RENs should not exceed five (5.0). To be certain of the number of devices that may be connected to a line, as determined by the total RENs, contact the local telephone company. For products approved after July 23, 2001, the REN for this product is part of the product identifier that has the format US:AAAEQ##TXXXX. The digits represented by ## are the REN without a decimal point (e.g., 03 is a REN of 0.3). For earlier products, the REN is separately shown on the label.

If this telephone equipment, the XL-30 telephone, causes harm to the telephone network, the telephone company will notify you in advance that temporary discontinuance of service may be required. But if advance notice isn't practical, the telephone company will notify the customer as soon as possible. Also, you will be advised of your right to file a

Regulatory Compliance (continued)

complaint with the FCC if you believe it is necessary.

The telephone company may make changes in its facilities, equipment, operations or procedures that could affect the operation of the equipment. If this happens the telephone company will provide advance notice in order for you to make necessary modifications to maintain uninterrupted service.

If trouble is experienced with this telephone equipment, for repair or warranty information, please contact Clarity, (800) 426-3738. If the equipment is causing harm to the telephone network, the telephone company may request that you disconnect the equipment until the problem is resolved.

DO NOT DISASSEMBLE THIS EQUIPMENT.

This telephone equipment is not intended to be repaired and it contains no repairable parts. Opening the equipment or any attempt to perform repairs will void the warranty. For service or

repairs, call (800) 426-3738.

Connection to party line service is subject to state tariffs. Contact the state public utility commission, public service commission or corporation commission for information.

If your home has specially wired alarm equipment connected to the telephone line, ensure the installation of this telephone equipment does not disable your alarm equipment. If you have questions about what will disable alarm equipment, consult your telephone company or a qualified installer.

This telephone equipment is hearing aid compatible.

We recommend the installation of an AC surge arrester in the AC outlet to which this equipment is connected. The telephone companies report that electrical surges, typically lightning transients, are very destructive to customer terminal equipment connected to AC power sources.

Customer-Owned Coin/Credit Card Phones:

To comply with state tariffs, the telephone company must be given notification prior to connection. In some states, the state public utility commission, public service commission or corporation commission must give prior approval of connection.

Part 15 of FCC Rules Information

This device complies with part 15 of the FCC Rules. Operation is subject to the following two conditions: (1) This device may not cause harmful interference, and (2) this device must accept any interference received, including interference that may cause undesired operation.

Your XL-25s Telephone has been tested and found to comply with the limits of a Class B digital device, pursuant to Part 15 of FCC rules. These limits are

designed to provide reasonable protection against harmful interference in residential installation.

This equipment generates, uses, and can radiate radio frequency energy and, if not installed and used in accordance with the instructions, may cause harmful interference to radio communications. However, there is no guarantee that interference will not occur in a particular installation; if this equipment does cause harmful interference to radio or television reception, which can be determined by turning the equipment off and on, you are encouraged to try to correct the interference by one of the following measures:

1. Where it can be done safely, reorient the receiving television or radio antenna.
2. To the extent possible, relocate the television, radio or other receiver with respect to the telephone equipment. (This increases the separation between the telephone

equipment and the receiver.)

3. Connect the telephone equipment into an outlet on a circuit different from that to which the television, radio, or other receiver is connected.
4. Consult the dealer or an experienced radio/TV technician for help.

CAUTION: Changes or modifications not expressly approved by the manufacturer responsible for compliance could void the user's authority to operate the equipment.

THE PARTY RESPONSIBLE
FOR PRODUCT COMPLIANCE
Clarity, A Division of Plantronics, Inc.
4289 Bonny Oaks Drive
Chattanooga, TN 37406
(800) 426-3738

Industry Canada Technical Specifications

This product meets the applicable Industry Canada technical specifications.

Before installing this equipment, users should ensure that it is permissible to be connected to the facilities of the local telecommunications company. The equipment must also be installed using an acceptable method of connection. In some cases, the company's inside wiring associated with a single line individual service may be extended by means of a certified connector assembly (telephone extension cord). The customer should be aware that compliance with the above conditions may not prevent degradation of service in some situations.

Repairs to certified equipment should be made by an authorized

Canadian maintenance facility designated by the supplier. Any repairs or alterations made by the user to this equipment, or equipment malfunctions, may give the telecommunications company cause to request the user to disconnect the equipment.

Users should ensure for their own protection that the electrical ground connections of the power utility, telephone lines and internal metallic water pipe system, if present, are connected together. This precaution may be particularly important in rural areas.

Caution: Users should not attempt to make such connections themselves, but should contact the appropriate electric inspection authority, or electrician, as appropriate.

The Ringer Equivalence Number is an indication of the maximum number of terminals allowed to be connected to a telephone interface. The termination on an interface may consist of any combination of devices subject only to the requirement that the sum of the Ringer Equivalence Numbers of all the devices does not exceed five.

[The term "IC:" before the certification/registration number only signifies that the Industry Canada technical specifications were met.]

This warranty applies only to Clarity products that are purchased and used in the United States or Canada.

Clarity warrants the XL-25s telephone against any defect in materials or workmanship for the period of one year from the date of purchase.

If your Clarity product is defective and returned within 30 days of the date of purchase, your Clarity dealer will replace it at no charge.

If returned after 30 days but within one year from the date of purchase, we will repair or replace it at no charge. In the repair of your XL-25s, we may use new or reconditioned replacement parts. If we elect to replace your XL-25s, we may replace it with a new or reconditioned product of the same or similar design. Repair or replacement will be warranted for either 90 days or the remaining time on the original warranty period, whichever is longer. Implied warranties, including those

of fitness for a particular purpose and merchantability (an unwritten warranty that the product is fit for ordinary use), are limited to one year from date of purchase. We will not pay for loss of time, inconvenience, loss of use of your XL-25s phone, or property damage caused by your XL-25s phone or its failure to work, or any other incidental or consequential damages. Some states do not allow limitations on how long an implied warranty lasts or the exclusion of incidental or consequential damages, so the above exclusions or limitations may not apply to you.

To get warranty service for your XL-25s phone, you must provide proof of the purchase date. Within 30 days of the date of purchase, return your XL-25s to the place where you purchased it for immediate replacement. After 30 days, call Clarity at (800) 426-3738 for the authorized service center nearest you. You must prepay all shipping costs. We suggest you save the original package materials in the event you need to ship

Warranty

the XL-25s. When shipping for warranty repair, include your name, address, phone number, proof of purchase, and a description of the problem. After repairing the product, we, (or the service center) will ship it back to you at no cost within the United States and Canada. CANADIAN RESIDENTS: call Clarity at (800) 426-3738 , for instructions.

This warranty does not cover defects resulting from accidents, damage while in transit to our service location, alterations, unauthorized repair, failure to follow instructions, misuse, use outside the United States or Canada, fire, flood, and acts of God. Nor do we warrant the product to be compatible with any particular telephone equipment, party line, key telephone systems or more sophisticated switching systems. If your XL-25s is not covered by this warranty, call us at (800) 426-3738 for advice as to whether we will repair your XL-25s and other repair

information. The repair shall be warranted for 90 days.



4289 Bonny Oaks Drive • Chattanooga, TN 37406
TEL: (800) 426-3738 • FAX: (800) 325-8871
email: claritycs@plantronics.com website: www.clarityproducts.com

Free Manuals Download Website

<http://myh66.com>

<http://usermanuals.us>

<http://www.somanuals.com>

<http://www.4manuals.cc>

<http://www.manual-lib.com>

<http://www.404manual.com>

<http://www.luxmanual.com>

<http://aubethermostatmanual.com>

Golf course search by state

<http://golfingnear.com>

Email search by domain

<http://emailbydomain.com>

Auto manuals search

<http://auto.somanuals.com>

TV manuals search

<http://tv.somanuals.com>