

TransDock.Direct



DIGITAL LIFESTYLE OUTFITTERS

Download from [www.Somanuals.com](http://www.Somanuals.com). All Manuals Search And Download.

© 2008 DIGITAL LIFESTYLE OUTFITTERS

The DLO logo, Digital Lifestyle Outfitters and TransDock are trademarks of Digital Lifestyle Outfitters. iPod is a trademark of Apple Inc., registered in the U.S. and other countries. All Rights Reserved

Printed in China

M93052-080725-B



<a href="#">Important Information</a>	04
<a href="#">About TransDock Direct</a>	05
Product Overview	05
What's in the Box	05
What You Will Need	05
<a href="#">Getting Started</a>	06
<a href="#">Using TransDock Direct</a>	08
Detailed Instructions	08
Using Your Detachable 12V Power Socket	10
<a href="#">Tech Specs</a>	11
<a href="#">Service + Support</a>	12
<a href="#">Warranty</a>	13

Please take a moment to read this manual before using your TransDock Direct. It contains important information about operating your new product.

### Disposal of your old product:

Your product is designed and manufactured with high quality materials and components, which can be recycled and reused. Please inform yourself about the local separate collection system for electrical and electronic products. Please take the package to your local recycling center.

### WARNINGS

- Do not expose the product to rain or water.
- Limit exposure to sunlight to prevent heat build-up.
- Do not disassemble or repair.
- Keep away from high voltage devices.

### Product Overview

TransDock Direct is an in-car iPod solution that connects your iPod directly to your car stereo via the car's auxiliary input with the included Aux-In Cable, while it charges and cradles your iPod. TransDock Direct also includes a detachable external 12V Power Socket that allows you to simultaneously charge other accessories, such as a GPS, gaming device, or mobile phone while enjoying your iPod. For cars not equipped with an aux-in port, the TransDock Direct will also work with cassette adapters (sold separately).

### What's in the Box

1. TransDock Direct Cradle
2. Car Power Adapter
3. Flex Arm
4. Detachable 12V Power Socket
5. Aux-In Cable
6. iPod touch Support Bracket
7. User Manual

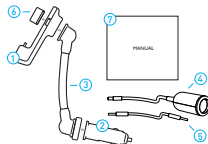

### What You Will Need

- iPod
- Car stereo with aux-in capabilities
- 12V auto power outlet

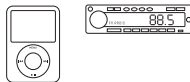

# Getting Started

This section will help with the initial installation of your TransDock Direct.

1. Assemble your TransDock Direct by attaching the Flex Arm to both the Car Power Adapter and the TransDock Direct Cradle.
2. Insert your TransDock Direct into your car's power outlet. TransDock Direct Cradle shows power status at a glance – one light when connected, two when charging and three when fully charged. TransDock Direct will indicate that it is receiving power with a single light.
3. Gently slide your iPod onto your TransDock Direct. Your iPod will now begin charging if your car is on. TransDock Direct will indicate that it is charging your iPod with two illuminated lights on the front of the cradle. When the third light is illuminated, your iPod is fully charged.
4. Insert the included stereo mini cable into the Aux-In Jack on the bottom of the TransDock Direct Cradle and connect to your car stereo's auxiliary input. The car's aux-in port may be located on the dashboard, alongside the stereo, under the dash or even in the glove compartment. Consult your car's owner's manual for details.
5. Click Play on your iPod to enjoy your music over your car stereo.  
**NOTE:** Your iPod will automatically pause playback when your TransDock Direct is powered off.

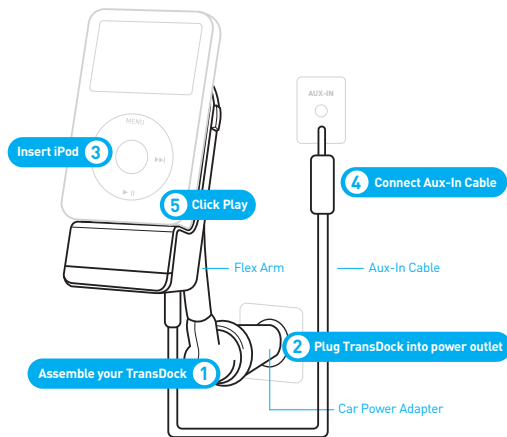

# Using TransDock Direct

## Detailed Instructions

---

1. Turn on your car stereo and set it to AUX mode.

**NOTE:** Labeling may vary by vehicle. Consult your car's owner's manual for details.

2. Assemble your TransDock Direct by attaching the Flex Arm to both the Car Power Adapter and the TransDock Direct Cradle.

**NOTE:** For cars that do not need the additional length of the Flex Arm, you may attach the TransDock Direct Cradle directly to the Car Power Adapter.

3. Insert your TransDock Direct into your auto power outlet. TransDock Direct will indicate that it is receiving power with a single illuminated light on the front of the cradle.

4. Gently slide your iPod onto your TransDock Direct. Your iPod will now begin charging if your car is on. The TransDock Direct display shows power status at a glance – one light when connected, two when iPod is charging, and three when iPod is fully charged.

**NOTE:** To ensure the best fit for your particular iPod, press the button on the upper right side of the TransDock Direct Cradle to extend or contract the circular adapter in the center of the TransDock Direct Cradle. Release the button to lock the adapter's position. For iPod touch users, you may attach the included iPod touch Support Bracket, which allows you to position your iPod touch horizontally in the TransDock Direct Cradle. Insert the iPod touch

Support Bracket into the center adapter and position it on either side of the TransDock Direct Cradle.

5. Insert the included stereo mini cable into the Aux-In Jack on the bottom of the TransDock Direct Cradle and connect to your car stereo's auxiliary input. The car's aux-in port may be located on the dashboard, alongside the stereo, under the dash or even in the glove compartment. Consult your car's owner's manual for details.
6. Click Play on your iPod to enjoy your music over your car stereo.
7. To control the overall volume of your music while using your TransDock Direct, use the stereo's volume control, not the iPod volume. The volume control function on your iPod is disabled while docked.

**NOTE:** To power another device, connect the detachable 12V Power Socket to the 5.5mm port on the top of the Car Power Adapter. You may now simultaneously power another device while enjoying your iPod. See [Using Your Detachable 12V Power Socket](#) on page 10 for more information.

**IMPORTANT:** Do not insert anything other than an appropriate plug that fits the socket, or allow any liquid to get into the socket. Doing so may cause electrical failure, electric shock, or a short circuit. The total combined current for the 12V socket should not exceed 10 amps. This accessory outlet should be used for accessories only; do not use a lighter element in this outlet.

## Using Your Detachable 12V Power Socket

The detachable 12V Power Socket allows you to power other accessories while enjoying your TransDock Direct. To install, locate the 5.5mm port on the top of the Car Power Adapter and insert the 5.5mm jack of the Power Socket. This will activate the 12V Power Socket.

**IMPORTANT:** Do not insert anything other than an appropriate plug that fits the socket, or allow any liquid to get into the socket. Doing so may cause electrical failure, electric shock, or a short circuit. The total combined current for the 12V DC socket should not exceed 10 amps. This accessory outlet should be used for accessories only; do not use a lighter element in this outlet.

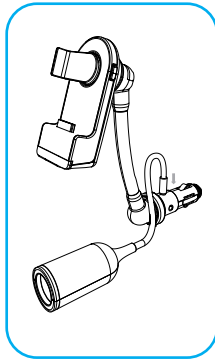

## COMPATIBILITY

All iPods with Dock Connector

## CONNECTIONS

30-Pin iPod Dock Connector

Auxiliary Input: 3.5mm stereo mini jack

Power Output: 5.5mm 12V DC jack

## POWER

Input Voltage: 12 – 16 VDC

Input Current: <300mA @ DC12V~16

Detachable Power Socket: 12V DC car adapter

## CABLE

3.5mm to 3.5mm Aux Cable

## TEMPERATURE

Storage Temperature: -10° to 120° F [-23° to 49° C]

Operating Temperature: -4° to 113° F [-20° to 45° C]

For more information and Frequently Asked Questions, please visit our website at [www.dlo.com](http://www.dlo.com) and click [Support](#).

## Digital Lifestyle Outfitters Limited Manufacturer's Warranty

**What This Warranty Covers.** DLO (Digital Lifestyle Outfitters) warrants this product against defects in materials and workmanship. This limited warranty applies only to products manufactured by or for DLO.

**What This Warranty Does Not Cover.** This warranty does not apply to damage caused by: (a) accident, abuse, misuse, misapplication, ordinary wear, improper maintenance, failure to follow instructions, or products not manufactured by or for DLO; and (b) aftermarket services (including upgrades and expansions).

**How Long This Warranty Lasts.** This warranty lasts for a period of ninety (90) days from the date of original retail purchase.

**What DLO Will Do.** If a defect exists, DLO will exchange the product, at its option, with a product that is new or has been manufactured from new or serviceable used parts and that is at least functionally equivalent to the original product. DLO will warrant a replacement product against defects in materials and workmanship for a period of ninety (90) days from the date of replacement.

**How To Get Service.** In order to be eligible for this warranty, you MUST register your purchase at [www.dlo.com/register](http://www.dlo.com/register) within thirty (30) days of purchasing this product. If you believe that this product is defective in materials or workmanship, please e-mail [customerservice@dlo.com](mailto:customerservice@dlo.com) with a brief description of the problem, for further instructions.

**No Change To Warranty.** No DLO reseller, agent or employee is authorized to make any modification, extension, or addition to this warranty.

**How State Law Applies.** This warranty gives you specific legal rights, and you also may have other rights that vary from state to state, or country.

**Restrictions On Implied Warranties.** All implied warranties, including, without limitation, warranties of merchantability and fitness for a particular purpose, are limited in duration to the duration of this warranty. Some states do not allow limitations on how long an implied warranty lasts, so the above limitation may not apply to you.

**Restrictions On Damages.** DLO is not responsible for direct, special, incidental or consequential damages resulting from any breach of warranty or condition or under any other legal theory (including, without limitation, lost profits; downtime; goodwill; damage to or replacement of equipment and property; failure to maintain the confidentiality of data stored on the product; and any costs of recovering, reprogramming or reproducing any program or data stored in or used with products manufactured by or for DLO). Some states and countries do not allow the exclusion or limitation of incidental or consequential damages, so the above limitation or exclusion may not apply to you.

W1000-050803-B







Thanks for purchasing TransDock Direct  
Enjoy the Ride

## Free Manuals Download Website

<http://myh66.com>

<http://usermanuals.us>

<http://www.somanuals.com>

<http://www.4manuals.cc>

<http://www.manual-lib.com>

<http://www.404manual.com>

<http://www.luxmanual.com>

<http://aubethermostatmanual.com>

Golf course search by state

<http://golfingnear.com>

Email search by domain

<http://emailbydomain.com>

Auto manuals search

<http://auto.somanuals.com>

TV manuals search

<http://tv.somanuals.com>