

# ***Remote Vehicle Starter***

---

***CSM-3***

## ***Owner's Manual***

INS0916  
Rev. A  
6/99

## ***Table of Contents***

<b>How the CSM-3 Operates .....</b>	<b>3</b>
<b>Starting the Vehicle with the Remote Starter .....</b>	<b>3</b>
<b>Stopping the Vehicle While It Is Running Via the Remote Starter .....</b>	<b>4</b>
<b>Operating Your Vehicle While the CSM-3 is Engaged .....</b>	<b>4</b>
<b>Engaging the CSM-3 When Exiting Your Vehicle .....</b>	<b>4</b>
<b>Status Indication .....</b>	<b>4</b>
<b>System Maintenance .....</b>	<b>5</b>
Changing the Remote Transmitter Battery	
Adding Remote Transmitters to Your System	
Programming Keyless Entry Characteristics .....	<b>6</b>
<b>Warranty Information .....</b>	<b>7</b>

This product was manufactured in environmentally friendly manufacturing facility and may contain certain recycled materials. All materials meet or exceed original specifications for quality and reliability.

**Warning: Operation of your remote vehicle starter can be dangerous. Avoid operating in confined or crowded areas.**

Download from [www.Somanuals.com](http://www.Somanuals.com). All Manuals Search And Download.

## How the CSM-3 Operates

The CSM-3 functions as a keyless entry system and a remote vehicle starter. All features of the CSM-3 are controlled through the supplied remote transmitters.

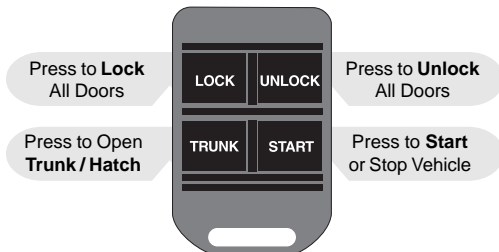

## Starting the Vehicle with the Remote Starter

Press the START button on the remote transmitter. The parking lights will flash one time to confirm that the vehicle is about to start. The CSM-3 will energize the vehicle ignition system and crank the starter for up to 5 seconds, disengaging as soon as the vehicle starts.

### If the vehicle does not start...

If the vehicle does not start on the first attempt, the CSM-3 will pause 5 seconds, then try 3 more times to start the vehicle (a total of four attempts). On each attempt the CSM-3 will crank the starter one second longer than the previous attempt. The CSM-3 pauses 5 seconds between each start attempt.

If the vehicle does not start after the fourth attempt, the CSM-3 will shut down.

### After the vehicle has started...

Immediately after the parking lights have turned on, the vehicle accessories (heater, air conditioning, etc.) will turn on to cool or heat the vehicle and the vehicle parking lights will turn on to indicate the vehicle has started (and is still running). The vehicle will run for 15 minutes before shutting down.

### If the vehicle stalls...

If the vehicle stalls, the CSM-3 will pause 5 seconds, then attempt to restart the vehicle following the same procedure as above. The 15-minute run time timer will resume where it left off when the vehicle stalled.

## ***Stopping the Vehicle While It Is Running Via the Remote Starter***

The vehicle will instantly shut down if any of the following occurs while it is running via the remote starter:

- The START button on the remote transmitter is pressed.
- The vehicle brake pedal is pressed before the ignition key is turned to the ON position.
- The vehicle hood is opened before the ignition key is turned to the ON position.
- The engine is "revved" at or near 3000 RPM.

## ***Operating Your Vehicle While the CSM-3 is Engaged***

When your vehicle is running via the remote starter, perform the following steps to transition from CSM-3 operation to normal operation without shutting the vehicle off:

1. Press the UNLOCK button and enter the vehicle.
2. Without pressing the brake, insert the key into the ignition and turn to the ON position. **DO NOT CRANK THE STARTER.**
3. Press the brake pedal. The parking lights will turn off, indicating that the vehicle is running normally (the CSM-3 is inactive).

## ***Quick-Stop™***

If you wish to leave your vehicle running while you make a short stop (at a convenience store for instance), the CSM-3 enables the vehicle to continue running, while allowing you to remove your keys and take them with you. Perform the following steps while the vehicle is running:

1. Make sure the vehicle is in PARK.
2. With your foot OFF the brake pedal, press the START button on your remote transmitter. One second later, the parking lights will turn on, indicating that the vehicle is running via the remote starter.
3. Turn the ignition key off and remove. The vehicle will continue to run for 15 minutes, or until you return.
4. You may lock the doors with your remote transmitter while the vehicle is running via the remote starter.

## ***Status Indication***

The CSM-3 uses the vehicle parking lights to indicate the system's current status while operating:

- 1 flash - Vehicle is about to start
- 2 flashes - Can't start - hood is open or brake is pressed
- On Solid - Vehicle is running via the remote starter

## System Maintenance

### Changing the Remote Transmitter Battery

The 12-volt alkaline battery supplied in your remote transmitter should last approximately one year, depending on usage. When the battery begins to weaken, you will notice a decrease in range, or the distance from your vehicle that your remote transmitter will operate. Follow the instructions below to change the remote transmitter battery.

1. Remove the screw (if equipped) on the back of your remote transmitter.
2. Use a small coin or screwdriver to pry off the back of the transmitter case.
3. Replace the worn battery with a new battery.
4. Replace the case backing and test. It is not necessary to reprogram the remote transmitter after changing the battery.

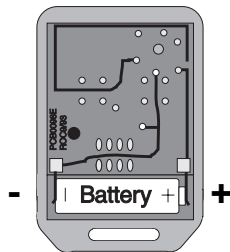

### Adding Remote Transmitters to Your System

**Note:** Each CSM-3 module has four “slots”, or memory locations, to store remote transmitter codes, giving it the ability to operate from up to four remote transmitters. For proper operation, a transmitter code must be stored into each memory slot. When using less than four remote transmitters, follow the suggested programming parameters:

- **One Remote Transmitter** - Program four (4) times
- **Two Remote Transmitters** - Program each transmitter two (2) times
- **Three Remote Transmitters** - Program one transmitter twice, and each remaining transmitter once.

1. Press and hold the brake pedal. Turn the ignition on and off **three (3) times**, then release the brake pedal.  
*If done correctly, the unit will respond by flashing the parking lights three (3) times. (From inside the vehicle, you will hear three (3) ‘clicks’ from the module.) This indicates that the unit has entered the programming mode.*
- 2a. Without pressing the brake pedal, press the LOCK button (button 1) on the remote transmitter to be programmed.  
*The parking lights will flash once (one click from the module), indicating that the system has “learned” that remote transmitter.*
- 2b. Repeat step 2a for any additional transmitters or transmitter codes.
3. Press and release the brake pedal to exit the programming mode. Test all remote transmitters to ensure that they work properly.

## System Maintenance

### Programming Keyless Entry Characteristics

1. Press and hold the brake pedal. Turn the ignition on and off **four (4) times**, then release the brake pedal.  
*If done correctly, the unit will respond by flashing the parking lights four (4) times. (From inside the vehicle, you will hear four (4) 'clicks' from the module.) This indicates that the unit has entered the programming mode.*

2. Press the LOCK button (button 1) on a programmed

transmitter to begin option selections. The vehicle parking lights will flash a number of times to indicate the number of the option.

The vehicle door locks indicate whether an option is on or off.

- **If the selected option is ON, the doors will lock.**
- **If the selected option is OFF, the doors will unlock.**
- **Doors will lock or unlock when an option is changed.**

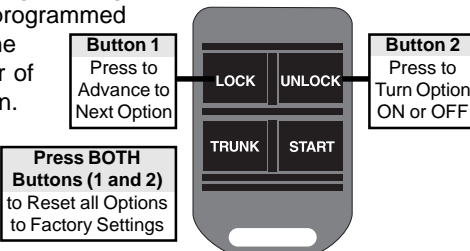

Option Number and Description	<i>Bold Type Indicates Factory Settings</i>	Door Locks	
		Locked	Unlocked
1 Doors lock when all doors are closed and ignition is turned on	<b>YES</b>	NO	
2 Doors unlock when ignition is turned off	<b>YES</b>	NO	
3 Courtesy light turns on when ignition is turned off	<b>YES</b>	NO	
4 Door lock / unlock output duration is (1) 1/2 second or (2) 5 seconds	(2)	<b>(1)</b>	
5 Courtesy light stays on 1 minute after exiting vehicle	<b>YES</b>	NO	

3. Press and release the brake pedal to exit the programming mode.

## CODE-ALARM, INC. LIMITED LIFETIME WARRANTY

A CODE-ALARM, INC. ("CODE") vehicle security system sold to a retail consumer purchaser by an authorized dealer of CODE and installed by an authorized dealer of CODE is warranted by CODE to the original retail consumer purchaser to be free from defects in workmanship and materials for the lifetime of the vehicle in which the security system was originally installed.

A CODE vehicle security system sold to a retail consumer purchaser by an authorized dealer of CODE and installed by a party other than an authorized dealer of CODE is warranted by CODE to the original retail consumer purchaser to be free from defects in workmanship and materials for a period of ninety (90) days. Defects caused by or related to the improper installation of the security system are not covered by this or any other warranty.

The duration of this warranty described above applies to all components of the security system except for: switches, indicator lights, transmitter(s) and accessories purchased separately.

Transmitters, exclusive of the transmitter case, are warranted by CODE to the original retail consumer purchaser to be free from defects in workmanship and materials for the lifetime of the of the vehicle in which the security system was originally installed.

Switches, indicator lights, and transmitter cases are warranted to the original consumer purchaser for a period of one (1) year from the date of purchase when the system is installed by an authorized CODE dealer.

Switches, indicator lights, and transmitter cases are warranted to the original consumer purchaser for a period of ninety (90) days from the date of purchase when the system is installed by a party other than an authorized CODE dealer.

Security system accessories are covered by the warranty supplied with the accessory. Wiring harnesses altered by installation and transmitter batteries are not covered by this or any other warranty.

This warranty is nontransferable, nonassignable and is completely voided when the security system is removed from the car in which it was originally installed. If the vehicle in which the security system was originally installed in is transferred to another party, this warranty no longer applies.

This warranty does not apply to any product damaged by accident, physical or electrical abuse, improper installation, alteration, any use contrary to its intended function, unauthorized service (i.e. service by anyone other than CODE or its authorized service personnel), fire, flood, lightning or other acts of God.

Should a product be found to be defective during the warranty duration, CODE will repair or replace the product or any part of the product that CODE agrees is defective without charge to the retail consumer purchaser of the product during the first year of the warranty period. After the first year of the warranty period has expired CODE will repair or replace the product or any part of the product that CODE agrees is defective for a fee of \$10.00 to cover shipping and handling charges.

In order for a product to be repaired or replaced under the terms of this warranty, the defective product must be returned to an authorized CODE dealer and accompanied by a copy of the original retail sales receipt. The date of purchase and year, make and model of the vehicle in which the security system was originally installed in must be clearly indicated on the sales receipt.

CODE shall not be held responsible for any removal and/or reinstallation charges of a defective product, damage to or theft of the vehicle or its contents, or any incidental or consequential damages caused by any failure of the product to function properly. Under no circumstances should this warranty, or product covered by it, be construed as an insurance policy against loss. CODE neither assumes nor authorizes any person or organization to make ANY WARRANTIES or assume any liability in connection with the sale, installation, or use of this product. This is the complete CODE warranty and no other warranty exists.

The warranty identified in this form is exclusive and CODE makes no other warranties expressed or implied for any goods or services provided by CODE. CODE specifically and expressly excludes any other warranties including the fitness for a particular purpose and all warranties of merchantability. The customers sole and exclusive remedy for any and all claims against CODE arising out to the customers use of any CODE vehicle security system or component shall be as delineated in the warranty set forth above. CODE shall not be liable to any customer or any other person or entity for any direct or indirect, consequential, special or exemplary damages arising out of or in connection with the customers use of, or inability to use, or misuse of any CODE provided product.

Some states do not allow the exclusion or limitation of incidental or consequential damages, so the above limitation may not apply to you. This warranty gives you specific legal rights, and you may also have other rights which vary from state to state.

**CODE-ALARM, INC.**  
**950 E. Whitcomb**  
**Madison Heights, MI. 48071**





## Free Manuals Download Website

<http://myh66.com>

<http://usermanuals.us>

<http://www.somanuals.com>

<http://www.4manuals.cc>

<http://www.manual-lib.com>

<http://www.404manual.com>

<http://www.luxmanual.com>

<http://aubethermostatmanual.com>

Golf course search by state

<http://golfingnear.com>

Email search by domain

<http://emailbydomain.com>

Auto manuals search

<http://auto.somanuals.com>

TV manuals search

<http://tv.somanuals.com>