

COOPER LIGHTING - METALUX®

DESCRIPTION

The MC Series combines a low profile, surface modular design with the latest in energy-efficient technology. The dihedral recessed top design allows for cooler fixture operation. Other features include a die-formed housing, surface or stem mounting (single or continuous row), full seam-welded corners and a broad selection of attractive door frames.

The versatile modular MC Series can be the perfect solution when used in applications such as commercial office spaces, schools, hospitals, and retail merchandising areas.

SPECIFICATION FEATURES

A ... Construction

Housing die formed code gauge prime cold rolled steel. Smooth sides permit flush joint for continuous row mounting. Full seam welded corners. Dihedral recessed top design insures cooler ballast operation. Die formed captive lampholder bracket fully encloses wiring permitting easy lampholder replacement. Ballast covers easily removed without tools.

B ... Electrical*

Ballasts are CBM/ETL Class "P" and are positively secured by mounting bolts. Pressure lock lampholders. UL/CUL listed. Suitable for damp locations.

C ... Finish

Painted after fabrication. Electrostatically applied baked white polyester powder enamel finish. Multistage cleaning cycle, iron phosphate coating with rust inhibitor. Conveyorized application and baking timing accurately controlled at an elevated temperature.

D ... Hinging/Latching

Positive cam action steel latches with baked white enamel finish. Safety lock T-hinges allow hinging and latching either side.

E ... Frame/Shielding

Die formed, heavy gauge, flat steel door. Baked white enamel finish. Reinforced, mitered door frame corners. Door frame quadrasealed to prevent light spillage. Light stabilized 100% virgin acrylic prismatic shielding. Standard #12 pattern. Optional shielding available.



MC240
232
M340
332

1' X 4' SURFACE
2 OR 3 LAMPS
Surface Modular

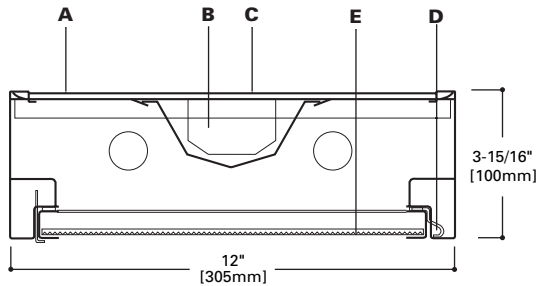

MOUNTING DATA

MC (2 Lamp)

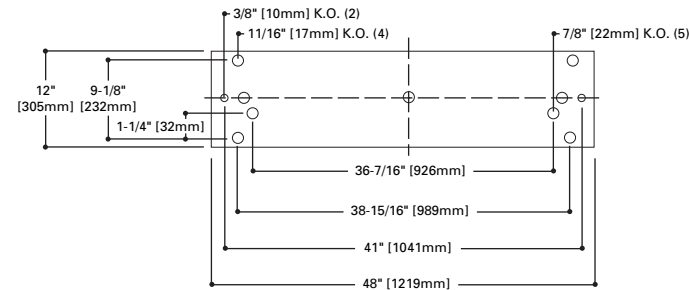

M (3 Lamp)

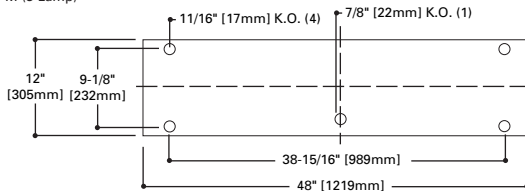

STEM MOUNTING METHODS

Consult Pre Sales Technical Support for Continuous Row Application

M Fixture Application (3 Lamp)

4 Point Suspension

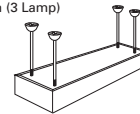

MC Fixture Application (2 Lamp)

2 Point Suspension

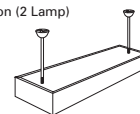

LAMP CONFIGURATIONS

MC (2 Lamp)

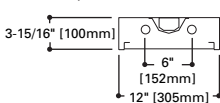

M (3 Lamp)

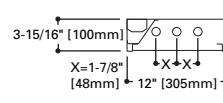

DOOR FRAMES

M or MC
Flat, White
Steel



MXF or MCXF
Flat, Extruded
White Aluminum

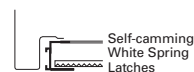

MSR or MCSR
Regressed,
White Steel



MXR or MCXR
Regressed,
Natural Aluminum



MXRD or MCXRD
Deep, Regressed,
Extruded Natural Aluminum



ENERGY DATA

Input Watts:

EB Ballast & STD Lamps

240 (72)

232 (61)

340 (110)

332 (91)

ES Ballast & STD Lamps

240 (86)

232 (71)

340 (136)

332 (108)

Luminaire Efficacy Rating

LER = FL-55

Catalog Number: MC-232A

Yearly Cost of 1000 lumens,
3000 hrs at .08 KWH = \$4.36

*Reference the lamp/ballast data in the
Technical Section for specific lamp/ballast
requirements.

**LAMPS CONTAIN MERCURY. DISPOSE ACCORDING
TO LOCAL, STATE OR FEDERAL LAWS**

LINEAR DISCONNECT

Safe and convenient means of
disconnecting power



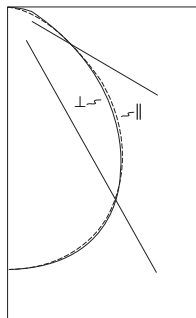

MC-232A

Energy Saving Ballast

F32T8/35K Lamps
2850 Lumens

Spacing criterion:
(ll) 1.2 x mounting height,
(⊥) 1.2 x mounting height

Efficiency 62.3%

Test Report:
MC232A.IES

LER = FL-55

Yearly Cost of 1000 lumens, 3000 hrs at .08 KWH = \$4.36

Coefficients of Utilization

rc	Effective floor cavity reflectance																						
	80%				70%				50%				30%				10%				0%		
rw	70	50	30	10	70	50	30	10	50	30	10	50	30	10	50	30	10	50	30	10	0		
RCR																							
0	74	74	74	74	72	72	72	72	69	69	69	66	66	66	64	64	64	62	62	62	62		
1	69	66	64	62	67	65	63	61	62	60	59	60	58	57	58	56	55	54	54	54	54		
2	64	59	55	52	62	58	55	52	56	53	51	54	51	49	52	50	48	47	47	47	47		
3	59	53	49	45	57	52	48	45	50	47	44	49	46	43	47	45	42	41	41	41	41		
4	54	48	43	39	53	47	42	39	45	41	38	44	41	38	43	40	37	36	36	36	36		
5	50	43	38	34	49	42	37	34	41	37	33	40	36	33	38	35	33	31	31	31	31		
6	46	39	33	30	45	38	33	30	37	33	29	36	32	29	35	32	29	28	28	28	28		
7	43	35	30	26	42	34	30	26	33	29	26	33	29	26	32	28	26	24	24	24	24		
8	39	31	26	23	39	31	26	23	30	26	23	29	25	23	29	25	22	21	21	21	21		
9	36	28	23	20	36	28	23	20	27	23	20	27	23	20	26	22	20	18	18	18	18		
10	34	26	21	18	33	25	21	18	25	21	18	24	20	17	24	20	17	16	16	16	16		

Zonal Lumen Summary

Zone	Lumens	%Lamp	%Fixture
0-30	1176	20.6	33.1
0-40	1890	33.2	53.2
0-60	3034	53.2	85.4
0-90	3552	62.3	100.0
0-180	3552	62.3	100.0

Typical VCP Percentages

Room Size (Ft.)	Height Along		Height Across	
	8.5'	10.0'	8.5'	10.0'
20 x 20	61	65	60	65
30 x 30	54	58	53	57
30 x 60	45	48	43	47
60 x 30	56	60	56	60
60 x 60	46	49	44	47

Candela

Angle	Along ll	45°	Across ⊥
0	1510	1510	1510
5	1504	1506	1505
10	1483	1491	1493
15	1449	1462	1467
20	1400	1417	1420
25	1334	1352	1350
30	1249	1263	1253
35	1145	1149	1126
40	1021	1011	992
45	875	852	852
50	712	690	701
55	553	538	541
60	414	395	394
65	305	270	287
70	222	180	219
75	163	132	175
80	120	105	131
85	64	58	71
90	0	0	0

ORDERING INFORMATION

Sample Number: MC-232A-120V-EB81-U

<p>Width =1' width</p> <p>Series 1,2 M =1' Width (3 Lamp), 2' Width MC =1' Width (2 Lamp)</p> <p>Door Frame Standard =Flat White Steel Door (Leave blank) FA =Flush White Extruded Aluminum c/w Spring Latch RA =Regressed White Extruded Aluminum FAN =Flush Natural Anodized Extruded Aluminum RAN =Regressed Natural Anodized Extruded Aluminum FAB =Flush Black Extruded Aluminum RAB =Regressed Black Extruded Aluminum</p>	<p>Number of Lamps 3 2 Lamps (Not Included) 3 Lamps (Not Included)</p> <p>Wattage 32 =32W T8 (48") 40 =40W T12 (48")</p> <p>Lens A =#12 Pattern Acrylic (Standard) A125 =#12 Pattern Acrylic (.125" Thick) A19/156 =#19 Pattern Acrylic (.156" Thick) IMA48 =Injection Molded Acrylic (.150" Thick) PB15 =Silver Parabolic Louver DA =Dropped Dish Matte White Acrylic</p>	<p>Voltage 4 120V =120 Volt 277V =277 Volt 347V =347 Volt UNV =Universal Voltage 5 120-277</p> <p>Options GL =Single Element Fuse GM =Double Element Fuse Emergency =EM Installed</p>	<p>Ballast Type 4 LE3 = T12 Magnetic Energy Saving EB =Electronic Instant Start ER =T8 Electronic Program Rapid Start. Total Harmonic Distortion < 10% DLS =Digital Lighting System Dimming</p> <p>Lamp Size 2 =T12 8 =T8</p> <p>Number of Ballasts 1 =1 Ballast 2 =2 Ballast</p>	<p>Options /PLUS =Higher Ballast Factor > 1.13. Total Harmonic Distortion < 20% RLS =Rotor Lock Socket (T8 Lamp only) RIF1 =Radio Interference Suppressor VRS =Vandal Resistant 6 Screws EKO =End plate with 7/8" KO 7 (Required for Continuous Row Mounting)</p> <p>Packaging U=Unit Pack</p> <p>Notes: 1 2' x 2', 2' x 4' require 4-point suspension, side mounted ballast recommended. 2 Full seam welded corners on 1' x 4', 2' x 2', 2' x 4' fixtures. 3 1' x 4' 3-lamp, 2' x 4' 3-lamp have side mounted ballasts covers. 4 Products also available in non-US voltage and frequencies for international markets. 5 Not Available when specifying emergencies, voltage must be specific 6 Available on flat doors only. 7 For continuous row mounting 7/8" KOs furnished in end of fixture, specify EKO.</p>
--	--	---	--	---

ACCESSORIES

(Order Separately)
SCF=Fixed Stem Set (Specify Length)
SCS=Swivel Stem Set (Specify Length)
SCA=Adjustable 48" Stem Set
 (Additional Accessories Available. See Options and Accessories Section.)

SHIPPING INFORMATION

Catalog No.	Wt.
MC-232A	25 lbs.
M-332A	30 lbs.

Free Manuals Download Website

<http://myh66.com>

<http://usermanuals.us>

<http://www.somanuals.com>

<http://www.4manuals.cc>

<http://www.manual-lib.com>

<http://www.404manual.com>

<http://www.luxmanual.com>

<http://aubethermostatmanual.com>

Golf course search by state

<http://golfingnear.com>

Email search by domain

<http://emailbydomain.com>

Auto manuals search

<http://auto.somanuals.com>

TV manuals search

<http://tv.somanuals.com>