

EZ-3 and EZ-4

1-WAY REMOTE START SYSTEM



OPERATING INSTRUCTIONS

CONGRATULATIONS on your choice of a Cool Start™ Remote Engine Starter and Keyless Entry with DP Technology by Crimestopper Security Products Inc. This booklet contains the information necessary for operating your system. If any questions arise, contact your installation dealer or Crimestopper Security Products Inc.

***IMPORTANT INFORMATION: Primary and Optional Features**

-PRIMARY: These are features that must be connected in order for the system to operate properly i.e. Remote Start connections, Flashing lights, and Brake Reset. For programming, the hood pin and program button are required.

-OPTIONAL: These features are to be connected only if desired or agreed upon by the customer and the installing dealer i.e. Door Locks, Trunk Pop, Dome Light Illumination, Horn-Honk, Anti-Grind, etc. These features may also require additional parts and/or labor fees. Consult with your installer beforehand to be sure of what is going to be installed with your particular system.

CRIMESTOPPER SECURITY PRODUCTS, INC.
1770 S. TAPO STREET, SIMI VALLEY, CA. 93063

REV 09-2008

This device complies with FCC Rules part 15. Operation is subject to the following two conditions: 1) This device may not cause interference, and (2) this device must accept any interference that may be received, including interference that may cause undesired operation. The manufacturer is not responsible for any radio or TV interference caused by unauthorized modification to this equipment. Such modification could void the user's authority to operate the equipment.

TABLE OF CONTENTS

Operation Cautions & Warnings.....	2
Using the Remote Transmitter.....	3
Status LED.....	4
Remote Engine Control.....	4-7
Turbo Timer Mode.....	8-9
Convenience and Safety Features.....	10-11
Transmitter Programming.....	12
2 Vehicle Operation.....	13
No Factory Keyless Entry after Remote Start.....	14
Remote Start Diagnostics.....	14
Battery Replacement.....	15
2-Way Data Port.....	16

OPERATION CAUTIONS & WARNINGS

CRIMESTOPPER SECURITY PRODUCTS, INC. and its **VENDORS** shall not be liable for any accident resulting from the use of this equipment. This system is designed to be professionally installed into a car or vehicle in which all items, such as parking brake and all associated components, door switches, transmission shift linkage, throttle linkage, and all engine safety features, are in perfect working condition.

DO NOT install the Remote Engine Starting System on MANUAL TRANSMISSION vehicles. If accidentally left in gear the vehicle could become a self-propelled threat to life and property.

IT IS ABSOLUTELY THE OWNER'S SOLE RESPONSIBILITY TO: A) Understand the operation of this system and its safety features. B) Check for proper operation of the system prior to accepting delivery of the vehicle from the installation facility. C) Check and maintain the condition of the vehicle and all items relative to the proper operation of this system and its safety features. D) Always leave the doors and windows closed and locked to protect against accidents and theft.

DO NOT remote start the vehicle in a closed garage. Make sure that the garage door is open or there is adequate ventilation. Failure to observe this rule could result in **injury or death** from poisonous Carbon Monoxide fumes.

USING THE REMOTE TRANSMITTER

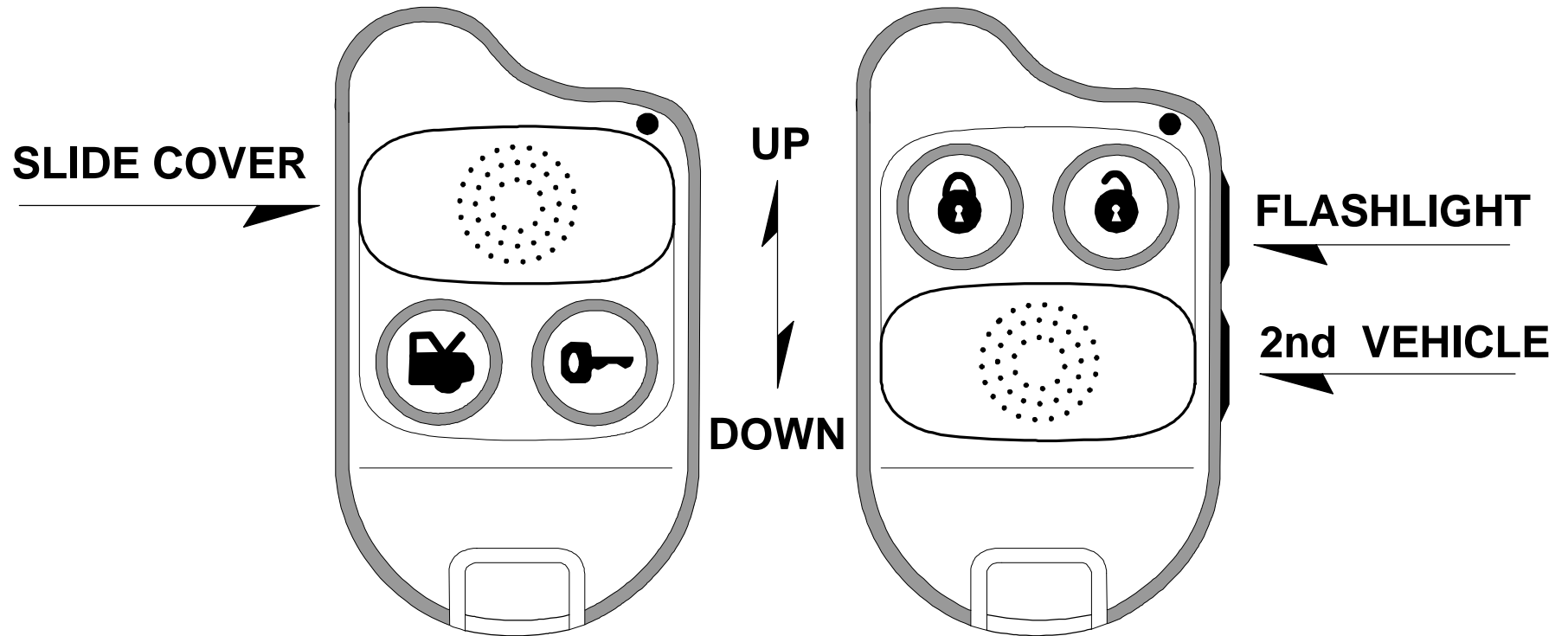

For RS-3DP II

The transmitter supplied with this system has 3 buttons, a flashlight and a car 2 side button. The button configuration is Factory-set and unchangeable. See Page 13 for additional information on how to use your remote to operate a second vehicle equipped with an RS-3 series system.

For RS-4DP II

The transmitter supplied with this system has 4 buttons, a flashlight and a car 2 side button. The button configuration is Factory-set and unchangeable. See Page 13 for additional information on how to use your remote to operate a second vehicle equipped with an RS-4 series system.

STATUS LED

LED Operation: (Optional, requires Installation of LED)

LED will flash when locking your doors with remote.

LED will remain solid in Valet Service Mode.

REMOTE ENGINE CONTROL

Remote Start & Auxiliary Output – Button Press Selection (Option # 6):

To eliminate the possibility of accidentally opening the trunk or starting the vehicle, there are (3) options for button press selection. This option will allow you to change whether the Remote starter and Trunk release activate by a:

1. Double button - ½ second presses.
2. *Single ½ second press (Default).
3. Press and Hold 2 seconds.

Default = 1 single press

REMOTE ENGINE STARTING - SUCCESSFUL START:

- 1) Press the remote start button for at least 1/2 second (*default). Parking lights flash once, return solid, and the Ignition/Acc circuits turn on.
- 2) After a few seconds the Starter Motor engages. The parking lights and Acc circuits will turn off while cranking.
- 3) Engine Starts and Runs. Parking Lights and Acc turns back on, and the doors lock.
- 4) Engine will remain running for programmed run time until reset with Brake pedal. If needed, the engine can be turned off with remote transmitter by pressing and releasing the Start button.

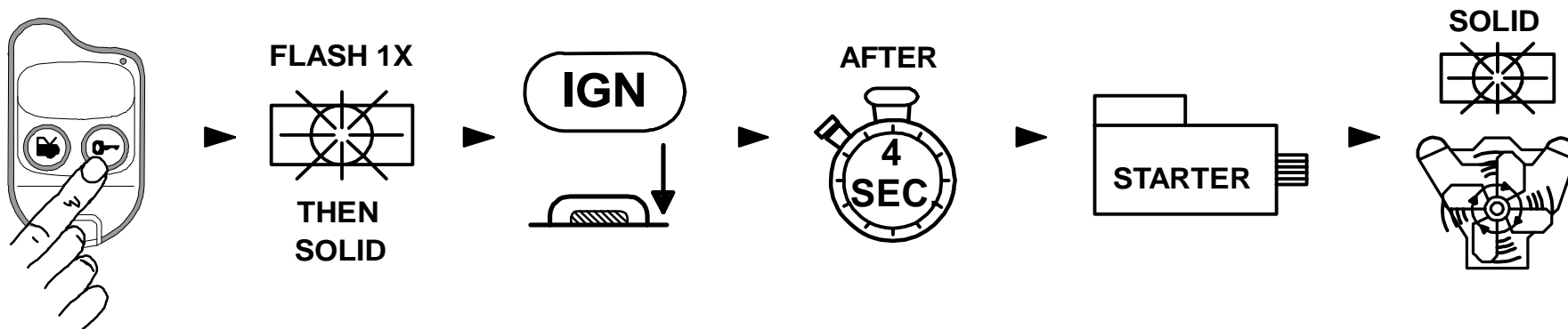

REMOTE ENGINE CONTROL

REMOTE ENGINE STARTING - UNSUCCESSFUL START

In the event that the engine does not start on the first attempt, the system shuts down for a few seconds, then attempts to restart the engine a 2nd and 3rd time. For hard starting engines, the unit will allow a starter crank time of up to 13 seconds maximum. This should provide ample cranking time for difficult starts, but is limited to 13 seconds to help prevent damage to the starter from over cranking.

- 1) If engine starts on 2nd or 3rd attempt, see steps 4 & 5 of "Successful Start" on page 4.
- 2) If Third attempt fails to start engine, the system will turn off and doors will remain locked. *NO FURTHER ATTEMPTS WILL BE MADE AUTOMATICALLY*

TURNING OFF A REMOTE STARTED ENGINE:

- 1) Engine is running in Remote Start (Parking lights ON).
- 2) Press and release the remote start button or double press (If option #6 is on).
- 3) Engine & parking lights OFF, Doors re-lock/re-arm.

ENTERING YOUR REMOTE STARTED VEHICLE:

- 1) With engine running, Unlock system with remote (If equipped) or open door with key.
- 2) Enter vehicle and be careful not to step on brake pedal! (Remote Start Reset)
- 3) Turn Ignition to ON/RUN position, then press brake pedal to reset the Remote Starter & Shift out of park.
- 4) Remote starter will reset instantly when the brake is pressed. Parking lights will turn off and the ignition key is now controlling your vehicle.

REMOTE START *RUN TIME RESET*:

You can now reset the engine-run timer to allow for more running time after remote start has already occurred using the remote control. After a successful remote start, press both the Lock & Unlock buttons together for at least 2 seconds. The parking lights will flash 3 times and internal engine timer will reset back to zero minutes.

REMOTE ENGINE CONTROL

IDLE DOWN MODE:

This mode allows the unit to take over operation of the parked vehicle while the ignition key is removed and you exit the vehicle. The vehicle is put into a remote running condition before you exit and it will remain running for the programmed run time or until you come back.

Examples:

- You pull up to a convenience store for a quick stop, "Idle Down" mode keeps engine running when you exit the vehicle, (with keys in hand) remote lock doors or arm alarm. When you return, unlock, turn ignition ON and drive away.

IDLE DOWN MODE - EXITING THE VEHICLE:

- 1) With vehicle engine running with key, press the Remote Start button for at least one second or twice if set for Double press.
- 2) Parking Lights will turn ON.
- 3) Doors will unlock, or if brake pedal is being depressed, doors will unlock when it is released.
- 4) Turn OFF Ignition and remove key. Engine should remain running.
- 5) Exit vehicle then remote lock doors if desired.
- 6) Engine will remain running for programmed run time or until you return (whichever comes first).

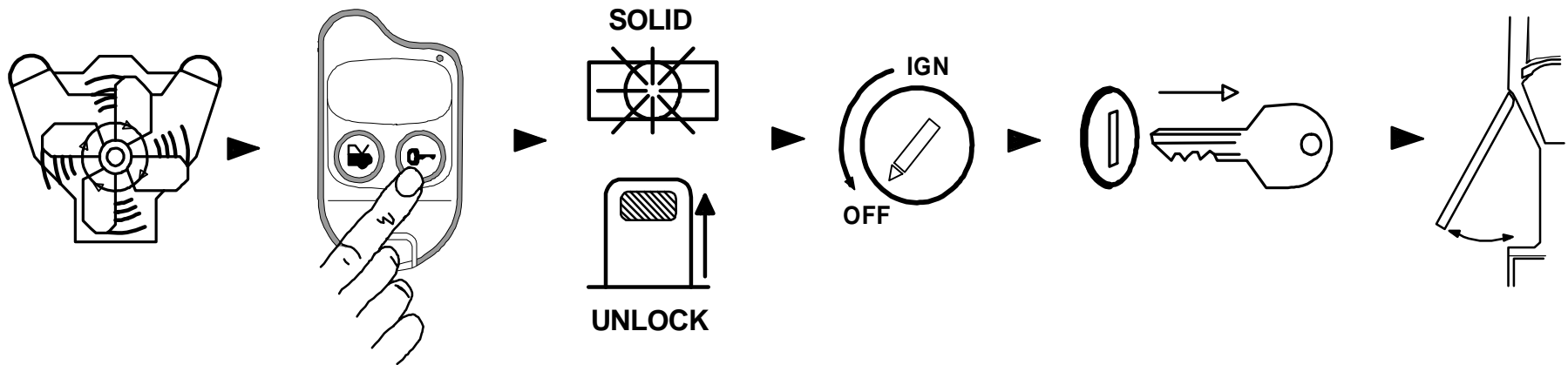

REMOTE ENGINE CONTROL

INFINITY RUN MODE

This mode can only be activated with "Idle Down" procedure. The Infinity Run mode allows the vehicle engine to remain running *INDEFINITELY after the programmed run time elapses*. This mode will allow the vehicle to be left running and unattended *without* the ignition key in the switch preventing the vehicle from being stolen. This mode can be beneficial to law enforcement or commercial trucks that need to remain running unattended for long periods of time.

INFINITY RUN MODE – EXITING THE VEHICLE:

- 1) With vehicle engine running with the key, press the Remote Start button for at least 1 second, pause a few seconds, then press and release the remote start button a second time.
- 2) Parking Lights will start flashing, and doors will unlock.
- 3) Turn Ignition switch OFF, remove key and exit the vehicle. Engine should remain running.
- 4) The vehicle's parking lights will flash for the programmed run time of 12, 24, or 36, or 48 minutes and then switch to solid while motor runs indefinitely or until fuel supply runs out.

SELECTABLE HOURLY COLD-START MODE (1-4 HOURS)

This mode allows the vehicle to be programmed to self-start every 1, 2, 3 or 4 hours and run for the programmed run time. This can be helpful during extremely cold conditions where engine fluid freeze-up is a concern.

THE VEHICLE MUST BE OUTDOORS OR IN A WELL VENTILATED AREA! Once this mode is set, the unit will start at the programmed hourly interval and run for the programmed run time. To reset this mode, either start the vehicle with the key or the remote control.

SELECTABLE HOURLY COLD-START MODE – EXITING THE VEHICLE:

- 1) Engine should be running with the Key. Press the Remote Start button for at least 1 second. Lights will turn on signaling the remote start has turned on and doors will unlock.
- 2) Within 10 seconds press and release the valet/program button once for each hourly increment (1 time = 1 hour, 2X = 2 hours, 3X = every 3 hours, 4X = every 4 hours).
- 3) Parking Lights will turn ON when the button is pressed and flash once for each consecutive button press.
- 4) Turn Ignition switch OFF, remove key and exit the vehicle. Engine should remain running.
- 5) Once outside the vehicle, press and release the remote start button to turn off engine. The parking lights will flash the number of times indicating the hourly increment for confirmation. The vehicle will start by itself at the selected hourly increment until driven with key or started via the remote control.

TURBO TIMER MODE (OPTION #22)

The optional Turbo Timer mode allows the CoolStart system to keep a Turbo or Turbo Diesel vehicle running for 1 to 5 minutes [selectively] after you remove the key and exit the vehicle. This is handy for turbo cool-down without the need for expensive turbo timers. This mode requires the use of an extra part called a momentary switch/button that is not included with the kit. There are (3) modes of operation for the Turbo Timer Mode

1. **Brake Pedal Set Mode.** With the engine running by key, **press Remote Start Button with brake pedal depressed.** As you release the brake pedal, the Parking Lights and Status LED will blink the number of minutes for the Turbo Timer setting. The doors unlock after confirmation. The run time can be changed by using the push button switch attached to the green start activation wire (see Always Set Mode).
2. **Always Set Mode (default).** The Turbo Timer Run Time must always be set. With brake pedal depressed and engine running by key, Press the "Turbo Timer" button 1 to 5 times for each minute of run time you desire. (1 press = 1 min.) As you release the brake pedal, your system will confirm by flashing the lights the same number of times the button was pressed. The doors unlock after confirmation. Turn Ignition switch OFF, remove key and exit the vehicle.
3. **Idle Down Mode.** This replaces the normal Idle Down Mode. Can't use Infinity Run or Manual Transmission Mode with this option. **With the engine running by key, press the Remote Start Button.** The Parking Lights and Status LED will blink the number of minutes for the Turbo Timer setting. The doors unlock after confirmation. The run time can be changed by using the push button switch attached to the green start activation wire (see Always Set Mode).

Note: Mode 1 and 3, the run timer (1 to 5 min.) is set one time. The system always remembers the Turbo Timer setting even with battery disconnection.

SETTING THE TURBO TIMER RUN TIME

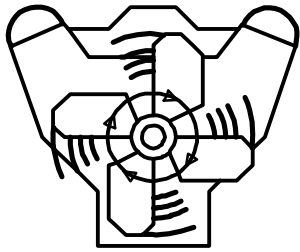

RUNNING



**PRESS
AND HOLD
BRAKE**

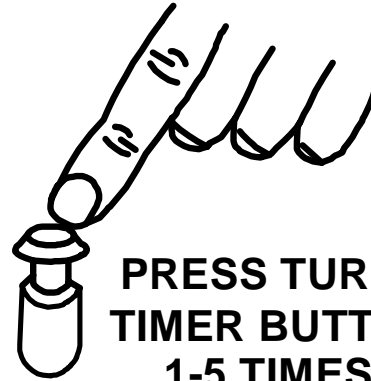

**PRESS TURBO
TIMER BUTTON
1-5 TIMES**

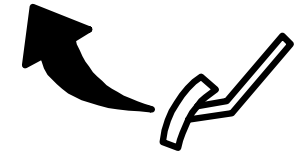

**RELEASE
BRAKE**



**LIGHTS
FLASH 1-5X**

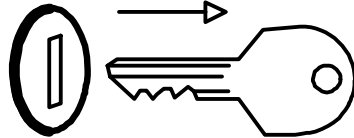

REMOVE KEY

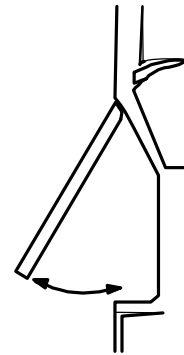

EXIT VEH.

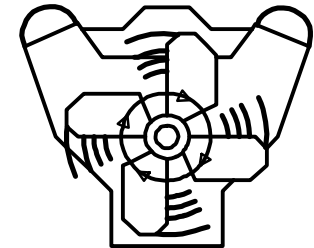

**REMAIN
RUNNING
1-5 MIN.**

CONVENIENCE AND SAFETY FEATURES

KEYLESS ENTRY (POWER DOOR LOCK CONTROL, Optional)

This system enables you to remotely lock and unlock the vehicle's doors (if equipped with power locks) via remote control for safety and convenience. Note: This feature may require extra labor and/or parts to install. Press the Lock or Unlock transmitter button as you leave or come near the vehicle. Parking lights will flash once for lock and twice for unlock. If vehicle is running by the remote start system, the lights will flash, but return back to solid.

AUTO LOCK/UNLOCK (Option # 2)

The Auto Lock feature controls whether the doors will automatically lock/unlock on your vehicle when driving or with turning the Ignition ON/OFF. If the Auto Lock feature is turned on, and your system is in "Tach" mode, then the doors should automatically lock as the engine RPM's increase (driving). If the Auto Lock feature is turned on, and your system is in "Smart Tachless" mode, then the doors will lock a few seconds after the Ignition is turned on. When the Auto Lock feature is turned on, the system will always unlock the doors when the Ignition is turned off. With this feature turned OFF, the system will not automatically lock or unlock the vehicle. See your installer for programming information on this feature.

DOOR LOCK NOTE: *If your system has been setup with an optional starter kill relay, but you do not have power door locks, note the following: The lock and unlock buttons on the remote control must still be utilized to operate the Starter disable.*

REMOTE PANIC (Optional)

For personal safety this unit now includes a panic feature. To sound the vehicle car horn, press the Lock Button on the remote for more than 2 seconds. The vehicle horn will honk along with flashing parking lamps for 1 minute. Reset Remote Panic by pressing either the lock or unlock button. See next section for Horn Honk information.

HORN CHIRP/HONK OUTPUT (Option # 7 & 13)

This feature, if installed, will provide audible confirmation chirps from the factory horn for lock and unlock. When using this feature, pressing the Lock or Unlock button a 2nd time within 3 seconds or once (programmable option) will provide a horn chirp for audible confirmation. The system can also be programmed to provide 3 chirps when a remote start is requested using the remote. Note: Horn honk/chirp feature may require extra labor and/or parts to install.

REMOTE TRUNK RELEASE OR DOMELIGHT ILLUMINATION (Optional) Applies to RS-4

This CoolStart system includes an output that can be programmed to remotely release a factory electronic trunk or illuminate the interior light when you unlock your vehicle for lighted entry at night. If you have the optional trunk pop installed, simply press and release the Trunk Button #3 on the transmitter or if option # 6 is turned on you must press Button # 3 twice within 3 seconds, to remotely open trunk. If your system is programmed for Dome Light illumination, then it will work automatically lighting the dome light for 30 seconds when you unlock your vehicle via the remote. The dome light will turn off after 30 seconds, or turning the key on (whichever comes first). The trunk Pop or Dome Light Illumination may require extra labor and/or parts to install.

CONVENIENCE AND SAFETY FEATURES

VALET MODE / REMOTE START DISABLE (Requires Installation of Valet Switch)

Before servicing your vehicle or handing the keys over to a Valet we recommend putting the unit into Valet Mode. The remote start function WILL NOT operate when in Valet Mode. To enter Valet mode, turn the key to the ON position, press and hold Program/Valet switch for 5-6 seconds. The LED will turn on solid when the system is in Valet Mode. To exit Valet Mode, perform this procedure again. The keyless entry will still function normally while in Valet Mode. In the event of a lost or broken transmitter, perform this step to override the Starter Disable (if installed).

ANTI-GRIND / STARTER DISABLE (Optional, relay not included)

This Optional feature prevents the user from accidentally grinding the starter if the Ignition key is turned too far to the start position while engine is already running from the remote starter. The Anti-Grind/Starter Disable requires the use of an external relay. This system must be programmed to allow the relay to work as a starter disable.

HOOD OPEN SAFETY (Requires hood pin switch)

Prevents the engine from being Remote Started when hood is open. Eliminates risk of injury to someone working under the hood of the vehicle with a properly working hood pin installed. The hood can be opened after a successful Remote Start, but not before. If Remote Start button is pressed with the hood open, the lights will flash once and the unit will not attempt a start.

BRAKE PEDAL RESET

Prevents starting or shuts off a remote started vehicle when this circuit is active. Prevents unauthorized driving of vehicle. This circuit shuts the system down immediately when brake pedal is pressed. Turn the ignition key to the "ON" position before the brake pedal is pressed.

OEM ALARM INTERFACE (May require optional Databus Module)

This feature is designed to Disarm and Re-arm Factory equipped security systems in conjunction with remote start and keyless entry (if needed for your vehicle). This feature will maintain the original integrity and security of your vehicle's factory equipped systems before, during, or after remote start. Some vehicles require an optional Databus module to operate a factory alarm or keyless entry.

NOTE: *When changing, charging, or jumpstarting the vehicle's battery we recommend removing the main power fuses located on the heavy gauge RED wires near the remote start module.*

TRANSMITTER PROGRAMMING

Note: All transmitter codes must be learned at time of programming!! The RS-4 learns up to 4 different transmitter codes.

1. Turn key to the ON position. (Pink wire must be connected.)
2. Press Programming button 4 times, then after a few seconds the unit flashes the parking lights 4 times.
3. Press button #1 of the transmitter to be coded. You should get 2 light flashes indicating the unit is waiting for a 2nd code, then press button #1 of a second transmitter, the unit will flash 3 times indicating its waiting for the 3rd code and so on. If all 4 codes are learned, the unit will automatically exit code learning mode, otherwise turn key off. See diagram below.

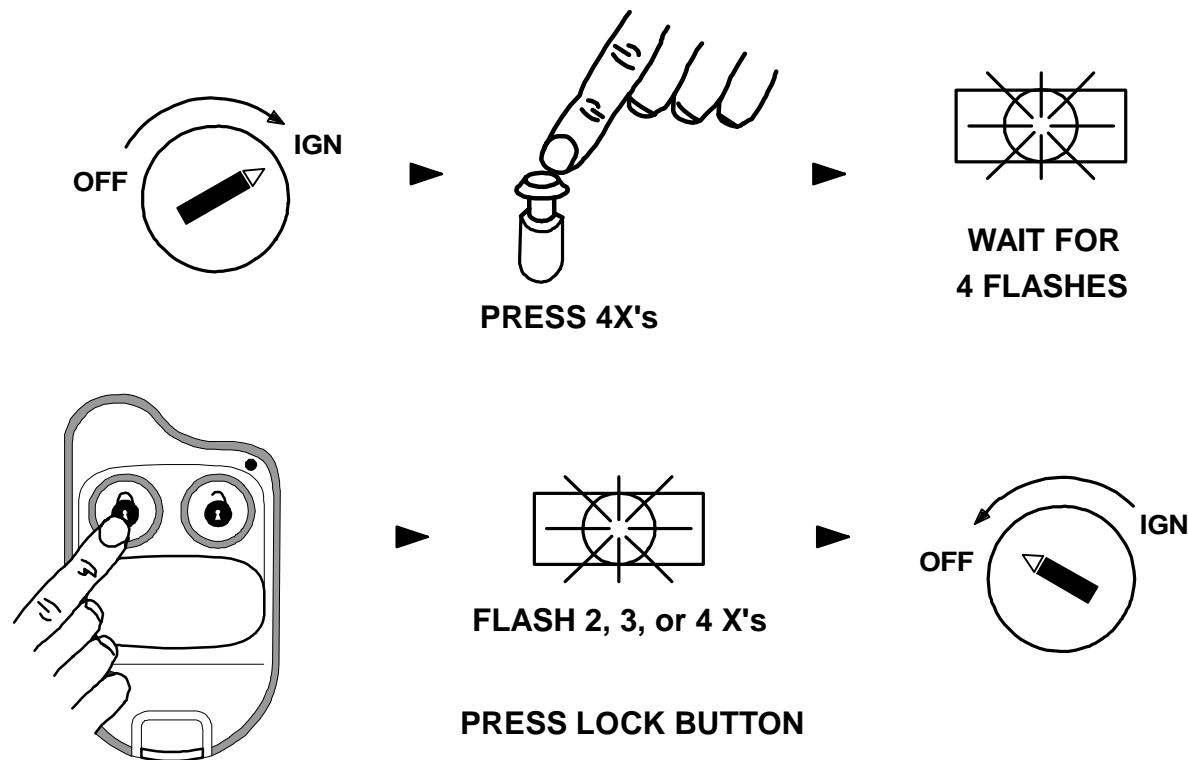

2-VEHICLE OPERATION & PROGRAMMING

A single Remote Control can control two different vehicles.

SETUP:

Follow the "Transmitter Programming" steps on the second vehicle below. Program Car #2's existing remotes, then quickly press the Car #2 side button on your remote before pressing the lock button on your remote to program it to Car #2. Once your remote is programmed to the second vehicle, press the car #2 side button on your remote first, and within 3 seconds press any of the 4 function buttons on your remote. You can keep pressing function buttons to control car #2 as long as it is within the 3-second window. After 3 seconds have elapsed, the remote will revert back to Car #1 control.

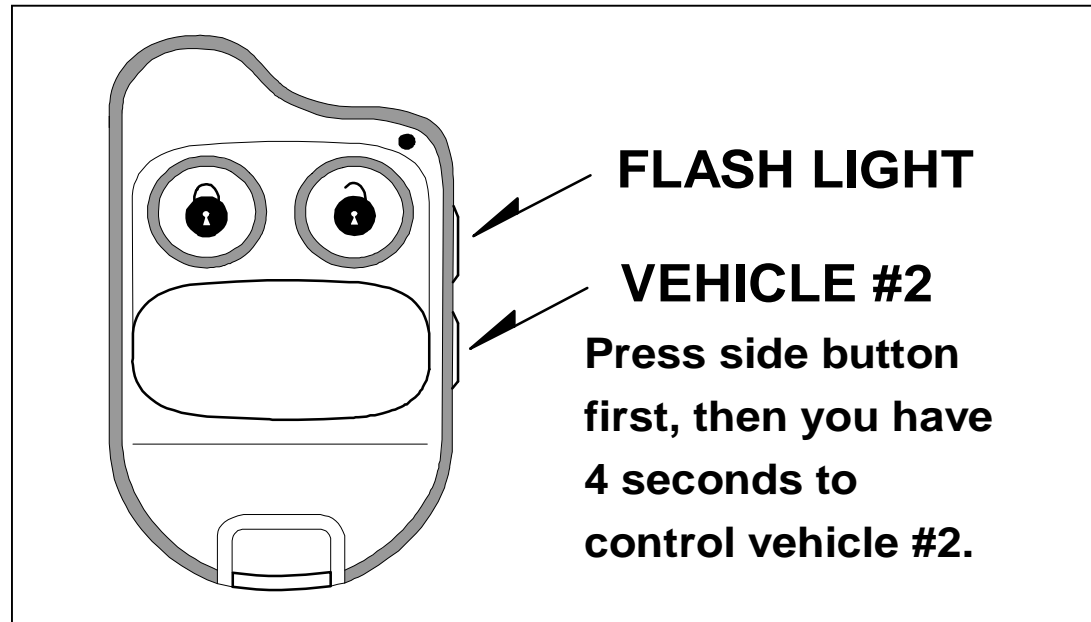

NO FACTORY KEYLESS ENTRY AFTER REMOTE START

Most new cars Do Not allow the factory Remote Keyless Entry to function with the Ignition ON. This means you can't use the factory remote to lock or unlock the doors. After remote start you have to use the keys to unlock the door. Also, many new vehicles unlock the doors when disarming the factory alarm. This leaves the doors unlocked while Remote Started. To resolve this problem, have your installer connect the door locks to the Remote Start Keyless Entry. The Remote Starter will Re-Lock the doors after remote starting.

Model RS-3 and RS-4

When you return to a remote started vehicle, just press the Unlock button on the remote control.

Note: There are 3 Remote Start Options (see page 4). The options are: 1/2 second press (Default), 2 second press or Double button press.

REMOTE START DIAGNOSTICS

If the system flashes the parking lights one to three times and doesn't attempt remote, it means the following:

- 1 Parking Light Flash = Problem with Brake Switch.**
- 2 Parking Light Flashes = Problem with Hood Switch.**
- 3 Parking Light Flashes = Valet Service Mode (see page 11).**
- 7 Parking Light Flashes = Manual Transmission Error.**

Be sure to tell your installer the Diagnostic code when taking vehicle in for service

SYSTEM IS UNSUCCESSFUL AT REMOTE START DURING EXTREME COLD CONDITIONS:

Please be aware that during sub-freezing conditions your remote starter may take more than one attempt to start, or it may not successfully start the vehicle after 3 attempts. During these conditions the vehicle may not properly start even using the key, therefore trying to start by the remote would also be unsuccessful.

BATTERY REPLACEMENT

To replace the battery: Simply remove the 3 screws on back of the transmitter and open the case. Remove the battery and replace. The replacement battery is GP23A.

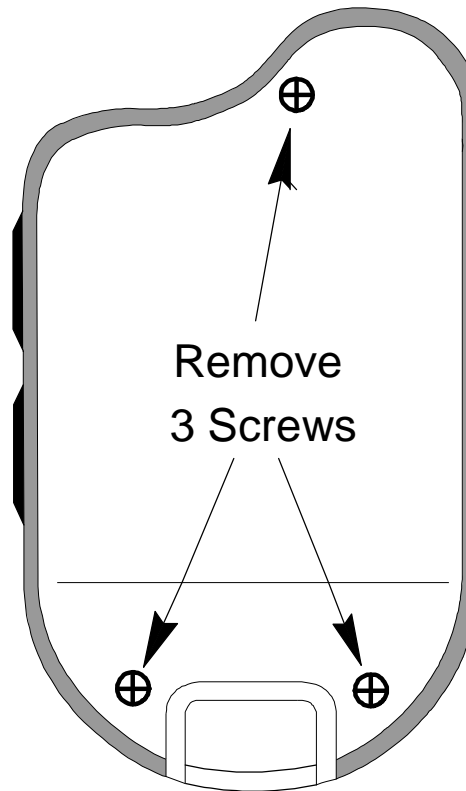

2-Way DATA PORT

Some vehicles require a Databus Module to Bypass the factory Immobilizer and operate the keyless entry

Databus modules are used to communicate with the vehicles computer at the OBD2 Data connector or Canbus wires. This reduces installation error. Crimestopper Systems with DP Series have a direct Data Port Plug-In for the Databus bypass module. This eliminates conventional wiring between the Alarm/Remote Starter and the bypass interface module.

Features Include

- Transponder Immobilizer.
- PassLock Immobilizer.
- O.E.M. Alarm Control.
- R.A.P. Shutdown.
- Power Door Locks.
- Priority Unlock.
- Trunk Release.
- Parking Lights.
- Courtesy Lights.
- Tachometer.
- Heated Seats.
- Rear Defrost.
- Driver 1 and 2 Memory presets.

The actual features controlled depend on the vehicle and Databus module.

The logo for Crimestopper, featuring the word "CRIMESTOPPER" in a bold, black, sans-serif font. The letters are white with a black outline, and the text is set against a black rectangular background.

www.crimestopper.com
email@crimestopper.com
Phone (800) 998-6880
FAX (805) 581-9500

The logo for TechWeb, featuring the word "TechWeb" in a stylized, rounded, white font with a black outline. The text is set against a black rectangular background.

ONLINE TECHNICAL SUPPORT
www.crimestopper.com

Free Manuals Download Website

<http://myh66.com>

<http://usermanuals.us>

<http://www.somanuals.com>

<http://www.4manuals.cc>

<http://www.manual-lib.com>

<http://www.404manual.com>

<http://www.luxmanual.com>

<http://aubethermostatmanual.com>

Golf course search by state

<http://golfingnear.com>

Email search by domain

<http://emailbydomain.com>

Auto manuals search

<http://auto.somanuals.com>

TV manuals search

<http://tv.somanuals.com>