

USER'S GUIDE

DSD-9502T/9503T

**Twin digital terrestrial Receiver &
Hard disc Recorder**

Introduction

Thank you for purchasing the Digital PVR.

Equipped with the latest technology and design, the DSD-9502T/9503T is a set-top box ideal for digital terrestrial broadcast reception. The simple installation and operation, user-friendly three-dimensional OSD, Digital audio output with Dolby Digital ready, and advanced video clarity made for TV and VCR are all designed to enrich the viewer experience.

As a digital set-top box, it can receive FTA broadcasts. Outstanding stability and comfort are its built in features. In addition to delivering more channels with its new highly sensitive tuner, DSD-9502T/9503T boasts the Electronic Program Guide (EPG), for even better program information on all channels, and information that enables subtitles and teletext for a bounty of useful information on programs and broadcast signals.

As a twin tuner PVR, you can see picture in picture (PIP) to see two programmes on one screen, you can record one channel while watching another. Furthermore, you can record two channels simultaneously while playing back a previous recording from the HDD.

As a PVR, DSD-9502T/9503T utilizes the preloaded software functions by incorporating the hard disk drive. This allows for assorted trick play, diverse formats of recording, and recordings playback, all through the time shift recording function.

New versions can be updated through automatic software upgrade service (OAD). With the latest software, viewers are always sure to enjoy endless hours of extraordinary digital broadcasts and an abundance of data.



If you have any difficulties concerning the operation of your PVR, please refer to the relevant section of this manual. This manual will provide you with useful information on using the PVR.

Important care and safety advice

This Digital PVR has been manufactured to meet international safety standards, but you must take care to operate it safely.

It is important that you read these safety instructions.

If you have any doubts about the installation, operation, or safety of this Digital PVR, contact Daewoo, as shown in the next page.

	CAUTION RISK OF ELECTRIC SHOCK DO NOT OPEN	
<p>CAUTION: TO REDUCE THE RISK OF ELECTRIC SHOCK, DO NOT REMOVE COVER (OR BACK). NO USER-SERVICEABLE PARTS INSIDE. REFER SERVICING TO QUALIFIED SERVICE PERSONNEL.</p>		



The lightning flash with arrowhead symbol, within an equilateral triangle, is intended to alert the user to the presence of uninsulated "dangerous voltage" within the product's enclosure that may be of sufficient magnitude to constitute a risk of electric shock.



The exclamation point within an equilateral triangle is intended to alert the user to the presence of important operating and servicing instructions in the literature accompanying the appliance.

Electrical warning

- Your Digital PVR contains a high voltage which is sufficient to cause a dangerous electric shock.
- Never remove the Digital PVR cover.
- There are no user-serviceable parts inside.
Switch off the power supply from the mains wall socket. before you disconnect any equipment from the Digital PVR.
- Never push anything into holes, slots or other openings in the case.

Positioning the PVR

- The Digital PVR and cables should be placed so that they not likely to be walked on or pinched by items placed upon or against them.
- Do not expose your Digital PVR to direct sunlight or to extreme temperatures (above 40°C or below -5°C), high moisture levels or dust.
- The apparatus shall not be exposed to dripping or splashing and that no objects filled with liquids, such as vases, shall be placed on the apparatus.
- The ventilation should not be impeded by covering the ventilation openings with items, such as newspapers, table-cloths, curtains, etc.
- Do not Place the Digital PVR on an unstable surface or on a bed, sofa, rug, or similar surface as this may block air ventilation and cause it to overheat.
- Never place the Digital PVR over a radiator or in an unventilated cabinet. No naked flame sources, such as candles, should be placed on the apparatus.

Important care and safety advice

Cleaning

- Cleaning : always disconnect from the mains supply before cleaning. Wipe with a lint-free cloth or one that has been slightly dampened with clean water. Never use detergents, liquid cleaners.

Unplug when not in use

- When not in use for an extended period, unplug the Digital PVR from the mains outlet. Do not overload wall outlets and extension adapters as this can result in a risk of fire or electric shock.

Use only authorized servicing

Earthing : The antenna cable must be earthed.

If any of the following occur

- Any of the cables or plugs are damaged.
- Liquid has spilled onto, or objects have fallen into, the Digital PVR.
- The Digital PVR has been dropped or the casing has been damaged.
- The Digital PVR does not operate normally.

Carefully unplug the Digital PVR from the electrical outlet and

- Contact the retailer/ supplier who sold you the Digital PVR
- Call the Daewoo Helpline : 0870 100 2525
Or e-mail us at information@desuk.co.uk

End User licence

This hardware and software of this product are licensed to the user as a single product that cannot be separated.

It is intended as domestic product for the purposes of receiving digital television services; any other use is done so at the users risk.

In relation to the software the end user is prohibited from copying, transferring to a 3rd party, modifying or otherwise attempting to derive the source code of any part or whole of the software in the product. The software is not sold, but licensed for use in the European Union to the owner of the hardware. New software maybe transmitted to the box by the manufacturer in which case the licence transfers to the new software.

Table of Contents

Introduction	1
Important care and safety advice	2
Table of Contents	4
Package contents	4
Front Panel	5
Rear Panel	6
Remote Control	7
Connecting the PVR	8
Installation wizard	11
Basic Operation	12
PIP and Time Shifted Recording	14
Recording and Playback	16
Using the Main & Setup Menu 's	19
Where to get more help	25
Specification	26

Package contents

When you open the packaging you should find

1) Daewoo Digital PVR



2) Remote Control & Batteries



3) RF-lead



4) User's Guide & Quick start Guide

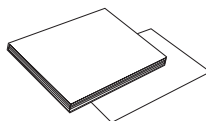

- If any parts are missing, do not attempt to install this product. Please contact the Daewoo Careline on **0870 100 2525**.

Front Panel

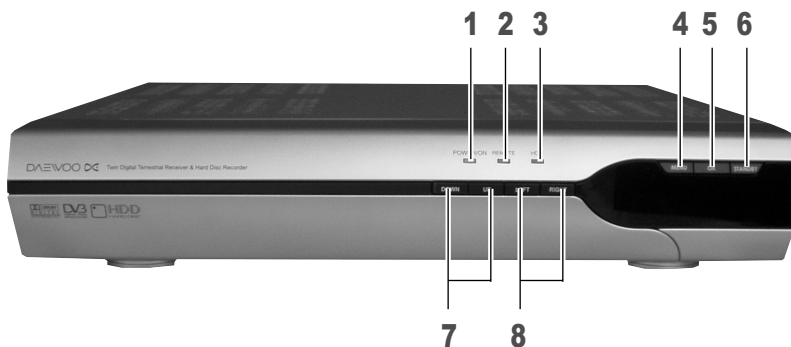

1 Power On indicator

2 Remote indicator

3 Hard disk drive indicator

; will be visible when hard disk drive is in use ie when in record or time shift mode.

4 Menu Button

; allows access to on screen menu.

5 OK button

; can be used to select a menu or confirm menu options.

6 Standby Button

; switches between Operation and Standby modes.

7 Menu up/down Buttons

; can be used for moving up and down Menu screens.

8 Menu left/right Buttons

; can be used for moving left and right Menu screens.

Rear Panel

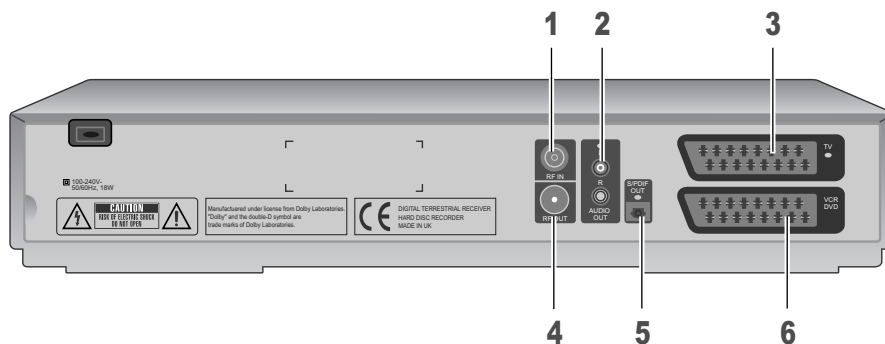

1 RF IN

; connects your aerial.

2 Audio L/R

; connects to your TV or VCR and outputs audio signals.

3 T V Scart

; connects a T V SCART cable.

4 RF OUT

; connects an RF to the RF (ANT) input on your TV or VCR.

5 S/PDIF

; outputs the digital audio signals.

6 VCR/DVD SCART

; connects to your VCR/DVD.

Remote Control

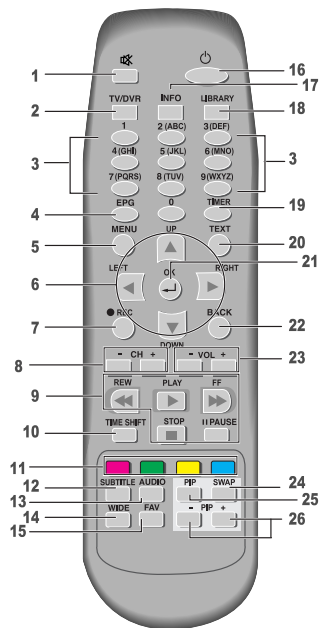

- 1 Mute** ; pauses the audio temporarily.
- 2 TV/DVR** ; switches between DVR and TV.
- 3 Number buttons**
- 4 EPG** ; Electronic Programme Guide
- 5 Menu** ; choose and change a wide range of PVR's features. Or exit the menu.
- 6 Arrow buttons** ; allows you to move through menu's. Or navigates in playback mode.
- 7 Record** ; initialises the record - see relevant section in this manual.
- 8 Channel +/-** ; allows you to change channel.
- 9 Playback control buttons** ; Includes Play, Fast Forward, Rewind, Pause and Stop.
- 10 Time Shift** ; activates time shift function -see relevant section in this manual)
- 11 Colour buttons** ; used for selecting interactive applications.

- 12 Subtitle** ; switch ON/OFF programme subtitles.
- 13 Audio** ; displays audio language menu.
- 14 Wide** ; sets display format.
- 15 FAV** ; moves to favourite TV channels (List 1 - List 2...)
- 16 Standby** ; switches between operation and standby modes.
- 17 Info** ; displays information on the current and next programs on the channel.
- 18 Library** ; displays Recording library menu.
- 19 Timer** ; accesses the timer programming channels
- 20 TEXT** ; enters TeleText service.
- 21 OK** ; selects channel list or confirms the selected operation.
- 22 BACK** ; exits from TeleText service.
- 23 Volume +/-** ; allows volume control.
- 24 Swap** ; swaps the focus between the main and the PIP screen.
- 25 PIP** ; displays the picture in picture (PIP) screen.
- 26 PIP+/-** ; changes the PIP Channel.

Connecting the PVR

SCART connections offer the best picture and sound quality.

They can also tell your TV when the Digital PVR is switched on and off and whether widescreen pictures are being broadcast. Therefore this is the way this box has been designed to be connected.

1. Connect your aerial to the Digital PVR.

- Make sure your TV is switched off, together with any other equipment you are connecting to it.
- Insert the cable from your aerial into the Digital PVR socket marked 'RF IN'.

2. Connect the SCART cable.

Choose the option below that best suits your TV (and VCR, if you have one). If you need a longer SCART cable, you can find one at most TV or electronics retailers.

Ask for a "fully-populated" SCART lead.

Option 1: connecting to a TV only

- Connect the SCART cable between the 'TV' socket on your Digital PVR's rear panel and your TV's SCART socket.
- Connect an RF cable between the 'RF OUT' output on the Digital PVR and the RF socket on your TV (where you normally connect the aerial).

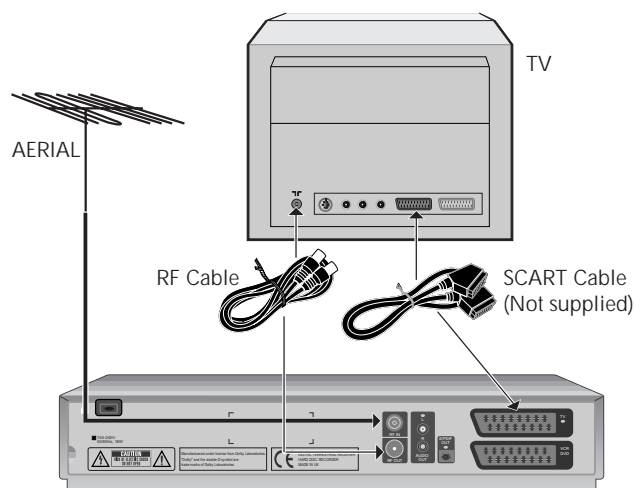

Option 2: connecting to a TV and VCR

- Connect the SCART cable between the VCR socket on your Digital PVR and your VCR's SCART IN socket.
- Connect a SCART cable between the SCART TV socket on your Digital PVR and your TV SCART IN socket.
- Connect an RF cable between the 'RF OUT' socket on the Digital PVR and the RF input socket on your VCR.
- If there isn't already one in place, connect a second RF cable between the RF output on your VCR and the RF input socket on your TV.

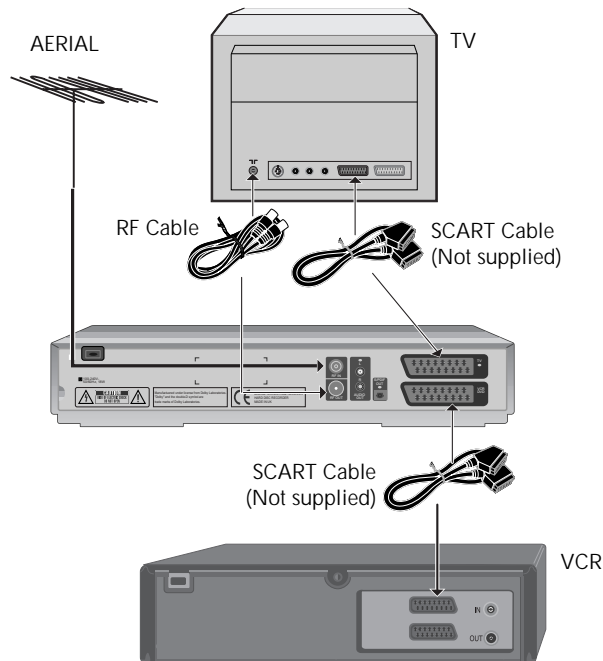
**3. Connect the POWER cable.****4. Switch on your TV.**

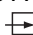
- Switch on your TV
- Switch on the mains outlet for the Digital PVR.
- Press [POWER] on your PVR remote. The PVR's green light should go on.
- Your TV should switch to the Digital PVR automatically. If no, select the AV channel using the button on your TV remote marked AV, EXT, TV/AV, O/E or a  symbol, or

Connecting the PVR

refer to your TV manual.

- If you cannot see the picture from the Digital PVR, please refer to the “where to get more help” section towards the end of this user’s guide.

You are now ready to tune in to the digital TV service.

Installation wizard

Using your Digital PVR for the first time.

The first time you use your Digital PVR, you will see a screen like the one below. The Digital PVR now needs to scan for available Digital TV channels.

- Press [OK] on your Digital PVR's remote control to begin searching for digital channels. The search will take between 2 and 5 minutes, depending on the digital TV service in your area.



- As channels are found, their names are listed on the TV screen.
- When the scan has finished, the Digital PVR will automatically switch to the first channel in the list.

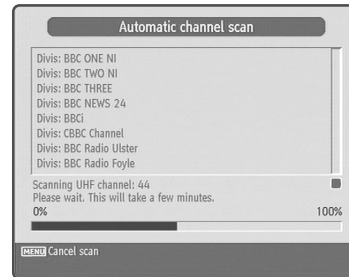

You can now explore and enjoy the channels available on your Digital TV service.

Please read on to find out more about the features offered by your Digital PVR.

Basic Operation

This chapter describes functions such as switching channel, volume control and basic features for watching programmes.

Using Standby

When you are not watching TV, you should set your Digital PVR to 'Standby'.

To do this: Press [POWER(⏻)] to switch to STANDBY.

If you plan to leave your Digital PVR unattended for a long period, switch it off and unplug it at the mains supply. (Don't worry - all of your settings will be saved.)

Switching Channel

You can switch the current channel using one of the following methods.

- 1 Press the [CH-/CH+] button.
- 2 Enter your desired channel numeric using the [NUMERICAL (0-9)] button to go to the channel directly.
- 3 Go to desired channel using the [▲/▼] button and press the [OK] button.

Volume Control

- 1 Press the [Vol+/Vol-] buttons to adjust the audio volume.
- 2 Press the [MUTE] button to switch the sound ON/OFF.

Note: The mute function will remain off after changing channels.

To switch Subtitle on/off

If the current programme provides Subtitle information, you can switch the Subtitle on or off by pressing [SUBTITLE] button.

You can select a default subtitle language by selecting SETUP - Language - Subtitle Language.

To change Audio language

If the current programme is available in multiple audio languages, you can select the language that you wish to listen to.

- 1 Press the [AUDIO] button to display the audio language menu.
- 2 Select your desired audio language using the [◀/▶] button and press the [OK] button.

You can select a default audio language by selecting SETUP - Language - Audio Language.

Using the TV Guide (EPG)

The TV Guide shows a full list of available channels and programmes.

To view the Guide :

- 1 Press [EPG].
- 2 Press [▲/▼] to scroll through the list of channels.
- 3 To scroll through the programmes press [◀▶].
To scroll forwards and backwards, one day at a time, press the blue and the yellow colour buttons.
To preview the highlighted channel, press [INFO].

To add the selected programme to your Timer, press the [REC] button.



- 4 To go up or down to next page, press [CH+/-].
- 5 To view the highlighted channel, press [OK].
- 6 To exit the TV Guide without changing channel, press [MENU] or [EPG].

Now and Next Information

Now and Next gives you information on the current and next programmes on each channel.

- 1 To open the Now/Next menu press [INFO]. This displays information on the programme showing Now.
- 2 To see more detailed information press [INFO] again.
- 3 To see information on the programme showing Next, press [▶].
- 4 To change the channel you want information for press [▲/▼].
- 5 To watch the highlighted channel press [OK].



PIP and Time Shifted Recording

Picture-in-Picture (PIP) Screen

If you press the [PIP] button on the remote control while watching TV, you can watch 2 channels at the same time. The Audio from the Main screen will be outputted.

Each time you press the [PIP] button, the PIP screen is switched on or off.



PIP screen



Normal screen

Note:

- The PIP screen is not available while recording two channels simultaneously.
- The subtitle is not available when you are watching PIP screen
- The teletext (MHEG) is only available on the main screen.

1. Swapping the PIP screen.

Press the [SWAP] button on the remote control to swap the main screen for the PIP screen. Press the [CH-/CH+] button to change the main screen channel.

Playback is available only on the main screen (swapping is not available).

2. Switching channels in the PIP screen

You can change the PIP channel using the [PIP+/PIP-] button.

Press the PIP button on the remote control to display the PIP screen, then press the [PIP+/PIP-] button to change the channel on the only PIP screen.

Time Shifted Recording (TSR)

You can perform the time shift operations like VCR functions using the Playback control buttons while playing a programme.

To save the programme on the screen to the installed hard disk drive temporarily press [TIME SHIFT] button, so that users can pause, play, fast rewind, fast forward, replay, etc. even while watching the currently broadcasting TV programme.



1. Time shift information

First enter time shift mode by pressing [TIME SHIFT] button this will pause live TV and press [PLAY] button to continue watching TV or if you press the [INFO] button in TSR mode, the time shift information will be displayed. The time shift information displays the current operation status and the time difference between the broadcasting point and watching point.

2. Pause

If you press the [PAUSE] button on the remote control, the current programme is paused. If you press the [PAUSE] button once again, the programme is resumed from that point.

Note: Pause makes the time difference or delay between the broadcasting (live) point and watching point. The time difference is equal to the period the programme was paused. Operations like slow motion and fast rewind also make the time difference. Press the STOP button to remove the time difference and go to the live programme.

3. Slow

If you press the [◀▶] button in pause screen, the screen enters into slow playback mode. When you press the [◀▶] repeatedly, the speed will be set to 1/4 or 1/2.

4. Fast Rewind to Previous Scene

Press the [REW] button on the remote control to watch the scene passed by. Whenever you press the [REW] button, the rewind speed increases. (x1.5, x3, x6, x12, x24) If you press the [PLAY] button, the fast rewind operation stops and the programme is played at normal speed.

Note: You can fast rewind back to the point. If you reach the start point while rewinding, the programme is automatically played at normal speed from that point.

5. Fast Forward to the Next Scene

Press the [FF] button on the remote control to fast forward the programme. Whenever you press [FF] button, the speed increases. (x1.5, x3, x6, x12, x24) If you press the [PLAY] button, the fast forward operation stops and the programme is played at normal speed.

Note: If you reach the live screen while in fast forward operation, the time shift operations is stopped and goes to the live mode automatically.

Recording and Playback

Using the built-in hard disk drive, you can record a programme without an external media device such as a VCR.

Instant Recording

Press the [REC] button on the remote control to record the current programme instantly. If you change channels while recording and press the [REC] button, recording starts. You can record up to two channels simultaneously. While recording two channels simultaneously, only programmes which are being recorded can be viewed.

While simultaneously recording two channels, pressing the stop button will stop the recording on the channel currently being viewed.

If simultaneously recording two channels, and a third channel is selected for record via the EPG, you will be prompted to select one to stop.

Note:

- Ensure that there is enough free space before recording. If the free space on the hard disk drive is insufficient, recording will stop. Recording one hour of programme may require up to 2 or 3GB of hard disk space. The space for recording 1 hour of programme may be different depending on the programme recorded.
- You can record radio programmes also.

Timer

You can set a programme to record automatically by going to Menu - Recording - Timers. Or easily by pressing the [TIMER] button.

You can record up to two channels simultaneously. While recording two channels simultaneously, only programmes being record can be viewed.

1 Programming the PVR to record

- 1 Press the yellow button to add a new recording schedule.
- 2 Change the Channel and Date using the [◀/▶] button.
- 3 Change the Date and Time using the [◀/▶] button and the [NUMERICAL (0~9)] button.
- 4 Select one of Repeat mode options among Once, Daily and Weekly using the [◀/▶] button.
- 5 Select Playback and Change/Delete preference using the [◀/▶] button.
- 6 Press the green button to complete entering.
- 7 Press the red button to cancel the reservation.

Note:

- You can reserve 2 programmes to record simultaneously.
- If the target channel is locked, restricted by watching time or parental control, you have to enter a password for reservation.

2 Editing the Recording Schedule

- 1 Select a reserved programme list and press the green button to edit the reserved recording schedule.
- 2 Change each item like above steps.

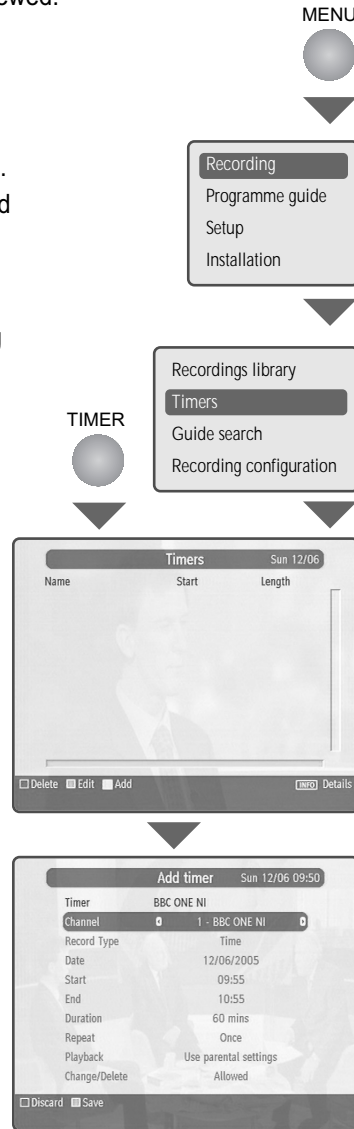

Programme Playback

You can view the recorded programmes in the Menu - Recording - Recording library. You also can easily view the recorded programme list by pressing the [LIBRARY] button.

- 1 Select the desired programme to playback using the [▲/▼] button and then press the [PLAY] button to playback the programme.
- 2 Press the [STOP] button to stop the current programme and go to the current live programme.
The eye icon in front of programme names highlights recordings which have not been watched fully.
- 3 You can see various play options when you press [OK] button on a highlighted recording.
 - play from start : plays from the beginning
 - resume : plays from the last watched scene
 - play from offset : plays from inputted offset minute
 - manage chapters : delete chapters or play from a marked chapter
 - create archive : plays several tagged recordings sequentially
- 4 If you press the [MENU] button during playback, chapter option shows up. Then you can create a new chapter or move to last or next chapter.

Programme playback from recording library

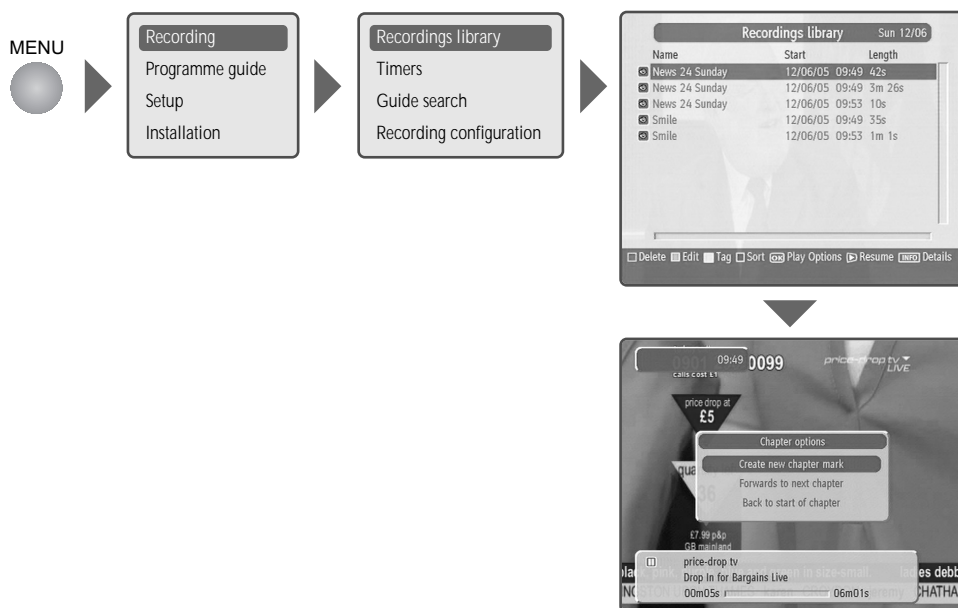

Using the Main & Setup Menu's

The Main menu lets you choose and change a wide range of your Digital PVR's features.

- To access the Main Menu, press [MENU].

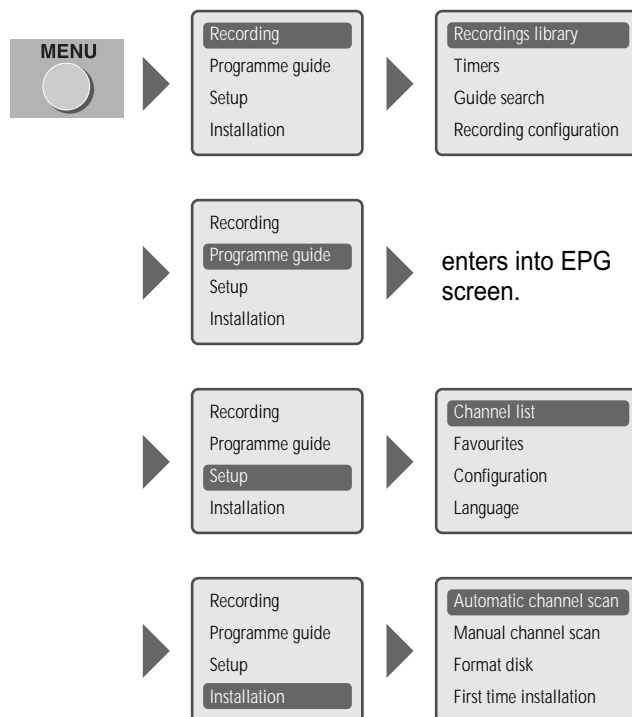

Recording - Recording library

- lets you see a recording list. Refer to page 18 for more information.

Recording - Timers

- lets you set a timer so that the Digital PVR changes to a specific channel at a certain time (such as when you wish to record a programme). Refer to page 17 for more information.

Recording - Guide search

- searches and finds out the programmes which you want. You can enter this menu by pressing the [TEXT] button in programme guide [EPG].
Search : selects target channels (current channel list, single channel, all channels, all TV channels, all radio channels)
Channel : selects a target channel when you search single channel
From, Until : sets search time
Search by : sets search method (Genre, Name by)
Match on : sets search details (specific genre or title)

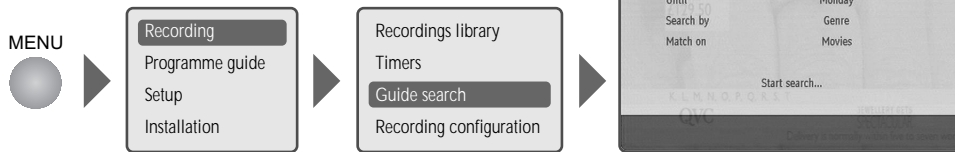

Recording - Recording configuration

- Start early, End late : sets the start and end timing for programme guide recording. These menus are valid only when record type is 'time'.
- Max timeshift : sets the maximum timeshift time. But this time is not exact because the size of broadcasting stream is different case by case.
- Record type : sets the record type (Event, Time)
- Auto discard : sets the method of discarding recordings when HDD capacity is not enough.
- discard : sets the discarding target (none, oldest, longest, shortest)
- Unplayed : selects whether you discard unplayed recordings or not. (Excluded, Included)
- Watershed : sets the watershed time. If you want to record during the watershed time, you have to enter PIN code.

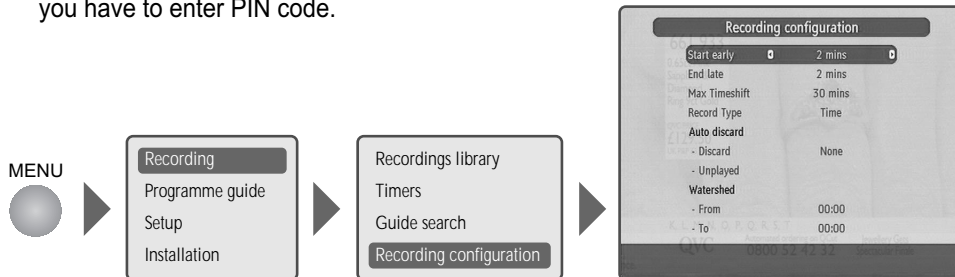

Programme guide

- displays programme information about each channel, based on the date and time. You can also schedule your recording using the information given. Refer to page 13 for more information.
- You can shrink and expand time range and navigate to previous or next day by colour buttons. Searching is available by pressing [TEXT] button and recording is also available by pressing [REC] button.

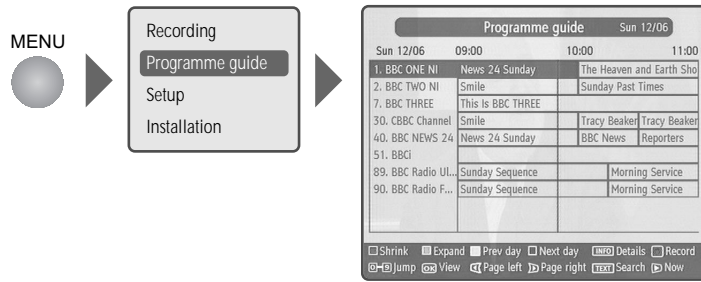

Setup - Channel list

- lets you delete, reorder, lock, favourite and rename the channel line up.
- Channel list shows only favorite list channels when favourite mode is on.
 You can easily enter channel list menu by pressing [OK] button while watching a channel.

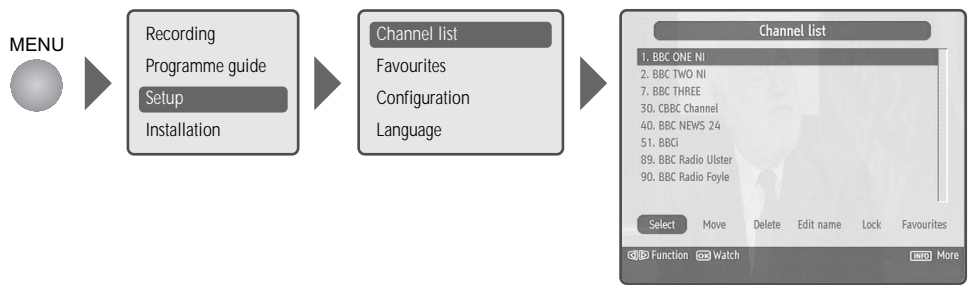

Setup - Favourites

- lets you edit favorite channel list. After you set favourite list and switch favourite mode on, channel list shows only favourite channel list.
- You can move to other channels by entering channel number by [numerical] buttons.
 5 favourite lists are available and you can move to another list by pressing [FAV] button (list1 - list2 - list3 - list4 - list5 - all channel - list1 - ...).

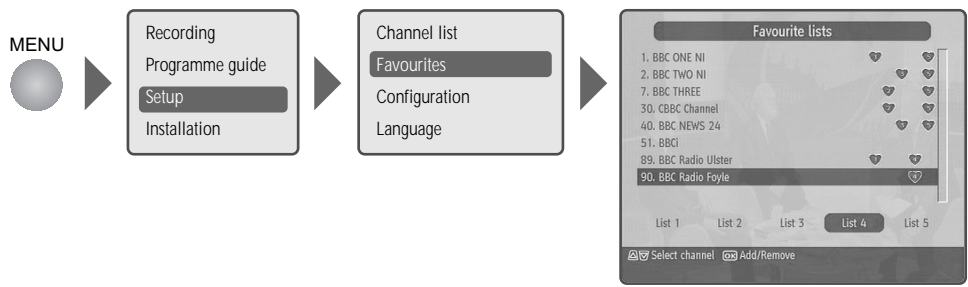

Setup - Configuration

- 1 **Country** : sets country. Broadcasting RF band is different for each country.
- 2 **Subtitle** : sets subtitle on/off
- 3 **TV type** : lets you change how programmes are displayed on your TV (widescreen 16:9 or normal 4:3).
- 4 **TV Out** : set TV output option among RGB and CVBS.
- 5 **Favourite mode** : sets favourite mode (Off, list 1~5)
- 6 **Channel list** : sets channel list (Show all, TV only, Radio only, text only)
- 7 **Receiver Upgrade** : confirm current software version
- 8 **Parental control** : set parental control for each programme and change your Password.
Enter password using numerical [0 -9] buttons when prompted.
Note: The Default Password is 0000. If you have forgotten your Password, please contact your local product distributor.
- 9 **Recordings configuration** : Refer to page 20 for more information.
- 10 **Hard disk info** : You can check the free space of the hard disk drive.

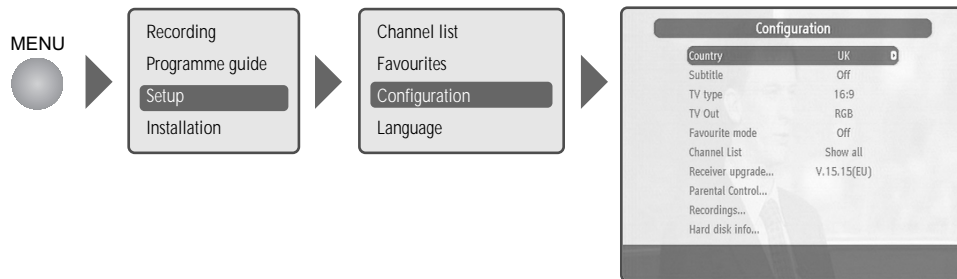

Setup - Language

You can set Language for Menu, Audio and Subtitle. You also can easily view by pressing the [AUDIO] button.

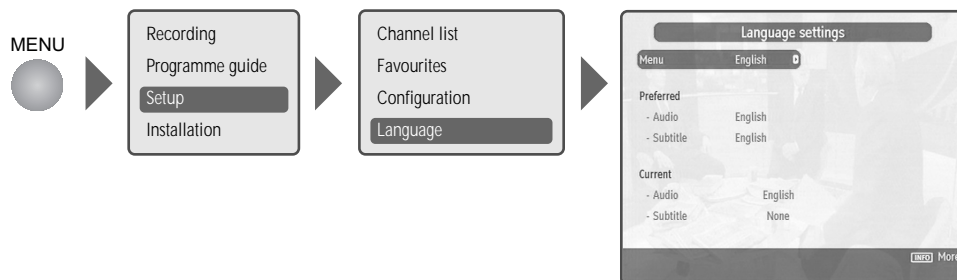

Installation

- 1 Automatic channel scan - If your product is connected to the aerial and television, you can automatically search channels without entering any other information.
- 2 Manual channel scan - You can search channels manually by pressing the [numerical] buttons.
- 3 Format disk - can format (erase) the disk drive if necessary.
- 4 First time installation - restores the product to the default settings.

Warning :

- Please note that once you set to the default settings, all data such as channel list and user configured data are deleted.

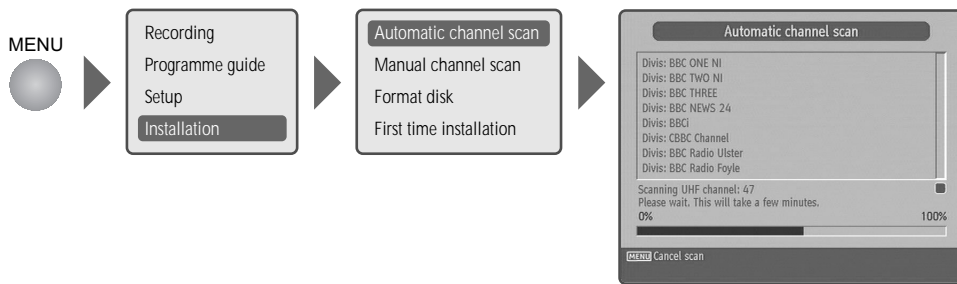

Where to get more help

If you have any problems using your Digital PVR and cannot find a solution in this user guide:

For general problems contact

Daewoo helpline on 0870 100 25 25

Or e-mail us at information@desuk.co.uk

If possible when calling, you should be close to your TV and have your Digital PVR and TV switched on.

For general Freeview reception enquires

Freeview : 08708 80 99 80 or www.freeview.co.uk

Digital TV Group : www.dtg.org.uk

For aerial and signal problems

Euro Aerials on 0870 412 4862 (lines open Monday to Saturday, 8:30am to 5:30pm)

The product referred to in this manual is a Digital Terrestrial PVR supplied by Daewoo Electronics UK, Rathenraw Ind. Est. 62-82 Greystone Road Antrim, Co. Antrim, BT41 1NU

Specification

UHF Channel	Channel 21-69 -75 to -20 dBm Bandwidth 8 MHz
DVB Compatible	ETS 300 744
Decoding	MPEG2 compatible (DVB/Main profile@Main level)
Video	1.5~15Mb/s (720 x 576)
Audio	MPEG2 - Musicam (layer 1&2) (32, 44.1, 48kHz)
Symbol rate	2~40 Mbaud
Power	Input Voltage : 240V, 50/60Hz 20Wmax
Power requirements	18W in operation 11W in standby
RF Connection	IEC connector 169-2 (female), diameter 9.5mm
TV Connection	Two SCART RGB / CVBS
Accessories	Remote Control, Batteries, RF lead, User Guide, Quick start Guide

Due to continued product improvement, this specification may change without notice.

This product complies with the following European Council Directive
EN60065
73/23/EEC (the Low Voltage Directive) as amended
89/336/EEC (the EMC Directive) as amended
Digital Terrestrial Television Broadcast Receiver and Decoder
MADE IN UK

Disposal of Used Electrical & Electronic Equipment

The meaning of the symbol on the product, its accessory or packaging indicates that this product shall not be treated as household waste.

Please, dispose of this equipment at your applicable collection point for the recycling of electrical & electronic equipments waste. In the European Union and Other European countries which there are separate collection systems for used electrical and electronic products.

By ensuring the correct disposal of this product, you will help prevent potentially hazardous release to the environment and damage to human health, which could otherwise be caused by unsuitable waste handling of this product.

The recycling of materials will help conserve natural resources.

Please do not therefore dispose of your old electrical and electronic equipment with your household waste. For more detailed information about recycling of this product, please contact your local city office, your household waste disposal service or the shop where you purchased the product.



Free Manuals Download Website

<http://myh66.com>

<http://usermanuals.us>

<http://www.somanuals.com>

<http://www.4manuals.cc>

<http://www.manual-lib.com>

<http://www.404manual.com>

<http://www.luxmanual.com>

<http://aubethermostatmanual.com>

Golf course search by state

<http://golfingnear.com>

Email search by domain

<http://emailbydomain.com>

Auto manuals search

<http://auto.somanuals.com>

TV manuals search

<http://tv.somanuals.com>