

DAEWOO

PLASMA TELEVISION

USER MANUAL

DTS - 4 2

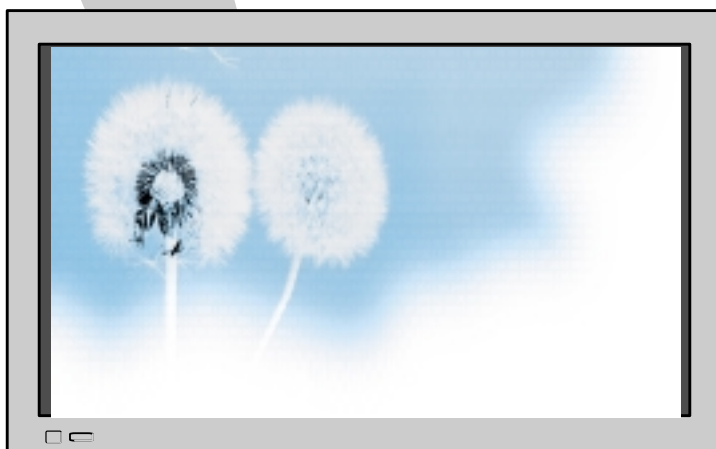

**Proper use guarantees
product life.**

Before using the product, be advised
that you read this user manual well and
try to operate it.

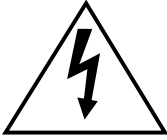

CAUTION

RISK OF ELECTRIC SHOCK
DO NOT OPEN



CAUTION: TO REDUCE THE RISK OF ELECTRIC SHOCK,
DO NOT REMOVE COVER (OR BACK).
NO USER-SERVICEABLE PARTS INSIDE.
REFER SERVICING TO QUALIFIED SERVICE
PERSONNEL.



This symbol is intended to alert the user to the presence of uninsulated "dangerous voltage" within the product's enclosure that may be of sufficient magnitude to constitute a risk of electric shock to persons.



The symbol is intended to alert the user to the presence of important operating and maintenance(servicing) instructions in the literature accompanying the appliance.

WARNING:

TO REDUCE THE RISK OF FIRE OR ELECTRIC SHOCK, DO NOT EXPOSE THIS PRODUCT TO RAIN OR MOISTURE.

CAUTION:

- TO PREVENT ELECTRIC SHOCK, MATCH WIDE BLADE OF PLUG TO WIDE SLOT, FULLY INSERT.
- THE STAND INTENDED FOR USE ONLY WITH THIS PDP TV. USE WITH OTHER APPARATUS IS CAPABLE OF RESULTING IN INSTABILITY CAUSING POSSIBLE INJURY.

Important Safety Instructions

1. Read these instructions.
2. Keep these instructions.
3. Heed all warnings.
4. Follow all instructions.
5. Do not use this apparatus near water.
6. Clean only with a damp cloth.
7. Do not block any of the ventilation openings. Install in accordance with the manufacturer's instructions.
8. Do not install near any heat sources such as radiators, heat registers, stoves, or other apparatus(including amplifiers) that produce heat.
9. Do not defeat the safety purpose of the polarized or grounding type plug. A polarized plug has two blades with one wider than the other. A grounding type plug has two blades and a third grounding prong. The wide blade or the third prong is provided for your safety. When the provided plug does not fit into your outlet, consult an electrician for replacement of the obsolete outlet.
10. Protect the power cord from being walked on or pinched particularly at plugs, convenience receptacles, and the point where they exit from the apparatus.
11. Only use the attachments/accessories specified by the manufacturer.
12. Use only with a cart, stand, tripod, bracket, or table specified by the manufacturer, or sold with the apparatus. When a cart is used, use caution when moving the cart/apparatus combination to avoid injury from tip-over.



13. Unplug this apparatus during lightning storms or when unused for long periods of time.
14. Refer all servicing to qualified service personnel. Servicing is required when the apparatus has been damaged in any way, such as power supply cord or plug is damaged, liquid has been spilled or objects have fallen into the apparatus, the apparatus has been exposed to rain or moisture, does not operate normally, or has been dropped.

Features

- **42" VGA wide Plasma Panel**

- **Built in Analog Tuner**

PDP has the analog tuner inside for watching terrestrial broadcasting without the need to purchase a separate broadcasting receiver.

- **DVD Direct Connection / Outstanding Picture Quality via a Digital Broadcast Receiver**

A DVD can be directly connected to the unit so that you can view clear digital images. You can enjoy even higher quality images by connecting a digital broadcasting receiver with which digital broadcasts can be viewed.

- **A PC Direct Connection**

PC can be connected to the PDP without a separate device and can be used as a TV making it ideal for presentation, various events and exhibitions.

- **160° Wide-Angle Viewing Area**

- **Flat Panel with No Distortion and Color Blurring**

Since Plasma TV has no problems such as distortion, blurring, flickering unlike existing CRT type displays you can enjoy Home Cinema picture quality and sound.

- **Various Control Functions**

- 4 Languages OSD, 20 Step screen zoom function, Full-screen still function, Various aspect ratio, Keypad lock function, Sleep timer, and so forth.

- **Free Volt (100-240V~, 50/60Hz)**

- **DVI (Digital Visual Interface) Connection**

When connected to a PC, you can receive DVI digital signals as well as the former analog signals by using DVI input and D-Sub input. Furthermore, using the DVI Input, you can receive directly a digital signal from the computer. Consequently, pictures on the screen are much more clear and fresh.

- **CCF(Capsulated Color Filter) Technology for natural color**

CCF Technology makes the picture clearer by controlling of the brightness among three different color filters.

- **MGDI (Meta Genuine Digital Image) Engine**

MGDI is the image enhancement technology of Daewoo Electronics, which provides more clear, splendid, and delicated images.

**This User Manual presents safety precautions and how to use the product.
After reading it thoroughly, use the product safely.
Keep this manual where the user can see it easily.**

Failure to comply with warnings and cautions for the safe use of electric appliances may cause fire or human injury.

FCC RF INTERFERENCE STATEMENT

NOTE :

This equipment has been tested and found to comply with the limits for a Class B digital device, pursuant to Part 15 of the FCC Rules. These limits are designed to provide reasonable protection against harmful interference in a residential installation.

This equipment generates, uses and can radiate radio frequency energy and, if not installed and used in accordance with the instructions, may cause interference to radio communications. However, there is no guarantee that interference will not occur in a particular installation.

If this equipment does cause interference to radio or television reception which can be determined by turning the equipment off and on, the user is encouraged to try to correct the interference by one or more of the following measures.

- Reorient or relocate the receiving antenna.
- Increase the separation between the equipment and receiver.
- Connect the equipment into an outlet on a circuit different from that to which the receiver is connected.
- Consult authorized service centers for help.
- Only shielded interface cable should be used.

Finally, any changes or modifications to the equipment by the user not expressly approved by the grantee or manufacturer could void the users authority to operate such equipment,

Safety Precautions

Always obey all safety messages.

- All the safety and operating instructions should be read before the product is operated. If anything strange happens, unplug this product from the wall outlet.
- Do not disassemble or replace any parts of the TV. Refer to a qualified service personnel for repair.

WARNING

You can be dead or seriously injured if you do not follow instructions.

Power

During a lightning storm, or when it is left unattended and unused for a long period of time, unplug it from the wall outlet.

It can result in fire.

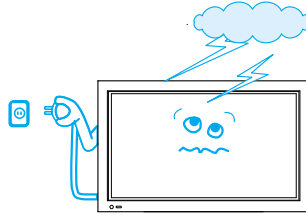

When unplugging your TV, always grip plug firmly and pull straight out from the receptacle.

It can result in fire or electric shock due to damaged power cord.

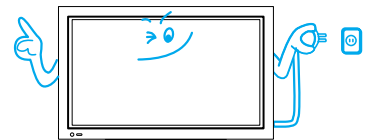

This product must be properly grounded.

- Improper grounding may cause malfunction or electric shock.
- When proper grounding is not possible, install circuit breaker.
- Do not ground to gas pipe, water pipe, lightning rod, or telephone line.

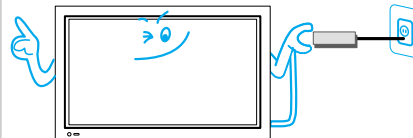

During a lightning storm, unplug the TV from the wall outlet, and do not touch the antenna.

It can cause fire or electric shock.

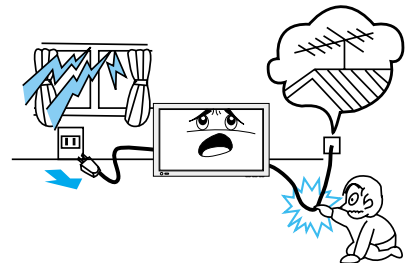

Installation

Do not use this product in the neighborhood of a bath or shower.

It can result in electric shock or fire.

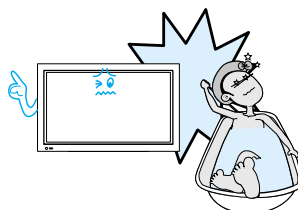

Do not place this TV on an unstable cart, stand, or table

It may cause the product and cart to overturn, damaging equipment or causing possible injury.

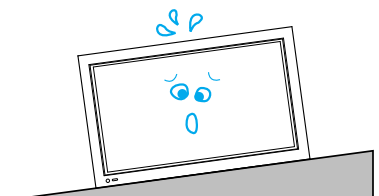

During Use

Do not open the cover (or back) because high voltage is present within the TV enclosure.

It may cause electric shock.

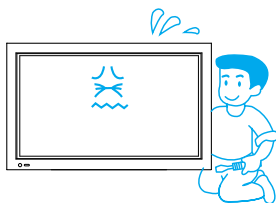

Never push any kind of objects into this product through openings at the back of TV.

It may cause fire or electric shock.

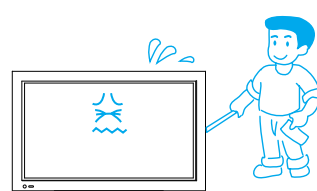

The apparatus shall not be exposed to dripping or splashing and that no objects filled with liquids, such as vases, shall be placed on the apparatus.

Spilled liquids may cause electric shock or fire.

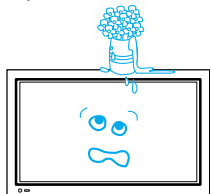

Do not allow children to play or hang on the TV.

These actions may tip it over, causing personal injury.

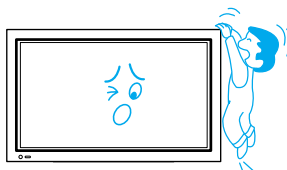

Do not place a candle or lighted cigarette on the TV.

If these fall into the inside of the TV, it may cause a fire or explosion.

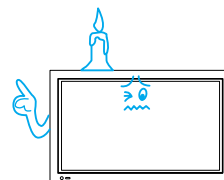

Do not disassemble batteries, and do not leave around in case children swallow them.

Heavy metal may contaminate environment, and can be harmful or detrimental to human health. (If children swallow the batteries, go to hospital and consult with a doctor.) Batteries could explode if fitted incorrectly. Align the batteries according to the (+) and (-) indication inside the case.

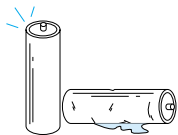

Do not spray water onto the TV or wipe with damp cloth.

It may cause an electric shock or fire.

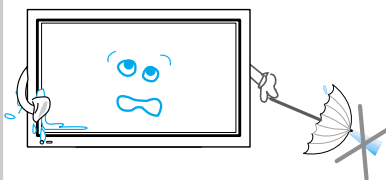

Unplug the TV from the wall outlet when smoke or a strange smell occurs, then refer to a service personnel.

Leaving the TV on in this condition, may cause fire or electric shock.

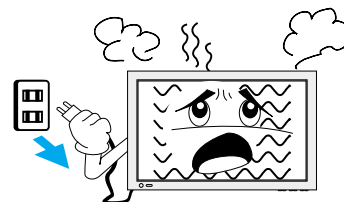

Safety Precautions

Always obey all safety messages.

- All the safety and operating instructions should be read before the product is operated.

CAUTION

You can be injured, or this product or any other of your property can be damaged if you don't follow instructions.

Power

When moving your TV, remove the power plug, antenna, and cables, and be sure to move it by using two people..

Failure to follow this instruction can result in electric shock or personal injury.



Do not touch the power plug with wet hands when plugging or unplugging it into the wall socket.

It can result in a risk of electric shock.

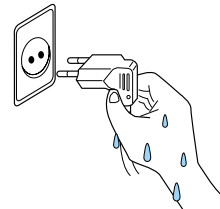

Installation

Do not install the product where there is oil, smog, moist, or dust

It may cause malfunction.

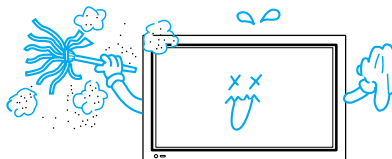

Do not install the product where it will be exposed to the direct sunlight, and the product should not be near heat sources such as radiators, stoves, etc.

It may cause malfunction.

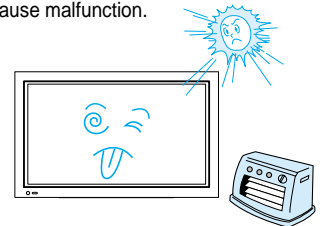

For proper ventilation, separate the product from the wall, and keep a distance of more than 10cm (4").

Due to the increase of temperature inside the TV, it may cause fire.

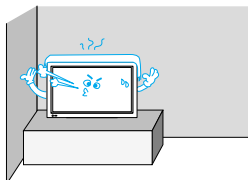

Minimum distances around the apparatus for sufficient ventilation.

Due to the increase of temperature inside the TV, it may cause fire.

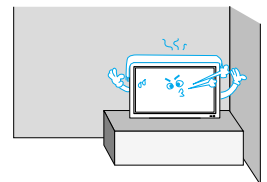

If you wish to install this product on the wall or ceiling, refer to a professional.

Failure to do so may cause damage to product and injury to human.



When using an outside antenna system, do not install it in the vicinity of overhead power lines.

If the antenna touches such power lines, it may cause electric shock.

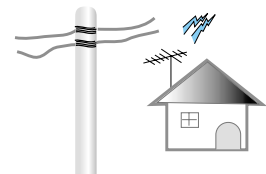

During Use

The plasma television panel consists of fine cells. Although the panels are produced with more than 99.9 percent active cells, there may be some cells that do not produce light or remain lit.

Do not allow a still picture to be displayed for an extended period, as this can cause a permanent ghost image to remain on the Wide Plasma Television.

Examples of still pictures include logos, video games, computer images, teletext and images displayed in 4:3 mode.

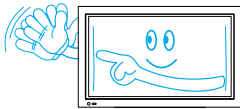

Warranty does not cover any damage caused by image retention.

Do not wipe the TV using a cloth damped with chemicals (benzene, thinner, etc.).

TV appearance may be marred. (Unplug the power plug and wipe with soft cloth.)

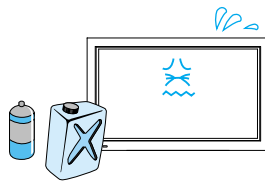

Do not place heavy objects or heat sources on the power cord.

It may damage the power cord, causing fire or electric shock.

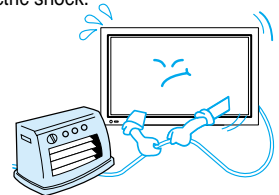

Do not place any object or cover on the TV.

In an event of improper ventilation, the TV will be overheated causing fire.

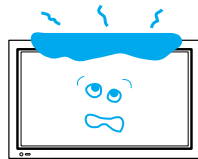

When watching the TV, the distance between the TV screen and your eye should be as 5~7 times as the diagonal distance of the TV.

Watching the TV for a long time may hurt your eye sight.

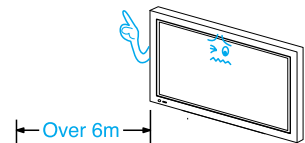

When cleaning of the inside of the TV is required, consult to the qualified service personnel.

When the TV is not cleaned for a long period of time, dust in it may cause fire or malfunction.



When the TV is placed on a cart or table, the front side of the TV should not project outward.

Unbalance may cause the TV to drop, resulting in personal injury or equipment malfunction and damage.

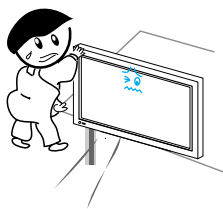

Do not grip speakers when moving the TV attached with speakers.

When moving the TV while gripping speakers, speakers may be fallen away from the TV due to its weight, causing personal injury.

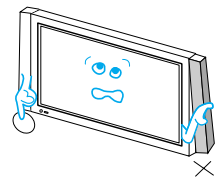

Checking Accessories



Note

Check to be sure that the following items are packed with your Plasma panel.

Supplied Accessories

Remote Control

1 UNIT

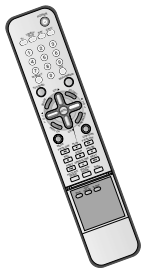

Component Cable

1 UNIT

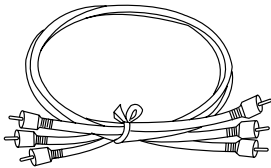

A/V Cable

2 UNITS

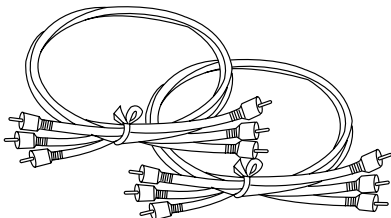

Ferrite Core

2 UNITS



Place the small ferrite cores in the speaker cables close to the speaker terminals of the PDP unit.

Speaker(2 units)

Coaxial Cable

1 UNIT

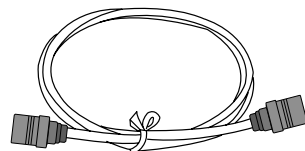

AC Cable 1 UNIT



Note

The following items are optional accessories. Refer purchasing optional accessories from Daewoo Electronics Local retailer or the retailer from where you purchased the unit.

Optional Accessories

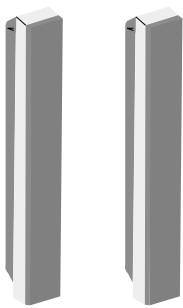
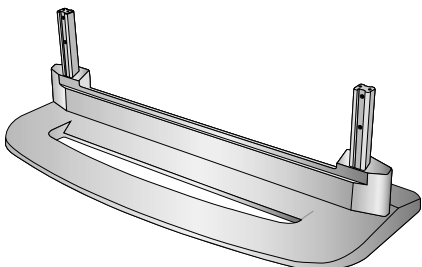
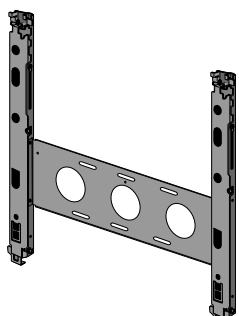
<h3>Speakers</h3> 	<h3>DTS-42SP</h3> <ul style="list-style-type: none"> - Speaker Main Unit Dimension : 100(W) x 628(H) x 83(D) mm 39.37(W) x 24.72(H) x 3.27(D) inch - Dimension Including Speaker Stand : 170(W) x 729(H) x 194(D) mm 6.69(W) x 28.7(H) x 7.64(D) inch - Audio Amplifier : 10W + 10W - Impedance : 8Ω - Weight : 6.4kg(14.11 Lbs)
<h3>Table Top Stand</h3> 	<h3>DTS-42ST</h3> <ul style="list-style-type: none"> - Dimension : 667(W) x 212(H) x 320(D) mm 26.26(W) x 8.35(H) x 12.6(D) inch - Weight : 7kg(15.43 Lbs)
<h3>Wall Mounting Unit</h3> 	<h3>DSP/DP-HG10, DSP/DP-HG20, DSP/DP-HG22</h3> <ul style="list-style-type: none"> - Variable Angles : 0°, 10°, 15°, 20° - Dimension : 601(W) x 592(H) x 35(D) mm 23.66(W) x 23.31(H) x 1.9(D) inch - Weight : 4.5kg(10 Lbs)





CONTENTS

PREPARATION

- 6 • Safety Precautions
- 10 • Checking Accessories
- 14 • Panel Controls
- 15 • Remote control
- 16 • Remote Control Setup

CONNECTION

- 17 • Antenna Connection
- 20 • To Watch TV
- 22 • Channel Setup
- 28 • Watching Digital Broadcasts
- 30 • Watching Cable Broadcasts
- 32 • Watching Satellite Broadcasts
- 34 • Watching a DVD Image
- 36 • Watching a VCR Image
- 38 • Watching a Camcorder/Game Console Image
- 40 • Connecting PC(15Pin D-Sub)
- 42 • Connecting PC(DVI)

APPLICATION

- 45 • Selecting Picture Mode
- 46 • Customizing Picture
- 48 • Adjusting Screen Size
- 50 • Adjusting Screen Size(PC, DVI)
- 52 • Enlarging Screen Size
- 54 • Watching a Still Image
- 55 • Adjusting Auto Sound Mode
- 56 • Customizing Sound Mode
- 58 • Selecting INPUT SIGNAL
- 60 • Checking the Current Input Signal
- 61 • MENU Background, Languages and Keypad Lock Settings
- 63 • MGDl (Meta Genuine Digital Image)
- 65 • Closed Caption Setting
- 67 • Time Setting
- 69 • Image Sticking Minimization(ISM)
- 71 • Parental Lock Setting
- 75 • Initialize Setting
- 77 • Setting Sleep Timer

MISC.

- 78 • Before Requesting Service
- 79 • SPECIFICATIONS

Panel Controls

Front Panel, Back Panel, Remote Control

* Items having same names on Plasma television and the remote control would function in exactly the same way.

Front

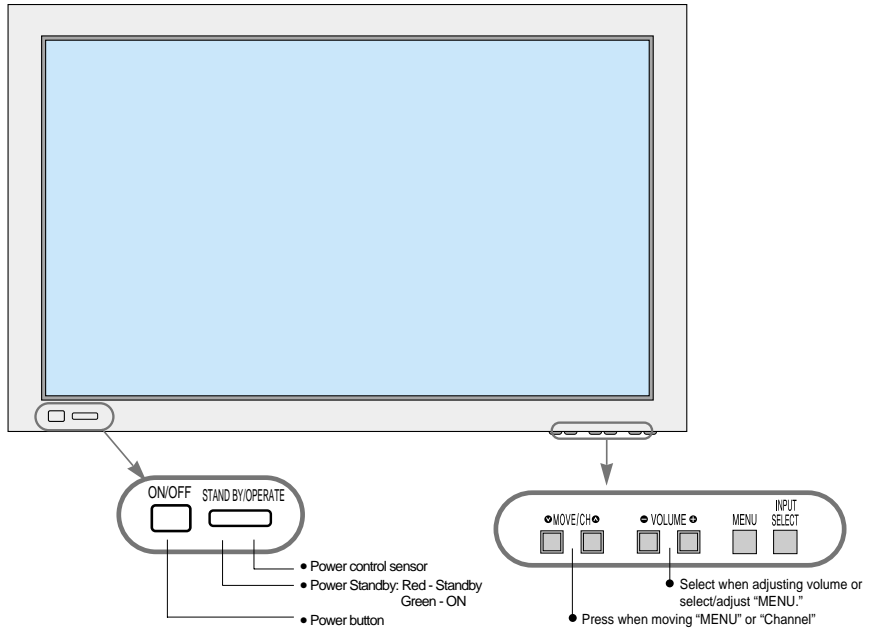

Rear

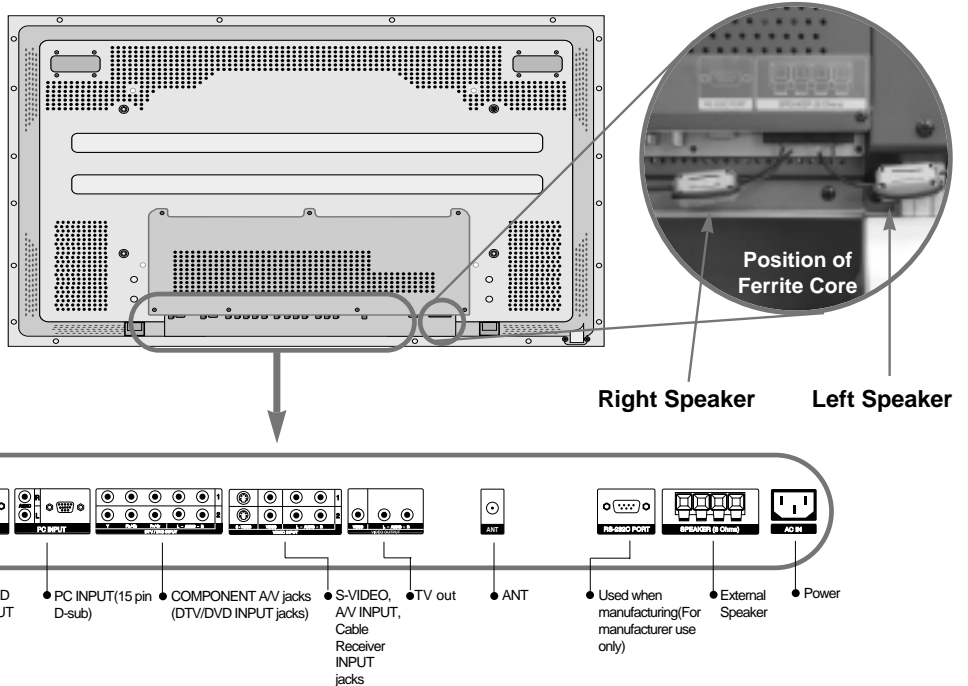

Remote Control



Note

- Use two "AAA" batteries.
- Be sure to use replacement batteries of the same type as the original ones.
- The life of a battery depends on how much it has been used.

* The number in () indicates the page in which the function of each button is explained in detail.

TV/VIDEO(DVD)/SAT/CATV

21 Channel number (0~9)
Use to select channel directly 0~9

60 Display button
Indicates the current state and resolution.

58 TV/VIDEO
Use this function to make video input selection. It changes in the following sequence TV -> Video1 -> Video2 -> TV

52 ZOOM button
Used to zoom the screen. To enlarge, press the(+) button, and to return to the previous condition, press the(-) button.(Zoom Mode : Zoom 0~20)

22 Menu button
Used to display a desired menu.

Previous Channel button
It returns to previous channel.

20 Mute button
Mute sound.

45 Picture Mode button
Every press of the button cycles through the four different. Normal -> Dynamic -> Cinema -> User.

57 MTS button
This feature allows you to select the language and stereo sound while broadcasting

24 CHANNEL ADD/ERASE
The feature either memorizes the current channel or erases a channel that has previously memorized.

Power button 20
Pressing the Power button of the TV allows the Display to be standby. (Red light is shown in the Remote Control Sensor.) At this time, if you press the Power button of the Remote Control, the Display is turned ON (Green light in the Sensor).

100
Use it when selecting a channel number of over 100

Multimedia 58
Use this function to make video input selection. It changes in the following sequence PC -> DVI -> Component 1-> Component 2 -> PC

CH button ▼/▲ Adjusts the channel.

Volume button ◀/▶ Adjusts the volume.

Screen Size button 48
Adjusts the size of the screen (Normal, 16:9, etc.)

Caption button 65
This feature allows you to choose the caption.

VIDEO/DVD Function

Still button 54
Used to view a still picture during watching moving images.(Sound can be heard.)

Sound Mode button 55
Every press of the button cycles through the five different modes: Normal -> Movie -> Music -> News -> User.

Sleep Timer button 77
Each time you press this button, a different input mode appears. The sequence is as follows: 15Min. -> 30Min. -> 60Min. -> 90Min. -> 120Min. -> OFF
After the time is selected, it automatically becomes standby state.

■ When Using Remote Control:

- Be sure not to allow the Remote Control to drop or to become wet.
- Keep it away from hot or moist locations.



■ Installing the Batteries in your Remote Control:

- Push to open the cover of the remote controller
- Set the batteries in the battery cell after checking the electrode, and then shut the cover.

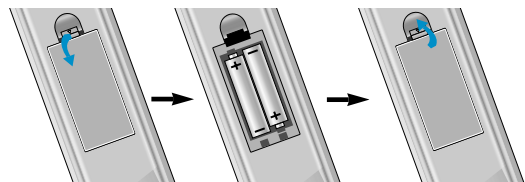

Remote Control Setup

Remote control supporting the multi brand devices.

- The remote control provided is designed to operate the Daewoo PDP set.
- However, using the remote control, you can control the Cable Converter, VCR , DVD and Satellite Broadcasting Receiver of other brands after setting up the remote control.

Notices:

- All the preset codes are erased when replacing the battery. In this case, you must set the remote control again.
- Some of the products may not be applied because of different signal system.
- This is only for the basic control of the devices.

● HOW TO SET UP THE REMOTE CONTROL FOR USING OTHER DEVICES .

- Turn on the Device. (Cable Converter, VCR , DVD or Satellite Broadcasting Receiver)
- Press the device selection button of remote control until it is flickering. It takes about 3 seconds.
- Press the assigned three digits code of the device using number key button of the remote Control toward the IR receiver of the device. The code number is provided below. Whenever pressing the number, the device selection button will be flicked once.
- If the code is set properly, the device will turn off automatically. If not, repeat the process 3.
- As the device is turned off, press the flickering device selection button of the remote control once. Then the lamp will be turned off.
- Now, the setting-up of the device can be controlled by Daewoo PDP remote control.

Remote Control Setup Code

VCR (STANDARD : 004)		SAT (STANDARD : 004)	
Maker (Brand) Name	Code Number (3 digit) List	Maker (Brand) Name	Code Number (3 digit) List
DAEWOO	004 012 014 017 068 069 094 096 097 098 102 103 104	DAEWOO	004
JVC	018 037 039 048 052 054 059 064 111 130 132 206	PANASONIC	066
MITSUBISHI	019 026 049 050 053 055 063 065 131 223	PHILIPS	075
PANASONIC	070 074 078 086 114 125 224 225	SAMSUNG	122 142
PHILIPS	037 039 058 075 087	For more device codes, contact Daewoo service center.	
SAMSUNG	038 045 088 090 091 093 095 098 099 101 105 106 109 231		
SHARP	037 058 129 221 228		
SONY	003 016 037 056 060 061 062 080 081 082 129 214		
DVD			
DAEWOO	352 360		
LG	350 368 369		
PANASONIC	357 370		
PHILIPS	355		
SAMSUNG	351 363 364		

Antenna Connection

Indoor Antenna Connection

1. Connect the feeder cable of the antenna to the combining adapter.

WHEN THE IMAGE IS NOT CLEAR

- Unclear screen image and bad reception may be a cause of wrong antenna connection. Be sure to check its direction and place when installing.

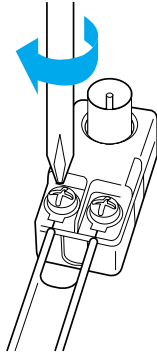

2. Connect the combining adapter to the antenna input at the back of the TV set.

WHEN USING THE COMBINING ADAPTER

- You may obtain the combining adapter at your closest Service Center.

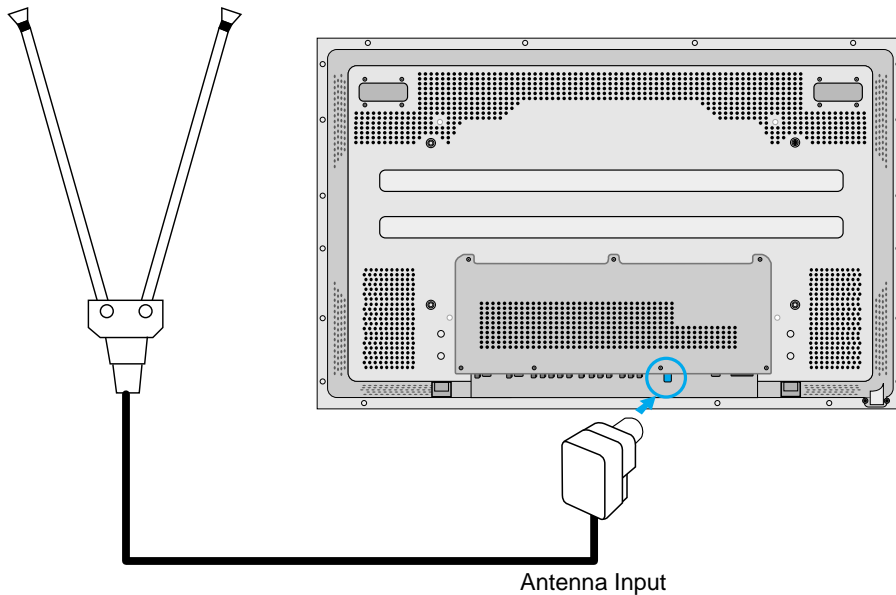

CTV Antenna Connection

TV Antenna installation may be found in most.

When a coaxial cable is used

Plug the coaxial cable to the antenna socket, and fix it firmly.
It is recommended to use the provided coaxial cable.

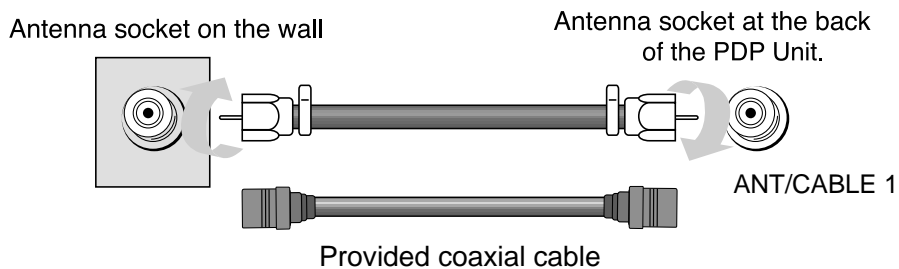

When a feeder cable is used

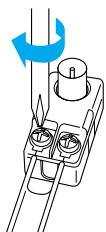
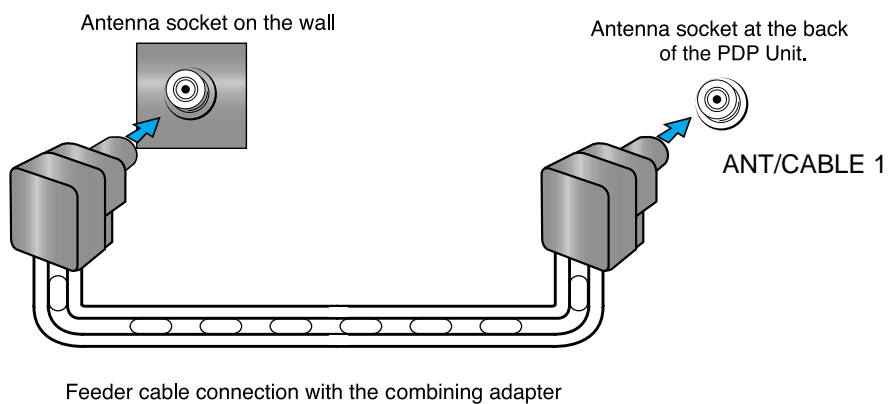

Outdoor Antenna Connection

Outdoor Antenna connection-such as VHF or/and UHF-may be necessary for installation at private houses

Single Antenna Connection.

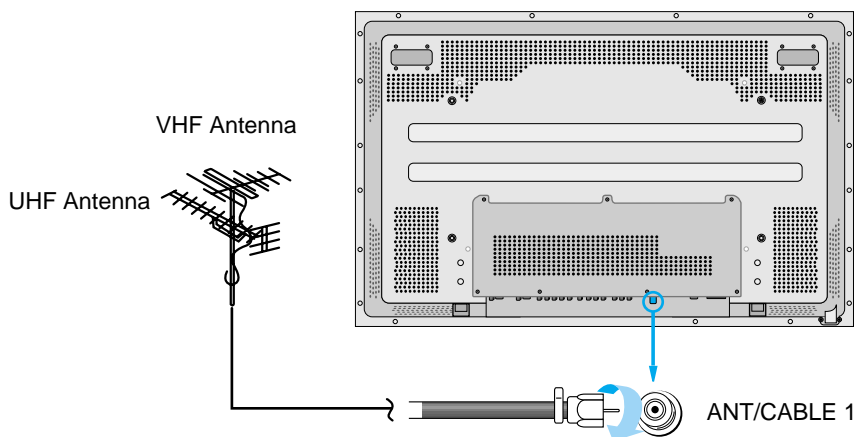

Separate Antenna Connection.

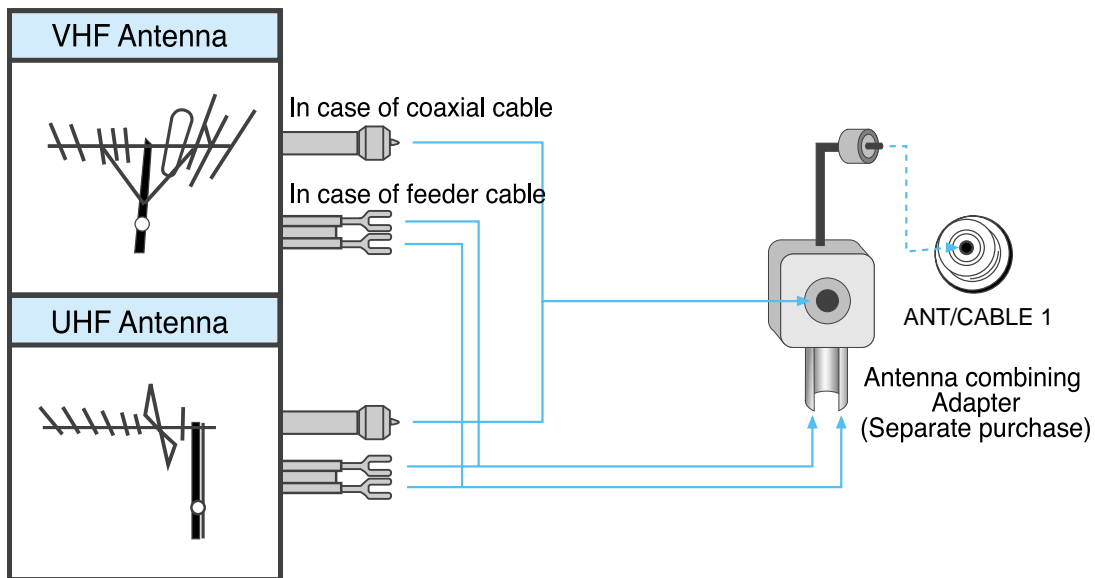

To Watch TV

To Watch TV

- The buttons on the keypad in the PDP unit, which have the same name as those on the remote controller, perform the same function as the remote controller.

Press the "ON/OFF" button of the PDP unit.

- Power button of the remote control and the keypad on the PDP unit would be operated only when the "AC Power" of the PDP unit is supplied. Otherwise, neither the remote controller nor keypad of the PDP unit can turn on the PDP.

When pressing a Channel button

- Select two digits if using the number button for Channel selection.
For example, to watch Channel No.9, press the Number buttons 0 and 9.
If pressing only number 9, it takes more time than pressing two digits for selecting a channel.

To mute the sound

1. Press the "MUTE" button.
2. No sound is heard if "MUTE" is displayed on the screen.
3. Sound is heard again if pressing the "MUTE" button once again.
For example, you can use this button when telephone rings or when guest comes while watching TV.

Check of TV operation status

- If pressing the "DISPLAY" button, the status of the Channel or broadcasting being currently watched or entry status of video component is displayed on the screen.

Auto Power Off

- If TV broadcast for the day is finished, the TV will automatically turn off after about 30 minutes. However, if the Off-time or Sleep time is operating, it takes precedence. This Auto Power Off feature only operates in the TV mode.





1 Press the "ON/OFF" button.



- Press the "ON/OFF" button of the PDP set.
- The main power lamp turns on in red color.
- Press the "POWER" button of the remote control or any button in the keypad of the main body.
- The LED of the PDP set turns on in "green" color and the set turns on.



2 Select Channel.

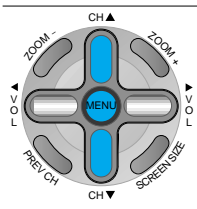

- Select the desired channel by pressing the "▼CH▲" button or the number button.
- Ex) Channel 09

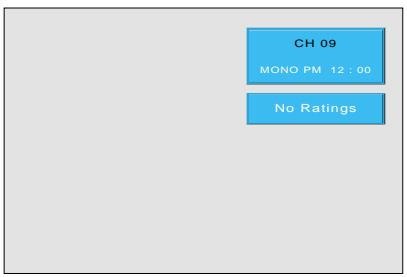
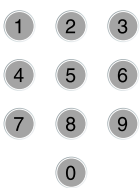

3 Adjust volume.

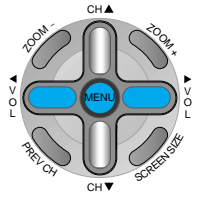

- Sound reduces if pressing the "◀VOL" button.
- Sound increases if pressing the "VOL▶" button.

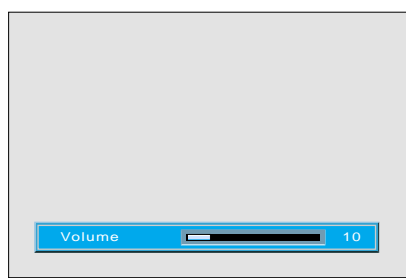

4 Press the "POWER" button to turn off the PDP set.



- TV turns off and the LED of the PDP set changes to red color.



Channel Setup

Automatic Channel Memory

- This is the function for the TV to memorize the broadcasting channels. If the Auto Setup is done, you can simply find out channels with "▼CH▲" buttons and so need not to select channels by pressing each channel number.



1 Press the "Menu" button.

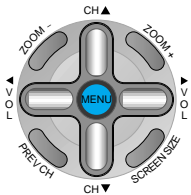

- The menu screen appears as follows.
- Press the "▼CH▲" button until coming on the channel.
- Press the "◀VOL▶" to enter the sub menu.

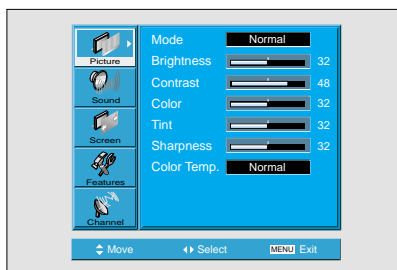

2 Select the Channel Mode.

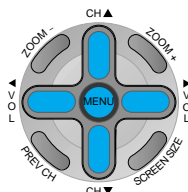

- Select the [Ch Mode] by pressing the "▼CH▲" button.
- Select "Air" to watch the general broadcasting, and select "Cable" to watch the cable TV by using the "◀VOL▶" button.

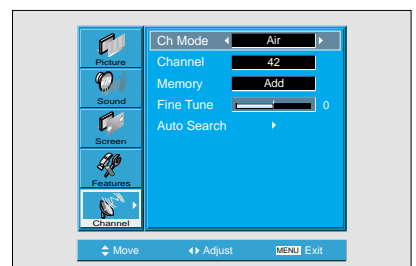

3 Select the [Auto Search].

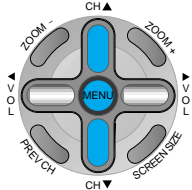

- Select the "Auto Search" with the "▼CH▲" button.

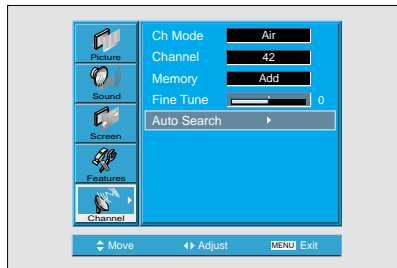

4 Press the "VOL ▶" button.

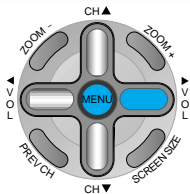

- By pressing the "VOL ▶" button automatically searches OnAir Channel as in the right.
- On Air TV, searches from 2 channels through 69 channels, and on Cable TV, searches from 1 channels through 125 channels.
- In this case, if pressing the menu button, the automatic Channel search is stopped and channels searched by that time are saved.

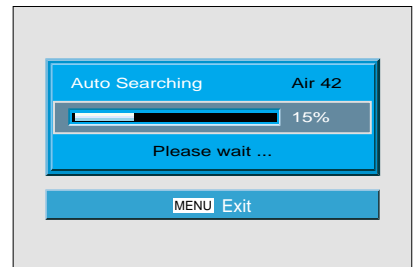

5 Auto Search is completed.

- If auto search is completed, first memorized channel appears on the screen.

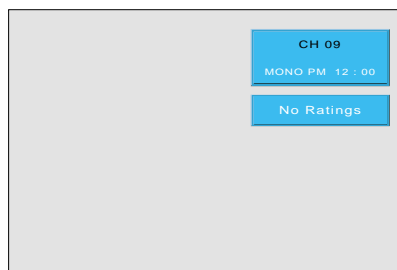

6 Check by pressing the "▼CH▲" button.

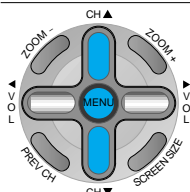

- You can search only the memorized channels.

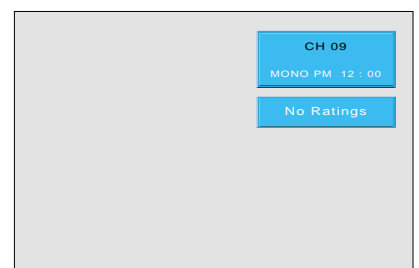

Additional Channel Memory

Additional Channel Memory

- This is method for additionally memorizing channels not memorized due to weak broadcasting signal.
- This function is available even in the [Menu] - [Channel] - [ADD/ERASE].

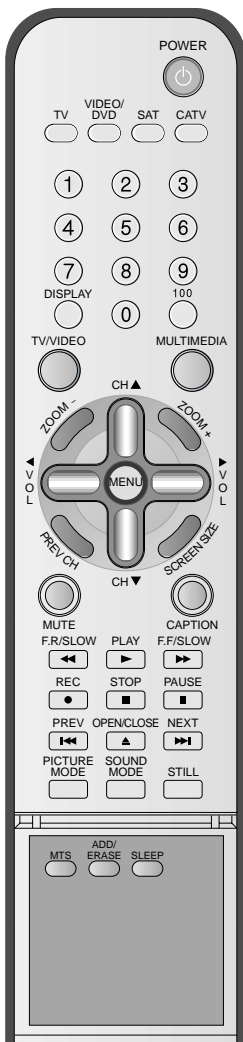

1 Select the Channel to memorize.

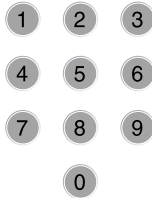

- Select the Channel by pressing the number button.
Ex) "13" channel

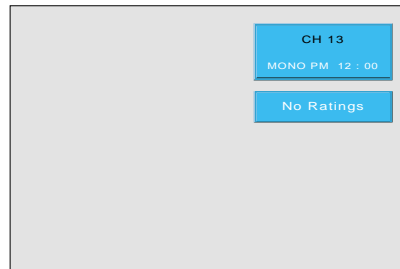

2 Press the "ADD/ERASE" button.



- "ADD/ERASE" character alternatively appears whenever pressing this button.
- Add appears in green color and Erase appears in red color.
- Add 13 channel by pressing the "ADD/ERASE" button.

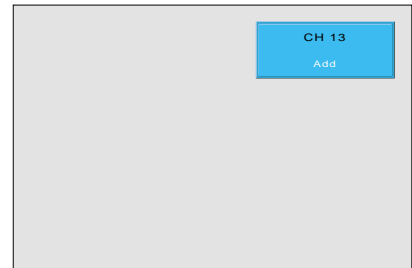

3 Check the Channel by pressing the "▼CH▲" button.

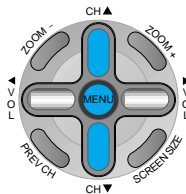

- "13" is selected by pressing the "▼CH▲" button.

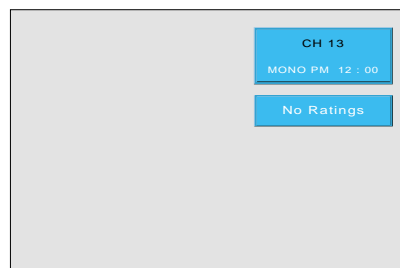

Erase of Memorized Channel

1 Select the Channel to erase.

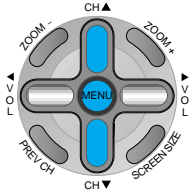

- Select the Channel to erase with the “▼CH▲” button.
- You may select the Channel by pressing the number button.
Ex) “13” channel



2 Press the “ADD/ERASE” button.



- After selecting the channel to want to erase, press the “ADD/ERASE”
- “ADD/ERASE” character alternatively appears whenever pressing this button.
- If pressing the “ADD/ERASE” button, the Channel number changes from green color to red color.

Notices:

- The OSD menu disappears if commands are NOT received for 20 sec.
- Press menu button to exit from the OSD menu or to go to previous step.
- Available commands for each OSD menu are displayed in the lower parts of the menu.

Erase of Memorized Channel

- This is function to erase unnecessary memorized channel.
- This function is available even in the [Menu] - [Channel] - [ADD/ERASE].

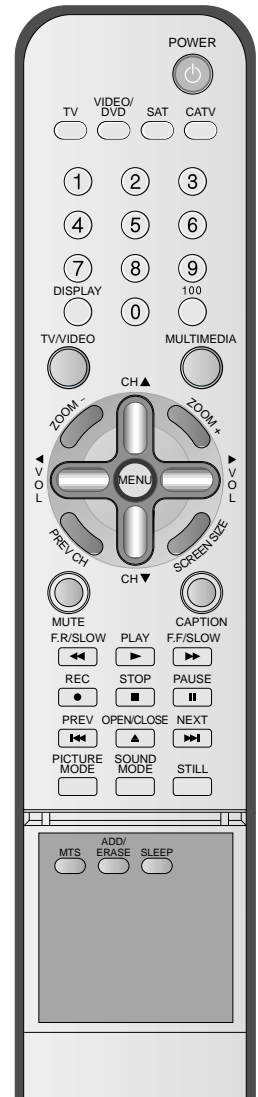

Fine Tune

- If you are unable to get a good picture or sound because of a poor signal reception, it is possible to adjust it with the Fine Tune feature..

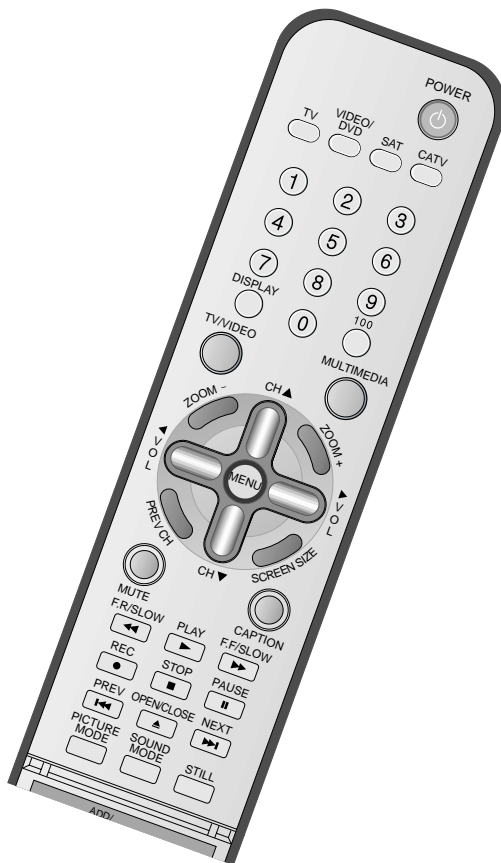

1 Select the [Channel] with the “Menu” button and the “◀VOL▶” button.

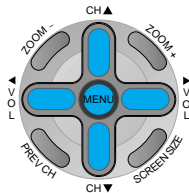

- Enter the sub menu of [Channel] by pressing the “◀VOL▶” button.



2 Select "Air/Cable" in [Ch Mode].

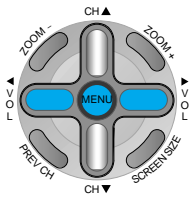

- This function is used for selecting "Air TV" and "Cable TV"
- The screen is changed to "Air TV" and "Cable TV" whenever pressing the "◀VOL▶" button.

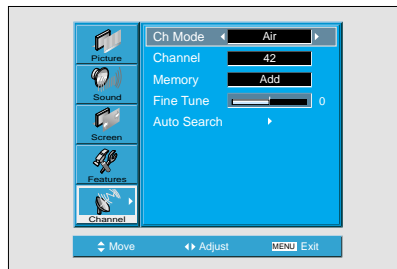

3 Select Fine Tune

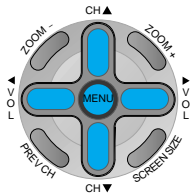

- Select [Fine Tune] by using the "▼CH▲" button.
- Until the screen becomes best condition, adjust the screen by pressing the "◀VOL▶" button.

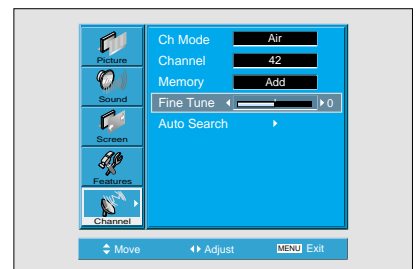

Note:

Fine Tune

- If original TV signal input is not good, fine-tuning may not improve screen condition.
- For different Ch mode(Air or Cable), the fine-tuning of each channel is set independently. For example, fine-tuning Ch13(Air) does not affect ch13(Cable) tuning set.

Watching Digital Broadcasts

Watching Digital Broadcasts

- To watch digital broadcasts:
 - Purchase a separate digital Broadcasting Receiver (SET-TOP BOX)
 - Connect the PDP to a Digital Broadcasting Receiver as shown right.

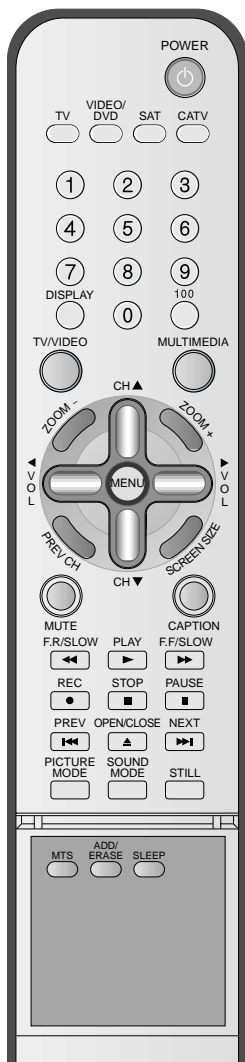

1 Connect a Digital Broadcasting Receiver to the PDP

- Prepare supplied A/V cables.
- Connect the cables from the Digital TV Receiver output terminal to the PDP (Component 1, 2) input terminal.
- When connecting the cables, be sure to match the cable colors.

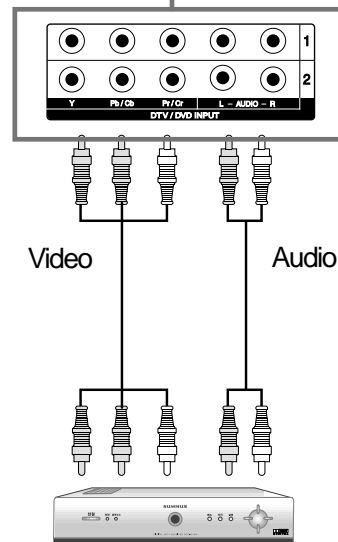
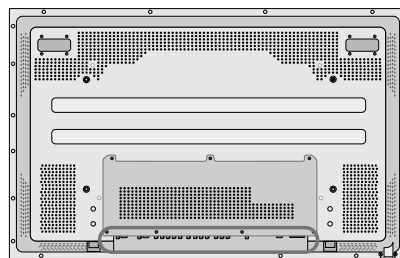

Digital Broadcasting Receiver
(Set-Top Box)

2 Press the Power Buttons

POWER



- Turn the PDP and the Receiver ON.

3 Input Select

MULTIMEDIA



- Select [Component 1 or Component 2] by pressing the "Multimedia" button of the Remote Control or the "INPUT SELECT" Key in KeyPad of the pdp set.
- Each time you press the "Multimedia" button, different input modes appear. The sequence is as follows:

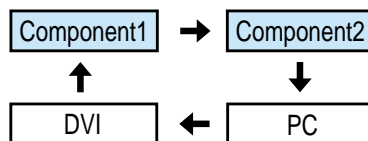

4 Select a Desired Channel and Function

- Select a desired channel and function by using the Remote Control of Digital Broadcasting Receiver.



NOTES:

- 1) You can select input using [INPUT SELECT] button in the keypad of the pdp set. The used sequence is as follows:
TV -> PC -> DVI -> Component1 -> Component2 -> Video1 -> Video2
- 2) Possible Digital Broadcasting signals: 1080i, 720p, 480p.
- 3) Antenna Connection:
Apartment : Check if community antenna receives digital broadcasts.
Private Houses: Set the indoor/outdoor UHF antenna to the direction of the digital broadcasting transmitting company.
- 4) For detailed connection method, refer to the Owner's Manual of Digital Broadcasting Receiver.
- 5) What is a component? : Signals with which brightness and color are separated, producing a sharp picture.
- 6) If the Digital Broadcasting Receiver has PC Output terminal or DVI Output terminal, connect to 'PC INPUT' or 'DVI INPUT' at the back panel of the PDP.
When watching the PDP by PC or DVI Input, some undesired signals may be seen at the top and bottom area of the screen. In this case, select [Menu] -> [Screen] -> [V. Size] to adjust.

Watching Cable Broadcasts

Watching Cable Broadcasts

- To watch cable broadcasts, subscribe to your local Cable TV Broadcasting, and then connect a cable Broadcasting Receiver TV to the PDP as shown right.

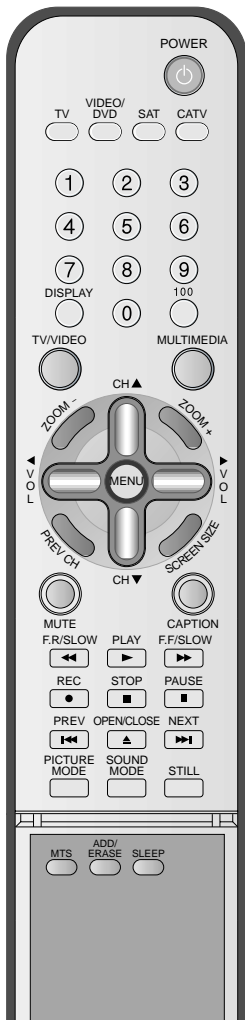

1 Connect a Cable Broadcasting Receiver to the PDP.

- Prepare the A/V cable.
- Connect the receiver(Output) to PDP(Video Input) as shown below.
- When connecting to an external AV source, be sure to match the colors.

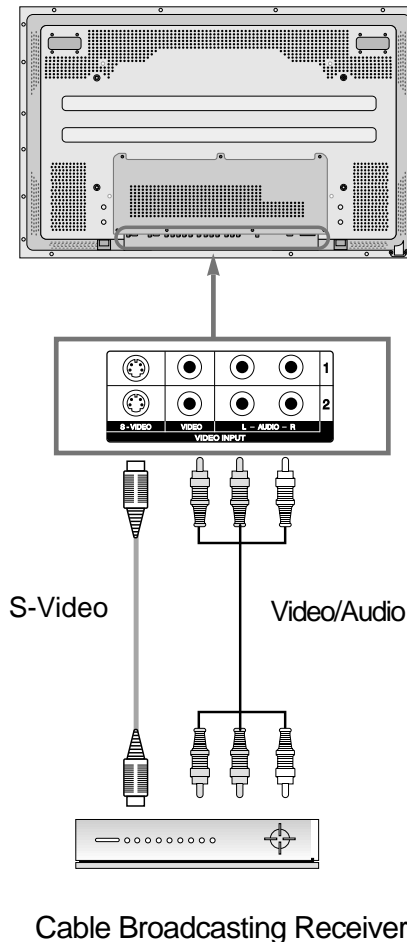

2 Press the Power Buttons

POWER



- Turn the PDP and the Receiver ON.

3 Input Select

TV/VIDEO



- Select [Video 1 or Video 2] by pressing the TV/VIDEO button of the Remote Control or the "INPUT SELECT" Key in KeyPad of the pdp set.
- Each time you press the "TV/VIDEO" button, different input modes appear. The sequence is as follows:

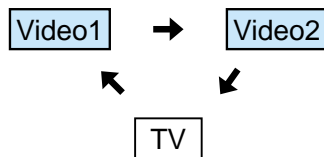

4 Select a Desired Channel and Function

- Select a desired channel and function by using the Remote Control of the Cable Broadcasting Receiver.



NOTES:

- 1) If your local cable company re-transmits digital broadcasts, you may watch normal broadcasts or digital broadcasts simultaneously. For detailed information, refer to your local cable company.

Watching Satellite Broadcasts

Watching Satellite Broadcasts

- To watch satellite broadcasting, subscribe to Digital Satellite Broadcasting, then connect satellite Broadcasting Receiver to the PDP as shown right.

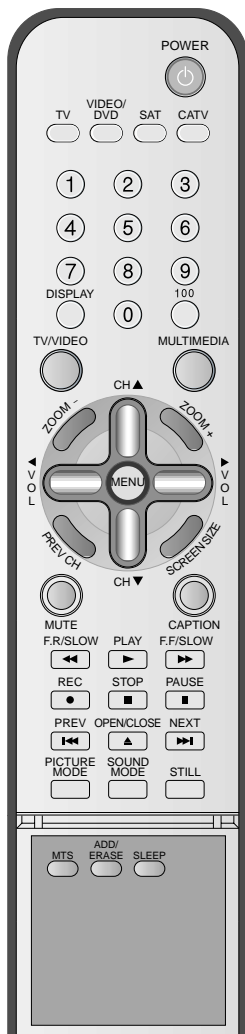

1 Connect a Satellite Broadcasting Receiver to the PDP.

- Prepare the A/V cable.
- Connect the receiver(Output) to PDP(Video Input) as shown below.
- When connecting to an external AV source, be sure to match the colors.

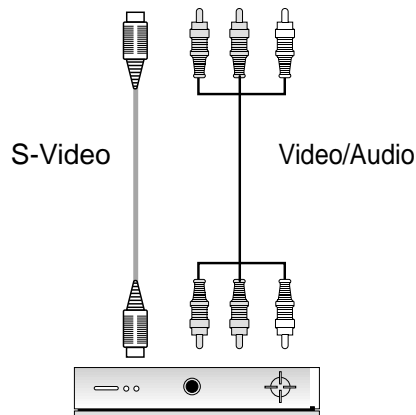
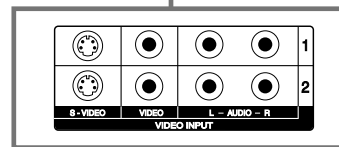
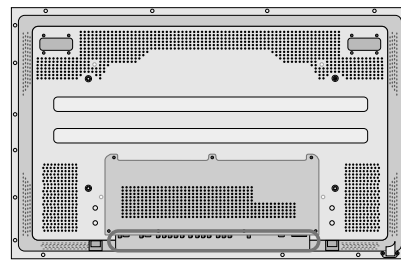

Satellite Broadcasting Receiver

2 Press the Power Buttons

POWER



- Turn the PDP and the Receiver ON.

3 Input Select

TV/VIDEO



- Select [Video 1 or Video 2] by pressing the TV/VIDEO button of the Remote Control or the "INPUT SELECT" Key in KeyPad of the pdp set.
- Each time you press "TV/VIDEO" button, a different input mode appears. The sequence is as follows:

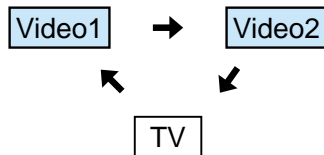

4 Select a Desired Channel and Function

- Select a desired channel and function by using the Remote Control of the Satellite Broadcasting Receiver.

Watching a DVD Image

Watching a DVD Image

- Component Input is set to 480i and 480p mode.
- Connect the cable from the DVD Video Output (Y, Pb/Cb, Pr/Cr) to the Component Input at the back of PDP, and connect the cable from DVD Audio output (Left, Right) to the Audio Input at the back of PDP.

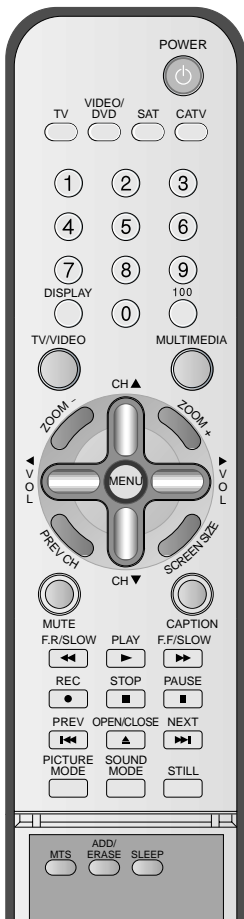

1 Connect a DVD Player to the PDP.

- Prepare the AV cable.
- Connect the DVD(Output) to the PDP(Component or Video Input) as shown below.
- When connecting to an external AV source, be sure to match the colors.

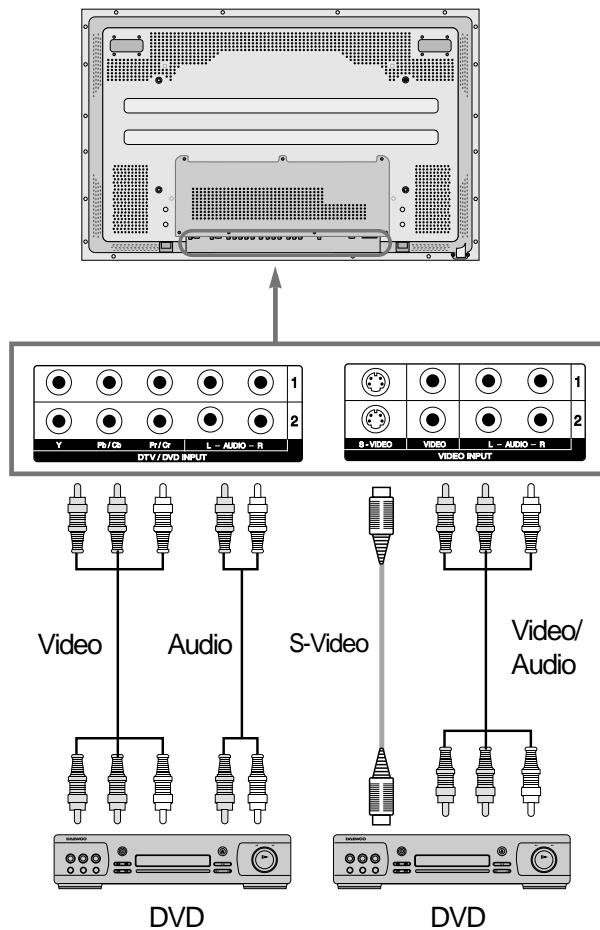

2 Press the Power Buttons

- Turn the PDP and the DVD ON.



3 Input Select

MULTIMEDIA



TV/VIDEO



- Select [Component 1 or Component 2, Video1, Video2] by pressing the "MULTIMEDIA" or "TV/VIDEO" button of the Remote Control or the "INPUT SELECT" Key in KeyPad of the PDP set.
- Each time you press the "MULTIMEDIA" or "TV/VIDEO" button, a different input mode appears. The sequence is as follows:

• "MULTIMEDIA" button

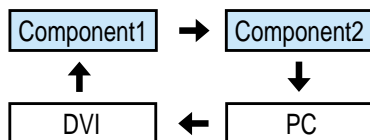

• "TV/VIDEO" button

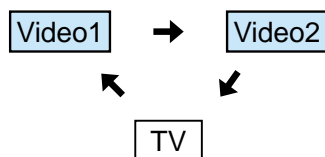

4 Select a Desired Title and Function

- Select a desired title and function by using the Remote Control of the DVD.



NOTES:

- 1) Y/Cb/Cr, which stands for DVD Player's Output Terminal, can also be written as Y/B-Y/R-Y, Y/Pb/Pr depending on the kinds of DVD devices.
- 2) The way of connecting the DVD to the PDP is as follows:
Y ↔ Y Cb ↔ Pb, B-Y, Cr ↔ Pr, R-Y
- 3) The DVD output can be Video, S-Video and/or Component Video depending on the DVD devices. There are various output modes, so be sure to check when you purchase it.
- 4) When connecting S-Video and Video simultaneously, only S-Video will be displayed on the screen.

Watching a VCR Image

Watching a VCR Image

- Video can use either the video terminal or the S-video terminal.

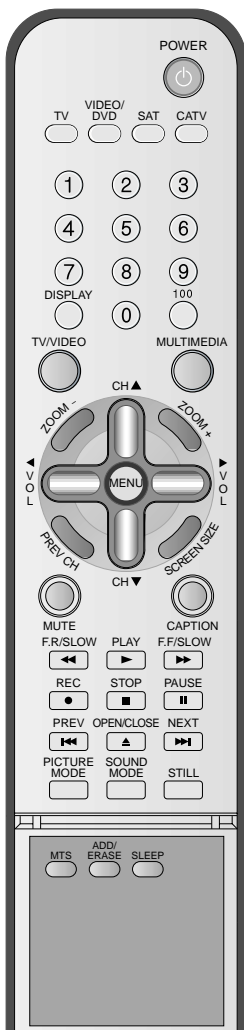

1 Connect a VCR to the PDP.

- Prepare the AV cable.
- Connect the Video(Output) to PDP(Video Input) as shown below.

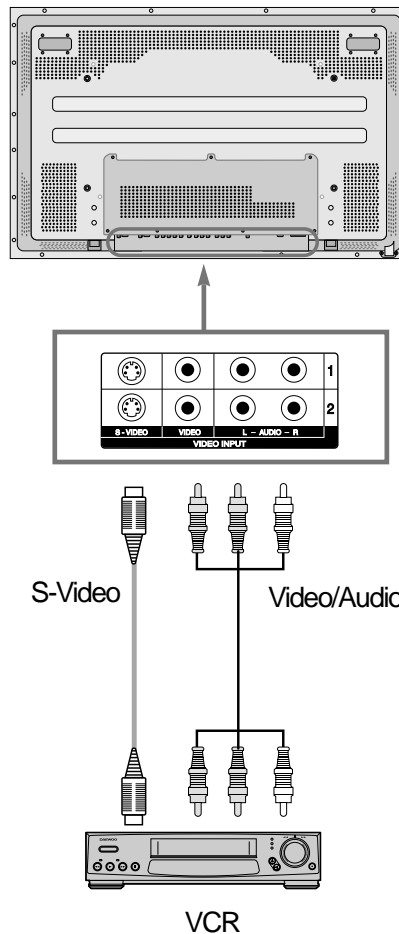

2 Press the Power Buttons

- Turn the PDP and the VCR ON.

POWER





3 Input Select

TV/VIDEO



- Select [Video 1 or Video 2] by pressing the "TV/VIDEO" button of Remote Control or the "INPUT SELECT" Key in KeyPad of the pdp set.
- Each time you press the "TV/VIDEO" button, a different input mode appears. The sequence is as follows:

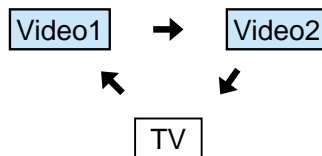

4 Select a Desired Title and Function

- Select a desired title and function by using the Remote Control of the VCR.



NOTES:

- 1) When connecting a Video, the S-Video terminal provides a better image than the Video terminal.
- 2) When connecting to the Video terminal, connect 3 color AV cables (video, left audio, right audio) to the PDP; for the S-Video terminal, connect the Audio terminal (Left, Right) in the same way, and connect the S-Video cable (sold separately).
- 3) When connecting the Video terminal and the S-Video simultaneously, the S-Video terminal is selected. This can be checked by the "DISPLAY" button of the Remote Control.

Watching a Camcorder/Game Console Image

Watching a Camcorder/Game Console Image

- Enjoy images recorded by camcorder or the game console after connecting to the PDP.

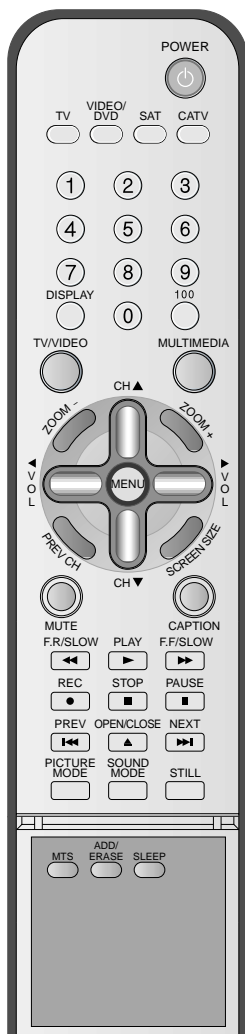

1 Connect a Camcorder/Game Console to the PDP.

- Prepare the AV cable.
- Connect the Video(Output) to the PDP(Video Input) as shown below.
- When connecting to an external AV source, be sure to match the colors.

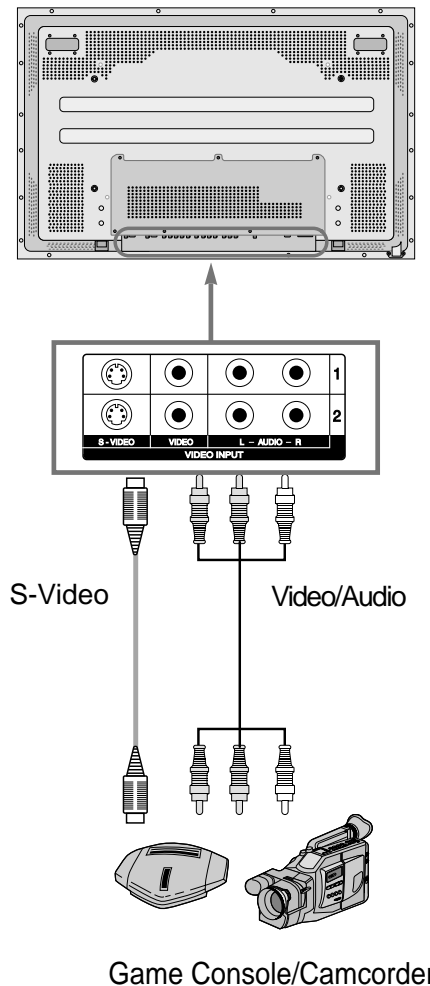

2 Press the Power Buttons

- Turn the PDP and the Camcorder/Game Console ON.

3 Input Select

TV/VIDEO



- Select [Video 1 or Video 2] by pressing the "TV/VIDEO" button of the Remote Control or the "INPUT SELECT" Key in KeyPad of the pdp set.
- Each time you press the "TV/VIDEO" button, a different input mode appears. The sequence is as follows:

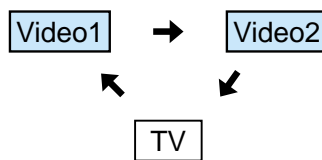

4 Select Function

- Select the Function by using the Remote Control of Camcorder or Game Console.



NOTES:

- 1) When connecting a Video, the S-Video terminal provides a better image than the Video terminal.
- 2) When connecting to the Video terminal, connect 3 color AV cables (video, left audio, right audio) to the PDP; for the S-Video terminal, connect the Audio terminal (Left, Right) in the same way, and connect the S-Video cable(sold separately).
- 3) When connecting a component, refer to "Watching a DVD Image" on page 34-35.

Connecting PC(15pin D-sub)

Connecting PC

- This product supports resolution of VGA, SVGA, XGA, and SXGA.
- Before connecting a PC to the PDP, be sure to adjust the resolution of PC.

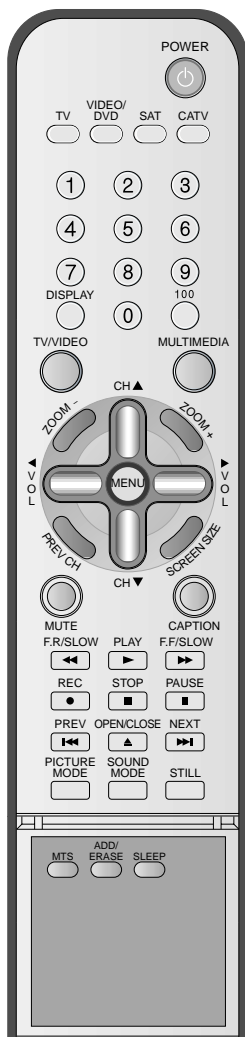

1 Before connecting to the PDP, set the resolution of the PC.

- Go to SETUP-CONTROL PANEL-DISPLAY PROPERTIES in Window Screen of the PC.
- Choose the SETTINGS tab in the DISPLAY Menu.
- In the SETTINGS Menu, select 640 x 480 or 800 x 600.

2 Connect the PC to the PDP.

- Prepare the PC cable (D-sub 15pin) and the PC audio cable(Sold separately).
- Connect the PC(Output) to the PDP(Input) as shown below.

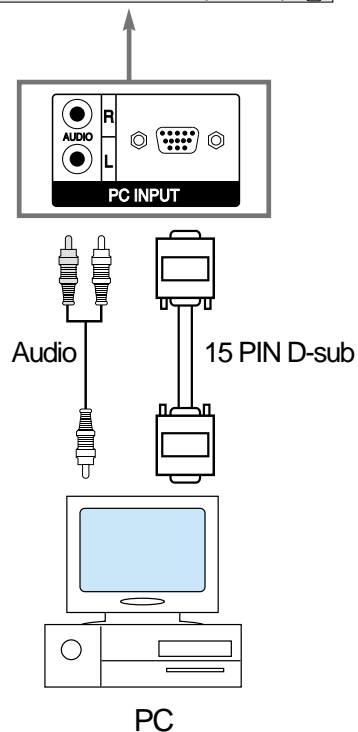
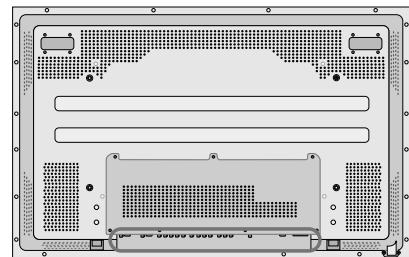

3 Press the Power Buttons.

- Turn on the PDP and the PC.

4 Input Select

MULTIMEDIA



- Select [PC] by pressing the "MULTIMEDIA" button of the Remote Control or PDP unit.
- Each time you press the "MULTIMEDIA" button, a different input mode appears. The sequence is as follows:

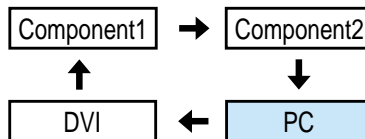

5 Enjoy Dynamic Ultra Screen TV by Using PC's Keyboard or Mouse.



NOTES:

- 1) The resolution of the PC TV is best at 640 x 480 (VGA).
- 2) If there is a [Vertical Frequency] setting menu in the [Display] Menu of the PC, adjust the frequency to 60Hz.
- 3) If the PC resolution is too high, it may be hard to read letters. Select a suitable resolution.

Connecting PC(DVI)

Connecting PC

- This product supports resolution of VGA, SVGA, XGA, SXGA.
- Before connecting a PC to the PDP, be sure to adjust the resolution of PC.
- This product is supported by Plug and Play only at DVI.

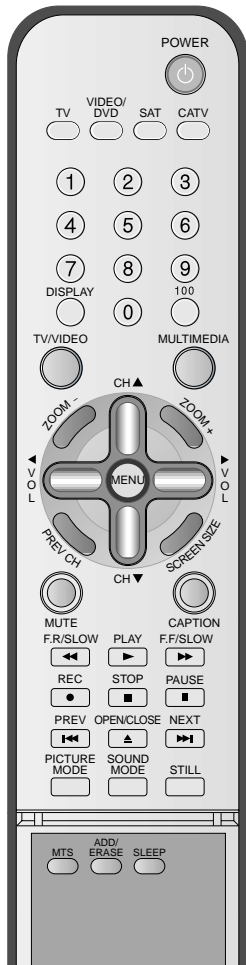

1 Before connecting to the PDP, set the resolution of the PC.

- Go to SETUP-CONTROL PANEL-DISPLAY PROPERTIES in Window Screen of the PC.
- Choose the SETTINGS tab in the DISPLAY Menu.
- In the SETTINGS Menu, select 640 x 480 or 800 x 600.

2 Connect the PC to the PDP.

- Prepare the DVI cable and the PC audio cable(Sold separately).
- Connect the PC(Output) to the PDP(Input) as shown below.

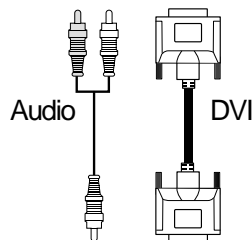
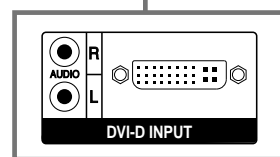
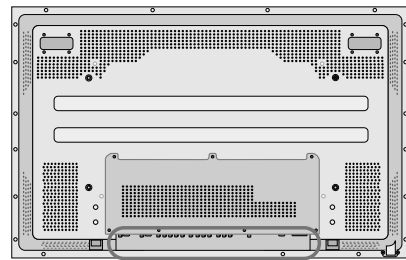

PC

3 Press the Power Buttons.

- Turn on the PDP and the PC.

4 Input Select

MULTIMEDIA



- Select [DVI] by pressing the "MULTIMEDIA" button of the Remote Control or PDP unit.
- Each time you press the "MULTIMEDIA" button, a different input mode appears. The sequence is as follows:

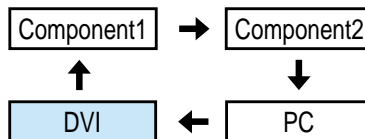

5 Enjoy Dynamic Ultra Screen TV by Using PC's Keyboard or Mouse.



NOTES:

- 1) The resolution of the PC monitor is best at 640 x 480 (VGA).
- 2) If there is a [Vertical Frequency] setting menu in the [Display] Menu of the PC, adjust the frequency to 60Hz.
- 3) If the PC resolution is too high, it may be hard to read letters. Select a suitable resolution.
- 4) DVI input port receives only Digital Signal.
- 5) Depending on the graphic card when plug & unplug the DVI connection the screen may not display correctly. Restart the computer if this happens.

PC and DVI Input Resolution Available in PDP

- Depending on graphic card, problems like no signal detected or line noises can happen. If these problems happen, contact the graphic card company for help.

Resolution	H Freq. (KHz)	V Freq. (Hz)	Remark	DVI	PC
640x400	37.861	85.080	VESA		O
640x480	31.469	59.940	DOS	O	O
	37.861	72.809	VESA	O	O
	37.500	75.000	VESA	O	O
	43.269	85.061	VESA	O	O
720x400	31.469	70.087	IBM	O	O
	37.927	85.039	VESA		O
800x600	35.156	56.250	VESA	O	O
	37.879	60.317	VESA	O	O
	48.077	72.188	VESA	O	O
	46.875	75.000	VESA	O	O
	53.674	85.061	VESA	O	O
1024x768	48.363	60.004	VESA	O	O
	56.476	70.069	HP&VESA	O	O
	60.023	75.029	VESA	O	O
	68.677	84.997	VESA		O
1152x864	67.500	75.000	VESA	O	O
1280x960	60.000	60.000	VESA	O	O

Selecting Picture Mode

1 Selecting Picture Mode

PICTURE
MODE



- Press the [PICTURE MODE] on the Remote Control.
- While pressing the [PICTURE MODE] for the first time, the current PICTURE MODE will be displayed.

2 Each Press of the Button Will Select One of Four Picture Modes.

PICTURE
MODE



- Each time you press the button, a different Picture mode appears. The sequence used is as follows:

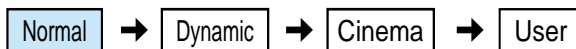

- * Normal : For a highly defined image in a normally bright room
- * Dynamic: For a clear-cut image emphasizing high contrast for sports viewing
- * Cinema: For a movie
- * User: Allows the user to customise settings as desired.

3 Menu on the Screen will disappear.

- After selecting a desired Picture mode, the menu on the screen will disappear.
- Normal, Dynamic, and Cinema Modes are factory preset values. If you want to customise the Picture modes, refer to the following page.

Selecting Picture Mode

- Select the Picture mode that is appropriately set depending on the kinds of pictures, and enjoy them.

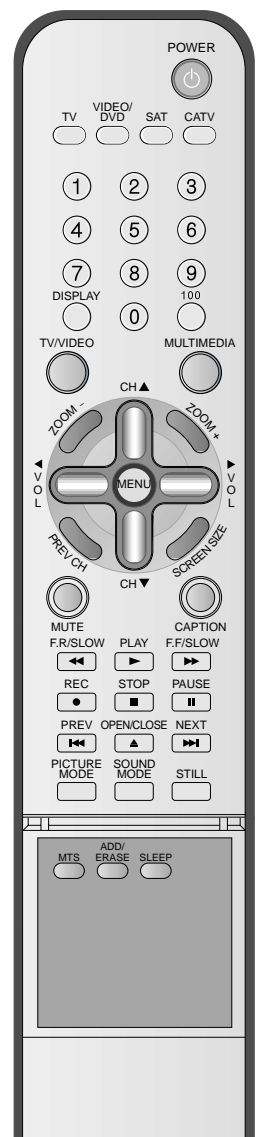

NOTES:

- 1) Normal, Dynamic, and Cinema Modes are factory preset values.
- 2) When adjusting sub-menus while you are in Normal, Dynamic, and Cinema Modes, the Picture Mode will be automatically converted to User Mode, and the adjustments will be made.
- 3) Selecting [Initialise] in the [Features], Menu will allow the Brightness, Contrast, etc. to return to the factory preset values.

Customizing Picture

Customizing Picture

- You can adjust the color tone and brightness to your preference.

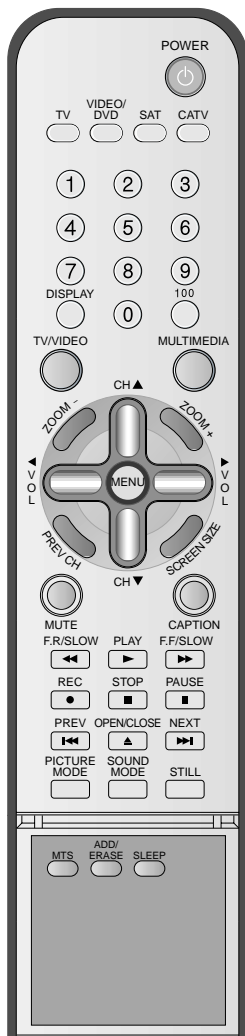

1 Press the MENU Button.

- The MENU shown below will display on the screen.

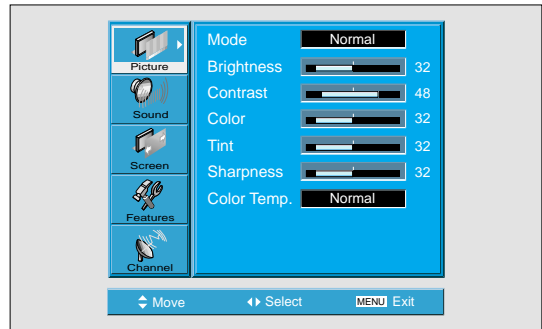
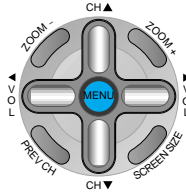

2 Press the “▲CH▼” Button.

- After selecting [Picture] by pressing “▲CH▼” button, press the “◀VOL▶” button. Then the sub menu of [Picture] will be displayed.

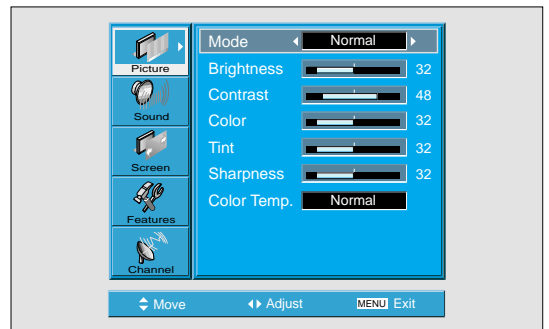
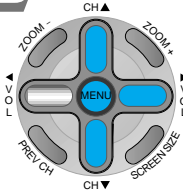

3 Select the User Mode.

- Select [User] by pressing the “◀VOL▶” button.

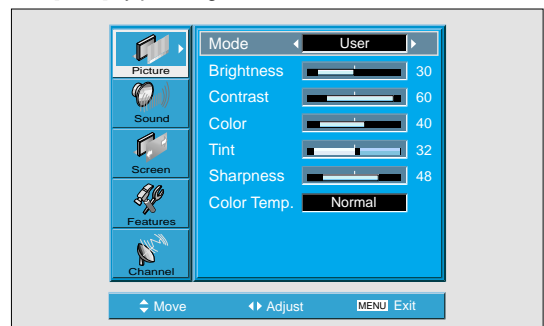
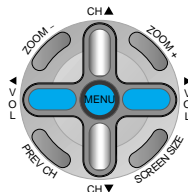

4 Select User Mode Adjustments

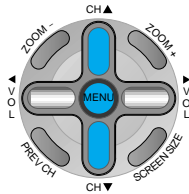

- While you are in [Picture Mode – User], press the “▲CH▼” buttons to select a specific adjustment item.

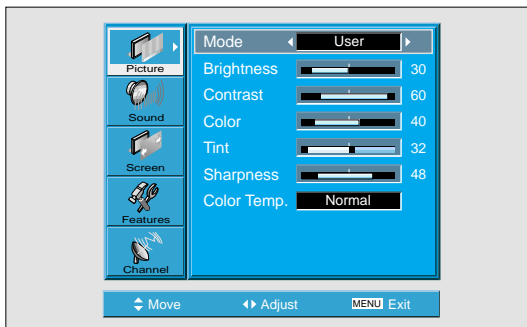

5 Picture Condition Adjustments

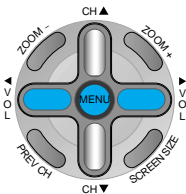

- Press the “◀VOL▶” buttons to adjust the picture at your preference.

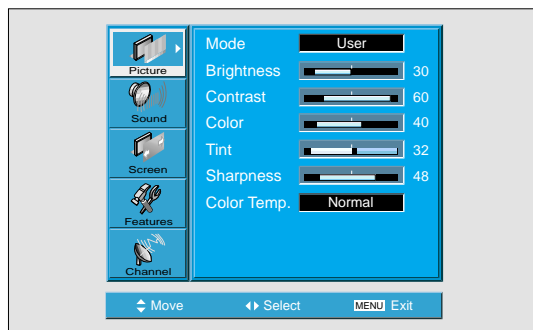

NOTES:

- 1) While you are in the PC or DVI INPUT mode, you can only adjust brightness, contrast, sharpness and color temperature.
- 2) When you adjust Brightness, Contrast, Color and Tint in DTV mode or adjust Brightness and Contrast in PC or DVI mode, the picture is adjusted finely.
- 3) The Tint control is used when the input signal is NTSC. If input signal is NTSC, Tint control is displayed in picture menu.
- 4) Selecting the Color Temperature makes the mood normal, warm or cold.

Adjusting Screen Size

Adjusting Screen Size

- You can adjust screen size or aspect ratio as desired.

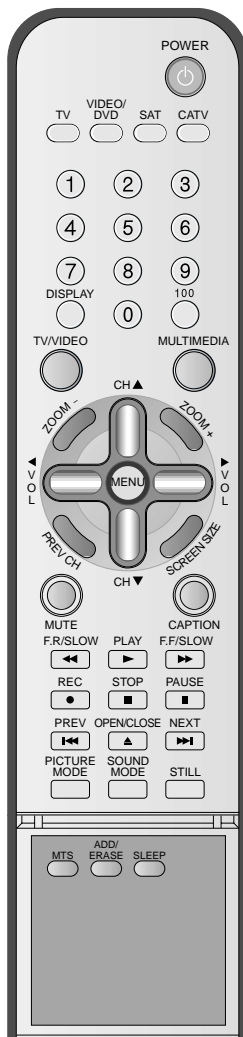

1 Press the "SCREEN SIZE" Button.



- Each time you press the "SCREEN SIZE" button on the Remote Control, a different "SCREEN SIZE" appears. The sequence used is as follows:
- The current screen size will be displayed on the screen.

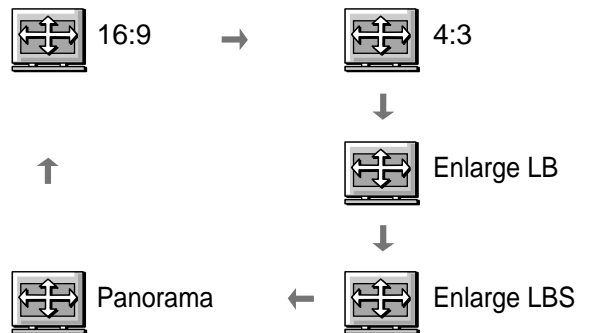

NOTES:

- When the INPUT SIGNAL is DTV [in Component 1 or Component 2], only the aspect ratios of 16:9 and 4:3 are available.
- Displaying a picture in a 4:3 mode for a long time may cause phosphor of the PDP to be burned. So avoid displaying a picture in 4:3 screen size for a long time.
- 16:9 : Theater-like 16:9 picture formats
 4:3 : 4:3 picture formats like an Analog TV.
 Enlarge LB : Enlarges the screen as to fill the black part of up and down.
 Enlarge LBS : Enlarges the screen, and shifts up as to see the subtitles in case you are watching video with subtitles.
 Panorama : 16:9 picture formats with panorama effect.
- If the picture shows unclear image in the 480p component input source, try to toggle the resolution from the [MENU]-[Screen]-[DTV/DVD]. This menu appears only when the input signal is component 480p.

1 Press the MENU Button.

- Press the [MENU] button on the Remote Control.

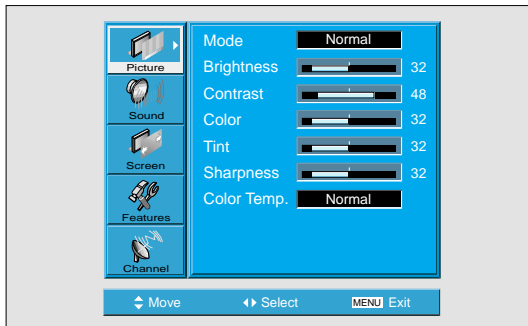
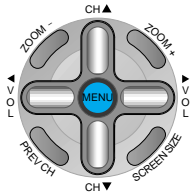

2 Select [Screen].

- Press the Channel “▲CH▼” button to select [Screen].

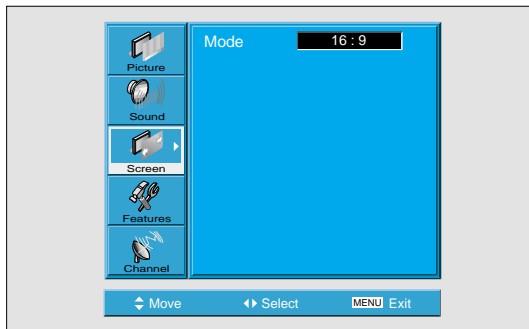
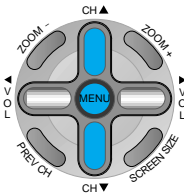

3 Select the [Screen Size].

- Enter the sub menu by pressing “◀VOL▶” button.
- Press the Volume “◀VOL▶” buttons to select [Screen Size].

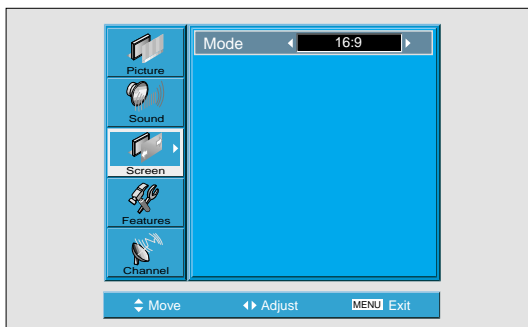
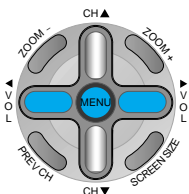

Adjusting from MENU Screen

- Available Screen Mode

Input	Available Mode
DVI	H, V Size
PC	H, V Size and Position, Phase, Frequency
Video Component (480i)	16:9, 4:3, Enlarge LB, Enlarge LBS, Panorama
Component (480p or above)	16:9, 4:3

Adjusting Screen Size(PC, DVI)

Adjusting Screen Position and Size

- You can adjust the screen position and size as desired.

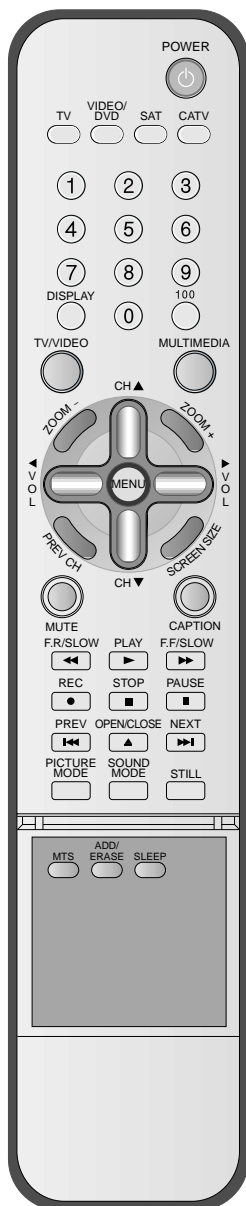

1 Press the MENU Button.

- The MENU screen as shown below will appear.

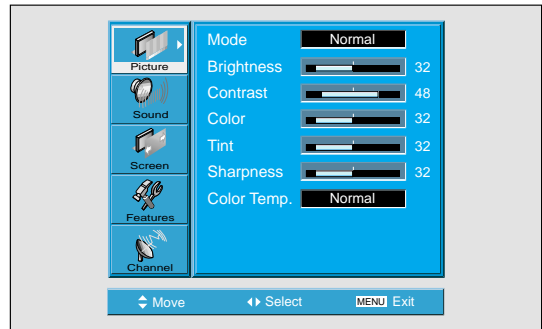
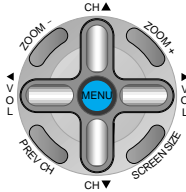

2 Press the “▲CH▼” button.

- Press the “▲CH▼” button to select [Screen].

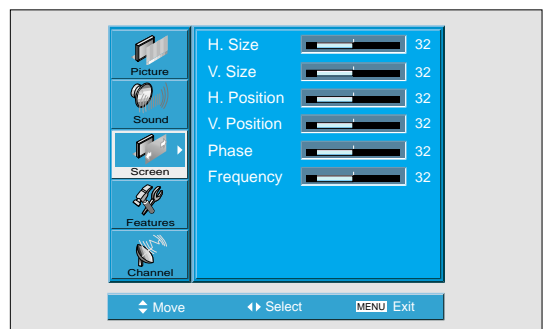
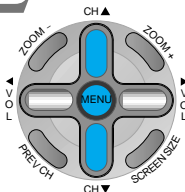



3 Press the Volume “◀VOL▶” button.

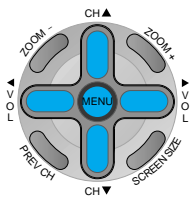

- Press the Volume “◀VOL▶” button to enter the sub menu of [Screen].
- While you are in [Screen] mode, press the “▲CH▼” button to select a desired item, and then, adjust the value by pressing the “◀VOL▶”.

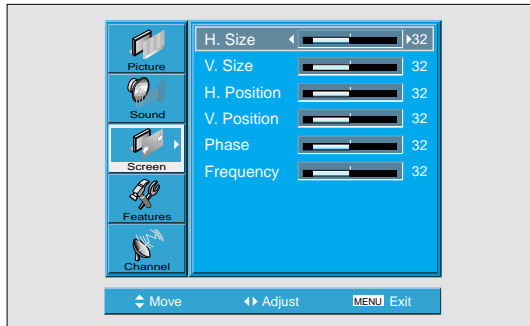

NOTES:

- 1) Horizontal/Vertical size and position values can be adjusted only in the [PC] input mode and in the [DVI] input mode, only Horizontal/Vertical size are available.
- 2) H. Size: As the value increases, the screen width increases
- 3) V. Size: As the value increases, the screen height increases.
- 4) H. Position: As the value increases, the screen moves to the right.
- 5) V. Position: As the value increases, the screen moves up.
- 6) Phase: When there is jitter or blurring of the image, adjust this value.
- 7) Frequency: When there is jitter or blurring of the image, adjust this value.
- 8) In case of DVI, only H and V size can be adjusted.
- 9) Using Screen Size button on the remote control, you can control the H and V size directly in PC or DVI mode.

Enlarging Screen Size

Enlarging Screen Size

- You can view enlarged size of the screen with this function

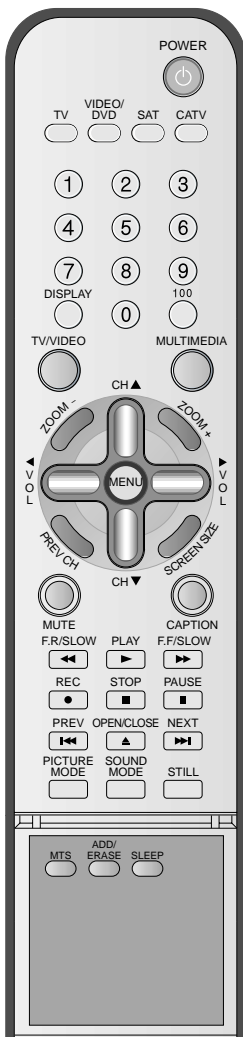

1 Press the “ZOOM+” Button.

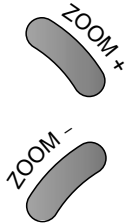

- Press the “ZOOM+” button to show currently selected screen size.
- Each time you press the “ZOOM+” button, the screen size will increase stepwise in 0 ~ 20 scale.
- To reduce the screen size, press the “ZOOM-” button.

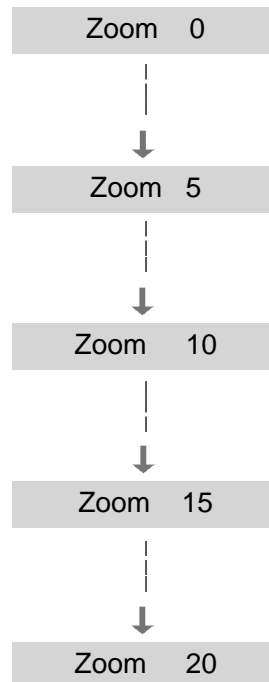
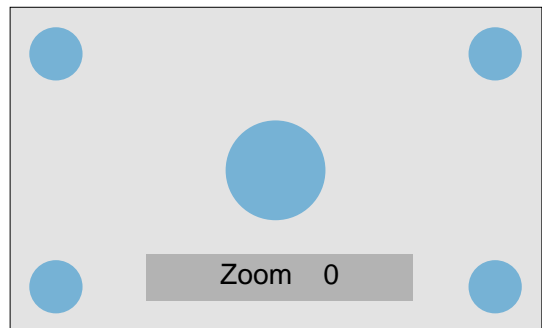

2 Move the Screen Position.

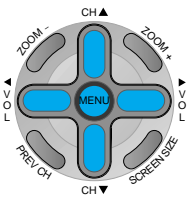

- While you are in the 'Zoom' mode, press the "▲CH▼" and "◀VOL▶" buttons to move screen stepwise up/down and left/right, respectively.

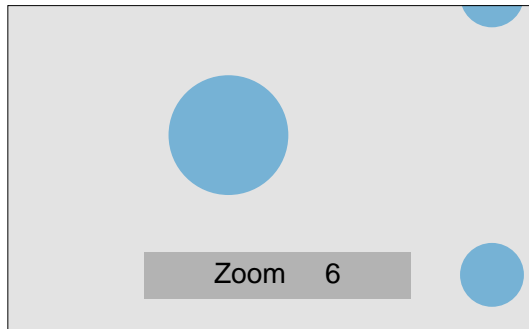

NOTES:

- 1) When the screen is enlarged, the pixel of the screen can become thick and dim.
- 2) When only subtitle of zoom level remains, you can scroll the image.
If subtitle of zoom level disappears, press zoom key, and scroll the image.

Watching a STILL Image

Watching a Still Image

- You can view still images with this function. However, displaying the same images such as still images for a long time may cause image sticking.

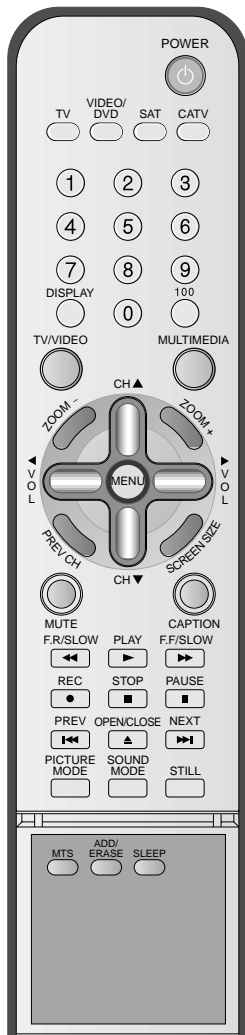

1 Press the “STILL” Button.

STILL



- If you wish to freeze a picture, press the “STILL” button. You can still hear the sound.
- Press “STILL” button to cancel the “STILL” function.
- To view the enlarged images, press the “ZOOM+” button.

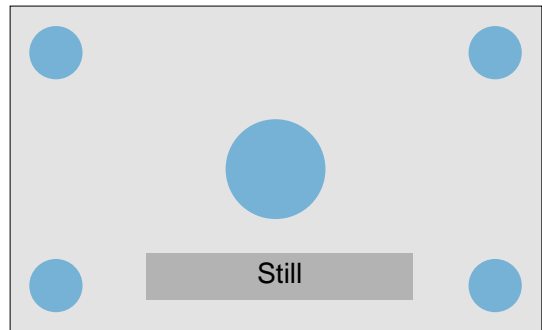

2 Move the Screen Position.

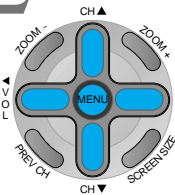

- While you are in still mode, press the “▲ CH▼” and “◀VOL▶” button to move screen stepwise up/down and left/right.

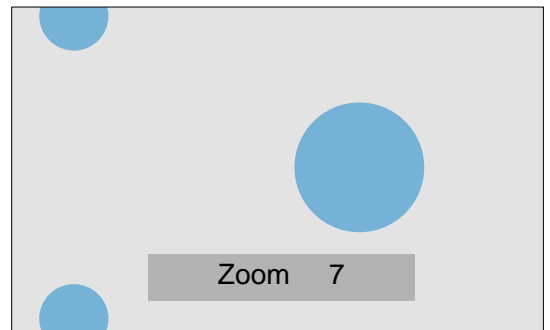

NOTES:

- Displaying the same images such as still images for a long time may cause image sticking (after-image lagging).
- In this case, such “image sticking” may become less noticeable if moving images are later displayed for a long time.
- However, an image sticking may become a permanent one, damaging the Plasma Display; therefore, avoid displaying the same images for a long time.
- Use the function [ISM], while displaying still images for a long period of time to minimize this effect.

Adjusting Auto Sound Mode

1 Select "SOUND MODE".

SOUND
MODE



- Press the "SOUND MODE" on the Remote Control.
- Current sound mode will be displayed.

2 Every Press of the Button Changes Modes.

SOUND
MODE



- Each time you press the button, a different sound mode appears. The sequence used is as follows:

Normal → Movie → Music → News → User

- * Normal : Suitable for watching any motion picture
- * Movie : Select this mode to simulate being at a movie theater
- * Music : Ideal for listening to music
- * News : Allows human voice to be heard more clearly
- * User : Allows the user to adjust as desired.

3 MENU will Disappear.

- After selecting a desired sound mode, on-screen menu will disappear in about 2~3 seconds.
- Normal, Movie, Music and News Modes are factory preset values. If you want to customize the sound modes at your preference, refer to the following page.

Adjusting Auto Sound Mode

- Enjoy various sound modes by selecting your favorite Sound Mode depending on the kinds of moving pictures.

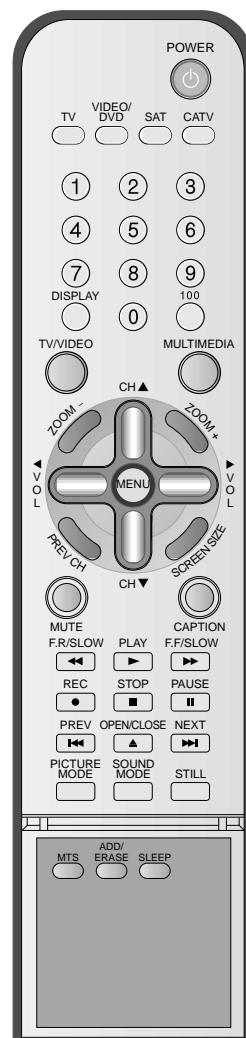

Customizing Sound Mode

Customizing Sound Mode

- This feature allows the user to adjust at his preference.

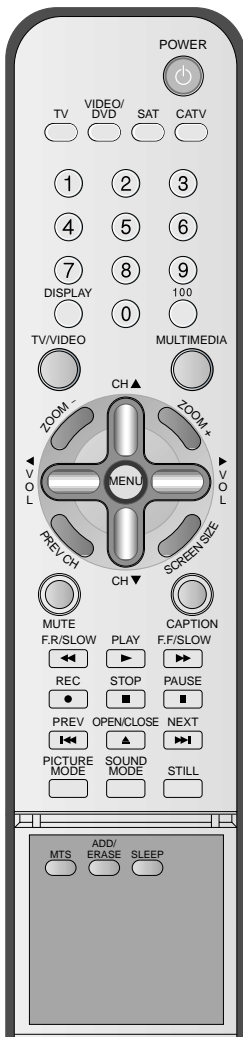

1 Press the MENU Button.

- The MENU Screen as below will be displayed.

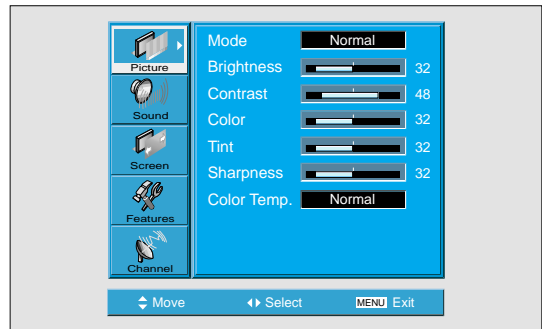
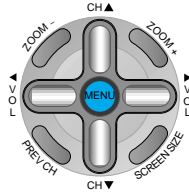

2 Press the “▲CH▼” button.

- Select [Sound] by pressing the “▲CH▼” button, then press the “◀VOL▶” button to display the following.

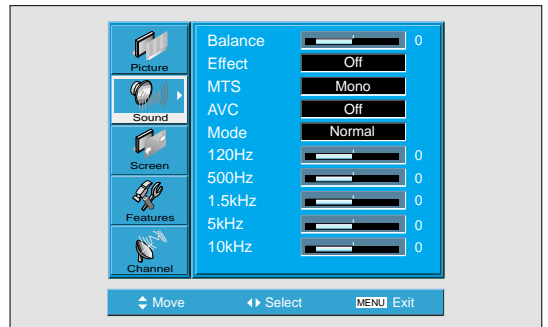
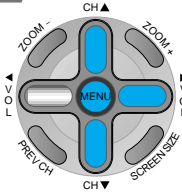

3 Select SOUND BALANCE.

- Select Sound [Balance] by the “◀VOL▶” button, then adjust it.
- Sound Balance Function adjusts sound balance of left and right speaker.

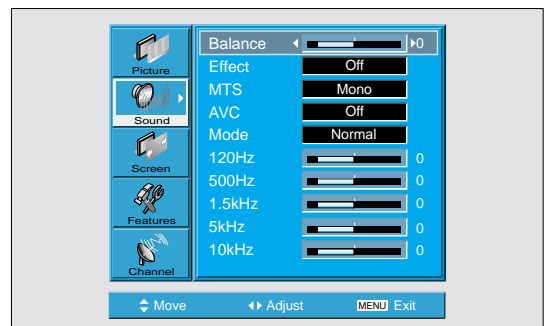
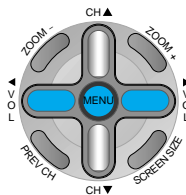

4 Select the Effect Mode.

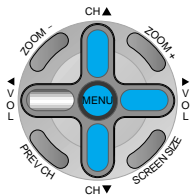

- Select [Effect] by pressing the “▲CH▼” buttons, then select ON/OFF by pressing the “◀VOL▶” button.
- [Effect]: Used to emphasize stereo effect.

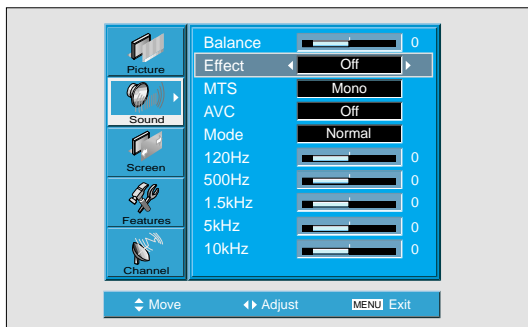

5 Select the Sound Mode.

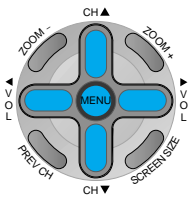

- Select the Sound Mode by pressing the “▲CH▼” button, then adjust it by pressing the “◀VOL▶” button.

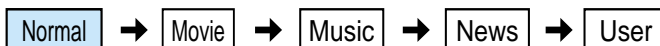
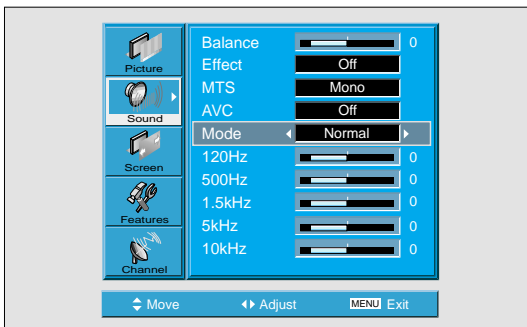

- * Normal : Suitable for watching any motion picture
- * Movie : Select this mode to simulate being at a movie theater
- * Music : Suitable for listening to music
- * News : Allows human voice to be heard more clearly
- * User : Allows the user to adjust as desired.

NOTES:

- 1) User Mode : Used as an Equalizer with which the user can adjust the sound frequency as desired.
- 2) If you modify the sound frequency in auto Sound Mode (News, Movie, Music, etc.), it is automatically switched to the User Mode.
- 3) For the realistic sound effect, lower than 120Hz frequency sound and greater than 10kHz frequency sound are emphasized.
- 4) If you make connection to the Left Audio Input as input is MONO you can hear from both speakers.
- 5) AVC function : This function adjusts volume to the set level automatically. However, depend on the sources, it may have different volume level because the sound sources have their own initially set up levels.
- 6) MTS function can control the sound output according to the current state of sound.
Pressing “DISPLAY” button displays current state of sound in the OSD located upper right corner of the screen.

MTS Function

If a channel is received in two languages (dual language) and stereo, you can switch to MONO, STEREO or SAP by the MTS menu or pressing the MTS button of the remote control repeatedly.

MONO

MONO sends the mono sound to the loudspeakers.

STEREO

STEREO sends the stereo sound to the loudspeakers.

SAP

SAP sends the secondary broadcast language to the loudspeakers.



Selecting INPUT SIGNAL

INPUT SIGNAL

- Used to select INPUT signal of external device connected to the PDP.

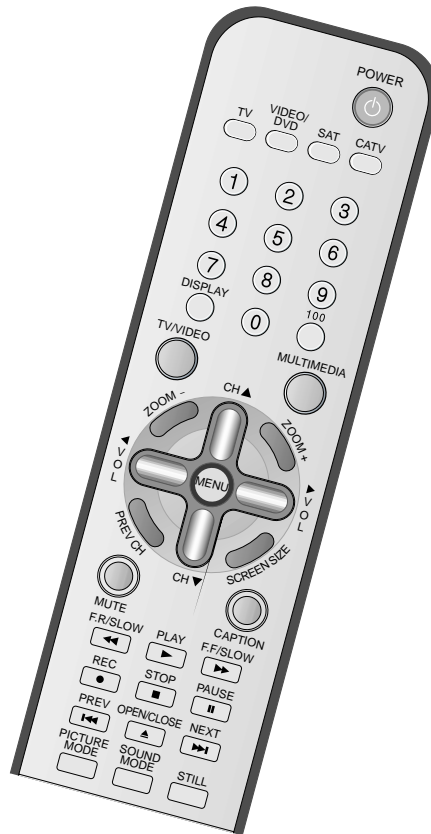

1 Press the INPUT SELECT Button.

TV/VIDEO



MULTIMEDIA



- Press the “TV/VIDEO” and “MULTIMEDIA” button on the Remote Control or the PDP Display to select desired input signal.
- Each time you press the “TV/VIDEO” or “MULTIMEDIA” button, a different screen mode appears. The sequence used is as follows:

• “TV/VIDEO” button

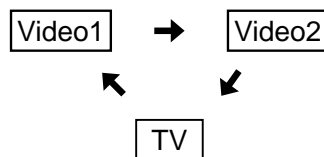

• “MULTIMEDIA” button

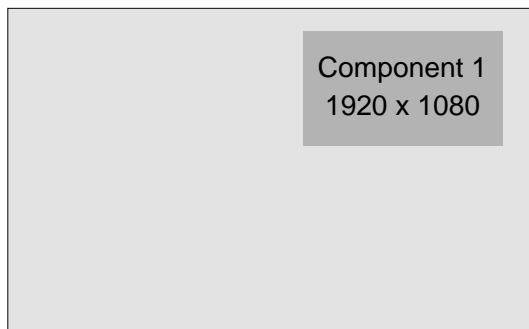
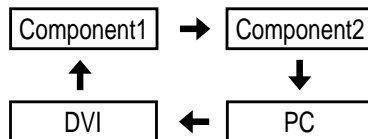

NOTES:

- 1) If an external device is not connected or INPUT signal is not applied, Warning Message (“No Signal”) would be displayed.
- 2) In this case, check if external device is connected and/or terminal connection is properly done.
- 3) Also, you can select input using [INPUT SELECT] button in the keypad of the pdp set.
The used sequence is as follows:
TV -> PC -> DVI -> Component1 -> Component2 -> Video1 -> Video2

Checking the Current Input Signal

Checking the Current Input Signal

- Used to check the INPUT signal mode, resolution, frequency(video only), etc. of the current screen.



1 Press the “DISPLAY” Button.

- Press the “DISPLAY” button on the Remote Control.

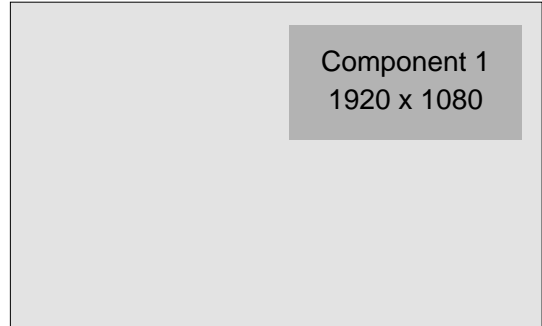
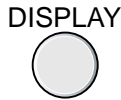

1. If you watch Component, PC or DVI :

Component 1 → Displays which input terminal is used, and indicates the input signal mode.
 1920 x 1080 → Indicates the horizontal and vertical resolution of the current INPUT signal.

2. If you watch TV:

Ch Mode Ch No. → Displays the Channel Mode and its number.
 MONO/STEREO/SAP/st. SAP Time → Indicates the current sound state and time.

3. If you watch VCR image:

Video 1 → Displays which input terminal is used, and indicates the signal mode.
 NTSC 60 Hz → Indicates the mode and frequency of the current INPUT signal.



NOTES:

- 1) DAEWOO PLASMA can receive NTSC, PAL, SECAM, etc.
- 2) “1920 x 1080” displayed in the INPUT signal is not the resolution of the TV. The displayed resolution is sent by Digital Broadcast Receiver.

MENU Background, Language and Key pad Lock Settings

1 Press the MENU Button.

- The MENU screen will be displayed as below.

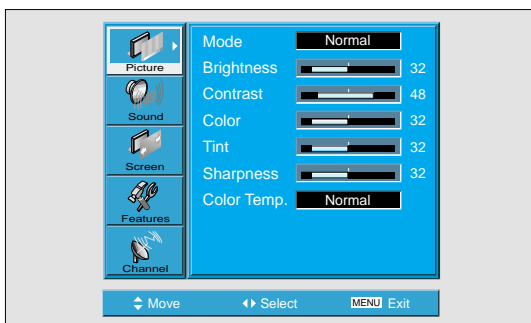
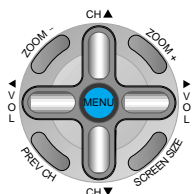

2 Press the “▲CH▼” Button.

- Select [Features] by Pressing the “▲CH▼” button.

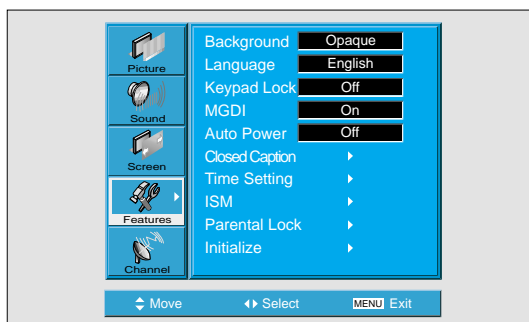
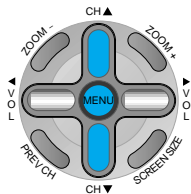

3 Select the menu Background.

- Select the MENU [Background] by pressing the “◀VOL▶” button.
- Every press of the “◀VOL▶” button while you are in the [Background] would switch between Transparent and Opaque.

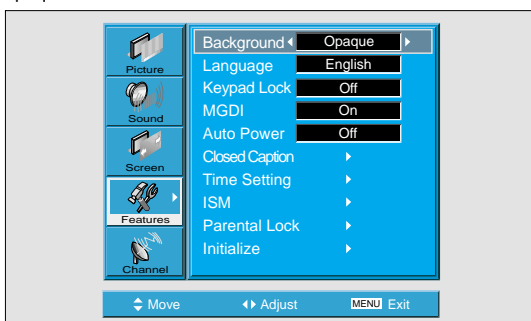
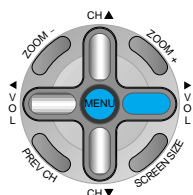

Menu Background and Language Settings

- Used to select transparent of MENU background and language used in MENU.

MENU Background, Language and Key pad Lock Settings

4 Select LANGUAGE by using the “▲CH▼” Button.

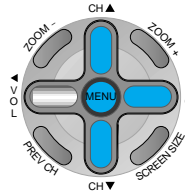

- Select LANGUAGE by using the “▲CH▼” button.
- Every press of the “◀VOL▶” button while you are in the [LANGUAGE] mode would cycle through the different languages.

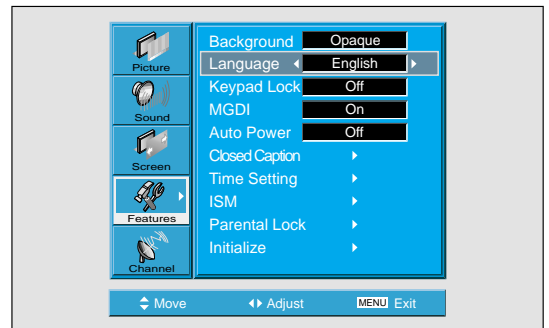

NOTES:

- * When Power is turned ON first time, 'SELECT LANGUAGE' Mode will be displayed, then, select a desired language by using “◀VOL▶” button. (Displayed only once)

5 Keypad Lock Setting

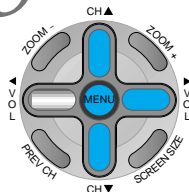

- Select [Keypad Lock] by the “▲CH▼” buttons, then press the “◀VOL▶” button to set Keypad Lock ON.

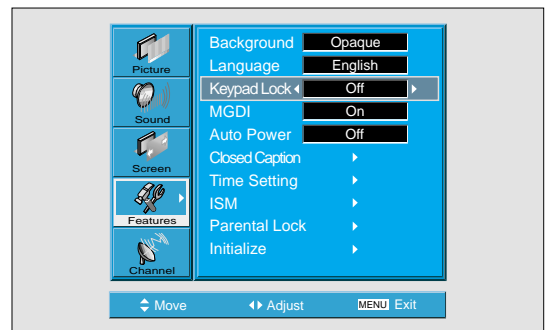

Keypad Lock

- 1) If Keypad Lock is set to On, pdp can be turned on only using the remote controller.



MGDI (Meta Genuine Digital Image)

MGDI is the image enhancement technology of Daewoo Electronics, which provides more clear, splendid, and delicated images.

1 Press the MENU Button.

- The MENU screen will be displayed as below.

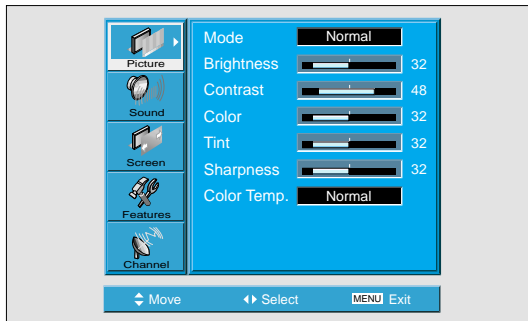
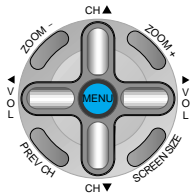

2 Select Features

- Select [Features] by the “▲CH▼” button.

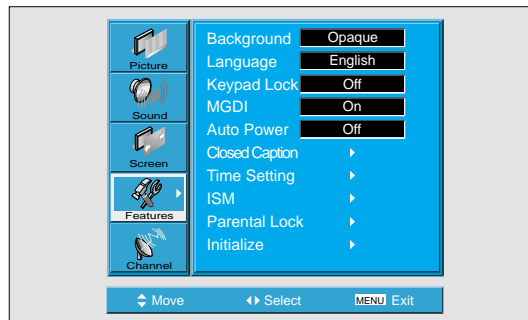
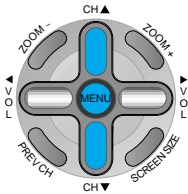

3 MGDI Setting

- Enter the sub Menu by using the “VOL ▶” button.
- Select the [MGDI] by pressing the “▼CH▲” button.
- You can select [MGDI] On, Off, and Demo mode by using the “◀VOL▶” button.

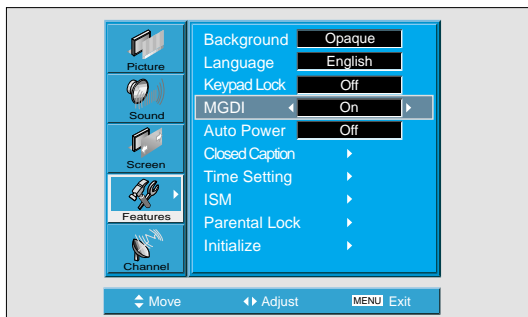
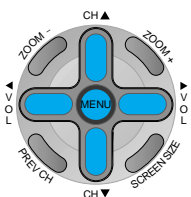

MGDI Demo

- When [MGDI] is set to Demo mode, Half of screen is [MGDI] ON and the other half is [MGDI] OFF.
- As [MGDI] is off, the sharpness of the Picture mode cannot be controlled.

* MGDI Demo Mode

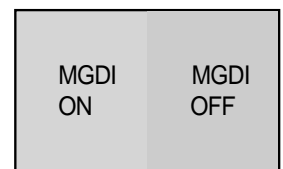

Auto Power Setting

POWER/STANDBY Indicator

Front panel LED lights

- When the AC power is on : Green.
- When the AC power is in the standby mode : Red.

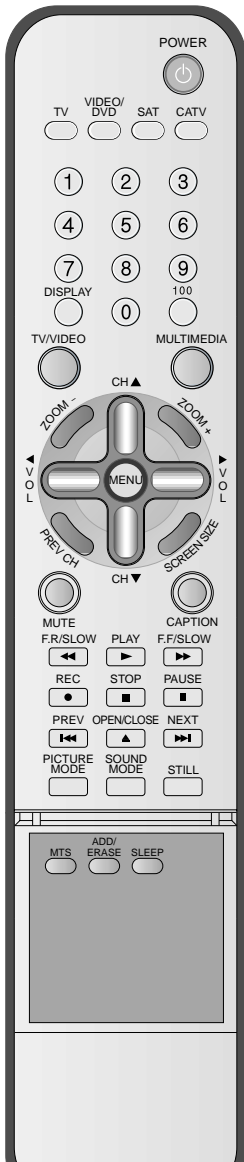

4 Auto Power Setting

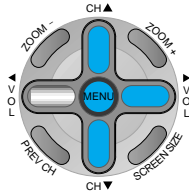

- Select the [Auto Power] by pressing the “▲CH▼” button from [Features].
- You can select [Auto Power] ON and OFF mode by using the “◀VOL▶” button.



Auto Power

- 1) ON : When the AC power is ON, the TV will be turned on automatically without pressing the power button on the remote control.

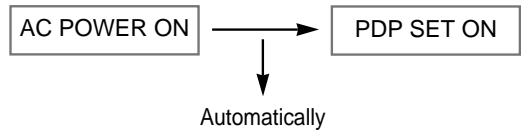

- 2) OFF : When the AC power is ON, the TV will be turned on by pressing the power button on the remote control or the keypad of front panel.

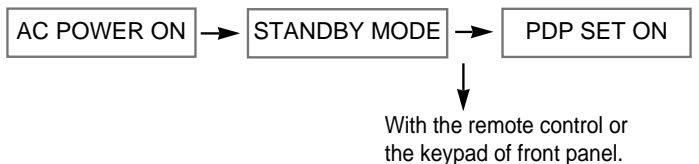

Closed Caption Setting

1 Closed Caption Setting



- Press the "CAPTION" button on the Remote Control.
- Whenever pressing the "CAPTION" button, caption mode is changed as follow.

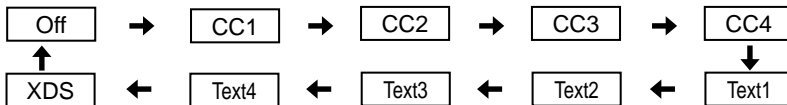

2 Closed Caption Setting in the Menu.

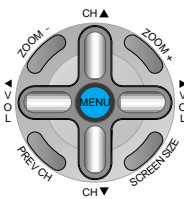

- Press the Menu Button.
- The MENU screen will be displayed as below.

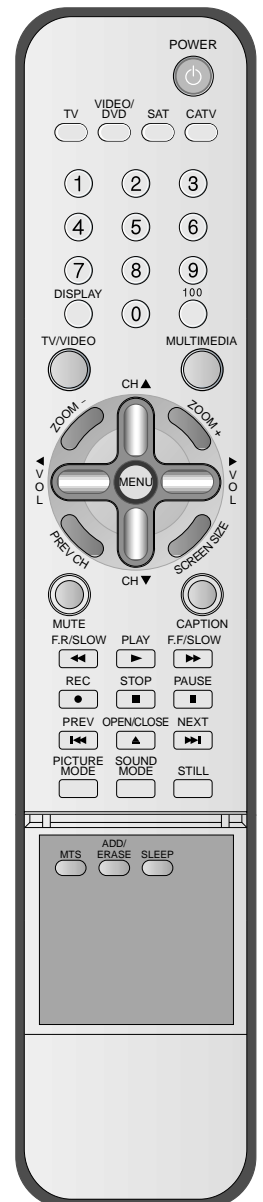
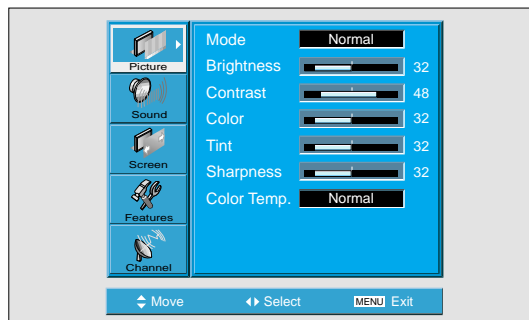

Closed Caption Setting

Caption Box Setting

- Black : Background of the caption box is black.
- Transparent : Background of the caption box is Transparent.

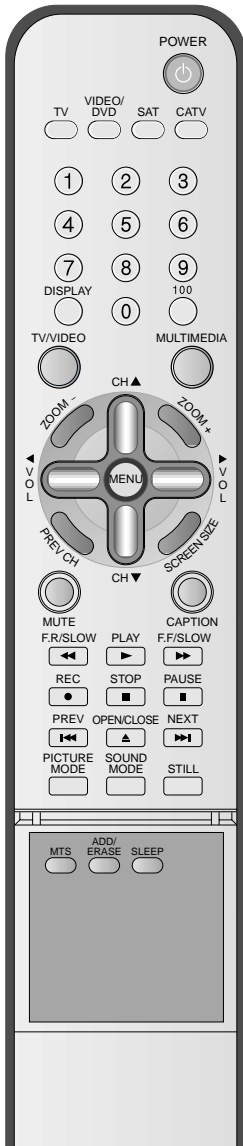

3 Select Features

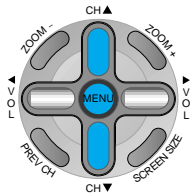

- Select [Features] by pressing the “▲CH▼” button.



4 Select Closed Caption

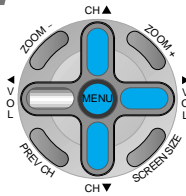

- Enter the sub menu by using the “◀VOL▶” button.
- Select the [Closed Caption] by pressing the “▲CH▼” button.
- You can select [Closed Caption] by using the “◀VOL▶” button.

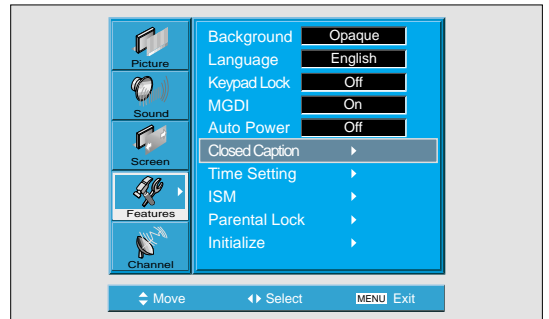

- Caption Mode (Off -> CC1 -> CC2 -> CC3 -> CC4 -> Text1 -> Text2 -> Text3 -> Text4 -> XDS -> Off), caption box (black and transparent) and CC on Mute can be set. CC on Mute function : Display “CC1” automatically when sound is “MUTE”.

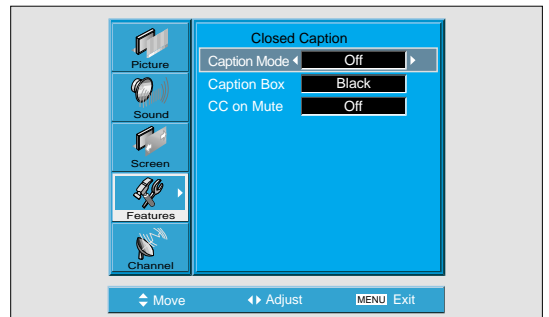

Time Setting

1 Press the MENU Button.

- The MENU screen will be displayed as below.

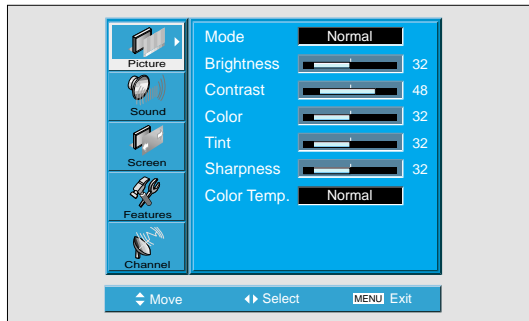
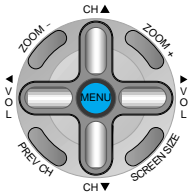

2 Select Features

- Select [Features] by the “▲CH▼” button.

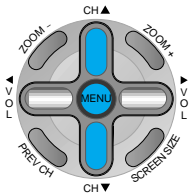

3 Select Time Setting

- Enter the sub menu by using the “◀VOL▶” button.
- Select the [Time setting] by pressing the “▲CH▼” button.
- You can select [Time setting] by using the “◀VOL▶” button.

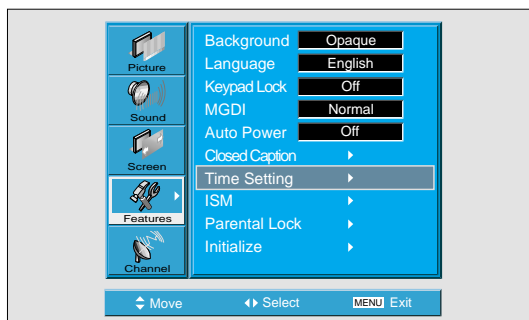
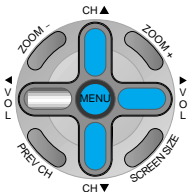

Time Setting

Clock(current time) Setting

- The "Current time" must be set up ahead of setting up other time memories.



4 Off Time and Wake Time settings.

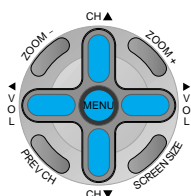

- Select Functions by pressing the "▲CH▼" button. First, set [Clock]- current time, and then You can setup off-time and wake time.
- [Clock] : Enter clock setting menu by pressing the "VOL▶" button. then adjust the desired hour and minute with "▲CH▼" button.
- [Off Time] and [Wake Time] Setting methods are same as [Clock] setting method.
- [Off Timer] and [Wake Timer] : Setting [On] and [Off] of each Timer.
- [Wake Ch.] and [Wake Vol.] : Setting channel and volume when TV is turned on by [Wake Timer].

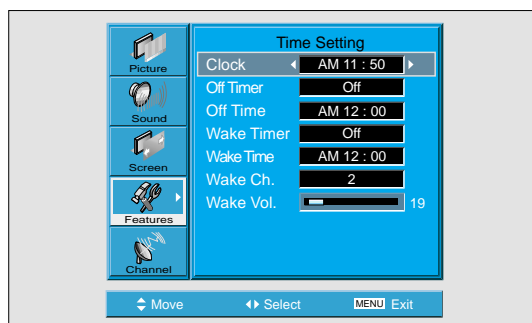

Time Setting Functions

- This time memory function automatically turns the TV set "On" of "Off" at a desired time. Once set up, this function works every day unless the set time is canceled or the TV set is unplugged. Therefore, this function could be used for a "Get up" alarm (Morning Call) by setting up the time for "On" in the morning.
- However, if you once power off with ON/OFF in the PDP unit, the Time Setting will be reset.

Image Sticking Minimization(ISM)

1 Press the MENU Button.

- The MENU screen will be displayed as below.

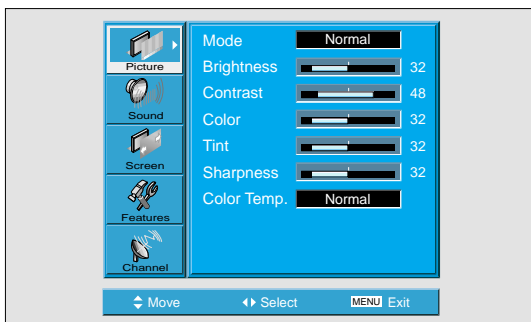
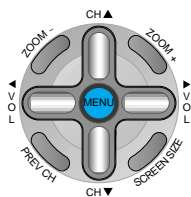

2 Press the “▲CH▼” Button.

- Select [Features] by pressing the “▲CH▼” button.

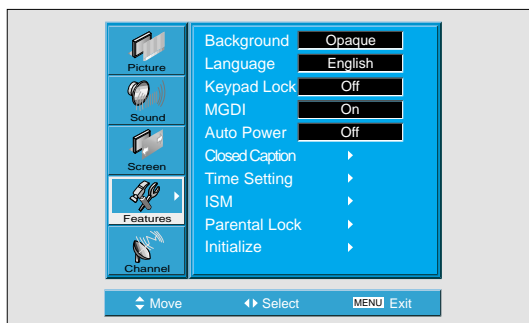
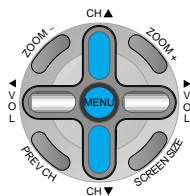

3 Select ISM.

- Enter the sub menu by using the “◀VOL▶” button.
- Select the [ISM] by pressing the “▲CH▼” button.
- Press of the “◀VOL▶” button while you are in the ISM.

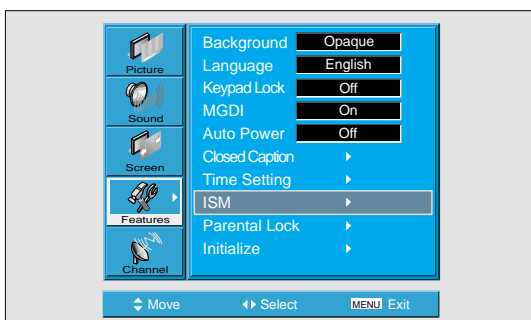
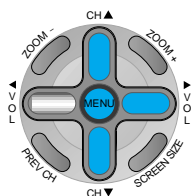

ISM

- Image sticking minimization.
- Displaying a still image like PC input for a long time causes part image sticking in the panel
- The ISM function minimize this effect.

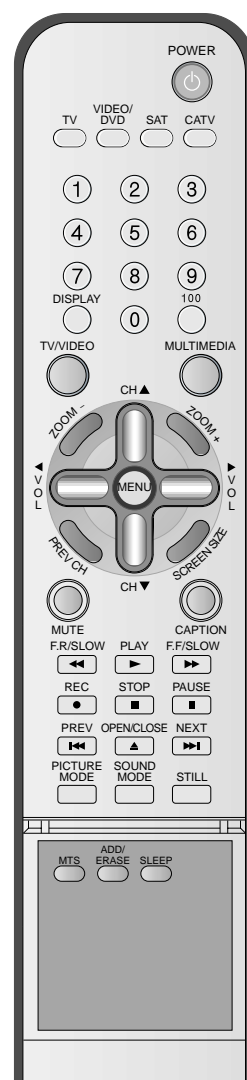
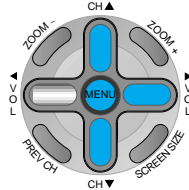
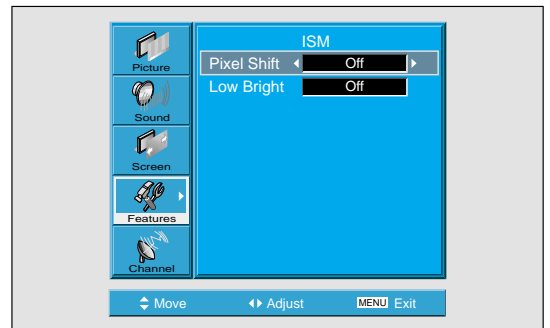

Image Sticking Minimization(ISM)

4 Select Functions.



- Every press of the “◀VOL▶” button after select function by the “▲CH▼” button would switch between ON/OFF.



NOTES:

- * **Pixel Shift** : The whole screen shifts up/down, left/right at 20sec interval to minimise image sticking.
- * **Low Bright** : When displaying a still picture or a fixed pattern for a long time, the brightness level decreases to minimise image sticking.

Parental Lock Setting

1 Press the MENU Button.

- The MENU screen will be displayed as below.

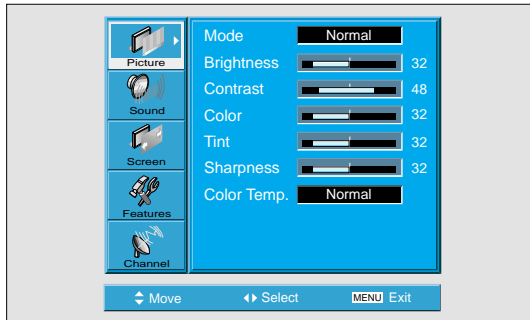
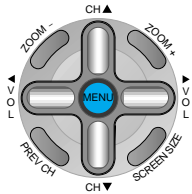

2 Select Features

- Select [Features] by pressing the “▲CH▼” button.

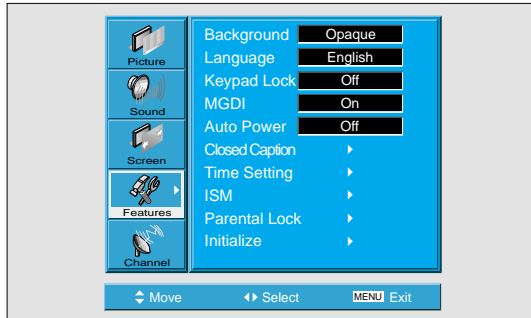
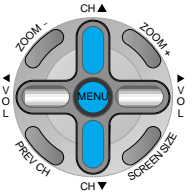

3 Select the Parental Lock

- Enter the sub menu by using the “◀VOL▶” button.
- Select the [Parental Lock] by pressing the “▲CH▼” button.
- You can select [Parental Lock] by using the “◀VOL▶” button.

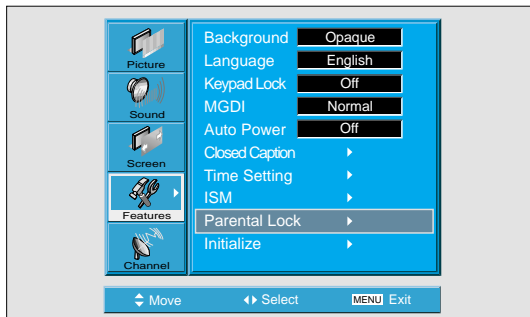
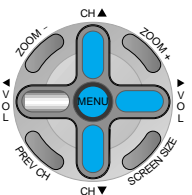

Parental Lock

- When “Parental Lock” is on, the locked channels are not available on the screen.

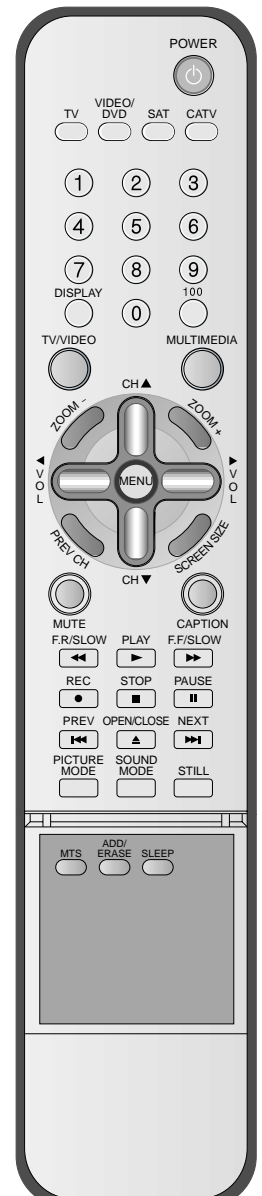

Parental Lock Setting

New Password setting

New Password setting menu is displayed at first use.
Set New Password for using Parental Lock menu.

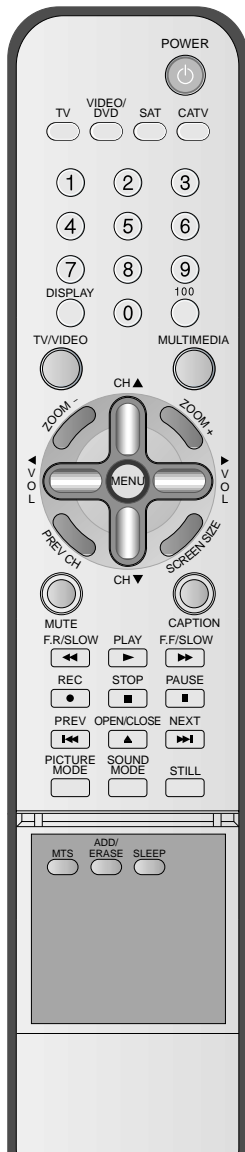

4 Press "Password".

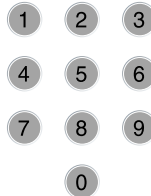

- Press Password by using number 0~9.

Caution) If using your password, remember it. It is needed for continuous use of this function hereafter.

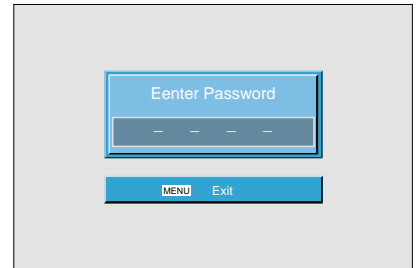

On – Off of the Parental Control is repeated whenever pressing the "◀VOL▶" button.

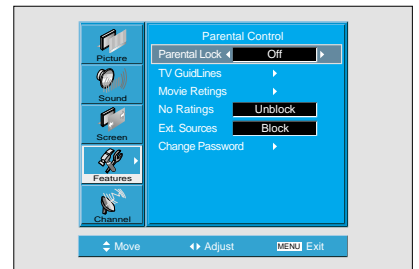
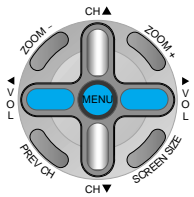

- A guideline of TV is setup in all the TV programs including sports, news.

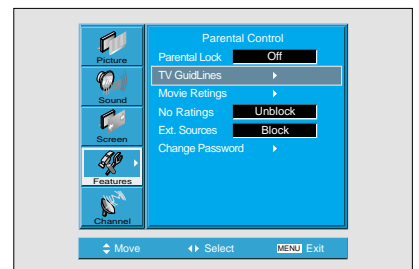
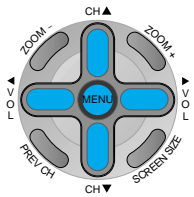

- The "▼CH▲" and "◀VOL▶" button select items and the "MUTE" button sets up or cancels each item.

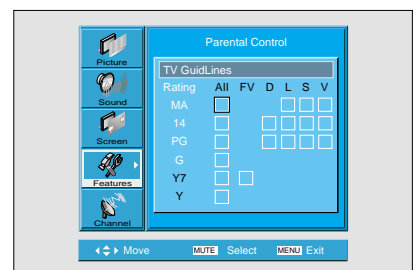
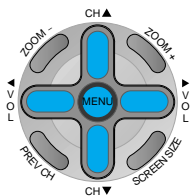

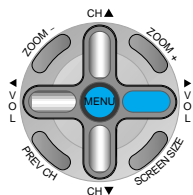

- Rating of movie is setup even in movie, videotape and other media objects including TV program.

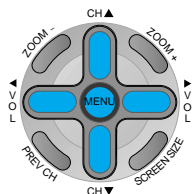
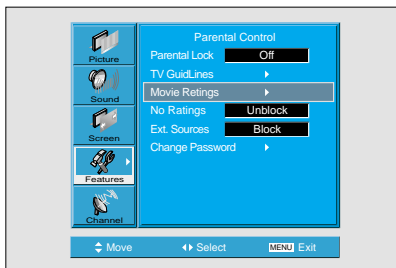

- The “▼CH▲” and “◀VOL▶”button select items and the “MUTE” button sets up or cancels each item.

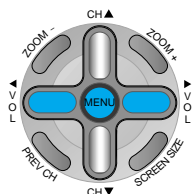
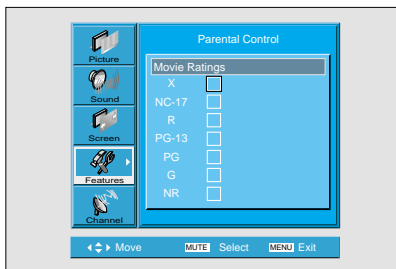

- Interrupts program without rating.
- Interrupts program of the input terminal for the outside video (Video 1, 2)
- Sets up the Unblock or the Block with the “◀VOL▶” button.

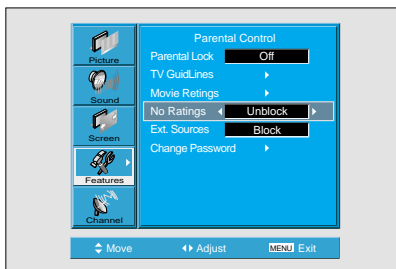

Parental Lock Setting



5 "Change Password".

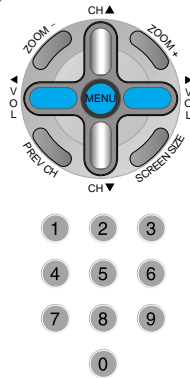

- In the initial purchase of TV set, password is set to blank.
In continuous use of Parental Control, you need to change your password.
- If pressing the "◀VOL▶" button after selecting password, the second screen of below drawing appears. Here, newly enter your unique password by using number of 0 through 9. Enter your password in the same manner once again.

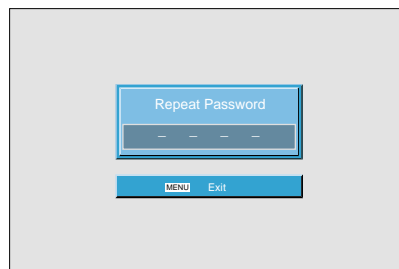
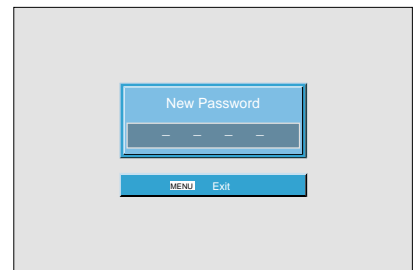
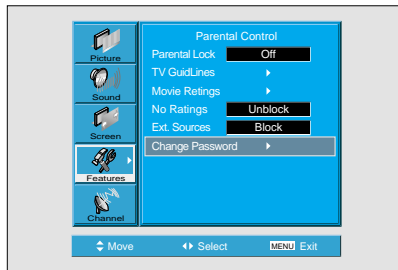

6 Exit from the "Parental Control" menu.

- The main menu appears if pressing the menu button once.
- The OSD of the menu disappears if pressing the menu button until it disappears.

Initialize Setting

1 Press the MENU Button.

- The MENU screen will be displayed as below.

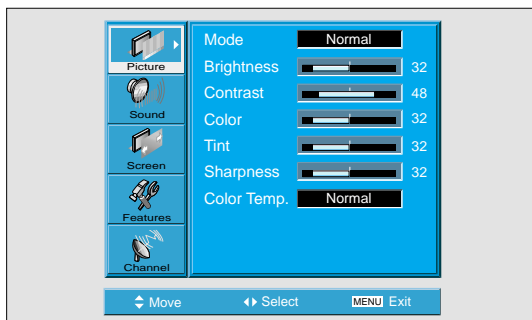
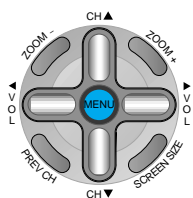

2 Select Features

- Select [Features] by the "▲CH▼" button.

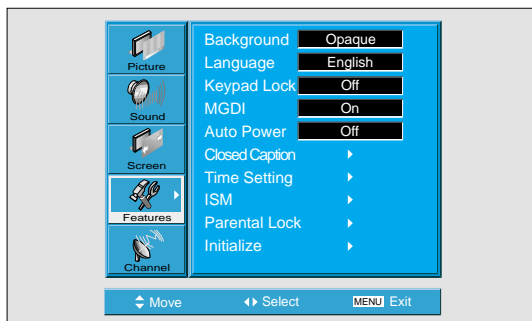
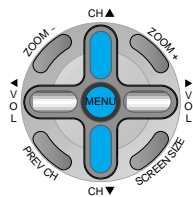

Back to Initialization

- You can restore the values of the adjustment setting made in the MENU to factory settings.



Initialize Setting

3 INITIALIZATION

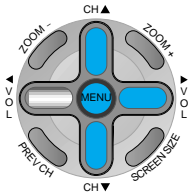

- Enter the sub menu by using the “◀VOL▶” button.
- Select the [Initialize] by pressing the “▲CH▼” button, then press the “◀VOL▶” button.
- A confirmation message will be displayed.
- To perform initialization, press the “VOL▶” button after selecting [YES] by pressing the “▲CH▼” button.
- To return to MENU, press "MENU" button.

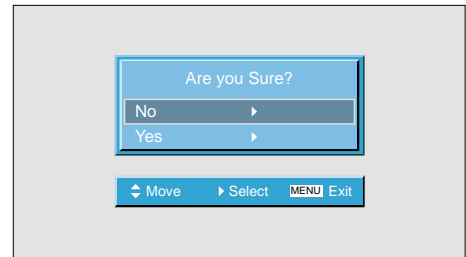
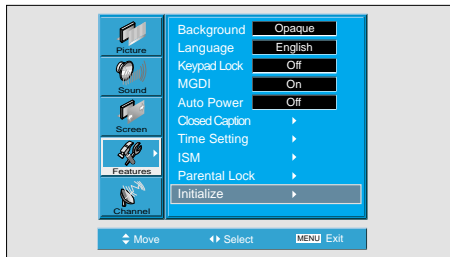

When [INITIALIZATION] is completed:

- 1) When [INITIALIZATION] is completed, those values that have been set in the User Mode of [SCREEN MODE] and [SOUND MODE] will be returned to the factory preset values.
- 2) Once initialized, you can not undo.
- 3) The items in the [SCREEN] Menu in PC or DVI INPUT are also initialized (i.e., H. Size, V. Size, H. Position, V. Position, Phase, Frequency, etc.)
- 4) Language, channel, time, volume, input mode are not initialized.

Setting Sleep Timer

1 Press the "SLEEP" Button.



- Press the "SLEEP" button on the Remote Control.
- Pressing the "SLEEP" button first time will display the current setting for SLEEP TIMER.
- To cancel the SLEEP TIMER, press the "SLEEP" button to select 'OFF'.

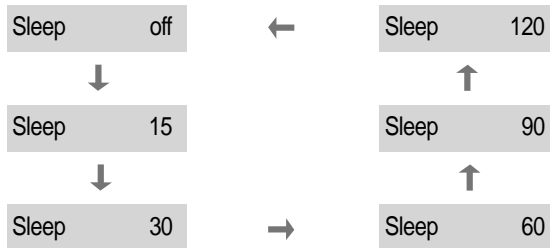
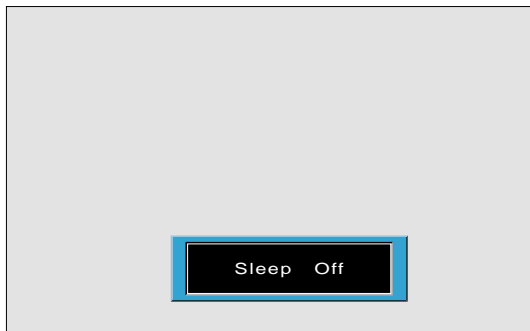

NOTES:

- 1) On-screen information disappears if you do not take any action for about two seconds after pressing the SLEEP button.
- 2) If you turn the PDP off after setting SLEEP, the setting is erased.

Setting Sleep Timer

- SLEEP TIMER turns the PDP off after a preset time.



Before Requesting Service

Before requesting for service, check the following points once again.

Symptoms

Checks

Action

- Remote control does not function properly.

- Check for any obstacle between the Remote Control and the Display.
- Check for dead batteries and incorrect battery orientation.
- Check if the Remote Control is the right one.

- Remove any obstacle between the Remote Control and the Display.

- Replace batteries and use the correct polarity (+) or (-) of the batteries.

- Use the correct Remote Control proper to the model.

- The Display makes a snapping sound.

- Check if the pictures and sound are normal.

- This sound is produced due to variations in room temperature.
- This sound does not indicate that the Display has a problem if the pictures and sound can be viewed and heard properly.

- There are empty spots at the top and the bottom area of the screen.

- Check if the screen size of an image is wider than 16:9 aspect ratio (theater screen size).

- When video screen is wider than 16:9 aspect ratio, you may see dark areas at the top and the bottom of the screen.

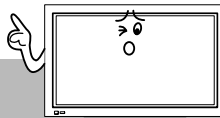

Before Requesting for Service

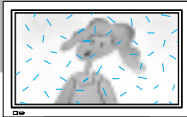

Symptoms

Checks

Action

- There are spots on the screen or screen rolls.

- Check if your product is affected by any interference from automobiles, high-voltage transmission lines, neon signs or other potential sources.

- Screen size is suddenly changed.

- The screen size of a video image may not be matched to the size of the dark initial screen.

- Check by using other video tape.

SPECIFICATIONS

In the event that the product has been submerged in the water in rainy season:

Immediately wash it with clean water, and dry it in a shadow place, then call for service from the nearest Daewoo Service Center.

Never plug the Power Cord since there is risk of electric shock and damage of the product.

DISPLAY UNIT

Diagonal Size	106cm (42")
Screen Aspect Ratio	16 : 9
Display Resolution	853(H) × 480(V) dots
Pixel Pitch	1.08(H) × 1.08(V) mm
Video Signal	NTSC, PAL, SECAM, PAL-M/N, NTSC4.43
Dimension	1044(W) × 631(H) × 89(D)mm 41.10(W) × 24.84(H) × 3.50(D)inch
Weight	30 kg (66.14Lbs)
Power Requirement	100-240V~, 50/60Hz

* Appearance and specifications of this product are subject to change for improving the product without prior notice.

INPUT/OUTPUT TERMINAL

	ITEMS	VIDEO	AUDIO
EXTERNAL INPUT	DVI INPUT	DVI-D Digital Only Jack	(LEFT/RIGHT)
	PC INPUT	one 15 pin D-sub jack	(LEFT/RIGHT)
	Component INPUT	Y, Pb/Cb, Pr/Cr RCA Jack 2sets	2sets (LEFT/RIGHT)
	Video INPUT	RCA and S-Video Jack 2 sets each	2sets (LEFT/RIGHT)
	TV	Standard : NTSC-M Receiving Channel : VHF : CH02 ~ 13 (55.25MHz ~ 211.25MHz) UHF : CH14 ~ 69 (471.25MHz ~ 801.25MHz) CATV : CH1(73.25MHz), 14 ~ 125 (121.25MHz ~ 799.25MHz)	
EXTERNAL OUTPUT		VIDEO OUTPUT	RCA jack (LEFT/RIGHT)
AUDIO OUTPUT	SPEAKER OUTPUT (8 Ohm)	20W (10W + 10W)	

Free Manuals Download Website

<http://myh66.com>

<http://usermanuals.us>

<http://www.somanuals.com>

<http://www.4manuals.cc>

<http://www.manual-lib.com>

<http://www.404manual.com>

<http://www.luxmanual.com>

<http://aubethermostatmanual.com>

Golf course search by state

<http://golfingnear.com>

Email search by domain

<http://emailbydomain.com>

Auto manuals search

<http://auto.somanuals.com>

TV manuals search

<http://tv.somanuals.com>