

# Operation Manual

## DeskPilot II

World Time LCD Clock, w/ Built-in  
10 Digit, Desktop Calculator

**World Time—16 Cities!**

**DENVER, CHICAGO, NEW YORK, SAN JUAN,  
SYDNEY, ANCHORAGE, HONOLULU, LOS ANGELES,  
KARACHI, HONG KONG, TOKYO, LONDON,  
PARIS, JERUSALEM, MOSCOW, MY ZONE.**

**10 Digit Calculator**

**Calendar**

**Large Digit Clock w/ Musical Alarm**

**Currency Converter**

**Tip & Tax Calculator**

DF-551

**DATEXX**

### 1. Installing Main Batteries

**Step 1.** Open the battery cover located on the bottom.

**Step 2.** Use 2 AAA Alkaline Batteries and place them according to the polarity direction indicated.

**Step 3.** Close Battery Cover.

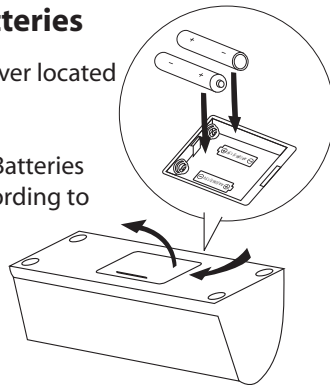

### Setting the Time and Date

The easiest way to set the time is to choose the largest city in your time zone and set the time for that key. Once you set the time for the largest city near you (See the city keys), all other time zones will be set automatically.

1. Press the CLOCK button to display the time mode
2. Select a City nearest you, except MY ZONE, by pushing the button with the selected City's name. (Note: City names are on each key.)
3. Then push SET twice and the HOUR on the display should be blinking.
4. Press "=" key to switch to 12-hour mode. Use the UP and DOWN buttons to change the Hour.
5. Press SET a 3rd time in order to change the minutes and the minutes will blink. Use the Up and Down buttons to adjust the minutes.
6. Press SET a 4th time for Month, a 5th time for Day, and a 6th time for Year. In each case, adjust the values using the Up and Down buttons.
7. After the Year has been selected, press CLOCK one more time to lock in the time.

**Notes:** The date display format may be toggled between (for example) 2/23 and 23/2 depending on your locality. To toggle this reading, press the [Clock] button on the front and then press [Tax-] on the calculator side the display will reverse date and month.

At any time during the above steps, pressing CLOCK will lock the settings and end the procedure. After you set the time for the city selected, all other city times will be adjusted accordingly.

### Choosing Military Time

1. Press the CLOCK button to lock into TIME MODE
2. Then push SET, the HOUR should be blinking.
3. Press the = key on the calculator side. This toggles the display into Military Time.
4. If you want to return to regular time, press the (=) key again.
5. At Any time, pressing CLOCK will lock the settings and end the procedure.

### Daylight Savings Time (DST Key)

For the US (except Anchorage, Alaska) compensation for Daylight Savings Time is automatic. The Daylight Savings Time (DST) adjustment applies to all US city keys, except the MY ZONE key.

## Setting custom time zone (MY ZONE)

For those of us who are not close to one of the 16 major key cities listed on this unit, Datexx has provided the MY ZONE key, which may be customized to your local time and is not affected by automatic Daylight Savings Time adjustments. If DST is desired, this adjustment may be made manually. MY ZONE is the only function not automatically adjusted. The custom time zone can be set by the following steps:

1. Press and hold the MY ZONE key for 3 seconds. The display "Minute" will flash.
2. Press UP or DOWN to adjust time. The time starts at London time and you can adjust time by increments of 30 minutes.
3. Press the MY ZONE key again to confirm the setting.

\*Caution! DO NOT press SET to confirm MY ZONE time setting. By doing so, it will change other cities' time. Auto DST feature does not apply on MY ZONE.

## Monitoring World Time

Once you have programmed your calculator with the local time (See above) you need only press a city key, e.g., Los Angeles, to see that time in that city.

## Setting the Musical Alarm

1. Press ALARM -- you will see A and 1. This number will tell you which song the alarm will use. You may choose between two different musical sounds. To test the songs just press any key between 1 or 2.
2. Then Press SET once to select the Hour, Twice to select the Minutes.
3. To change the Hour or Minutes push the DOWN and UP buttons. Be careful to note the PM designation, which will tell you whether you are setting the alarm for morning or afternoon.
4. Once your desired time has been selected, Press SET, then, to return to the time display, press CLOCK. (A small bell symbol on the left of the display will show that the alarm has been set.)
5. To Turn Alarm Off, Press ALARM twice -- until you see alarm time replaced by a row of dashes, then Press TIME.

**To disable a sounding alarm**, touch any key.

Operating the 10-Digit Calculator

To enter the calculator mode, touch the CAL ON CE/AC key. (The calculator automatically turns off after about 7 minutes if no key is pressed.)

## Performing Calculations

Addition (+)

Example:  $6 + 7 = 13$ . [6] + [7] = 13

Subtraction (-)

Example:  $10 - 4 = 6$ . [1] [0] - [4] = 6

Multiplication (x)

Example:  $7 \times 5 = 35$ . [7] x [5] = 35

Percentages (%)

Example: Calculate 6% of 100. [1] [0] [0] x [6] % = 6

Example:

Add 6% tax to \$20. [2] [0] + [6] % = \$21.20

Example:

Calculate a 20% discount from \$150. [1] [5] [0] - [2] [0] % = 120

Constant Calculations

Press = to repeat last function.

Example:

Calculate  $5 \times 5 \times 5 \times 5 + 2 + 2 = 629$

Press [5] x = = + [2] = = 629

## Profit Analysis

Example1: If the cost is \$19.95 and selling Price is \$39.90, what is the profit margin (%)?

Press [1][9][.][9][5] [COST] [3][9][.][9] [SELL]  
Profit% =50

Example2: If the selling price is \$20 and profit margin needs to be 50%, how much the cost should be?

Press [2][0] [SELL] [5][0] [Profit%]  
Cost=10

Example3: If the cost is \$69.3 and profit margin needs to be 30%, how much the selling price should be?

Press [6][9][.][3] [COST] [3][0] [Profit%]  
Sell =99

## Tax & Tip Calculations

### Setting the Tax or Tip Rate

To automatically calculate taxes and/or tips you need only enter the markup value such as 15% for tips into the calculator.

1. To set a Tax rate or a tip rate press CE/AC, then Press and hold the TAX RATE key until you hear a beep and a 0 will appear on the display.
2. Enter the Tax or Tip rate, (enter 15 in this example), and press TAX RATE again.
3. The Tax rate is now set.

## Adding and Subtracting Tips, Taxes and Discounts

Here is an example showing a convenient tip calculation: (This is assuming you have programmed the RATE key for a 15% tip.)

Once programmed with a value the key remains programmed until a new value is entered.

The Dinner is \$138.00

1. Press CE/AC
2. Enter 138
3. Press the TAX+ key and the tax will be automatically added to the total.
4. The total bill with tip = \$158.70
5. Press TAX+ key again and it will show the tip = \$20.70

If you need to figure a senior discount (10% for example), set the RATE using the procedure above, and this time, when you enter the \$138 dinner price, hit the TAX – key and the discounted value or in this case, \$120 will be displayed. Press TAX – key again and the discounted amount \$18 will be displayed.

Remember, once a Tax or Tip rate is set, it will remain in memory until a new rate is entered

## The Currency Conversion Mode

### Setting a Currency Rate

(Example: 1 US Dollar = 0.93 Euro)

1. Press CE/AC to clear calculations
2. Press the round CURRENCY EX RATE key and hold it until a blinking 0 appear on the display.
3. Press (0) (.) (93) and CURRENCY EX RATE key.
4. The conversion rate is now set. To change this rate, repeat the procedure outlined.

Example: How much is \$115.00 in Euros?

1. Press CE/AC to clear all calculations
2. Enter 115 and press the FOREIGN key
3. The answer is calculated automatically and displayed =106.95 Euros.

Example: How much is 100.00 Euros in USD?

1. Press CE/AC to clear all calculations
2. Enter 100 and press the HOME key
3. The answer is calculated automatically and displayed =107.52 USD.

## Battery Replacement

### Calculator/Calendar Batteries

1. Turn Calculator Over
  2. Replace Batteries following the Polarity Diagram Inside.
- NOTE: Use Two AAA Batteries

Warning: (Keep batteries out of the reach of children)

## Reset Feature

If at any time the Calculator or Clock freezes, Turn calculator over and locate the reset button on the bottom. Use an opened paper clip to push the button. (The actual button is located inside the cover). This will reset all functions.

## Care and Maintenance

Keep the calculator dry. If it gets wet, wipe it dry before use.

Do not use harsh solvents or detergents to clean.

Warning: (Keep batteries out of the reach of children)

#### Reset Feature

If at any time the Calculator or Clock freezes, Turn calculator over and locate the reset button on the bottom. Use an opened paper clip to push the button. (The actual button is located inside the cover). This will reset all functions.

#### Care and Maintenance

Keep the calculator dry. If it gets wet, wipe it dry before use.

Do not use harsh solvents or detergents to clean.

#### **TELEDEX Limited U.S.A. Warranty**

TELEDEX INC. warrants these products to the original purchaser to be free from defective material and workmanship. The product will be repaired or replaced at our option, for up to one year when returned with proof of purchase to the address below. Include a check or money order for \$5.00 to cover postage.

TELEDEX INC. 1 Atlas st. Kenilworth, NJ 07033

Warranty valid only in the U.S.A.

[www.datexx.com](http://www.datexx.com)

Printed in China 4/03

## Free Manuals Download Website

<http://myh66.com>

<http://usermanuals.us>

<http://www.somanuals.com>

<http://www.4manuals.cc>

<http://www.manual-lib.com>

<http://www.404manual.com>

<http://www.luxmanual.com>

<http://aubethermostatmanual.com>

Golf course search by state

<http://golfingnear.com>

Email search by domain

<http://emailbydomain.com>

Auto manuals search

<http://auto.somanuals.com>

TV manuals search

<http://tv.somanuals.com>